

# Pan Head Skt Barrel Nuts

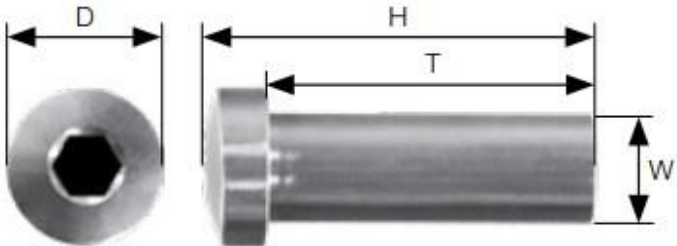

**316 SS**

	Hex Skt Drive	316 SS	D (mm)	T (mm)	Int. Thread Length (mm)	W (mm)
M3	2mm		8	12	9	5
M4	2.5mm		10	18	14	6
M5	3mm		12	30	26	7
M6	4mm		14	30	26	8
M8	5mm		16	34	27	10
M10	6mm		18	34	28	13
M12	8mm		21	40	34	15

# Csk Skt Barrel Nuts

**316 SS**

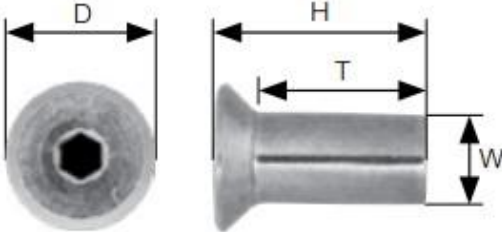

	Hex Skt Drive	316 SS	D (mm)	H (mm)	T (mm)	Int. Thread Length (mm)	W (mm)
M3	2mm		8	8	6	3	5
M4	2.5mm		10	12	10	3	6
M5	3mm		12	20	17	11	7
M6	4mm		14	23	19	13	8
M8*	5mm		15	27	22	16	10
M10**	6mm		20	27	22	16	12
M12	8mm		24	31	25	18	14

\*Will fit on M10 sleeve anchor  
 \*\*Will fit on M12 sleeve anchor