



Modular top plate/raceway design allows for several top plate and mounting hole configurations.

Elimination of kingpin eliminates the number one cause of swivel caster failure.

Patented heat-treated raceways reduce bearing indentations caused by impact loads allowing the swivel section to turn easily in the roughest applications.

Patented precision-machined raceway: reduces raceway wear, improves swivel action, reduces maintenance and provides longer service life.

RWM - The King of

Kingpinless

Casters

Technology in Motion™

RWM is the originator of the Kingpinless™ caster, the most emulated caster in the industry today.

RWM's Patented Offset Raceway – Why It's a Superior Design

Our patented offset precision-machined raceway exerts radial force evenly where there is full contact between the ball bearing and the raceway.

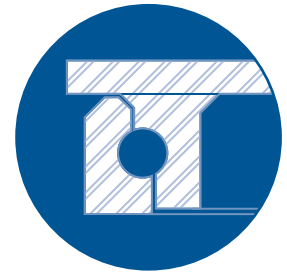

The result:

- No direct "hammering" forces on the intersections of the raceways
- Vastly reduced raceway wear
- Elimination of the "pull apart" forces of stress in the swivel section
- Smoother swiveling action
- High maneuverability
- Longer service life
- Less maintenance
- Extra impact resistance
- High radial force absorption

RWM's unique design adds more mass at key points. This, plus more thorough heat treatment, provides additional strength and combats brinelling into the core material.

We offer several top plate and mounting hole configurations to meet your specific needs.

The Majority of Competitor's Raceways

The inline positioning of the competition's raceway (as opposed to the offset positioning utilized by RWM) creates a direct "hammering" effect via the ball bearings which are centered on the tangent of the two raceways, thus savaging and eventually eroding the raceway. The inevitable result is a loose fit and progressive swivel failure. Even a double raceway configuration is subject to these same "hammering" hazards.

The machining requirements of the competition to accommodate a swivel lock reduces strength, leading to premature fatigue, stress fractures of the raceway and eventual failure.

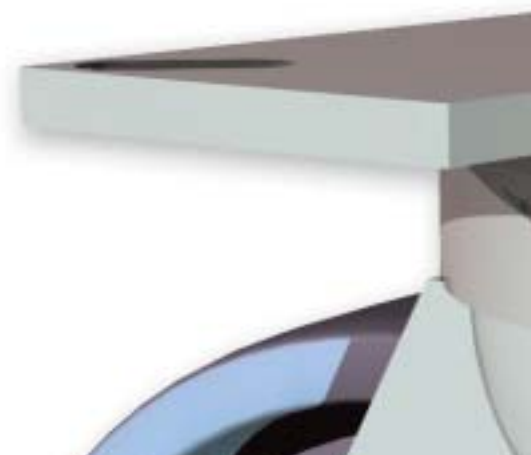
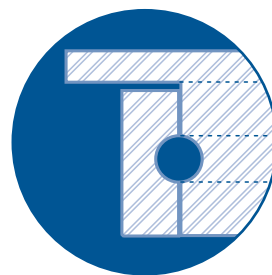

More Reasons to Buy RWM Kingpinless™ Casters

No caster shimmy. Superior strength means superior performance – and RWM’s patented swivel section provides the strength to build longer swivel leads that function flawlessly – even at high speeds – without shimmy. We have applied over 100,000 pounds of impact forces to our 125 series with a 5” swivel lead with no damage to the swivel section.

Closer machine tolerances. RWM swivel section tolerances are .017, compared with .030 for the competition. This differential represents the amount of play between the top plate and the swivel yoke. The more precise the machining, the closer the tolerances; and the closer the tolerances, the longer the service life.

Double-welded construction. RWM’s raceway provides the additional mass necessary for a double weld on its legs, inside and outside, as opposed to the competition’s single weld. Their machining process does not provide the necessary mass for a weld on the outside race.

Higher carbon steel. Tests prove that RWM legs have a 74% higher yield strength* than the competition, and a 74% higher ultimate strength** than the competition. RWM’s carbon content, the essential ingredient for strength in steel, is nearly seven times higher than the competition.

Superior heat treatment. The steel in RWM’s race is superior in its heat treatment – nearly 18% harder than the competition. As a result, the RWM welded-in race is nearly 20% better equipped to resist brinelling than the competition, and allows the swivel section to turn easily in the roughest applications.



For Ultimate Dependability, Choose RWM Kingpinless™ Casters



*The point at which steel begins to stretch like a rubber band

**The point at which steel actually snaps in two pieces



47-RAB-0820-S

47 Series Casters

Medium Heavy Duty
Kingpinless™ Casters

FEATURES

- Raceway Design** - Patented Kingpinless™ single ball bearing precision machined raceway hardened to 53 Rockwell C. minimum. Swivel section features 2 1/8" diameter raceway with 1/4" ball bearings.
- Swivel Section** - All swivel sections are supplied with a lubrication fitting for field maintenance.
- Leg Thickness** - 1/4" formed steel
- Axle** - 1/2" bolt and locking nut drilled with lube fitting
- Finish** - Zinc plated to protect from corrosion
- Mounting Plate Size** - 4" x 4-1/2" x 1/4"
- Bolt Hole Spacing** - 2-5/8" x 3-5/8", slotted to 3" x 3"
- Mounting Bolt Diameter** - 3/8"

SPECIFICATIONS

Wheel Diameter	Wheel Width	Wheel Type	Capacity lbs	Overall Height	Swivel Caster Model Number			Swivel Lead	Approx. Weight lbs
					Straight Roller Bearing	Ball Bearing	Plain, Oilite, Celcon Bearing		
4"	1-1/2"	Forged Steel	1400	5-5/8"	47-FSR-0415-S		47-FSC-0415-S	1-11/32"	7.0
		Cast Iron	800		47-CIR-0420-S	47-CIB-0420-S	47-CIC-0420-S		6.5
		Durastan	800		47-DUR-0420-S		47-DUC-0420-S		5.2
		GT	1050			47-GTB-0420-S			5.0
		High Temp. Nylon	800		47-HNR-0420-S	47-HNB-0420-S			5.2
		Performance TPR	350		47-RPR-0420-S	47-RPB-0420-S	47-RPC-0420-S		5.3
		Polyolefin	500		47-POR-0420-S	47-POB-0420-S	47-POC-0420-S		4.8
		Rubber on Aluminum	525		47-RAR-0420-S		47-RAC-0420-S		7.4
		Rubber on Iron	350		47-RIR-0420-S		47-RIC-0420-S		7.5
		Solid Urethane	1000		47-SUR-0420-S	47-SUB-0420-S	47-SUC-0420-S		5.2
		Urethane on Aluminum	700		47-UAR-0420-S		47-UAC-0420-S		5.0
		Urethane on Iron	700		47-UIR-0420-S		47-UIC-0420-S		6.6
		Urethane Plastic	600		47-UPR-0420-S	47-UPB-0420-S	47-UPC-0420-S		5.3
		V-Groove Iron	800		47-VIR-0420-S		47-VIC-0420-S		7.6
5"	2"	Cast Iron	1000	6-1/2"	47-CIR-0520-S	47-CIB-0520-S	47-CIC-0520-S	1-1/2"	7.8
		Durastan	1000		47-DUR-0520-S		47-DUC-0520-S		5.4
		Forged Steel	1500		47-FSR-0520-S		47-FSC-0520-S		8.1
		GT	1200			47-GTB-0520-S			6.0
		High Temp. Nylon	1000		47-HNR-0520-S	47-HNB-0520-S			5.4
		Performance TPR	375		47-RPR-0520-S	47-RPB-0520-S	47-RPC-0520-S		5.3
		Polyolefin	650		47-POR-0520-S	47-POB-0520-S	47-POC-0520-S		4.6
		Rubber on Aluminum	600		47-RAR-0520-S	47-RAB-0520-S	47-RAC-0520-S		7.5
		Rubber on Iron	400		47-RIR-0520-S		47-RIC-0520-S		7.6
		Solid Urethane	1000		47-SUR-0520-S	47-SUB-0520-S	47-SUC-0520-S		5.4
		Urethane on Aluminum	1050		47-UAR-0520-S		47-UAC-0520-S		5.5
		Urethane on Iron	1050		47-UIR-0520-S		47-UIC-0520-S		7.7
		Urethane Plastic	750		47-UPR-0520-S	47-UPB-0520-S	47-UPC-0520-S		5.3
		V-Groove Iron	800		47-VIR-0520-S		47-VIC-0520-S		9.9
6"	2"	Cast Iron	1200	7-1/2"	47-CIR-0620-S	47-CIB-0620-S	47-CIC-0620-S	1-25/32"	9.1
		Durastan	1200		47-DUR-0620-S	47-DUB-0620-S	47-DUC-0620-S		6.3
		Forged Steel	1500		47-FSR-0620-S		47-FSC-0620-S		10.0
		GT	1500			47-GTB-0620-S			8.0
		High Temp Nylon	1200		47-HNR-0620-S	47-HNB-0620-S			6.3
		Omega	1000		47-UOR-0620-S	47-UOB-0620-S	47-UOC-0620-S		8.8
		Performance TPR	525		47-RPR-0620-S	47-RPB-0620-S	47-RPC-0620-S		5.7
		Polyolefin	700		47-POR-0620-S	47-POB-0620-S	47-POC-0620-S		5.0
		Rubber on Aluminum	615		47-RAR-0620-S	47-RAB-0620-S	47-RAC-0620-S		7.8
		Rubber on Iron	410		47-RIR-0620-S		47-RIC-0620-S		7.8
		Solid Urethane	1000		47-SUR-0620-S	47-SUB-0620-S	47-SUC-0620-S		6.3
		Urethane on Aluminum	1230		47-UAR-0620-S				6.3
		Urethane on Iron	1230		47-UIR-0620-S	47-UIB-0620-S	47-UIC-0620-S		8.8
		Urethane Plastic	900		47-UPR-0620-S	47-UPB-0620-S	47-UPC-0620-S		5.7
V-Groove Iron	1000	47-VIR-0620-S		47-VIC-0620-S	10.9				
8"	2"	Cast Iron	1400	9-1/2"	47-CIR-0820-S	47-CIB-0820-S	47-CIC-0820-S	2-1/8"	13.3
		Durastan	1400		47-DUR-0820-S	47-DUB-0820-S	47-DUC-0820-S		7.7
		GT	1500			47-GTB-0820-S			12.2
		Omega	1200		47-UOR-0820-S	47-UOB-0820-S	47-UOC-0820-S		12.2
		Performance TPR	600		47-RPR-0820-S	47-RPB-0820-S	47-RPC-0820-S		7.7
		Polyolefin	800		47-POR-0820-S	47-POB-0820-S	47-POC-0820-S		5.8
		Rubber on Aluminum	750		47-RAR-0820-S	47-RAB-0820-S	47-RAC-0820-S		10.1
		Rubber on Iron	500		47-RIR-0820-S		47-RIC-0820-S		10.2
		Solid Urethane	1200		47-SUR-0820-S	47-SUB-0820-S	47-SUC-0820-S		12.0
		Urethane on Aluminum	1500		47-UAR-0820-S		47-UAC-0820-S		7.3
		Urethane on Iron	1500		47-UIR-0820-S	47-UIB-0820-S	47-UIC-0820-S		12.1
		Urethane Plastic	1000		47-UPR-0820-S	47-UPB-0820-S	47-UPC-0820-S		7.7
		V-Groove Iron	1050		47-VIR-0820-S		47-VIC-0820-S		15.3

OPTIONS

- DSL** Demountable Swivel Lock
- HT** High Temperature Lubrication
- ICWB** Installable Face Contact Brake
- LT** Low Temperature Lubrication
- SL** Swivel Lock
- TG** Thread Guards
- WB** Side Wheel Brake with Roller Bearing only
- WS** Wheel Seals
- WWB** Wraparound Wheel Brake

OPTIONAL OVERALL HEIGHTS

Wheel Diameter	Overall Height
4"	5-9/16"
5"	6-11/16"
6"	7-19/32"
8"	10-1/8"

OPTIONAL MOUNTING PLATES

Optional Top Plate Number	Mounting Plate	Bolt Hole Spacing	Bolt Size
41ST 41RT	4" x 5"	2-5/8" x 3-5/8" slotted to 3" x 4"	3/8"
42ST 42RT	4-1/2" x 6-1/2"	2-7/16" x 4-15/16" slotted to 3-3/8" x 5-1/4"	1/2"
43ST 43RT	5" x 5-1/2"	4-1/8" x 4-1/2"	3/8"

To order a rigid caster, change the "S" to "R" in the model number. For example, "47-UPB-0520-R".

To order a rig only, omit the blue letters. For example: "47-Q520-S".

For approximate weight of rigid caster deduct .7 pounds.

Dimensions shown are nominal.

If precise dimensions are required, please consult your RWM representative.



65-SUB-0820-S

FEATURES

- Raceway Design** - Patented Kingpinless™ single ball bearing precision machined raceway hardened to 53 Rockwell C. minimum. Swivel section features a 2-3/8" diameter raceway with 3/8" ball bearings.
 - Leg Thickness** - 1/4" formed steel
 - Axle** - 1/2" bolt and lock nut drilled with lube fitting
 - Finish** - Zinc plated to protect from corrosion
 - Wheels** - Wheels are available with a straight roller bearing which rotates on a hardened and ground spanner bushing, an annular ball bearing for ease of rollability or a celcon bearing
 - Mounting Plate Size** - 4" x 4-1/2" x 1/4" **Bolt Hole Spacing** - 2-5/8" x 3-5/8", slotted to 3" x 3"
 - Mounting Bolt Diameter** - 3/8"
- All swivel sections are supplied with a lubrication fitting for field maintenance.

SPECIFICATIONS

Wheel Diameter	Wheel Width	Wheel Type	Capacity lbs	Overall Height	Swivel Caster Model Number			Swivel Lead	Approx Weight lbs	
					Straight Roller Bearing	Ball Bearing	Plain, Oilite, Celcon Bearing			
4"	1-1/2"	Forged Steel	1400	5-5/8"	65-FSR-0415-S		65-FSC-0415-S	1-3/16"	9.0	
		Cast Iron	800		65-CIR-0420-S	65-CIB-0420-S	65-CIC-0420-S		10.0	
		Durastan	800		65-DUR-0420-S		65-DUC-0420-S		8.0	
		GT	1050			65-GTB-0420-S			8.0	
	2"	2"	High Temp. Nylon	800	5-5/8"	65-HNR-0420-S	65-HNB-0420-S		1-3/16"	8.0
			Performance TPR	350		65-RPR-0420-S	65-RPB-0420-S	65-RPC-0420-S		7.3
			Polyolefin	500		65-POR-0420-S	65-POB-0420-S	65-POC-0420-S		7.6
			Rubber on Aluminum	525		65-RAR-0420-S		65-RAC-0420-S		8.0
			Rubber on Iron	350		65-RIR-0420-S		65-RIC-0420-S		8.0
			Solid Urethane	1000		65-SUR-0420-S	65-SUB-0420-S	65-SUC-0420-S		8.0
			Urethane on Aluminum	700		65-UAR-0420-S		65-UAC-0420-S		7.5
			Urethane on Iron	700		65-UIR-0420-S		65-UIC-0420-S		8.0
			Urethane Polypropylene	600		65-UPR-0420-S	65-UPB-0420-S	65-UPC-0420-S		7.3
V-Groove Iron	800	65-VIR-0420-S		65-VIC-0420-S	10.0					
5"	2"	Cast Iron	1000	6-1/2"	65-CIR-0520-S	65-CIB-0520-S	65-CIC-0520-S	1-11/32"	12.0	
		Durastan	1000		65-DUR-0520-S		65-DUC-0520-S		9.0	
		Forged Steel	1500		65-FSR-0520-S		65-FSC-0520-S		12.0	
		GT	1200			65-GTB-0520-S			9.0	
		High Temp. Nylon	1000		65-HNR-0520-S	65-HNB-0520-S			9.0	
		Performance TPR	375		65-RPR-0520-S	65-RPB-0520-S	65-RPC-0520-S		7.3	
		Polyolefin	650		65-POR-0520-S	65-POB-0520-S	65-POC-0520-S		8.7	
		Rubber on Aluminum	600		65-RAR-0520-S		65-RAC-0520-S		8.6	
		Rubber on Iron	400		65-RIR-0520-S		65-RIC-0520-S		9.0	
		Solid Urethane	1000		65-SUR-0520-S	65-SUB-0520-S	65-SUC-0520-S		9.0	
		Urethane on Aluminum	1050		65-UAR-0520-S		65-UAC-0520-S		8.5	
		Urethane on Iron	1050		65-UIR-0520-S		65-UIC-0520-S		9.0	
		Urethane Polypropylene	750		65-UPR-0520-S	65-UPB-0520-S	65-UPC-0520-S		7.3	
V-Groove Iron	800	65-VIR-0520-S		65-VIC-0520-S	12.0					
6"	2"	Cast Iron	1200	7-1/2"	65-CIR-0620-S	65-CIB-0620-S	65-CIC-0620-S	1-9/16"	13.0	
		Durastan	1200		65-DUR-0620-S	65-DUB-0620-S	65-DUC-0620-S		10.0	
		Forged Steel	1800		65-FSR-0620-S		65-FSC-0620-S		13.0	
		GT	1500			65-GTB-0620-S			10.0	
		High Temp. Nylon	1200		65-HNR-0620-S	65-HNB-0620-S			10.0	
		Omega	1000		65-UOR-0620-S	65-UOB-0620-S	65-UOC-0620-S		12.0	
		Performance TPR	525		65-RPR-0620-S	65-RPB-0620-S	65-RPC-0620-S		7.7	
		Polyolefin	700		65-POR-0620-S	65-POB-0620-S	65-POC-0620-S		8.7	
		Rubber on Aluminum	615		65-RAR-0620-S	65-RAB-0620-S	65-RAC-0620-S		10.0	
		Rubber on Iron	410		65-RIR-0620-S		65-RIC-0620-S		10.0	
		Solid Urethane	1000		65-SUR-0620-S	65-SUB-0620-S	65-SUC-0620-S		10.0	
		Urethane on Aluminum	1230		65-UAR-0620-S		65-UAC-0620-S		11.0	
		Urethane on Iron	1230		65-UIR-0620-S	65-UIB-0620-S	65-UIC-0620-S		12.0	
Urethane Polypropylene	900	65-UPR-0620-S	65-UPB-0620-S	65-UPC-0620-S	7.7					
V-Groove Iron	1000	65-VIR-0620-S		65-VIC-0620-S	13.0					
8"	2"	Cast Iron	1400	10-1/8"	65-CIR-0820-S	65-CIB-0820-S	65-CIC-0820-S	2-1/4"	16.0	
		Durastan	1400		65-DUR-0820-S	65-DUB-0820-S	65-DUC-0820-S		11.0	
		GT	1800			65-GTB-0820-S			11.0	
		Performance TPR	600		65-RPR-0820-S	65-RPB-0820-S	65-RPC-0820-S		9.1	
		Omega	1200		65-UOR-0820-S	65-UOB-0820-S	65-UOC-0820-S		13.0	
		Polyolefin	800		65-POR-0820-S	65-POB-0820-S	65-POC-0820-S		9.1	
		Rubber on Aluminum	750		65-RAR-0820-S	65-RAB-0820-S	65-RAC-0820-S		11.0	
		Rubber on Iron	500		65-RIR-0820-S		65-RIC-0820-S		11.0	
		Solid Urethane	1200		65-SUR-0820-S	65-SUB-0820-S	65-SUC-0820-S		11.0	
		Urethane on Aluminum	1500		65-UAR-0820-S		65-UAC-0820-S		12.0	
		Urethane on Iron	1500		65-UIR-0820-S	65-UIB-0820-S	65-UIC-0820-S		13.0	
		Urethane Polypropylene	1000		65-UPR-0820-S	65-UPB-0820-S	65-UPC-0820-S		9.1	
		V-Groove Iron	1050		65-VIR-0820-S		65-VIC-0820-S		16.0	

To order a rigid caster, change the "S" to "R" in the model number. For example: "65-CIR-0520-R". To order a rig only, omit the blue letters. For example: "65-0520-S". Dimensions shown are nominal. If precise dimensions are required, consult your RWM representative. For approximate weight of our rigid caster, deduct 1.5 pounds.

OPTIONAL MOUNTING PLATES

Optional Top Plate Number	Mounting Plate	Bolt Hole Spacing	Bolt Size
41ST 41RT	4" x 5"	2-5/8" x 3-5/8" slotted to 3" x 4"	3/8"
42ST 42RT	4-1/2" x 6-1/2"	2-7/16" x 4-15/16" slotted to 3-3/8" x 5-1/4"	1/2"
43ST 43RT	5" x 5-1/2"	4-1/8" x 4-1/2"	3/8"



65-SUB-0820-S

Also available with a dual-wheel configuration. Call for details or visit www.rwmcasters.com

OPTIONS

- DSL** Demountable Swivel Lock
- HT** High Temperature Lubrication
- ICWB** Installable Face Contact Brake
- LT** Low Temperature Lubrication
- SL** Swivel Lock
- SR** Sealed Raceway
- TG** Thread Guards
- WB** Side Wheel Brake (roller bearing only)
- WS** Wheel Seals
- WWB** Wrap Around Wheel Brake

OPTIONAL OVERALL HEIGHTS

Wheel Diameter	Overall Height
4"	5-9/16"
5"	6-11/16"
6"	7-19/32"
8"	9-1/2"



COMPONENT

Available NSF Products: All casters except those with the cast iron, soft rubber, Omega, rubber on iron, rubber on aluminum, forged steel, urethane on aluminum, urethane on iron, or V-groove wheels. The following options are not available: DSL, HT, LT, SL, SR, TG, WS. Add "N" to the end of the model number to specify an NSF approved caster. For example: 65-DUR-0620-S-N.



70 Series Casters

Heavy Duty Kingpinless™ Casters

FEATURES

- Raceway Design** - 2-3/4" diameter with 1/2" carbon steel balls. Load and thrust are accommodated by our patented Kingpinless™ design. Precision machined; hardened to 53 Rockwell C. minimum.
- Leg Thickness** - 1/4" formed steel
- Axle** - 1/2" bolt and nut. Lubrication - Zerk fitting in axle on 2" wide wheels, 3/4" axle on 2-1/2" and 3" wide wheels
- Finish** - Laguna Blue paint
- Wheels** - 2" wide wheels are equipped with either 3/4" roller bearing which rotates on a 3/4" hardened and ground spanner, annular bearing, or a delrin/plain wheel bearing. 2-1/2" and 3" wide wheels are equipped with either a 1" I.D. straight roller bearing which rotates on a spanner bushing, 3/4" I.D. tapered bearings that rotate on the axle, or precision ball bearings.
- Mounting Plate Size** - 4-1/2" x 6-1/2" x 5/16" **Bolt Hole Spacing** - 2-7/16" x 4-15/16", slotted to 3-3/8" x 5-1/4"
- Mounting Bolt Diameter** - 1/2"

70-DUR-0825-S

SPECIFICATIONS

Wheel Diameter	Wheel Width	Wheel Type	Capacity lbs.	Overall Height	Swivel Caster Model Number				Swivel Lead	Approx Weight lbs.
					Straight Roller Bearing	Ball Bearing	Plain, Oilite, Celcon Bearing	Tapered Roller		
4"	1-1/2"	Forged Steel	1400	5-5/8"	70-FSR-0415-S		70-FSC-0415-S		1-3/16"	10.0
4"	2"	Cast Iron	800	5-5/8"	70-CIR-0420-S	70-CIB-0420-S	70-CIC-0420-S		1-3/16"	10.0
		Durastan	800		70-DUR-0420-S		70-DUC-0420-S			8.0
		GT	1050			70-GTB-0420-S				8.0
		High Temp. Nylon	800		70-HNR-0420-S	70-HNB-0420-S				8.0
		Performance TPR	350		70-RPR-0420-S	70-RPB-0420-S	70-RPC-0420-S			8.3
		Polyolefin	500		70-POR-0420-S	70-POB-0420-S	70-POC-0420-S			8.0
		Rubber on Aluminum	525		70-RAR-0420-S	70-RAB-0420-S	70-RAC-0420-S			7.8
		Rubber on Iron	350		70-RIR-0420-S		70-RIC-0420-S			8.0
		Solid Urethane	1000		70-SUR-0420-S	70-SUB-0420-S	70-SUC-0420-S			8.0
		Urethane on Aluminum	700		70-UAR-0420-S		70-UAC-0420-S			7.5
		Urethane on Iron	700		70-UIR-0420-S		70-UIC-0420-S			8.0
		Urethane Polypropylene	600		70-UPR-0420-S	70-UPB-0420-S	70-UPC-0420-S			8.3
		V-Groove Iron	800		70-VIR-0420-S		70-VIC-0415-S			10.0
5"	2"	Cast Iron	1000	6-1/2"	70-CIR-0520-S	70-CIB-0520-S	70-CIC-0520-S		1-1/2"	12.0
		Durastan	1000		70-DUR-0520-S		70-DUC-0520-S			9.0
		Forged Steel	1500		70-FSR-0520-S		70-FSC-0520-S			12.0
		GT	1200			70-GTB-0520-S				9.0
		High Temp. Nylon	1000		70-HNR-0520-S	70-HNB-0520-S				9.0
		Performance TPR	375		70-RPR-0520-S	70-RPB-0520-S	70-RPC-0520-S			8.3
		Polyolefin	650		70-POR-0520-S	70-POB-0520-S	70-POC-0520-S			9.0
		Rubber on Aluminum	600		70-RAR-0520-S	70-RAB-0520-S	70-RAC-0520-S			8.9
		Rubber on Iron	400		70-RIR-0520-S		70-RIC-0520-S			9.0
		Solid Urethane	1000		70-SUR-0520-S	70-SUB-0520-S	70-SUC-0520-S			9.0
		Urethane on Aluminum	1050		70-UAR-0520-S		70-UAC-0520-S			8.5
		Urethane on Iron	1050		70-UIR-0520-S		70-UIC-0520-S			9.0
		Urethane Polypropylene	750		70-UPR-0520-S	70-UPB-0520-S	70-UPC-0520-S			8.3
V-Groove Iron	800	70-VIR-0520-S		70-VIC-0520-S		12.0				
6"	2"	Cast Iron	1200	7-1/2"	70-CIR-0620-S	70-CIB-0620-S	70-CIC-0620-S		1-3/8"	13.0
		Durastan	1200		70-DUR-0620-S	70-DUB-0620-S	70-DUC-0620-S			10.0
		Forged Steel	1800		70-FSR-0620-S		70-FSC-0620-S			13.0
		GT	1500			70-GTB-0620-S				10.0
		High Temp. Nylon	1200		70-HNR-0620-S	70-HNB-0620-S				10.0
		Omega	1000		70-UOR-0620-S	70-UOB-0620-S	70-UOC-0620-S			12.0
		Performance TPR	525		70-RPR-0620-S	70-RPB-0620-S	70-RPC-0620-S			8.7
		Polyolefin	700		70-POR-0620-S	70-POB-0620-S	70-POC-0620-S			10.0
		Rubber on Aluminum	615		70-RAR-0620-S	70-RAB-0620-S	70-RAC-0620-S			9.8
		Rubber on Iron	410		70-RIR-0620-S		70-RIC-0620-S			10.0
		Solid Urethane	1000		70-SUR-0620-S	70-SUB-0620-S	70-SUC-0620-S			10.0
		Urethane on Aluminum	1230		70-UAR-0620-S		70-UAC-0620-S			11.0
		Urethane on Iron	1230		70-UIR-0620-S	70-UIB-0620-S	70-UIC-0620-S			12.0
Urethane Polypropylene	900	70-UPR-0620-S	70-UPB-0620-S	70-UPC-0620-S		8.7				
V-Groove Iron	1000	70-VIR-0620-S		70-VIC-0620-S		13.0				
6"	2-1/2"	Cast Iron	1800	7-1/2"	70-CIR-0625-S			70-CIT-0625-S	1-3/8"	18.0
		Durastan	1600		70-DUR-0625-S			70-FST-0625-S		11.0
		Forged Steel	4000		70-FSR-0625-S					18.0
		GT	2300			70-GTB-0625-S				11.0
		Rubber on Iron	540		70-RIR-0625-S			70-RIT-0625-S		16.0
		Urethane on Iron	1620		70-UIR-0625-S			70-UIT-0625-S		16.0
		V-Groove Iron	2500		70-VIR-0625-S			70-VIT-0625-S		18.0
8"	2"	Cast Iron	1400	10-1/8"	70-CIR-0820-S	70-CIB-0820-S	70-CIC-0820-S		2-1/16"	16.0
		Durastan	1400		70-DUR-0820-S	70-DUB-0820-S	70-DUC-0820-S			11.0
		GT	1800			70-GTB-0820-S				11.5
		Omega	1200		70-UOR-0820-S	70-UOB-0820-S	70-UOC-0820-S			13.0
		Performance TPR	600		70-RPR-0820-S	70-RPB-0820-S	70-RPC-0620-S			9.1
		Polyolefin	800		70-POR-0820-S	70-POB-0820-S	70-POC-0820-S			11.0
		Rubber on Aluminum	750		70-RAR-0820-S	70-RAB-0820-S	70-RAC-0820-S			11.0
		Rubber on Iron	500		70-RIR-0820-S		70-RIC-0820-S			11.0
		Solid Urethane	1200		70-SUR-0820-S	70-SUB-0820-S	70-SUC-0820-S			11.3
		Urethane on Aluminum	1500		70-UAR-0820-S		70-UAC-0820-S			13.0
		Urethane on Iron	1500		70-UIR-0820-S	70-UIB-0820-S	70-UIC-0820-S			13.0
		Urethane Polypropylene	1000		70-UPR-0820-S	70-UPB-0820-S	70-UPC-0820-S			10.1
		V-Groove Iron	1050		70-VIR-0820-S		70-VIC-0820-S			16.0
8"	2-1/2"	Cast Iron	1800	10-1/8"	70-CIR-0825-S			70-CIT-0825-S	2-1/16"	20.0
		Durastan	1800		70-DUR-0825-S			70-FST-0825-S		14.0
		Forged Steel	4000		70-FSR-0825-S					20.0
		GT	2400			70-GTB-0825-S				14.0
		Rubber on Iron	670		70-RIR-0825-S			70-RIT-0825-S		17.0
		Urethane on Iron	1800		70-UIR-0825-S			70-UIT-0825-S		18.0
		V-Groove Iron	3000		70-VIR-0825-S			70-VIT-0825-S		20.0
10"	2-1/2"	Cast Iron	1800	11-1/2"	70-CIR-1025-S			70-CIT-1025-S	2-5/16"	26.0
		Durastan	1800		70-DUR-1025-S					16.0
		Rubber on Iron	790		70-RIR-1025-S			70-RIT-1025-S		21.0
		Urethane on Iron	2370		70-UIR-1025-S			70-UIT-1025-S		21.0

OPTIONS

- CWB** Cam Wheel Brake (2" & 2-1/2" wide)
- HT** High Temperature Lubrication
- LT** Low Temperature Lubrication
- NY** Notched Yoke Base
- SL** Swivel Lock
- SR** Sealed Swivel Raceway
- TG** Thread Guards (2" wide only)
- WB** Side Wheel Brake (roller bearing only, 2" wide)
- ZP** Zinc Plated

To order a rigid caster, change the "S" to "R" in the model number. For example: "70-CIR-0420-R". To order a rigid only, omit the blue letters. For example: "70-0420-S". Dimensions shown are nominal. If precise dimensions are required, consult your RWM representative. For approximate weight of our rigid casters, deduct 3.9 pounds



75-DUR-1030-S

FEATURES

Raceway Design - Patented Kingpinless™ single ball bearing precision machined raceway hardened to 53 Rockwell C minimum. Swivel section features a 3" diameter raceway with 1/2" ball bearings. The notched raceway is standard.

Axle - 3/4" bolt and lock or slotted nut as required

Finish - Laguna Blue paint

Wheels - Wheels are available with either a 1" roller bearing which rotates on a hardened and ground spanner bushing or 3/4" tapered bearings that rotate on the axle. All wheels are equipped with a lubrication fitting.

Mounting Plate Size - 4-1/2" x 6-1/2" x 5/16" **Mounting Bolt Diameter** - 1/2"

Bolt Hole Spacing - 2-7/16" x 4-15/16", slotted to 3-3/8" x 5-1/4"

Leg Thickness - 5/16" formed steel

SPECIFICATIONS

Wheel Diameter	Wheel Width	Wheel Type	Capacity lbs	Overall Height	Swivel Caster Model Number			Swivel Lead	Approx Weight lbs.
					Straight Roller Bearing	Ball Bearing	Tapered Roller Bearing		
5"	2-1/2"	Cast Iron	2000	6-1/2"	75-CIR-0525-S		75-CIT-0525-S	1-1/8"	18.0
		Durastan	1800		75-CIR-0625-S		75-CIT-0625-S		17.0
6"	2-1/2"	Forged Steel	1600	7-1/2"	75-DUR-0625-S		75-CIT-0625-S	1-5/16"	11.5
		GT	5000		75-FSR-0625-S	75-FST-0625-S	20.5		
		Rubber on Iron	540		75-RIR-0625-S	75-RIT-0625-S	16.5		
		Urethane on Iron	1620		75-UIR-0625-S	75-UIT-0625-S	16.5		
		V-Groove Iron	2500		75-VIR-0625-S	75-VIT-0625-S	16.5		
		Cast Iron	3000		75-CIR-0630-S	75-CIT-0630-S	18.5		
		Durastan	2000		75-DUR-0630-S		12.5		
6"	3"	Forged Steel	6000	7-1/2"	75-FSR-0630-S		75-FST-0630-S	1-5/16"	31.0
		Rubber on Iron	1020		75-RIR-0630-S	75-RIT-0630-S	17.5		
		Solid Urethane	1200		75-SUR-0630-S	75-SUB-0630-S	12.5		
		Urethane on Iron	2000		75-UIR-0630-S	75-UIT-0630-S	17.5		
		V-Groove Forged	6000		75-VFR-0630-S	75-VFT-0630-S	30.0		
		Cast Iron	1800		75-CIR-0825-S	75-CIT-0825-S	23.0		
		Durastan	2000		75-DUR-0825-S		15.0		
8"	2-1/2"	Forged Steel	4000	10-1/8"	75-FSR-0825-S		75-FST-0825-S	2"	25.5
		GT	2400		75-GTB-0825-S		15.0		
		Rubber on Iron	1000		75-RIR-0825-S	75-RIT-0825-S	18.5		
		Urethane on Iron	2000		75-UIR-0825-S	75-UIT-0825-S	18.5		
		V-Groove Iron	3000		75-VIR-0825-S	75-VIT-0825-S	27.0		
		Cast Iron	2500		75-CIR-0830-S	75-CIT-0830-S	26.0		
		Durastan	2500		75-DUR-0830-S		16.5		
8"	3"	Forged Steel	5500	10-1/8"	75-FSR-0830-S		75-FST-0830-S	2"	26.0
		Rubber on Iron	1200		75-RIR-0830-S	75-RIT-0830-S	19.5		
		Omega	1600		75-UOR-0830-S	75-UOT-0830-S	19.0		
		Solid Urethane	1200		75-SUR-0830-S	75-SUB-0830-S	16.5		
		Urethane on Iron	2500		75-UIR-0830-S	75-UIT-0830-S	19.5		
		V-Groove Forged	6000		75-VFR-0830-S	75-VFT-0830-S	36.0		
		V-Groove Iron	5000		75-VIR-0830-S	75-VIT-0830-S	26.0		
		Cast Iron	2500		75-CIR-1025-S	75-CIT-1025-S	25.5		
		Durastan	2500		75-DUR-1025-S		16.5		
		Rubber on Iron	1180		75-RIR-1025-S	75-RIT-1025-S	21.5		
Urethane on Iron	2370	75-UIR-1025-S	75-UIT-1025-S	21.5					
10"	3"	Cast Iron	4000	11-1/2"	75-CIR-1030-S		75-CIT-1030-S	2-3/16"	23.0
		Durastan	2900		75-DUR-1030-S		20.0		
		Forged Steel	6000		75-FSR-1030-S		41.0		
		GT	3000		75-GTB-1030-S	75-FST-1030-S	20.0		
		Omega	2000		75-UOR-1030-S	75-UOB-1030-S	20.0		
		Rubber on Aluminum	1500		75-RIR-1030-S	75-RAT-1030-S	20.3		
		Rubber on Iron	1500		75-RIR-1030-S	75-RIT-1030-S	22.5		
		Solid Urethane	1400		75-SUR-1030-S	75-SUB-1030-S	20.0		
		Urethane on Iron	3000		75-UIR-1030-S	75-UIT-1030-S	22.5		
		Ultra Thick Urethane	2800		75-UTR-1030-S	75-UJT-1030-S	25.0		
		V-Groove Forged	5000		75-VFR-1030-S	75-VFT-1030-S	48.0		
		V-Groove Iron	5000		75-VIR-1030-S	75-VIT-1030-S	23.0		
		Durastan	3000		75-DUR-1225-S	75-CIT-1230-S	20.5		
12"	2-1/2"	Rubber on Iron	1350	13-1/2"	75-RIR-1225-S		75-RIT-1225-S	2-5/8"	23.5
		Urethane on Iron	2700		75-UIR-1225-S	75-UIT-1225-S	23.5		
		Cast Iron	5000		75-CIR-1230-S	75-CIT-1230-S	32.0		
12"	3"	Durastan	3500	13-1/2"	75-DUR-1230-S		75-CIT-1230-S	2-5/8"	22.5
		Rubber on Aluminum	1710		75-RIR-1230-S	75-RAT-1230-S	24.5		
		Rubber on Iron	1710		75-RIR-1230-S	75-RIT-1230-S	26.5		
		Urethane on Iron	3400		75-UIR-1230-S	75-UIT-1230-S	26.5		
		Ultra Thick Urethane	3900		75-UTR-1230-S	75-UJT-1230-S	28.0		
		V-Groove Iron	6000		75-VIR-1230-S	75-VIT-1230-S	43.0		

OPTIONS

CWB	Cam Wheel Brake
DSL	Demountable Swivel Lock
HT	High Temperature Lubrication
LT	Low Temperature Lubrication
PCWB	Poly Cam Wheel Brake
SL	Swivel Lock
SR	Sealed Swivel Raceway
CWB	Cam Wheel Brake
ZP	Zinc Plated

To order a rigid caster, change the "S" to "R" in the model number. For example: "75-CIR-1030-R". To order a rig only, omit the blue letters. For example: "75-1030-S". Dimensions shown are nominal. If precise dimensions are required, consult your RWM representative. For approximate weight of our rigid caster, deduct 3.9 pounds.

OPTIONAL MOUNTING PLATES

Optional Top Plate Number	Mounting Plate	Bolt Hole Spacing	Bolt Size
90ST*** 90RT	6" x 7"	4-5/8" x 5-1/2" slotted to 4-3/8" x 5-5/8"	1/2"
43ST* 43RT	5" x 5-1/2"	4-1/8" x 4-1/2"	3/8"
76ST** 76RT	5-1/4" x 7-1/4"	3-3/8" x 5-1/4" slotted to 4-1/8" x 6-1/8"	1/2"

* Subtract 1/16" OAH when using this top plate
 ** Add 1/16" OAH when using this top plate
 *** Add 3/16" OAH when using this top plate



2-75-DUR-0520-S-WB

Also available with a dual-wheel configuration. Call for details or visit www.rwmcasters.com

76 Series Casters

Heavy Duty
Kingpinless™ Casters



76-DUR-0830-S

FEATURES

Raceway Design - Patented Kingpinless™ single ball bearing precision machined raceway hardened to 53 Rockwell C minimum. Swivel section features 3" diameter raceway with 1/2" ball bearings. The notched raceway is standard.

Leg Thickness - 3/8"

Axle - 3/4" bolt with lock or slotted nut as required

Finish - Laguna Blue paint

Wheels - Wheels are available with either a 1" roller bearing which rotates on a hardened and ground spanner bushing or 3/4" tapered bearings that rotate on the axle. All wheels are equipped with a lubrication fitting.

Mounting Plate Size - 5-1/4" x 7-1/4" x 3/8"

Bolt Hole Spacing - 3-3/8" x 5-1/4", slotted to 4-1/8" x 6-1/8"

Mounting Bolt Diameter - 1/2"

SPECIFICATIONS

Wheel Diameter	Wheel Width	Wheel Type	Capacity lbs	Overall Height	Swivel Caster Model Number			Swivel Lead	Approx Weight lbs	
					Straight Roller Bearing	Ball Bearing	Tapered Roller Bearing			
5"	2-1/2"	Cast Iron	2000	7"	76-CIR-0525-S		76-CIT-0525-S	1-31/32"	18.0	
6"	2-1/2"	Cast Iron	1800	8"	76-CIR-0625-S		76-CIT-0625-S	2-7/32"	17.0	
		Durastan	1600		76-DUR-0625-S				11.5	
		Forged Steel	5000		76-FSR-0625-S		76-FST-0625-S		20.5	
		GT	2300			76-GTB-0625-S			11.5	
		Rubber on Iron	810		76-RIR-0625-S		76-RIT-0625-S		16.5	
		Urethane on Iron	1620		76-UIR-0625-S		76-UIT-0625-S		16.5	
V-Groove Iron	2500	76-VIR-0625-S		76-VIT-0625-S	16.5					
6"	3"	Cast Iron	3000	8"	76-CIR-0630-S		76-CIT-0630-S	2-7/32"	18.5	
		Durastan	2000		76-DUR-0630-S				12.5	
		Forged Steel	6000		76-FSR-0630-S		76-FST-0630-S		31.0	
		Rubber on Iron	1020		76-RIR-0630-S		76-RIT-0630-S		17.5	
		Solid Urethane	1200		76-SUR-0630-S		76-SUB-0630-S		12.5	
		Urethane on Iron	2000		76-UIR-0630-S		76-UIT-0630-S		17.5	
V-Groove Forged	7000	76-VFR-0630-S		76-VIT-0630-S	30.0					
8"	2-1/2"	Cast Iron	1800	10-1/2"	76-CIR-0825-S		76-CIT-0825-S	2-29/32"	23.0	
		Durastan	2000		76-DUR-0825-S				15.0	
		Forged Steel	4000		76-FSR-0825-S		76-FST-0825-S		25.5	
		GT	2400			76-GTB-0825-S			15.0	
		Rubber on Iron	1000		76-RIR-0825-S		76-RIT-0825-S		18.5	
		Urethane on Iron	2000		76-UIR-0825-S		76-UIT-0825-S		18.5	
V-Groove Iron	3000	76-VIR-0825-S		76-VIT-0825-S	27.0					
8"	3"	Cast Iron	2500	10-1/2"	76-CIR-0830-S		76-CIT-0830-S	2-29/32"	26.0	
		Durastan	2500		76-DUR-0830-S				16.5	
		Forged Steel	5500		76-FSR-0830-S		76-FST-0830-S		26.0	
		Omega	1600		76-UOR-0830-S		76-UOT-0830-S		19.0	
		Rubber on Iron	1260		76-RIR-0830-S		76-RIT-0830-S		19.5	
		Solid Urethane	1200		76-SUR-0830-S		76-SUB-0830-S		16.5	
		Urethane on Iron	2500		76-UIR-0830-S		76-UIT-0830-S		19.5	
		V-Groove	5000		76-VIR-0830-S		76-VIT-0830-S		26.0	
		V-Groove Forged	6000		76-VFR-0830-S		76-VFT-0830-S		36.0	
		10"	2-1/2"		Cast Iron	2500	12-1/2"		76-CIR-1025-S	
Durastan	2500			76-DUR-1025-S				16.5		
Rubber on Iron	1180			76-RIR-1025-S		76-RIT-1025-S		21.5		
Urethane on Iron	2370			76-UIR-1025-S		76-UIT-1025-S		21.5		
10"	3"	Cast Iron	4000	12-1/2"	76-CIR-1030-S		76-CIT-1030-S	3-3/8"	23.0	
		Durastan	2900		76-DUR-1030-S				20.0	
		Forged Steel	6000		76-FSR-1030-S		76-FST-1030-S		41.0	
		GT	3000			76-GTB-1030-S			20.0	
		Omega	2000		76-UOR-1030-S		76-UOB-1030-S		22.0	
		Rubber on Aluminum	1500		76-RAB-1030-S		76-RAT-1030-S		20.3	
		Rubber on Iron	1500		76-RIR-1030-S		76-RIT-1030-S		22.5	
		Solid Urethane	1400		76-SUR-1030-S		76-SUB-1030-S		20.0	
		Urethane on Iron	3000		76-UIR-1030-S		76-UIT-1030-S		22.5	
		Ultra Thick Urethane	3400		76-UTR-1030-S		76-UTT-1030-S		26.0	
		V-Groove Forged	6000		76-VFR-1030-S		76-VFT-1030-S		48.0	
		V-Groove Iron	5000		76-VIR-1030-S		76-VIT-1030-S		23.0	
		12"	2-1/2"		Durastan	3000	15-1/2"		76-DUR-1225-S	
Rubber on Iron	1350			76-RIR-1225-S		76-RIT-1225-S		23.5		
Urethane on Iron	2700			76-UIR-1225-S		76-UIT-1225-S		23.5		
12"	3"	Cast Iron	5000	15-1/2"	76-CIR-1230-S		76-CIT-1230-S	4-5/16"	32.0	
		Durastan	3500		76-DUR-1230-S				22.5	
		Rubber on Aluminum	1710			76-RAB-1230-S			76-RAT-1230-S	24.5
		Rubber on Iron	1710		76-RIR-1230-S		76-RIT-1230-S		26.5	
		Urethane on Iron	3400		76-UIR-1230-S		76-UIT-1230-S		26.5	
		Ultra Thick Urethane	3900		76-UTR-1230-S		76-UTT-1230-S		29.0	
V-Groove Iron	6000	76-VIR-1230-S		76-VIT-1230-S	43.0					

OPTIONS

CWB	Cam Wheel Brake
DSL	Demountable Swivel Lock
HT	High Temperature Lubrication
LT	Low Temperature Lubrication
PCWB	Poly Cam Wheel Brake
SL	Swivel Lock
SR	Sealed Swivel Raceway
ZP	Zinc Plated

To order a rigid caster, change the "S" to "R" in the model number. For example: "76-CIR-1230-R". To order a rig only, omit the blue letters. For example: "76-1230-S". Dimensions shown are nominal. If precise dimensions are required, consult your RWM representative. For approximate weight of our rigid casters, deduct 3.9 pounds.

OPTIONAL MOUNTING PLATES

Optional Top Plate Number	Mounting Plate	Bolt Hole Spacing	Bolt Size
90ST* 90RT	6" x 7"	4-5/8" x 5-1/2" slotted to 4-3/8" x 5-5/8"	1/2"
95ST* 95RT	6" x 7-1/2"	4-1/2" x 6" slotted to 4-1/8" x 6-1/8"	1/2"
75ST** 75RT	4-1/2" x 6-1/2"	2-7/16" x 4-15/16" slotted to 3-3/8" x 5-1/4"	1/2"

* Add 1/8" OAH when using this top plate

** Subtract 1/16" OAH when using this top plate



2-76-DUR-0625-S-SL-WB

Also available with a
dual-wheel configuration.
Call for details or visit
www.rwmcasters.com



85-DUR-1230-S

FEATURES

Raceway Design - Patented Kingpinless™ single ball bearing precision machined raceway hardened to 53 Rockwell C minimum 4-1/4" diameter raceway with 5/8" ball bearings.

Axle - 3/4" bolt and nut for 3" wide, 1" or 1-1/4" bolt and nut for 4" wide, 1-1/4" bolt and nut for 5" wide.

Finish - Laguna Blue paint

Wheels - 3" wide wheels are available with either a 1" roller bearing that rotates on a 3/4" x 1" x 3-9/16" hardened and ground spanner bushing or 3/4" tapered bearings that rotate on a 3/4" axle. 4" and 5" wheels are available with either a 1-1/4" I.D. roller bearing which rotates on a hardened and ground spanner bushing or 1-1/4" tapered bearings which rotate on the axle. All wheels are equipped with lubrication fitting.

Mounting Plate Size - 6" x 7" x 1/2" **Mounting Bolt Diameter** - 1/2"

Bolt Hole Spacing - 4-5/8" x 5-1/2", slotted to 4-3/8" x 5-5/8"

Leg Thickness - 3/8", 3" wide for 3" wheels, 4" wide for 4" wheels, 5" wide for 5" wheels.

SPECIFICATIONS

Wheel Diameter	Wheel Width	Wheel Type	lbs Capacity	Overall Height	Swivel Caster Model Number			Swivel Lead	Approx Weight lbs.	
					Straight Roller Bearing	Ball Bearing	Tapered Roller Bearing			
6"	2-1/2"	Forged Steel GT	5000 2300	8-1/2"	85-FSR-0625-S	85-GTB-0625-S	85-FST-0625-S	2"	23.0 17.0	
		Cast Iron Durastan Forged Steel Rubber on Iron Solid Urethane Urethane V-Groove Forged	3000 2000 6000 1020 1200 2000 7000		85-CIR-0630-S 85-DUR-0630-S 85-FSR-0630-S 85-RIR-0630-S 85-SUR-0630-S 85-UJR-0630-S 85-VFR-0630-S		85-CIT-0630-S 85-FST-0630-S 85-RIT-0630-S 85-SUB-0630-S 85-UIT-0630-S 85-VFT-0630-S		24.0 17.0 28.0 20.0 17.0 23.0 32.0	
8"	2-1/2"	Forged Steel GT	4000 2400	10-1/2"	85-RSR-0825-S	85-GTB-0825-S	85-RST-0825-S	2-1/2"	30.0 21.0	
		Rubber on Iron V-Groove Iron	1000 3000		85-RIR-0825-S 85-VIR-0825-S		85-RIT-0825-S 85-VIT-0825-S		23.0 27.0	
		Cast Iron Durastan Forged Steel Omega Rubber on Iron Solid Urethane Urethane on Iron V-Groove Forged Steel V-Groove Iron	2500 2500 5500 1600 840 1200 2500 6000 5000		85-CIR-0830-S 85-DUR-0830-S 85-FSR-0830-S 85-UOR-0830-S 85-RIR-0830-S 85-SUR-0830-S 85-UJR-0830-S 85-VFR-0830-S 85-VIR-0830-S		85-CIT-0830-S 85-FST-0830-S 85-UOT-0830-S 85-RIT-0830-S 85-UIT-0830-S 85-VFT-0830-S 85-VIT-0830-S		28.0 21.0 32.0 26.0 23.0 21.0 26.0 29.0 30.0	
8"	3"	Cast Iron Durastan Forged Steel Omega Rubber on Iron Solid Urethane Urethane on Iron V-Groove Forged Steel V-Groove Iron	4000 10000 3500 10000	10-1/2"	85-CIR-0840-S 85-FSR-0840-S 85-UJR-0840-S 85-VFR-0840-S	85-GTB-0840-S	85-CIT-0840-S 85-FST-0840-S 85-UIT-0840-S 85-VFT-0840-S	2-1/8"	34.0 36.0 28.0 36.0	
		Cast Iron Durastan Forged Steel GT Omega Rubber on Aluminum Rubber on Iron Solid Urethane Ultra Thick Urethane Urethane on Iron V-Groove Forged Steel V-Groove Iron	4000 2900 6000 3000 2000 1500 1000 1400 3400 3000 6000 5000		85-CIR-1030-S 85-DUR-1030-S 85-FSR-1030-S 85-UOR-1030-S 85-RIR-1030-S 85-SUR-1030-S 85-UTR-1030-S 85-UJR-1030-S 85-VFR-1030-S 85-VIR-1030-S		85-CIT-1030-S 85-FST-1030-S 85-UOT-1030-S 85-RAT-1030-S 85-RIT-1030-S 85-SUB-1030-S 85-UTT-1030-S 85-UIT-1030-S 85-VFT-1030-S 85-VIT-1030-S		38.0 25.0 39.0 25.0 32.0 26.0 28.0 25.0 28.0 32.0 39.0 44.0	
		Forged Steel Rubber on Iron Ultra Thick Urethane Urethane on Iron	10000 1400 4500 4200		85-FSR-1040-S 85-RIR-1040-S 85-UTR-1040-S 85-UJR-1040-S		85-FST-1040-S 85-RIT-1040-S 85-UTT-1040-S 85-UIT-1040-S		44.0 32.0 32.0 27.0	
10"	4"	Urethane on Iron	5000	12-1/2"	85-UJR-1050-S		85-UIT-1050-S	2-9/16"	32.0	
12"	3"	Cast Iron Durastan Rubber on Aluminum Rubber on Iron Ultra Thick Urethane Urethane on Iron V-Groove Iron	5000 3500 1710 1140 3900 3400 6000	15-1/2"	85-CIR-1230-S 85-DUR-1230-S	85-RAB-1230-S	85-RAT-1230-S 85-RIT-1230-S 85-UTT-1230-S 85-UIT-1230-S 85-VIT-1230-S	3-7/8"	41.0 29.0 35.0 38.0 31.0 42.0 43.0	
		Durastan Rubber on Iron Ultra Thick Urethane Urethane on Iron	4000 1600 5300 4800		85-DUR-1240-S 85-RIR-1240-S 85-UTR-1240-S 85-UJR-1240-S		85-RIT-1240-S 85-UTT-1240-S 85-UIT-1240-S		28.0 29.0 36.0 29.0	
		Rubber on Iron Ultra Thick Urethane Urethane on Iron	2050 6500 6000		85-RIR-1250-S 85-UTR-1250-S 85-UJR-1250-S		85-RIT-1250-S 85-UTT-1250-S 85-UIT-1250-S		44.0 45.0 48.0	

OPTIONS

- CWB** Cam Wheel Brake
- DSL** Demountable Swivel Lock*
- HT** High Temperature Lubrication
- LT** Low Temperature Lubrication
- NY** Notched Yoke
- PCWB** Poly Cam Wheel Brake
- SL** Swivel Lock
- SR** Sealed Swivel Raceway
- ZP** Zinc Plate

*When ordering the Demountable Swivel Lock (DSL), you must also order the Notched Yoke (NY).

To order a rigid caster, change the "S" to "R" in the model number.
For example: "85-CIR-0840-R".
To order a rig only, omit the blue letters.
For example: "85-0840-S".
Dimensions shown are nominal. If precise dimensions are required, consult your RWM representative.
For approximate weight of our rigid caster, deduct 3.9 pounds.

OPTIONAL MOUNTING PLATES

Optional Top Plate Number	Mounting Plate	Bolt Hole Spacing	Bolt Size
95ST 95RT	6" x 7-1/2"	4-1/2" x 6" slotted to 4-1/8" x 6-1/8"	1/2"
LLST LLRT	8-1/2" X 11"	7" x 9-3/4"	5/8"
LMST LMRT	8-1/2" X 8-1/2"	7" x 7"	5/8"



2-85-UJR-0830-S

Also available with a dual-wheel configuration. Call for details or visit www.rwmcasters.com

95 Series Casters

Heavy Duty
Kingpinless™ Casters



95-UOT-1030-S

FEATURES

Raceway Design - 4-1/2" diameter with 3/4" diameter carbon steel balls. Precision machined and hardened to 53 Rockwell C minimum scale. Load and thrust are accommodated by our patented Kingpinless™ design. Sealed raceway is standard.

Finish - Laguna Blue paint

Wheels - 3" wide wheels are available with either a 1" roller bearing that rotates on a 3/4" x 1" x 3-9/16" hardened and ground spanner bushing or 3/4" tapered bearings that rotate on a 3/4" axle. 4" and 5" wheels are available with either a 1-1/4" I.D. roller bearing which rotates on a hardened and ground spanner bushing or 1-1/4" tapered bearings which rotate on the axle. All wheels are equipped with a lubrication fitting.

Axle - 3/4" bolt and nut for 3" wide, 1" or 1-1/4" bolt and nut for 4" wide, 1-1/4" bolt and nut for 5" wide.

Lubrication - Grease fitting in swivel and hub of wheel

Mounting Plate Size - 6-1/4" x 7-1/2" x 1/2" swivel top plate, 6" x 7-1/2" x 1/2" rigid top plate

Mounting Bolt Diameter - 1/2"

Bolt Hole Spacing - 4-1/2" x 6", slotted to 4-1/8" x 6-1/8"

Leg Thickness - 3/8" formed steel

Swivel Top Plate - SAE 1045 hot steel forging

Swivel Yoke Base - SAE 1045 hot steel forging

SPECIFICATIONS

Wheel Diameter	Wheel Width	Wheel Type	Capacity lbs	Overall Height	Swivel Caster Model Number			Swivel Lead	Approx Weight lbs.					
					Straight Roller Bearing	Ball Bearing	Tapered Roller Bearing							
6"	2-1/2"	Forged Steel GT	5000 2300	8-1/2"	95-FSR-0625-S	95-GTB-0625-S	95-FST-0625-S	1-3/4"	23.0 17.0					
		Cast Iron	3000		95-CIR-0630-S		95-CIT-0630-S		24.0					
6"	3"	Durastan	2000	8-1/2"	95-DUR-0630-S	95-SUB-0630-S	95-FST-0630-S	1-3/4"	17.0					
		Forged Steel	6000		95-FSR-0630-S		95-FST-0630-S		28.0					
		Forged Steel-HD	10,000		95-FSR-0630-SHD		95-FST-0630-SHD		28.0					
		Rubber on Iron	1020		95-RIR-0630-S		95-RIT-0630-S		20.0					
		Solid Urethane	1200		95-SUR-0630-S		95-SUR-0630-S		17.0					
		Urethane on Iron	2000		95-UIR-0630-S		95-UIT-0630-S		23.0					
		V-Groove Forged Steel	7000		95-VFR-0630-S		95-VFT-0630-S		32.0					
		8"	2-1/2"		Forged Steel GT		4000 2400		10-1/2"	95-FSR-0825-S	95-GTB-0825-S	95-FST-0825-S	2-3/16"	30.0 21.0
		Rubber on Iron			1000		95-RIR-0825-S			95-RIT-0825-S		23.0		
		8"	3"		V-Groove Iron		3000		10-1/2"	95-VIR-0825-S	95-SUB-0830-S	95-VIT-0825-S	2-3/16"	27.0
Cast Iron	2500			95-CIR-0830-S	95-CIT-0830-S	28.0								
Durastan	2500			95-DUR-0830-S	95-FST-0830-S	21.0								
Forged Steel	5500			95-FSR-0830-S	95-FST-0830-S	32.0								
Omega	1600			95-UOR-0830-S	95-UOT-0830-S	26.0								
Rubber on Iron	1260			95-RIR-0830-S	95-RIT-0830-S	23.0								
Solid Urethane	1200			95-SUR-0830-S	95-SUR-0830-S	21.0								
Urethane on Iron	2500			95-UIR-0830-S	95-UIT-0830-S	26.0								
V-Groove Forged Steel	6000			95-VFR-0830-S	95-VFT-0830-S	29.0								
V-Groove Iron	5000			95-VIR-0830-S	95-VIT-0830-S	30.0								
8"	4"	Cast Iron	4000	10-1/2"	95-CIR-0840-S	95-VFT-0840-S	95-CIT-0840-S	2-3/16"	30.0					
		Forged Steel	10000		95-FSR-0840-S		95-FST-0840-S		34.0					
		Forged Steel	20000		95-UIR-0840-S		95-UIT-0840-S		34.0					
		Urethane on Iron	3500		95-VFR-0840-S		95-VFT-0840-S		28.0					
10"	3"	V-Groove Forged Steel	10000	12-1/2"	95-VFR-0840-S	95-SUB-1030-S	95-VIT-0840-S	2-11/16"	34.0					
		Cast Iron	4000		95-CIR-1030-S		95-CIT-1030-S		38.0					
		Durastan	2900		95-DUR-1030-S		95-FST-1030-S		25.0					
		Forged Steel	6000		95-FSR-1030-S		95-FST-1030-S		39.0					
		GT	3000		95-UOR-1030-S		95-UOT-1030-S		25.0					
		Omega	2000		95-UOR-1030-S		95-UOB-1030-S		32.0					
		Rubber on Aluminum	1500		95-RIR-1030-S		95-RAT-1030-S		26.0					
		Rubber on Iron	1500		95-RIR-1030-S		95-RIT-1030-S		28.0					
		Solid Urethane	1400		95-SUR-1030-S		95-SUR-1030-S		25.0					
		Ultra Thick Urethane	3400		95-UTR-1030-S		95-UTT-1030-S		32.0					
		Urethane on Iron	3000		95-UIR-1030-S		95-UIT-1030-S		32.0					
		V-Groove Forged Steel	6000		95-VFR-1030-S		95-VFT-1030-S		39.0					
		V-Groove Iron	5000		95-VIR-1030-S		95-VIT-1030-S		44.0					
		10"	4"		Forged Steel		10000		12-1/2"	95-FSR-1040-S	95-VFT-1040-S	95-FST-1040-S	2-7/16"	41.0
Forged Steel	20000			95-RIR-1040-S	95-RIT-1040-S	41.0								
Rubber on Iron	1400			95-UIR-1040-S	95-UIT-1040-S	34.0								
Ultra Thick Urethane	4500			95-UTR-1040-S	95-UTT-1040-S	36.0								
Urethane on Iron	4200			95-UIR-1040-S	95-UIT-1040-S	63.0								
V-Groove Forged Steel	10000			95-VFR-1040-S	95-VFT-1040-S	41.0								
V-Groove Forged	15000	95-VIR-1040-S	95-VIT-1040-S	41.0										
10"	5"	Urethane on Iron	5000	12-1/2"	95-UIR-1050-S	95-VFT-1040-S	95-UIT-1050-S	2-5/8"	32.0					
		Cast Iron	5000		95-CIR-1230-S		95-CIT-1230-S		41.0					
12"	3"	Durastan	3500	15-1/2"	95-DUR-1230-S	95-RAB-1230-S	95-FST-1230-S	3-5/8"	29.0					
		Rubber on Aluminum	1710		95-RIR-1230-S		95-RAT-1230-S		35.0					
		Rubber on Iron	1710		95-RIR-1230-S		95-RIT-1230-S		38.0					
		Ultra Thick Urethane	3500		95-UTR-1230-S		95-UTT-1230-S		35.0					
		Urethane on Iron	3400		95-UIR-1230-S		95-UIT-1230-S		42.0					
		V-Groove Iron	6000		95-VIR-1230-S		95-VIT-1230-S		43.0					
		12"	4"		Durastan		4000		15-1/2"	95-DUR-1240-S	95-RAB-1230-S	95-FST-1240-S	3-5/8"	30.0
		Rubber on Iron			1600		95-RIR-1240-S			95-RIT-1240-S		40.0		
Ultra Thick Urethane	5300	95-UTR-1240-S		95-UTT-1240-S	40.0									
12"	5"	Urethane on Iron	4800	15-1/2"	95-UIR-1240-S	95-RAB-1230-S	95-UIT-1240-S	3-5/8"	44.0					
Rubber on Iron		2050	95-RIR-1250-S		95-RIT-1250-S		44.0							
Ultra Thick Urethane		6500	95-UTR-1250-S		95-UTT-1250-S		49.0							
14"	3"	Urethane on Iron	6000	18"	95-UIR-1250-S	95-RAB-1230-S	95-UIT-1250-S	4-3/8"	48.0					
Ultra Thick Urethane		4300	95-UTR-1430-S		95-UTT-1430-S		39.0							
14"		4"	Ultra Thick Urethane		6200		18"		95-UTR-1440-S	95-RAB-1230-S	95-UTT-1440-S	4-3/8"	44.0	
14"	5"		Ultra Thick Urethane	7600	18"	95-UTR-1450-S		95-RAB-1230-S	95-UTT-1450-S		4-5/32"		52.0	
16"		3"	Durastan	4000		19"	95-DUR-1630-S		95-RAB-1230-S	95-FST-1630-S		4-3/8"	35.0	
	Rubber on Iron		1420	95-RIR-1630-S	95-RIT-1630-S		45.0							
	Ultra Thick Urethane		4600	95-UTR-1630-S	95-UTT-1630-S		47.0							
	Urethane on Iron		4600	95-UIR-1630-S	95-UIT-1630-S		48.0							
16"	4"	Durastan	8000	19"	95-DUR-1640-S	95-RAB-1230-S	95-FST-1640-S	4-3/8"	37.0					
		Ultra Thick Urethane	7100		95-UTR-1640-S		95-UTT-1640-S		52.0					
		Urethane on Iron	6000		95-UIR-1640-S		95-UIT-1640-S		54.0					
16"	5"	Ultra Thick Urethane	8400	19"	95-UTR-1650-S	95-RAB-1230-S	95-UTT-1650-S	4-5/32"	60.0					
		Urethane on Iron	8400		95-UIR-1650-S		95-UIT-1650-S		60.0					

OPTIONS

- CWB** Cam Wheel Brake
- DSL** Demountable Swivel Lock*
- HT** High Temperature Lubrication
- LT** Low Temperature Lubrication
- NY** Notched Yoke
- PCWB** Poly Cam Wheel Brake
- SL** Swivel Lock**
- WS** Wheel Seals
- ZP** Zinc Plating

*When ordering a Demountable Swivel Lock (DSL), you must also order the Notched Yoke (NY).
**Add 1/4" to overall height for swivel lock (SL) casters with 4" and 5" wide wheels.



2.95-UIR-0830-S

Also available with a dual-wheel configuration. Call for details or visit www.rwmcasters.com

To order a rigid caster, change the "S" to "R" in the model number.
For example: "95-CIR-0630-R".
To order a rig only, omit the blue letters.
For example: "95-0630-S".
Dimensions shown are nominal. If precise dimensions are required, consult your RWM representative.
For approximate weight of our rigid caster, deduct 9.6 pounds.



125-UIT-0840-S

FEATURES

Raceway Design - Patented Kingpinless™ single ball bearing precision machined raceway hardened to 53 Rockwell C Minimum, 7" diameter raceway with 3/4" diameter ball bearings

Finish - Laguna Blue paint

Wheels - Wheels are either 3", 4", 5" or 6" wide depending upon wheel size and type. Wheels have either a 3/4", 1", 1-1/4" or 1-1/2" roller bearing or 3/4", 1", 1-1/4" tapered wheel bearings. Roller bearing wheels rotate on a hardened and ground spanner, tapered wheel bearings rotate on the axle. All wheels are equipped with lubrication fittings.

Mounting Plate Size - 8-1/2" x 8-1/2" x 1/2" **Mounting Bolt Diameter** - 5/8" **Bolt Hole Spacing** - 7" x 7"

SPECIFICATIONS

Wheel Diameter	Wheel Width	Wheel Type	Capacity lbs	Overall Height	Swivel Caster Model Number		Swivel Lead	Approx Weight lbs.	
					Straight Roller Bearing	Tapered Roller Bearing			
8"	4"	Cast Iron	4000	11"	125-CIR-0840-S	125-CIT-0840-S	2-3/16"	70.0	
		Forged Steel	10000		125-FSR-0840-S			86.0	
		Forged Steel	20000			125-FST-0840-S			86.0
		Urethane on Iron	3500		125-UIR-0840-S	125-UIT-0840-S		62.0	
		V-Grooved Forged	10000		125-VFR-0840-S			80.0	
		V-Grooved Forged	15000			125-VFT-0840-S			80.0
10"	4"	Cast Iron	5000	13"	125-CIR-1040-S	125-CIT-1040-S	2-9/16"	90.0	
		Forged Steel	10000		125-FSR-1040-S			100.0	
		Forged Steel	20000			125-FST-1040-S			100.0
		Rubber On Iron	1400		125-RIR-1040-S	125-RIT-1040-S		72.0	
		Ultra Thick Urethane	4500		125-UTR-1040-S	125-UTT-1040-S		62.0	
		Urethane on Iron	4200		125-UIR-1040-S	125-UIT-1040-S		75.0	
		V-Grooved Forged	10000		125-VFR-1040-S			92.0	
		V-Grooved Forged	15000			125-VFT-1040-S			92.0
		Cast Iron	6000		125-CIR-1050-S	125-CIT-1050-S		2-9/16"	95.0
Urethane on Iron	5000	125-UIR-1050-S	125-UIT-1050-S		80.0				
11"	5"	Rubber On Iron	1760	14"	125-RIR-1150-S	125-RIT-1150-S	2-5/8"	85.0	
		Urethane on Iron	5500		125-UIR-1150-S	125-UIT-1150-S		85.0	
11"	6"	Cast Iron	10000	14"	125-CIR-1160-S	125-CIT-1160-S	2-3/4"	95.0	
12"	4"	Rubber On Iron	1600	15-1/2"	125-RIR-1240-S	125-RIT-1240-S	3-3/8"	78.0	
		Ultra Thick Urethane	5300		125-UTR-1240-S	125-UTT-1240-S		75.0	
		Urethane on Iron	4800		125-UIR-1240-S	125-UIT-1240-S		78.0	
12"	5"	Rubber On Iron	2050	15-1/2"	125-RIR-1250-S	125-RIT-1250-S	3-3/8"	90.0	
		Ultra Thick Urethane	6500		125-UTR-1250-S	125-UTT-1250-S		78.0	
		Urethane on Iron	6000		125-UIR-1250-S	125-UIT-1250-S		90.0	
12"	6"	Cast Iron	10000	15-1/2"	125-CIR-1260-S	125-CIT-1260-S	3-3/8"	130.0	
		Urethane on Iron	7500		125-UIR-1260-S	125-UIT-1260-S		95.0	
14"	4"	Ultra Thick Urethane	6200	18"	125-UTR-1440-S	125-UTT-1440-S	3-11/16"	90.0	
14"	5"	Ultra Thick Urethane	7600	18"	125-UTR-1450-S	125-UTT-1450-S	3-11/16"	85.0	
14"	6"	Ultra Thick Urethane	7800	18"	125-UIR-1460-S	125-UIT-1460-S	3-11/16"	140.0	
16"	4"	Rubber On Iron	2050	19"	125-RIR-1640-S	125-RIT-1640-S	3-17/32"	130.0	
		Ultra Thick Urethane	7100		125-UTR-1640-S	125-UTT-1640-S		97.0	
		Urethane on Iron	6000		125-UIR-1640-S	125-UIT-1640-S		130.0	
16"	5"	Rubber On Iron	2570	19"	125-RIR-1650-S	125-RIT-1650-S	3-17/32"	140.0	
		Ultra Thick Urethane	8400		125-UTR-1650-S	125-UTT-1650-S		130.0	
		Urethane on Iron	8400		125-UIR-1650-S	125-UIT-1650-S		140.0	
18"	5"	Rubber On Iron	2800	22"	125-RIR-1850-S	125-RIT-1850-S	4-1/4"	150.0	
		Urethane on Iron	8600		125-UIR-1850-S	125-UIT-1850-S		138.0	
20"	5"	Rubber On Iron	2900	23"	125-RIR-2050-S	125-RIT-2050-S	4-1/4"	155.0	
		Urethane on Iron	9000		125-UIR-2050-S	125-UIT-2050-S		149.0	

OPTIONS

DSL	Demountable Swivel Lock*
FCWB	Face Contact Wheel Brake
HT	High Temperature Lubrication
LT	Low Temperature Lubrication
NY	Notched Yoke
PCWB	Poly Cam Wheel Brake
SL	Swivel Lock
SR	Sealed Swivel Raceway
WS	Wheel Seals
ZP	Zinc Plated

*When ordering the Demountable Swivel Lock (DSL), you must also order the Notched Yoke (NY).

To order a rigid caster, change the "S" to "R" in the model number. For example: "125-CIR-0840-R". To order rig only, omit the blue letters. For example: "125-0840-S". Dimensions shown are nominal. If precise dimensions are required, consult your RWM representative. For approximate weight of our rigid casters, deduct 12.5 pounds per item.

OPTIONAL MOUNTING PLATES

Optional Top Plate Number	Mounting Plate	Bolt Hole Spacing	Bolt Size
LLST/LLRT	8-1/2" x 11"	7" x 9-3/4"	5/8"



2-125-CIT-1260-S

Also available with a dual-wheel configuration. Call for details or visit www.rwmcasters.com

SA Series Casters

Shock Absorbing Casters

- Reduce stress on wheels and rigs due to shock from rough surfaces
- Dampen and isolate shocks and vibration from rough surfaces to protect cargo or contents in a cart or equipment
- Reduce noise caused by casters traveling over rough surfaces
- Equalize the load over uneven terrain among four or more casters, thereby reducing overloads on casters and twisting of the cart/frame

75-DUR-0825-S-VMS-500

SPECIFICATIONS

Wheel Diameter	Wheel Width	Wheel Type	Swivel Series	Overall Height @1/2 Deflection	Swivel Lead	Swivel Radius	Deflection Range*	Caster Load Rating Availability (Min-Max)	lbs. Approx Weight	Swivel Caster Model Number**
VMS SA CASTER										
Vertical Mount Spring										
6"	2"	Phenolic	44	8-1/8"	1-3/4"	4-3/4"	7/8"	200-800	9.0	44-DUR-0620-S-VMS
		Rubber/Iron					1"	200-400	11.0	44-RIR-0620-S-VMS
		Urethane					1"	200-800	11.1	44-UIR-0620-S-VMS
8"	2"	Phenolic	44	10"	2-1/8"	6-1/8"	15/16"	200-1000	10.0	44-DUR-0820-S-VMS
		Rubber/Iron					1"	200-500	12.0	44-RIR-0820-S-VMS
		Urethane					1"	200-1000	12.0	44-UIR-0820-S-VMS
8"	2"	Phenolic	65	11"	2-1/8"	6-1/8"	1-1/4"	500-1000-1400	12.0	65-DUR-0820-S-VMS
		Rubber/Iron			2-1/4"	6-1/2"		500	13.0	65-RIR-0820-S-VMS
		Urethane			2-1/4"	6-1/2"	500-1000-1500	13.0	65-UIR-0820-S-VMS	
8"	2-1/2"	Phenolic	75	11"	2-1/4"	6-1/2"	1-1/4"	500-1000-1500	13.5	75-DUR-0825-S-VMS
		Rubber/Iron						500-670	15.0	75-RIR-0825-S-VMS
		Urethane					500-1000-1500	15.0	75-UIR-0825-S-VMS	
8"	2-1/2"	Phenolic	2-75	11"	2"	7-1/8"	1-1/4"	1000-2000-3000	27.0	2-75-DUR-0825-S-VMS
		Rubber/Iron			2-1/4"			1000-1340	30.0	2-75-RIR-0825-S-VMS
		Urethane			2-1/4"		1000-2000-3000	30.0	2-75-UIR-0825-S-VMS	
10"	2-1/2"	Phenolic	75	13"	2-3/4"	8"	1-1/4"	500-1000-1050	15.0	75-DUR-1025-S-VMS
		Rubber/Iron						500-790	20.0	75-RIR-1025-S-VMS
		Urethane					500-1000-1500	20.0	75-UIR-1025-S-VMS	
10"	2-1/2"	Phenolic	2-75	13"	2-3/4"	8"	1-1/4"	1000-2000-3000	30.0	2-75-DUR-1025-S-VMS
		Rubber/Iron						1000-1500	40.0	2-75-RIR-1025-S-VMS
		Urethane					1000-2000-3000	40.0	2-75-UIR-1025-S-VMS	
10"	3"	Phenolic	2-75	13"	2-3/4"	8-5/8"	1-1/4"	1000-2000-3000	38.0	2-75-DUR-1030-S-VMS
		Rubber/Iron						1000-2000	48.0	2-75-RIR-1030-S-VMS
		Urethane					1000-2000-3000	48.0	2-75-UIR-1030-S-VMS	
OMS SA CASTER										
Outside Mount Spring										
12"	4"	Urethane	2-125	21"	5-1/2"	12-3/4"	2-1/2"	4800-9600	290.0	2-125-UIT-1240-S-OMS
		Urethane Thick						4800-9600	290.0	2-125-UTT-1240-S-OMS
12"	5"	Urethane	125	21"	5-1/2"	12"	2-1/2"	3250-6000	100.0	125-UIT-1250-S-OMS
16"	5"	Urethane	125	23"	5-1/2"	14"	2-1/2"	3250-6500	180.0	125-UIT-1650-S-OMS
		Urethane Thick						3250-6500	180.0	125-UTT-1650-S-OMS
16"	5"	Urethane	2-125	23"	5-1/2"	15"	2-1/2"	6500-13000	400.0	2-125-UIT-1650-S-OMS
		Urethane Thick						6500-13000	400.0	2-125-UTT-1650-S-OMS
18"	5"	Urethane	2-125	25"	5-1/2"	16"	2-1/4"	8000-16000	570.0	2-125-UIT-1850-S-OMS
20"	5"	Urethane Iron	2-125	25-5/8"	5-7/8"	18-5/8"	1-1/2"	10000-20000	925.0	2-125-UIT-2050-S-OMS
IMS SA CASTER										
Inside Mount Spring										
4"	2"	Phenolic	65	7-1/4"	2"	4-1/8"	1-1/16"	100-200-250	10.0	65-DUR-0420-S-IMS
		Rubber/Iron						100-200-250	10.0	65-RIR-0420-S-IMS
		Urethane						100-200-250	10.0	65-UIR-0420-S-IMS
4"	2-1/2"	Urethane	65	7-1/4"	2"	4-1/4"	1-1/16"	100-200-250	10.0	65-UIB-0425-S-IMS
8"	2-1/2"	Phenolic	75	11"	4-1/2"	8-3/4"	1-1/2"	500-1000-1500-2000	13.5	75-DUR-0825-S-IMS
		Rubber/Iron						670	15.0	75-RIR-0825-S-IMS
		Urethane						1000-1500-2000	20.0	75-UIR-0825-S-IMS
8"	3"	Phenolic	75	11"	4-1/2"	8-3/4"	1-1/2"	1000-1500-2000	15.0	75-DUR-0830-S-IMS
		Rubber/Iron						840	17.0	75-RIR-0830-S-IMS
		Urethane						1000-1500-2000	27.0	75-UIT-0830-S-IMS
		Urethane Thick						1000-1500-2000	17.0	75-UTR-0830-S-IMS
8"	3"	Phenolic	2-85	11-1/2"	4-1/2"	9-3/8"	1-1/2"	2000-3000	35.0	2-85-DUR-0830-S-IMS
		Rubber/Iron						1680	45.0	2-85-RIR-0830-S-IMS
		Urethane						2000-3000	45.0	2-85-UIT-0830-S-IMS
		Urethane Thick						2000-3000	45.0	2-85-UTT-0830-S-IMS
10"	2-1/2"	Phenolic	75	13"	4-1/2"	9-3/4"	1-1/2"	1100-1650-2200	15.0	75-DUR-1025-S-IMS
		Rubber/Iron						790	20.0	75-RIR-1025-S-IMS
		Urethane						1100-1650-2200	49.0	75-UIR-1025-S-IMS
10"	3"	Phenolic	75	13"	4-1/2"	9-3/4"	1"	1100-1650-2200	18.0	75-DUR-1030-S-IMS
		Rubber/Iron						1000	40.0	75-RIR-1030-S-IMS
		Urethane						1100-1650-2200	23.0	75-UIT-1030-S-IMS
		Urethane Thick						1100-1650-2200	23.0	75-UTT-1030-S-IMS
10"	3"	Phenolic	2-85	13-1/2"	4-1/2"	10-1/4"	1-1/2"	2200-3300-4400	42.0	2-85-DUR-1030-S-IMS
		Rubber/Iron						2000	52.0	2-85-RIR-1030-S-IMS
		Urethane						2200-3300-4400	52.0	2-85-UIT-1030-S-IMS
		Urethane Thick						2200-3300-4400	52.0	2-85-UTT-1030-S-IMS
10"	5"	Urethane	125	15-1/2"	4-1/2"	10"	1-3/4"	2200-3300	80.0	125-UIT-1050-S-IMS
12"	3"	Phenolic	75	16"	5-1/2"	11-3/4"	1-3/4"	1100-2200-3300	26.0	75-DUR-1230-S-IMS
		Rubber/Iron						1100	31.0	75-RIR-1230-S-IMS
		Urethane						1100-2200-3300	47.0	75-UIT-1230-S-IMS
		Urethane Thick						1100-2200-3300	53.0	75-UTT-1230-S-IMS
12"	3"	Phenolic	2-85	16-1/2"	5-1/2"	12-1/4"	1-3/4"	2200-4400-6600	60.0	2-85-DUR-1230-S-IMS
		Rubber/Iron						2200	65.0	2-85-RIR-1230-S-IMS
		Urethane						2200-4400-6600	102.0	2-85-UIT-1230-S-IMS
		Urethane Thick						2200-4400-6600	116.0	2-85-UTT-1230-S-IMS
12"	5"	Urethane	125	16-1/2"	5-1/2"	12"	2"	2200-3300	290.0	125-UIT-1250-S-IMS

* Half deflection at specified overall height and caster load rating.

** When placing an order, add the capacity to the end of the model number. Example: 65-DUR-0820-S-VMS-1000

† Often called working height. Add 1/2 of total deflection range to obtain height at no load. Example: 75-DUR-0825-S-VMS-500.

11" overall height plus 5/8" equals 11-5/8" height at no load. All dimensions are nominal. Contact RWM representative for exact information.

Call factory for specialty top plates or applications.



S65-SUB-0820-S-42ST

FEATURES

Raceway Design - Patented Kingpinless™ single ball bearing precision machined raceway. 2-3/8" diameter raceway with 3/8" stainless ball bearings.

Leg Thickness - 3/16"

Axle - 1/2" bolt with locking nut

Wheels - Wheels are available with either a straight roller bearing, an annular ball bearing for ease of rollability, or a celcon bearing

Mounting Plate Size - 4" x 4-1/2" x 1/4"

Mounting Bolt Diameter - 3/8"

Bolt Hole Spacing - 2-5/8" x 3-5/8" slotted to 3" x 3"

SPECIFICATIONS

Wheel Diameter	Wheel Width	Wheel Type	Capacity lbs	Overall Height	Swivel Caster Model Number			Swivel Lead	Approx Weight lbs.
					Straight Roller Bearing	Ball Bearing	Plain, Oilite, Celcon Bearing		
4"	2"	Durastan	800	5-5/8"	S65-DUR-0420-S	S65-DUB-0420-S	S65-DUC-0420-S	1-9/32"	8.0
		GT	1050		S65-GTB-0420-S				8.0
		High Temp. Nylon	800		S65-HNR-0420-S	S65-HNB-0420-S			8.0
		Performance TPR	350		S65-RPR-0420-S	S65-RPB-0420-S	S65-RPC-0420-S		7.3
		Polyolefin	500		S65-POR-0420-S	S65-POB-0420-S	S65-POC-0420-S		7.6
		Rubber on Aluminum	525		S65-RAR-0420-S		S65-RAC-0420-S		8.0
		Solid Urethane	1000		S65-SUR-0420-S	S65-SUB-0420-S	S65-SUC-0420-S		8.0
		Urethane on Aluminum	700		S65-UAR-0420-S		S65-UAC-0420-S		7.5
		Urethane on Iron	700		S65-UIR-0420-S	S65-UIB-0420-S	S65-UIC-0420-S		8.0
		Urethane Polypropylene	600		S65-UPR-0420-S	S65-UPB-0420-S	S65-UPC-0420-S		7.3
5"	2"	Durastan	1000	6-1/2"	S65-DUR-0520-S	S65-DUB-0520-S	S65-DUC-0520-S	1-7/16"	9.0
		GT	1200		S65-GTB-0520-S				9.0
		High Temp Nylon	1000		S65-HNR-0520-S	S65-HNB-0520-S			9.0
		Performance TPR	375		S65-RPR-0520-S	S65-RPB-0520-S	S65-RPC-0520-S		7.3
		Polyolefin	650		S65-POR-0520-S	S65-POB-0520-S	S65-POC-0520-S		8.7
		Rubber on Aluminum	600		S65-RAR-0520-S		S65-RAC-0520-S		8.6
		Solid Urethane	1000		S65-SUR-0520-S	S65-SUB-0520-S	S65-SUC-0520-S		9.0
		Urethane on Aluminum	1050		S65-UAR-0520-S		S65-UAC-0520-S		8.5
		Urethane on Iron	1050		S65-UIR-0520-S	S65-UIB-0520-S	S65-UIC-0520-S		9.0
		Urethane Polypropylene	750		S65-UPR-0520-S	S65-UPB-0520-S	S65-UPC-0520-S		7.3
6"	2"	Durastan	1200	7-1/2"	S65-DUR-0620-S		S65-DUC-0620-S	1-21/32"	10.0
		GT	1200		S65-GTB-0620-S				10.0
		High Temp. Nylon	1200		S65-HNR-0620-S	S65-HNB-0620-S			10.0
		Omega	1000		S65-UOR-0620-S	S65-UOB-0620-S	S65-UOC-0620-S		12.0
		Performance TPR	525		S65-RPR-0620-S	S65-RPB-0620-S	S65-RPC-0620-S		7.7
		Polyolefin	700		S65-POR-0620-S	S65-POB-0620-S	S65-POC-0620-S		8.7
		Rubber on Aluminum	615		S65-RAR-0620-S	S65-RAB-0620-S	S65-RAC-0620-S		10.0
		Solid Urethane	1000		S65-SUR-0620-S	S65-SUB-0620-S	S65-SUC-0620-S		10.0
		Urethane on Aluminum	1200		S65-UAR-0620-S		S65-UAC-0620-S		11.0
		Urethane on Iron	1200		S65-UIR-0620-S	S65-UIB-0620-S	S65-UIC-0620-S		12.0
Urethane Polypropylene	900	S65-UPR-0620-S	S65-UPB-0620-S	S65-UPC-0620-S	7.7				
8"	2"	Durastan	1200	10-1/8"	S65-DUR-0820-S	S65-DUB-0820-S	S65-DUC-0820-S	2-3/8"	11.0
		GT	1200		S65-GTB-0820-S				11.0
		Omega	1200		S65-UOR-0820-S	S65-UOB-0820-S	S65-UOC-0820-S		13.0
		Performance TPR	600		S65-RPR-0820-S	S65-RPB-0820-S	S65-RPC-0820-S		8.1
		Polyolefin	800		S65-POR-0820-S	S65-POB-0820-S	S65-POC-0820-S		9.1
		Rubber on Aluminum	750		S65-RAR-0820-S	S65-RAB-0820-S	S65-RAC-0820-S		11.0
		Solid Urethane	1200		S65-SUR-0820-S	S65-SUB-0820-S	S65-SUC-0820-S		11.0
		Urethane on Aluminum	1200		S65-UAR-0820-S		S65-UAC-0820-S		12.0
		Urethane on Iron	1200		S65-UIR-0820-S	S65-UIB-0820-S	S65-UIC-0820-S		13.0
		Urethane Polypropylene	1000		S65-UPR-0820-S	S65-UPB-0820-S	S65-UPC-0820-S		9.1

OPTIONS

DSL	Demountable Swivel Lock
SCWB	Stainless Steel Cam Wheel Brake
SICWB	Stainless Installable Face Contact Brake
SL	Swivel Lock
SR	Sealed Swivel Raceway
SSBB	Stainless Steel Ball Bearing
SSRB	Stainless Steel Roller Bearing
WB	Stainless Side Wheel Brake
WTHB	Stainless Welded T-Handle Brake

OPTIONAL OVERALL HEIGHTS

Wheel Diameter	Overall Height
4"	5-9/16"
5"	6-11/16"
6"	7-19/32"
8"	9-1/2"



COMPONENT

Available NSF Products:

All casters except those with cast iron, soft rubber, Omega, rubber on iron, rubber on aluminum, forged steel, urethane on aluminum, urethane on iron, or V-groove wheels.

The following options are also not available: SL and SR. Add "-N" to the end of the model number to specify an NSF approved caster.

For example: S65-DUR-0620-S-N.

OPTIONAL MOUNTING PLATES

Optional Top Plate Number	Mounting Plate	Bolt Hole Spacing	Bolt Size
41RT 41ST	4" x 5"	2-5/8" x 3-5/8" slotted to 3" x 4"	3/8"
42RT 42ST	4-1/2" x 6-1/2"	2-7/16" x 4-15/16" slotted to 3-3/8" x 5-1/4"	1/2"
43RT 43ST	5" x 5-1/2"	4-1/8" x 4-1/2"	3/8"

To order a rigid caster, change the "S" to "R" in the model number.

For example: "S65-GTB-0420-R".

To order a rig only, omit the blue letters.

For example: "S65-0420-S".

Dimensions shown are nominal. If precise dimensions are required, consult your RWM representative.

For approximate weight of our rigid caster, deduct 5.4 pounds.



S75 Stainless Steel Casters

Kingpinless™
Design

FEATURES

Raceway Design - Patented Kingpinless™ single ball bearing precision machined raceway. 3" diameter raceway with 1/2" stainless ball bearings.

Leg Thickness - 1/4"

Mounting Plate Size - 4-1/2" x 6-1/2" x 1/4"

Mounting Bolt Diameter - 1/2"

Bolt Hole Spacing - 2-7/16" x 4-15/16" slotted to 3-3/8" x 5-1/4"

S75-GTB-0625-S-SSBB-WTHB

SPECIFICATIONS

Wheel Diameter	Wheel Width	Wheel Type	lbs Capacity	Overall Height	Swivel Caster Model Number			Swivel Lead	lbs. Approx Weight	
					Straight Roller Bearing	Ball Bearing	Tapered Roller Bearing			
6"	2-1/2"	Durastan	1600	7-1/2"	S75-DUR-0625-S	S75-GTB-0625-S	S75-UIT-0625-S	1-3/8"	11.5	
		GT	2300		11.5					
		Urethane on Iron	1620		16.5					
6"	3"	Durastan	2000	7-1/2"	S75-DUR-0630-S	S75-SUB-0630-S	S75-UIT-0630-S	1-3/8"	12.5	
		Solid Urethane	1200		12.5					
		Urethane on Iron	2000		17.5					
8"	2-1/2"	Durastan	2000	10-1/8"	S75-DUR-0825-S	S75-GTB-0825-S	S75-UIT-0825-S	2-3/32"	15.0	
		GT	2400		15.0					
		Urethane on Iron	2000		18.5					
8"	3"	Durastan	2500	10-1/8"	S75-DUR-0830-S	S75-SUB-0830-S	S75-UIT-0830-S	2-3/32"	16.5	
		Omega	1600		S75-UOT-0830-S				19.0	
		Solid Urethane	1200		S75-SUR-0830-S				16.5	
		Urethane on Iron	2500		S75-UIR-0830-S				19.5	
		Urethane on Iron	2500		S75-UIT-0830-S				19.5	
10"	2-1/2"	Durastan	2500	11-1/2"	S75-DUR-1025-S	S75-UIT-1025-S	S75-UIT-1025-S	2-1/4"	16.5	
		Urethane on Iron	2370		21.5					
10"	3"	Durastan	2500	11-1/2"	S75-DUR-1030-S	S75-GTB-1030-S	S75-UIT-1030-S	2-1/4"	20.0	
		GT	2500		S75-UOB-1030-S				20.0	
		Omega	2000		S75-UOT-1030-S				22.0	
		Rubber on Aluminum	1500		S75-RAB-1030-S				S75-RAT-1030-S	20.3
		Solid Urethane	1400		S75-SUR-1030-S				S75-SUB-1030-S	20.0
		Urethane on Iron	2500		S75-UIR-1030-S				S75-UIT-1030-S	22.5
		Ultra Thick Urethane	2500		S75-UTR-1030-S				S75-UTT-1030-S	25.0
12"	2-1/2"	Durastan	2500	13-1/2"	S75-DUR-1225-S	S75-UIT-1225-S	S75-UIT-1225-S	2-11/16"	20.5	
		Urethane on Iron	2500		23.5					
12"	3"	Durastan	2500	13-1/2"	S75-DUR-1230-S	S75-RAB-1230-S	S75-RAT-1230-S	2-11/16"	22.5	
		Rubber on Aluminum	1710		S75-UIT-1230-S				24.5	
		Urethane on Iron	2500		S75-UIR-1230-S				26.5	
		Ultra Thick Urethane	2500		S75-UTR-1230-S				S75-UTT-1230-S	28.0

OPTIONS

SCWB	Stainless Steel Cam Wheel Brake
SL	Swivel Lock
SR	Sealed Swivel Raceway
SSBB	Stainless Steel Ball Bearing
SSRB	Stainless Steel Roller Bearing
WTHB	Welded "T" Handle Brake

To order a rigid caster, change the "S" to "R" in the model number. For example: "S75-DUR-0830-R".
To order a rig only, omit the blue letters. For example: "S75-0830-S".
Dimensions shown are nominal. If precise dimensions are required, consult your RWM representative.
For approximate weight of our rigid caster, deduct 5.4 pounds.



RAPIDSTOCK™ products are available to ship in 1 to 5 days. All of our products shown in this brochure are available in the RAPIDSTOCK™ program. Products can easily be ordered by phone or fax. Visit our website at www.rwmcasters.com or contact customer service at 1-800-634-7704 for more information.

FEATURES

Raceway Design - Patented Kingpinless™ single ball bearing precision machined raceway hardened to 53 Rockwell C minimum. All swivel sections are supplied with a lubrication fitting for field maintenance. See individual series section for more information.

Mounting - Choose an available mounting plate or specify a desired method. Some options include: stems, center holes, and tapped holes.

Finish - Laguna Blue paint. 47 and 65 Series come standard zinc plated.

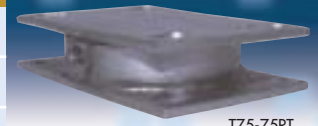

T75-75RT

SPECIFICATIONS

Swivel Section	Mounting Plates	Overall Stack Height	Capacity	Max. Offset	Approx. Weight	Top Plate Size	Bolt Hole Spacing	Center Hole
47	T47-46RT (47STD)	1-1/16"	900	1-3/16"	2.6	4" x 4-1/2"	2-5/8" x 3-5/8" slotted to 3" x 3"	1"
	T47-41RT	1-1/16"			3.8	4" x 5"	2-5/8" x 3-5/8" slotted to 3" x 4"	
	T47-42RT	1-1/16"			4.8	4-1/2" x 6-1/2"	2-7/16" x 4-15/16" slotted to 3-3/8" x 5-1/4"	
	T47-43RT	1-1/16"			4.9	5" x 5-1/2"	4-1/8" x 4-1/2"	
65	T65-41RT	1-9/16"	1500	1-3/16"	4.3	4" x 5"	2-5/8" x 3-5/8" slotted to 3" x 4"	1"
	T65-42RT	1-9/16"			5.3	4-1/2" x 6-1/2"	2-7/16" x 4-15/16" slotted to 3-3/8" x 5-1/4"	
	T65-43RT	1-9/16"			5.4	5" x 5-1/2"	4-1/8" x 4-1/2"	
	T65-46RT (65STD)	1-9/16"			3.13	4" x 4 1/2"	2 5/8" x 3 5/8" slotted to 3" x 3"	
	T65-54RT	1-13/16"			8.13	5-1/4" x 7-1/4"	3-3/8" x 5-1/4" slotted to 4-1/8" x 6-1/8"	
	T65-75RT	1-11/16"			6.5	4-1/2" x 6-1/2"	2-7/16" x 4-15/16" slotted to 3-3/8" x 5-1/4"	
75	T75-75RT	1-11/16"	4500	1-1/2"	7.1	4-1/2" x 6-1/2"	2-7/16" x 4-15/16" slotted to 3-3/8" x 5-1/4"	1-1/2"
	T75-76RT	1-13/16"	5200		10.7	5-1/4" x 7-1/4"	3 3/8" x 5 1/4" slotted to 4 1/8" x 6 1/8"	
	T75-90RT	2-1/16"	5200		14.1	6" x 7"	4-5/8" x 5-1/2" slotted to 4-3/8" x 5-5/8"	
	T75-95RT	2-1/16"	5200		15.4	6" x 7-1/2"	4-1/2" x 6" slotted 4-1/8" x 6-1/8"	
85	T85-90RT (85STD)	2-3/8"	7500	2-1/8"	17.5	6" x 7"	4-5/8" x 5-1/2" slotted to 4-3/8" x 5-5/8"	2"
	T85-95RT	2-3/8"			18.7	6" x 7-1/2"	4-1/2" x 6" slotted 4-1/8" x 6-1/8"	
	T85-LLRT	2-3/8"			41.1	8-1/2" x 11"	7" x 9-3/4"	
	T85-LMRT	2-3/8"			25.1	8-1/2" x 8-1/2"	7" x 7"	
95	T95-95RT	2-1/2"	10,000	2-1/4"	22.1	6-1/4" x 7-1/2"	4-1/2" x 6" slotted 4-1/8" x 6-1/8"	1"
125	T125-LLRT	2-7/8"	30,000	3-1/2"	52.1	8-1/2" x 11"	7" x 9-3/4"	4"
	T125-LMRT (125STD)	2-7/8"			36.1	8-1/2" x 8-1/2"	7" x 7"	

All dimensions are in inches except for capacity, which is in pounds.

Consult the factory for special mounting options and applications.

**For Ultimate Dependability,
Order RWM Kingpinless™ Casters Today!**

OPTIONS

DSL	Demountable Swivel Lock*
HT	High Temperature Lubrication
LT	Low Temperature Lubrication
NY	Notched Yoke
OM	Optional Mounting
SL	Swivel Lock
SR	Sealed Raceway
SS	Stainless Steel (65, 75 only)
ZP	Zinc Plated

*When ordering the Demountable Swivel Lock (DSL), you must also order the Notched Yoke (NY).



Applications

- Aerospace
- Assembly Plants
- Automotive
- Cleanroom
- Composites
- Food Service
- Foundries
- Glass Factories
- Industrial Laundries
- Medical
- Newspapers
- Printing
- Sub-Assembly Plants
- Textile
- Tire Plants
- Warehouses

Other RWM product literature available:

- RWM Product Catalog
- Material Handling Brochure
- TwinWheel™ Brochure
- CargoMax™ Brochure
- Light Duty Inverted Cargo Caster Sheet
- 31 Series Caster Sheet
- High Temperature Nylon Wheels & Elastomeric High Tensile Wheels Sheet
- Performance Wheel Brochure
- 46 Series Brake & 27 Series Brake Sheet
- RWM Laminated Product Poster

***Call or visit our website to order
or download a copy.***



P.O. Box 668
1225 Isley Road
Gastonia NC 28053
Phone: 1-800-634-7704
Fax: 1-800-253-6634
www.rwmcasters.com