

# AUSTAL PATROL 58 – CAPE CLASS



## CAPE CLASS PATROL BOATS PROJECT

In the 2010-11 Budget, the Australian Government reaffirmed its commitment to improving maritime border security by investing in building and supporting eight new enhanced patrol boats to replace the Bay Class vessels, which are nearing the end of their planned operational life.

In March 2010, Customs and Border Protection released a tender for the design and construction of these boats. Austal emerged as the winner of the contract to design, build and provide in-service support to Customs and Border Protection's next generation of vessels.

The in-service support contract extends for a minimum period of eight years and encompasses a full range of intermediate and

depot level maintenance activities. Further options can be exercised by Customs and Border Protection for in-service support for the life of the fleet.

This contract is Austal's second significant contract with Customs and Border Protection, having designed and constructed its current fleet of eight Bay Class vessels.

The new Cape Class Patrol Boats represent a significant investment in Australia's long term security and is the biggest maritime acquisition project ever undertaken by Customs and Border Protection.

The first Cape Class Patrol Boat came on line in early 2013, and the full fleet will be operational by late 2015.

## ABOUT THE CAPE CLASS PATROL BOATS

The Cape Class Patrol Boats have greater range, endurance and flexibility in responding to maritime security threats than the current Bay Class vessels. These boats also have enhanced capability to operate in higher sea states and survive in more severe conditions.

The patrol boats have capacity to accommodate future upgrades in surveillance technology and response capability. It is intended that these vessels will be connected to the Australian Maritime Security Operations Centre via an Australian Maritime Identification System terminal onboard each vessel.

The Cape Class Patrol Boats are able to:

- Undertake 28 day patrols
- Sail 4,000 nautical miles before having to refuel
- Sail to 50 degrees south, in Southern Ocean waters
- Combat the full range of maritime security threats
- Carry a larger crew than the Bay Class vessels to more effectively and safely manage boarding operations
- Identify, track, intercept additional threats in the maritime domain and gather intelligence and store evidence for matters that may proceed to the courts
- Launch two Tender Response Vessels simultaneously



## USE OF PATROL BOATS

Customs and Border Protection patrol boats may be deployed according to aerial surveillance, community reports and/or radar sightings.

They may be used to:

- Counter people, drug and weapons smuggling
- Apprehend foreign fishing vessels
- Gather information and intelligence
- Monitor environmental pollution
- Assist management of offshore nature reserves and marine parks



## COMBATING MARITIME SECURITY THREATS

Australia has 36,000 kilometres of coastline and an offshore maritime area of nearly 13 million square kilometres.

The new Customs and Border Protection Cape Class Patrol Boats will play a significant role in border security by maintaining a presence around Australia's coastline and responding to reported or suspected border incidents and illegal activity.

Customs and Border Protection vessels perform strategic patrols and tactical surveillance and enforcement for various agencies to address maritime security threats within and beyond Australia's 200 nautical mile Exclusive Economic Zone (EEZ).

These threats are:

- unauthorised maritime arrivals
- bio-security
- illegal exploitation of natural resources
- illegal activity in protected areas
- import or export of prohibited items
- maritime terrorism
- piracy, robbery or violence at sea
- marine pollution

The Cape Class Patrol Boats and crew are capable of operating to the full extent of the Australian EEZ, other than in the deep Southern Ocean, and have the capacity to conduct operations in all environments in which Customs and Border Protection now operates and will be required to operate in the future.

# CAPE CLASS PATROL BOAT SPECIFICATIONS



## PRINCIPAL DIMENSIONS

Length overall .....	58.1 metres
Beam (overall).....	10.8 metres
Draft (approx.) .....	3.1 metres

## ACCOMMODATION

Crew .....	18
Facilities .....	Holding areas equipped with CCTV and facilities for accommodating intercepted illegal foreign fishers and suspected unauthorised people attempting to enter Australia

## ARMAMENT

Weapons .....	Two deck-mounted 0.50 cal general purpose machine guns
---------------	--

## COMMUNICATION & SENSORS

Communication system .....	Secure/Non-secure voice and data over VHF, UHF, SATCOM and Sea Boat's Situational Awareness
Navigation.....	Integrated bridge system including Radars, 2 x ECDIS, 2 x Gyro Compass, Secure AIS, 2 x DGPS, EOSS and VDR

## ADDITIONAL FEATURES

Sea boats .....	2 x 7.3 metre Gemini
Motion control system.....	Austal 2 x 3.25m <sup>2</sup> roll fins 2 x 4.5m <sup>2</sup> trim flaps

## PROPULSION

Main engines .....	2 x Caterpillar 3516C
.....	2 x 2,525 kW @ 1,800 rpm
Gearboxes.....	2 x ZF 9055A
Propellers.....	2 x fixed pitch
Bow thruster.....	HRP 2001 TT (160 kW)

## PERFORMANCE

Speed.....	26 knots
Range at 12 knots .....	> 4000 nautical miles

## CLASSIFICATION

Det Norske Veritas  
✘1A1 LC, PATROL, E0, N, BIS, NAUT-HSC, ELT, RADHAZ



# AUSTAL PATROL 58 – CAPE CLASS

Vessel Type: Cape Class Patrol Boat

PROFILE



PROFILE @ CENTRELIN

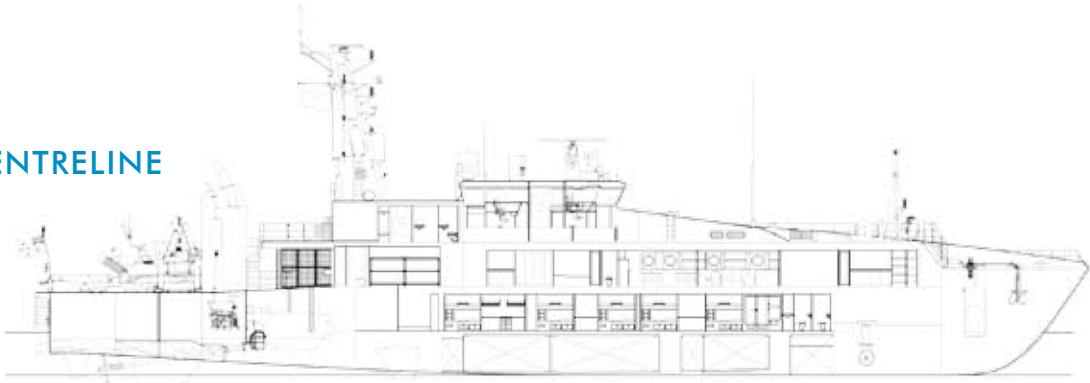

BRIDGE DECK

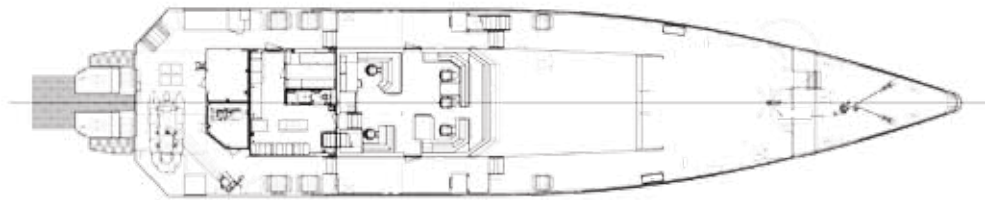

MAIN DECK



LOWER DECK



YARD NO : 361 - 368  
CAPE CLASS PATROL BOAT

DESTINATION: AUSTRALIA

DELIVERY : APRIL 2013 - SEPT 2015

CLIENT: AUSTRALIAN CUSTOMS AND  
BORDER PROTECTION SERVICE

100 Clarence Beach Road  
Henderson  
Western Australia 6166

Tel +61 8 9410 1111  
Fax +61 8 9410 2564  
sales@austal.com  
www.austal.com

SHIPS • SYSTEMS • SUPPORT

