

**ADDRESS**

2101 Dollard Avenue,  
LaSalle, Québec

**INTERSECTION**

Boul. Newman & Avenue Dollard

**TOTAL COMPLEX**

190,923 sq. ft.

**MAJOR TENANTS**

Maxi  
Rossy  
Winners  
Bouclair  
Royal Bank

**FEATURES**

- Excellent location on major intersection
- Less than five minutes by car from southwest commercial hub of the Island of Montréal
- Strong anchor tenants
- Ample parking

**TRADE AREA DEMOGRAPHICS**

0 -10 MINUTE DRIVE TIME

0 -20 MINUTE DRIVE TIME

2006 CENSUS

Total Population	100,605	643,540
Average Age	41.5	40.1
Total Households	45,180	294,415
Average Household Size	2.2	2.2
Households with Children	28,079	179,063
Average Household Income (\$)	\$49,847	\$59,373
Disposable Income per Household (\$)	\$31,085	\$35,527

**PROJECTIONS**

0 - 10 MINUTE DRIVE TIME

0 - 20 MINUTE DRIVE TIME

2012 PROJECTIONS

Total Population	107,531	661,703
Average Age	42.3	41.1
Total Households	49,859	318,236
Average Household Size	2.2	2.1
Households with Children	31,616	189,222
Average Household Income (\$)	\$50,886	\$56,648
Disposable Income per Household (\$)	\$32,728	\$35,651

**AREA MAP**



RUE EMIL-NELLIGAN

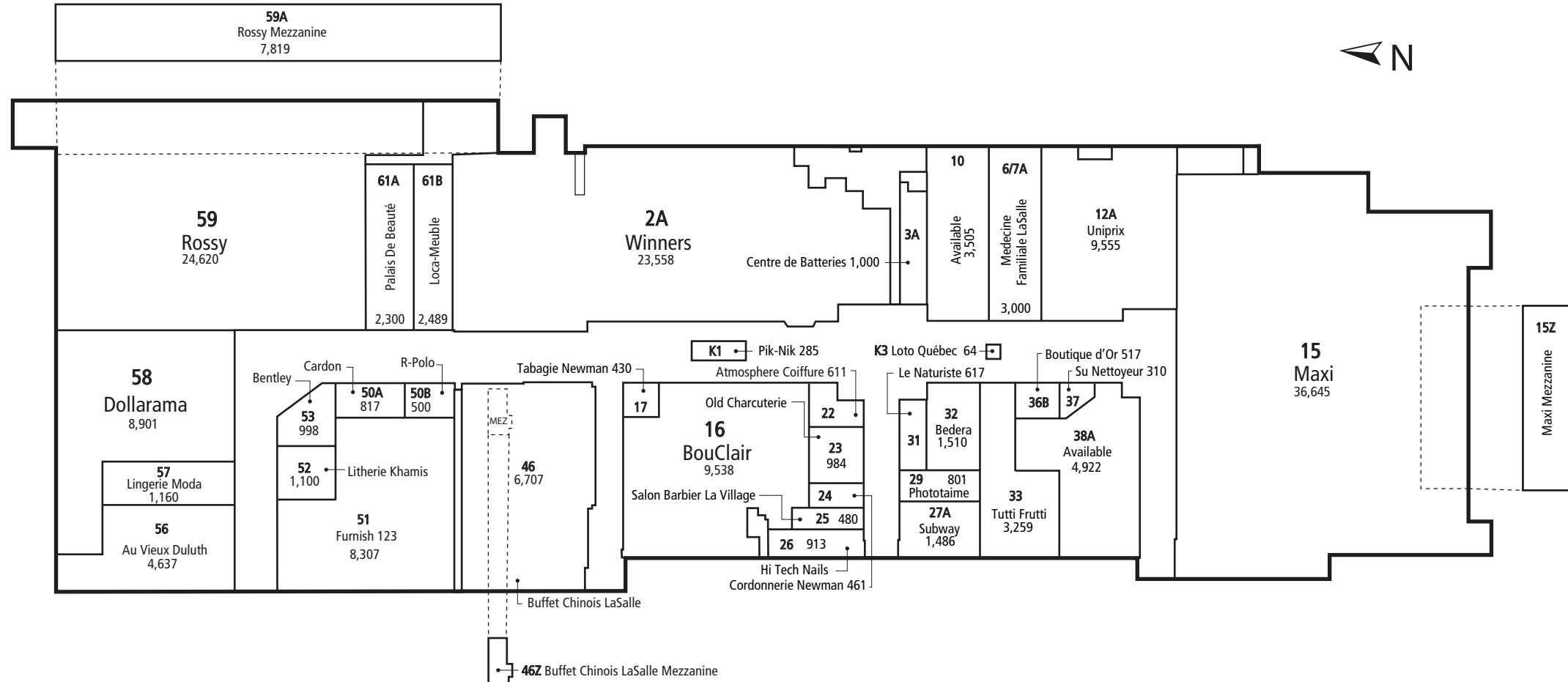

AVENUE DOLLARD

BOULEVARD NEWMAN

The purpose of this plan is to identify the approximate location of the Leased Premises in the Shopping Centre. Subject to the terms of the Lease, the landlord reserves the right at any time to relocate, rearrange, alter or expand any part of the Leased Premises from that shown on this plan. Any references on this plan to specific tenants are subject to change from time to time and shall not be deemed to be any representation as to the tenants that are within the Centre. 02/09