

Termination of Work No.1 (Railway) - Total length 22.032m
joining the Bathgate branch railway
Limit of Deviation of Work No. 1

Commencement of Work No.1F (Footbridge)

Centre Line of Work No.1A (Railway)

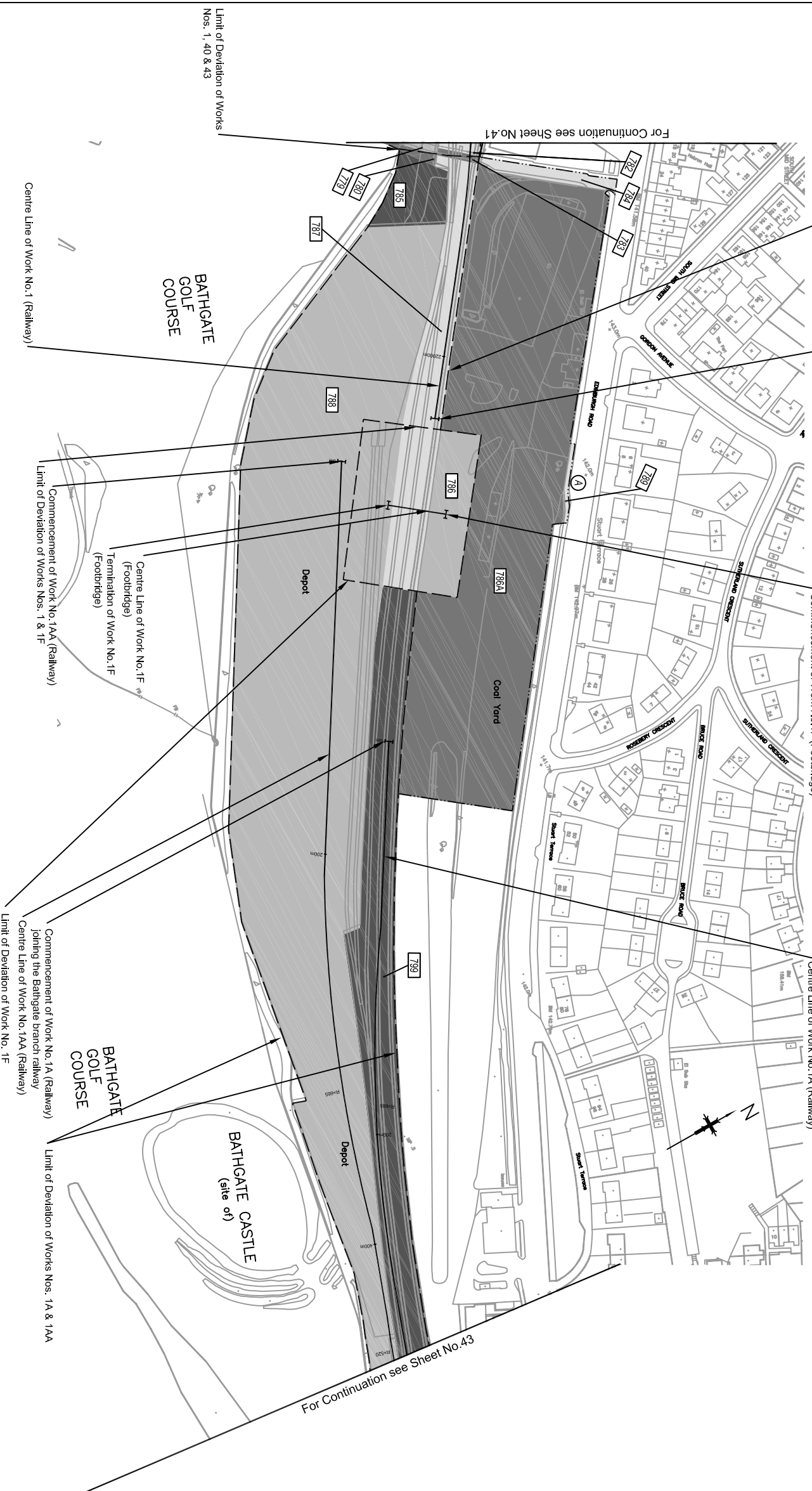

For Continuation see Sheet No.43

For Continuation see Sheet No.41

Limit of Deviation of Works Nos. 1, 40 & 43

Centre Line of Work No.1 (Railway)

Commencement of Work No.1AA (Railway)

Centre Line of Work No.1F (Footbridge)

Termination of Work No.1F (Footbridge)

Commencement of Work No.1A (Railway) joining the Bathgate branch railway

Centre Line of Work No.1AA (Railway)

Commencement of Work No.1A (Railway)

Limit of Deviation of Works Nos. 1A & 1AA

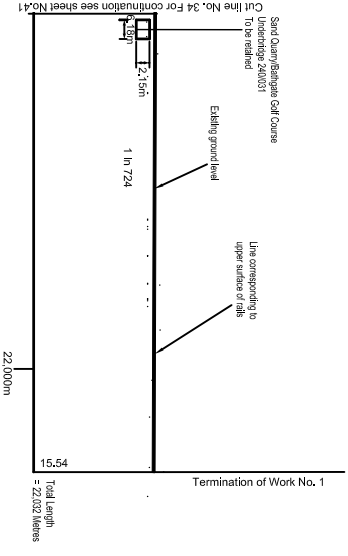

Termination of Work No. 1

Total Length 22.032 Metres

metres -50

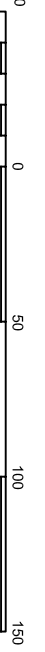

HORIZONTAL Scale for Plans and Sections 1:1250

metres -10



VERTICAL Scale 1:500

Section Work No. 1

SCOTTISH PARLIAMENT - SESSION 2

AIRDRIE - BATHGATE RAILWAY AND LINKED IMPROVEMENTS BILL

Work No. 1 (Railway)
Work No. 1A (Railway)
Work No. 1AA (Railway)
Work No. 1F (Footbridge)

For section of Work No.1A see Sheet 62
For section of Work No.1AA see Sheet 62
For section of Work No.1F see Sheet 63

PERMANENT ACQUISITION OF LAND INSIDE LIMITS OF DEVIATION:

| No. of Plan | Purpose for which land may be taken (See section 5) |
|---|---|
| 779, 780, 782, 783, 785, 786, 787, 788, 789 | For the authorised works |

PERMANENT ACQUISITION OF LAND OUTSIDE LIMITS OF DEVIATION:

| No. of Plan | Purpose for which land may be taken (See Part 1 of schedule 5) |
|-------------|--|
| 788A, 789 | Provision of station & car park |

ACQUISITION OF PERMANENT RIGHTS IN LAND OUTSIDE LIMITS OF DEVIATION:

| No. of Plan | Purpose for which land may be taken (See Part 2 of schedule 5) |
|-------------|--|
| 784 | Access for construction & thereafter for maintenance |

KEY:

- Centre Line of Work
- - - - - Limit of Deviation
- Limit of Land to be Acquired or Used
- Ⓐ Access to be Provided

Note:
The area enclosed by any limit of deviation or by any limit of land to be acquired or used is the area extending to the outer edge of the line marking those limits.

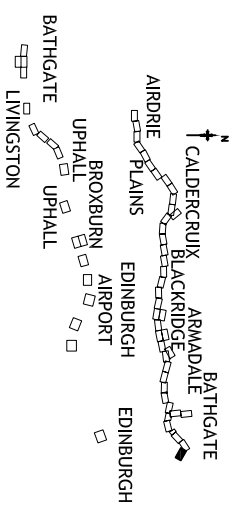

Based upon or including the 2005 Ordnance Survey 1:1250 map with the permission of the Controller of The Stationery Office.
©CROWN COPYRIGHT.
License No. 100020540.
Unauthorized reproduction infringes Crown Copyright and may lead to prosecution or civil proceedings.