

**NATIONAL REGISTER OF HISTORIC PLACES
INVENTORY - NOMINATION FORM**

(Type all entries - complete applicable sections)

STATE: New York	
COUNTY: New York	
FOR NPS USE ONLY	
ENTRY NUMBER	DATE
JUN 4 1973	

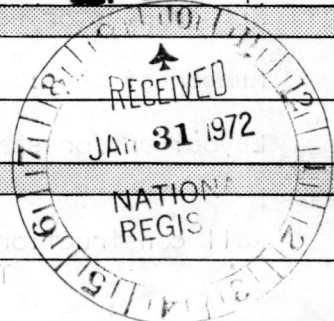

1. NAME

COMMON:
John Street Methodist Church

AND/OR HISTORIC:

2. LOCATION

STREET AND NUMBER:
44 John Street

CITY OR TOWN:
New York

STATE: New York CODE: 36 COUNTY: New York CODE: 061

3. CLASSIFICATION

CATEGORY (Check One)	OWNERSHIP	STATUS	ACCESSIBLE TO THE PUBLIC
<input type="checkbox"/> District <input checked="" type="checkbox"/> Building <input type="checkbox"/> Site <input type="checkbox"/> Structure <input type="checkbox"/> Object	<input type="checkbox"/> Public <input checked="" type="checkbox"/> Private <input type="checkbox"/> Both	<input checked="" type="checkbox"/> Occupied <input type="checkbox"/> Unoccupied <input type="checkbox"/> Preservation work in progress	Yes: <input type="checkbox"/> Restricted <input checked="" type="checkbox"/> Unrestricted <input type="checkbox"/> No
PRESENT USE (Check One or More as Appropriate)			
<input type="checkbox"/> Agricultural <input type="checkbox"/> Commercial <input checked="" type="checkbox"/> Educational <input type="checkbox"/> Entertainment	<input type="checkbox"/> Government <input type="checkbox"/> Industrial <input type="checkbox"/> Military <input type="checkbox"/> Museum	<input type="checkbox"/> Park <input type="checkbox"/> Private Residence <input checked="" type="checkbox"/> Religious <input type="checkbox"/> Scientific	<input type="checkbox"/> Transportation <input type="checkbox"/> Other (Specify) _____ _____

4. OWNER OF PROPERTY

OWNER'S NAME:
John Street Methodist Church

STREET AND NUMBER:
44 John Street

CITY OR TOWN: New York STATE: New York CODE: 36

5. LOCATION OF LEGAL DESCRIPTION

COURTHOUSE, REGISTRY OF DEEDS, ETC.:
New York County Hall of Records

STREET AND NUMBER:
31 Chambers Street

CITY OR TOWN: New York STATE: New York CODE: 36

6. REPRESENTATION IN EXISTING SURVEYS

TITLE OF SURVEY:
New York City Landmarks Preservation Commission

DATE OF SURVEY: Dec. 21, 1965 Federal State County Local

DEPOSITORY FOR SURVEY RECORDS:
New York City Landmarks Preservation Commission

STREET AND NUMBER:
305 Broadway

CITY OR TOWN: New York STATE: New York CODE: 36

SEE INSTRUCTIONS

STATE: New York
COUNTY: New York
ENTRY NUMBER: JUN 4 1973
DATE: _____
FOR NPS USE ONLY

7. DESCRIPTION

CONDITION	(Check One)					
	<input checked="" type="checkbox"/> Excellent	<input type="checkbox"/> Good	<input type="checkbox"/> Fair	<input type="checkbox"/> Deteriorated	<input type="checkbox"/> Ruins	<input type="checkbox"/> Unexposed
	(Check One)			(Check One)		
	<input type="checkbox"/> Altered	<input checked="" type="checkbox"/> Unaltered		<input type="checkbox"/> Moved	<input checked="" type="checkbox"/> Original Site	

DESCRIBE THE PRESENT AND ORIGINAL (if known) PHYSICAL APPEARANCE

Number of stories: The church is one story high with basement.

Number of bays: The John Street (north) facade is three bays wide.

Layout and/or shape of plan: The plan is basically rectangular with a semi-circular apse.

Wall construction: The north facade is brown-colored stuccoed brick. The remaining walls are brick.

Structural system: The structural system is masonry bearing wall.

Roof, cornice: On the north facade there is a pediment with a raking cornice and a closed lower cord surmounting a full entablature profiled at the ends.

Other notable features: There is a Palladian window placed directly above the broad main entrance door. Flanking the doorway are two elongated round-arched windows.

The pediment enframes a lunette window.

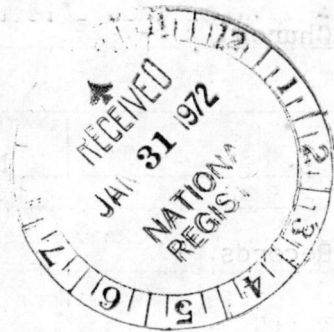

SEE INSTRUCTIONS

3. SIGNIFICANCE

PERIOD (Check One or More as Appropriate)

<input type="checkbox"/> Pre-Columbian	<input type="checkbox"/> 16th Century	<input type="checkbox"/> 18th Century	<input type="checkbox"/> 20th Century
<input type="checkbox"/> 15th Century	<input type="checkbox"/> 17th Century	<input checked="" type="checkbox"/> 19th Century	

SPECIFIC DATE(S) (If Applicable and Known) 1841

AREAS OF SIGNIFICANCE (Check One or More as Appropriate)

<input type="checkbox"/> Aboriginal	<input type="checkbox"/> Education	<input type="checkbox"/> Political	<input type="checkbox"/> Urban Planning
<input type="checkbox"/> Prehistoric	<input type="checkbox"/> Engineering	<input checked="" type="checkbox"/> Religion/Philosophy	<input type="checkbox"/> Other (Specify)
<input type="checkbox"/> Historic	<input type="checkbox"/> Industry	<input type="checkbox"/> Science	_____
<input type="checkbox"/> Agriculture	<input type="checkbox"/> Invention	<input type="checkbox"/> Sculpture	_____
<input checked="" type="checkbox"/> Architecture	<input type="checkbox"/> Landscape Architecture	<input type="checkbox"/> Social/Humanitarian	_____
<input type="checkbox"/> Art	<input type="checkbox"/> Literature	<input type="checkbox"/> Theater	_____
<input type="checkbox"/> Commerce	<input type="checkbox"/> Military	<input type="checkbox"/> Transportation	_____
<input type="checkbox"/> Communications	<input type="checkbox"/> Music		
<input type="checkbox"/> Conservation			

STATEMENT OF SIGNIFICANCE

The John Street Methodist Church is an example of the classical style applied to a small ecclesiastical building. Standing on the site of the earliest Methodist church in New York, the present structure is the product of the third rebuilding, accomplished in 1841. The Methodist Society in New York was founded by two disciples of John Wesley, who had immigrated to America. Their first building, a small one in the colonial style, was dedicated in 1768. A rebuilding of 1817-18 created a building from which many of the elements -- hand-hewn beams, curved stairways to the sanctuary, floorboards and pews -- were retained as part of the present church.

The John Street facade, crowned by a wide, low pediment with a lunette, is dominated by the great Palladian window above the entrance door frame. Two tall round-arched windows which flank the central bay are framed by plain frames carried on a corbeled sill. They are crowned by arches with keystones. At present, there are plans for a new building to the west which will be open at ground level, exposing the western wall of the church for the first time. This plan will require that the exposed wall be finished in a sympathetic manner, and it will provide a dramatic new view of the building.

Inside the church, in addition to the portions of its fabric which have survived from the earlier building, there are several reminders of its history. A large basement room serves as a gallery displaying prints, paintings and other objects including a large clock which was sent to the first congregation by John Wesley. A balcony in the nave was employed in the days before the Civil War as a way station on the Underground Railroad.

Doubly distinguished by its architecture and by its roots in colonial times, this church still stands, a notable structure in the City.

SEE INSTRUCTIONS



9. MAJOR BIBLIOGRAPHICAL REFERENCES

Files of the New York City Landmarks Preservation Commission.

10. GEOGRAPHICAL DATA

LATITUDE AND LONGITUDE COORDINATES DEFINING A RECTANGLE LOCATING THE PROPERTY			O R	LATITUDE AND LONGITUDE COORDINATES DEFINING THE CENTER POINT OF A PROPERTY OF LESS THAN TEN ACRES		
CORNER	LATITUDE	LONGITUDE		LATITUDE	LONGITUDE	
	Degrees Minutes Seconds	Degrees Minutes Seconds		Degrees Minutes Seconds	Degrees Minutes Seconds	
NW	° ' "	° ' "		40° 42' 34"	74° 00' 32"	
NE	° ' "	° ' "				
SE	° ' "	° ' "				
SW	° ' "	° ' "				

APPROXIMATE ACREAGE OF NOMINATED PROPERTY: under one acre

LIST ALL STATES AND COUNTIES FOR PROPERTIES OVERLAPPING STATE OR COUNTY BOUNDARIES

STATE:	CODE	COUNTY:	CODE

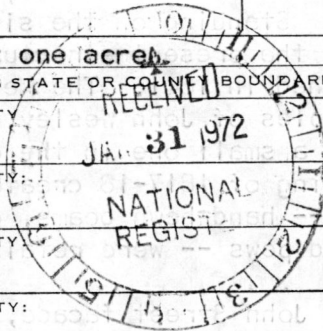

11. FORM PREPARED BY

NAME AND TITLE: Stephen S. Lash, Associate

ORGANIZATION: New York City Landmarks Preservation Commission DATE: Sept. 24, 1971

STREET AND NUMBER: 305 Broadway

CITY OR TOWN: New York STATE: New York CODE: 36

12. STATE LIAISON OFFICER CERTIFICATION **NATIONAL REGISTER VERIFICATION**

As the designated State Liaison Officer for the National Historic Preservation Act of 1966 (Public Law 89-665), I hereby nominate this property for inclusion in the National Register and certify that it has been evaluated according to the criteria and procedures set forth by the National Park Service. The recommended level of significance of this nomination is:

National State Local

Name: [Signature]

Title: Chairman, N.Y. State Historic Trust

Date: 04/72

I hereby certify that this property is included in the National Register.

[Signature]
Chief, Office of Archeology and Historic Preservation

Date: 6/4/73

ATTEST:

[Signature]
Keeper of The National Register

Date: 5/31/73

18/583 3740/45-06 720
4-19-72
DTM

SEE INSTRUCTIONS

The attached National Register Inventory-Nomination form is being returned to your office for clarification of the information indicated below.

- 1. Name. _____
- 2. Location. _____

- 3. Classification. _____
- 4. Owner of Property. _____
- 5. Location of Legal Description. _____
- 6. Representation in Existing Surveys. _____
- 7. Description. _____

- 8. Statement of Significance. _____

- 9. Bibliography. _____
- 10. Geographical Data.
 - a. Longitude and Latitude Coordinates: _____
 - b. Acreage. _____

- 11. Form Prepared By. _____
- 12. Certification. _____
- Photographic Coverage. PLEASE SEND A MORE RECENT PHOTO
(LESS THAN FIVE YEARS OLD).
- Map Coverage. _____
- Other. WE'LL PROCESS AS SOON AS POSSIBLE AFTER YOU
RETURN IT.

Clarification or correction of the above items must be made prior to the initiation of our professional review. Correction of these technical errors does not necessarily insure that the nomination will then satisfy National Register criteria in full.

THANKS-

Thank you for your attention to the above items checked.

SIGNED: Very D. Ryan

Ing N.Y. city

John Street Methodist Church
PROPERTY 7300/219 STATE NY

DATE OF RECEIPT 1/31/72 YES _____ NO _____

NUMBER _____ REGISTER: _____

DATA PAGE _____

PHOTO (S) _____

PHOTO DESCRIPTION (S) _____

MAP (S) _____

MAP DESCRIPTION (S) _____

LOGGED _____

ACKNOWLEDGE _____

RESUBMIT 4.26.73 2/1/72

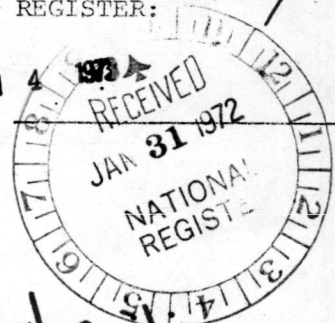

check OK 3/24/72 JB

REVIEW NEEDS MORE RECENT PHOTO. means 6/22/72 Sent recent photo OK cm

HISTORIAN send photo only 5 yrs. old - some improvement but not much Accept - Amf 5/4/73

ARCHEOLOGIST Accept KH 5/7/73

ARCHITECT Agree on photos unless they assure us there have been no changes - OK Chambers 7-21-72

ASST. KEEPER Accept 5-8-73

KEEPER OK 5/3/73 C.S. skull

WRITER/EDITOR O.K. for writeup Rowland 5/28/72

CHIEF, OAHP OK 5/31/73

EDITORIAL PROCESSING, EDITOR _____

Federal Registry Entry 8-7-73 Annual Edition Entry _____

LOGGED JUN 4 1973 CARD JUN 4 1973

COMMENTS: _____ WORKING NUMBER 1.31.72.171

CONGRESSIONAL DIST. Bella S. Abzug



NPS Number 6.4.73

Title: Joho St Methodist
Church

Loc. New York Co, N.Y.
Front facade

①

PROPERTY OF THE NATIONAL REGISTER



BROUN
GREEN
CO.

THIS CHURCH
WAS BUILT BY THE
METHODIST EPISCOPAL CHURCH
OF THE SOUTH IN 1856

LOFT
RENT
FLOORS
TO LET
NOYES

Fairish
Chop House
EST. 1856
SOUTH DOWN STREET

STOCK CERTIFICATES & BONDS

A-27

47661
73-10

Reproduced from the collections of the Library of Congress

NPS Number 6.4.73

Title: John St. Methodist
Church

Loc. New York Co., N.Y. (2)
North facade

PROPERTY OF THE NATIONAL REGISTER

NATIONAL REGISTER OF HISTORIC PLACES
PROPERTY MAP FORM

(Type all entries - attach to or enclose with map)

STATE New York	
COUNTY New York	
FOR NPS USE ONLY	
ENTRY NUMBER 4	DATE 1973

SEE INSTRUCTIONS

1. NAME

COMMON: John Street Methodist Church
AND/OR HISTORIC:

2. LOCATION

STREET AND NUMBER:

44 John Street

CITY OR TOWN:

New York

STATE:

New York

CODE

36

COUNTY:

New York

CODE

061

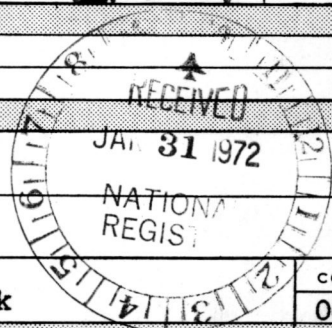

3. MAP REFERENCE

SOURCE:

USGS Quadrangle 7.5 minute series Jersey City, N.J.- N.Y.

SCALE: 1:24000

DATE: 1967

4. REQUIREMENTS

TO BE INCLUDED ON ALL MAPS

1. Property boundaries where required.
2. North arrow.
3. Latitude and longitude reference.

7H0030678

John Street Methodist Church.

JERSEY CITY QUADRANGLE

NEW JERSEY - NEW YORK

7.5 MINUTE SERIES (TOPOGRAPHIC)

GEORGE WASHINGTON BRIDGE 8 MI.

6285 IV SW
CENTRAL PARK



(INT. 495) 2 MI.

2'30" 581

582

2 180 000 FEET (N. J.) 583

9

584

74°00'

40°45'

RECEIVED
TUNNEL
JAN 81
NATIONAL REGISTER

690 000 FEET
(N. J.)

42'30"

MANHATTAN BRIDGE 0.3 MI.
NS HEADQUARTERS 4 MI. N

UNITED STATES
DEPARTMENT OF THE INTERIOR
GEOLOGICAL SURVEY

JOHN S. BENTLEY, METROLOGIST, C. HOUSTON, PHOTOGRAPHER
PHO 3 0678
JERSEY CITY QUADRANGLE
NEW JERSEY-NEW YORK
7.5 MINUTE SERIES (TOPOGRAPHIC)
GEORGE WASHINGTON BRIDGE 8 MI.

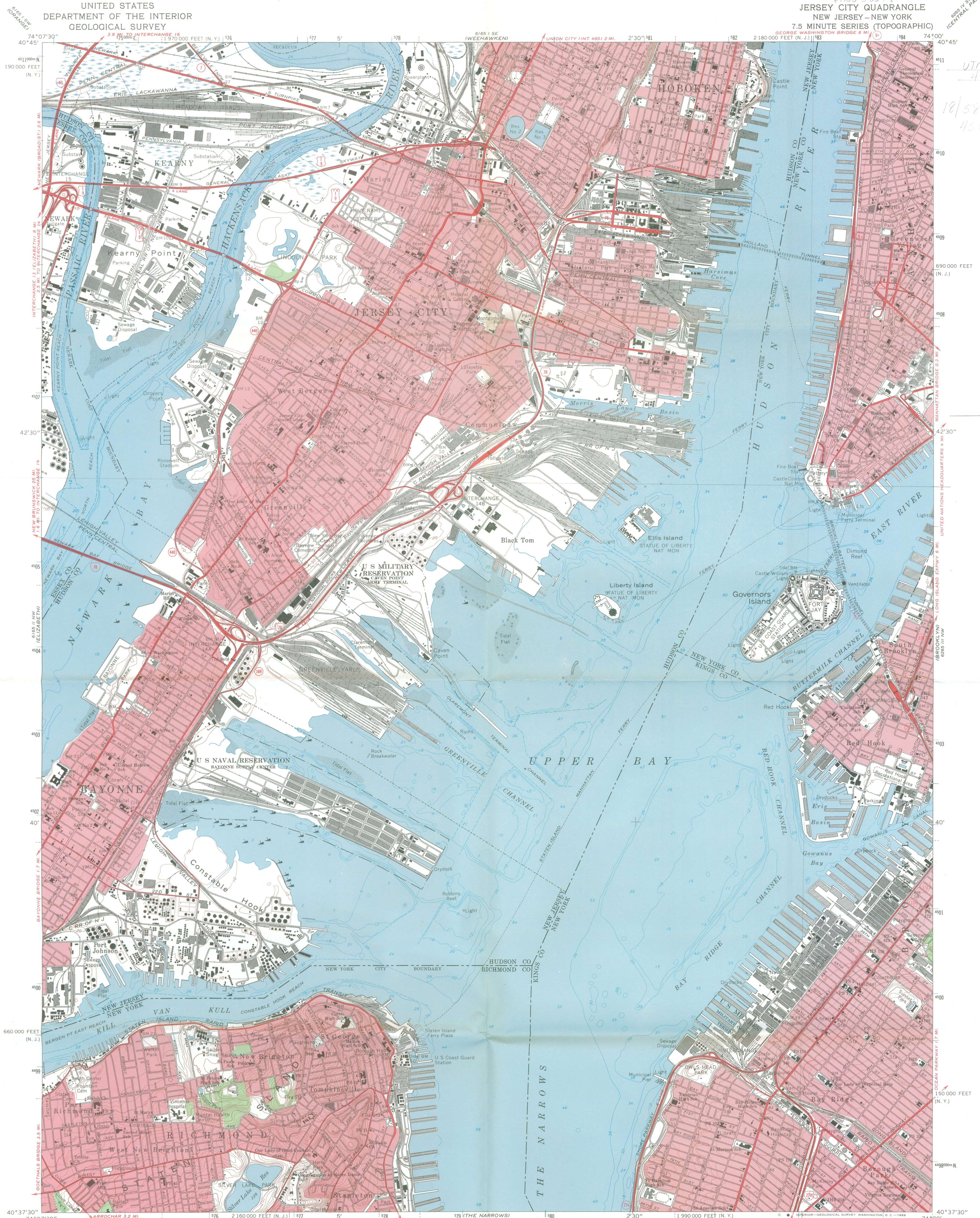

UTM 72T un
41576
181583140
4803720

Mapped, edited, and published by the Geological Survey
Revised in cooperation with New York Department of Transportation
Control by USGS, USC&GS, USCE, New Jersey Geodetic Survey,
and City of New York Board of Estimate and Apportionment
Planimetry by photogrammetric methods and from USC&GS
Charts T-5111, T-5277, T-5332, T-5450, T-5453, T-5454,
T-5460, T-5461, T-5466, T-5468, T-5469, and T-5470
Topography by photogrammetric methods from aerial
photographs taken 1954 and planetable surveys 1955
Revised from aerial photographs taken 1966. Field checked 1967
Selected hydrographic data compiled from USC&GS Charts 285, 287, 541,
and 745 (1966). This information is not intended for navigational purposes
Polyconic projection, 1927 North American datum, 10,000-foot grids based on
New Jersey coordinate system, and New York coordinate system, Long Island zone
1000-meter Universal Transverse Mercator grid ticks, zone 18, shown in blue
Red tint indicates areas in which only landmark buildings are shown

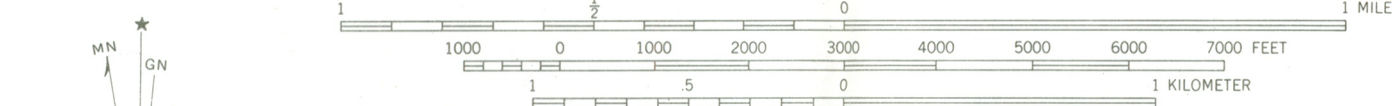

CONTOUR INTERVAL 10 FEET
DATUM IS MEAN SEA LEVEL
DEPTH CURVES AND SOUNDINGS IN FEET—DATUM IS MEAN LOW WATER
SHORELINE SHOWN REPRESENTS THE APPROXIMATE LINE OF MEAN HIGH WATER
THE MEAN RANGE OF TIDE IS APPROXIMATELY 4.4 FEET IN
UPPER BAY AND 4.8 FEET IN NEWARK BAY

THIS MAP COMPLIES WITH NATIONAL MAP ACCURACY STANDARDS
FOR SALE BY U.S. GEOLOGICAL SURVEY, WASHINGTON, D.C. 20242
A FOLDER DESCRIBING TOPOGRAPHIC MAPS AND SYMBOLS IS AVAILABLE ON REQUEST

ROAD CLASSIFICATION
Heavy-duty ——— Light-duty ———
Unimproved dirt - - - - -
Interstate Route U.S. Route State Route

JERSEY CITY, N. J.—N. Y.
N4037.5—W7400/7.5

1967

AMS 6165 II NE—SERIES V822



NEW YORK STATE PARKS & RECREATION

• South Swan Street Building, South Mall, Albany, N.Y. 12223

Alexander Aldrich
Commissioner

April 12, 1973

Mr. Jerry Rogers
National Register of Historic Places
Department of the Interior
National Park Service
Washington, D. C. 20240

Dear Mr. Rogers:

I am returning herewith the National Register form for the John St. Methodist Church in New York County, New York. Enclosed please find a more recent photograph than the one originally submitted which is also enclosed.

Thank you for your assistance.

Sincerely yours,

Lynn Beebe Weaver
Research Assistant
Division for Historic
Preservation

LBW/djf



ENTRIES IN THE NATIONAL REGISTER

STATE NEW YORK

Date Entered JUN 4 1973

<u>Name</u>	<u>Location</u>
Lowertown Historic District	Lockport Niagara County
Haskell House	New Windsor vicinity Orange County
Steinheim (Allen) Museum	Alfred Allegany County
Church of the Holy Cross	Troy Rensselaer County
Phelps Mansion	Binghamton Broome County
John Street Methodist Church	New York New York County
Church of the Transfiguration	New York New York County

Hon. Howard W. Robison
Hon. Charles Rangel
Hon. John Murphy

Also Notified

Hon. Jacob K. Javits
Hon. James L. Buckley
Hon. Henry P. Smith
Hon. Benjamin Gilman
Hon. James F. Hastings
Hon. Carlton J. King

State Historic Preservation Officer
Mr. Alexander Aldrich, Commissioner
Parks and Recreation
Room 303, South Swan Street
Building
Albany, New York 12223

Director, Northeast Region

PHR NRowland: pcl 6/12/73