

(19) World Intellectual Property Organization
International Bureau



(43) International Publication Date
10 January 2008 (10.01.2008)

PCT

(10) International Publication Number
WO 2008/006120 A2

- (51) International Patent Classification:
F25D 25/00 (2006.01) F25D 3/08 (2006.01)
- (21) International Application Number:
PCT/US2007/077747
- (22) International Filing Date:
6 September 2007 (06.09.2007)
- (25) Filing Language: English
- (26) Publication Language: English
- (30) Priority Data:
60/818,518 6 July 2006 (06.07.2006) US
- (71) Applicant and
(72) Inventor: JOHNSON, Mark A. [US/US]; 33 Broadway,
Chula Vista, California 91915 (US).
- (74) Agent: BABIN, Jane K.; c/o Intellevate, P.O. Box 52050,
Minneapolis, MN 55402 (US).
- (81) Designated States (unless otherwise indicated, for every
kind of national protection available): AE, AG, AL, AM,
AT, AU, AZ, BA, BB, BG, BH, BR, BW, BY, BZ, CA, CH,
CN, CO, CR, CU, CZ, DE, DK, DM, DO, DZ, EC, EE, EG,

ES, FI, GB, GD, GE, GH, GM, GT, HN, HR, HU, ID, IL,
IN, IS, JP, KE, KG, KM, KN, KP, KR, KZ, LA, LC, LK,
LR, LS, LT, LU, LY, MA, MD, ME, MG, MK, MN, MW,
MX, MY, MZ, NA, NG, NI, NO, NZ, OM, PG, PH, PL,
PT, RO, RS, RU, SC, SD, SE, SG, SK, SL, SM, SV, SY,
TJ, TM, TN, TR, TT, TZ, UA, UG, US, UZ, VC, VN, ZA,
ZM, ZW.

- (84) Designated States (unless otherwise indicated, for every
kind of regional protection available): ARIPO (BW, GH,
GM, KE, LS, MW, MZ, NA, SD, SL, SZ, TZ, UG, ZM,
ZW), Eurasian (AM, AZ, BY, KG, KZ, MD, RU, TJ, TM),
European (AT, BE, BG, CH, CY, CZ, DE, DK, EE, ES, FI,
FR, GB, GR, HU, IE, IS, IT, LT, LU, LV, MC, MT, NL, PL,
PT, RO, SE, SI, SK, TR), OAPI (BF, BJ, CF, CG, CI, CM,
GA, GN, GQ, GW, ML, MR, NE, SN, TD, TG).

Declarations under Rule 4.17:

- as to applicant's entitlement to apply for and be granted a
patent (Rule 4.17(ii))
- as to the applicant's entitlement to claim the priority of the
earlier application (Rule 4.17(iii))

[Continued on next page]

(54) Title: PORTABLE COOLER

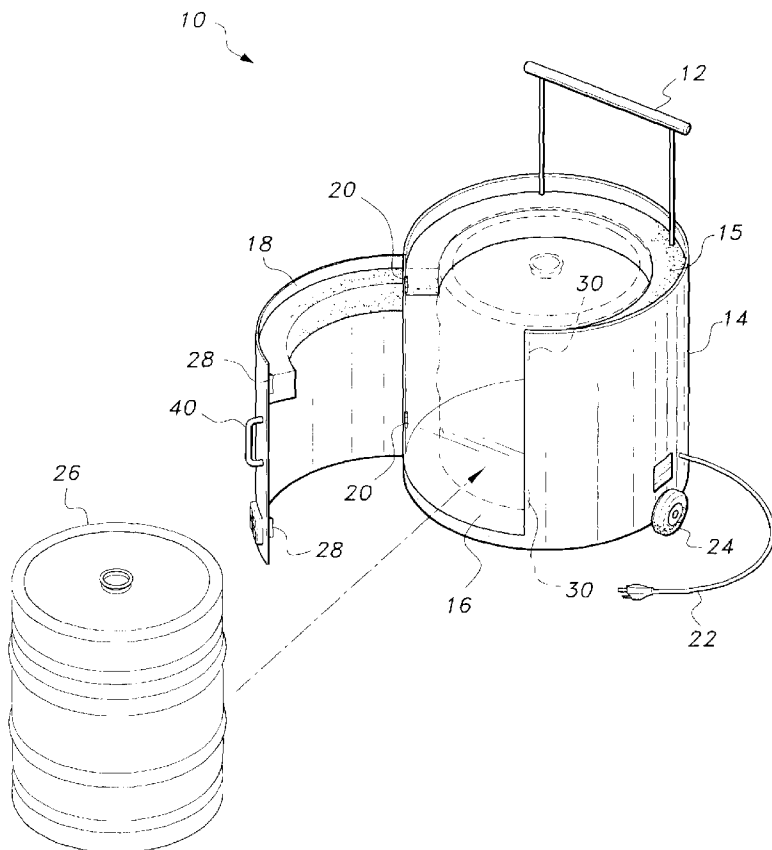

(57) Abstract: The portable cooler is a portable refrigeration system for selectively and adjustably cooling a removable container, such as a beer keg, for example. The portable cooler includes a housing that defines an open interior region for removably receiving the keg. A door is pivotally mounted to the housing, providing the user with selective access to the open interior region. A refrigeration device is mounted within the housing, adjacent the container, and may be powered by an external power supply or by rechargeable batteries, also received within the housing. Wheels are pivotally mounted to a lower end of the housing, and a handle is mounted to an upper end of the housing, allowing the user to selectively transport the housing and keg.

WO 2008/006120 A2



Published:

- *without international search report and to be republished upon receipt of that report*
- *the filing date of the international application is within two months from the date of expiration of the priority period*

For two-letter codes and other abbreviations, refer to the "Guidance Notes on Codes and Abbreviations" appearing at the beginning of each regular issue of the PCT Gazette.

5

Description

PORTABLE COOLER

RELATED APPLICATIONS

[1] This application claims the benefit of priority to U.S. provisional application No. 60/818,518, filed July 6, 2006, the contents of which is incorporated herein by reference in its entirety.

BACKGROUND OF THE INVENTION

Field of the Invention

[2] The present invention relates to a portable cooler, which is a portable refrigeration system for selectively and adjustably cooling and transporting a removable container, such as a beer keg, for example.

Background

[3] Large beverage containers, such as beer kegs and the like, require either large-scale or specially adapted refrigeration units. Such units are typically mounted within bars or restaurants, such that the container may be placed in the refrigeration unit and tapped to dispense the cooled beverage to the patrons. Such refrigeration units, however, are typically permanently mounted within the bar or counter of the bar or restaurant, thus allowing for efficient cooling of the beverage to take place only in the bar or restaurant.

5 **[4]** Users may desire to cool a beverage container, such as the exemplary beer
keg, in a remote location, and not a bar, restaurant or other food and drink
service establishment. Though a beer keg or the like may be mounted on a
dolly or other transportation device to transport the keg to the remote
location, the specialized refrigeration unit cannot be transported along with
10 the container because it is heavy and difficult to maneuver.

SUMMARY OF THE INVENTION

15 **[5]** The portable cooler is a portable refrigeration system for selectively and
adjustably cooling a removable container, such as a beer keg or a
carbonated beverage system, for example. The portable cooler includes a
housing, which defines an open interior region therein for removably
receiving the container. The housing can be made of any suitable material,
including plastic, steel, aluminum or the like, and may be insulated to
prevent refrigeration loss from or heat transfer into the interior region. An
opening is formed through a front face of the housing, and a door or pair of
20 doors is pivotally mounted to the housing, providing the user with selective
access to the open interior region. The door or doors selectively covers and
seals the opening formed through the front face of the housing, and may
include latches or the like, for selectively and releasably locking the door to
the housing. Further, a door handle may be mounted to the door, providing
25 the user with a gripping device for easily opening and closing the door. In
one embodiment, the housing includes an open upper portion, allowing the
keg, or other container, to project upwardly therethrough.

[6] A refrigeration device is mounted within the housing, adjacent the
container, and may be powered by an external power supply or by

5 rechargeable batteries, also received within the housing. In certain
embodiments, the cooler includes means for is electrically connecting the
refrigeration device to a motor vehicle cigarette lighter. In other
embodiments, the refrigeration device can be electrically connected
through a suitable means to a solar power unit which may contain a solar
10 cell or photovoltaic panel and a power storage block.

[7] In one aspect of the invention, the refrigeration device is a compact unit
scaled to cool the beverage container. The refrigeration device may
include refrigeration coils, a compressor and other conventional
refrigeration elements. A control panel may be mounted on the housing,
15 with the control panel being in communication with the refrigeration
device, allowing the user to selectively and adjustably control the
temperature within the housing.

[8] A plurality of wheels are pivotally mounted to a lower end of the housing,
and a handle is mounted to an upper end of the housing, allowing the user
20 to selectively transport the housing and container in a controlled manner.
The handle is preferably retractable within the housing. In certain
embodiments, a second, optionally retractable handle is mounted to a lower
end of the housing to facilitate lifting the portable cooler using two hands
or by two persons. In one aspect of the invention, the first and second
25 handles are mounted to the rear of the housing. Further, a support stand
may be pivotally mounted to a rear face of the housing, allowing the
housing to be supported at an angle with respect to a support surface, such
as the floor or the ground.

[9] These and other features of the present invention will become readily

5 apparent upon further review of the following specification and drawings.

BRIEF DESCRIPTION OF THE DRAWINGS

- [10] **FIG. 1** is an environmental, perspective view of a portable cooler according to the present invention.
- 10 [11] **FIG. 2** is a front view of the portable cooler according to the present invention.
- [12] **FIG. 3** is a side view of the portable cooler according to the present invention.
- [13] **FIG. 4** is a rear view of the portable cooler according to the present
15 invention.
- [14] **FIG. 5** is a side, partial cut-away view of the portable cooler according to the present invention.
- [15] **FIG. 6** is an environmental, perspective view of an alternative embodiment of the portable cooler according to the present invention.
- 20 [16] **FIGS. 7A-F** show various views of an alternative embodiment a portable cooler according to the present invention. **FIG. 7A** is a front view of the alternative embodiment the portable cooler. **FIG. 7B** is a top view of the portable cooler viewed from the front. **FIG. 7C** is a side view of the alternative embodiment the portable cooler. **FIG. 7D** is a top view of the
25 portable cooler viewed from the side. **FIG. 7E** is a rear view of the

5 alternative embodiment the portable cooler. **FIG. 7F** is a top view from the portable cooler viewed from the rear.

[17] Similar reference characters denote corresponding features consistently throughout the attached drawings.

10

DETAILED DESCRIPTION OF THE INVENTION

[18] The present invention is a portable cooler **10**. The portable cooler **10** is a portable refrigeration system for selectively and adjustably cooling a removable container, such as a beer keg, for example. It should be understood that the portable cooler **10** may be utilized for the cooling and transportation of any container received therein, and that the beer keg **26**,
15 illustrated in **FIG. 1**, and the carbonated beverage system illustrated in **FIG. 6** are for exemplary purposes only. Further, the portable cooler **10** may be sized, contoured and constructed from materials dependent upon the needs and desires of the user, and further dependent upon the size,
20 contour and nature of container being stored and transported within cooler **10**.

[19] As shown in **FIGS. 1-7**, the portable cooler **10** includes a housing **14** that defines an open interior region **16** therein, for removably receiving the keg **26**, carbonated beverage system **60**, or any other suitable container. In one
25 embodiment, housing **14** has a substantially cylindrical contour, however, as described above, housing **14** may be sized, contoured and constructed from suitable materials dependent upon the needs and desires of the user.

- 5 **[20]** In one aspect of the invention, housing **14** is constructed from steel, particularly stainless steel. In another aspect of the invention, housing **14** is constructed from aluminium, any other suitable metal, mixtures or alloys thereof. The metal may be anodized, galvanized, coated or treated in a manner suitable to protect the surfaces thereof. In certain embodiments, housing **14** may have a single wall construction. In other embodiments, double or triple wall construction may be used.
- 10
- [21]** As illustrated in **FIG. 6**, the invention further contemplates that housing **14** may be insulated, such as by wrapping, coating or encasing it in an insulating material **11**, as shown in **Fig. 6**. The insulating material can be any material suitable for preventing heat transfer to the housing and/or preventing refrigeration loss. Suitable insulating materials according to the present invention include but are not limited to urethanes, polystyrenes, polyesters, epoxies, and natural or synthetic rubbers, which may for example, be foamed, expanded or extruded.
- 15
- [22]** In certain embodiments, housing **14** comprises plastic. The entire housing **14** may be made of plastic or similar material, for example in a molded, extruded or fabricated form. In other embodiments, housing **14** may comprise multiple layers, such as an inner layer of steel or other metal, with or without an insulating layer, which is encased or coated in plastic, rubber or other resilient material. According to certain non-limiting aspects of this embodiment, the coating may serve the purpose of protecting or enclosing the inner and/or insulating layers. In other aspects the coating can be decorative and/or provide a surface on which brand information and/or instructions can be applied. Furthermore, the outer layer, where used, may be textured to provide slip resistance to facilitate handling.
- 20
- 25
- 30

5 [23] As shown, the housing **14** may have an open upper portion, allowing the
keg **26** or other container to project upwardly therethrough when the keg **26**
is received within the housing **14**. Alternatively, housing **14** may include a
closed upper portion **28**, allowing for complete coverage of the keg **26**.
The contouring and configuration of the housing **14** are dependent upon the
10 needs and desires of the user. This skilled artisan will appreciate that the
size of any opening in housing **14** may be adapted as required to
accommodate the keg **26**, carbonated beverage system **60**, other container
or any fittings thereon. In certain aspects of the invention, the housing may
be fitted with a tap **70** as illustrated in **FIGS. 7A-7F**, nozzle, dispensing
15 gun or other device for connecting to the keg **26**, carbonated beverage
system **70** or other container to conveniently dispense a beverage contained
therein.

[24] An opening is formed through a front face of the housing **14**, providing
access to the open interior region **16**, and a door **18** is pivotally mounted to
20 the housing **14**. Door **18** is preferably secured to housing **14** by hinges **20**,
or by any other suitable means for pivotal attachment. Door **18** provides
the user with selective access to the open interior region **16**. The door **18**
selectively covers and seals the opening formed through the front face of
the housing **14**, and may include latches **28** or the like, for selectively and
25 releasably locking the door **18** to the housing **14**. In certain embodiments,
a set of double doors **19** may be used in place of a single door, each
independently hinged and independently operable. The invention
contemplates that double doors may allow partial access to the keg **26**,
carbonated beverage system **60** or other container, while minimizing
30 exposure to the exterior environment.

- 5 [25] In the exemplary embodiments illustrated in the Figures, latches **28** engage corresponding recesses **30**, formed in the outer surface of housing **14**, however, it should be understood that any suitable means for releasably securing and locking door **18** may be utilized. As shown, an annular thermal seal **15** may be secured to the upper edges of both the door **18** and
10 the housing **14**. Annular seal **15** may be formed from rubber or any other suitable flexible and thermally insulative material. Seal **15** further acts to support and secure keg **26**, when the keg **26** is received within housing **14**.
- [26] As best shown in **FIG. 2**, a door handle **40** may be mounted to the door **18**, providing the user with a gripping device for easily opening and closing the
15 door **18**. Further, a control panel **42** may be mounted to door **18**, as shown, providing the user with selective control over the temperature and operation of the refrigeration system (to be described in greater detail below). Control panel **42** may alternatively be mounted to any suitable portion of housing **14**.
- 20 [27] As shown in **FIG. 5**, a refrigeration system is mounted within the housing **14**, adjacent the keg **26**, for selective and controlled cooling thereof. The refrigeration system may be powered by an external power source, such as a standard household AC electrical source, via power cord **22** (shown in **FIG. 1**), or may alternately be powered by batteries **50**, which may be
25 rechargeable, also received within the housing **14**. In one embodiment, the refrigeration system may be adapted to run on a gasoline, diesel or other engine, such as a portable generator or a motor vehicle engine. Conveniently, power cord **22** may be adapted to include a plug **21** that is sized and shaped to be received in a cigarette lighter receptacle of the
30 motor vehicle to electrically connect the refrigeration system to a power

5 source of the motor vehicle via the cigarette lighter receptacle as shown in the alternative embodiment illustrated in **FIG.6**.

[28] In yet another embodiment of the invention, the refrigeration system is electrically connected to a solar power unit, which may be a portable solar powered unit. The solar power unit will typically comprise at least one solar cell or photovoltaic panel which receives light from an external source such as the sun. The electrical power generated by the one or more solar cells is provided to a power storage block, which may include one or more batteries or other power storage device(s). A controller and/or inverter block may be coupled to the power storage block. The controller and/or inverter block may include an inverter to convert the power received from the power storage block to an appropriate power signal for the refrigeration unit. Optionally, the photovoltaic units may be selectively positionable at a plurality of angles in order to optimally receive sunlight. In one embodiment, the solar powered unit or photovoltaic panel thereof, is adapted for mounting on the roof of a motor vehicle. According to this embodiment, the positioning of the photovoltaic panels may be optionally adjustable by any suitable means, such as mechanical, hydraulic, electronic or the like. In another aspect of this embodiment, the photovoltaic panels are mounted in a fixed position, but can be positioned to receive sunlight by manually moving the photovoltaic unit itself or, e.g., moving the motor vehicle upon which the photovoltaic panels are mounted.

[29] The refrigeration system may be a conventional refrigeration system, including one or more refrigeration coils **52** in communication with a compressor motor **54**, or the like. As used herein, terms “refrigeration system” and “refrigeration device” are interchangeable. It should be

5 understood that refrigeration coils **52** and compressor motor **54** are shown for exemplary purposes only, and that any suitable user-controllable and actuatable refrigeration system may be utilized. In certain embodiments, the refrigeration system is a compact and/or lightweight unit suitably sized to fit within or about the housing **14**, including but not limited to high
10 efficiency refrigeration systems. Optionally, one or more components of the refrigeration system (e.g., the refrigeration coils **52**) may be mounted on the exterior of the cooler. As noted above, control panel **42** is mounted on the housing **14**, with the control panel **42** being in communication with the refrigeration system, allowing the user to selectively and adjustably
15 control the temperature within the housing **14**.

[30] A plurality of wheels **24** are pivotally mounted to a lower end of the housing **14**, allowing the housing **14** to be transported to any desired location. Though shown as having two such wheels **24** in the **Figures**, it should be understood that this is for exemplary purposes only, and any
20 desired number of wheels may be pivotally mounted to the lower end of housing **14**. Additionally, a handle **12** is mounted to an upper end of the housing **14**, providing the user with a grip for the transport of the housing **14** and container **26** in a controlled manner. The handle **12** is preferably retractable within the housing **14**, and is positioned in the vertical direction
25 (as indicated by the directional arrow in **FIG. 5**). As best shown in **FIG. 2**, handle **12** preferably includes a pair of side supports **36**, and a central gripping member **34**. In certain embodiments, a second, optionally retractable handle is mounted to a lower end of the housing to facilitate lifting the portable cooler using two hands or by two persons. In one aspect
30 of the invention, the first and second handles are mounted to the rear of the

5 housing. In certain embodiments, the lower handle may also serve as a
foot-actuated titling device for titling the cooler **10** relative to the support
surface during transport. The skilled artisan will appreciate that certain
embodiments of the cooler may more easily wheeled in a tilted position
similar to the operation of a hand truck. In certain other embodiments, the
10 cooler may have a separate foot-actuated titling means attached to the
lower portion of the cooler **10**, such as on the rear face or bottom of the
housing **14**, below handle **12** and positioned at a height suitable for titling
the cooler using foot action while grasping handle **12**.

[31] Further, as shown in **FIGS. 3** and **4**, a support stand **44** may be pivotally
15 mounted to a rear face of the housing **14**, allowing the housing **14** to be
supported at an angle with respect to a support surface, such as the floor or
the ground. Support stand **44** may include a pair of side support members
46 that support a crossbar **48**. A proximal end of each side support member
46 can be pivotally joined to the rear face of housing **14**, by hinges or the
20 like, with the distal ends of side support members **46** being secured to
opposite ends of crossbar **48**. Additionally, a pair of upper supports **13**
may be mounted to the rear face of housing **14**, allowing the cooler **10** to be
positioned horizontally on a support surface, such as the ground or floor.
Supports **13** cooperate with support stand **44** which, in its deployed
25 position, allows for either the horizontal or angled positioning of the cooler
10 with respect to the horizontal. Alternatively, wheels **24** may be
positioned towards the rear of housing **14**, allowing supports **13** to act
cooperatively with the wheels **24** for the horizontal positioning of the
cooler **10**.

30 [32] In use, the user releases latches **28** and opens door **18** or doors **19** to

5 provide access to the open interior region **16**. A keg **26** or other suitable container is received within the open interior region **16** and the user closes door **18** and re-secures latches **28**, to secure the keg **26** within housing **14**. Housing **14** may be formed, at least partially, from a thermally insulating material. The user may input a desired temperature or other operational
10 parameters into control panel **42**, for the controlled and selective actuation of the refrigeration system.

[33] The user may further deploy handle **12** and, used in combination with wheels **24**, transport the housing **14** and keg **26** to a desired location. Support stand **44** may further be deployed if the user wishes to support the
15 housing **14** at an angle with respect to the support surface. The handle **12** and support stand **44** may both be selectively retracted for storage of the portable cooler **10**.

[34] In one embodiment of the invention, the portable cooler may be adapted for carbonated drink dispensing. According to this embodiment, as shown in
20 **FIG. 6**, interior region **16** is sized to receive the components of a carbonated beverage system **60**, such as a soft drink mixing and/or dispensing system. The system may comprise one or more of a pressurized CO₂ cylinder **62**, a carbonating vessel **64**, syrup reservoir **66**, and dispensing port **61**, which may be connected through a series of tubes **68**.
25 Flow through the system may be delivered via one or more in-line mechanical pumps. Optionally, the system may include a trigger-operated delivery gun, which may be adapted to dispense one of several available beverage flavors from a plurality of syrup reservoirs. In certain aspects of the invention, the CO₂ cylinder component of the carbonated beverage
30 system may be located on the exterior of housing **14** in a compartment **72**

5 adapted to removably receive and secure the cylinder. According to this embodiment, communication between the CO₂ cylinder and the interior of the compartment may provided by an opening in the housing **14**.

[35] It is to be understood that the present invention is not limited to the embodiments described above, but encompasses any and all embodiments
10 within the scope of the following claims

CLAIMS

[1] What is claimed is:

1. A portable cooler, comprising:

a housing having an opening formed through a front face thereof, said

5 housing defining an open interior region adapted for removably receiving a container;

a door pivotally mounted to said housing, said door selectively sealing and covering the opening formed through the front face of said housing;

10 a refrigeration device received within said housing for selectively and adjustably cooling the container;

a plurality of wheels being pivotally mounted to a lower end of said housing; and,

15 a handle being mounted to an upper end of said housing, whereby the container is received within the open interior region of the housing for selective and adjustable cooling and selective transport thereof.

2. The portable cooler as recited in claim 1, further comprising a support stand mounted to a rear face of said housing.

20 3. The portable cooler as recited in claim 1, further comprising means for selectively and releasably locking said door to said housing.

4. The portable cooler as recited in claim 1, wherein the container is a beer keg or a carbonated beverage system.

25

5. The portable cooler as recited in claim 1, wherein the housing

comprises plastic, steel or aluminum.

6. The portable cooler as recited in claim 1, further comprising means for electrically connecting the refrigeration device to a motor vehicle cigarette lighter.

7. The portable cooler as recited in claim 1, further comprising means for electrically connecting the refrigeration device to a solar power unit.

8. The portable cooler as recited in claim 7, wherein the solar power unit comprises at least one solar cell or photovoltaic panel and a power storage block.

9. The portable cooler as recited in claim 1, further comprising a battery electrically connected to the refrigeration device.

10. The portable cooler as recited in claim 1, wherein the housing is insulated.

11. A portable cooler, comprising:
a housing having an opening formed through a front face thereof, said housing defining an open interior region adapted for removably receiving a container;
a pair of doors, each pivotally mounted to said housing, said pair of doors selectively sealing

and covering the opening formed through the front face of said housing;
a refrigeration device received within said housing for selectively and
adjustably cooling the container;

a plurality of wheels being pivotally mounted to a lower end of said
housing; and,

a handle being mounted to an upper end of said housing, whereby the
container is received within the open interior region of the housing for
selective and adjustable cooling and selective transport thereof.

12. The portable cooler as recited in claim 11, further comprising a
support stand mounted to a rear face of said housing.

13. The portable cooler as recited in claim 11, further comprising
means for selectively and releasably locking said door to said housing.

14. The portable cooler as recited in claim 11, wherein the container is
a beer keg or a carbonated beverage system.

15. The portable cooler as recited in claim 11, wherein the housing
comprises plastic, steel or aluminum.

16. The portable cooler as recited in claim 11, further comprising
means for electrically connecting the refrigeration device to a motor
vehicle cigarette lighter.

17. The portable cooler as recited in claim 11, further comprising

means for electrically connecting the refrigeration device to a solar power unit.

5 18. The portable cooler as recited in claim 12, wherein the solar power unit comprises at least one solar cell or photovoltaic panel and a power storage block.

10 19. The portable cooler as recited in claim 11, further comprising a battery electrically connected to the refrigeration device.

20. The portable cooler as recited in claim 11, wherein the housing is insulated.

1/7

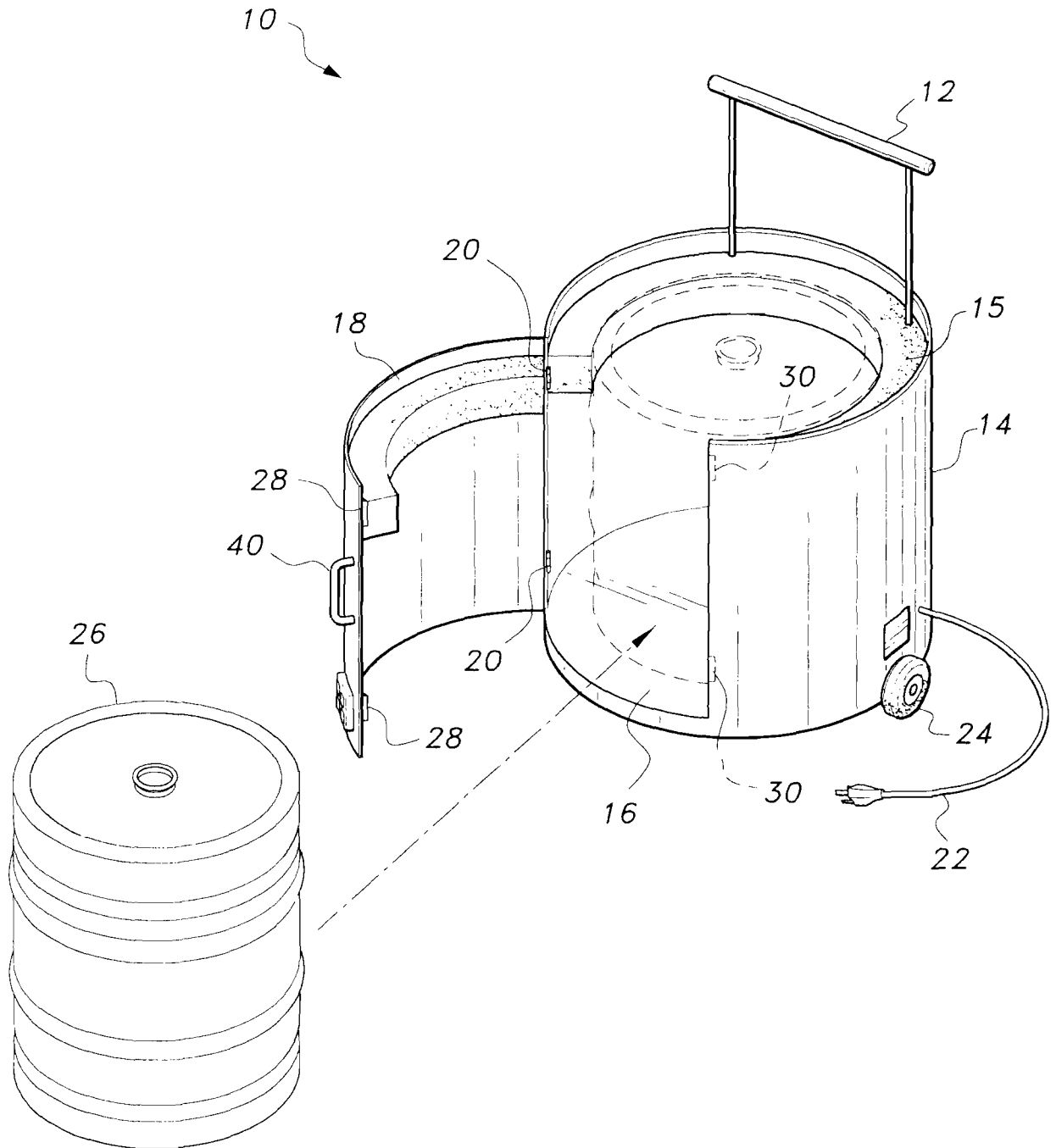

2/7

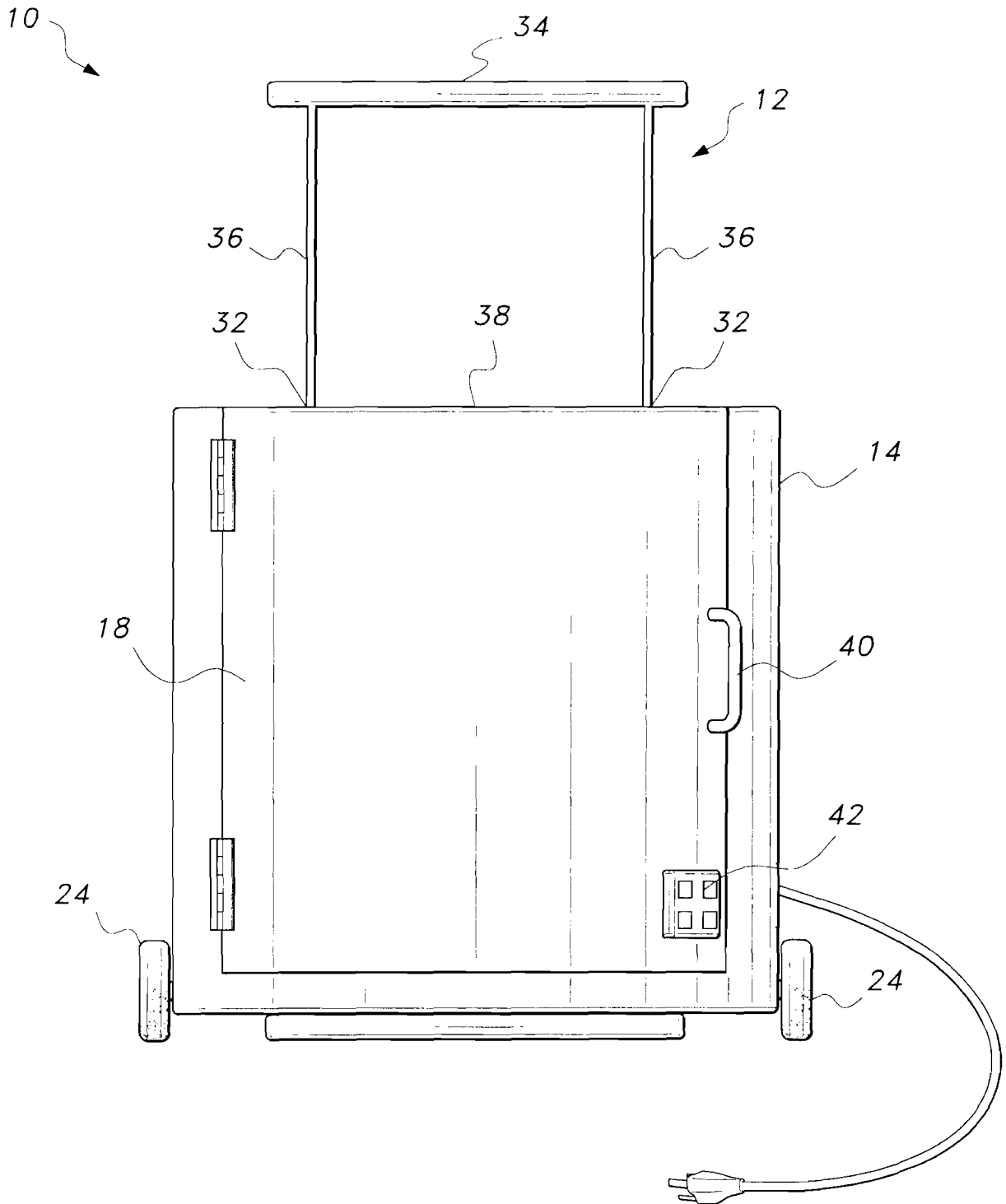

3/7

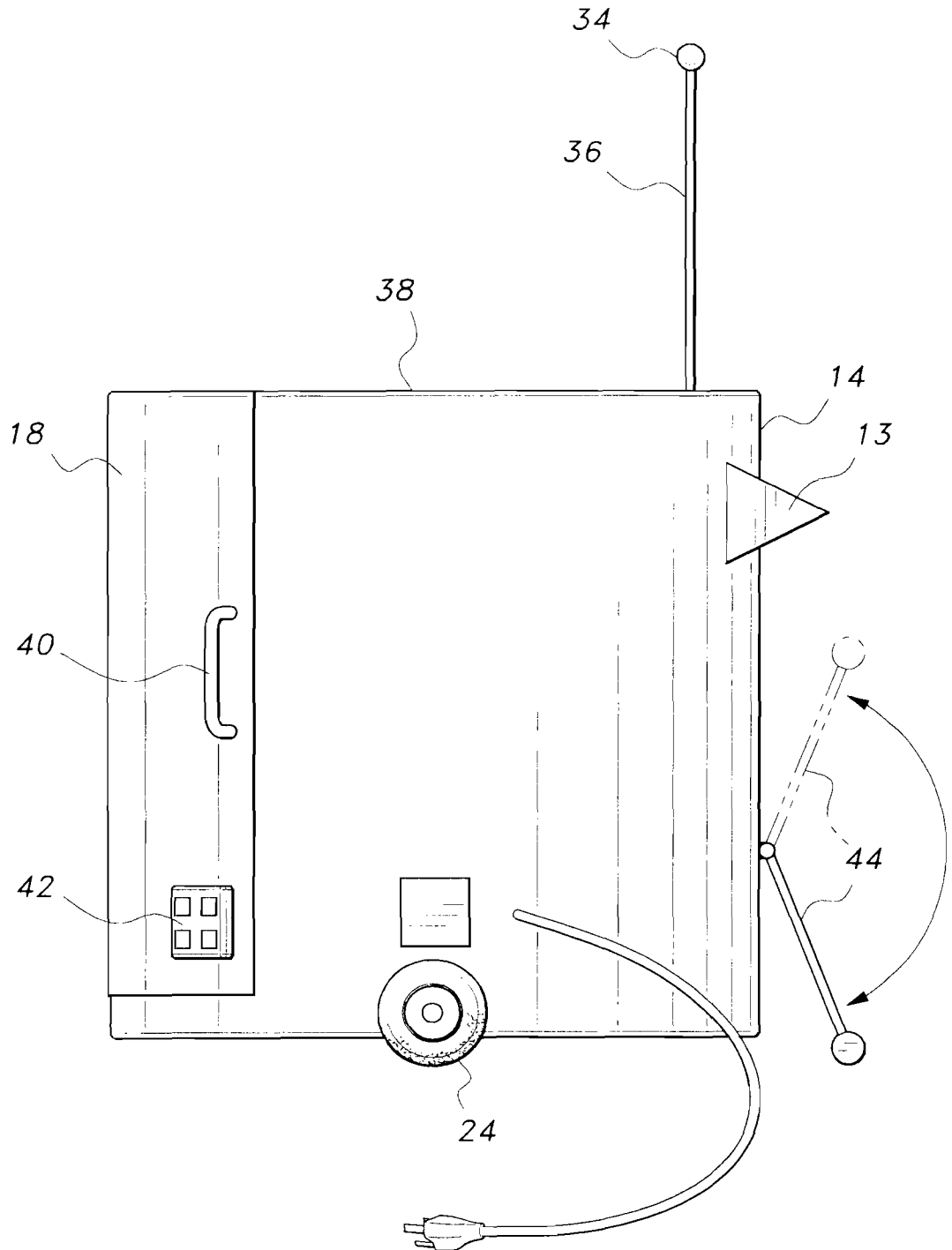

4/7

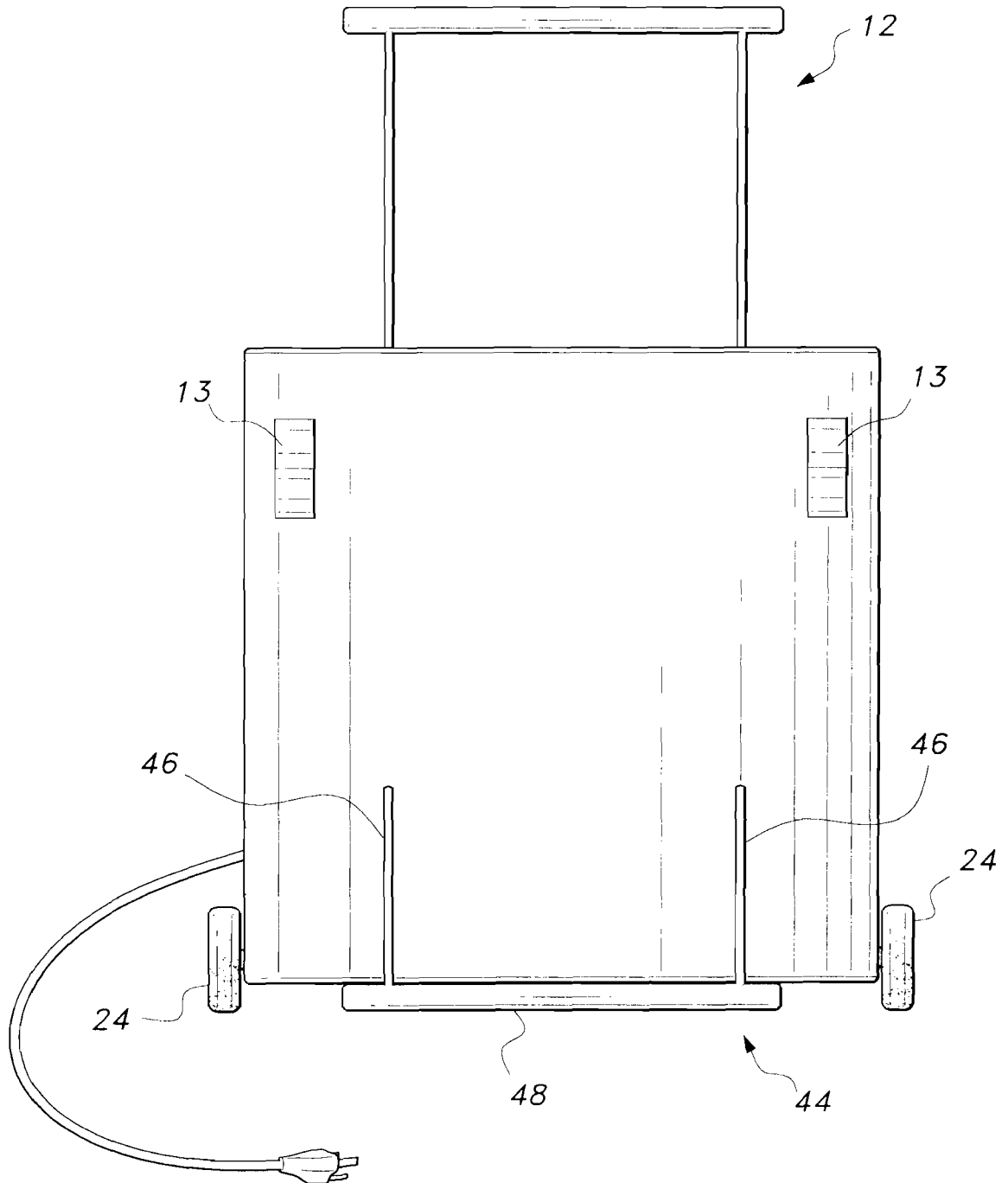

5/7

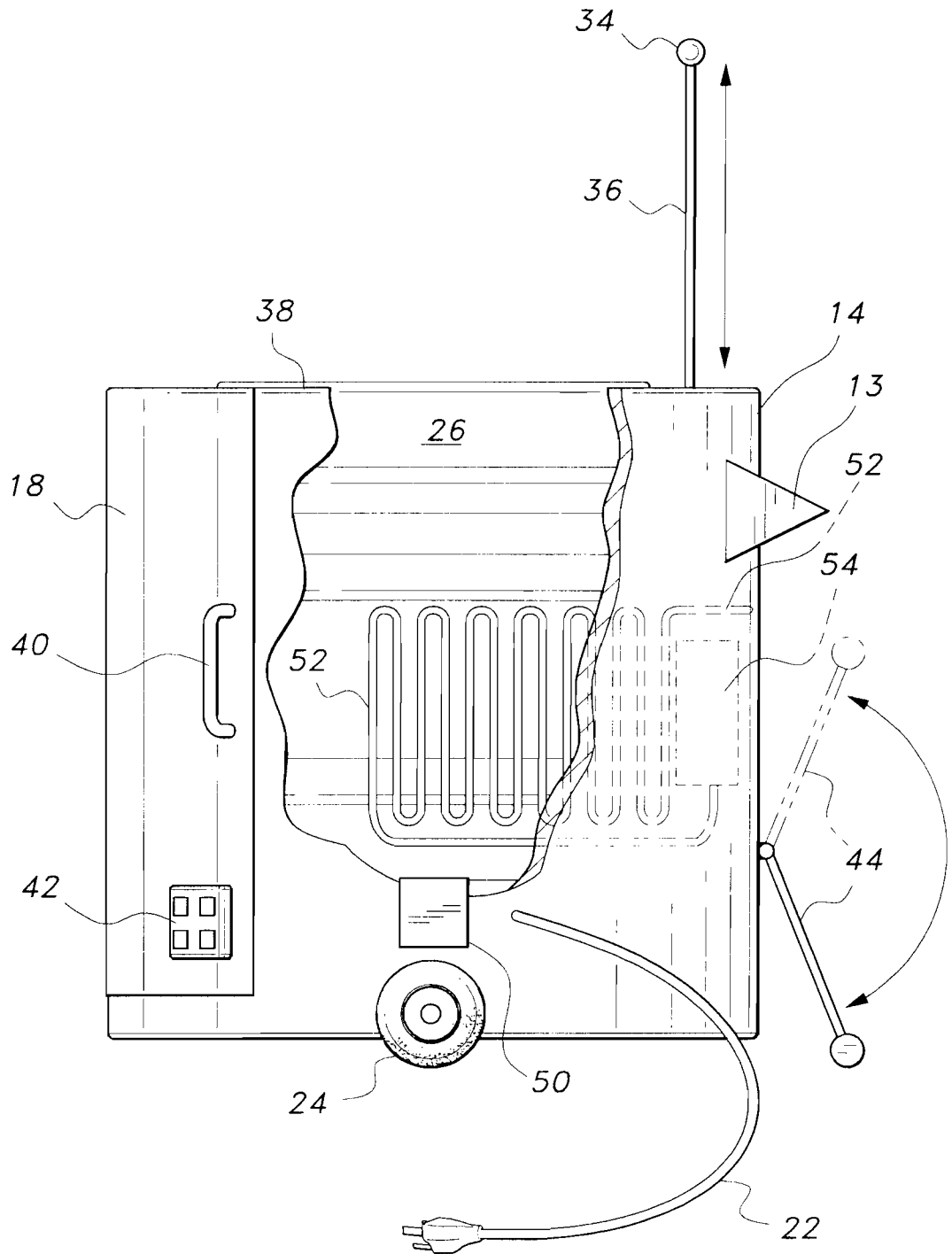

6/7

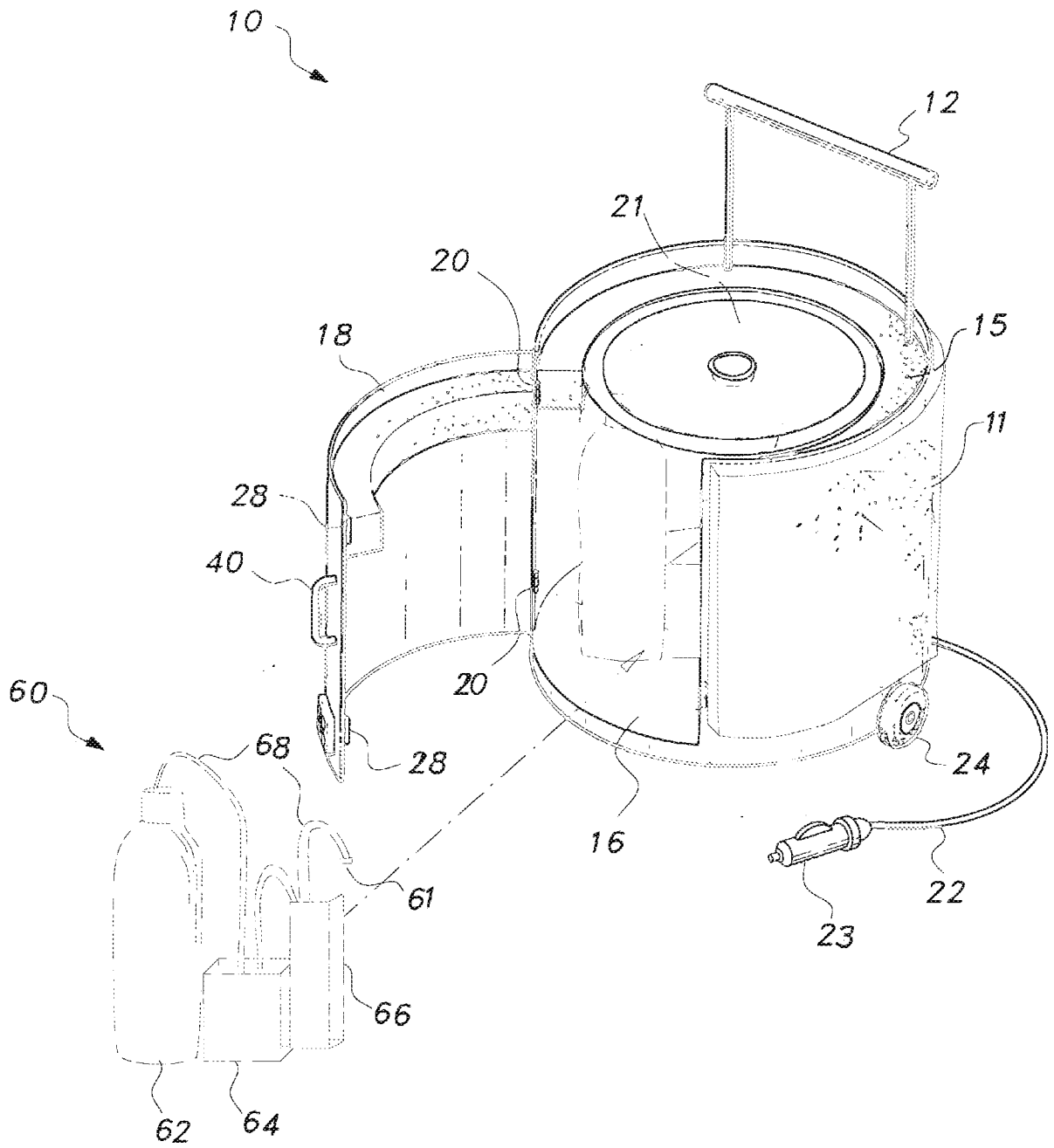

7/7

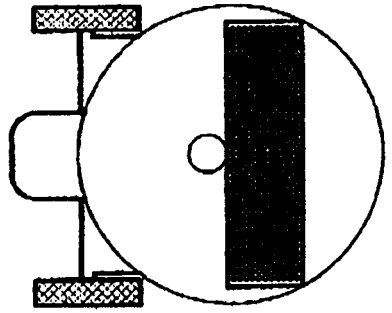

FIG. 7F

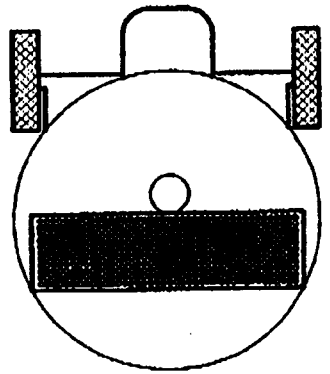

FIG. 7D

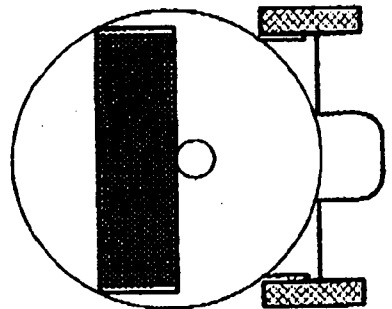

FIG. 7B

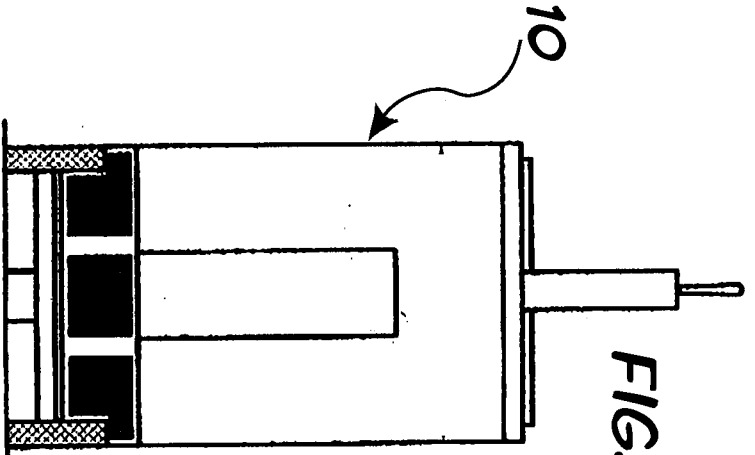

FIG. 7E

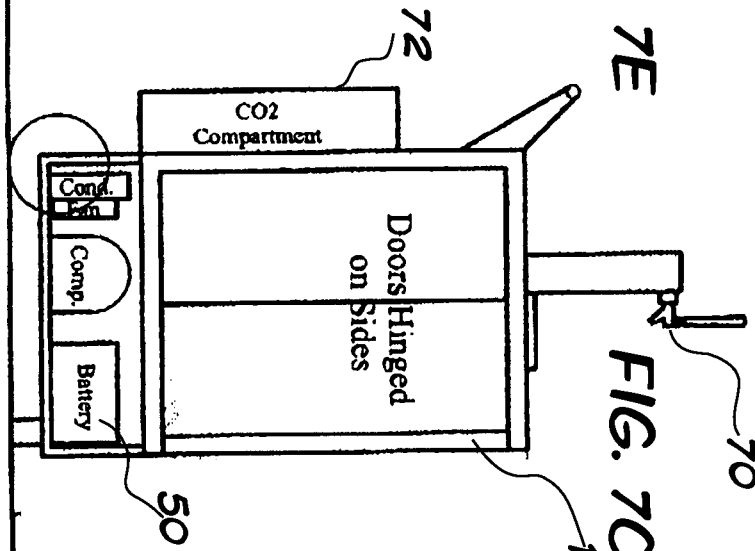

FIG. 7C

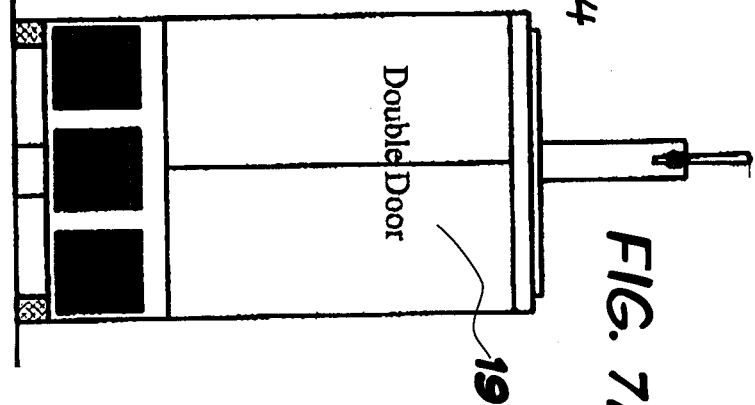

FIG. 7A