

May 10, 1949.

I. W. JACOBSON

2,469,556

CHILDREN'S SLEEPING GARMENT

Filed Aug. 7, 1947

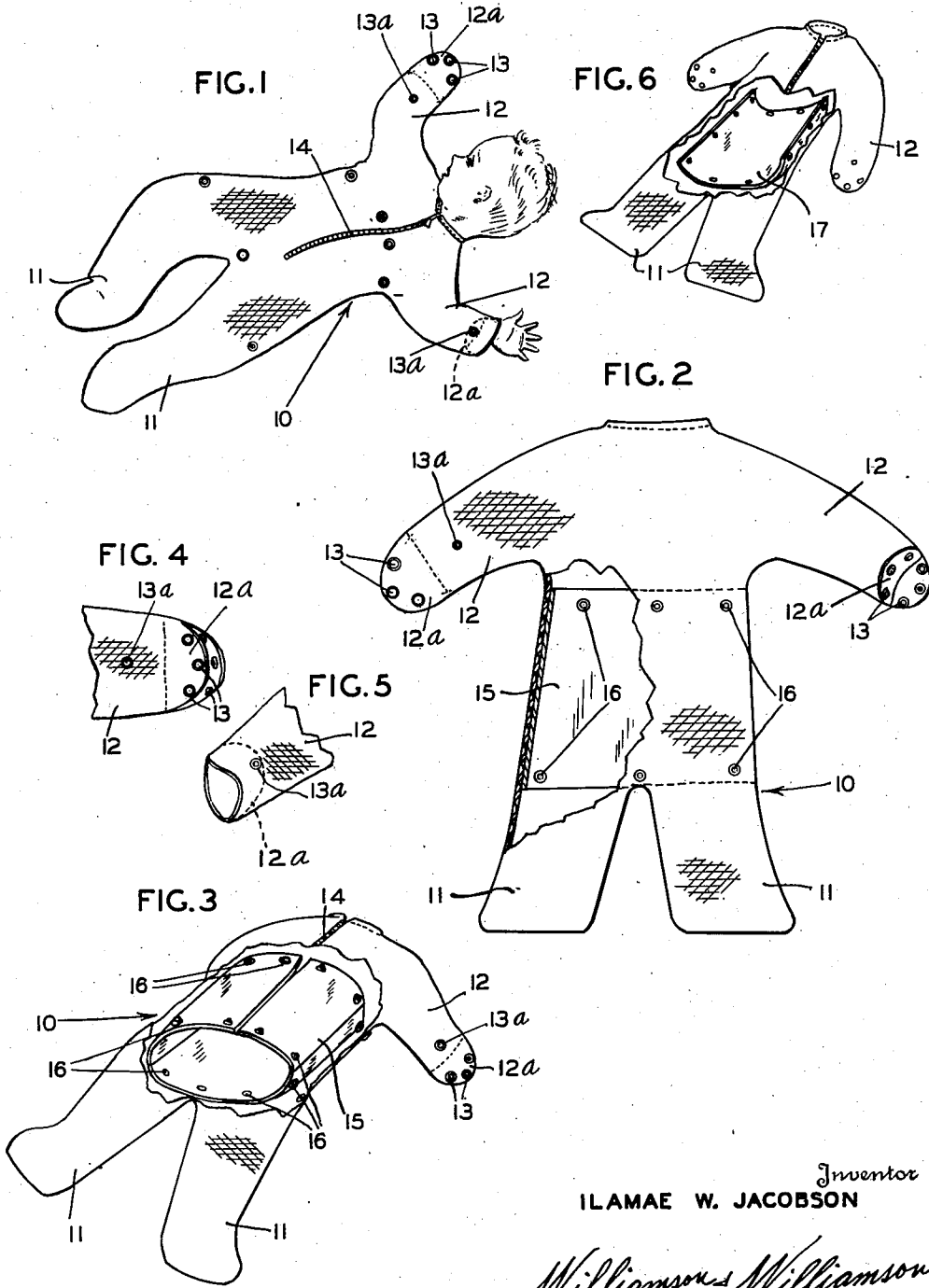

Inventor
ILAMAE W. JACOBSON

Williamson & Williamson

Attorneys

UNITED STATES PATENT OFFICE

2,469,556

CHILDREN'S SLEEPING GARMENT

Hamae W. Jacobson, St. Louis Park, Minn.

Application August 7, 1947, Serial No. 766,979

6 Claims. (Cl. 2-83)

1

This invention relates to sleeping covers for children.

It has been a serious problem to keep infant children properly covered while they sleep and still permit them complete freedom of movement without danger of strangulation. Also, before a child has been completely trained it is a problem to keep his bed and bedding dry.

It is an object of my invention to provide a sleeping cover for children which will permit complete freedom of movement and still keep the child fully covered without twisting on his body or tightening around his neck and to thereby eliminate the danger of strangulation.

It is another object to provide a child's sleeping suit which includes a moisture-proof sheet interposed between a portion of the child and the outer fabric of the suit to protect the suit and the bedding.

It is still a further object of my invention to provide an easily washable sleeping cover for children having a moisture-proof sheet removably attached therein to facilitate washing of both the sheet and the cover.

These and other objects and advantages of my invention will more fully appear from the following description made in connection with the accompanying drawings, wherein like reference characters refer to similar parts throughout the several views and in which:

Figure 1 is a top plan view of a sleeping child with my improved sleeping cover fully enclosing his body and limbs;

Figure 2 is a rear elevational view of my sleeping garment with a portion thereof cut away to show the moisture-proof protector attached therein;

Figure 3 is a perspective view of the suit with the central portion cut away to show one form of the moisture-proof sheet attached to completely surround a portion of the child's body;

Figure 4 is a perspective view of the cuff of the suit showing the same in extended hand-enclosing position;

Figure 5 is a perspective view of a cuff folded inwardly to permit a child's hand to extend there-through; and

Figure 6 is a perspective view of my suit with an alternative form of moisture-proof sheeting attached therein.

As illustrated in Figures 1 through 6, I provide a fabric sleeping cover or suit designated as an entirety by the numeral 10. The suit 10 has a pair of legs 11 individually formed at the bottom thereof and a pair of sleeves 12 extending out-

2

wardly in diametrically opposed relation from the top side portions of said suit and adapted to receive the arms of a child and to cover the same. The lower extremities of the legs 11 are closed in the suit illustrated to completely enclose the feet and legs of a child wearing the suit.

A cuff is formed on the outer extremity of each of said sleeves 12. Each of these cuffs is split longitudinally to form two opposed cooperating cuff flaps 12a. The outer extremities of the cuff flaps 12a are provided with closure means such as the three snap fasteners 13. In Figure 1 the cuff flaps of the right-hand sleeve 12 are shown in extended position with the respective fasteners closing the extremity thereof to enclose the right hand of the child wearing the suit, and the flaps of the left-hand cuff are shown folded into retracted position, to permit the child's hand to extend therethrough and the two parts of the outermost fastener 13 are respectively snapped into cooperating parts of a fastener 13a fixed in opposed relation to intermediate portions of the sleeve 12 to hold said cuff in retracted position. This cooperating fastener 13a is not absolutely necessary but merely affords positive means for holding the cuff in retracted position.

A suitable front closure is provided, such as the zipper 14 which extends down the greater part of the front body portion of suit 10. Any other closure means could be provided, but I have found a zipper to be the most convenient and the most attractive means for initially opening the suit to put it on the child and thereafter closing the same to completely cover the child's body.

In the form of my invention illustrated in Figures 2 and 3 I provide a sheet of moisture-proof material 15 such as "Bunelite," which is a rubberized material with flannel on one side and is sometimes known as "dryette." In this form of my invention I use a relatively long sheet of moisture-proof material which completely surrounds the medial portion of the child to protect the fabric of the suit 10 as well as the bedding and keep the same dry. The flannel side of the moisture-proof material should of course be adjacent the child's body so that the rubber will be on the outer surface of the protector.

Suitable fastening means are provided for attaching the moisture-proof sheet to the inner surface of the fabric of the suit 10, such as the snap fasteners 16. One half of each fastener is fixed to the moisture-proof material and the other half is fixed to the inside of the suit 10 in position to cooperate with the part of the fastener fixed to the moisture-proof material 15 and removably

attach said moisture-proof sheet 15 within the suit 10.

In Figure 6 I illustrate a second form of moisture-proof sheet which is relatively short and only underlies the child, and which is attached to either the front or the back portion of the suit 10, depending upon whether the child sleeps on his stomach or his back. If the child sleeps on his back of course the moisture-proof sheet designated by the numeral 17 will be attached to only the back of the suit and will not extend around the front portion thereof. The method of attaching this short protector 17 is exactly the same as that provided for the long sheet 15 except that it is only attached to either the front side or the back side of the suit and not to both sides.

When the child is wearing this suit he will be completely covered and there will be no chance of his becoming uncovered and thereby catching cold. Also, by providing the individual legs 11, each of which encloses one of the child's legs, the suit is prevented from twisting on the child as he twists and turns in bed. The sleeves 12 on the suit further prevent the suit from twisting and there is therefore no danger of the neck of the suit tightening around the child's neck and the possibility of the child strangling himself is absolutely eliminated, even though complete freedom of movement is provided. The cuff flaps 12a of the suit are adapted to either enclose the child's hands when in extended position with the fasteners 13 closing the ends thereof or when in retracted position the cuff is so designed to present a neat tailored cuff and permit the child's hand to extend therethrough. The respective parts of the outermost fastener 13 of the cuff flaps cooperate with the respective parts of the fastener 13a to hold the cuff in retracted position.

Either the moisture-proof sheet 15 or the moisture-proof sheet 17 is removably attached to the inner surface of the suit or cover 10 to protect the suit fabric and the bedding, and being removable greatly facilitates washing both the suit 10 and the protector 15 or 17. The protector 17 has the advantage of being cooler, by not completely surrounding the medial portion of the child, while the form 15 has the advantage of completely protecting the suit 10 and the bedding both front and rear when the child is sleeping. In the event that the child should turn over in his sleep this complete protection would be highly desirable, but in the summer months, if the child is a quiet sleeper, the form 17 would be sufficient, and materially cooler than the form 15.

It will be seen that I have provided a greatly improved, highly efficient sleeping cover for children which while keeping the child fully covered permits complete freedom of movement without danger of strangulation. Also, I incorporate in my improved sleeping cover a removable moisture-proof sheet interposed between the child and at least the underlying portion of the suit. By removably attaching this moisture-proof protector it is no more difficult to wash the suit than it is to wash a pair of child's pajamas and yet the protector is securely held in the desired position and protects the bedding and suit at all times. If this protector could not be removed, the suit would be extremely cumbersome and difficult to wash and keep clean.

It will, of course, be understood that various changes may be made in the form, details, arrangement and proportions of the parts without departing from the scope of my invention, and

that materials of varying weights may be used in the manufacture of these sleeping garments, depending on the temperature and the climate in which they are to be used.

What I claim is:

1. A child's sleeping suit comprising a body-enclosing portion, individual limb-enclosing portions for all four limbs having their inner ends connected to said body portion, said individual limb-enclosing portions preventing the suit from twisting on the child's body to eliminate danger of strangulation and permit complete freedom of movement while fully covering the sleeping child at all times, a sheet of moisture-proof material interposed between the medial portion of the child and a portion of the suit adjacent thereto, and means for removably attaching said sheet at both the top and bottom thereof within the body portion of said suit to hold the same in the desired position and prevent bunching and wrinkling of said sheet while permitting removal of the same to facilitate cleaning both the suit and the moisture-proof sheet.

2. A child's sleeping garment comprising a fabric suit having a body portion, individual limb-enclosing portions for all four limbs connected to said body portion, a moisture-proof sheet interposed between only the underlying portion of the suit body and the medial portion of the child to protect the underlying suit portion as well as the bedding, and means at both the top and bottom of said moisture-proof sheet for removably attaching said moisture-proof sheet to the inside of said suit body portion to securely hold the top and bottom of the sheet in position therein and permit easy removal thereof to facilitate cleaning of both the suit and the moisture-proof sheet.

3. A child's sleeping garment comprising a fabric suit, including a body portion, individual limb-enclosing portions connected thereto, a moisture-proof sheet interposed between the medial portion of a child and the portion of said suit adjacent thereto and completely surrounding on said medial portion of the child to protect the suit and bedding, and means at the top and bottom of said sheet for removably attaching said moisture-proof sheet to the inside of said suit body portion to hold the top and bottom of the sheet securely in position therein and permit easy removal thereof for cleaning both the suit and the moisture-proof sheet.

4. A child's sleeping suit comprising a body enclosing portion, individual limb enclosing portions for all four limbs having their inner ends connected to said body portion, a liner of moisture proof material adapted to surround only the medial portion of a child and interposed between said medial portion and the portion of the suit adjacent thereto, and releasable means for removably fastening down all of the marginal edge portions of said moisture proof material, to securely anchor all portions of the liner to the inside of said suit in the desired protective position, said individual limb enclosing portions of said suit preventing displacement of said suit and moisture proof liner relative to the child's body.

5. A child's sleeping suit comprising a body enclosing portion, a liner of moisture proof material adapted to surround only the medial portion of a child enclosed in said suit and mountable between the child and the suit and having its end portions open to permit substantially unrestricted ventilation for the child's body, and means for fastening down said liner to said suit to securely

5

hold the same in protective position within the said suit.

6. A child's sleeping suit comprising a body enclosing portion including arm enclosures and leg enclosures and having a relatively long body portion and low crotch, a liner of moisture-proof material adapted to surround only the medial portion of a child substantially from the waist to slightly below the crotch of the child and having completely open bottom and top end portions to permit substantially unrestricted ventilation for the medial portion of the child's body and to permit substantially unconfined movement of the child's legs, and means for fastening down said liner to said suit to hold the same in protective position therein.

ILAMAE W. JACOBSON.

6

REFERENCES CITED

The following references are of record in the file of this patent:

UNITED STATES PATENTS

Number	Name	Date
1,092,047	Hertz	Mar. 31, 1914
1,292,351	Milkes	Jan. 21, 1919
1,365,526	Milkes	Jan. 11, 1921
1,393,900	Milkes	Oct. 18, 1921
1,905,948	Nosik et al.	Apr. 25, 1933
2,143,064	Giusto	Jan. 10, 1939
2,374,299	O'Hara	Apr. 24, 1945

FOREIGN PATENTS

Number	Country	Date
483,375	Germany	Oct. 1, 1929