



US 20160259177A1

(19) **United States**

(12) **Patent Application Publication**
Ladwig et al.

(10) **Pub. No.: US 2016/0259177 A1**

(43) **Pub. Date: Sep. 8, 2016**

(54) **CAMERA LENS SUSPENSION WITH INTEGRATED ELECTRICAL LEADS**

Publication Classification

(71) Applicant: **Hutchinson Technology Incorporated**,
Hutchinson, MN (US)

(51) **Int. Cl.**
G02B 27/64 (2006.01)
G02B 7/02 (2006.01)
G02B 7/09 (2006.01)

(72) Inventors: **Peter F. Ladwig**, Hutchinson, MN (US);
Mark A. Miller, Hutchinson, MN (US)

(52) **U.S. Cl.**
CPC **G02B 27/646** (2013.01); **G02B 7/09**
(2013.01); **G02B 7/023** (2013.01)

(21) Appl. No.: **14/863,046**

(57) **ABSTRACT**

(22) Filed: **Sep. 23, 2015**

Embodiments of the invention include a camera lens optical image stabilization suspension assembly having a support member, a moving member movably coupled to the support member, and smart metal alloy wires coupled between the support and moving members. The moving member includes flexure arms that have integrated conductive traces.

Related U.S. Application Data

(60) Provisional application No. 62/129,562, filed on Mar. 6, 2015.

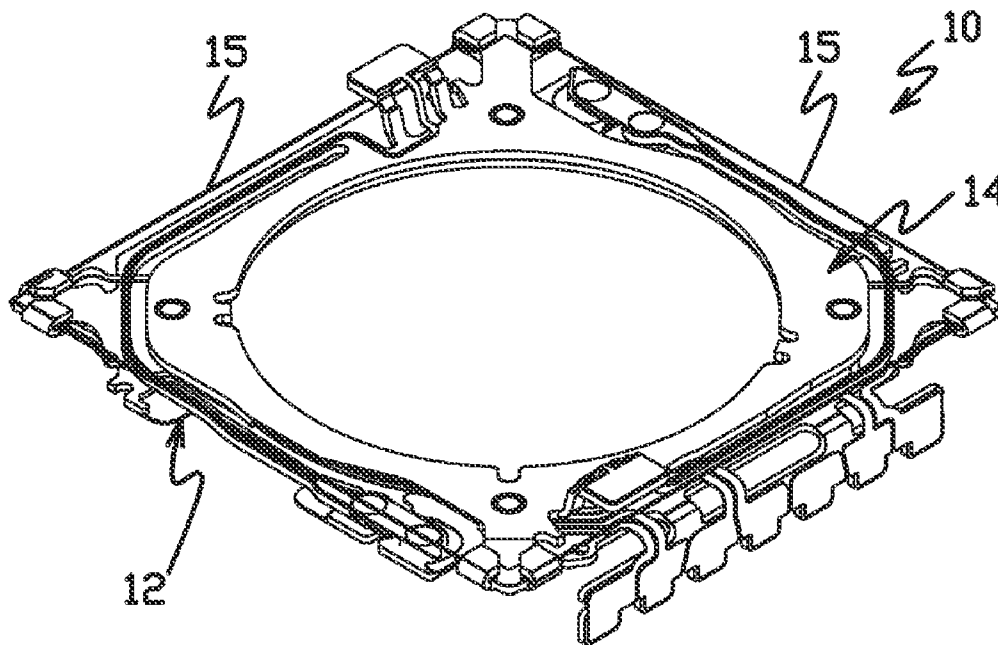

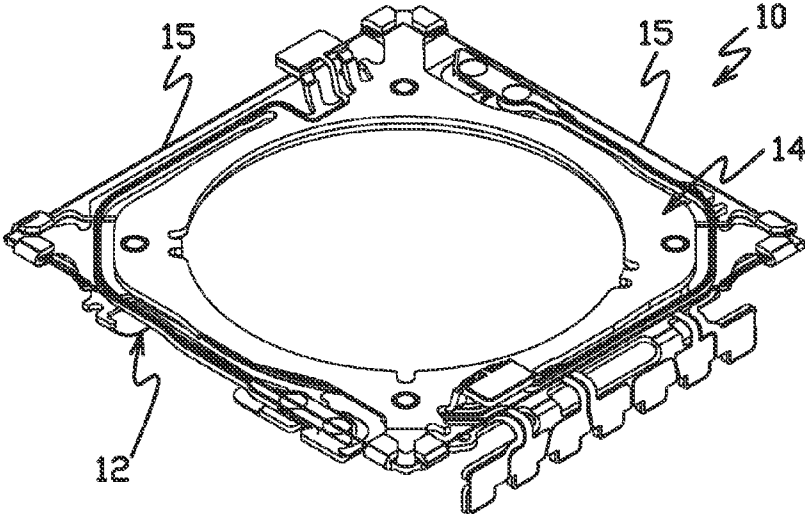

FIG. 1A

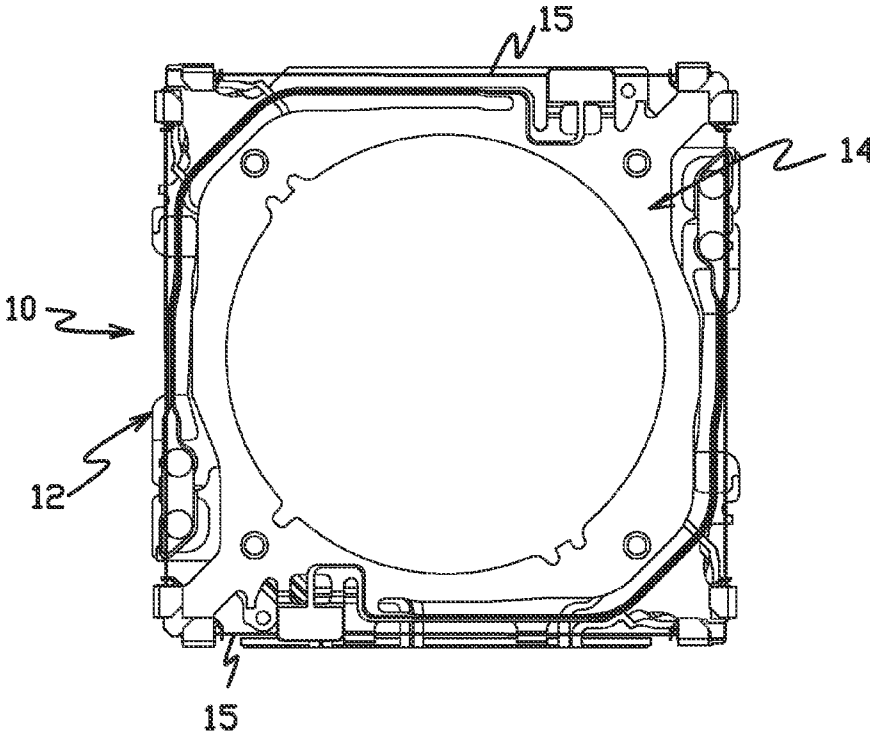

FIG. 1B

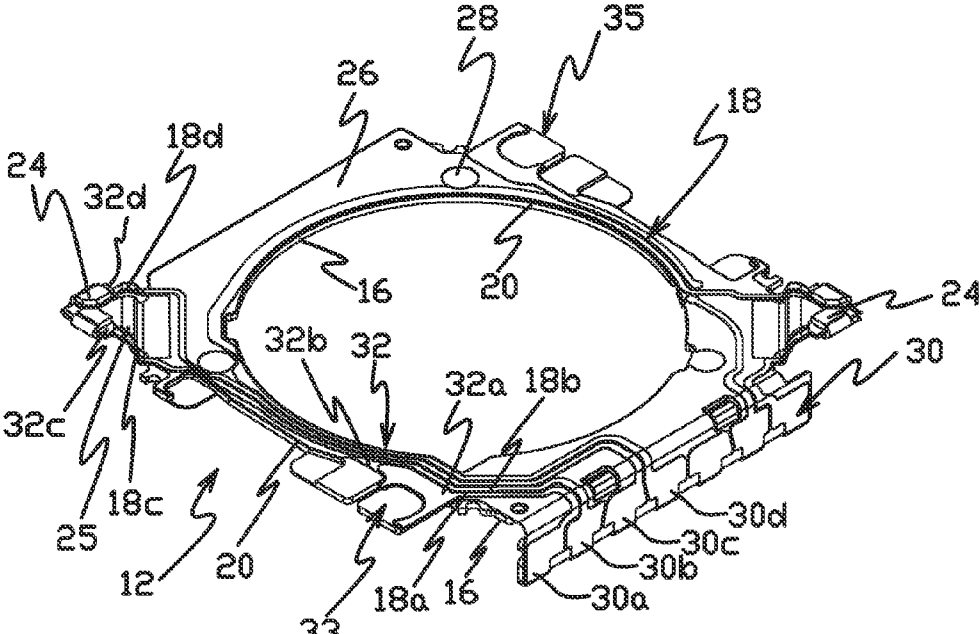

FIG. 2A

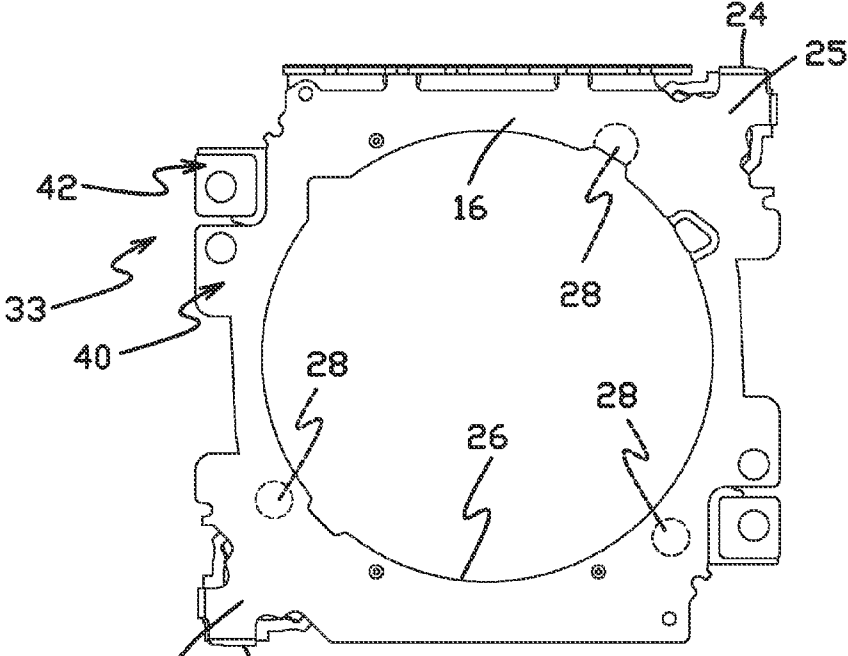
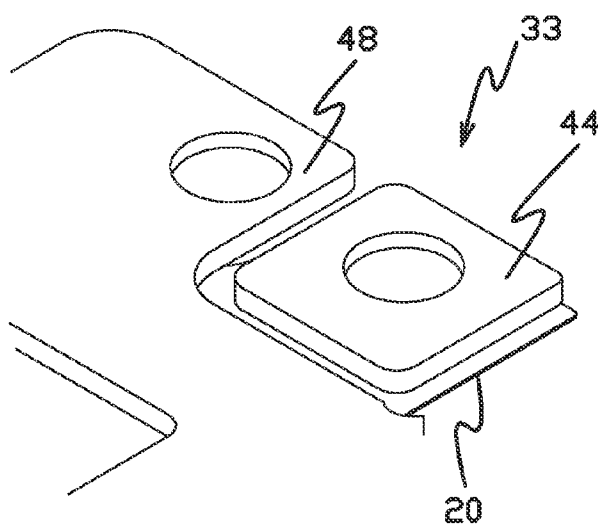
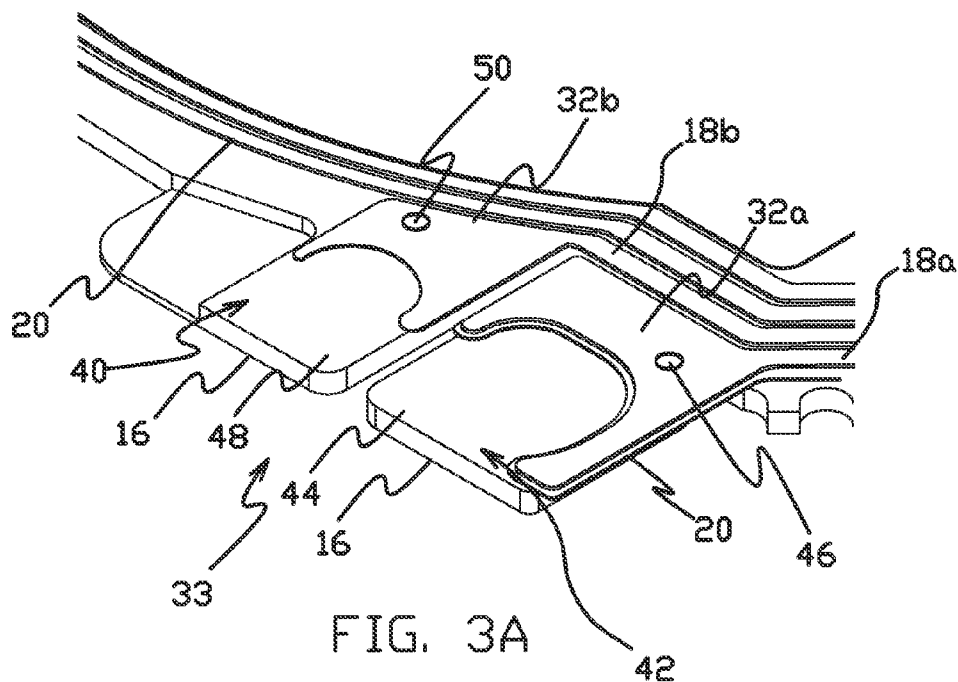

FIG. 2B



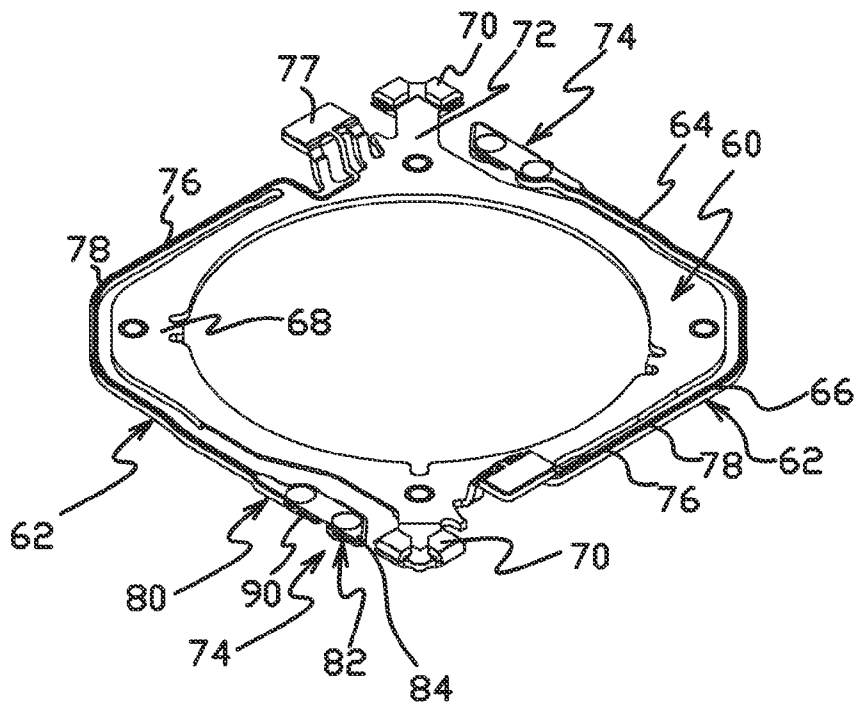

FIG. 4A

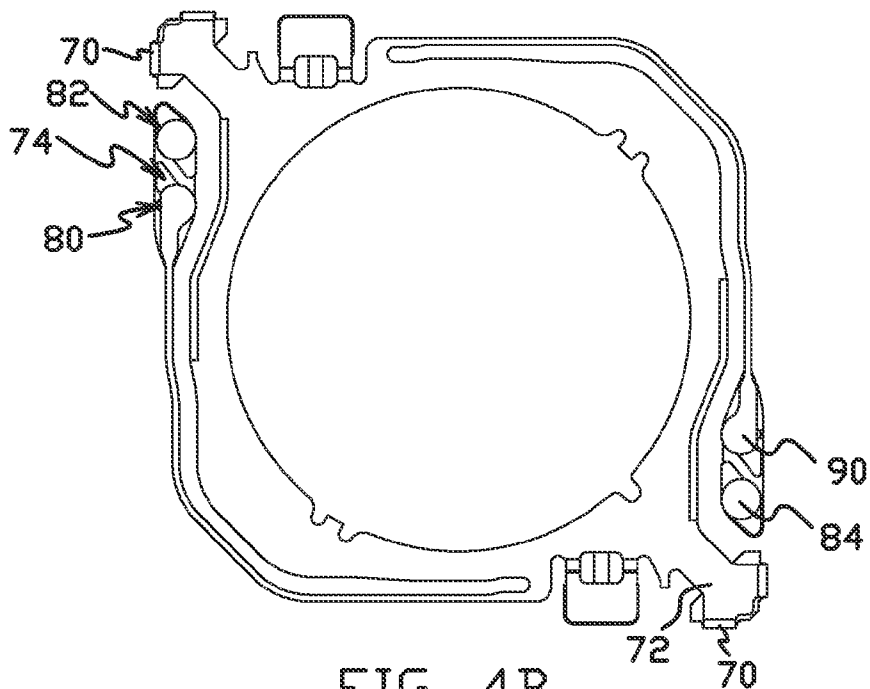

FIG. 4B

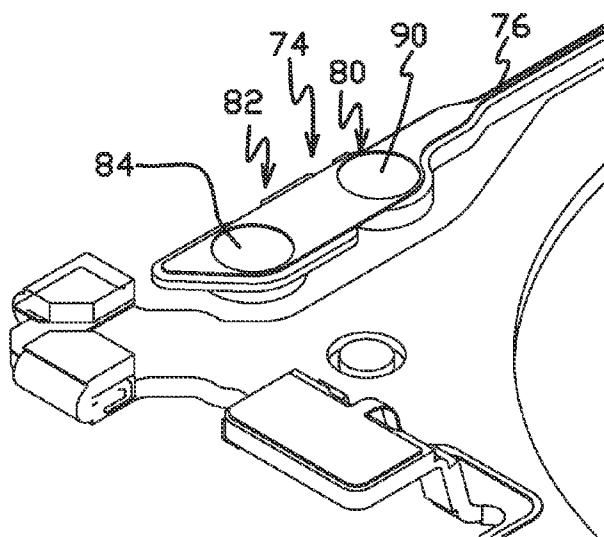

FIG. 5

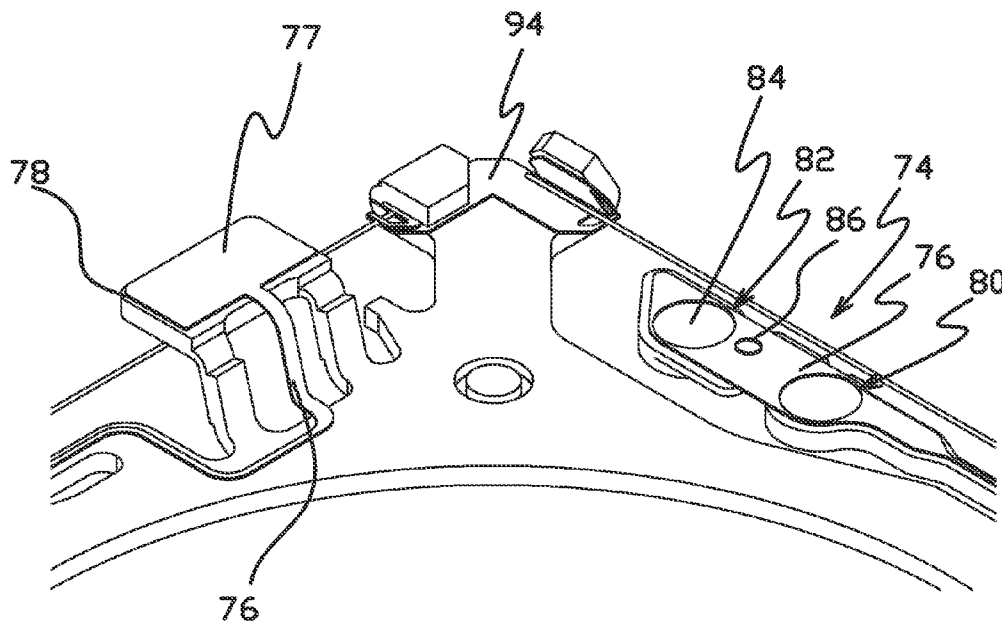

FIG. 6

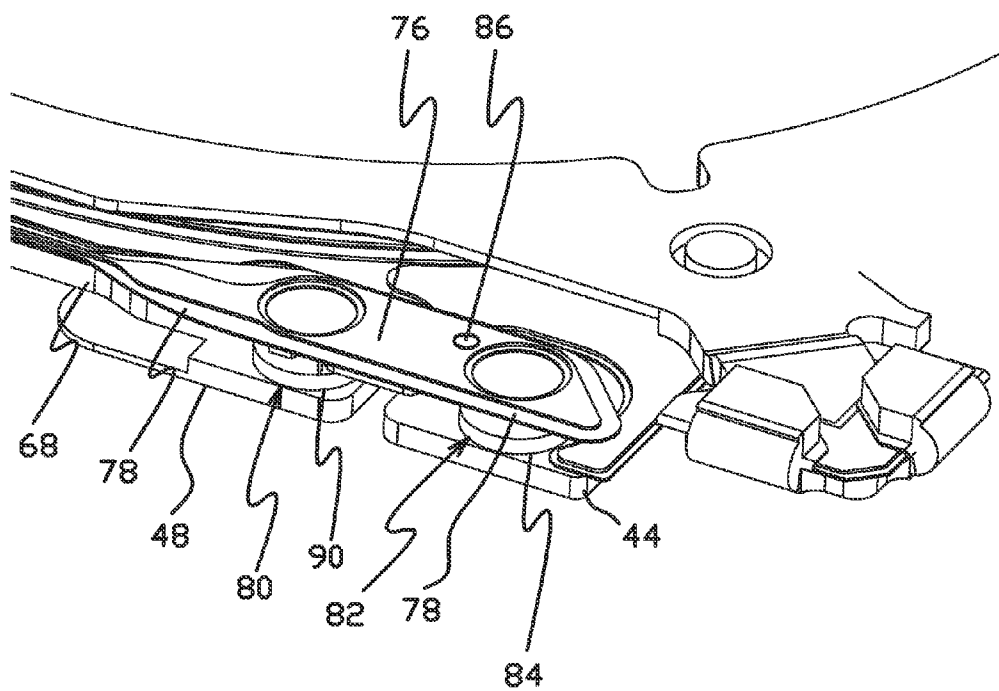
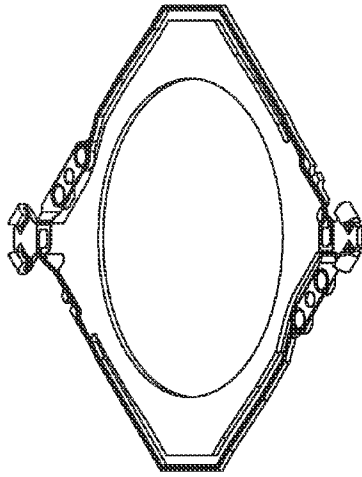
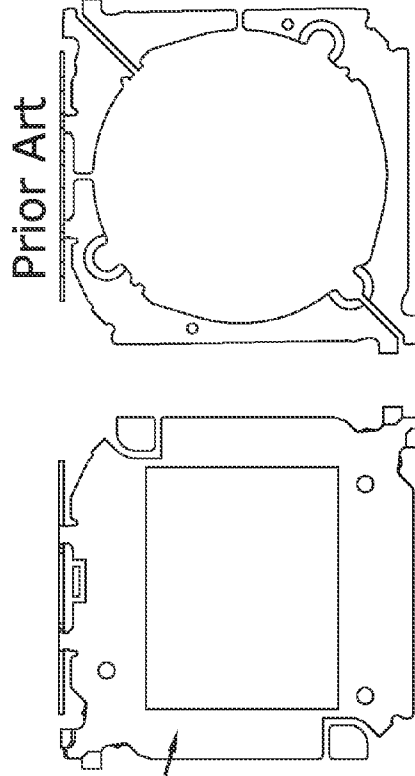

FIG. 7



Enable integrated full hard SST (stainless steel) spring and moving crimps

- Use poly and copper to take up any spring back of full hard SST after crimp for high wire pull strength



Enable solid FPC (flexible printed circuit) SST layer

- Enables thin 2-piece welded OIS
- Enable OIS_COMMON to be FPC SST layer for strong weld connection

FIG. 8

Integrated spring and crimps

- Use poly and copper to take up any spring back of full hard SST after crimp for high wire pull strength
- Poly and copper will not damage the wire like full hard metal could during the crimp process

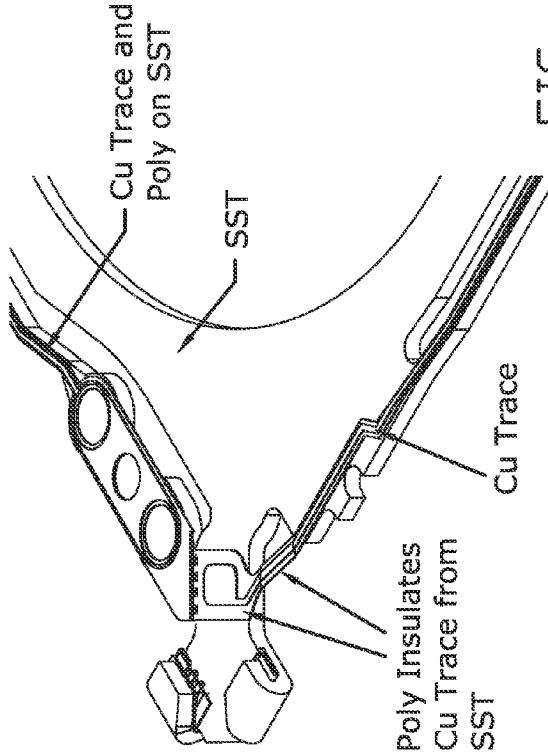
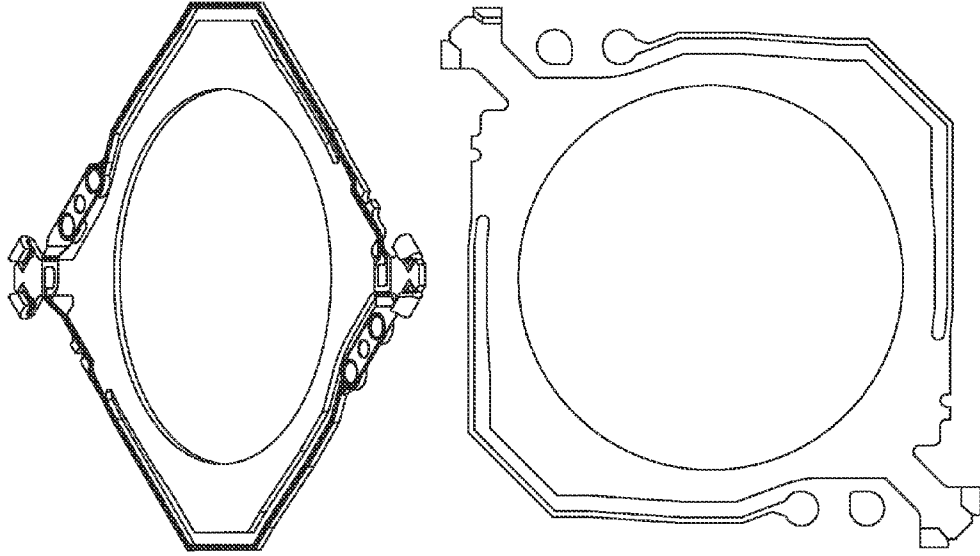
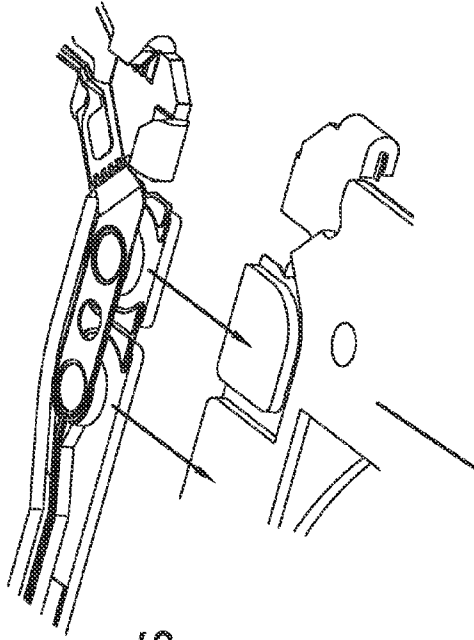

FIG. 9

Enables thin 2-piece welded OIS



Allows OIS Common to be base metal circuit path giving you a solid FPC to weld to

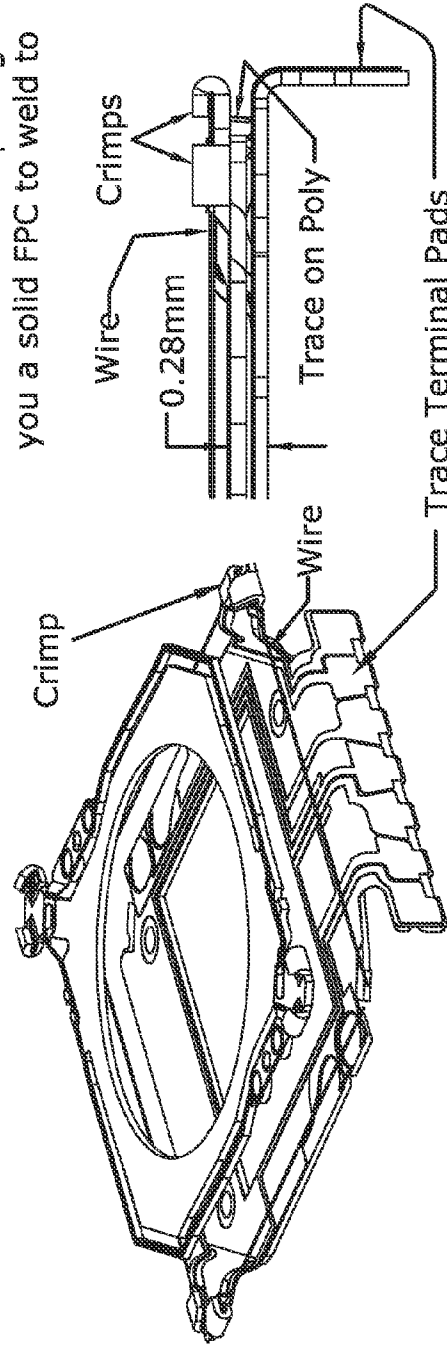
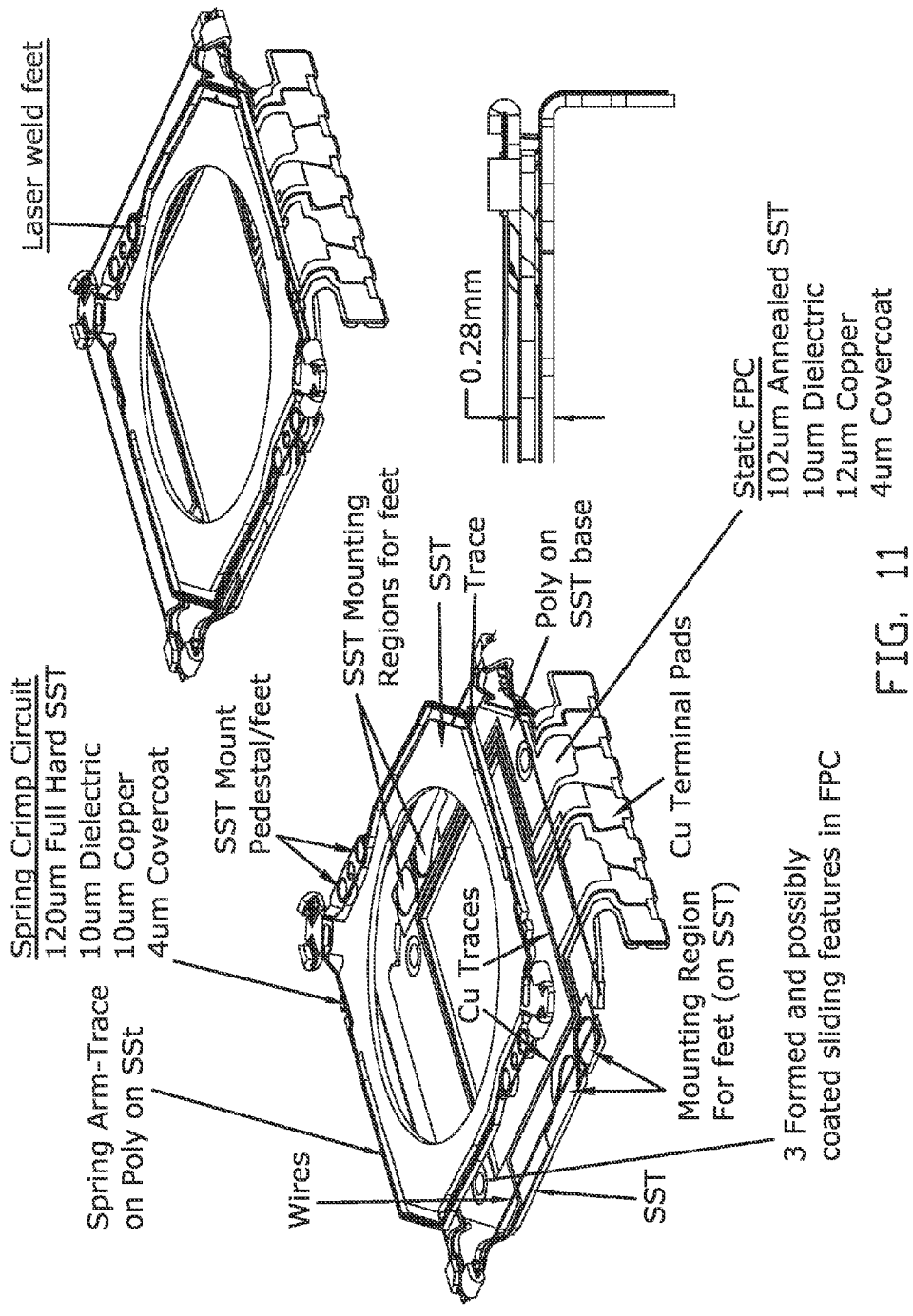

FIG. 10



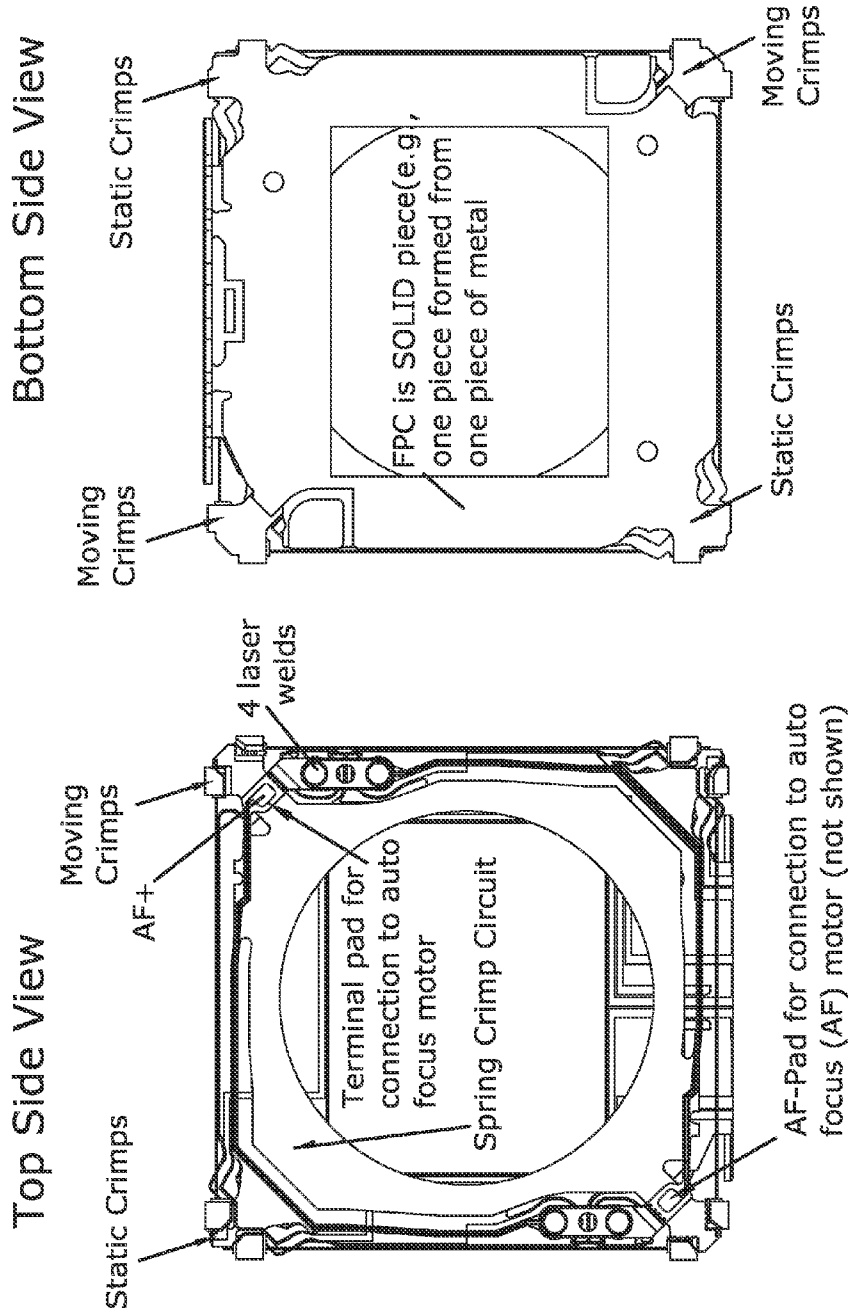

FIG. 12

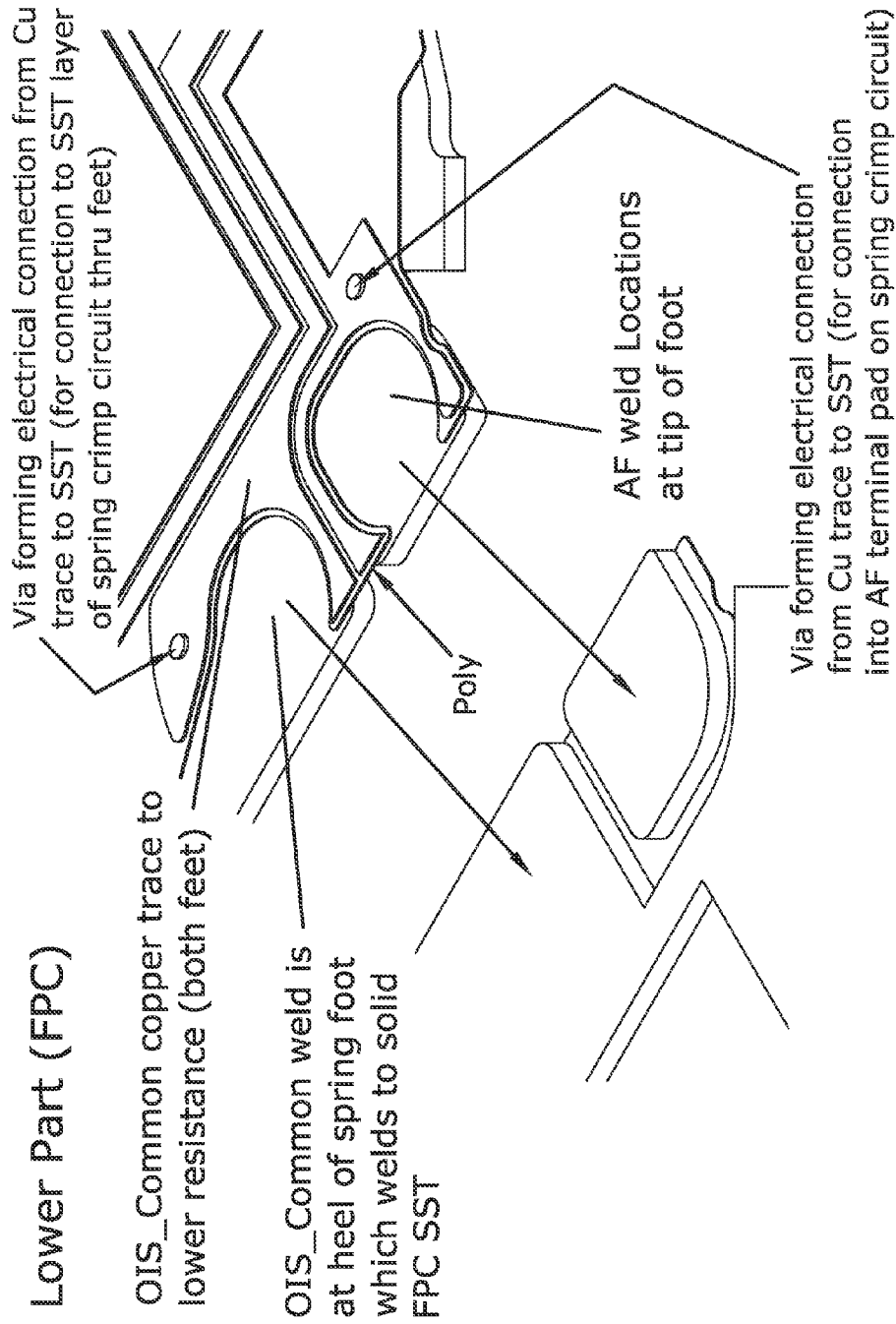

FIG. 13

Upper Part (Spring_Crimp)

- Full Hard SST (120um)
- Poly (10um)
- CU (10um)
- CL (4um)

Break free at assembly weld
Enables pre form of spring feet, but keeps feet in plane for weld locating

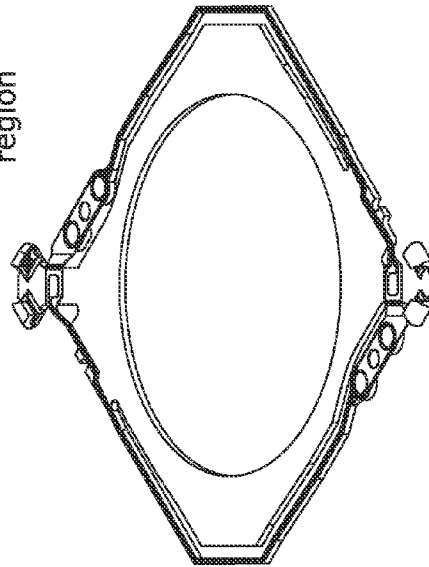
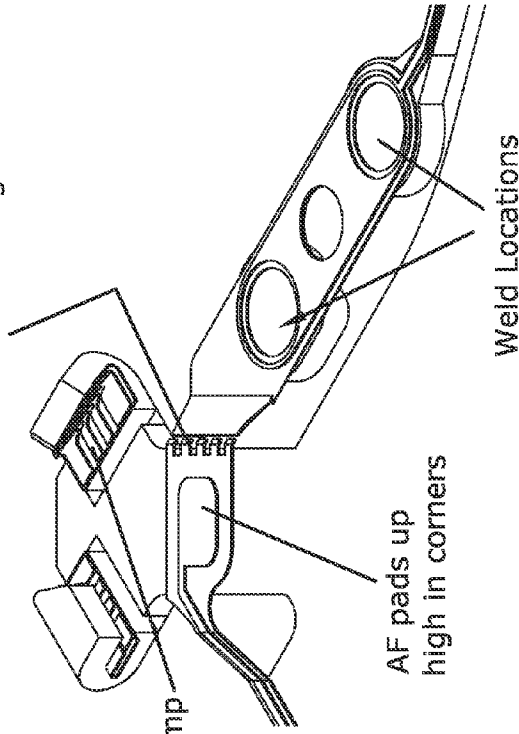

FIG. 14

CAMERA LENS SUSPENSION WITH INTEGRATED ELECTRICAL LEADS

CROSS REFERENCE TO RELATED APPLICATION

[0001] This application claims the benefit of U.S. Provisional Application No. 62/129,562 filed on Mar. 6, 2015 and entitled Two-Piece Camera Lens Suspension With Integrated Electrical Leads, which is incorporated herein by reference in its entirety and for all purposes.

FIELD OF THE INVENTION

[0002] The invention relates generally to camera lens suspensions such as those incorporated into mobile phones. In particular, the invention relates to such camera lens suspensions having integrated electrical leads.

BACKGROUND

[0003] PCT International Application Publication Nos. WO 2014/083318 and WO 2013/175197 disclose a camera lens optical image stabilization (OIS) suspension system that has a moving assembly (to which a camera lens element can be mounted) supported by a flexure element or spring plate on a stationary support assembly. The flexure element, which is formed from metal such as phosphor bronze, has a moving plate and flexures. The flexures extend between the moving plate and the stationary support assembly and function as springs to enable the movement of the moving assembly with respect to the stationary support assembly. In addition to this mechanical function, the flexures provide electrical connections from the support assembly to structures such as the camera lens element mounted to the moving assembly. The moving assembly and support assembly are coupled by shape memory alloy (SMA) wires extending between the assemblies. Each of the SMA wires has one end attached to the support assembly, and an opposite end attached to the moving assembly. The suspension is actuated by applying electrical drive signals to the SMA wires. The above-identified PCT publications are incorporated herein by reference for all purposes.

[0004] There remains a continuing need for improved lens suspensions. In particular, there is a need for such suspension structures with improved structures for coupling electrical signals on the suspensions. Suspension structures of these types that are highly functional, robust and efficient to manufacture would be particularly desirable.

SUMMARY

[0005] The invention is an improved lens suspension having integrated electrical traces. The suspension is functional, robust and efficient to manufacture. Embodiments of the suspension comprise a support member and a moving member movably coupled to the support member. The support member includes a metal base layer, conductive traces on the base layer, dielectric between the base layer and the traces, and a smart memory alloy wire attach structure. The moving member includes a plate, flexure arms extending from the plate and coupled to the support member, a metal base layer in the plate and flexure arms, conductive traces on the base layer of the flexure arms and optionally the plate, dielectric between the base layer and the traces, and a smart memory alloy wire

attach structure. The conductive traces on the flexure arms are electrically connected to the conductive traces on the support member.

BRIEF DESCRIPTION OF THE DRAWINGS

[0006] FIG. 1A is a top isometric view of a suspension in accordance with embodiments of the invention.

[0007] FIG. 1B is a top plan view of the suspension shown in FIG. 1A.

[0008] FIG. 2A is a top isometric view of the support member of the suspension shown in FIG. 1A.

[0009] FIG. 2B is a bottom plan view of the support member shown in FIG. 2A.

[0010] FIG. 3A is a detailed top isometric view of a mount region of the support member shown in FIG. 2A.

[0011] FIG. 3B is a detailed bottom isometric view of the mount region of the support member shown in FIG. 2A.

[0012] FIG. 4A is a top isometric view of the moving member of the suspension shown in FIG. 1A.

[0013] FIG. 4B is a bottom plan view of the moving member shown in FIG. 4A.

[0014] FIG. 5 is a detailed top isometric view of a flexure arm mount region and a wire attach of the moving member shown in FIG. 4A.

[0015] FIG. 6 is a detailed top isometric view of a flexure arm mounting region and a wire attach of the moving member shown in FIG. 4A.

[0016] FIG. 7 is a detailed top isometric view of a support member mount region and a flexure arm mount region of the suspension shown in FIG. 1A.

[0017] FIGS. 8-14 are annotated illustrations of embodiments of the suspension.

DESCRIPTION OF THE INVENTION

[0018] FIGS. 1A and 1B illustrate a suspension assembly 10 in accordance with embodiments of the invention. As shown, the suspension assembly 10 includes a flexible printed circuit (FPC) or support member 12 and a spring crimp circuit or moving member 14 that is coupled to the support member. Smart memory alloy (SMA) wires 15 extend between the support member 12 and the moving member 14, and can be electrically actuated to move and control the position of the moving member with respect to the support member. In embodiments, the suspension assembly 10 is a camera lens optical image stabilization (OIS) device that can be incorporated, for example, into mobile phones, tablets, laptop computers.

[0019] FIGS. 2A, 2B, 3A and 3B illustrate the support member 12 in greater detail. As shown, the support member 12 includes a base layer 16 and a plurality of conductive traces 18 such as traces 18a-18d in a conductor layer on the base layer. A layer of dielectric 20 is located between the conductive traces 18 and the base layer 16 to electrically insulate the traces from the base layer. A plurality of wire attach structures such as crimps 24 (i.e., static crimps; four are shown in the illustrated embodiment) are located on the base layer 16. In the illustrated embodiment the crimps 24 are organized as two pairs of adjacent structures that are integrally formed on a ledge 25 in the base layer 16 at a level spaced (e.g., in a z-direction) from a major planar surface portion 26 of the base layer. Other embodiments (not shown) include other wire attach structures (e.g., solder pads) and/or wire attach structures that are organized in other arrangements (e.g., singly

rather than in pairs). In embodiments, bearing-retaining recesses 28 are formed in the portion 26 of base layer 16. Bearings (not shown) in the recesses 28 can engage the moving member 14 and movably support the moving member with respect to the support member 12. Traces 18 include terminals 30 and contact pads 32 in the conductor layer on the base layer 16. Each of the traces 18 couples a terminal 30 to a contact pad 32. For example, contact pads 32a and 32b are at a first mount region 33 of the support member 12, and traces 18a and 18b couple terminals 30a and 30b to pads 32a and 32b, respectively. Contact pads 32 at a second mount region 35 are similarly coupled to terminal 30 by traces 18. A contact pad 32 is located at each of the crimps 24 in the illustrated embodiment, and each of the contact pads is coupled by a separate trace to a separate terminal 30 (e.g., trace 18d couples terminal 30d to pad 32d). The portion of the base layer 16 on which the terminals 30 are located is formed out of the plane of the major surface portion 26 (e.g., perpendicular to the plane of the major surface portion in the illustrated embodiment).

[0020] FIGS. 3A and 3B illustrate in greater detail embodiments of the mount region 33 of the support member 12. As shown, the mount region 33 includes first and second mounting pads 40 and 42. Mounting pad 42 includes an island or pad portion 44 in the base layer 16 that is electrically isolated from other portions of the base layer. The island pad portion 44 can be supported in part from adjacent portions of the base layer 16 by areas of dielectric 20 that extend between the island pad portion and adjacent portions of the base layer. Trace 18a and contact pad 32a extend to the island pad portion 44, and in embodiments are electrically connected to the island pad portion 44 by an electrical connection such as a plated or other via 46 that extends through the dielectric 20 at the mounting pad 42. Other embodiments include other electrical connections in place of or in addition to via 46, such as, for example, conductive adhesive that extends between the contact pad 32a and island pad portion 44 over the edges of the dielectric 20. Mounting pad 40 is adjacent to mounting pad 42, and includes a pad portion 48 in the base layer 16 (that in embodiments functions as an electrical ground or common structure), and an electrical connection such as via 50 that connects the contact pad 32b to the pad portion 48. The mount region 35 can be similar to mount region 33.

[0021] FIGS. 4A, 4B, 5, 6 and 7 illustrate embodiments of the moving member 14 in greater detail. As shown, the moving member 14 includes a plate 60 and spring or flexure arms 62 extending from the plate 60. In the illustrated embodiments, the plate 60 is a rectangular member, and each flexure arm 62 is an elongated member having first and second portions 64 and 66 that extend along two sides of the periphery of the plate. The plate 60 and flexure arms 62 are formed in a spring metal base layer 68 such as stainless steel. Moving member 14 also includes SMA wire attach structures such as crimps 70 (moving crimps; four are shown in the illustrated embodiment, organized in pairs). In the illustrated embodiment, the crimps 70 are unitary with and formed from the same spring metal base layer 68 as the plate 60 (i.e., on ends of arms 72 extending from the plate). Moving member 14 is configured differently in other embodiments. For example, in other embodiments (not shown) the flexure arms 62 can be shaped differently, be different in number, organized differently, and/or can extend from other locations on the plate 60. In still other embodiments (not shown), the crimps 70 can be formed as separate structures that are attached to the plate 60

(i.e., not unitary with the plate). Other embodiments (not shown) include other types of wire attach structures (e.g., solder pads) and/or wire attach structures that are organized in other arrangements (e.g., singly rather than in pairs).

[0022] The end portions of the flexure arms 62 have mount regions 74 that are configured to be mounted to the mount regions 33 and 35 of the support member 12. Conductive traces 76 on the base layer 68 extend on the flexure arms 62 from the mount regions 74. In embodiments, the traces 76 also extend on the base layer 68 over portions of the plate 60. In the illustrated embodiment, the traces 76 also extend to contact pads 77 on the arms 72 on the plate 60. In the illustrated embodiment, the contact pads 77 are on platforms extending out of the major planar surface of the plate 60. The contact pads are at other locations (e.g., on the plate 60) in other embodiments (not shown). A layer of dielectric 78 is located between the conductive traces 76 and the base layer 68 to electrically insulate the traces from the base layer. Mount regions 74 include first and second mounting pads 80 and 82. Each mounting pad 82 includes an island or pad portion 84 in the base layer 68 that is electrically isolated from other portions of the base layer. Each trace 76 extends from the mounting pad 82, over (and electrically insulated from) the mounting pad 80. In the illustrated embodiment, the portions of traces 76 extending between the mounting pads 80 and 82 are enlarged over the portions of the traces on the flexure arms 62 to provide support for the island pad portions 84 in the base layer 68. The traces 76 extend to the island pad portions 84, and in embodiments are electrically connected to the island pad portions by electrical connections such as a plated or other via 86 that extends through the dielectric 78 at the mounting pad 82. Other embodiments include other electrical connections in place of or in addition to vias 86, such as conductive adhesive that extends between the trace 76 and island pad portion 84 over the edges of the dielectric 78. Mounting pad 80 includes a pad portion 90 in the base layer 68 that is electrically isolated from the trace 76 by the dielectric 78. In the illustrated embodiments, the portions of the traces 76 over the mounting pads 80 and 82 are circular and open in the center, but take other forms in other embodiments (not shown).

[0023] As perhaps best shown in FIGS. 1A and 7, the mount regions 74 of the moving member flexure arms 62 are mechanically attached to the mount regions 33 and 35 of the support member 12. The traces 76 on the flexure arms 62 are electrically connected to the associated traces 18 on the support member 12. In embodiments, the mechanical connections are made by welds between the pad portions 84 and 90 in the base layer 68 of the moving member 14 and the corresponding pad portions 44 and 48 in the base layer 16 of the support member 12. The welds can, for example, be made through the openings in the traces 76 at the pad portions 84 and 90. The welds also enable electrical connections between the pad portions 84 and 90 of the moving member 14 and the corresponding pad portions 44 and 48 of the support member 12. By these electrical connections, the metal base layer 68 of the moving member 14, and thereby the moving crimps 70, are electrically connected in common to an associated trace 18 (i.e., such as 18b through via 50). Similarly, each flexure arm trace 76 is electrically connected to an associated trace 18 (i.e., such as 18a through via 46). Other embodiments of the invention (not shown) have other structures for mechanically mounting the flexure arms 62 to the support member 12, and/or for electrically connecting the traces 76 on the flexure

arms to the associated traces **18** on the support member. In the illustrated embodiment, conductive metal regions **94** are located directly on the metal base layer **68** of the moving member **14** at the crimps **70** (i.e., there is no dielectric or other insulating material between the conductive metal regions and the metal base layer) to enhance the electrical connections between the metal base layer and the SMA wires **15** engaged by the crimps.

[0024] As described in greater detail below, the support member **12** and moving member **14** can be formed from additive and/or subtractive processes. Base layers **16** and/or **68** are stainless steel in embodiments. In other embodiments the base layers **16** and/or **68** are other metals or materials such as phosphor-bronze. Traces **18** and **76**, terminals **30** and contact pads **32** can be formed from copper, copper alloys or other conductors. Polyimide or other insulating materials can be used as the dielectric **20** and **78**. Other embodiments of the support member **12** and/or moving member **14** (not shown) have more or fewer traces **18** and **76**, and the traces can be arranged in different layouts. Structures other than crimps **24**, such as welds, can be used to attach the SMA wires **15** to the base layer **16**. Other embodiments of the invention (not shown) have more or fewer crimps **24** and **70**, and the crimps can be at different locations on the support member **12** and moving member **14**, respectively.

[0025] FIGS. **8-14** are annotated illustrations of an improved camera lens suspension assembly in accordance with embodiments of the invention. The suspension assembly has two primary components—a base or support member (referred to in FIGS. **8-14** as a static FPC (flexible printed circuit)), and a moving/spring member (referred to in the FIGS. **8-14** as a spring crimp circuit). Both the static FPC (base member) and the spring crimp circuit (moving member) are integrated lead structures in the illustrated embodiments, in that they have electrical structures such as leads, contact pads and terminals (e.g. in a copper “Cu” or copper alloy layer) formed on the base metal (stainless steel (SST)) in the illustrated embodiments). A layer of insulator (e.g., polyimide or “poly”) separates the portions of the electrical structures that are to be electrically isolated from the SST (other portions of the Cu layer are connected to or directly on the SST layer). At some locations, the electrical structures can be electrically connected to the SST layer by electrical connections (e.g., “vias”) extending from the Cu trace or lead layer to the SST layer through openings in the poly layer. In embodiments, a lens can be mounted to the spring crimp circuit. In yet other embodiments, an autofocus system supporting the lens can be mounted to the spring crimp circuit.

[0026] As noted above, the static FPC and spring crimp circuit can be formed from overlaying layers of base metal (e.g., a spring metal such as SST), poly and Cu (i.e., the “trace” layer). An insulating covercoat can be applied over all or portions of the Cu. Corrosion resistant metals such as gold (Au) and/or nickel (Ni) can be plated or otherwise applied to portions of the trace layer to provide corrosion resistance. Conventional additive deposition and/or subtractive processes such as wet (e.g., chemical) and dry (e.g., plasma) etching, electro plating and electroless plating and sputtering processes in connection with photolithography (e.g., use of patterned and/or unpatterned photoresist masks), as well as mechanical forming methods (e.g., using punches and forms) can be used to manufacture the static FPC and spring crimp circuit in accordance with embodiments of the invention. Additive and subtractive processes of these types are, for

example, known and used in connection with the manufacture of disk drive head suspensions, and are disclosed generally in the following U.S. patents, all of which are incorporated herein by reference for all purposes: Bennin et al. U.S. Pat. No. 8,885,299 entitled Low Resistance Ground Joints for Dual Stage Actuation Disk Drive Suspensions, Rice et al. U.S. Pat. No. 8,169,746 entitled Integrated Lead Suspension with Multiple Trace Configurations, Hentges et al. U.S. Pat. No. 8,144,430 entitled Multi-Layer Ground Plane Structures for Integrated Lead Suspensions, Hentges et al. U.S. Pat. No. 7,929,252 entitled Multi-Layer Ground Plane Structures for Integrated Lead Suspensions, Swanson et al. U.S. Pat. No. 7,388,733 entitled Method for Making Noble Metal Conductive Leads for Suspension Assemblies, Peltoma et al. U.S. Pat. No. 7,384,531 entitled Plated Ground Features for Integrated Lead Suspensions.

[0027] The static FPC is a one-piece member in the illustrated embodiment, and has two static crimps (attachment structures) on each of two diagonal corners of the member (4 static crimps in total). A terminal pad section includes terminal pads in the trace layer that are connected to traces that extend over the surface of the member. As shown for example, a separate trace extends to each of the four static crimps. At each of the static crimps is an electrical contact or terminal formed by the trace and poly layers. Formed dimples extending from the upper surface of the static FPC member engage the back surface of the spring crimp circuit member, and function as sliding interface bearings to enable low friction movement of the spring crimp circuit member with respect to the static FPC. The traces on the static FPC also couple terminal pads to electrical pad locations on the static FPC that are electrically and mechanically coupled to the spring crimp circuit member (e.g., to provide electrical signals to an auto focus (AF) assembly and to provide a common or ground signal path to the SST layer of the spring crimp circuit member. Vias couple the respective traces on the static FPC to portions of the SST layer that are connected to the feet.

[0028] The spring crimp circuit is a one-piece member in the illustrated embodiments and includes a central member for supporting a lens or auto focus system, and one or more spring arms (two in the illustrated embodiment) extending from the central member. The spring crimp member has two moving crimps on each of two diagonal corners of the member (4 moving crimps in all). Pedestals or feet in the SST layer (on the ends of the spring arms opposite the central member in the illustrated embodiment) are configured to be welded or otherwise attached to corresponding locations on the static FPC. Traces on the spring crimp member are configured to be electrically coupled to traces on the static FPC (e.g., through the feet) and couple signals to terminal pads such as the auto focus (AF) terminal pads. In the illustrated embodiment, the SST layer of the spring crimp circuit is used as a signal path to the ends of the SMA wires attached to the moving crimps. Electrical connection between the corresponding terminal pad and trace on the static FPC to the SST layer of the spring crimp circuit is provided by the connection between the feet of the spring arms and the SST layer of the static FPC (i.e., the SST layers of the two members are electrically coupled, and are at a common ground potential in embodiments).

[0029] Suspensions in accordance with the invention having traces on the moving member flexure arms offer important advantages. They can for example, be efficiently fabricated and assembled. The traces are effective structures for

coupling electrical signals to structures mounted to the plate or other portions of the moving member.

[0030] Although the invention has been described with reference to preferred embodiments, those of skill in the art will recognize that changes can be made in form and detail without departing from the spirit and scope of the invention. For example, although the illustrated embodiments include the traces on the sides of the flexure arms opposite the support member (i.e., on the top side of the traces), other embodiments can alternatively or in addition include traces on the sides of the flexure arms facing the moving member (i.e., on the bottom side of the traces).

1. A suspension assembly, comprising:
 - a support member, including:
 - a metal base layer;
 - conductive traces on the base layer;
 - dielectric between the base layer and the traces of the support member; and
 - a shape memory alloy wire attach structure; and
 - a moving member coupled to the support member including:
 - a plate;
 - flexure arms extending from the plate and coupled to the support member;
 - a metal base layer, wherein the plate and flexure arms include the metal base layer;
 - conductive traces on the base layer of the flexure arms, wherein the conductive traces on the flexure arms are electrically connected to the conductive traces on the support member;
 - dielectric between the base layer and the traces of the moving member; and
 - a shape memory alloy wire attach structure.
2. The suspension assembly of claim 1 wherein the moving member further includes conductive traces on the base layer of the plate, and wherein the conductive traces on the plate extend from the conductive traces on the flexure arms.
3. The suspension assembly of claim 1 wherein the flexure arms are elongated members extending from a periphery of the plate.
4. The suspension assembly of claim 1 wherein:
 - the flexure arms include mount regions on ends opposite the plate;
 - the support member includes mount regions; and
 - the mount regions of the flexure arms are attached to the mount regions of the support member.
5. The suspension assembly of claim 4 wherein the metal base layer of the flexure arm mount regions is mechanically and electrically attached to the metal base layer of the associated support member mount regions.
6. The suspension assembly of claim 4 wherein:
 - the support member has a first mount region and includes:
 - a first pad portion in the metal base layer at the first mount region, wherein the first pad portion is an island;
 - a first trace of the support member traces extending to the first pad portion at the mount region; and
 - a first support member electrical connection between the first pad portion and the first trace of the support member, wherein the first support member electrical connection is optionally a via through the dielectric on the support member; and
 - the moving member has a first flexure arm having a first flexure arm mount region and includes:

- a first pad portion in the metal base layer of the first flexure arm mount region, wherein the first pad portion in the metal base layer of the first flexure arm mount region is an island, and is mechanically and electrically coupled, optionally by a weld, to the first pad portion in the metal base layer at the first mount region of the support member;
 - a first trace of the first flexure arm extending to the first pad portion of the first flexure arm mount region; and
 - a first arm trace electrical connection between the first pad portion and the first trace of the first flexure arm mount region, wherein the first arm trace electrical connection is optionally a via through the dielectric on the moving member.
7. The suspension assembly of claim 6 wherein the first flexure arm is an elongated member extending from a periphery of the plate.
8. The suspension assembly of claim 7 wherein the wire attach structure of the moving member is unitary with the plate and includes the metal base layer of the moving member.
9. The suspension assembly of claim 8 wherein the wire attach structure of the support member includes the metal base layer of the support member.
10. The suspension assembly of claim 6 wherein:
 - the support member includes:
 - a second pad portion in the metal base layer at the first mount region;
 - a second trace of the support member traces extending to the second pad portion at the first mount region; and
 - a second support member electrical connection between the second pad portion and the second trace of the support member, wherein the second support member electrical connection is optionally a via through the dielectric on the support member; and
 - the moving member includes a second pad portion in the metal base layer of the first flexure arm mount region, wherein the second pad portion is mechanically and electrically coupled, optionally by a weld, to the second pad portion in the metal base layer at the first mount region of the support member.
11. The suspension assembly of claim 10 wherein the first flexure arm is an elongated member extending from a periphery of the plate.
12. The suspension assembly of claim 11 wherein the wire attach structure of the moving member is unitary with the plate and includes the metal base layer of the moving member.
13. The suspension assembly of claim 12 wherein the wire attach structure of the support member includes the metal base layer of the support member.
14. The suspension assembly of claim 10 wherein:
 - the support member has a second mount region and includes:
 - a third pad portion in the metal base layer at the second mount region, wherein the third pad portion is an island;
 - a third trace of the support member traces extending to the third pad portion at the second mount region;
 - a third support member electrical connection between the third pad portion and the third trace at the second mount region, wherein the third support member electrical connection is optionally a via through the dielectric on the support member;

- a fourth pad portion in the metal base layer at the second mount region;
 - a fourth trace of the support member traces extending to the fourth pad portion at the second mount region; and
 - a fourth support member electrical connection between the fourth pad portion and the fourth trace of the support member, wherein the fourth support member electrical connection is optionally a via through the dielectric on the support member; and
- the moving member has a second flexure arm having a flexure arm mount region and includes:
- a first pad portion in the metal base layer of the second flexure arm mount region, wherein the first pad portion in the metal base layer of the second flexure arm mount region is an island, and is mechanically and electrically coupled, optionally by a weld, to the third pad portion in the metal base layer at the second mount region of the support member;
 - a first trace of the second flexure arm extending to the first pad portion of the second flexure arm mount region;
 - a first trace electrical connection between the first pad portion of the second flexure arm mount region and the first trace of the second flexure arm, wherein the first trace electrical connection is optionally a via through the dielectric on the moving member;
 - a second pad portion in the metal base layer of the second flexure arm mount region, wherein the second pad portion is mechanically and electrically coupled, optionally by a weld, to the fourth pad portion in the metal base layer at the second mount region of the support member.

15. The suspension assembly of claim **14** wherein the first and second flexure arms are elongated members extending from a periphery of the plate.

16. The suspension assembly of claim **15** wherein the wire attach structure of the moving member is unitary with the plate and includes the metal base layer of the moving member.

17. The suspension assembly of claim **16** wherein the wire attach structure of the support member includes the metal base layer of the support member.

- 18.** The suspension assembly of claim **4** wherein:
- the support member has a first mount region and includes:
 - a first pad portion in the metal base layer at the first mount region;
 - a first trace of the support member traces extending to the first pad portion at the first mount region; and
 - a first support member electrical connection between the first pad portion and the first trace of the support member, wherein the first support member electrical connection is optionally a via through the dielectric on the support member; and

- the moving member has a first flexure arm having a flexure arm mount region and includes:
 - a first pad portion in the metal base layer of the first flexure arm mount region, wherein the first pad portion is mechanically and electrically coupled, optionally by a weld, to the first pad portion in the metal base layer at the first mount region of the support member.

19. The suspension assembly of claim **18** wherein the first flexure arm is an elongated member extending from a periphery of the plate.

20. The suspension assembly of claim **19** wherein the wire attach structure of the moving member is unitary with the plate and includes the metal base layer of the moving member.

21. The suspension assembly of claim **20** wherein the wire attach structure of the support member includes the metal base layer of the support member.

22. The suspension assembly of claim **1** wherein the wire attach structure of the moving member is unitary with the plate and includes the metal base layer of the moving member.

* * * * *