



(51) International Patent Classification:

A61B 1/00 (2006.01) H04N 5/77 (2006.01)
A61B 1/05 (2006.01) H04N 5/91 (2006.01)
A61B 1/06 (2006.01) A61B 1/015 (2006.01)

(21) International Application Number:

PCT/US2017/018287

(22) International Filing Date:

17 February 2017 (17.02.2017)

(25) Filing Language:

English

(26) Publication Language:

English

(30) Priority Data:

62/299,332 24 February 2016 (24.02.2016) US

(71) Applicant: ENDOCHOICE, INC. [US/US]; 11405 Old Roswell Rd., Alpharetta, GA 30009 (US).

(72) Inventors: KRIVOPISK, Leonid; Hashita 1/6, 3680001 Neshet (IL). AIZENFELD, Amram; Ramot Menashe, 1924500 Ramot Menashe (IL). SALMAN, Golan; Halochemim 108, 3030000 Atlit (IL).

(74) Agent: DALAL, Sona; Novel IP, 191 West Second Street, Santa Ana, CA 92701 (US).

(81) Designated States (unless otherwise indicated, for every kind of national protection available): AE, AG, AL, AM, AO, AT, AU, AZ, BA, BB, BG, BH, BN, BR, BW, BY, BZ, CA, CH, CL, CN, CO, CR, CU, CZ, DE, DJ, DK, DM, DO, DZ, EC, EE, EG, ES, FI, GB, GD, GE, GH, GM, GT, HN, HR, HU, ID, IL, IN, IR, IS, JP, KE, KG, KH, KN, KP, KR, KW, KZ, LA, LC, LK, LR, LS, LU, LY, MA, MD, ME, MG, MK, MN, MW, MX, MY, MZ, NA, NG, NI, NO, NZ, OM, PA, PE, PG, PH, PL, PT, QA, RO, RS, RU, RW, SA, SC, SD, SE, SG, SK, SL, SM, ST, SV, SY, TH, TJ, TM, TN, TR, TT, TZ, UA, UG, US, UZ, VC, VN, ZA, ZM, ZW.

(84) Designated States (unless otherwise indicated, for every kind of regional protection available): ARIPO (BW, GH, GM, KE, LR, LS, MW, MZ, NA, RW, SD, SL, ST, SZ, TZ, UG, ZM, ZW), Eurasian (AM, AZ, BY, KG, KZ, RU, TJ, TM), European (AL, AT, BE, BG, CH, CY, CZ, DE, DK, EE, ES, FI, FR, GB, GR, HR, HU, IE, IS, IT, LT, LU, LV, MC, MK, MT, NL, NO, PL, PT, RO, RS, SE, SI, SK, SM, TR), OAPI (BF, BJ, CF, CG, CI, CM, GA, GN, GQ, GW, KM, ML, MR, NE, SN, TD, TG).

Published:

— with international search report (Art. 21(3))

(54) Title: CIRCUIT BOARD ASSEMBLY FOR A MULTIPLE VIEWING ELEMENT ENDOSCOPE USING CMOS SENSORS

Figure 5

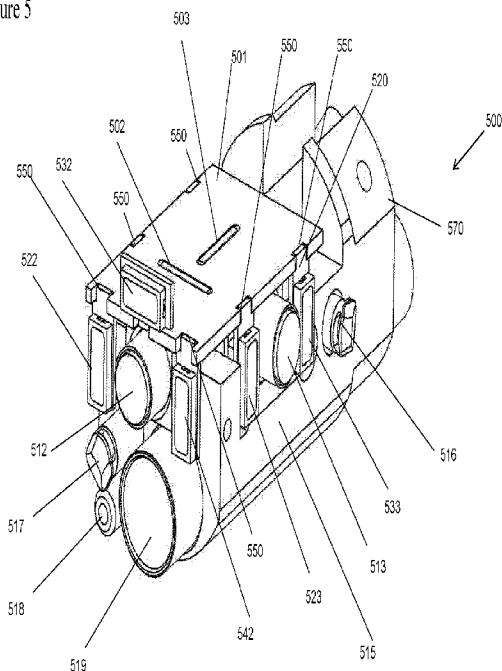

(57) Abstract: A circuit board design uses CMOS sensors for the tip section of a multi-viewing element endoscope. Side sensors and their optical assemblies are assembled to a common base board to save space. Individual base boards are separately constructed, inserted into grooves of a main base board, and are further connected to the main base board by means of flexural circuit boards.

**CIRCUIT BOARD ASSEMBLY FOR A MULTIPLE VIEWING ELEMENT
ENDOSCOPE USING CMOS SENSORS**

CROSS-REFERENCE

5 The present specification relies on, for priority, United States Patent Provisional Application Number 62/299,332, entitled “Circuit Board Assembly for a Multi-Viewing Element Endoscope Using CMOS Sensors”, filed on February 24, 2016.

 The present application relates to United States Patent Application Number 14/469,481, entitled “Circuit Board Assembly of a Multiple Viewing Elements Endoscope”,
10 filed on August 26, 2014, which relies on United States Provisional Patent Number 61/987,984, entitled Circuit Board Assembly of An Endoscope, and filed on May 2, 2014; United States Provisional Patent Number 61/935,647, of the same title and filed on February 4, 2014, and United States Provisional Patent Number 61/881,661, of the same title and filed on September 24, 2013, for priority.

15 The present application also relates to United States Patent Application Number 13/882,004, entitled “Optical Systems for Multi-Sensor Endoscopes” and filed on May 23, 2013, which is a 371 National Stage Entry of PCT Application Number PCT/IL2011/000832, of the same title and filed on October 27, 2011, which, relies upon United States Provisional Patent Application Number 61/407,495, filed on October 28, 2010, for priority.

20 The present specification also relates to United States Patent Application Number 13/992,014, entitled “Flexible Electronic Circuit Board for a Multi-Camera Endoscope” and filed on June 6, 2013, which is a 371 National Stage Entry of PCT Application Number PCT/IL2011/050049, of the same title and filed on December 8, 2011, which relies upon United States Provisional Patent Application Number 61/421,238, filed on December 9,
25 2010, for priority.

 The present specification also relates to United States Patent Application Number 13/992,021, entitled “Fluid Channeling Component of a Multi-Camera Endoscope” and filed on June 6, 2013, which is a 371 National Stage Entry of PCT Application Number PCT/IL2011/050050, entitled “Flexible Electronic Circuit Board Multi-Camera Endoscope”
30 and filed on December 8, 2011, which relies upon United States Provisional Patent Application Number 61/421,240, filed on December 9, 2010, for priority.

 The present application also relates to the following United States Patent Applications:

United States Patent Application Number 13/655,120, entitled “Multi-Camera Endoscope” and filed on October 18, 2012; United States Patent Application Number 13/212,627, entitled “Multi-Viewing Element Endoscope” and filed on August 18, 2011; and United States Patent Application Number 14/746,986, entitled “Multi-Camera Endoscope” and filed on January 21, 2016, which is a continuation of United States Patent Number 9,101,268, entitled “Multi-Camera Endoscope”, and issued on August 11, 2015, all of which are continuation-in-part applications of United States Patent Application Number 13/119,032, entitled “Multi-Camera Endoscope” and filed on July 15, 2011, which is a 371 National Stage Entry of PCT Application Number PCT/IL2010/000476, of the same title and filed on June 16, 2010, which relies upon United States Provisional Patent Application Number 61/218,085, for priority.

All of the above-mentioned applications are herein incorporated by reference in their entirety.

15 **FIELD**

The present specification relates generally to endoscopes, and more specifically, to a circuit board assembly for the tip section of a multiple viewing element endoscope that uses CMOS image sensors for capturing images.

20 **BACKGROUND**

Endoscopes have attained great acceptance within the medical community, since they provide a means for performing procedures, while enabling the physician to view the internal anatomy of the patient. Over the years, numerous endoscopes have been developed and categorized according to use in specific applications, such as cystoscopy, colonoscopy, laparoscopy, upper GI endoscopy among others. Endoscopes may be inserted into the body's natural orifices or through an incision in the skin.

An endoscope typically comprises an elongated tubular shaft, rigid or flexible, having a video camera or a fiber optic lens assembly at its distal end. The shaft is connected to a handle, which sometimes includes an ocular for direct viewing. Viewing is also usually possible via an external screen. Various surgical tools may be inserted through a working channel in the endoscope for performing different surgical procedures.

One disadvantage of existing endoscopes is their limited field of view. A limited field of view may not allow a physician to analyze an area under inspection in full detail. This in turn affects the rate of detection of pathological objects that exist in the body cavity in which

the endoscope operates. For example, clinical literature shows that the average adenoma miss rate is over 24%. That is, detection of cancer is missed in more than 24 of every 100 patients. Further, from a medical industry viewpoint, unless a physician is correctly identifying cancer in at least 20% of cancer patients, the average miss rate is considered higher than industry.

5 Therefore, there is a need in the art for endoscopes that allow a broader field of view. One approach to achieving this purpose is described in U.S. Patent Application No. 2011/0263938, which describes the use of multiple cameras or viewing elements in a single endoscope and is incorporated herein by reference.

10 In most embodiments of multi-camera endoscopes, CCD sensors are used as imagers in the circuit board assembly of the endoscope tip. As known in the art, CCD sensors generate analog signals while CMOS sensors generate digital signals. In a CCD sensor, every pixel's charge is transferred through a limited number of output nodes, often just one, to be converted to voltage, buffered, and sent off-chip as an analog signal. In a CMOS sensor on the other hand, each pixel has its own charge-to-voltage conversion, and the sensor often also
15 includes amplifiers, noise-correction, and digitization circuits, so that the chip outputs digital signals. With each pixel doing its own conversion, each pixel can be accessed concurrently, thereby allowing high total bandwidth and high speed. Thus, while a CCD interface is analog and requires synchronization signals and more circuitry at the end point, CMOS is only driven by power input and generates high speed digital video interface. The use of CCD
20 sensors requires electronics for digitizing pixels and for image processing, while CMOS sensors already contain the main blocks for digitization in the chip and require only software based processing for the images. CMOS sensor technology in recent years has leapfrogged CCDs owing to better performance, and the cost of CMOS sensors has become much lower due to a more advanced production process.

25 Therefore, there is a need in the art to simplify the electrical interface of the circuit board assembly used in the tip of multi viewing element endoscopes, such that it can employ CMOS sensors and support a digital interface. Such endoscopes would allow for easy control of the imagers as well as the image processing technique, while also providing a broader field of view compared to conventional single imager endoscopes. There is also need for a method
30 of assembling CMOS sensors in the tip of multiple viewing element endoscopes so as to occupy minimum space in the limited space environment of the tip section.

SUMMARY

The present specification describes a circuit board design that uses CMOS sensors within the tip section of a multiple viewing elements endoscope. In one embodiment, sensors and optical assemblies, associated with at least one side viewing element, are assembled on a common base board. In another embodiment, a dedicated base board is provided for each of the front and side sensors and their corresponding optical assemblies. The individual base boards are connected to the main base board by means of flexible circuit boards.

The present specification discloses a circuit board assembly for use in a tip section of a multi-viewing element endoscope, said tip comprising a front pointing viewing element and at least one side pointing viewing element, wherein each viewing element comprises an image sensor and a lens assembly, said circuit board assembly comprising: a first base board to which the front pointing viewing element is connected; a second base board, wherein the at least one side pointing viewing element is connected to a first side of the second base board; and a third base board to which said first and said second base boards are connected, wherein said first and said second base boards are placed perpendicular to said third base board.

Optionally, the tip section comprises a second side pointing viewing element facing a direction opposite to the at least one side pointing viewing element, wherein the second side pointing viewing element is connected to a second side of the second base board and wherein the first side of the second base board is opposite the second side of the second base board.

Optionally, each image sensor is a CMOS sensor comprising a first optics portion coupled with a second chip portion having a plurality of connector pins.

Optionally, the second chip portion of the CMOS sensor is connected to the first side of the second base board or the second side of the second base board by said plurality of connector pins.

Optionally, said first and said second base boards are positioned perpendicular to each other.

Optionally, said first base board is coupled to a metal frame which is configured to hold the lens assembly of the front pointing viewing element.

Optionally, said second base board is coupled to at least one metal frame, wherein the metal frame is configured to hold the at least one side lens assembly. Optionally, said metal frame is configured as heat sinks.

Optionally, each of the front and side pointing viewing elements is associated with at least one illuminator, and wherein said circuit board assembly comprises a separate circuit board to hold each of the at least one illuminators.

Optionally, said third base board comprises grooves adapted to receive said first base board and said second base board.

The present specification also discloses a circuit board assembly for the tip of a multi-viewing element endoscope, said tip comprising a front pointing viewing element, a first side pointing viewing element, and a second side pointing viewing element, wherein each viewing element comprises an image sensor and a lens assembly, said circuit board assembly comprising: a first base board to which the front pointing viewing element is connected; a second base board to which a first side pointing viewing element is connected; a third base board to which a second side pointing viewing element is connected; and, a fourth base board having three grooves, wherein each of said three grooves are adapted to receive one of said first, second and third base boards and wherein each of said first, second and third base boards are placed perpendicular to said fourth base board.

Optionally, each image sensor is a CMOS sensor.

Optionally, each of said first, second and third base boards is further connected to said fourth base board by a flexible circuit board.

Optionally, said second and said third base boards are positioned parallel to each other.

Optionally, said second and said third base boards are positioned perpendicular to the first base board.

Optionally, the circuit board assembly further comprises a front illuminator circuit board.

Optionally, said front illuminator circuit board is shaped as a “U” and is configured to hold three illuminators associated with the front pointing viewing element.

Optionally, the circuit board assembly further comprises two side illuminator circuit boards.

Optionally, each of the two side illuminator circuit boards is shaped as a “U” and is configured to hold two illuminators associated with the first side pointing viewing element and the second side pointing viewing element.

Optionally, the length of the front illuminator circuit board ranges from 5.5 mm to 11.5 mm and the height of the front illuminator circuit board ranges from 2.0 mm to 8.5 mm.

Optionally, the length of each of the side illuminator circuit boards ranges from 5.5 mm to 11.5 mm and the height of each of the side illuminator circuit boards ranges from 1.0 mm to 7.5 mm.

The aforementioned and other embodiments of the present shall be described in greater depth in the drawings and detailed description provided below.

BRIEF DESCRIPTION OF THE DRAWINGS

5 These and other features and advantages of the present invention will be appreciated, as they become better understood by reference to the following detailed description when considered in connection with the accompanying drawings, wherein:

Figure 1 illustrates a multiple viewing element endoscopy system;

Figure 2 is a cross-sectional view of a tip section of a multiple viewing element endoscope;

10 Figure 3 illustrates an outer design of the tip of an endoscope, in accordance with an embodiment;

Figure 4 illustrates a configuration of an endoscope tip where two base boards are used to support an optical assembly and illuminators;

15 Figure 5 illustrates a base board assembly with CMOS sensors, according to one embodiment of the present specification;

Figure 6a is a side view of an exemplary CMOS image sensor comprising an image sensor contact area, in accordance with an embodiment of the present specification;

Figure 6b is a front view of an exemplary CMOS image sensor comprising an image sensor contact area, shown in Figure 6a;

20 Figure 7 is a bottom view of a base board adapted to support the optical assembly and illuminators of an endoscope, according to one embodiment;

Figure 8 illustrates another perspective view of the circuit board design, according to one embodiment of the present specification;

25 Figure 9 illustrates another exemplary design of the base board assembly with CMOS sensors, according to one embodiment of the present specification;

Figure 10 illustrates another base board assembly with CMOS sensors, according to one embodiment of the present specification;

Figure 11 illustrates front illuminators on a substrate, in accordance with an embodiment of the present specification,

30 Figure 12 illustrates side illuminators on a substrate, in accordance with an embodiment of the present specification; and

Figure 13 is a flowchart illustrating the steps of assembling front and side optical assemblies and sensors in an endoscope tip, in accordance with an embodiment of the present specification.

DETAILED DESCRIPTION

5 In one embodiment, the present specification discloses a circuit board design for the tip of an endoscope system that uses CMOS sensors as imagers. The circuit board design not only makes more efficient use of the space inside the distal tip, which is crowded with components, but also reduces the cost of the assembly and makes the design easier to scale compared to existing circuit board designs for multiple viewing element endoscopes. With
10 the use of CMOS sensors, digital signals are obtained directly from the sensors and the endoscope system is not limited to the signal processing method directed by the sensor chipset, as is the case where CCD sensors are used. Thus, with the use of CMOS sensors, any image processing technique may be employed that is suitable for the specific clinical environment in which the endoscope is used. Further, the attributes of imagers, such as
15 exposure time, integration time, frame rate and multi-camera synchronization can be more readily controlled along with the image processing. As CMOS sensors support high bandwidth, high resolution images can be generated during endoscopic procedures.

In an embodiment, the present specification provides a circuit board assembly to be fitted within a tip section of a multi-viewing endoscope, wherein the circuit board assembly is
20 capable of accommodating both CCD and CMOS sensors. The use of CMOS sensors within endoscopes allows for easier control of the imagers as well as the image processing technique.

In another embodiment of the present specification, a circuit board assembly comprising one or more front and side facing CMOS sensors is provided for fitting into a tip
25 section of a multi-viewing endoscope, providing a broader field of view compared to conventional single imager endoscopes. The circuit board assembly comprises two CMOS sensors connected to a single base board for conserving space in the tip section (as shown in Figure 8).

In another embodiment, the present specification provides a circuit assembly
30 comprising three CMOS sensors, each being connected to a separate base board, and each base board being connected to a main base board by means of a dedicated flexible circuit board or flex board (as shown in Figure 9). The use of a flex board is advantageous in a multi-viewing element endoscope, given the shortage of space in the tip as a result of the

presence of multiple viewing elements. The flex board provides additional freedom of movement to the assembly process in a space constrained environment.

The present specification is directed towards multiple embodiments. The following disclosure is provided in order to enable a person having ordinary skill in the art to practice the invention. Language used in this specification should not be interpreted as a general disavowal of any one specific embodiment or used to limit the claims beyond the meaning of the terms used therein. The general principles defined herein may be applied to other embodiments and applications without departing from the spirit and scope of the invention. Also, the terminology and phraseology used is for the purpose of describing exemplary embodiments and should not be considered limiting. Thus, the present invention is to be accorded the widest scope encompassing numerous alternatives, modifications and equivalents consistent with the principles and features disclosed. For purpose of clarity, details relating to technical material that is known in the technical fields related to the invention have not been described in detail so as not to unnecessarily obscure the present invention.

In the description and claims of the application, each of the words "comprise" "include" and "have", and forms thereof, are not necessarily limited to members in a list with which the words may be associated. It should be noted herein that any feature or component described in association with a specific embodiment may be used and implemented with any other embodiment unless clearly indicated otherwise.

Reference is now made to Figure 1, which shows a multiple viewing element endoscopy system 100. System 100 may include a multiple viewing element endoscope 102. Multiple viewing element endoscope 102 may include a handle 104, from which an elongated shaft 106 emerges. Elongated shaft 106 terminates with a tip section 108 which is turnable by way of a bending section 110. Handle 104 may be used for maneuvering elongated shaft 106 within a body cavity. The handle may include one or more buttons and/or knobs and/or switches 105 which control bending section 110 as well as functions such as fluid injection and suction. Handle 104 may further include at least one, and in some embodiments, one or more working channel openings 112 through which surgical tools may be inserted as well as one and more side service channel openings.

A utility cable 114, also referred to as an umbilical tube, may connect between handle 104 and a Main Control Unit 199. Utility cable 114 may include therein one or more fluid channels and one or more electrical channels. The electrical channel(s) may include at least one data cable for receiving video signals from the front and side-pointing viewing elements,

as well as at least one power cable for providing electrical power to the viewing elements and to the discrete illuminators.

The main control unit 199 contains the controls required for displaying the images of internal organs captured by the endoscope 102. The main control unit 199 may govern power transmission to the endoscope's 102 tip section 108, such as for the tip section's viewing elements and illuminators. The main control unit 199 may further control one or more fluid, liquid and/or suction pump(s) which supply corresponding functionalities to the endoscope 102. One or more input devices 118, such as a keyboard, a touch screen, a voice controller and the like may be connected to the main control unit 199 for the purpose of user interaction with the main control unit 199. In the embodiment shown in Figure 1, the main control unit 199 comprises a screen/display 120 for displaying operation information concerning an endoscopy procedure when the endoscope 102 is in use. The screen 120 may be configured to display images and/or video streams received from the viewing elements of the multi-viewing element endoscope 102. The screen 120 may further be operative to display a user interface for allowing a human operator to set various features of the endoscopy system.

Optionally, the video streams received from the different viewing elements of the multi-viewing element endoscope 102 may be displayed separately on at least one monitor (not seen) by uploading information from the main control unit 199, either side-by-side or interchangeably (namely, the operator may switch between views from the different viewing elements manually). Alternatively, these video streams may be processed by the main control unit 199 to combine them into a single, panoramic video frame, based on an overlap between fields of view of the viewing elements. In an embodiment, two or more displays may be connected to the main control unit 199, each for displaying a video stream from a different viewing element of the multi-viewing element endoscope 102. The main control unit 199 is described in United States Patent Application Number 14/263,896, entitled "Method and System for Video Processing in a Multi-Viewing Element Endoscope" and filed on April 28, 2014, which is herein incorporated by reference in its entirety.

Reference is now made to Figure 2, which shows a cross-sectional view of a tip section 262 of a multi-viewing element endoscope, according to another embodiment of the specification. Tip section 262 may include a front-pointing image sensor 269, such as a Complementary Metal Oxide Semiconductor (CMOS) image sensor. Front-pointing image sensor 269 may be mounted on an integrated circuit board 279, which may be rigid or flexible. Integrated circuit board 279 may be employed to supply front-pointing image sensor 269 with the necessary electrical power and may derive still images and/or video feeds

captured by the image sensor. Integrated circuit board 279 may be connected to a set of electrical cables which may be threaded through an electrical channel running through the elongated shaft of the endoscope. Front-pointing image sensor 269 may have a lens assembly 281 mounted on top of it for providing the necessary optics for receiving images.

5 Lens assembly 281 may include a plurality of lenses, static or movable, which may provide a field of view of at least 90 degrees and up to essentially 180 degrees. In one embodiment, lens assembly 281 may provide a length over which an object remains in focus of about 3 to 100 millimeters. It should be appreciated that the term focal length may be used to refer to the distance from a lens to a sensor or may be used to refer to the distance, from
10 the lens, over which an object remains in focus. One of ordinary skill in the art would understand what definition for focal length is being used based on the context and distances discussed.

 Front-pointing image sensor 269 and lens assembly 281, with or without integrated circuit board 279, may be jointly referred to as a “front-pointing camera”. One or more
15 discrete front illuminators 283 may be placed next to lens assembly 281, for illuminating its field of view. In an alternate embodiment, discrete front illuminators 283 may also be attached to the same integrated circuit board 279 upon which front-pointing image sensor 269 is mounted.

 Tip section 262 may optionally include, in addition to a first side-pointing image sensor
20 285, a second side-pointing image sensor 264. While Figure 2 is discussed herein with respect to an embodiment with two side-pointing image sensors, it should be understood to those of ordinary skill in the art, that, in some embodiments, only one side pointing image sensor may be used.

 Referring back to Figure 2, side-pointing image sensors 285 and 264 may include a
25 Complementary Metal Oxide Semiconductor (CMOS) image sensor. Side-pointing image sensors 285 and 264 may be mounted on integrated circuit boards 287 and 266, respectively, which may be rigid or flexible. Integrated circuit boards 287 and 266 supply side-pointing image sensors 285 and 264 with the necessary electrical power and derive still images and/or video feeds captured by the image sensor. Integrated circuit boards 287 and 266 are
30 connected to a set of electrical cables (not shown) which may be threaded through an electrical channel running through the elongated shaft of the endoscope.

 In another embodiment, side-pointing image sensors 285 and 264 receive the necessary electrical power from one integrated circuit board adapted to supply the necessary electrical power to both the sensors.

Side-pointing image sensors 285 and 264 have lens assemblies 268 and 274, respectively, mounted thereto for providing the necessary optics for receiving images. Lens assemblies 268 and 274 may include a plurality of lenses, static or movable, which provide a field of view of at least 90 degrees and up to essentially 180 degrees. Side-pointing image sensors 285 and 264 and lens assemblies 268 and 274, with or without integrated circuit boards 287 and 266, respectively, may be jointly referred to as a “side-pointing cameras”.

Discrete side illuminators 276 and 289 may be placed next to lens assemblies 268 and 274, respectively, for illuminating its field of view. Optionally, in an alternate embodiment, discrete side illuminators 276 and 289 may be attached to the same integrated circuit boards 287 and 266 on which side-pointing image sensors 285 and 264 are mounted.

In another configuration, integrated circuit boards 279, 287, and 266 may be a single integrated circuit board on which front and side-pointing image sensors 269, 285, and 264, respectively, are mounted.

Front and side-pointing image sensors 269, 285, and 264 may be similar, identical or distinct in terms of, for example, field of view, resolution, light sensitivity, pixel size, focal length, focal distance and/or the like.

Figure 3 illustrates the outer design of the tip of an endoscope, in accordance with an embodiment. Referring to Figure 3, a side panel 302 is positioned on a side of the endoscope tip 300. The side panel 302 comprises an outer optical window 304, transparent surfaces, windows, optical windows or openings 306, 308, and a side nozzle 310. The outer optical window 304 is positioned on the circumference of the endoscope tip at a distance ranging from approximately 1 to 15 millimeters from the surface of the tip 300, and in an embodiment is positioned at approximately 7.0 or 9.0 millimeters, from the surface of the tip 300.

A front panel 312 is positioned on a front end of the endoscope tip 300. The front panel 312 comprises an optical window 314, transparent surfaces, windows, optical window or openings 316, 318, 320, a working/service channel opening 322, a nozzle opening 324 and a jet opening 326. In one embodiment, the diameter of the front working/service channel ranges from approximately 2.8 to 5.8 millimeters.

It may be noted that a base board, which in one embodiment is an electronic circuit board/printed circuit board, is associated with a fluid channeling component and adapted to support the optical assembly and illuminators of an endoscope. Thus, tip section of the endoscope may include a tip cover, an electronic circuit board assembly and a fluid channeling component. According to some embodiments, fluid channeling component may

be configured as a separate component from electronic circuit board assembly. This configuration may be adapted to separate the fluid channels, such as a side service channel, and at least one front working/service channel, which are located in fluid channeling component, from the sensitive electronic and optical parts which may be located in the area of electronic circuit board assembly. Thus, the component structure of the tip section enables effective isolation of the plurality of electronic elements from the plurality of fluid channels.

A particular challenge arises when attempting to package the tip cover, electronic circuit board assembly and fluid channeling component such that they fit within the minimalistic space available inside the tip section, while still providing the required results. Thus, a significant problem exists in the art when attempts are made to pack all necessary components into the small inner volume of the endoscope. This problem dramatically increases when two or more viewing elements and respective illumination sources (such as LEDs) are packed in the tip of the endoscope.

Figure 4 illustrates a configuration of an endoscope tip where two base boards are used to support the optical assembly and illuminators, where CCD sensors are employed. Referring to Figure 4, an upper base board 402 and a lower base board 404 in combination, form an electronic circuit board/printed circuit board and support the optical assembly and illuminators. The front optical assembly comprises a front lens assembly 406 and a front image sensor, typically a CCD sensor. The side optical assembly comprises a side lens assembly 414 and a side image sensor, typically a CCD sensor. The front image sensor's connector pins and contact area 420 are manipulated, including being cut, bent or folded, to be soldered to the upper base board 402 and lower base board 404. The side image sensors' connector pins and contact areas 422 and 424 (for the right and left side image sensors, respectively) are bent to be soldered to the upper base board 402 and lower base board 404. The upper base board 402 and the lower base board 404 have grooves/holes enabling the front and side illuminators to be placed within the grooves/holes. The upper and lower base boards 402, 404 hold three sets of front illuminators 408, 410, 412 and on each side panel two sets of illuminators 416, 418 (the figure illustrates only one first side panel of the endoscope, however it should be understood by those of ordinary skill in the art that the second side panel is equivalent to this side panel). Front illuminators 408, 412 are placed between the upper and lower base boards 402, 404, while front illuminator 410 is placed above front lens assembly 406. The two sets of illuminators 416, 418 are placed between the upper and lower base boards 402, 404.

As shown in Figure 4, jet opening 426 and nozzle opening 424' may be positioned adjacent to each other on front panel of the tip. Alternately, the openings may be positioned on either side of the working/service channel opening 422' on the front panel of the tip.

In order to make more efficient use of the limited space available within the tip, in 5 embodiments of the present specification, a CMOS sensor is employed in a novel circuit board design that eliminates the need of having two base boards (the upper base board 402 and lower base board 404) as described above. By reducing the number of base boards required from two to one, the present specification offers a more efficient design for the tight architecture of the distal tip of an endoscope.

10 Figure 5 illustrates one embodiment of a base board assembly for housing CMOS sensors-based components. Referring to Figure 5, a base board 501 is associated with a fluid channeling component 570 and is adapted to support the optical assembly and illuminators in an endoscope tip 500. In one embodiment, base board 501 comprises grooves 502 and 503, in which two smaller sections of the baseboard, also referred to as sensor base boards may be 15 placed. A first sensor base board section houses a front sensor and may be placed into groove 502 while a second sensor base board section houses at least one side sensor and is placed into groove 503.

In various embodiments, the base board 501 is provided with grooves/holes 550 for the front illuminators 522, 532, 542 and for the first set of side illuminators 523, 533 and the 20 second set of side illuminators (not shown) to be placed within. In one embodiment grooves 550 are identical for all illuminators, while in another embodiment each of the grooves may be adapted for different sizes of illuminators. For example, different types of illuminators may comprise LEDs (Light Emitting Diode) adapted to emit white light, infrared light, ultraviolet light, near-infrared light and other wavelengths of light and each type of 25 illuminator may have a different size.

In one embodiment, a separate circuit board, such as circuit board 520 (described in greater detail with respect to Figure 7 as 720), may be provided to hold each of the illuminators. Thus, for example in an endoscope tip having seven (7) illuminators, three on the front and two on each side, seven (7) separate circuit boards adapted to hold the seven 30 illuminators may be provided. Circuit board 520 is coupled to the base board 501. The side optical assembly, comprising side lens assembly 513 and side illuminators 523 and 533 is placed in a side panel 515, which also houses a side nozzle 516. At the front of the endoscope tip is a nozzle opening 517, a jet opening 518 and a working/service channel opening 519, which have been described earlier with reference to Figure 3.

As mentioned above, the front sensor and the side sensors in the present embodiment comprise CMOS sensors, which can be connected to an electronic board with ease and simplicity. Figure 6b illustrates a front looking view of a CMOS image sensor 600, while Figure 6a illustrates a side view of the same image sensor shown in Figure 6b. Referring to Figure 6a, CMOS image sensor 600 is equipped with a plurality of connector pins 603. The image sensor 600 also includes piece of glass or an optics portion 601 and a printed circuit board or computer chip 602. Since the glass optics portion 601 of the image sensor 600 is associated with the lens assembly, it is always placed to face away from a center of the endoscope tip and towards an object to be viewed. Therefore, when integrating with the baseboard of an endoscope tip, the optics portion 601 of the CMOS sensor 600 is directed towards the lens assembly of the endoscope tip, while the printed circuit board or integrated circuit portion 602 of the CMOS sensor 600 is connected to a sensor base board by means of pins 603 on the printed circuit board.

Figure 7 illustrates a view of one embodiment of a base board adapted to support the optical assembly and illuminators of an endoscope. Referring to Figure 7, the base board assembly comprises a main base board 701, which is associated with two smaller baseboards – the front sensor base board 702 and a side sensor base board 703. In one embodiment, the front sensor base board 702 and the side sensor base board 703 are placed perpendicular to each other. In one embodiment, the front sensor base board 702 and the side sensor base board 703 are also placed perpendicular to the main base board 701, in a three dimensional space. The front sensor base board 702 carries the front sensor and the front lens assembly 712. The side sensor base board 703 carries two side sensors and their associated side lens assemblies 713 and 723. It may be noted that by placing the side sensors and lens assemblies on either side of the side sensor base board 703, the side sensors are able to share one board, thereby saving space in the endoscope tip.

In an alternate embodiment, the front sensor base board 702 carries the front sensor and the front lens assembly 712, while the side sensor base board 703 carries only one side sensor and its associated side lens assembly 713 or 723.

In one embodiment, both the front and the side base boards are coupled to metal frames 705, 706, 707 which are positioned to support and hold the front and side lens assemblies 712, 713 and 723, respectively. In an embodiment, metal frames 705, 706, 707 also serve as heat sinks to the sensors incorporated in the endoscope. In one embodiment, as mentioned with respect to Figure 5 above, a separate circuit board 720 is provided to hold each illuminator, including the front illuminators 725 and side illuminators 730. The illuminator

circuit boards 720 are coupled to the main base board 701 by means of grooves/holes (shown in Figure 5) made in the main base board 701.

It may be noted that in alternate, optional designs of the base board, such as the one shown and explained with reference to Figure 4 which comprises an upper base board and a lower base board, a metal supporting frame may be placed between the viewing element holders. The metal supporting frame supports the viewing element holders by fixedly placing them between the upper and lower base boards. In some embodiments, the metal supporting frame is equipped with an internal air or fluid channel such that it acts as heat sink for the illuminators. In some designs, the metal supporting frame may also be integrated with the optical assemblies and acts as a heat sink for the LEDs while supporting the optical assemblies to be fixedly placed between the upper and lower base boards.

Figure 8 illustrates another perspective view of the circuit board design of the present specification. Referring to Figure 8, a side sensor base board 801 is connected to two side image sensors 802 and 803, which are CMOS sensors in the present embodiment. The CMOS sensors 802, 803 (similar to CMOS sensor 600 shown in Figure 6a) are integrated with the side sensor base board by directing the optics portion (such as glass portion 601 shown in Figure 6a) of the sensors towards the lens assembly of the endoscope tip, and connecting the pins 812, 813 (similar to pins 603 shown in Figure 6a) of the printed circuit board (such as chip portion 602 shown in Figure 6a) or computer chip of the sensors to the side sensor base board. By connecting two side image sensors 802 and 803 to one side sensor base board 801, the side sensors 802, 803 are able to share one board 801, thereby saving space in the endoscope tip. The side sensor board 801 is also connected to the main base board 810. In one embodiment, the side sensor board 801 is placed perpendicular to the main base board 810.

Figure 9 illustrates another exemplary embodiment for assembling CMOS sensors to a base board in an endoscope tip, wherein each image sensor connects to a dedicated board. Referring to Figure 9, a first side sensor 901 is connected to a first side sensor base board 911 and a second side sensor 902 is connected to a second side sensor base board 912. The circuit board assembly further comprises a front image sensor 903, which is connected to a dedicated front sensor base board 913. Side image sensors 901 and 902 and the front image sensor 903, are CMOS sensors in the present embodiment. The CMOS sensors are integrated with their respective sensor base boards by directing the optics part of the sensors, such as portions 903a and 902a of sensors 902 and 903 respectively, towards the lens assembly (not shown) of the endoscope tip, and connecting the pins (not shown in Figure 9) of the printed

circuit board or computer chip of the sensors to their dedicated sensor base board. The side sensor boards 911, 912 and the front sensor base board 913 are also connected to the main base board 910. In one embodiment, each of the side sensor boards 911 and 912 and the front sensor base board 913 are connected to main base board 910 by means of a dedicated flexible circuit board or flex board. As shown in the figure, flex board 923 connects between the front base board 913 and the main base board 910. Similarly, flex board 922 is adapted to connect between the side base board 912 and the main base board 910. Side base board 911 is connected to the main base board by another flex board (not shown). It may be appreciated that any flexible boards known in the art that are suitable for the application may be used in the present embodiment.

It may be noted that use of a flex board is advantageous in a multi-viewing element endoscope, owing to shortage of space in the tip exacerbated by the presence of multiple viewing elements. The flex board provides additional freedom of movement to the assembly process in a space constrained environment, and allows the two side sensor boards 911, 912 to be aligned in parallel and as close as possible one to each other. In one embodiment, side sensor base boards 911 and 912 are placed parallel to each other, while being placed perpendicular to the main base board 910. The front base board 913 is placed perpendicular to the side base boards 911 and 912, and also perpendicular to the main base board 910.

Figure 10 illustrates a front illuminator electronic circuit board 1006 adapted for supporting the front illuminators 1008a, 1008b, 1008c of an endoscope, in accordance with another embodiment of the present specification. Figure 10 also illustrates a main base board 1002 and a side illuminator electronic circuit board 1010 for supporting the side illuminators 1012a, 1012b (also as shown earlier in Figure 3). The front illuminators 1008a, 1008b, 1008c are associated with a front optical assembly comprising a front lens assembly 1014 and a front image sensor. The side illuminators 1012a, 1012b are associated with a side optical assembly comprising a side lens assembly 1016 and a side image sensor. The front sensor base board 1022 and side sensor base board 1023 are soldered to respective grooves (shown in Figure 5) placed in the main base board 1002. On each side panel, a side illuminator electronic circuit board 1010 holds a set of side illuminators 1012a, 1012b (the figure illustrates only one side panel of the endoscope, however it should be understood by those of ordinary skill in the art that the other side panel is equivalent to the shown side panel). In one embodiment, front illuminators 1008a, 1008b are positioned on either side of the front lens assembly 1014 while front illuminator 1008c is positioned above front lens assembly 1014 and above the main base board 1002. The two illuminators 1012a, 1012b on both sides of the

endoscope tip are positioned on either side of the side lens assembly 1016. In various embodiments, any material that is used for constructing a PCB (printed circuit board) may be used for constructing the front and side illuminator circuit boards. Typical materials used for making PCB boards are ceramic, polyamides for flexible board, and glass-reinforced epoxy, such as, FR4 (a composite material composed of woven fiberglass cloth with an epoxy resin binder that is flame resistant (self-extinguishing)). Also in various embodiments, the front and side illuminator circuit boards may or may not be made of the same materials as the upper and lower base boards.

Figure 11 illustrates a front illuminator electronic circuit board 1106, in accordance with an embodiment of the present specification. In one embodiment, as depicted in Figure 11, the circuit board 1106 is shaped as a 'U' and holds front illuminators 1108a, 1108b, 1108c in place. In various embodiments, the length l of the front illuminator electronic circuit board 1106 ranges from 5.5 mm to 11.5 mm, preferably 7.5 mm to 9.5 mm, and in an embodiment the length l is approximately 6.0 to 11.0 mm, preferably 8.0 to 9.0 mm. In various embodiments, the height h of the front illuminator electronic circuit board 1106 ranges from 2.0 mm to 8.5 mm, preferably 4.0 mm to 6.5 mm, and in an embodiment the height h is approximately 3.0 mm to 8.0 mm, preferably 5.0 to 6.0 mm.

Figure 12 illustrates a side illuminator electronic circuit board 1210, in accordance with an embodiment of the present specification. In one embodiment, as depicted in Figure 12, the circuit board 1210 is shaped as a 'U' and holds side illuminators 1212a, 1212b in place. In various embodiments, the length l of the side illuminator electronic circuit board 1210 ranges from 5.5 mm to 11.5 mm, preferably 7.5 mm to 9.5 mm, and in an embodiment the length l is approximately 4.5 to 9.5 mm, preferably 6.5 to 7.5 mm. In various embodiments, the height h of the front illuminator electronic circuit board 1106 ranges from 1.0 mm to 7.5 mm, preferably 3.0 mm to 5.5 mm, and in an embodiment the height h is approximately 2.0 mm to 7.0 mm, preferably 3.7 to 4.7 mm.

Figure 13 is a flowchart illustrating the steps of assembling front and side optical assemblies and sensors in an endoscope tip, in accordance with an embodiment of the present specification. At step 1302, a first sensor board is inserted into a first groove on a main base board. In one embodiment, the first sensor board is used for holding one or more side sensors and is placed perpendicular to the main base board. At step 1304, a second sensor board is inserted into a second groove on the main base board. In one embodiment, the second sensor board is used for holding a front sensor and is placed perpendicular to the main base board as well as to the first sensor board. At step 1306, the first and the second sensor boards are

soldered to the main base board. In an embodiment, the first and the second sensor boards are connected to the main base board by using one or more flex boards. At step 1308, a sensor is connected to each side of the first sensor board. At step 1310, a sensor is connected to a side of the first sensor board facing the outside of the endoscope tip. In an embodiment, the sensor is a CMOS sensor which is connected to a sensor board by directing optics part of the sensor towards a lens assembly of the endoscope tip, and connecting the pins of the computer chip of the sensor to the sensor board. At step 1312 a front optical assembly is fitted into a first metal frame which is then coupled with the second sensor board and soldered onto a predefined area on the main base board. At step 1314 one or more side optical assemblies are fitted into respective metal frames which are then coupled with the first sensor board and soldered at predefined areas on to the main base board. At step 1316 two or more illuminators are fitted to respective front illuminator boards which are inserted into corresponding front illuminator grooves in the main base board. At step 1318 the front illuminator boards are soldered to the main base board. At step 1320 two or more illuminators are fitted to respective side illuminator boards which are inserted into corresponding side illuminator grooves in the main base board. At step 1322 the side illuminator boards are soldered to the main base board.

In one embodiment, the circuit board assembly of the present specification can also be adapted for use with CCD sensors. That is, the same circuit board is designed as a common platform that can support either of the two technologies – CCD or CMOS, depending upon the application and requirement.

The above examples are merely illustrative of the many applications of the system of present invention. Although only a few embodiments of the present invention have been described herein, it should be understood that the present invention might be embodied in many other specific forms without departing from the spirit or scope of the invention. Therefore, the present examples and embodiments are to be considered as illustrative and not restrictive, and the invention may be modified within the scope of the appended claims.

CLAIMS

We claim:

1. A circuit board assembly for use in a tip section of a multi-viewing element endoscope, said tip comprising a front pointing viewing element and at least one side pointing viewing element, wherein each viewing element comprises an image sensor and a lens assembly, said circuit board assembly comprising:
 - a first base board to which the front pointing viewing element is connected;
 - a second base board, wherein the at least one side pointing viewing element is connected to a first side of the second base board; and
 - a third base board to which said first and said second base boards are connected, wherein said first and said second base boards are placed perpendicular to said third base board.
2. The circuit board assembly of claim 1 wherein the tip section comprises a second side pointing viewing element facing a direction opposite to the at least one side pointing viewing element, wherein the second side pointing viewing element is connected to a second side of the second base board and wherein the first side of the second base board is opposite the second side of the second base board.
3. The circuit board assembly of claim 1, wherein each image sensor is a CMOS sensor comprising a first optics portion coupled with a second chip portion having a plurality of connector pins.
4. The circuit board assembly of claim 3, wherein the second chip portion of the CMOS sensor is connected to the first side of the second base board or the second side of the second base board by said plurality of connector pins.
5. The circuit board assembly of claim 1, wherein said first and said second base boards are positioned perpendicular to each other.
6. The circuit board assembly of claim 1, wherein said first base board is coupled to a metal frame which is configured to hold the lens assembly of the front pointing viewing element.
7. The circuit board assembly of claim 1, wherein said second base board is coupled to at least one metal frame, wherein the metal frame is configured to hold the at least one side lens assembly.
8. The circuit board assembly of claim 7, wherein said metal frame is configured as heat sinks.

9. The circuit board assembly of claim 1, wherein each of the front and side pointing viewing elements is associated with at least one illuminator, and wherein said circuit board assembly comprises a separate circuit board to hold each of the at least one illuminators.
10. The circuit board assembly of claim 1, wherein said third base board comprises grooves adapted to receive said first base board and said second base board.
11. A circuit board assembly for the tip of a multi-viewing element endoscope, said tip comprising a front pointing viewing element, a first side pointing viewing element, and a second side pointing viewing element, wherein each viewing element comprises an image sensor and a lens assembly, said circuit board assembly comprising:
 - a first base board to which the front pointing viewing element is connected;
 - a second base board to which a first side pointing viewing element is connected;
 - a third base board to which a second side pointing viewing element is connected; and,
 - a fourth base board having three grooves, wherein each of said three grooves are adapted to receive one of said first, second and third base boards and wherein each of said first, second and third base boards are placed perpendicular to said fourth base board.
12. The circuit board assembly of claim 11, wherein each image sensor is a CMOS sensor.
13. The circuit board assembly of claim 11, wherein each of said first, second and third base boards is further connected to said fourth base board by a flexible circuit board.
14. The circuit board assembly of claim 11, wherein said second and said third base boards are positioned parallel to each other.
15. The circuit board assembly of claim 14, wherein said second and said third base boards are positioned perpendicular to the first base board.
16. The circuit board assembly of claim 16 further comprising a front illuminator circuit board.
17. The circuit board assembly of claim 16, wherein said front illuminator circuit board is shaped as a “U” and is configured to hold three illuminators associated with the front pointing viewing element.
18. The circuit board assembly of claim 11 further comprising two side illuminator circuit boards.
19. The circuit board assembly of claim 18, wherein each of the two side illuminator circuit boards is shaped as a “U” and is configured to hold two illuminators associated with the first side pointing viewing element and the second side pointing viewing element.

20. The circuit board assembly of claim 16, wherein the length of the front illuminator circuit board ranges from 5.5 mm to 11.5 mm and the height of the front illuminator circuit board ranges from 2.0 mm to 8.5 mm.
21. The circuit board assembly of claim 18, wherein the length of each of the side illuminator circuit boards ranges from 5.5 mm to 11.5 mm and the height of each of the side illuminator circuit boards ranges from 1.0 mm to 7.5 mm.

Figure 1

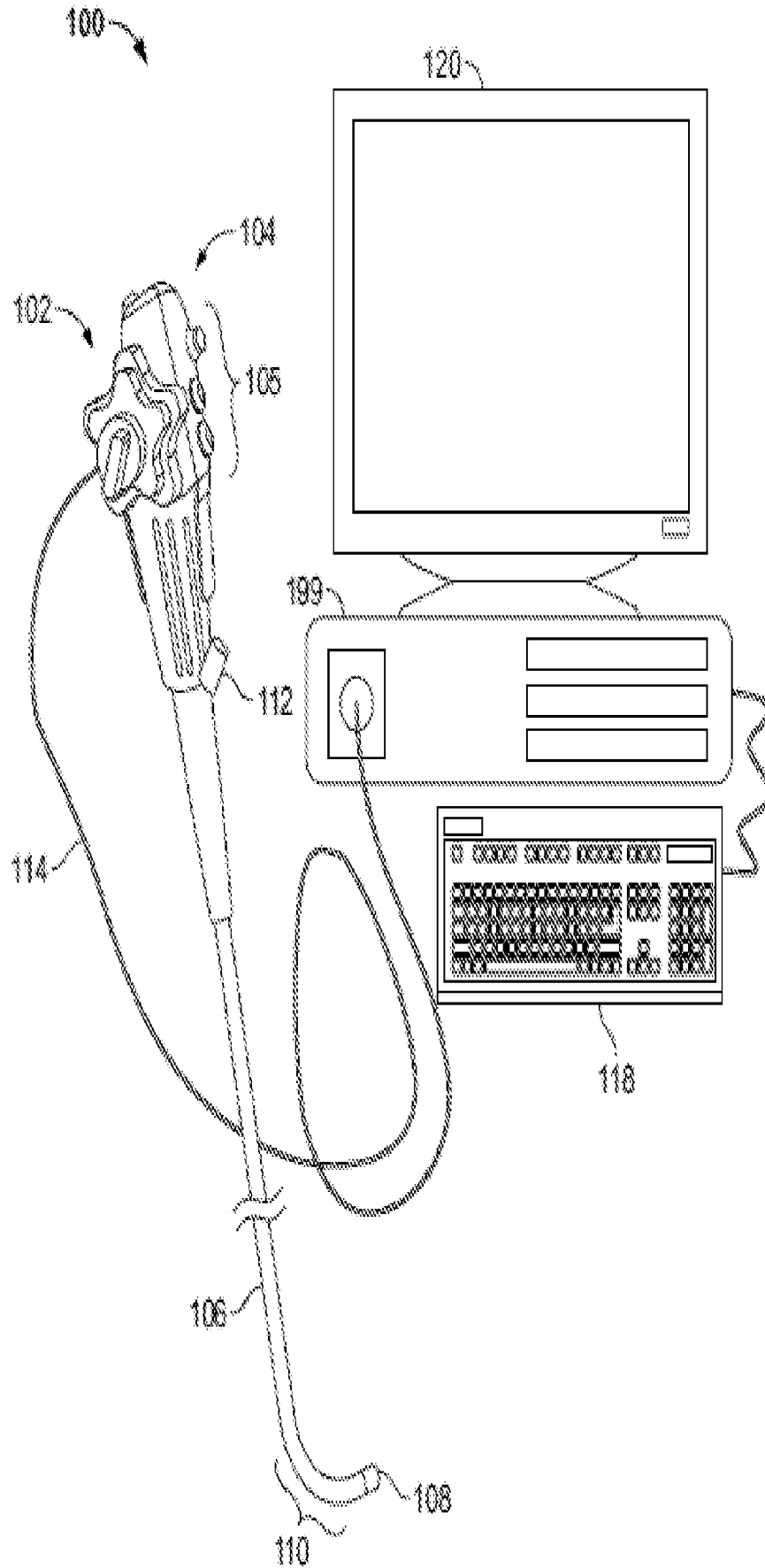

Figure 2

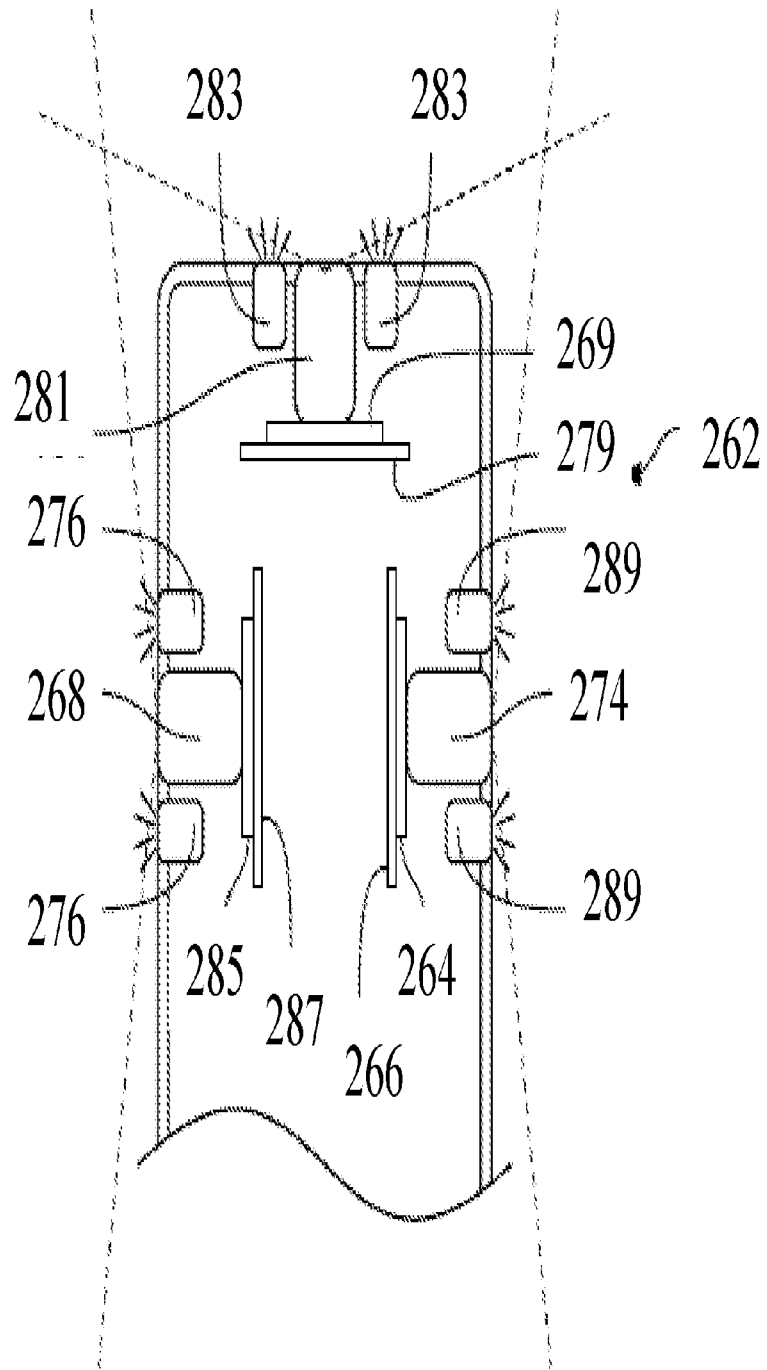

Figure 3

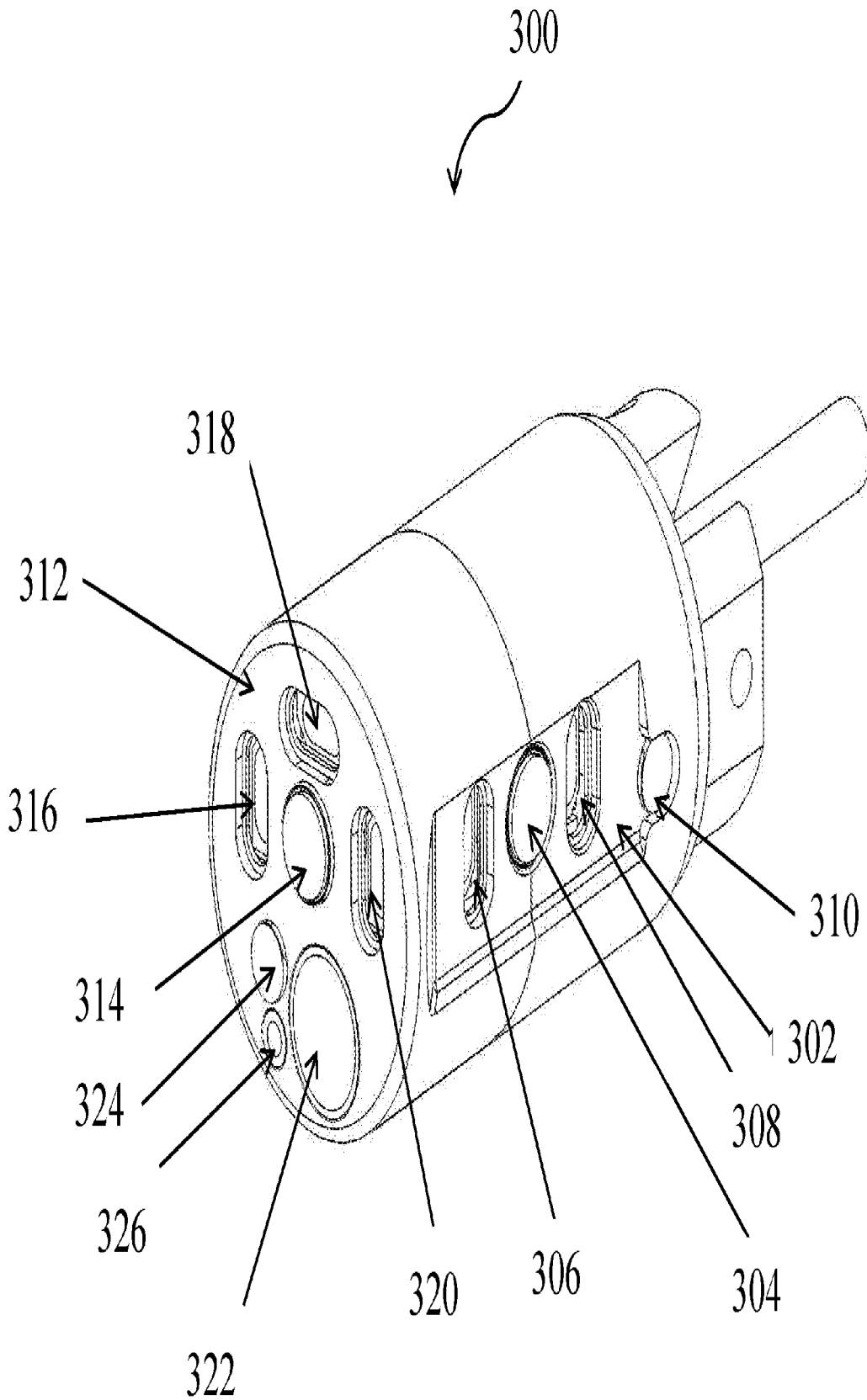

Figure 4

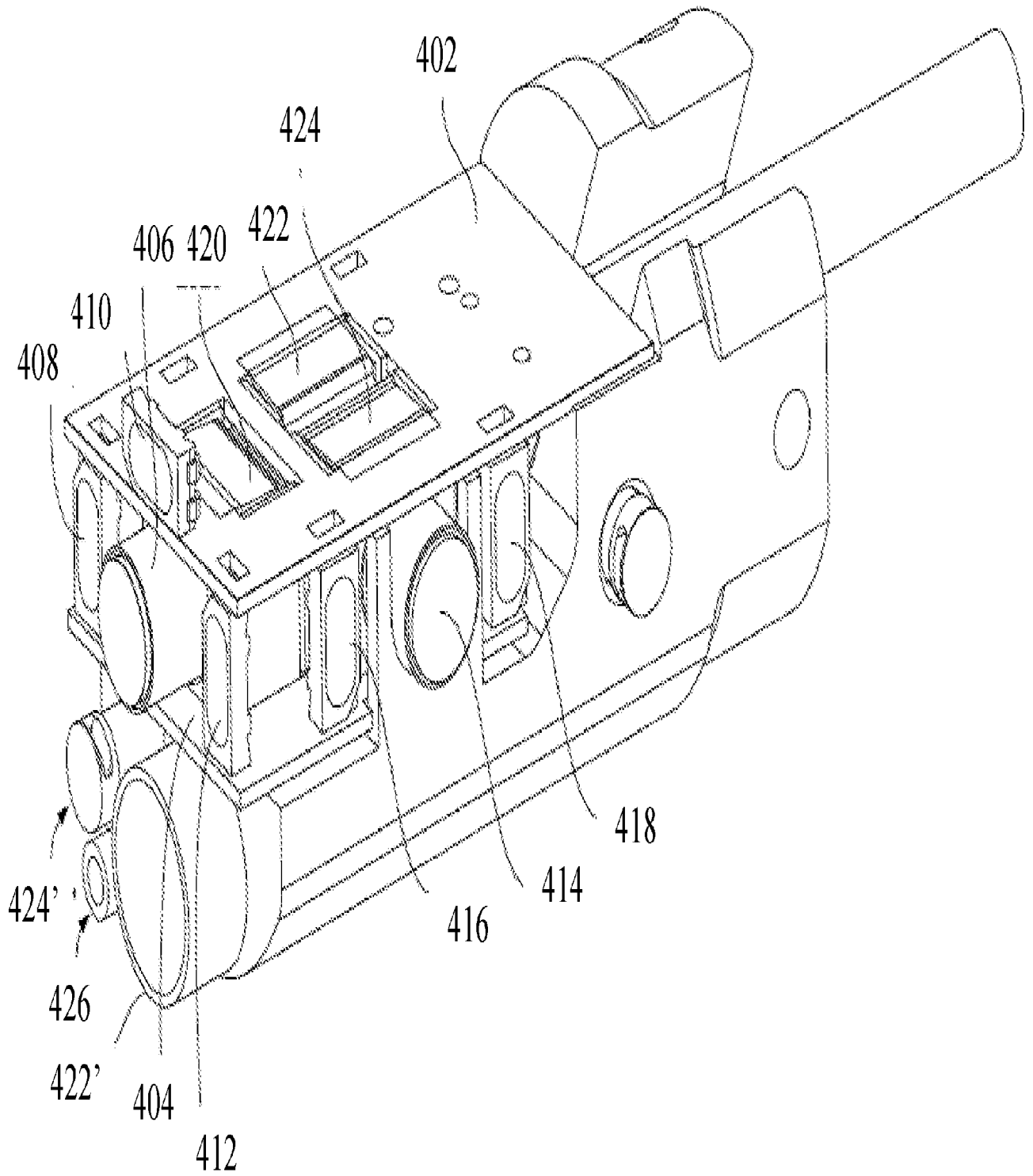

Figure 5

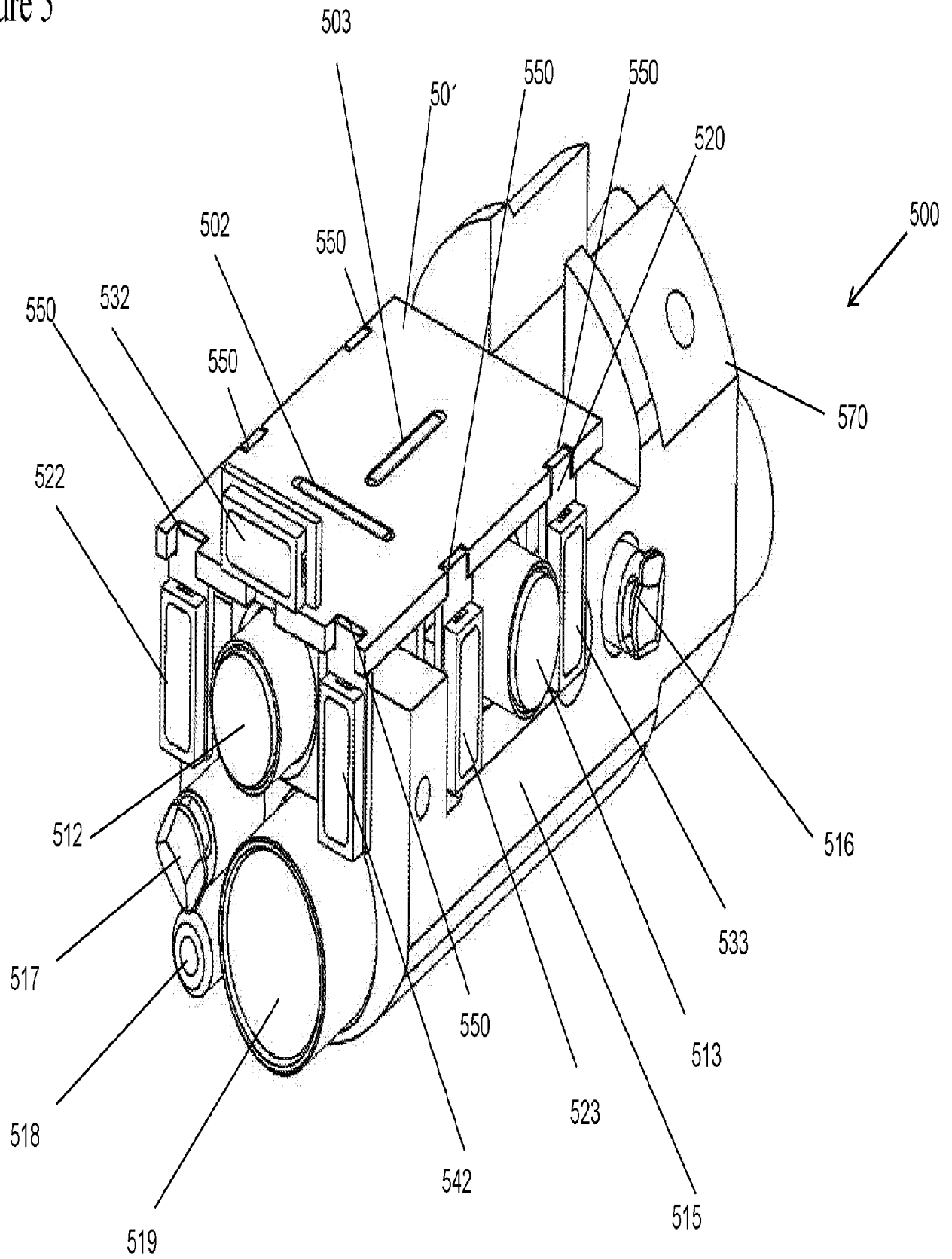

Figure 6a

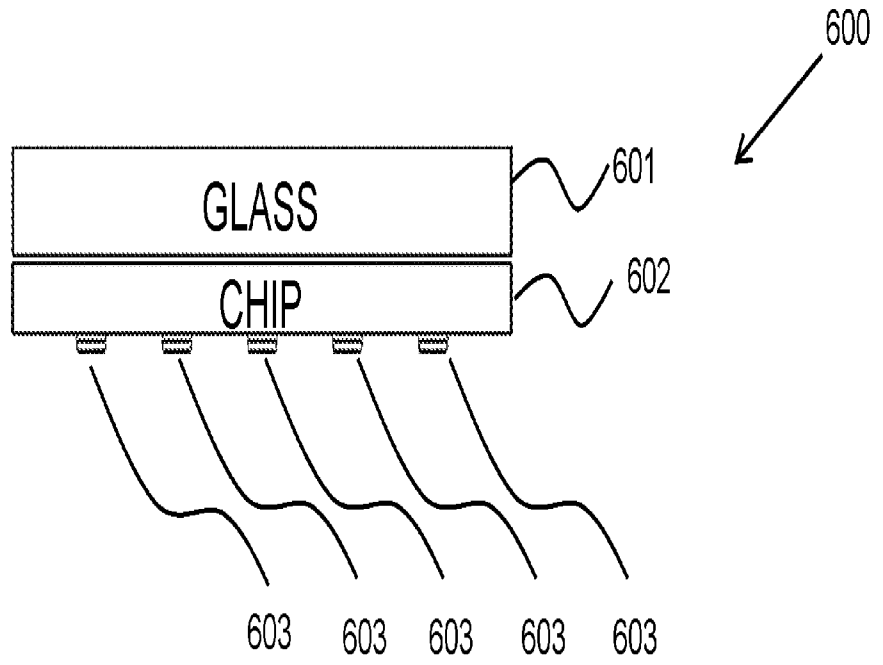

Figure 6b

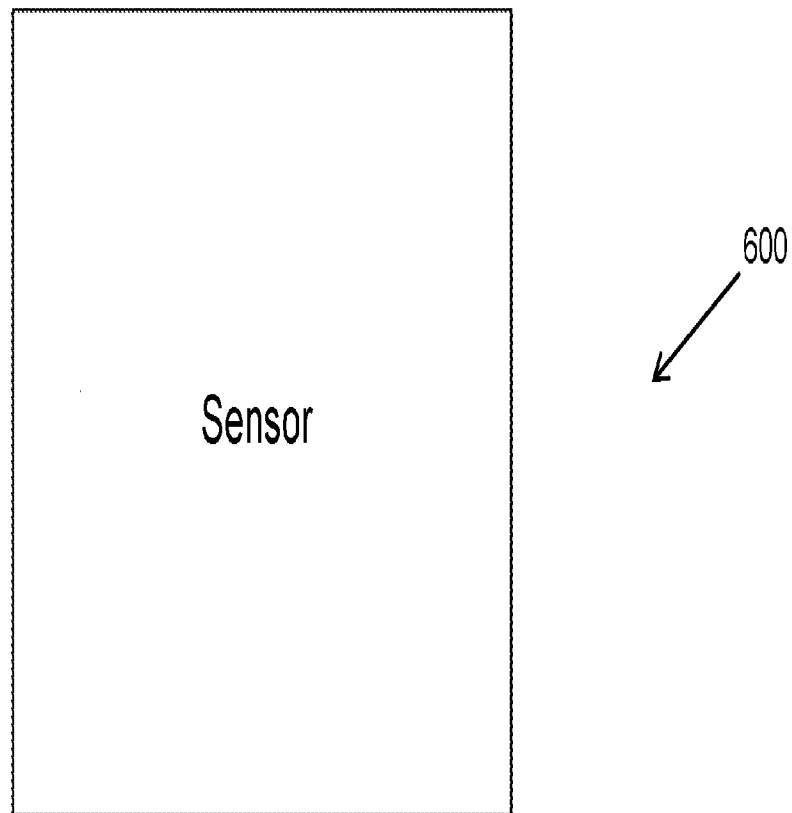

Figure 7

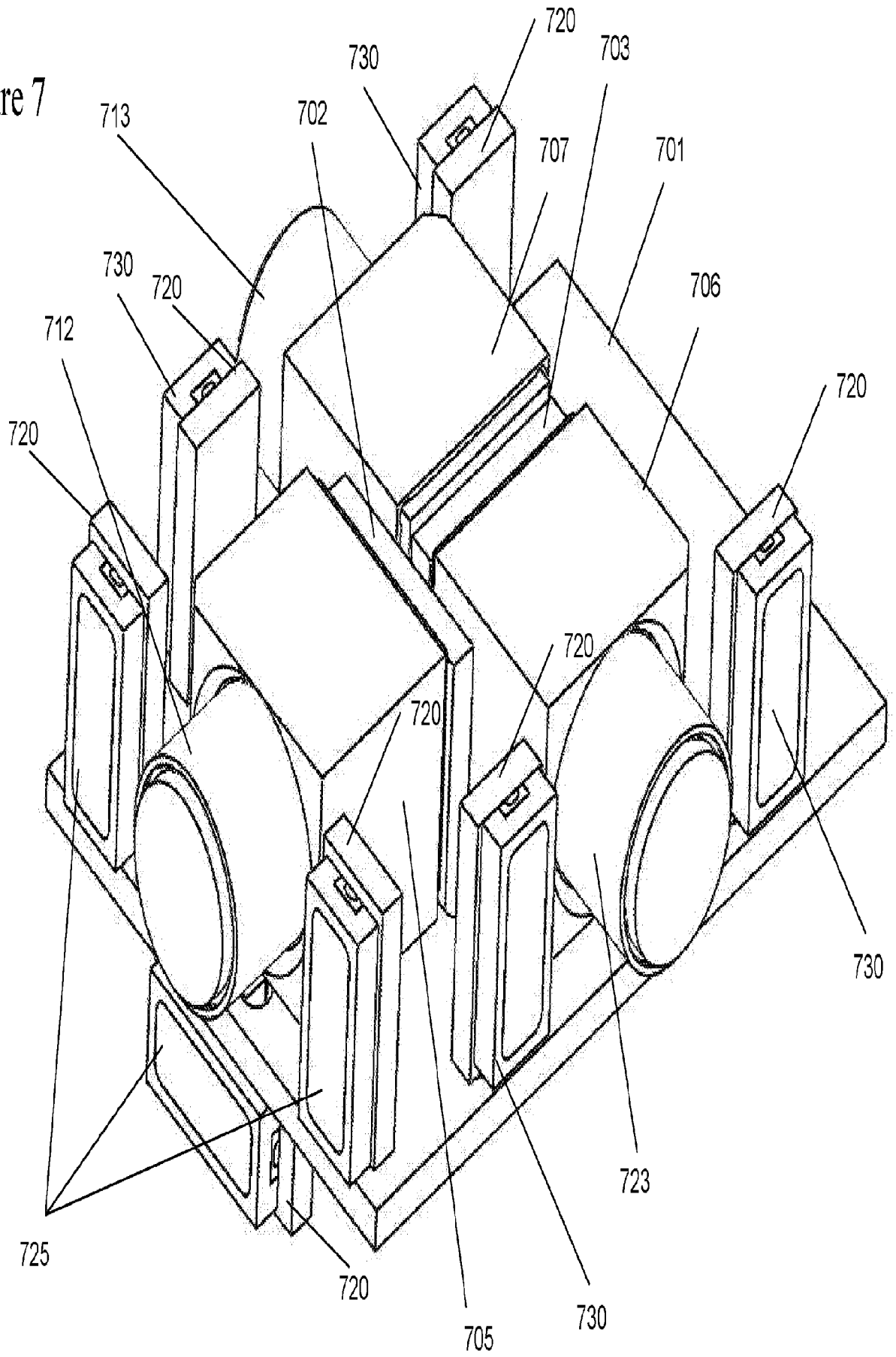

Figure 8

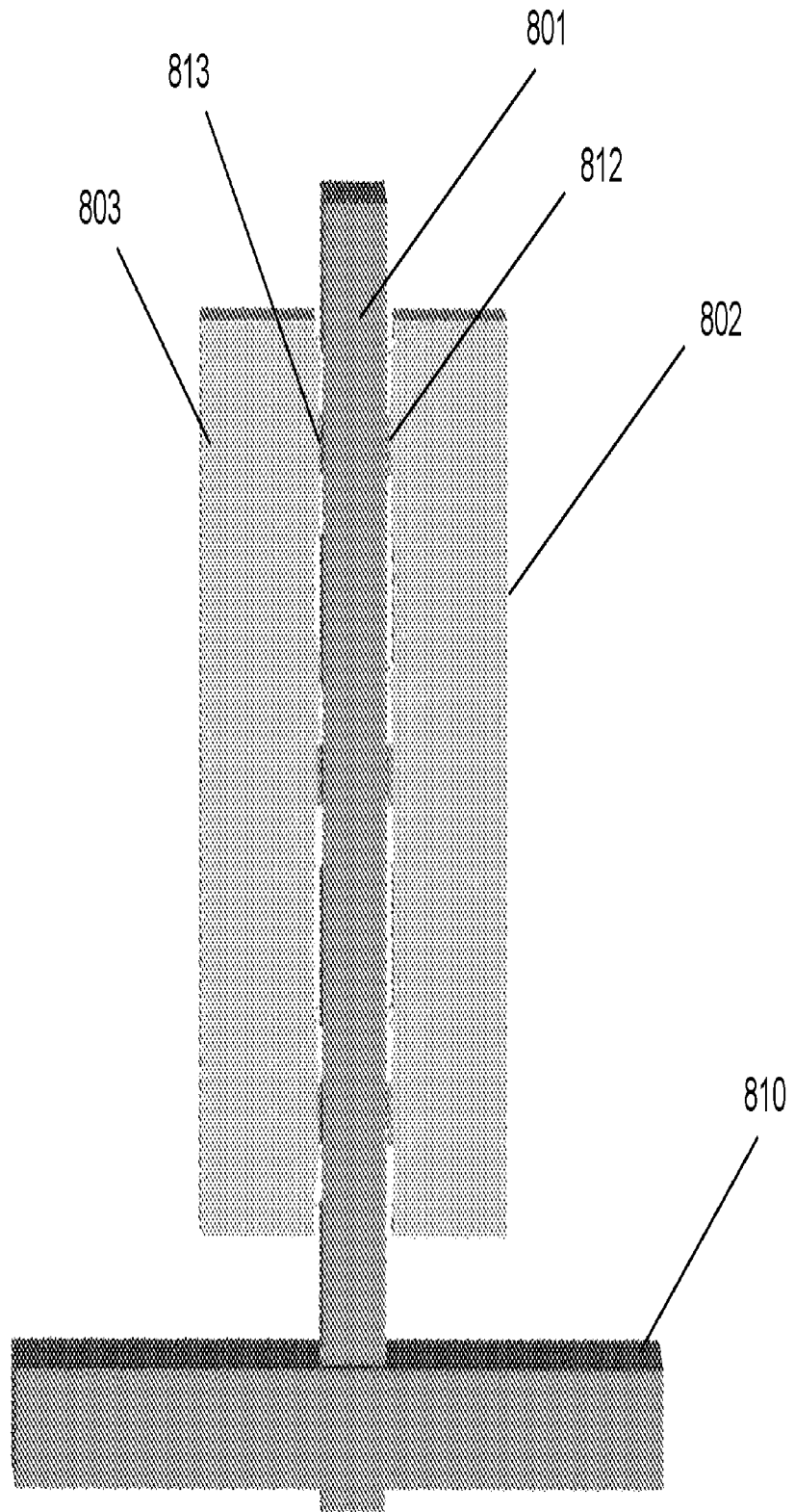

Figure 9

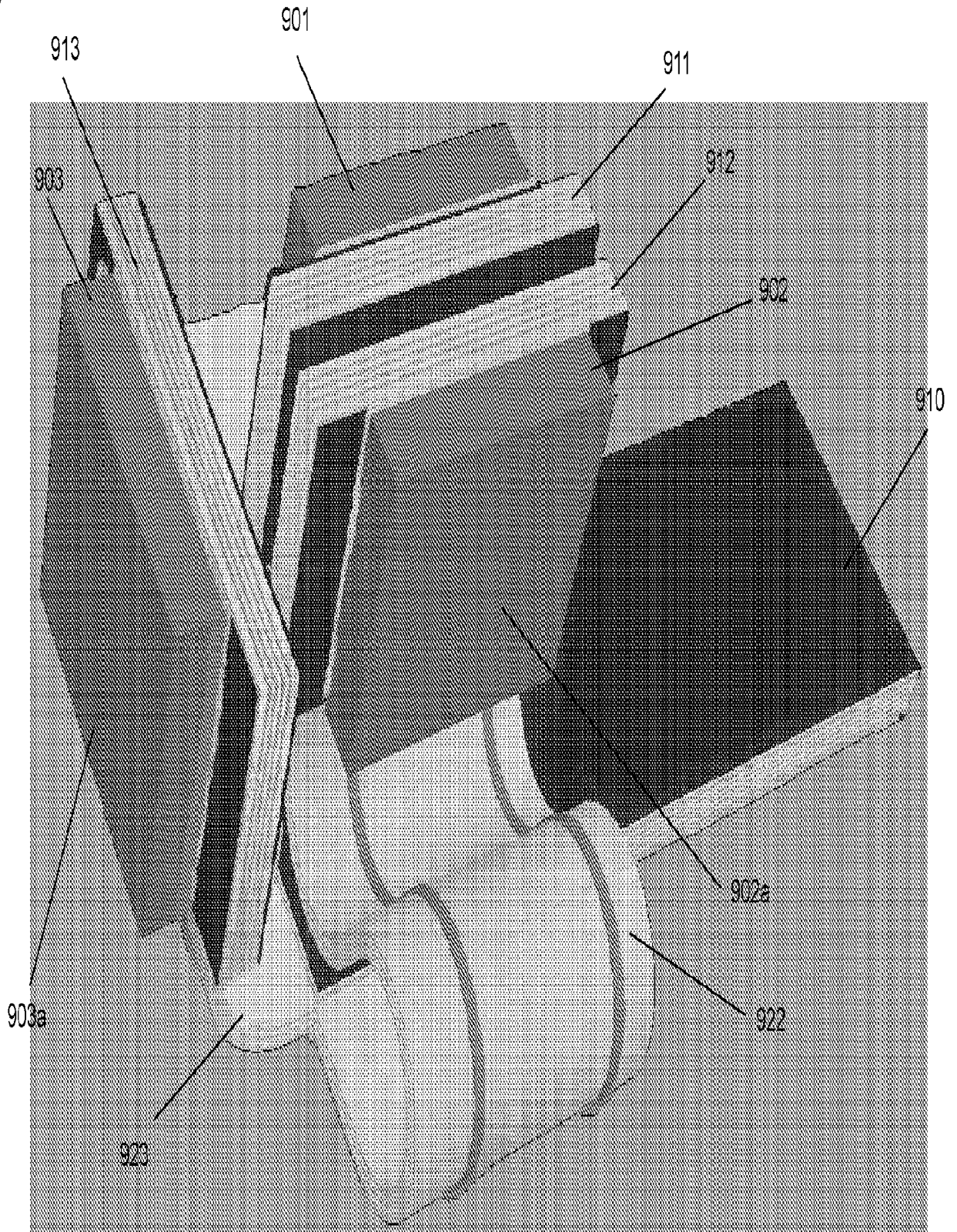

FIG. 10

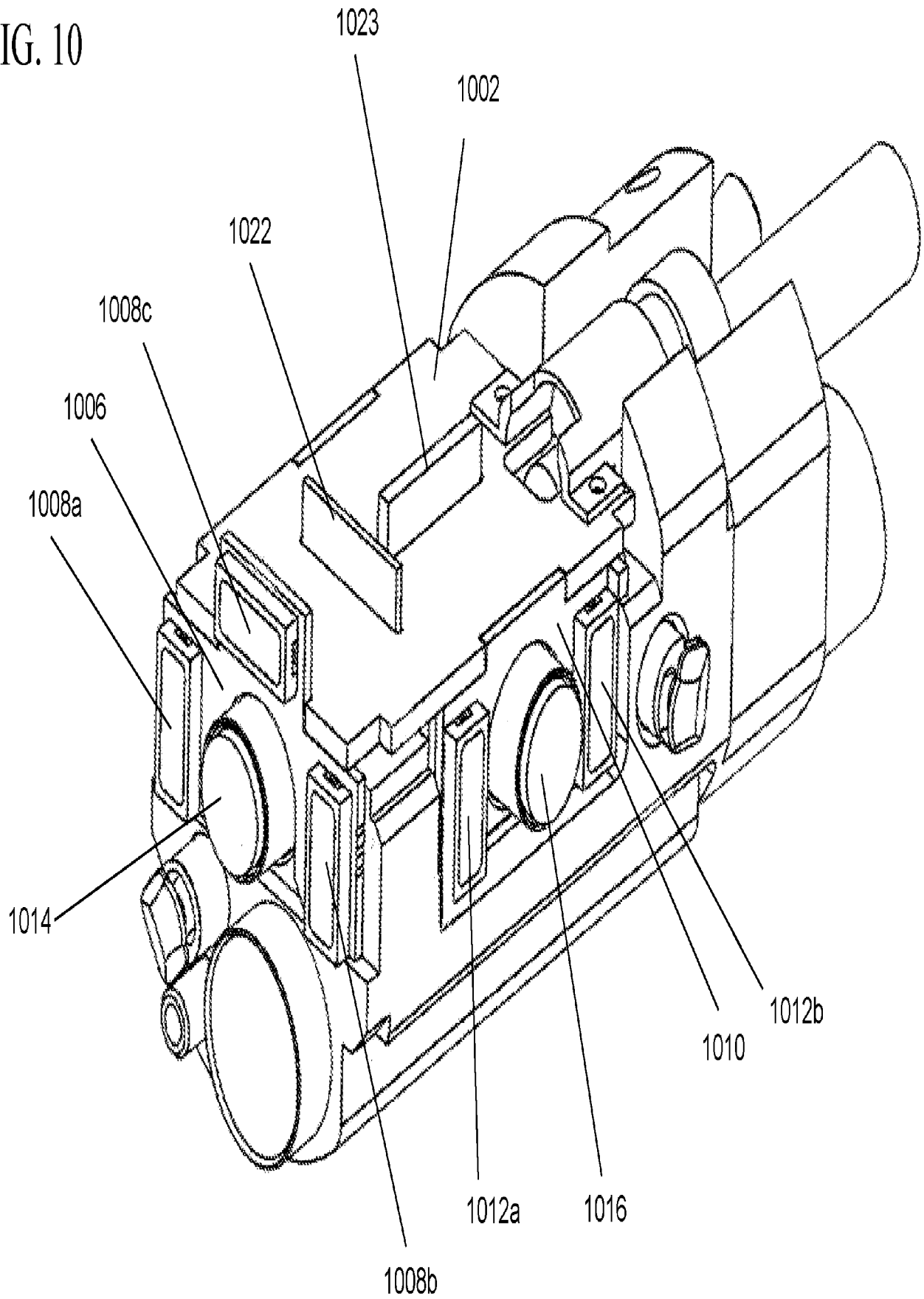

FIG. 11

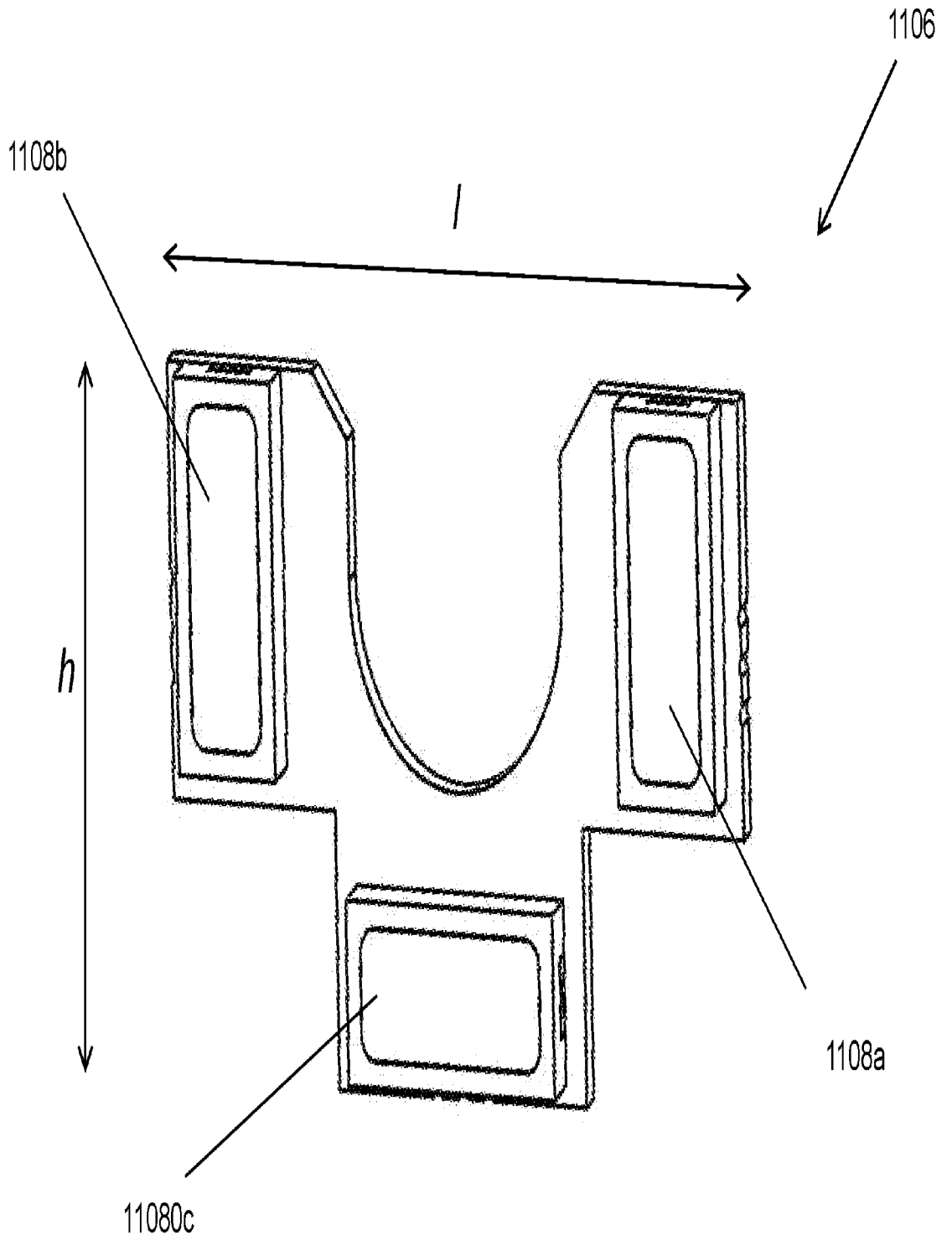
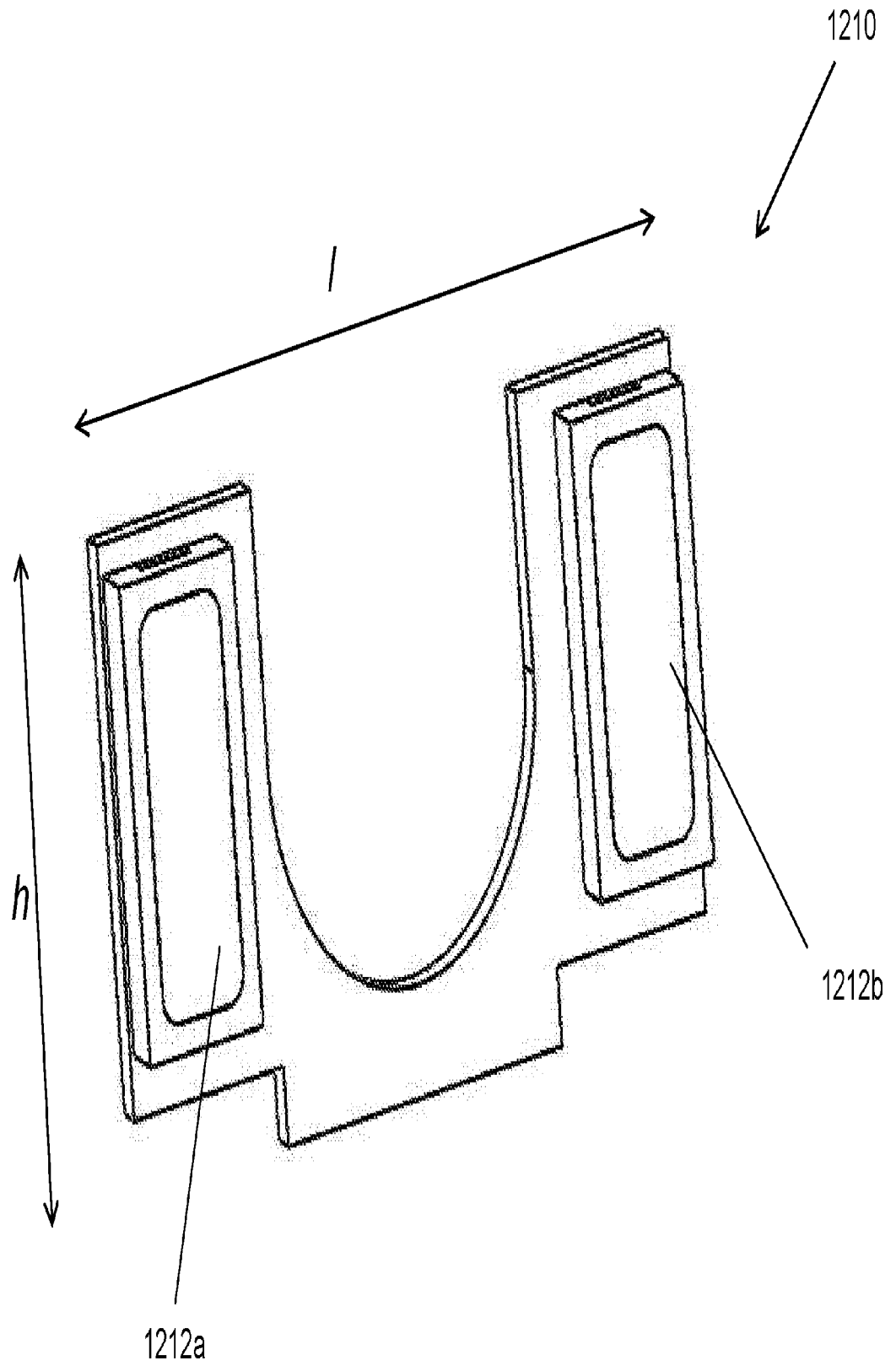

FIG. 12



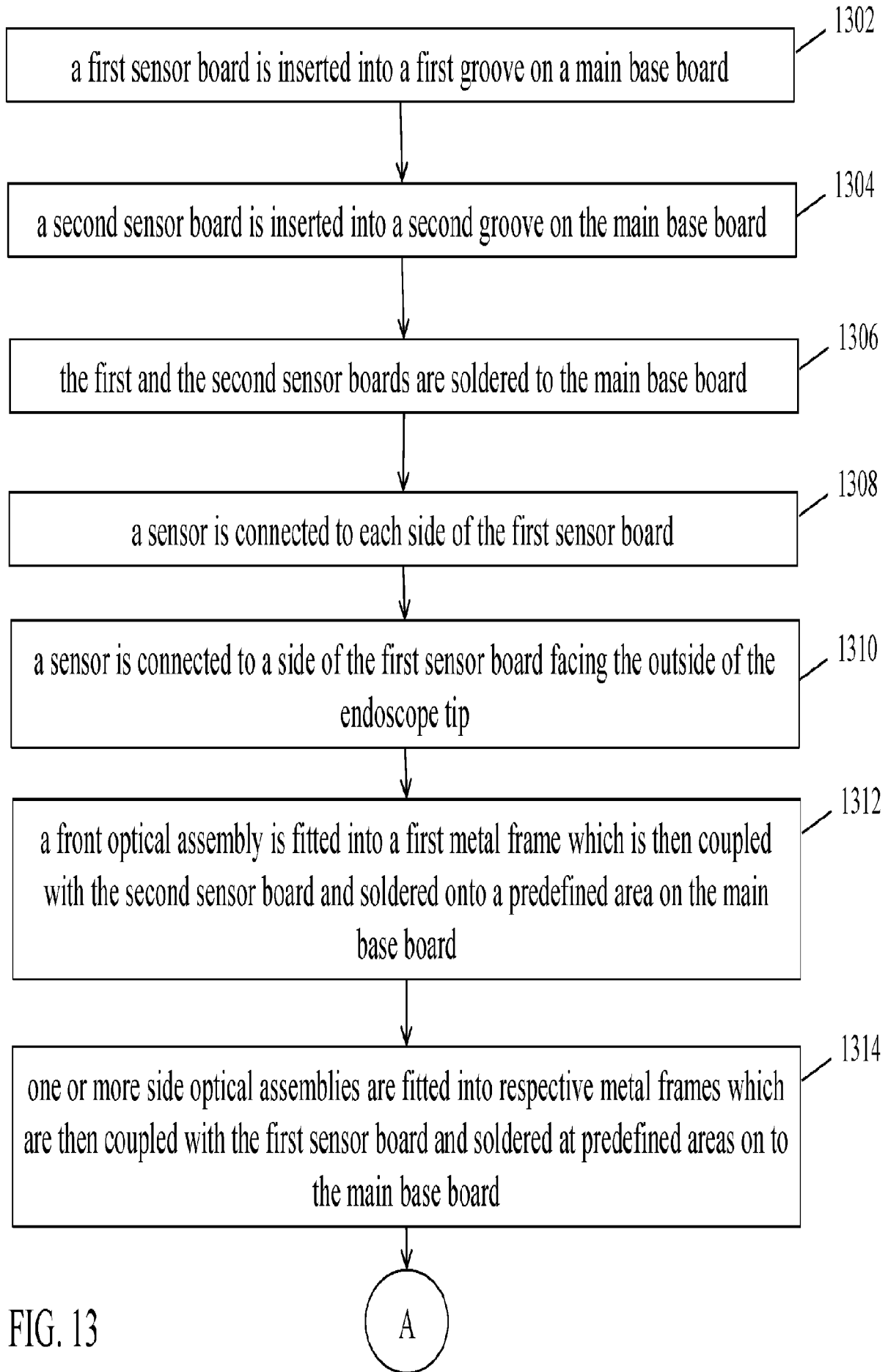

FIG. 13

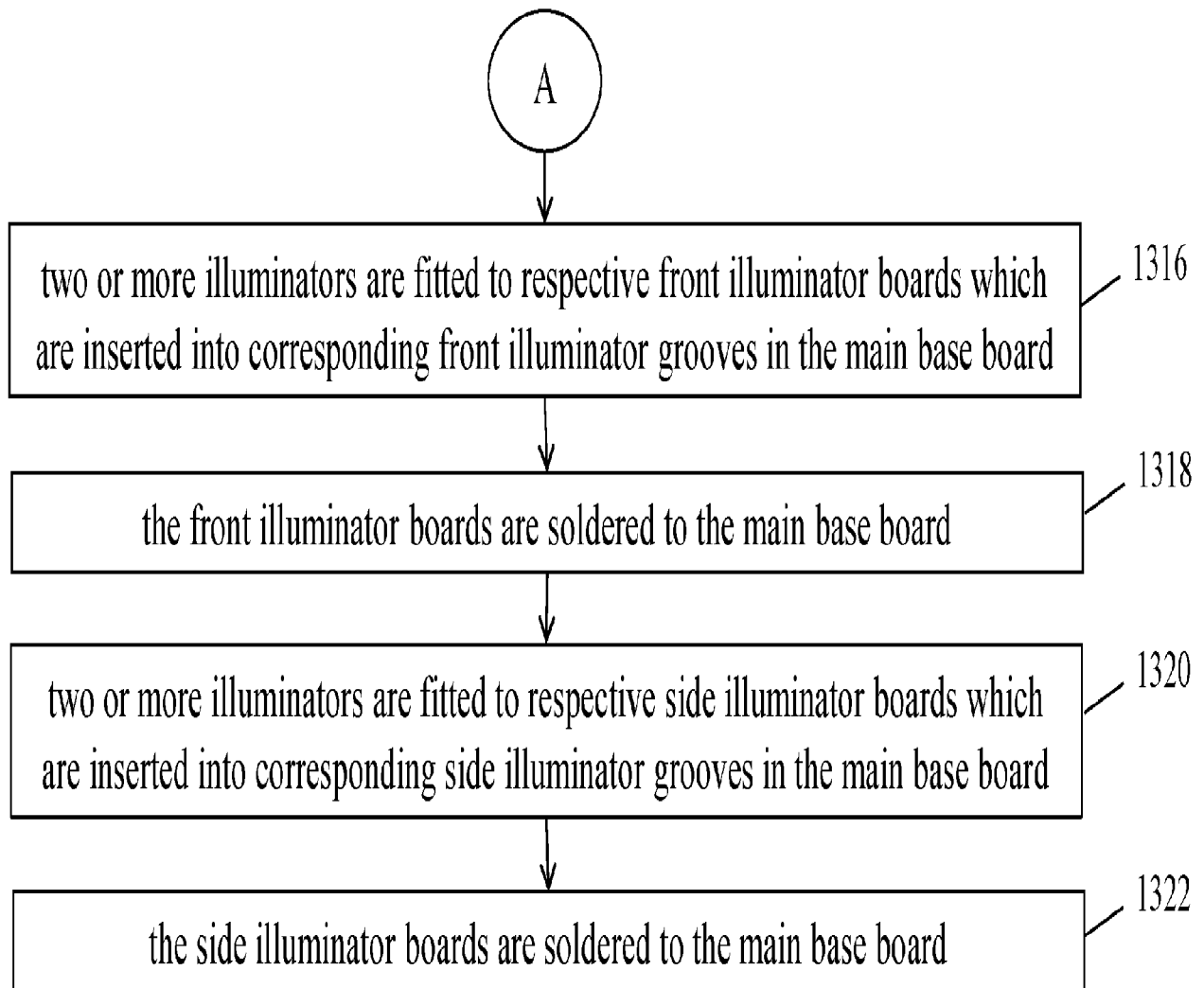

FIG. 13 contd.

INTERNATIONAL SEARCH REPORT

International application No.
PCT/US17/18287

A. CLASSIFICATION OF SUBJECT MATTER

IPC - A61B1/00; A61B1/05; A61B1/06; H04N5/77; H04N5/91; A61B1/015 (2017.01)
CPC - A61B1/00009; A61B1/0005; A61B1/0011; A61B1/00177; A61B1/00181; A61B1/00181;
A61B1/00188; A61B1/015; A61B1/051; A61B1/0615; A61B1/0684; H04N5/772; H04N5/91

According to International Patent Classification (IPC) or to both national classification and IPC

B. FIELDS SEARCHED

Minimum documentation searched (classification system followed by classification symbols)

See Search History document

Documentation searched other than minimum documentation to the extent that such documents are included in the fields searched

See Search History document

Electronic data base consulted during the international search (name of data base and, where practicable, search terms used)

See Search History document

C. DOCUMENTS CONSIDERED TO BE RELEVANT

Category*	Citation of document, with indication, where appropriate, of the relevant passages	Relevant to claim No.
X	US 2014/333743 A1 (ENDOCHOICE, INC.) 13 November 2014 (13.11.2014); figures 1C-1F, 16-18, 30A, 33A, 34, 35A, 36, 37 and 38F; paragraphs [0014], [0142], [0148]-[0153], [0183], [0458], [0636]-[0644], [0666], [0673], [0736], [0740]-[0746] and [0759].	1-21
A	US 2013/0296649 A1 (KIRMA, Y., et al.) 07 November 2013 (07.11.2013), entire document	1-21
A	US 2013/0274551 A1 (KIRMA, Y., et al.) 17 October 2013 (17.10.2013), entire document	1-21
A	US 2013/0271588 A1 (KIRMA, Y., et al.) 17 October 2013 (17.10.2013), entire document	1-21
A	US 2012/0065468 A1 (LEVY, A., et al.) 15 March 2012 (15.03.2012), entire document	1-21

Further documents are listed in the continuation of Box C.

See patent family annex.

* Special categories of cited documents:

"A" document defining the general state of the art which is not considered to be of particular relevance

"E" earlier application or patent but published on or after the international filing date

"L" document which may throw doubts on priority claim(s) or which is cited to establish the publication date of another citation or other special reason (as specified)

"O" document referring to an oral disclosure, use, exhibition or other means

"P" document published prior to the international filing date but later than the priority date claimed

"T" later document published after the international filing date or priority date and not in conflict with the application but cited to understand the principle or theory underlying the invention

"X" document of particular relevance; the claimed invention cannot be considered novel or cannot be considered to involve an inventive step when the document is taken alone

"Y" document of particular relevance; the claimed invention cannot be considered to involve an inventive step when the document is combined with one or more other such documents, such combination being obvious to a person skilled in the art

"&" document member of the same patent family

Date of the actual completion of the international search

13 April 2017 (13.04.2017)

Date of mailing of the international search report

10 MAY 2017

Name and mailing address of the ISA/

Mail Stop PCT, Attn: ISA/US, Commissioner for Patents
P.O. Box 1450, Alexandria, Virginia 22313-1450
Facsimile No. 571-273-8300

Authorized officer

Shane Thomas

PCT Helpdesk: 571-272-4300
PCT OSP: 571-272-7774