



(12) **DEMANDE DE BREVET CANADIEN  
CANADIAN PATENT APPLICATION**

(13) **A1**

(22) Date de dépôt/Filing Date: 2014/04/14  
(41) Mise à la disp. pub./Open to Public Insp.: 2014/10/23  
(62) Demande originale/Original Application: 2 909 355  
(30) Priorité/Priority: 2013/04/15 (US61/811,918)

(51) Cl.Int./Int.Cl. *G01N 1/28* (2006.01),  
*A61B 5/15* (2006.01), *A61B 5/157* (2006.01),  
*B01L 3/00* (2006.01)  
(71) Demandeur/Applicant:  
BECTON, DICKINSON AND COMPANY, US  
(72) Inventeurs/Inventors:  
GELFAND, CRAIG A., US;  
ROTHENBERG, ASHLEY RACHEL, US;  
WILKINSON, BRADLEY M., US;  
MARCHIARULLO, DANIEL J., US  
(74) Agent: PIASETZKI NENNIGER KVAS LLP

(54) Titre : DISPOSITIF DE COLLECTE DE FLUIDE BIOLOGIQUE ET SEPARATION DE FLUIDE BIOLOGIQUE ET SYSTEME D'ESSAI  
(54) Title: BIOLOGICAL FLUID COLLECTION DEVICE AND BIOLOGICAL FLUID SEPARATION AND TESTING SYSTEM

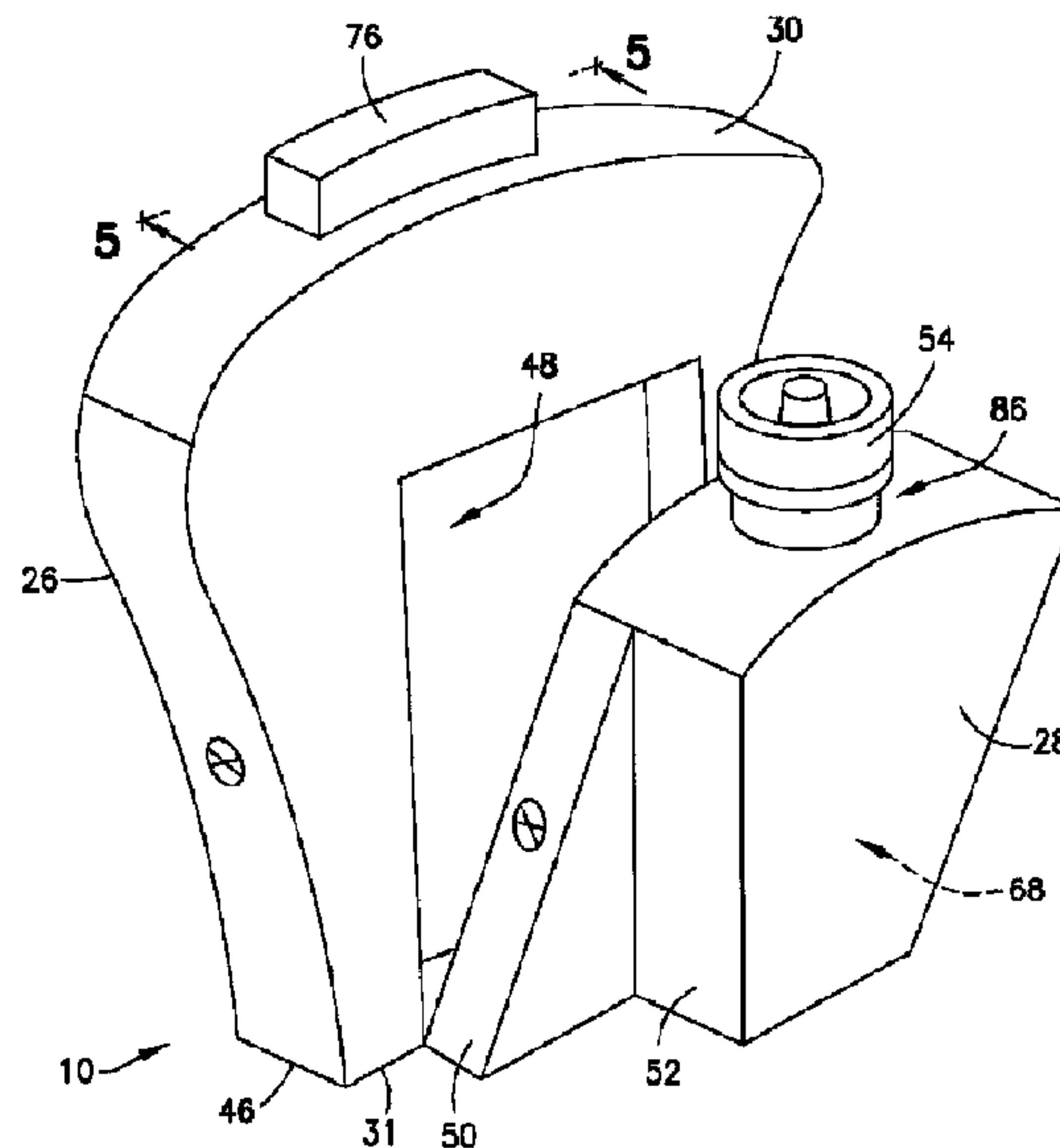

(57) **Abrégé/Abstract:**

A biological fluid collection device that is adapted to receive a blood sample having a cellular portion and a plasma portion is disclosed. After collecting the blood sample, the biological fluid collection device is able to transfer the blood sample to a point-of-care testing device or a biological fluid separation and testing device. After transferring the blood sample, the biological fluid separation and testing device is able to separate the plasma portion from the cellular portion and analyze the blood sample and obtain test results.

## ABSTRACT

A biological fluid collection device that is adapted to receive a blood sample having a cellular portion and a plasma portion is disclosed. After collecting the blood sample, the biological fluid collection device is able to transfer the blood sample to a point-of-care testing device or a biological fluid separation and testing device. After transferring the blood sample, the biological fluid separation and testing device is able to separate the plasma portion from the cellular portion and analyze the blood sample and obtain test results.

# **BIOLOGICAL FLUID COLLECTION DEVICE AND BIOLOGICAL FLUID SEPARATION AND TESTING SYSTEM**

## **BACKGROUND OF THE INVENTION**

### **1. Field of the Disclosure**

**[0001]** The present disclosure relates generally to devices, assemblies, and systems adapted for use with vascular access devices. More particularly, the present disclosure relates to devices, assemblies, and systems adapted for collecting biological samples for use in point-of-care testing.

### **2. Description of the Related Art**

**[0002]** Blood sampling is a common health care procedure involving the withdrawal of at least a drop of blood from a patient. Blood samples are commonly taken from hospitalized, homecare, and emergency room patients either by finger stick, heel stick, or venipuncture. Blood samples may also be taken from patients by venous or arterial lines. Once collected, blood samples may be analyzed to obtain medically useful information including chemical composition, hematology, or coagulation, for example.

**[0003]** Blood tests determine the physiological and biochemical states of the patient, such as disease, mineral content, drug effectiveness, and organ function. Blood tests may be performed in a clinical laboratory or at the point-of-care near the patient. One example of point-of-care blood testing is the routine testing of a patient's blood glucose levels which involves the extraction of blood via a finger stick and the mechanical collection of blood into a diagnostic cartridge. Thereafter, the diagnostic cartridge analyzes the blood sample and provides the clinician a reading of the patient's blood glucose level. Other devices are available which analyze blood gas electrolyte levels, lithium levels, and ionized calcium levels. Some other point-of-care devices identify markers for acute coronary syndrome (ACS) and deep vein thrombosis/pulmonary embolism (DVT/PE).

**[0004]** Despite the rapid advancement in point-of-care testing and diagnostics, blood sampling techniques have remained relatively unchanged. Blood samples are frequently drawn using hypodermic needles or vacuum tubes attached to a proximal end of a needle or a catheter assembly. In some instances, clinicians collect blood from a catheter assembly using a needle and syringe that is inserted into the catheter to withdraw blood from a patient through the inserted catheter. These procedures utilize needles and vacuum tubes as intermediate devices from which the collected blood sample is typically withdrawn prior to testing. These processes are thus device intensive, utilizing multiple devices in the process of

obtaining, preparing, and testing blood samples. Each additional device increases the time and cost of the testing process.

**[0005]** Point-of-care testing devices allow for a blood sample to be tested without needing to send the blood sample to a lab for analysis. Thus, it is desirable to create a device that provides an easy, safe, reproducible, and accurate process with a point-of-care testing system.

#### SUMMARY OF THE INVENTION

**[0006]** The present disclosure provides a biological fluid collection device, such as a blood collection device, that is adapted to receive a blood sample having a cellular portion and a plasma portion. After collecting the blood sample, the biological fluid collection device is able to transfer the blood sample to a point-of-care testing device or a biological fluid separation and testing device, such as a blood separation and testing device. After transferring the blood sample, the biological fluid separation and testing device is able to separate the plasma portion from the cellular portion and analyze the blood sample and obtain test results. In one embodiment, the biological fluid collection device provides a closed system that reduces the exposure of a blood sample to both skin and environment and provides fast mixing of a blood sample with a sample stabilizer. The sample stabilizer can be an anticoagulant, or a substance designed to preserve a specific element within the blood such as, for example, RNA, protein analyte, or other element.

**[0007]** In accordance with an embodiment of the present invention, a biological fluid collection device includes a lancet housing having an inlet port and an interior defining a first flow channel in fluid communication with the inlet port. The device also includes a second flow channel in fluid communication with the first flow channel, and at least a portion of the second flow channel is diverted from the first flow channel. The device also includes a puncturing element which is moveable between a pre-actuated position, in which the puncturing element is retained within the interior, and a puncturing position, in which the puncturing element extends through the inlet port of the housing and provides fluid communication with the first flow channel. The device also includes a transfer cartridge having a reservoir, and the second flow channel is in fluid communication with the reservoir of the transfer cartridge.

**[0008]** In certain configurations, the first flow channel is adapted to receive a blood sample therein. The first flow channel may be dimensioned to receive the first blood provided to the flow channel. The first flow channel may include a reservoir region spaced apart from the inlet port, and a truncated region spaced apart from the reservoir region. The second flow

channel may be provided in fluid communication with the truncated region. The transfer cartridge may be removably engageable with a portion of the housing. An internal fill volume of the reservoir may correspond to a volume of fluid required to perform a diagnostic test. At least one of the first flow channel and the second flow channel may include a vent to atmosphere.

**[0009]** In accordance with another embodiment of the present invention, a biological fluid separation device includes a rotatable body having a center of rotation and an outer periphery. The rotatable body has a body inlet adapted to receive a multi-component blood sample. The device also includes a separation chamber defined within the rotatable body and in fluid communication with the body inlet. The separation chamber has a chamber outlet spaced apart from the body inlet, and the separation chamber is adapted to receive the multi-component blood sample. The device also includes a blood component chamber defined within the rotatable body and in fluid communication with the chamber outlet. When a rotational force is applied to the rotatable body, a component of the multi-component blood sample passes from the separation chamber into the blood component chamber and a second component of the multi-component blood sample is retained within the separation chamber. The blood component chamber is disposed adjacent the center of rotation and the separation chamber is disposed adjacent the outer periphery of the rotatable body.

**[0010]** In certain configurations, the blood component is a plasma component of the multi-component blood sample and the second component is a cellular component of the multi-component blood sample. The device may also include a diagnostic chamber in fluid communication with the blood component chamber. The rotatable body may be disc-shaped. In other configurations, the blood component chamber receives the blood component of the multi-component blood sample upon the rotatable body being rotated by a processing instrument. The device may also include a diagnostic chamber in fluid communication with the blood component chamber and a detection zone readable by a processing instrument.

**[0011]** In accordance with another embodiment of the present invention, a biological fluid separation and testing system, such as a blood separation and testing system, for a multi-component blood sample includes a biological fluid collection device. The biological fluid collection device includes a lancet housing having an inlet port and an interior defining a first flow channel in fluid communication with the inlet port. The device also includes a second flow channel in fluid communication with the first flow channel, and at least a portion of the second flow channel is diverted from the first flow channel. The device also includes a puncturing element moveable between a pre-actuated position, wherein the puncturing

element is retained within the interior, and a puncturing position, wherein the puncturing element extends through the inlet port of the housing and provides fluid communication with the first flow channel. The device further includes a transfer cartridge having a reservoir, with the second flow channel in fluid communication with the reservoir of the transfer cartridge. The system also includes a biological fluid separation device, such as a blood separation device, including a rotatable body having a center of rotation and an outer periphery. The rotatable body has a body inlet adapted to receive the multi-component blood sample. The separation device also includes a separation chamber defined within the rotatable body and in fluid communication with the body inlet. The separation chamber also has a chamber outlet spaced apart from the body inlet, with the separation chamber adapted to receive the multi-component blood sample therein. The separation device further includes a blood component chamber defined within the rotatable body and in fluid communication with the chamber outlet. When a rotational force is applied to the rotatable body, a component of the multi-component blood sample passes from the separation chamber into the blood component chamber and a second component of the multi-component blood sample is retained within the separation chamber. The blood component chamber is disposed adjacent the center of rotation and the separation chamber is disposed adjacent the outer periphery of the rotatable body, and the body inlet is engageable with the reservoir of the transfer cartridge.

**[0012]** In certain configurations, a portion of the rotatable body is threadably engageable with a portion of the transfer cartridge for aligning the body inlet in fluid communication with the reservoir. The first flow channel may be dimensioned to receive the first blood provided to the flow channel. The transfer cartridge may be removably engageable with a portion of the housing and subsequently engageable with a portion of the rotatable body.

**[0013]** In other configurations, at least one of the first flow channel and the second flow channel includes a vent to atmosphere. The system may also include a diagnostic chamber in fluid communication with the blood component chamber. In certain configurations, the blood component is a plasma component of the multi-component blood sample and the second component is a cellular component of the multi-component blood sample. The blood component chamber may receive the component of the multi-component blood sample upon the rotatable body being rotated by a processing instrument. The system may also include a diagnostic chamber in fluid communication with the blood component and including a detection zone readable by a processing instrument.

## BRIEF DESCRIPTION OF THE DRAWINGS

[0014] The above-mentioned and other features and advantages of this disclosure, and the manner of attaining them, will become more apparent and the disclosure itself will be better understood by reference to the following descriptions of embodiments of the disclosure taken in conjunction with the accompanying drawings, wherein:

[0015] **Fig. 1** is a perspective view of a biological fluid collection device in accordance with an embodiment of the present invention.

[0016] **Fig. 2** is an assembled, perspective view of a biological fluid collection device in accordance with an embodiment of the present invention, with a transfer cartridge received within a portion of a lancet housing.

[0017] **Fig. 3** is a cross-sectional view of a portion of a biological fluid collection device in accordance with an embodiment of the present invention.

[0018] **Fig. 4** is a perspective view of a biological fluid collection device in accordance with an embodiment of the present invention, with a lancet housing in a first position.

[0019] **Fig. 5** is a cross-sectional view of a lancet housing in accordance with an embodiment of the present invention.

[0020] **Fig. 6** is a perspective view of a biological fluid collection device in accordance with an embodiment of the present invention, with a lancet housing in a second position.

[0021] **Fig. 7** is a perspective view of a transfer cartridge and a biological fluid separation and testing device in accordance with an embodiment of the present invention.

[0022] **Fig. 8** is an elevation view of a biological fluid separation and testing device in accordance with an embodiment of the present invention.

[0023] **Fig. 9** is a perspective view of a processing and analyzing instrument in accordance with an embodiment of the present invention.

[0024] **Fig. 10** is a cross-sectional view of a valve of a transfer cartridge in accordance with an embodiment of the present invention, with the valve in a closed position.

[0025] **Fig. 11** is a cross-sectional view of a valve of a transfer cartridge in accordance with an embodiment of the present invention, with the valve in an open position.

[0026] Corresponding reference characters indicate corresponding parts throughout the several views. The exemplifications set out herein illustrate exemplary embodiments of the disclosure, and such exemplifications are not to be construed as limiting the scope of the disclosure in any manner.

## DETAILED DESCRIPTION OF THE EMBODIMENTS

[0027] The following description is provided to enable those skilled in the art to make and use the described embodiments contemplated for carrying out the invention. Various modifications, equivalents, variations, and alternatives, however, will remain readily apparent to those skilled in the art. Any and all such modifications, variations, equivalents, and alternatives are intended to fall within the spirit and scope of the present invention.

[0028] For purposes of the description hereinafter, the terms “upper”, “lower”, “right”, “left”, “vertical”, “horizontal”, “top”, “bottom”, “lateral”, “longitudinal”, and derivatives thereof shall relate to the invention as it is oriented in the drawing figures. However, it is to be understood that the invention may assume alternative variations and step sequences, except where expressly specified to the contrary. It is also to be understood that the specific devices and processes illustrated in the attached drawings, and described in the following specification, are simply exemplary embodiments of the invention. Hence, specific dimensions and other physical characteristics related to the embodiments disclosed herein are not to be considered as limiting.

[0029] Various point-of-care testing devices are known in the art. Such point-of-care testing devices include test strips, glass slides, diagnostic cartridges, or other testing devices for testing and analysis. Test strips, glass slides, and diagnostic cartridges are point-of-care testing devices that receive a blood sample and test that blood for one or more physiological and biochemical states. There are many point-of-care devices that use cartridge based architecture to analyze very small amounts of blood bedside without the need to send the sample to a lab for analysis. This saves time in getting results over the long run but creates a different set of challenges versus the highly routine lab environment. Examples of such testing cartridges include the i-STAT<sup>®</sup> testing cartridge from the Abbot group of companies. Testing cartridges such as the i-STAT<sup>®</sup> cartridges may be used to test for a variety of conditions including the presence of chemicals and electrolytes, hematology, blood gas concentrations, coagulation, or cardiac markers. The results of tests using such cartridges are quickly provided to the clinician.

[0030] However, the samples provided to such point-of-care testing cartridges are currently manually collected with an open system and transferred to the point-of-care testing cartridge in a manual manner that often leads to inconsistent results, thereby negating the advantage of the point-of-care testing device. Accordingly, a need exists for a system for collecting and transferring a sample to a point-of-care testing device that provides safer, reproducible, and more accurate results. Accordingly, a point-of-care collecting and transferring system of the



present disclosure will be described hereinafter. A system of the present disclosure enhances the reliability of the point-of-care testing device by: 1) incorporating a more closed type of sampling and transfer system; 2) minimizing open exposure of the sample; 3) improving sample quality; and 4) improving the overall ease of use.

[0031] **Figs. 1-9** illustrate an exemplary embodiment of the present disclosure. Referring to **Figs. 1-9**, a biological fluid collection device, such as a blood collection device **10**, of the present disclosure is adapted to receive a multi-component blood sample **12** having a cellular portion **14** and a plasma portion **16**.

[0032] **Fig. 7** illustrates an exemplary embodiment of the present disclosure. Referring to **Fig. 7**, a biological fluid separation and testing system, such as a blood separation and testing system **20**, of the present disclosure includes a blood collection device **10** and a biological fluid separation and testing device, such as a blood separation and testing device, or point-of-care testing device **22** engageable with the blood collection device **10** for closed transfer of a blood sample **12** from the blood collection device **10** to the blood separation and testing device **22**. After transferring the blood sample **12**, the blood separation and testing device **22** is able to separate the plasma portion **16** from the cellular portion **14** of the multi-component blood sample and analyze the blood sample and obtain test results.

[0033] Referring to **Figs. 1-6**, the blood collection device **10** includes a lancet housing **26** and a transfer cartridge **28** that is removably engageable with a portion of the lancet housing **26**. The lancet housing **26** generally includes a top portion **30**, a bottom portion **31**, a central aperture or interior **32**, an inlet port **34**, a first flow channel **36**, a second flow channel **38**, a reservoir region **40**, a truncated region **42**, a puncturing element engagement portion **44**, an adhesive **46** on the bottom portion **31** of the lancet housing **26**, and a transfer cartridge receiving cavity **48**. The inlet port **34** and the first flow channel **36** are adapted to receive a blood sample therein.

[0034] In one embodiment, the lancet housing **26** includes a diverted and vented chamber or reservoir region **40** that pulls off a first drop of blood. In one embodiment, the reservoir region **40** includes a vent or a vent hole. In another embodiment, the reservoir region **40** could contain a small sponge or a wicking material that assists in drawing a first drop of blood. In yet another embodiment, the reservoir region **40** could include a passive valve design. For example, the reservoir region **40** could include structure that would fill the reservoir region **40** first and only once the reservoir region **40** is sufficiently filled would a barrier, such as a capillary break, be overcome thereby allowing a blood sample to flow to the transfer cartridge **28**. In other embodiments, the blood collection device **10** could include any

mechanism that is adapted to pull a first drop of blood into the reservoir region **40** without the first drop of blood flowing to the transfer cartridge **28**.

[0035] In one embodiment, the lancet housing **26** includes the first flow channel **36** that is in fluid communication with the inlet port **34** and the second flow channel **38** is in fluid communication with the first flow channel **36**. In one embodiment, at least a portion of the second flow channel **38** is diverted from the first flow channel **36**. In one embodiment, at least one of the first flow channel **36** and the second flow channel **38** includes a vent to atmosphere.

[0036] Referring to **Fig. 3**, in one embodiment, the first flow channel **36** of the lancet housing **26** includes a reservoir region **40** that is spaced apart from the inlet port **34** and a truncated region **42** that is spaced apart from the reservoir region **40**. In one embodiment, the second flow channel **38** of the lancet housing **26** is provided in fluid communication with the truncated region **42**.

[0037] Referring to **Figs. 1-6**, the blood collection device **10** also includes a puncturing element structure **70** that may be secured within the central aperture or interior **32** of the lancet housing **26**. The puncturing element structure **70** generally includes a first end **72**, a second end **74**, a push button **76** adjacent the first end **72**, a puncturing element **78** adjacent the second end **74**, and a housing engagement portion **80**. The housing engagement portion **80** engages the puncturing element engagement portion **44** of the lancet housing **26** for securing the puncturing element structure **70** to the lancet housing **26** within the central aperture **32** as shown in **Fig. 5**. The puncturing element structure **70** includes a puncturing element **78** having a puncturing end **82**. The puncturing end **82** is adapted for puncturing the skin surface **S** of a patient (**Fig. 4**), and may define a pointed end, a blade edge, or a similar cutting mechanism. The puncturing end **82** may include a preferred alignment orientation, such as with a pointed end of a blade aligned in a specific orientation. In one embodiment, the puncturing element **78** comprises a micro-needle array.

[0038] The puncturing element **78** is adapted for movement between a pre-actuated position wherein the puncturing element **78** including the puncturing end **82** is retained within the interior **32** of the lancet housing **26** and a puncturing position wherein the puncturing end **82** of the puncturing element **78** extends through the inlet port **34** of the lancet housing **26** to puncture a skin surface **S** of a patient to draw a blood sample **12**. In one embodiment, actuation of the push button **76** moves the puncturing element **78** from the pre-actuated position to the puncturing position.

[0039] In one embodiment, the lancet housing **26** of the blood collection device **10** may include a self-sealing dock that would allow an external lancet or puncturing element to be removably received within the lancet housing **26**. The external lancet or puncturing element could be either pre-integrated into the packaged blood collection device **10** or introduced separately by a user before using the blood collection device **10** of the present disclosure.

[0040] Referring to **Figs. 1-4**, the bottom portion **31** of the lancet housing **26** includes an adhesive or adhesive layer **46** so that the blood collection device **10** can be secured onto a skin surface **S** of a patient where a blood sample will be accessed. In one embodiment, the adhesive **46** of the bottom portion **31** is protected by a peel-off layer, similar to an adhesive bandage, which would be removed before placing the blood collection device **10** on the skin surface **S** of the patient's body. A hydrogel or other layer could be included to provide some thickness to the bottom portion **31** and help improve the stability of the adhesive seal. Additionally, in one embodiment, the adhesive **46** could include a chemistry to create a more liquid-tight seal, similar to painter's tape technology, where wetting from the paint itself causes a chemical reaction with the adhesive **46** to create a more water-tight barrier to prevent the paint from seeping under the tape. Importantly, the adhesive provides for proper adhesion of the lancet housing **26** to the skin surface **S** of a patient and minimizes skin contact which leads to a better sample for coagulation testing. The adhesive **46** of the lancet housing **26** can be punctured by the puncturing element **78** such that the blood evolving from the wound beneath passes through the cut into the lancet housing **26** to be collected inside the blood collection device **10**.

[0041] Referring to **Figs. 1-11**, the transfer cartridge **28** includes a first wall portion **50**, a second wall portion **52**, a transfer port **54**, a reservoir **68**, and a valve or septum **86** at the transfer port **54**. In one embodiment, an internal fill volume of the reservoir **68** of the transfer cartridge **28** corresponds to a volume of fluid required to perform a diagnostic test.

[0042] The transfer port **54** of the transfer cartridge **28** may include a valve or septum **86** that is transitionable between a closed position and an open position. With the valve **86** in an open position, the blood sample **12** may flow through the reservoir **68** of the transfer cartridge **28** to a blood separation and testing device **22** as described in more detail below.

[0043] Referring to **Fig. 2**, a portion of the transfer cartridge **28** can be received within the transfer cartridge receiving cavity **48** of the lancet housing **26**. In this initial position, the second flow channel **38** of the lancet housing **26** is in fluid communication with the reservoir **68** of the transfer cartridge **28** so that a collected blood sample **12** can flow through the inlet port **34** of the lancet housing **26** to the reservoir **68** of the transfer cartridge **28**. When the

reservoir **68** of the transfer cartridge **28** is filled with a blood sample **12**, the clinician or patient can remove the transfer cartridge **28** from the lancet housing **26** as shown in **Fig. 1**. When removed, the reservoir **68** of the transfer cartridge **28** and all flow channels of the lancet housing **26** are sealed from the external environment.

[0044] In one embodiment, with the transfer cartridge **28** received within the transfer cartridge receiving cavity **48** of the lancet housing **26**, the first wall portion **50** is received within the transfer cartridge receiving cavity **48** and the second wall portion **52** of the transfer cartridge **28** extends outward from the transfer cartridge receiving cavity **48**. In this manner, the second wall portion **52** of the transfer cartridge **28** can be grasped by a user to remove the transfer cartridge **28** from the lancet housing **26**.

[0045] The blood collection device **10** may also include a layer of sample stabilizer. For example, in one embodiment, a blood sample **12** that is collected within the blood collection device **10** may be exposed to and mixed with a sample stabilizer in a portion of the lancet housing **26** or the transfer cartridge **28**. The sample stabilizer can be an anticoagulant, or a substance designed to preserve a specific element within the blood such as, for example, RNA, protein analyte, or other element. In one embodiment, the sample stabilizer may be disposed in a portion of the lancet housing **26**. In another embodiment, the sample stabilizer may be disposed in a portion of the transfer cartridge **28** or any other area of the blood collection device **10** in which it contacts a blood sample.

[0046] Referring to **Figs. 7** and **8**, a blood separation and testing device or point-of-care testing device **22** includes a rotatable body **100** having a center of rotation **102** and an outer periphery **104**, a body inlet or receiving port **106**, a separation chamber **108**, a flow channel **110**, a blood component chamber, such as a plasma chamber **112**, and a diagnostic portion or diagnostic chamber **114** in fluid communication with the plasma chamber **112**. In one embodiment, the diagnostic chamber includes a detection zone **116** that is readable by a processing and analyzing instrument **200** (**Fig. 9**). In one embodiment, the rotatable body **100** is disc-shaped.

[0047] The receiving port or body inlet **106** is adapted to receive the valve **86** of the transfer port **54** of the transfer cartridge **28**. The blood separation and testing device **22** is adapted to receive the valve **86** of the transfer port **54** of the transfer cartridge **28** for closed transfer of a portion of the blood sample **12** from the reservoir **68** of the transfer cartridge **28** to the blood separation and testing device **22**. The blood separation and testing device **22** is able to separate the plasma portion **16** from the cellular portion **14** and analyze the blood sample **12** and obtain test results.

[0048] The separation chamber **108** is defined within the rotatable body **100** and is in fluid communication with the body inlet **106** and the separation chamber **108** includes a chamber outlet or flow channel **110** spaced apart from the body inlet **106**. The separation chamber **108** is adapted to receive both the cellular portion **14** and the plasma portion **16** therein.

[0049] The blood component chamber, such as the plasma chamber **112**, is defined within the rotatable body **100** and is in fluid communication with the separation chamber **108** via the flow channel or chamber outlet **110**. When a rotational force is applied to the rotatable body **100**, the plasma portion **16** passes from the separation chamber **108** into the plasma chamber **112** and the cellular portion **14** is retained within the separation chamber **108**. In one embodiment, the plasma chamber **112** receives the plasma portion **16** of the blood sample **12** upon the rotatable body **100** being rotated by a processing and analyzing instrument **200**. In one embodiment, the plasma chamber **112** is disposed adjacent the center of rotation **102** and the separation chamber **108** is disposed adjacent the outer periphery **104** of the rotatable body **100**.

[0050] Once a blood sample **12** is received into the blood separation and testing device **22**, the blood separation and testing device **22** may be inserted into a processing and analyzing instrument **200** that processes and analyzes the blood sample **12**. First, the blood separation and testing device **22** is spun at a high rate and the plasma portion **16** is separated from the cellular portion **14** in the separation chamber **108**. Then, the speed is slowed down to drive the plasma portion **16** to the plasma chamber **112** in a central portion of the blood separation and testing device **22**. The plasma portion **16** can then be processed inline through the diagnostic portion **114** of the blood separation and testing device **22**. Since the blood separation and testing device **22** may be of a compact disc format, the detection zone **116** is read by the internal laser of the processing and analyzing instrument **200** while it is still spinning or running.

[0051] Referring to **Fig. 7**, a blood separation and testing device **22** includes a receiving port or body inlet **106** adapted to receive the transfer port **54** of the transfer cartridge **28**. The blood separation and testing device **22** is adapted to receive the transfer port **54** of the transfer cartridge **28** for closed transfer of a portion of the blood sample **12** from the reservoir **68** of the transfer cartridge **28** to the blood separation and testing device **22**. The blood separation and testing device **22** is able to separate the plasma portion **16** from the cellular portion **14** and analyze the blood sample **12** and obtain test results.

[0052] As discussed above, the transfer port **54** of the transfer cartridge **28** may include a valve or septum **86** that is transitionable between a closed position and an open position.

With the valve or septum **86** in an open position (**Fig. 11**), the blood sample **12** may flow through the transfer port **54** to the body inlet **106** of the blood separation and testing device **22**.

[0053] In one embodiment, referring to **Figs. 10** and **11**, the valve **86** may generally include a transfer channel **90**, a bellows or deformable wall member **92**, and a septum or barrier **94** having a first barrier wall **96** and a second barrier wall **98**. Referring to **Fig. 10**, the valve **86** is in a closed position to prevent the blood sample **12** from flowing through the transfer port **54**. In this manner, the blood sample **12** is sealed within the transfer cartridge **28**. Referring to **Fig. 11**, the valve **86** is in an open position so that the blood sample **12** may flow through the transfer port **54** to a blood separation and testing device **22**.

[0054] Referring to **Fig. 11**, with the blood sample **12** received within the transfer port **54** of the transfer cartridge **28**, the transfer port **54** of the transfer cartridge **28** is then positioned over the receiving port or body inlet **106** of the blood separation and testing device **22**. Pushing down in the direction of arrow **B** compresses the deformable wall member **92** and opens up the first barrier wall **96** and the second barrier wall **98** of the septum **94** as shown in **Fig. 11**. With the valve **86** in the open position, the blood sample **12** is allowed to flow through the transfer port **54** and to the blood separation and testing device **22** in a closed manner reducing exposure to the clinician and the patient.

[0055] The valve **86** of the transfer cartridge **28** only opens when the transfer port **54** is pressed upon the receiving port **106** of the blood separation and testing device **22**. This releases the blood sample **12** directly into the receiving port **106** of the blood separation and testing device **22**, thus mitigating unnecessary exposure to the patient's blood.

[0056] In one embodiment, a portion of the rotatable body **100** of the blood separation and testing device **22** is threadably engageable with a portion of the transfer cartridge **28** for aligning the body inlet **106** in fluid communication with the reservoir **68** of the transfer cartridge **28**.

[0057] Referring to **Figs. 1-11**, use of a blood collection device of the present disclosure will now be described. Referring to **Fig. 4**, upon selecting a site, a clinician can adhere the adhesive **46** on the bottom portion **31** of the lancet housing **26** onto a skin surface **S** of a patient where a blood sample will be accessed over a selected sampling site.

[0058] Next, the push button **76** on the blood collection device **10** is depressed or actuated to move the puncturing element **78** from the pre-actuated position to the puncturing position so that the puncturing element **78** punctures the skin surface **S** of a patient. Thereafter, referring to **Fig. 6**, the blood collection device **10** is rolled back to collect a blood sample **12**

into the reservoir **68** of the transfer cartridge **28** via the inlet port **34** of the lancet housing **26**. In one embodiment, the blood sample **12** is exposed to and mixed with a sample stabilizer in a portion of the lancet housing **26** or the transfer cartridge **28**. The sample stabilizer can be an anticoagulant, or a substance designed to preserve a specific element within the blood such as, for example, RNA, protein analyte, or other element.

[0059] When the reservoir **68** of the transfer cartridge **28** is filled, the clinician or patient can remove the transfer cartridge **28** from the lancet housing **26** as shown in **Fig. 1**. When removed, the reservoir **68** of the transfer cartridge **28** and all flow channels of the lancet housing **26** are sealed from the external environment.

[0060] Referring to **Fig. 7**, the next step of the process involves insertion of the transfer cartridge **28** into a blood separation and testing device **22** to transfer a blood sample from the transfer cartridge **28** to the blood separation and testing device **22**. In one embodiment, the blood separation and testing device **22** may be a compact disc separation and testing system that is utilized as a point-of-care testing device.

[0061] Referring to **Figs. 7** and **11**, the transfer port **54** of the transfer cartridge **28** is positioned over the receiving port or body inlet **106** of the blood separation and testing device **22**. Pushing down in the direction of arrow **B** compresses the deformable wall member **92** and opens up the first barrier wall **96** and the second barrier wall **98** of the septum **94** as shown in **Fig. 11**. With the valve **86** in the open position, the blood sample **12** is allowed to flow through the transfer port **54** and to the blood separation and testing device **22** in a closed manner reducing exposure to the clinician and the patient. The valve **86** of the transfer cartridge **28** only opens when the transfer port **54** is pressed upon the receiving port **106** of the blood separation and testing device **22**. This releases the blood sample **12** directly into the receiving port **106** of the blood separation and testing device **22**, thus mitigating unnecessary exposure to the patient's blood.

[0062] Once a blood sample **12** is received into the blood separation and testing device **22**, the blood separation and testing device **22** may be inserted into a processing and analyzing instrument **200** that processes and analyzes the blood sample **12**. First, the blood separation and testing device **22** is spun at a high rate and the plasma portion **16** is separated from the cellular portion **14** in the separation chamber **108**. Then, the speed is slowed down to drive the plasma portion **16** to the plasma chamber **112** in a central portion of the blood separation and testing device **22**. The plasma portion **16** can then be processed inline through the diagnostic portion **114** of the blood separation and testing device **22**. Since the blood separation and testing device **22** may be of a compact disc format, the detection zone **116** is

read by the internal laser of the processing and analyzing instrument **200** while it is still spinning or running.

**[0063]** While this disclosure has been described as having exemplary designs, the present disclosure can be further modified within the spirit and scope of this disclosure. This application is therefore intended to cover any variations, uses, or adaptations of the disclosure using its general principles. Further, this application is intended to cover such departures from the present disclosure as come within known or customary practice in the art to which this disclosure pertains and which fall within the limits of the appended claims.



## CLAIMS:

1. A biological fluid separation device, comprising:
  - a rotatable body having a center of rotation and an outer periphery, the rotatable body having a body inlet adapted to receive a multi-component blood sample;
  - a separation chamber defined within the rotatable body and in fluid communication with the body inlet and having a chamber outlet spaced apart from the body inlet, the separation chamber adapted to receive the multi-component blood sample; and
  - a blood component chamber defined within the rotatable body and in fluid communication with the chamber outlet, wherein when a rotational force is applied to the rotatable body, a blood component of the multi-component blood sample passes from the separation chamber into the blood component chamber and a second component of the multi-component blood sample is retained within the separation chamber,wherein the blood component chamber is disposed adjacent the center of rotation and the separation chamber is disposed adjacent the outer periphery of the rotatable body.
2. The biological fluid separation device of claim 1, wherein the blood component is a plasma component of the multi-component blood sample and the second component is a cellular component of the multi-component blood sample.
3. The biological fluid separation device of claim 1, further comprising a diagnostic chamber in fluid communication with the blood component chamber.
4. The biological fluid separation device of claim 1, wherein the rotatable body is disc-shaped.
5. The biological fluid separation device of claim 1, wherein the blood component chamber receives the blood component of the multi-component blood sample upon the rotatable body being rotated by a processing instrument.
6. The biological fluid separation device of claim 1, further comprising a diagnostic chamber in fluid communication with the blood component chamber and including a detection zone readable by a processing instrument.

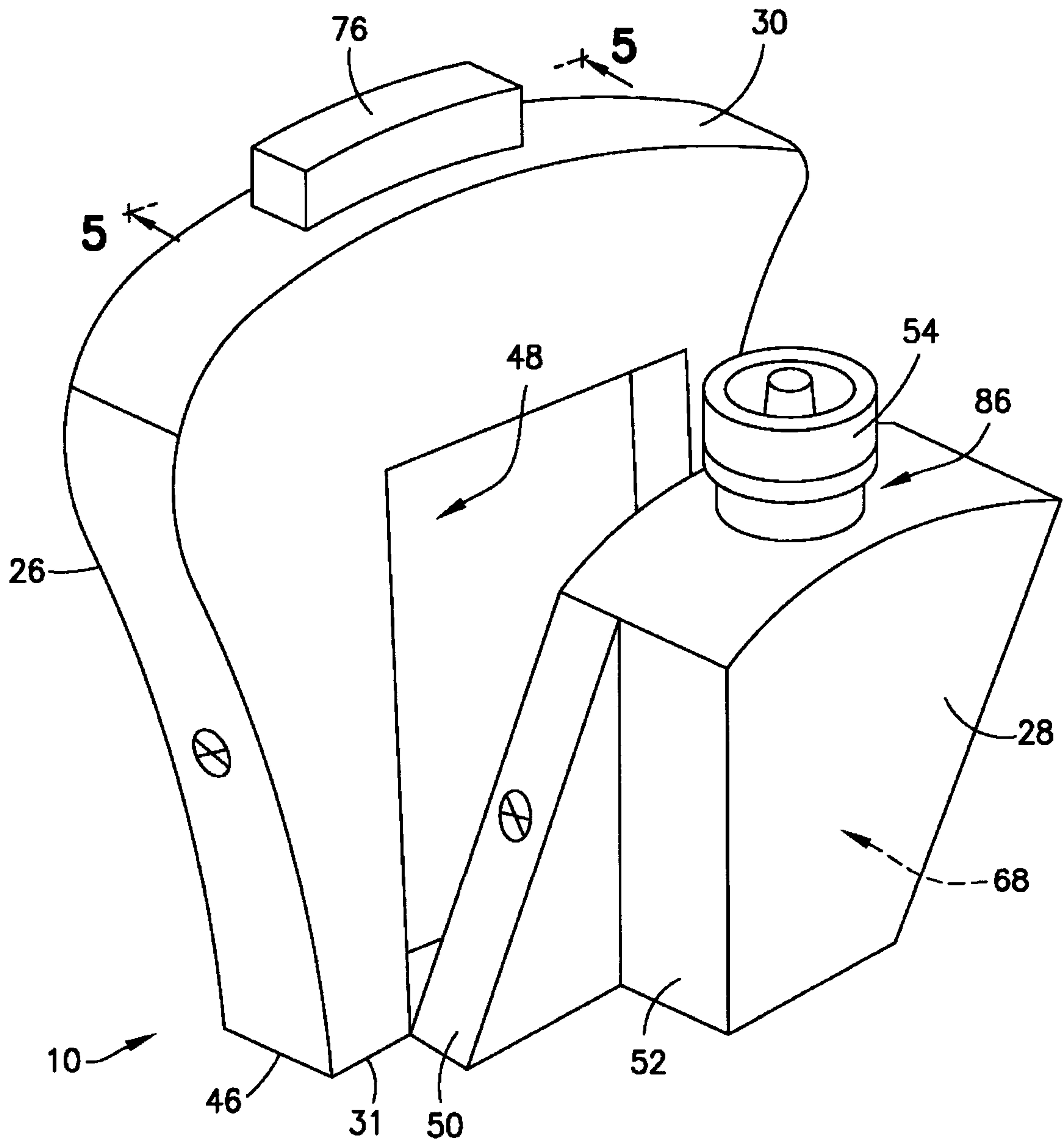

FIG. 1

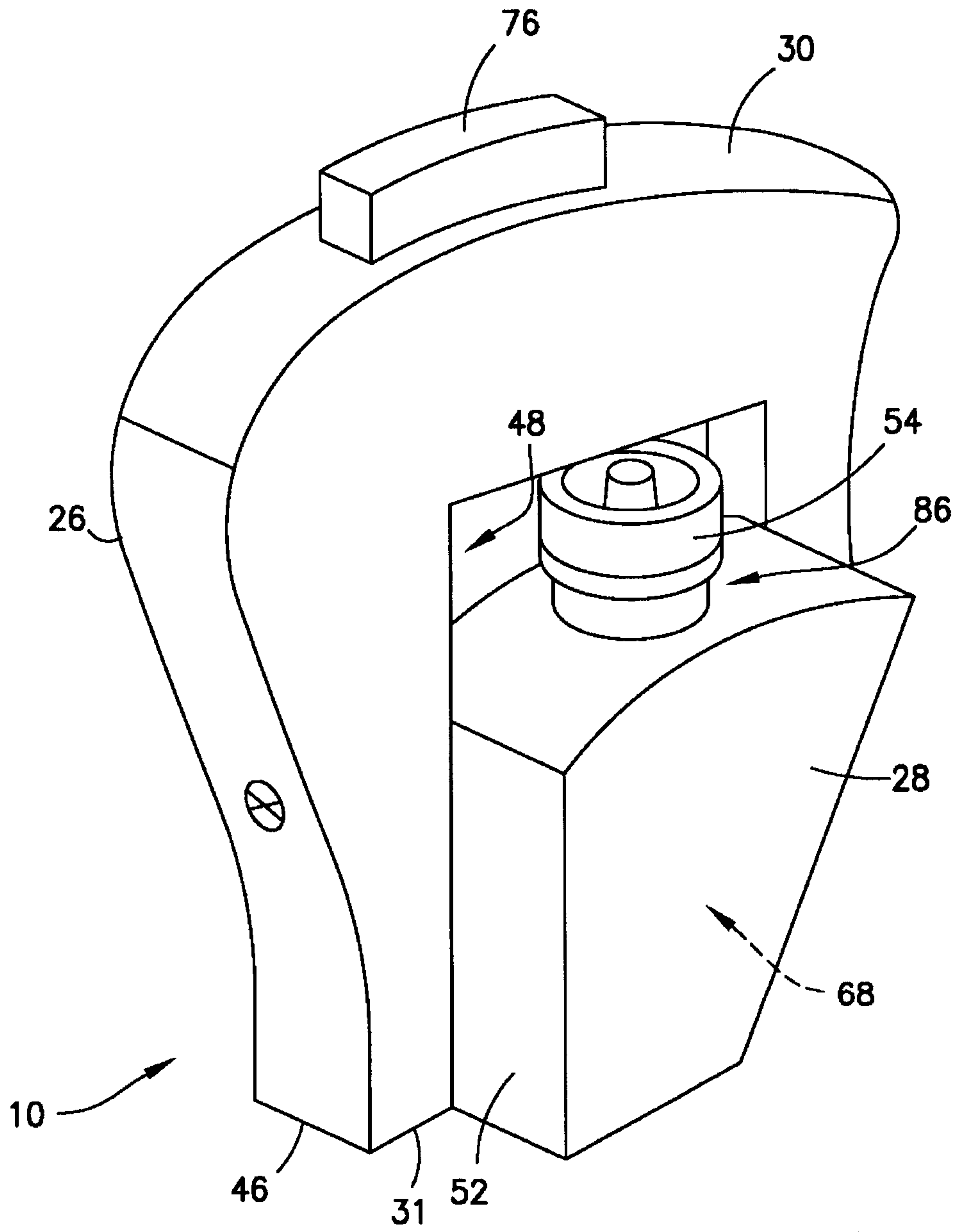

FIG.2

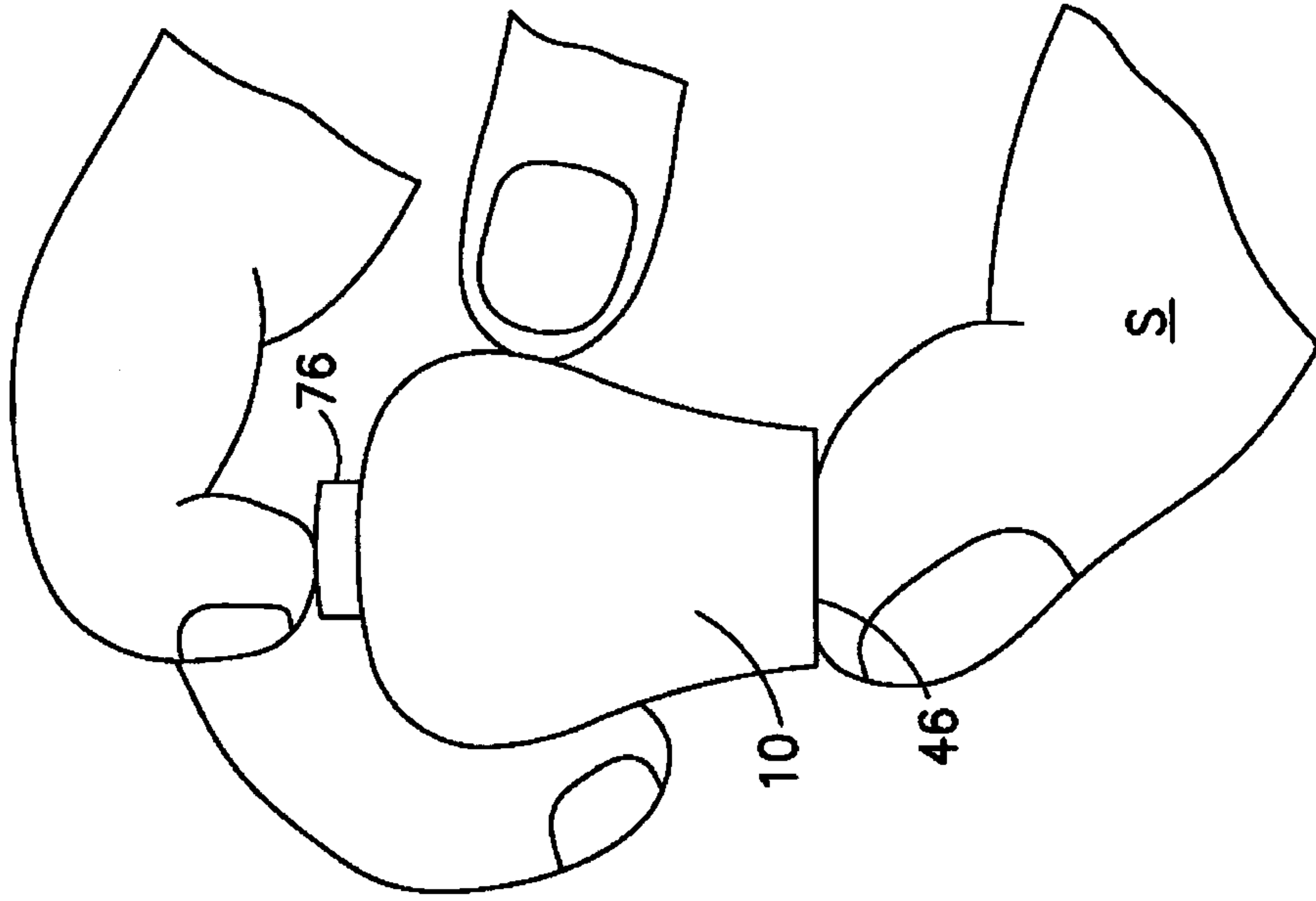

FIG. 4

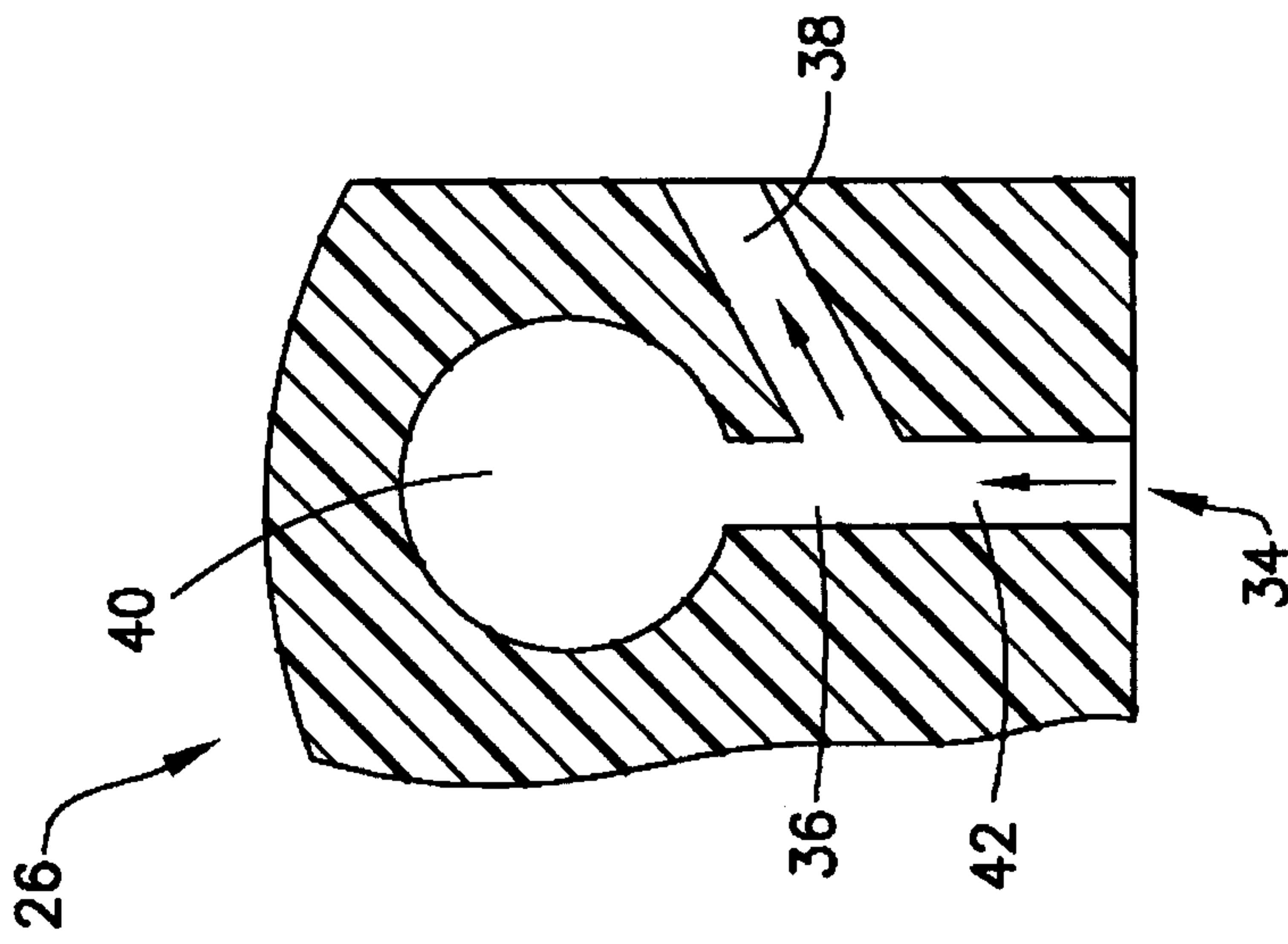
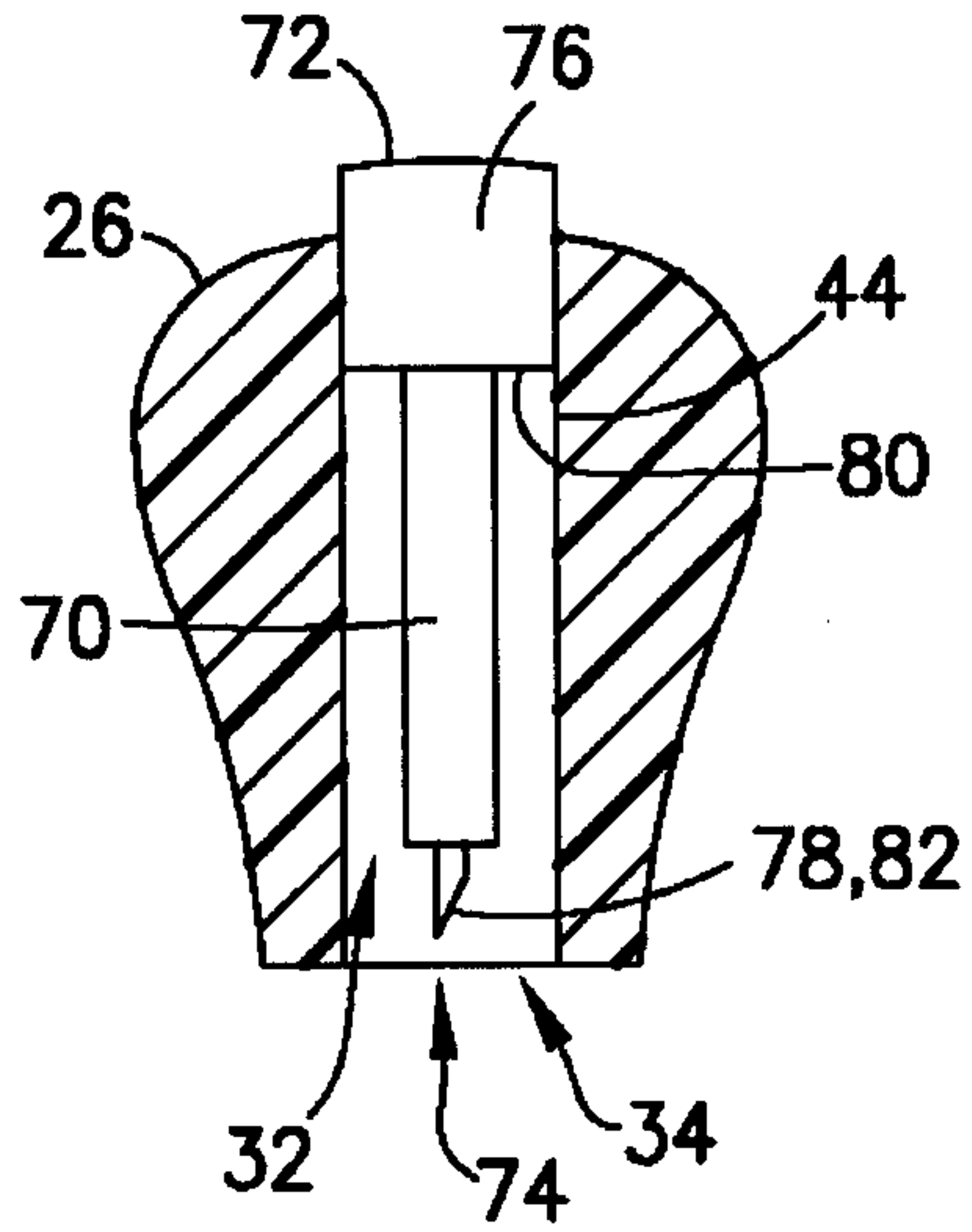
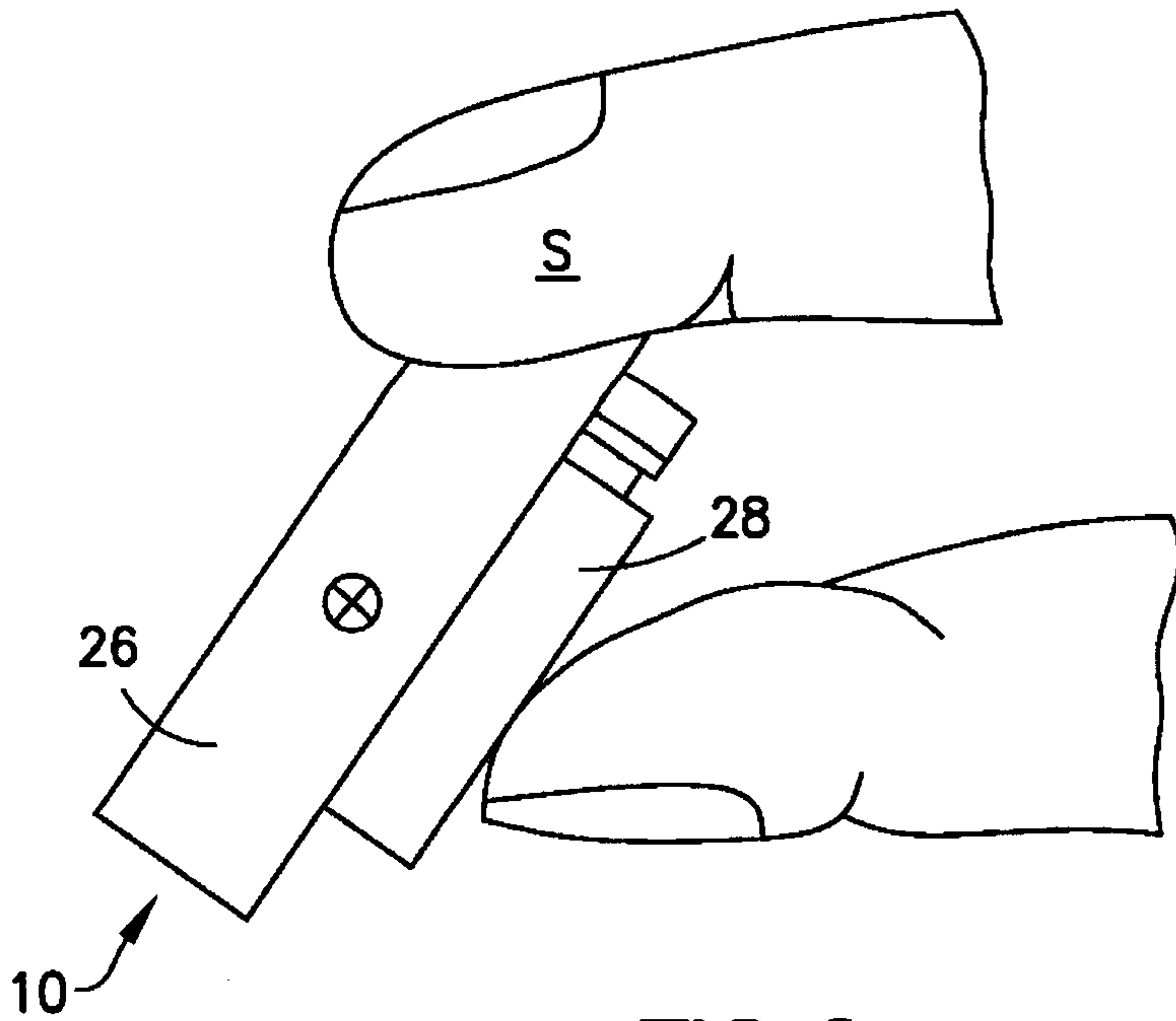

FIG. 3



**FIG.5**



**FIG.6**

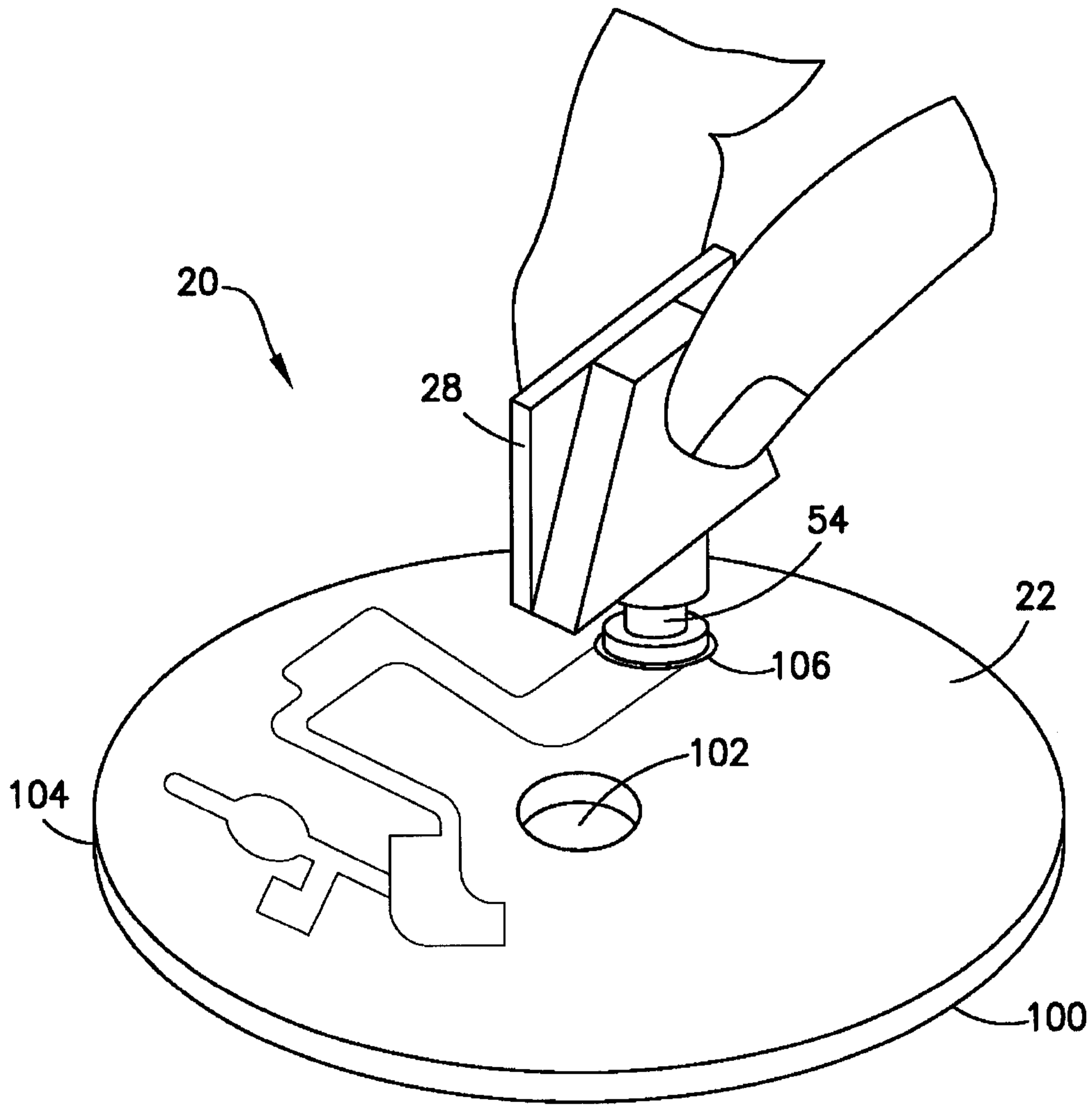

**FIG.7**

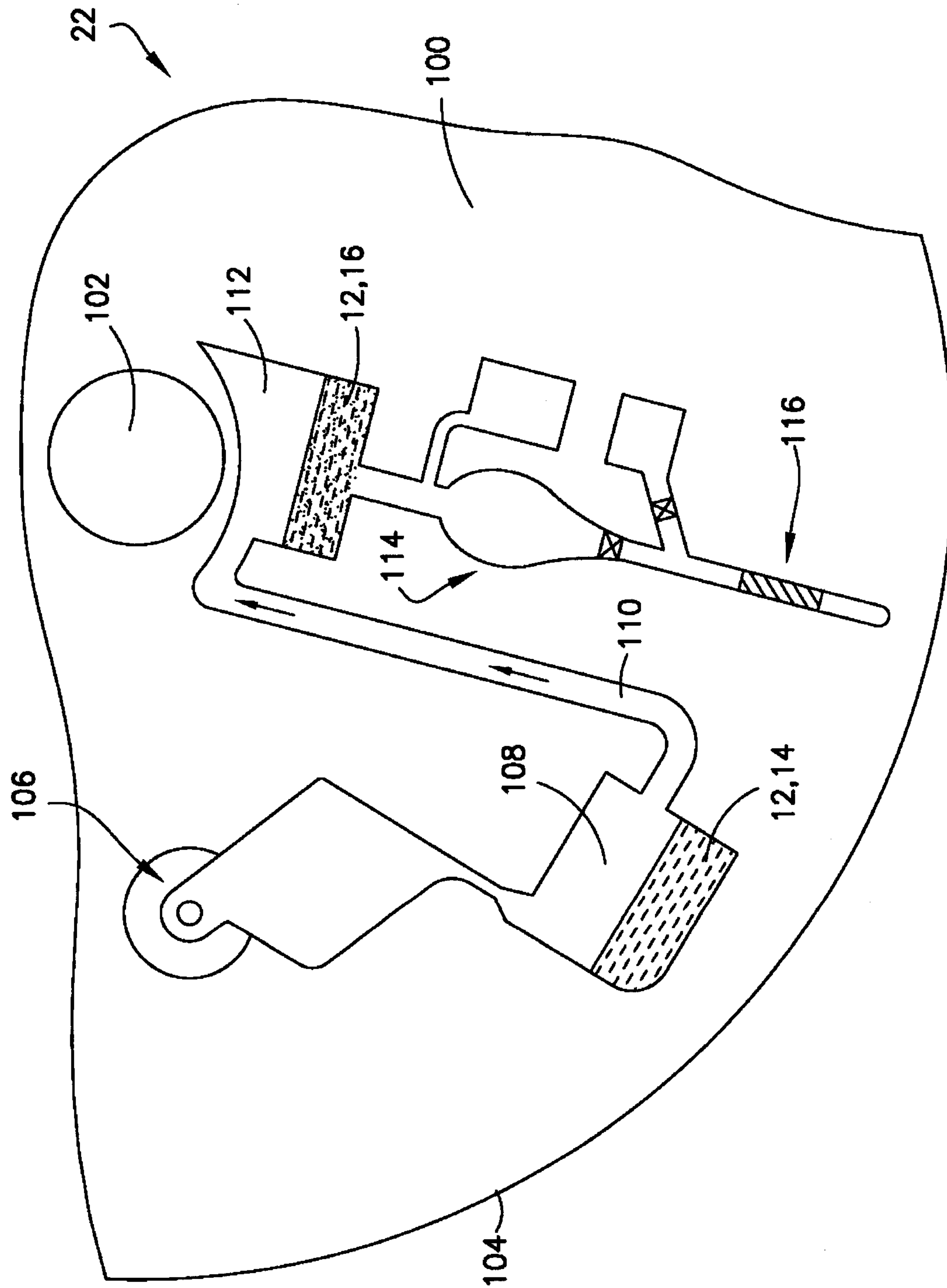
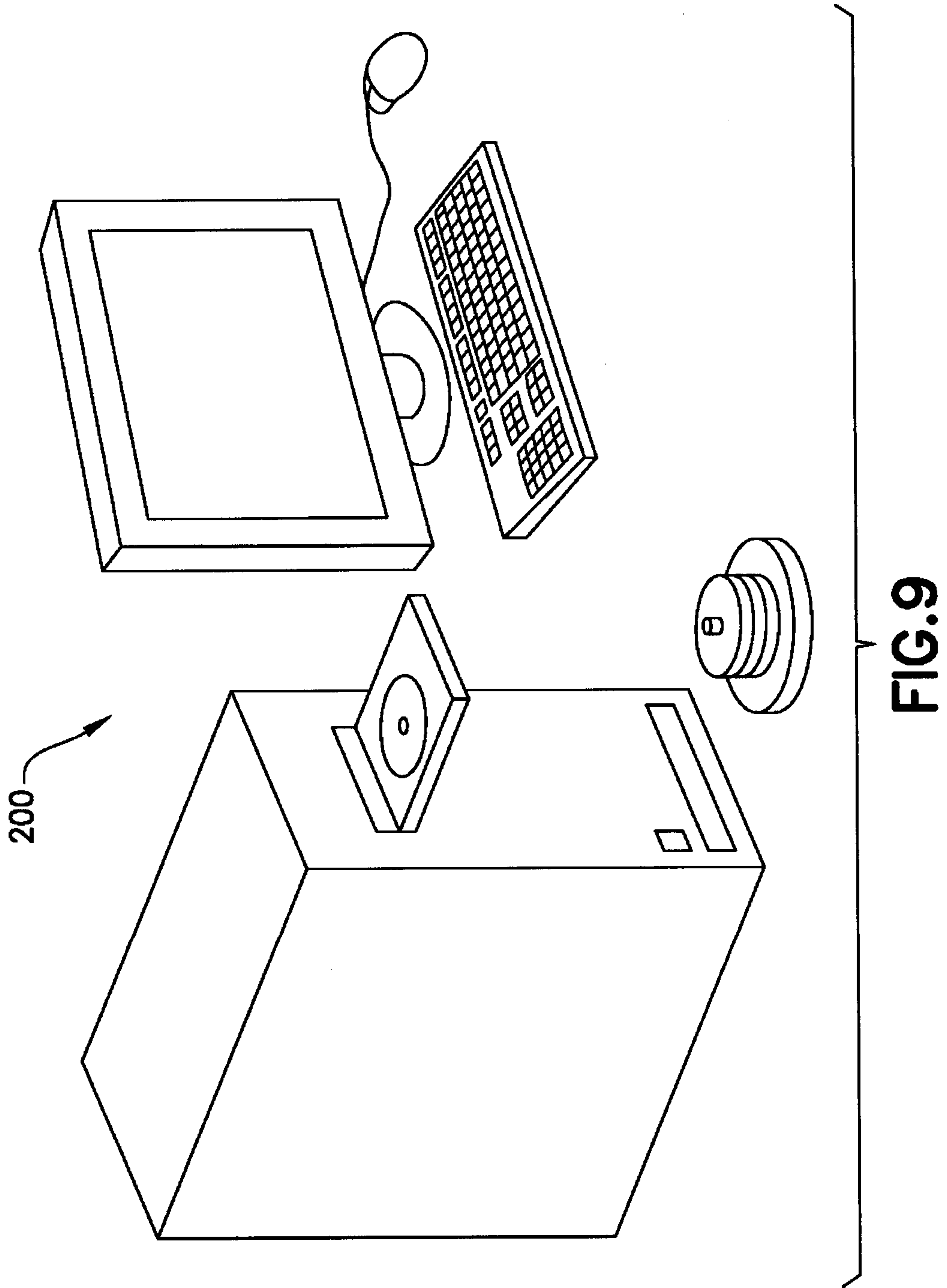

FIG.8





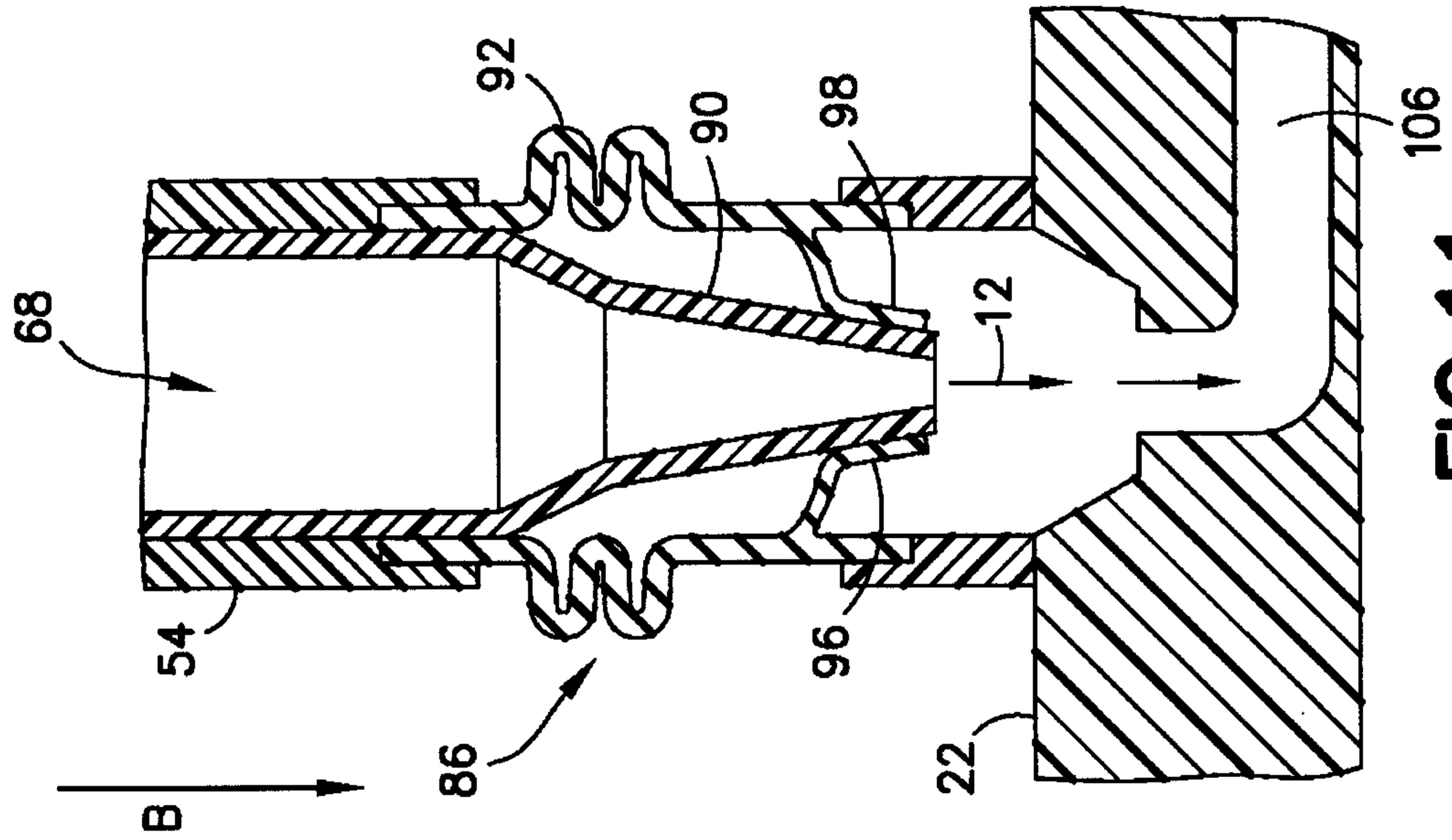

FIG. 10

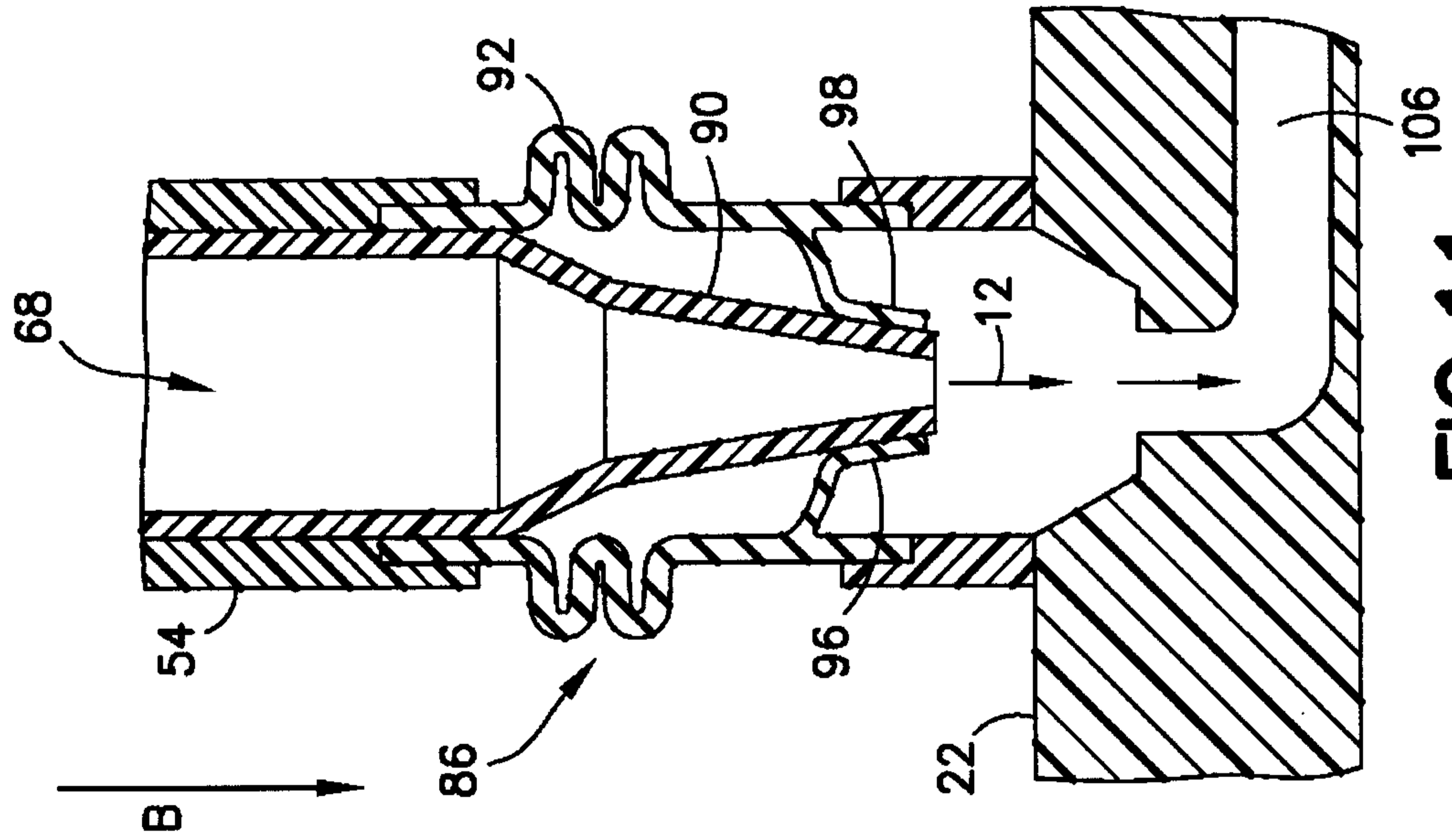

FIG. 11

