



US00D630502S

(12) **United States Design Patent**  
**Ishii et al.**

(10) **Patent No.:** **US D630,502 S**

(45) **Date of Patent:** **\*\* Jan. 11, 2011**

(54) **CORD LOCK**

(75) Inventors: **Taiyo Ishii**, Yokohama (JP); **Koji Yokota**, Tokyo (JP)

(73) Assignees: **Nifco Inc.**, Yokohama-Shi, Kanagawa-Ken (JP); **Morito Co., Ltd.**, Osaka (JP)

(\*\*) Term: **14 Years**

(21) Appl. No.: **29/347,860**

(22) Filed: **Jun. 25, 2010**

(30) **Foreign Application Priority Data**

Dec. 25, 2009 (JP) ..... 2009-030173

(51) **LOC (9) Cl.** ..... **08-08**

(52) **U.S. Cl.** ..... **D8/383**

(58) **Field of Classification Search** ..... D8/383,  
D8/356; 24/115 G, 112, 115 R, 136 R, 115 M  
See application file for complete search history.

(56) **References Cited**

**U.S. PATENT DOCUMENTS**

D417,388 S *	12/1999	Kawahara	.....	D8/383
D430,484 S *	9/2000	Ikeda	.....	D8/383
D439,507 S *	3/2001	Ikeda	.....	D8/383
D465,408 S *	11/2002	Man et al.	.....	D8/395
D481,300 S *	10/2003	Nezu	.....	D8/383
D551,067 S *	9/2007	Kawamura	.....	D8/383
D559,666 S *	1/2008	Yoshie et al.	.....	D8/383
D559,667 S *	1/2008	Yoshie et al.	.....	D8/383
D560,477 S *	1/2008	Yoshie et al.	.....	D8/383
D560,478 S *	1/2008	Yoshie et al.	.....	D8/383
D560,479 S *	1/2008	Yoshie et al.	.....	D8/383

D571,194 S *	6/2008	Mei	.....	D8/383
D584,942 S *	1/2009	Yoshie	.....	D8/383
D585,270 S *	1/2009	Yoshie	.....	D8/383
D585,271 S *	1/2009	Yoshie	.....	D8/383
D585,272 S *	1/2009	Yoshie	.....	D8/383
D615,391 S *	5/2010	Kawaguchi	.....	D8/383
2004/0074055 A1 *	4/2004	Watabe	.....	24/115 G
2010/0257701 A1 *	10/2010	Gammell et al.	.....	24/115 G

\* cited by examiner

*Primary Examiner*—Holly H Baynham

*Assistant Examiner*—Sheryl Lane

(74) *Attorney, Agent, or Firm*—Manabu Kanesaka

(57) **CLAIM**

The ornamental design for a cord lock, as shown and described.

**DESCRIPTION**

FIG. 1 is a perspective view of a cord lock showing our new design;

FIG. 2 is a front view thereof;

FIG. 3 is a rear view thereof;

FIG. 4 is a plan view thereof;

FIG. 5 is a bottom view thereof;

FIG. 6 is a right side view thereof, a left side view being the same as the right side view;

FIG. 7 is a perspective view of a male member of the cord lock shown separated for ease of illustration; and,

FIG. 8 is a sectional view of the cord lock taken along line 8—8 in FIG. 2.

**1 Claim, 6 Drawing Sheets**

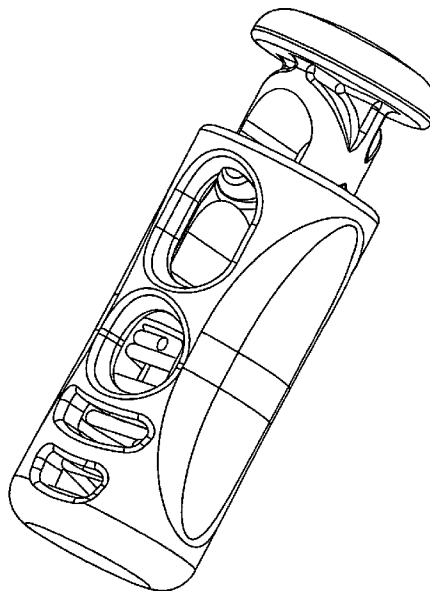

Fig. 1

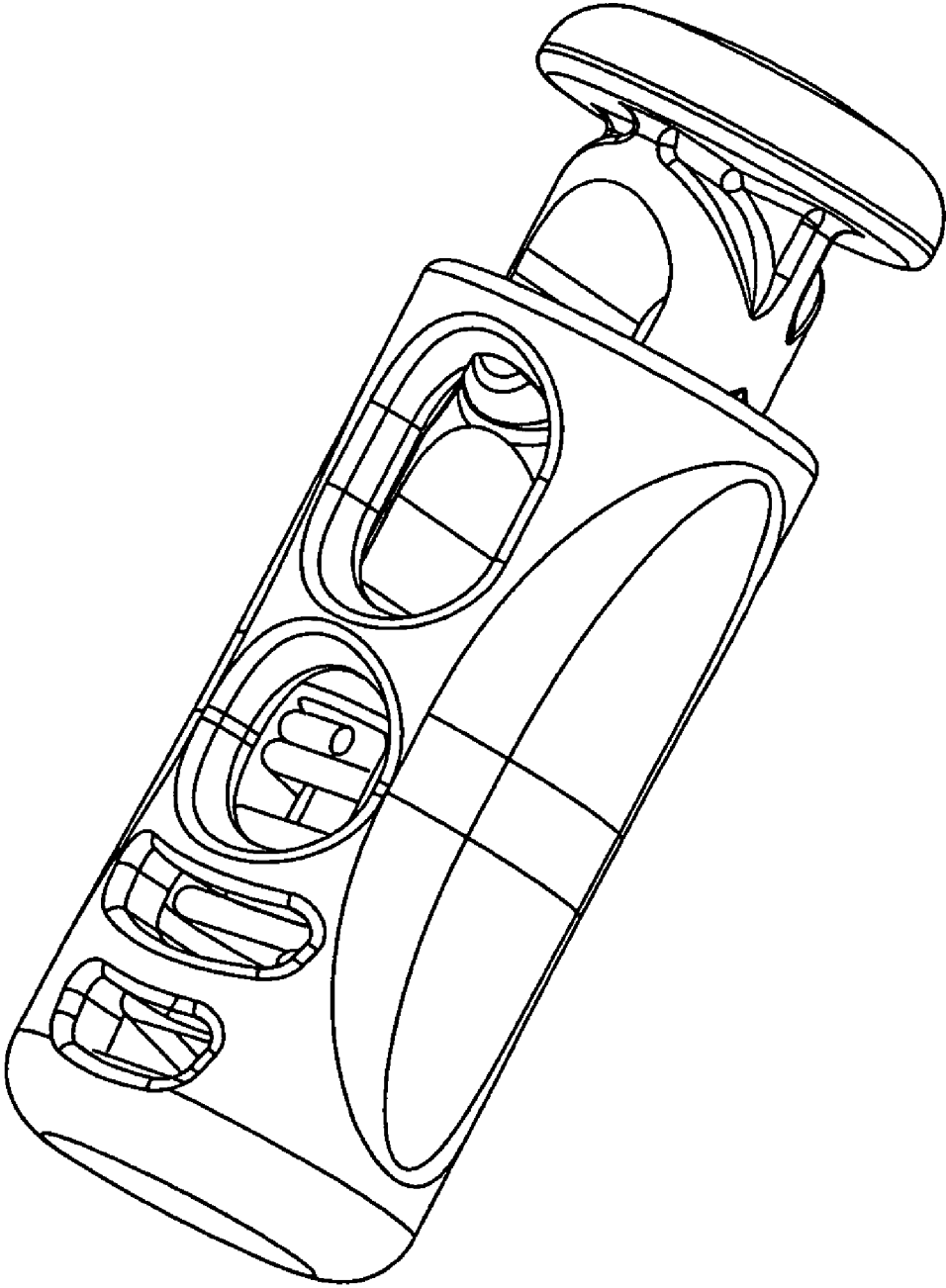

Fig. 2

Fig. 3

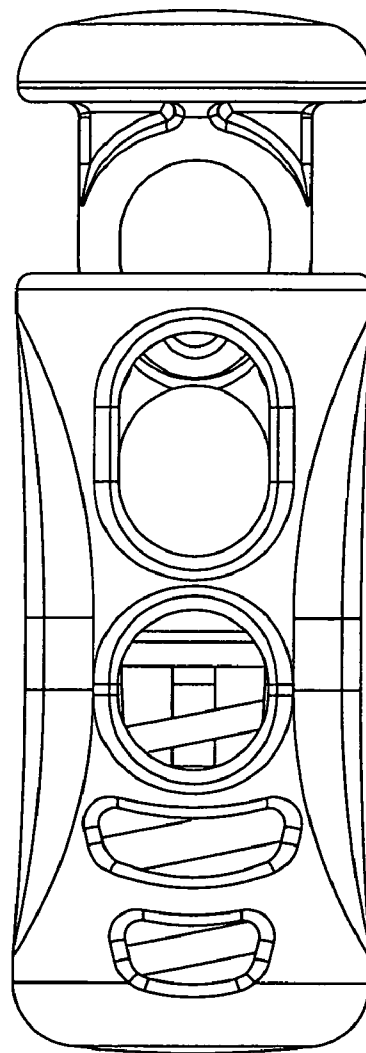
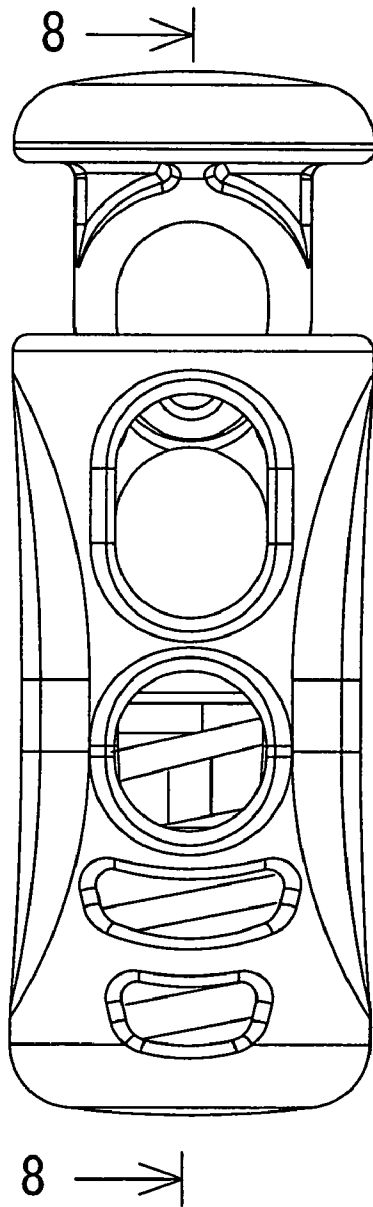

Fig. 4

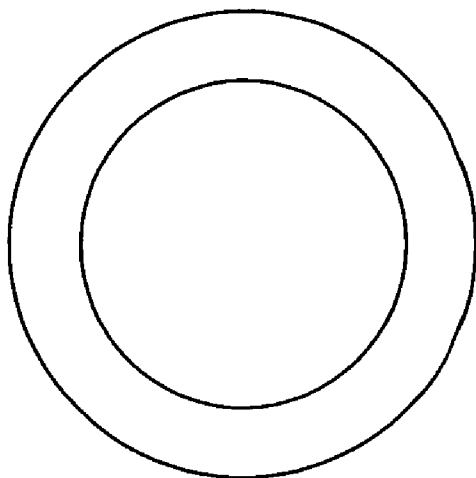

Fig. 5

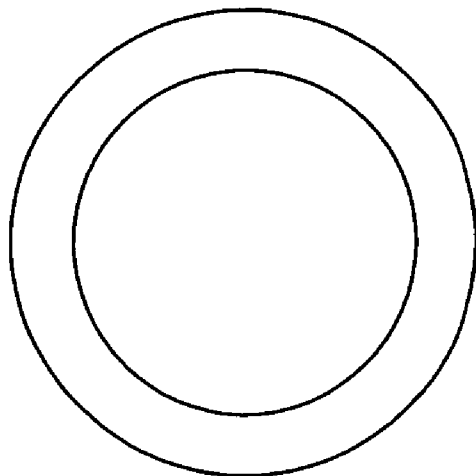

Fig. 6

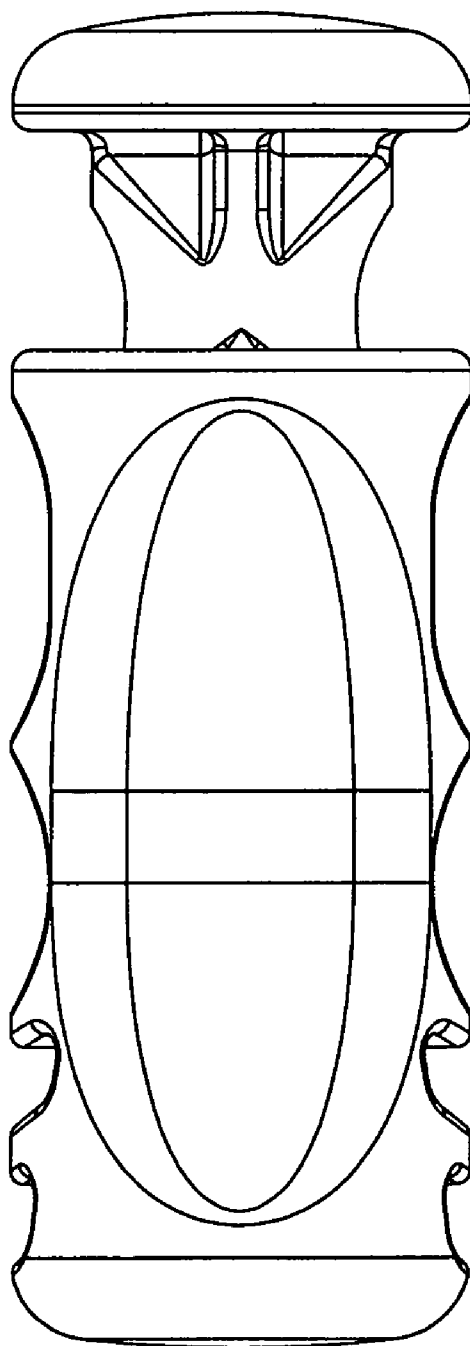

Fig. 7

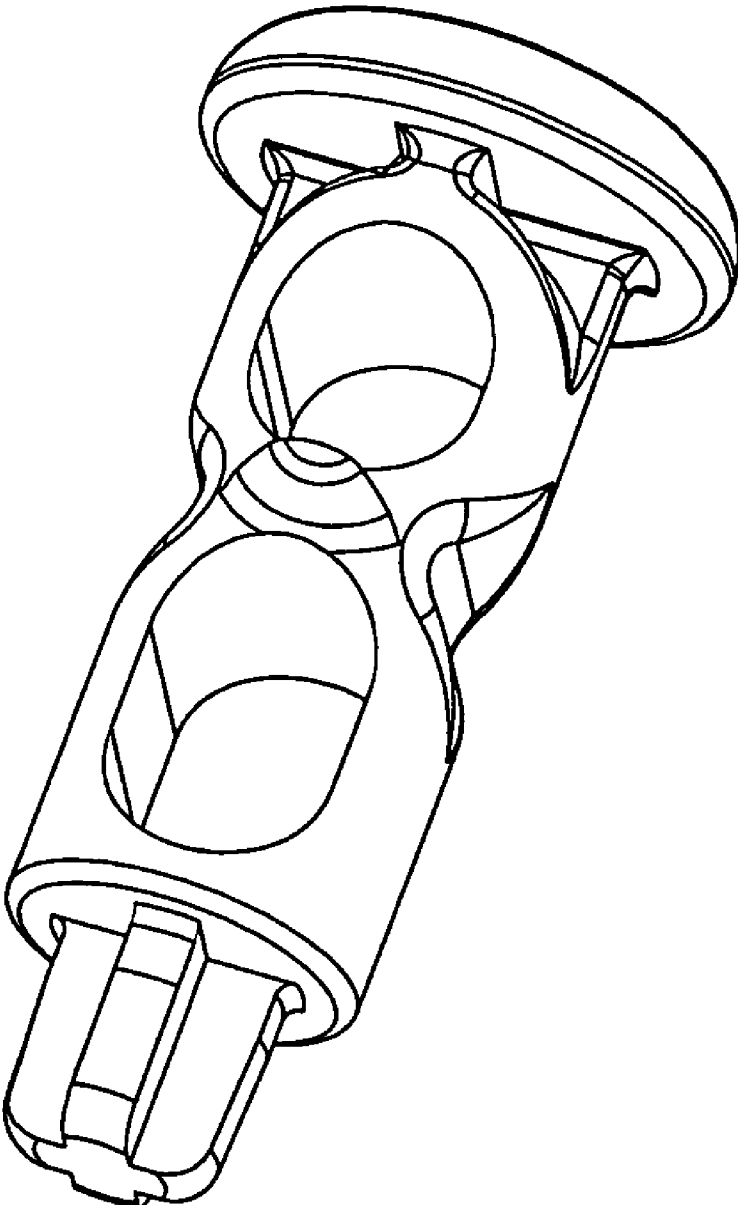

Fig. 8

