

(19)
(12)

(KR)
(A)

(51) 。 Int. Cl. 7
A61B 17/56

(11)
(43)

2002 - 0073438
2002 09 26

(21) 10 - 2002 - 0014088
(22) 2002 03 15

(30) 0103514 2001 03 15 (FR)

(71) , , (:33610)

(72) , , ,2
,33700 ,

(74)
:

(54)

(114) (22) (21) (2), (21)
(packer; 101)
(23)

5

1		1	,	
2	1		,	
3	1	2	(-)	,
4	2	1	(-)	,

5 2 ,
6 5 2 ,
7 2 ,
8 3 ,
9 4 .

< >

1; 101; 201; 301: 2:

21: 22:

23: 114:

. , , 가
: 가 , , 가 가 가
, , , 가
가 가 가
가 가 가

, 가 가 , ,

, (e) 가 (e) . , 가

, 1 2 1 1 2 2

, 2 1 , 2 1

, 가 가

(2)

(2),

(), (), : (21), " (2) (22) U 가

FR 2 642 643 FR 2 659 546 (2) (22) (2)

1) (24) V (23) (24)

1 4 , 1 (1)

(12) (15) , (14) (15)

(12) (12) V

(13) (15) (23) (2) (21) (2)

(24) , (1) (13) (12)

(15) (1) (A) (e)

4) 1 (2) (1) (11) (2)

(23) 가 (21) (1) (14) (11)

(11) (23) 가 (11)

(1) 316L , TA6V4 , PEEK(

) 가 3

가 (5)

5 7 , 2 (101)

(1) : (1)

(115) (15) ; 가 , (112) (12) (1)

15) (11) (111) 가 , (112) (13)

(113) (115) (114) (101)가 (116) 가 ,

(116) , (2) (21)

(2) (2) (101) (2)

(2) (101) (2) 1 (2) (

21) 가 , (2) (22)

(2) (22) (101) 5 (F)

(21) (116) (114) (116)

(21) (114) , (116)

가 , (101) 가 ,

(101) (111) (2) (23) 가

가 (101) 8 (2)

8 , 3 . (301) (301)
 (317) (311) (1)
 , 4 (317) , (311) (2) (23)
 , (301) , (301) (2) 1
 (1)
 (301) 1 (1)

9 , 4 , (201) (216) 가
 (101) (216) , (2) (21) (214)
 (201) (1) 3 , (201)
 (211) (23) (216)
 가 (201) (2) 1 (1)

, 가
 가
 , 가
 " (Morse tapers)"

(57)

1.

(22) (21) (2), (21) (14, 114,
 214, 314) (1, 101, 201, 301) ,
 (23)

2.

1 , (e) 가 (e) (116, 216)

3.

2 , 가 .

4.

2 3 , (116) (21)

5.

1 4 , (23)
(11, 111, 211, 311)

6.

5 , (301) (311) (317)

7.

1 6 , 1 , 1
(14, 114, 214, 314) 2 (1, 101, 201, 301)
1) 1 2 2 (13, 113, 213, 313)

8.

7 , 2 (13, 113, 213, 313) 1 (23)

9.

7 8 , 2 1 .

10.

1 9 .

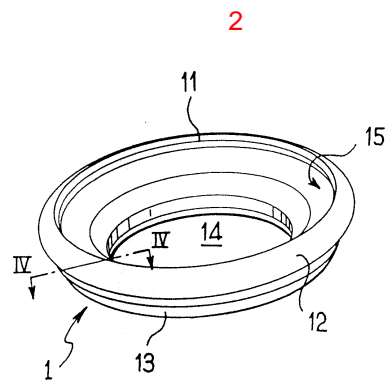
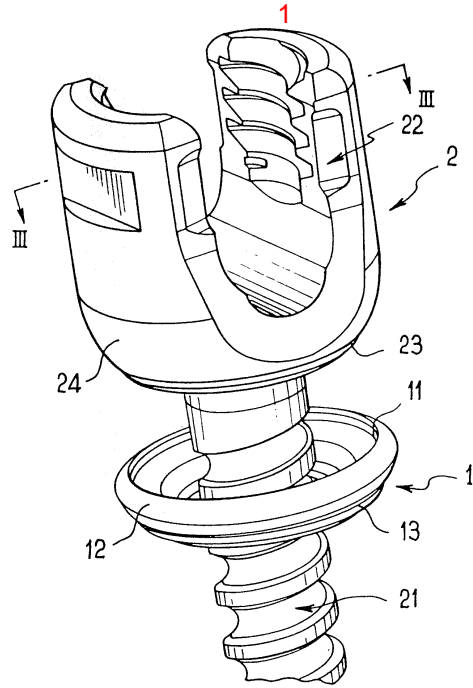

3

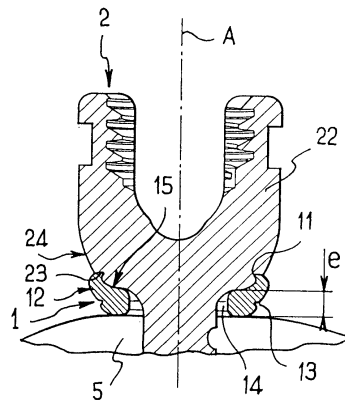

4

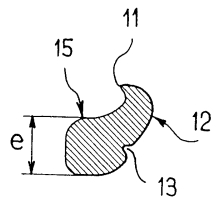

5

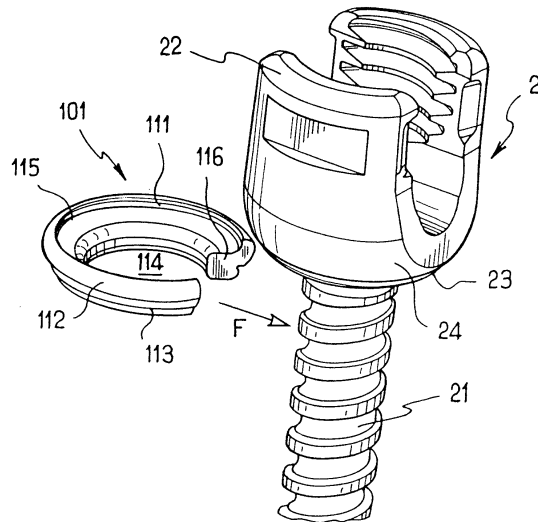

6

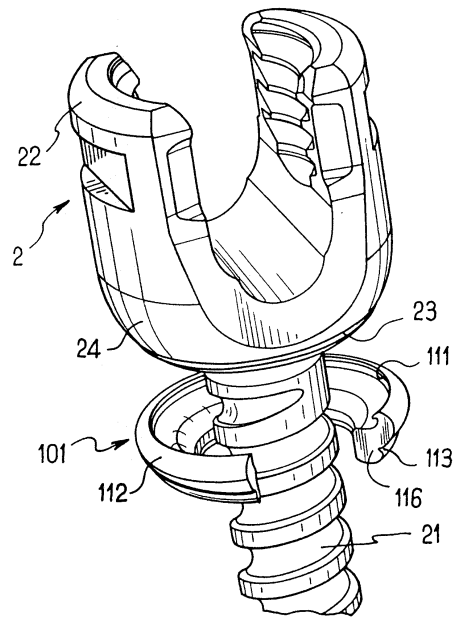

7

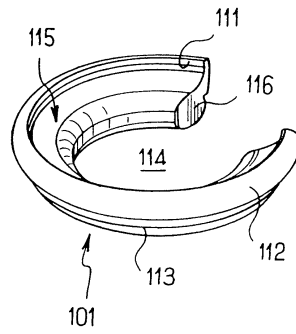

8

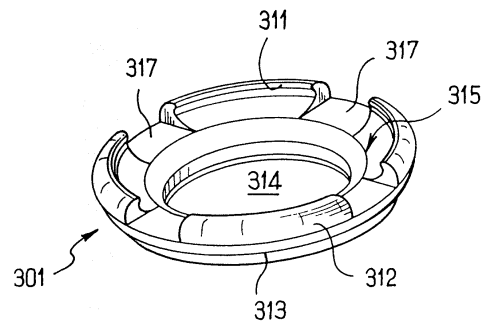

9

