

(12) INTERNATIONAL APPLICATION PUBLISHED UNDER THE PATENT COOPERATION TREATY (PCT)

(19) World Intellectual Property Organization  
International Bureau



(43) International Publication Date  
10 March 2011 (10.03.2011)

(10) International Publication Number  
**WO 2011/028370 A1**

- (51) International Patent Classification:  
A61F 5/00 (2006.01) A61M 39/02 (2006.01)
- (21) International Application Number:  
PCT/US2010/044957
- (22) International Filing Date:  
10 August 2010 (10.08.2010)
- (25) Filing Language: English
- (26) Publication Language: English
- (30) Priority Data:  
61/236,869 26 August 2009 (26.08.2009) US  
61/237,641 27 August 2009 (27.08.2009) US  
12/772,039 30 April 2010 (30.04.2010) US
- (71) Applicant (for all designated States except US): **ALLERGAN, INC.** [US/US]; 2525 Dupont Drive, T2-7H, Irvine, California 92612 (US).
- (72) Inventors; and  
(75) Inventors/Applicants (for US only): **OLROYD, Craig** [US/US]; 20 Oceano Avenue #1, Santa Barbara, California 93109 (US). **MUDD, Christopher** [US/US]; 451 Whitman Street, #B, Goleta, California 93117 (US). **TEZEL, Ahmet** [US/US]; 112 Gerard Drive, Goleta, California 93117 (US). **TURNER, Kris** [US/US]; 3715 Cordero Drive, Santa Barbara, California 93105 (US).
- (74) Agents: **VAKIL, Ketan, S.** et al.; Snell & Wilmer LLP, 600 Anton Blvd., Suite 1400, Costa Mesa, CA 92626 (US).

- (81) Designated States (unless otherwise indicated, for every kind of national protection available): AE, AG, AL, AM, AO, AT, AU, AZ, BA, BB, BG, BH, BR, BW, BY, BZ, CA, CH, CL, CN, CO, CR, CU, CZ, DE, DK, DM, DO, DZ, EC, EE, EG, ES, FI, GB, GD, GE, GH, GM, GT, HN, HR, HU, ID, IL, IN, IS, JP, KE, KG, KM, KN, KP, KR, KZ, LA, LC, LK, LR, LS, LT, LU, LY, MA, MD, ME, MG, MK, MN, MW, MX, MY, MZ, NA, NG, NI, NO, NZ, OM, PE, PG, PH, PL, PT, RO, RS, RU, SC, SD, SE, SG, SK, SL, SM, ST, SV, SY, TH, TJ, TM, TN, TR, TT, TZ, UA, UG, US, UZ, VC, VN, ZA, ZM, ZW.
- (84) Designated States (unless otherwise indicated, for every kind of regional protection available): ARIPO (BW, GH, GM, KE, LR, LS, MW, MZ, NA, SD, SL, SZ, TZ, UG, ZM, ZW), Eurasian (AM, AZ, BY, KG, KZ, MD, RU, TJ, TM), European (AL, AT, BE, BG, CH, CY, CZ, DE, DK, EE, ES, FI, FR, GB, GR, HR, HU, IE, IS, IT, LT, LU, LV, MC, MK, MT, NL, NO, PL, PT, RO, SE, SI, SK, SM, TR), OAPI (BF, BJ, CF, CG, CI, CM, GA, GN, GQ, GW, ML, MR, NE, SN, TD, TG).

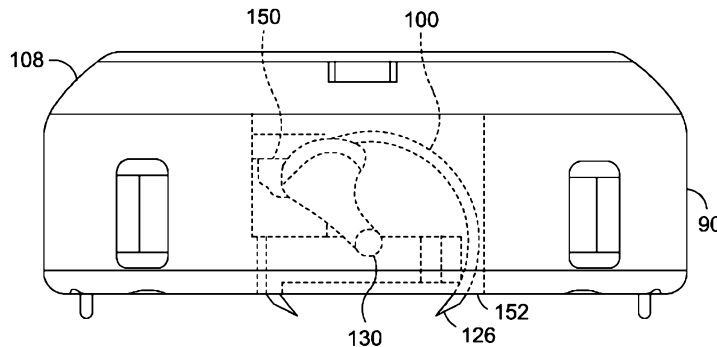
**Declarations under Rule 4.17:**

- as to applicant's entitlement to apply for and be granted a patent (Rule 4.17(ii))

**Published:**

- with international search report (Art. 21(3))
- before the expiration of the time limit for amending the claims and to be republished in the event of receipt of amendments (Rule 48.2(h))

(54) Title: SYSTEM INCLUDING ACCESS PORT AND APPLICATOR TOOL



**FIG. 11A**

(57) Abstract: The present invention provides a system for attaching a fluid access port to a patient. The system generally comprises an implantable access port and a tool for attaching an access port to a patient. The implantable access port may include a plurality of anchor assemblies composed of two different materials. In addition, a mesh member may be attached to the base of the access port to facilitate implantation of the access port into a patient's body. The tool may have a rotatable actuator head, and may engage the access port in various orientations.

WO 2011/028370 A1

**SYSTEM INCLUDING ACCESS PORT AND APPLICATOR TOOL**

BY

CRAIG OLROYD, CHRISTOPHER MUDD, AHMET TEZEL AND KRIS TURNER

**RELATED APPLICATIONS**

[0001] This application claims the benefit of U.S. Non-Provisional Patent Application Serial No. 12/772,039, filed April 30, 2010, U.S. Provisional Patent Application Serial No. 61/236,869, filed on August 26, 2009, and U.S. Provisional Patent Application Serial No. 61/237,641, filed on August 27, 2009, which Applications are hereby expressly incorporated in their entirety herein by reference.

**FIELD**

[0002] The present invention generally relates to medical systems and apparatus and uses thereof for treating obesity and/or obesity-related diseases, and more specifically, relates to access ports and tools for applying same to bodily tissue.

**BACKGROUND**

[0003] Adjustable gastric banding apparatus have provided an effective and substantially less invasive alternative to gastric bypass surgery and other conventional surgical weight loss procedures. Despite the positive outcomes of invasive weight loss procedures, such as gastric bypass surgery, it has been recognized that sustained weight loss can be achieved through a laparoscopically-placed gastric band, for example, the LAP-BAND® (Allergan, Inc., Irvine, CA) gastric band or the LAP-BAND AP® (Allergan, Inc., Irvine, CA) gastric band. Generally, gastric bands are placed about the cardia, or upper portion, of a patient's stomach forming a stoma that restricts food's passage into a lower portion of the stomach. When the stoma is of an appropriate size that is restricted by a gastric band, food held in the upper portion of the stomach provides a feeling of

satiety or fullness that discourages overeating. Unlike gastric bypass procedures, gastric band apparatus are reversible and require no permanent modification to the gastrointestinal tract.

**[0004]** Medical implants, including gastric band systems, for performing therapeutic functions for a patient are well known. Such devices include pace makers, vascular access ports, injection ports (such as used with gastric banding systems) and gastric pacing devices. Such implants need to be attached, typically subcutaneously, in an appropriate place in order to function properly. It is desirable that the procedure to implant such devices be quick, easy and efficient and require as small of an incision as possible.

#### **SUMMARY**

**[0005]** The present invention, in one aspect, provides a system for attaching a fluid access port to a patient. The system generally comprises an implantable access port and a tool for attaching an access port to a patient. The access port may be latched onto an interior portion, or muscle portion of a patient through various methods described herein.

**[0006]** In another aspect of the invention, access ports, or access port assemblies are provided. An access port assembly in accordance with the invention can be used in place of a conventional access port assembly designed to be used for facilitating inflation and deflation of a gastric band.

**[0007]** In yet another aspect of the invention, tools for securing a fluid access port assembly to a patient are provided.

**[0008]** In one embodiment, an access port assembly is provided which comprises a septum, for example, a self-sealing septum, for receiving a needle, and a plurality of anchor assemblies, spaced apart from the septum. Each of the anchor assemblies is rotatable from a deployed position to an undeployed position. In one embodiment, each of the anchor assemblies is rotatable

between a retracted or undeployed position, a midway position and a deployed position.

**[0009]** In one embodiment, each anchor assembly is a composite element. For example, each anchor assembly may be made of at least two different materials. In an exemplary embodiment, the anchor assembly includes a wire portion, for example made of a suitable metal, and a molded portion, for example, made of a polymer material, such as a suitable plastic, fixed to the wire portion.

**[0010]** In one embodiment, each anchor assembly is made of a bioresorbable material. A portion of each anchor assembly, or the entirety of each anchor assembly may be made of one or more bioresorbable materials.

**[0011]** The wire portion may include a curved region and a distal tip structured to penetrate and engage tissue. The molded portion is fixed to the wire portion, or molded to the wire portion. In one embodiment, the molded portion comprises a material which is overmolded to the wire portion. The molded portion may be molded or overmolded to a proximal region of the wire portion.

**[0012]** The molded portion may include a pivot axle substantially perpendicular to the plane of rotation of the wire portion. The molded portion may further comprise an actuator pin and a deploy pin spaced apart from the actuator pin.

**[0013]** In one embodiment, the rotation of an outer housing, or actuator, of the port causes each anchor assembly to rotate from the undeployed position to the deployed position. This may be accomplished by simply rotating the outer housing by hand which causes the anchor assemblies to deploy. Once deployed, there may be an audible "snap" to alert the physician that the anchors are fully deployed.

[0014] The anchor assembly and the actuator may be structured such that a torque applied to the anchor assembly increases as the anchor assemblies move from a retracted position to a deployed position.

[0015] In another aspect of the invention, an access port assembly is provided which comprises a septum, a housing secured to the septum and include a base substantially opposing the septum. The access port further comprises a plurality of anchors, for example, the anchor assemblies described elsewhere herein. In this particular embodiment, the access port assembly further comprises an attachment member, for example, a mesh member, secured to the base for encouraging tissue ingrowth when the port assembly is implanted in a patient. The mesh member is disposed along at least a portion of the housing and is effective to encourage or promote tissue ingrowth or tissue engagement after the access port assembly has been implanted in the patient.

[0016] In one embodiment, the mesh member does not substantially extend beyond the base. In another embodiment, the mesh member includes a portion extending beyond the base. For example, the portion of the mesh may extend outwardly from and substantially circumscribe the base.

[0017] Attachment of the mesh material may be accomplished in any suitable manner. For example, a size of mesh can be manually attached to a mesh ring that snaps to the bottom of the port (e.g., the base of the port). Alternatively, the mesh member can be ultrasonically welded to the bottom of a mesh ring that snaps onto the bottom of the port. In addition, the mesh member may be positioned between the mesh ring and the base of the port. Furthermore, the mesh member may be molded or overmolded to the base of the access port to form an integral member with the base. The mesh member may have an oversized

shape that allows the mesh to be supplied with the port and cut to the desired size.

**[0018]** In another aspect of the invention, a coating of bioresorbable material may be placed over a portion or the entirety of the base.

**[0019]** In another aspect of the invention, the base of the access port itself may be made of one or more bioresorbable materials.

**[0020]** In another aspect of the invention, a pulpation ring, or locking ring, may be fixed to the access port housing to form a ring-shaped gap. In addition, a compression ring may be placed within the access port housing. A portion of the septum may enter into the ring-shaped gap and be compressed by the pulpation ring and the compression ring, to provide a blocking point to prevent fluid from exiting the access port. The ring-shaped gap may be sized such that a standard syringe needle can not penetrate the septum in the cavity.

**[0021]** In another aspect of the invention, a tool is provided for facilitating attachment of a port, for example, the access port assembly described and shown elsewhere herein, to bodily tissue. In one embodiment, the tool includes a handle having a trigger, and an actuator head structured to removably engage the port housing.

**[0022]** In a particularly advantageous embodiment, the actuator head is rotatable or pivotal with respect to the handle, which facilitates manipulation and positioning of the access port. In one embodiment, the actuator head is rotatable at least 90 degrees and in other embodiments, the actuator head is rotatable up to 180 degrees, or even 360 degrees.

**[0023]** In another aspect of the invention, the actuator head is structured to engage the port assembly in more than one position, or orientation with respect to the actuator head.

[0024] These and other aspects of the invention may be more clearly understood and/or appreciated by referring to the accompanying drawings and detailed description.

#### **BRIEF DESCRIPTION OF THE DRAWINGS**

[0025] FIG. 1 illustrates a gastric band system according to an embodiment of the present invention.

[0026] FIG. 2A illustrates a perspective view of the inner diameter of the band corresponding to a decreased volume of fluid in the gastric band according to an embodiment of the present invention.

[0027] FIG. 2B illustrates a perspective view of the inner diameter of the band corresponding to an increased volume of fluid in the gastric band according to an embodiment of the present invention.

[0028] FIG. 3A illustrates a perspective view of the system of the present invention, including an access port and a tool according to an embodiment of the present invention.

[0029] FIG. 3B illustrates an exploded perspective view of the tool according to an embodiment of the present invention.

[0030] FIG. 3C illustrates a side view of the tool according to an embodiment of the present invention.

[0031] FIGS. 3D and 3E each illustrate a side, close-up view of the tool's handle according to an embodiment of the present invention.

[0032] FIGS. 4A and 4B each illustrate a side view of the tool according to an embodiment of the present invention.

[0033] FIG. 5A illustrates an exploded perspective view of the tool according to an embodiment of the present invention.

[0034] FIGS. 5B and 5D each illustrate a side view of the tool according to an embodiment of the present invention.

[0035] FIGS. 5C and 5E each illustrate a close-up view of a status indicator according to an embodiment of the present invention.

[0036] FIG. 6A illustrates an exploded perspective view of the access port according to an embodiment of the present invention.

[0037] FIG. 6B illustrates a close-up view of a tube connector according to an embodiment of the present invention.

[0038] FIG. 6C illustrates a perspective view of a tube connector according to an embodiment of the present invention.

[0039] FIG. 7 illustrates a perspective view of an anchor assembly according to an embodiment of the present invention.

[0040] FIG. 8A illustrates a perspective view of the access port according to an embodiment of the present invention.

[0041] FIG. 8B illustrates a top view of the access port according to an embodiment of the present invention.

[0042] FIG. 8C illustrates a side view of the access port according to an embodiment of the present invention.

[0043] FIGS. 9A, 9C, 9F, 9H and 9J each illustrate a side view of the access port according to an embodiment of the present invention.

[0044] FIGS. 9B, 9D, 9G, 9I and 9K each illustrate a bottom view of the access port according to an embodiment of the present invention.

[0045] FIG. 9L illustrates a side, cross sectional view of the access port according to an embodiment of the present invention.

[0046] FIG. 9E illustrates a perspective view of a mesh ring according to an embodiment of the present invention.

[0047] FIGS. 10A and 10D each illustrate a top view of the access port according to an embodiment of the present invention.



[0048] FIG. 10B illustrates a side view of the access port according to an embodiment of the present invention.

[0049] FIG. 10C illustrates a top, close-up, exposed view of the access port according to an embodiment of the present invention.

[0050] FIG. 10E illustrates a side, cross sectional view of the access port according to an embodiment of the present invention.

[0051] FIGS. 11A illustrates a side view of the access port according to an embodiment of the present invention.

[0052] FIG. 11B illustrates a top view of the access port according to an embodiment of the present invention.

[0053] FIG. 11C illustrates a side, cross sectional view of the access port according to an embodiment of the present invention.

[0054] FIGS. 12A and 12D each illustrate a top view of the access port according to an embodiment of the present invention.

[0055] FIG. 12B illustrates a side view of the access port according to an embodiment of the present invention.

[0056] FIG. 12C illustrates a top, close-up, exposed view of the access port according to an embodiment of the present invention.

[0057] FIG. 12E illustrates a side, cross sectional view of the access port according to an embodiment of the present invention.

[0058] FIGS. 13A and 13D each illustrate a top view of the access port according to an embodiment of the present invention.

[0059] FIG. 13B illustrates a side view of the access port according to an embodiment of the present invention.

[0060] FIG. 13C illustrates a top, close-up, exposed view of the access port according to an embodiment of the present invention.

[0061] FIG. 13E illustrates a side, cross sectional view of the access port according to an embodiment of the present invention.

[0062] FIG. 14 illustrates a side, cross sectional view of the access port according to an embodiment of the present invention.

[0063] FIGS. 15A and 15B each illustrate a perspective view of the actuator head and access port according to an embodiment of the present invention.

[0064] FIG. 16A illustrates a side view of the tool according to an embodiment of the present invention.

[0065] FIG. 16B illustrates a bottom view of the tool according to an embodiment of the present invention.

[0066] FIG. 16C illustrates a side, cross sectional view of the actuator head according to an embodiment of the present invention.

[0067] FIG. 16D illustrates a close-up bottom view of a portion of the actuator head according to an embodiment of the present invention.

[0068] FIG. 17A illustrates a side view of the tool according to an embodiment of the present invention.

[0069] FIG. 17B illustrates a bottom view of the tool according to an embodiment of the present invention.

[0070] FIG. 17C illustrates a side, cross sectional view of the actuator head according to an embodiment of the present invention.

[0071] FIG. 17D illustrates a close-up bottom view of a portion of the actuator head according to an embodiment of the present invention.

[0072] FIGS. 18A and 18C each illustrate a side view of the system according to an embodiment of the present invention.

[0073] FIGS. 18B and 18D each illustrate a bottom view of the system according to an embodiment of the present invention.

[0074] FIG. 19A illustrates a side view of the tool according to an embodiment of the present invention.

[0075] FIG. 19B illustrates a bottom view of the tool according to an embodiment of the present invention.

[0076] FIG. 19C illustrates a side, cross sectional view of the actuator head according to an embodiment of the present invention.

[0077] FIG. 19D illustrates a close-up bottom view of a portion of the actuator head according to an embodiment of the present invention.

[0078] FIG. 20A illustrates a side view of the tool according to an embodiment of the present invention.

[0079] FIG. 20B illustrates a bottom view of the tool according to an embodiment of the present invention.

[0080] FIG. 20C illustrates a side, cross sectional view of the actuator head according to an embodiment of the present invention.

[0081] FIG. 20D illustrates a close-up bottom view of a portion of the actuator head according to an embodiment of the present invention.

[0082] FIGS. 21A and 22A each illustrate a side view of the system according to an embodiment of the present invention.

[0083] FIGS. 21B and 22B each illustrate a bottom view of the system according to an embodiment of the present invention.

[0084] FIGS. 23 and 24 each illustrate a perspective view of the system according to an embodiment of the present invention.

#### **DETAILED DESCRIPTION**

[0085] The present invention relates to implantable medical devices and surgical instruments and fasteners, and more specifically to access ports and tools for applying same to bodily tissue.

[0086] As shown in FIG. 1, a simplified perspective view of an access port 10 of a system of the invention is shown. The access port 10 is shown as it is being penetrated by a needle 2 of a manually operable syringe 3. By passing fluid into the access port 10, or removing fluid by means of the access port 10, the needle 2 and syringe 3 provide a convenient means for inflating and/or deflating a conventional gastric band 4, thereby enabling adjustment of a size of a stoma or a level of restriction on a patient's stomach 5. The tube 6 passes the fluid from the access port 10 to and from the gastric band 4. The access port 10 is generally fixed within the interior of a patient's body, preferably latched to a patient's abdominal muscle.

[0087] The gastric band 4 is shown in a deflated state in FIG. 2A and an inflated state in FIG. 2B, and is not considered, in itself, to make up an embodiment of the present invention.

[0088] Turning now to FIG. 3A, a system 12 is provided for attaching the access port 10 to a portion of a patient's body. The system 12 generally comprises an implantable access port 10, and a tool 14 for attaching the access port 10 to the patient's body.

[0089] FIG. 3B illustrates an exploded view of the tool 14. In the shown embodiment, the tool 14 includes a handle 16 and an actuator head 18 coupled to the handle 16 through an extension tube 20. The handle 16 includes a trigger engagement portion 22 and a grip portion 24. The trigger engagement portion 22 may generally have a forked shape that retains and houses the manually operable trigger 26. The trigger 26 engages with the handle 16 through pins 28 located on the sides of the trigger 26 that pass through apertures 30 located along the sides of the trigger engagement portion 22. The trigger 26 is therefore retained, or bounded on two sides, in a slot formed by the forked ends of the trigger engagement portion 22. The grip

portion **24** has a generally cylindrical shape, and is used by a user (e.g., a physician) to grip the tool **14** during operation.

[0090] The handle **16** couples to the actuator head **18** through a generally cylindrically shaped extension tube **20**. The extension tube **20** has a hollow interior cavity that allows a cable assembly **40** to pass from the handle **16** to the actuator cap **42**. A proximal portion **32** of the extension tube **20** may have a pivot device **31**, or a slotted portion of the extension tube **20** that engages with the handle **16**. The pivot device **31** may allow the extension tube **20** to pivot, swivel, or rotate with respect to the handle **16**, and allow the actuator head **18** to pivot with respect to the handle **16**, as shown in FIG. 4B. In addition, the pivot device **31** may not be used, but may rather be replaced with a threaded device, to securely engage the extension tube **20** with the handle **16**, if the actuator head **18** is not configured to pivot. In one embodiment, both a threaded device and a pivot device, such as a swivel, may be used to couple the extension tube **20** to the handle **16**. In this embodiment, the threaded device firmly fixes the extension tube **20** to the handle **16**, yet the pivot device still allows the extension tube **20** to rotate with respect to the handle **16**. Furthermore, in one embodiment, the pivot device **31** may be equivalently replaced with a swivel device, a sleeve device, or any equivalent mechanism that allows the extension tube **20** to rotate. In addition, the pivot device **31** may be configured to allow the extension tube **20** to pivot laterally in multiple dimensions around the handle **16**, including a direction towards the handle **16**, away from the handle **16**, directions perpendicular to the handle **16**, or combinations of these directions.

[0091] A distal end **34** of the extension tube **20** couples to the actuator head **18**. In the embodiment shown in FIG. 3B, the extension tube **20** may couple to the extension tube **20** through a radius tube **36**. The radius tube **36** has a generally cylindrical

shape and a hollow interior cavity. The radius tube **36** is shaped to contour to a corresponding curved shape of the actuator head **18**. A threaded portion **38** of the radius tube **36** at one end of the radius tube **36** may be threaded into an internally threaded portion of the extension tube **20**. In addition, the radius tube **36** may also have a pivot device, similar to the pivot device **31** of the extension tube **20**. In this embodiment, the pivot device of the radius tube **36** allows the radius head **36** to rotate with respect to the handle **16**, or the extension tube **20**. In this manner, the actuator head **18** may rotate with respect to the handle **16** in this embodiment. Similar to the pivot device **31** of the extension tube **20**, the pivot device on the radius tube **36** may allow the actuator head **18** to rotate in multiple dimensions relative to the handle **16**. The radius tube **36** may be housed within the interior of the actuator head **18**, or may be positioned outside and below the actuator head **18**. The orientation of the radius tube **36** may be more clearly viewed in FIGS. 16B, 17B, 19B, and 20B. The radius tube **36** serves to thread a portion of the cable assembly **40** from the handle **16** to the actuator cap **42**.

[0092] The cable assembly **40** connects from the handle **16** to the actuator cap **42**. The cable assembly **40** has a proximal portion **44** and a distal portion **46**, with stiff, yet flexible, cable **50** extending between the portions **44**, **46**. The proximal portion **44** includes a ball **47**, or a ball head, positioned at the end of the cable **50**. The ball **47** engages the trigger **26**. The proximal portion **44** may additionally include a sheath **48** that strengthens the proximal portion **44**, and is positioned near the ball **47**. The sheath **48** generally provides a resistance to damage to the cable **50** during operation of the tool **14**. The sheath may be made of stainless steel, or the like. The sheath **48** may additionally constitute an attachment point from the cable **50** to the ball **47**.

[0093] The cable 50 extends from the proximal portion 44 to the distal portion 46 of the cable assembly 40, and includes an attachment device 52 positioned at the distal portion 46. The attachment device 52 is configured to engage the actuator cap 42, and may include a ball device, a plug device, or the like. The cable 50 is preferably made from a stiff, yet flexible material, such as a threaded metal, nitinol, or the like. The cable 50 is made from a stiff material to allow the cable 50 to transmit both a pulling force and a pushing force to the actuator cap 42 when the tool 14 is operated.

[0094] During assembly of the tool 14, the radius tube 36 is installed into the actuator head 18 in the orientation shown in FIG. 3B. The threaded portion 38 of the radius tube 36 connects to an internally threaded portion of the extension tube 20. The connection between the radius tube 36 and the extension tube 20 locks the actuator head 18 in position, and also provides a tubular path for the cable assembly 40 to travel from the trigger 26 to the actuator cap 42. Because the extension tube 20 engages the radius tube 36, and not the actuator head 18 directly, the actuator head 18 is free to pivot with respect to the extension tube 20, if the radius tube 36 is pivotally connected to the extension tube 20.

[0095] The extension tube 20 is either threaded into the handle 16, to firmly secure the extension tube 20 in position with respect to the handle 16, or the pivot device 31 is engaged with a mating slot in the handle 26. The mating slot conforms to the shape of the pivot device 31, and will allow the extension tube 20 and actuator head 18 to rotate with respect to the handle 16. The actuator head 18 may rotate with respect to the handle 16 because the extension tube 20 is firmly fixed to the radius tube 36.

[0096] The actuator cable assembly 40 is then fed through the top of the handle 16 and into a Teflon tube that has a clearance

fit inside the extension tube **20** and continues into the radius tube **36**. The Teflon tube reduces friction and improves the tactile feedback to the trigger **26**. The cable assembly **40** passes through the radius tube **36** and the distal end **46** of the cable assembly **40** is coupled to the actuator cap **42**. More specifically, the attachment device **52** of the cable assembly **40** is fixed to the actuator cap **42** along a slotted groove **54** positioned along the top perimeter of the actuator cap **42**. The slotted groove **54** may extend around a portion, or around the entire top surface of the actuator cap **42**. The slotted groove **54** allows a slack portion of the cable **50** to wrap around the actuator cap **42** and further increases the total contact surface area between the cable **50** and the actuator cap **42**. The increased contact surface area increases the torque strength transmitted from the cable **50** to the actuator cap **42**.

[0097] The trigger **26** is inserted into the trigger engagement portion **22** in the direction shown by arrow **56**. The pins **28** on the trigger **26** engage with the apertures **30**, to allow the trigger **26** to rotate with respect to an axis of rotation **60**.

[0098] When the trigger **26** is inserted into the trigger engagement portion **22**, the ball **47** positioned at the proximal end **44** of the cable assembly **40** attaches to the trigger **26**. A ball receiving structure **58** of the trigger **26** engages the ball **47** of the cable assembly **40**. The ball receiving structure **58** may comprise a cavity to receive the ball **47**, or any equivalent structure that retains the ball **47**.

[0099] The connection between the distal end **46** of the cable **50** and the actuator cap **42** is made by fixing the attachment device **52** to the actuator cap **42**, and then wrapping slack in the cable **50** around the outer top surface of the actuator cap **42**. The outer top surface of the actuator cap **42** includes the slotted groove **54** along the top of the actuator cap **42**. When the cable **50** is wrapped around the outer slotted groove **54** of the actuator



cap **42**, a smaller boss diameter **62** of the actuator cap **42** is mated with a mating diameter **64** of the actuator head **18**. Thus, the actuator cap **42** may rotate with respect to the actuator head **18**, through the pivotal connection between the smaller boss diameter **62** and the mating diameter **64**. A compression force applied to the actuator cap **42** and the actuator head **18** seats a snap interface and completes assembly of the tool **14**.

[0100] FIG. 3C illustrates a side view of the system **12**, including the assembled tool **14** engaged with an access port **10**.

[0101] FIG. 3D illustrates an aspect of the tool's **14** operation, related to the use of the trigger **26**. To operate the tool **14**, a user grips the grip portion **24** and squeezes the trigger **26** in a direction towards the top of the handle **16**. As shown in FIG. 3D, the pin **28** may include a notch **66**, or pointer, that points to a status indicator **68**. The notch **66** points to an indicator **68** that indicates whether the access port **10** is in an undeployed, or unlocked position, or is in a deployed, or locked position. Accordingly, if the trigger **26** has not yet been pressed, the notch **66** points to the unlocked status indicator **68**.

[0102] FIG. 3E illustrates the tool **14** in a deployed state after the trigger **26** has been pressed in the direction indicated by the arrow **70**. Because the pin **28** is pivotally coupled to the apertures **30** (shown in FIG. 3B), the trigger **26** rotates when it is squeezed. In this configuration, the notch **66** points to an indicator **68** indicating the access port **10** is locked, or deployed.

[0103] In operation, when the trigger **26** is pressed in the direction indicated by the arrow **70**, the ball receiving structure **58** pulls on the ball **47** of the cable assembly **40**. The cable **50** is then pulled in a direction towards the handle **16**, which rotates the actuator cap **42**. The distal portion **46** of the cable assembly **40**, wrapped around the slotted groove **54**, assures

the translational movement of the cable **50** up or down along inside the interior of the extension tube **20** is converted to a rotational movement of the actuator cap **42**. To return the tool **14** to the system shown in FIG. 3D, the user presses the trigger **26** in a direction opposite to arrow **70**. Because the cable **50** is made of a stiff, or rigid material, the cable **50** will rotate the actuator cap **42** back to its initial position. The push/pull connection between the trigger **26** and actuator cap **42** offers an improved tactile sense for the user. In addition, the present design further does not require costly material for manufacture, for example, PEEK.

**[0104]** FIGS. 4A and 4B illustrate the actuator head **18** being pivotal with respect to the handle **16**. As described above in relation to FIG. 3B, either the actuator head **18**, or the extension tube **20**, or both, may be pivotally coupled to the handle **16**. In one embodiment, as discussed above, the extension tube **20** includes a pivot device **31** (shown in FIG. 3B) that couples to the handle **16**, to allow the extension tube **20** to rotate with respect to the handle **16**. In one embodiment, the radius tube **36** may include a similar pivot device attaching the radius tube **36** to the extension tube **20**. Rotation of the extension tube **20** or rotation of the radius tube **36** will allow the actuator head **18** to rotate. In addition, in one embodiment discussed in relation to FIG. 3B, either the radius tube **36** or the extension tube **20** may be rotated, or pivoted in multiple dimensions with respect to the handle **16**.

**[0105]** The extension tube **20** may define a lateral axis **72** that the actuator head **18** may rotate around. Depending on the configuration of the tool **14**, the actuator head **18** may be configured to rotate 90 degrees about the axis **72**, 180 degrees about the axis **72**, or 360 degrees about the axis **72**. In addition, a friction mechanism or locking mechanism may be used to hold the rotated actuator head **18** in position after it has

been rotated. In one embodiment, the friction between the pivot device **31** and the mating slot may be sufficient to hold the actuator head **18** in position after it has been rotated.

[0106] The ball **47** located at the proximal end **44** of the cable assembly **40** allows the cable assembly **40** to rotate with the actuator head **18**. A shape of a cavity of the ball receiving structure **58** corresponds to the shape of the ball **47** and allows the ball **47** to rotate within the cavity. The ball **47** of the cable assembly **40** therefore aids, or enables the actuator head **18** to pivot with respect to the handle **16**.

[0107] The actuator head **18** pivots to allow a user to have a rotational degree of freedom when inserting the access port **10** into a patient's body. The rotating actuator head **18** allows the user to insert the access port **10** in multiple positions, yet retain the same grip on the handle **16**. This feature may be beneficial if the access port **10** will be attached to a portion of the patient's body that is difficult to access. In general, the rotational feature facilitates greater manipulation and positioning of the access port **10** during implantation.

[0108] FIGS. 5A-5E illustrate an embodiment of the present invention including design variations from the embodiments shown in FIGS. 3A-3E. In particular, FIG. 5A illustrates an exploded view of the present invention including a two part **78, 80** handle **16** structure that is combined together through columns, screws, fasteners, or the like. The two part handle **16** encloses a two part **82, 84** trigger **26** that is similarly combined with columns, screws, fasteners, or the like. The two part trigger **26** encloses a plug **74**, a ball device, or cylindrical shaped device positioned at the proximal end **44** of the cable **50**. The plug **74** is housed within the plug receiving structure **86**. Similar to the operation of the ball **47** and the ball receiving structure **58** shown in FIG. 3B, the plug **74** and the plug receiving structure **86** are shaped to allow, or enable the actuator head **18** to

rotate. The ball **47** (shown in FIG. 3B) and the plug **74** represent generally equivalent attachment mechanisms for the cable assembly **40**. In addition, the mating slot **76** (here more clearly visible than in FIG. 3B) encloses the pivot device **31** of the extension tube **20**. Furthermore, in this embodiment, an aperture **88** is positioned to allow the status indicator **68** to be visible when the tool **14** is either in the deployed or undeployed state.

**[0109]** FIG. 5B illustrates a side view of the tool **14**, shown in FIG. 5A, in the undeployed position. The status indicator **68** accordingly displays an undeployed, or unlocked indicator, as shown in FIG. 5C. FIG. 5D illustrates a side view of the tool **14** in the deployed position. The status indicator **68** accordingly displays a deployed, or locked indicator, as shown in FIG. 5E.

**[0110]** FIG. 6A illustrates an access port **10** shown in an exploded view. The access port **10** in this embodiment generally comprises a housing **90**, having a generally cylindrical shape. The housing **90** has a top portion **91** and a bottom portion **93**. The bottom portion **93** includes a base **92** fixed to the housing **90**, and comprising a bottom surface of the housing **90**. The base **92** provides a generally flat surface at the bottom of the housing **90**. The base **92** may be made from injection molded plastic, or the equivalent. The base **92** may further include an overmolded metal needle guard to prevent a syringe needle from penetrating and passing through the bottom portion **93** of the housing **90**.

**[0111]** The housing **90** includes an access port connector **95** at one side of the housing **90**. The access port connector **95** is configured to engage a tube **6** connecting from the access port **10** to the gastric band **4** (as shown in FIG. 1). A tube connector **94** may be connected to an end of the tube **6**, and fixed to the access port connector **95**, to secure engagement of the tube **6**

with the access port housing **90**. The inner diameter of tube connector **94** compresses tube **6** onto the port connector **95** to ensure sealing. The tube connector **94** may include a locking indicator, shown in FIG. 6B, indicating when the tube **6** has been properly engaged and locked with the housing **90**. The actuator **108** may have a similar indicator displaying a locked position. The tube connector **94** may additionally have a locking engagement mechanism, for example a friction element or a mechanical element to lock the tube **6** to the housing **90**. The tube connector **94** may comprise injection molded plastic or molded silicone, or both, or the like. A strain relief element **98** may additionally be placed over a portion of the tube **6**. One embodiment of the tube connector **94**, shown in FIG. 6C, includes a split-cylinder shape, and does not include the locking indicator shown in FIG. 6B.

[0112] The access port housing **90** generally may define two interior cavities. One interior cavity includes the fluid chamber **106** (shown more clearly in FIG. 14). Another interior cavity includes the central cavity **104** (shown more clearly in FIG. 14). The fluid chamber **106** stores fluid transferred to the gastric band **4** through the tube **6** (as shown in FIG. 1). The septum **102** is placed within the central cavity **104** and is placed over the fluid chamber **106**. The septum **102** substantially opposes the base **92**. A septum counter bore **118**, or ridge, seats the septum **102** over the fluid chamber **106**. A compression ring **107** is placed around the septum **102** to hold the septum **102** in place. An upper rim **113** of the septum **102** is positioned over an upper ridge **119** of the housing **90**. A palpation ring **110** (equivalently described as a locking ring) is further placed over the septum **102** to hold the septum **102** in place and protect the fluid chamber **106** from leakage, as further described in relation to FIG. 14. The palpation ring **110** locks around a portion of the housing, as shown in FIG. 14. An actuator **108** is additionally placed over a top portion **91** of the housing **90**. It

is noted that each device placed in within the interior cavities of the housing has a generally cylindrical shape, to conform to the shape of the cavities. Furthermore, each device placed within the interior cavities is positioned substantially concentric with one another.

[0113] The access port **10** further comprises a plurality of anchor assemblies **100** (sometimes hereinafter referred to simply as anchor **100**). Referring to FIG. 7, the anchor assembly **100** may be a composite element, for example, made of at least two different materials. The anchor assembly **100** includes a wire portion **124** and a molded portion **128**. The wire portion **124** may comprise stainless steel, or the equivalent, and the molded portion may comprise, for example, a plastic or polymer, or the equivalent. In one embodiment, the molded portion **128** is molded around the wire portion **124**. In one embodiment, the molded portion **128** is overmolded around the wire portion **124**.

[0114] In one embodiment, each anchor assembly **100** is made of a bioresorbable material. A portion of the anchor assembly **100** or the entirety of the anchor assembly may be made of one or more bioresorbable material. For example, the wire portion **124**, or the molded portion **128**, or both, may be made of a bioresorbable material. The bioresorbable material serves to increase the biological compatibility between the anchor **100** and the body tissue.

[0115] The wire portion **124** may include a distal portion **120** and a proximal portion **122**. The distal portion **120** may include a distal tip **126** structured to penetrate and engage tissue. The distal tip **126** represents the end point of the wire portion **124**. The wire portion **124** may have a generally curved shape, to allow the anchor **100** to hook into, and engage the tissue located below the access port **10**. In addition, the wire portion **124** may have a generally circular cross section, to reduce friction with the tissue, and to reduce the total cross sectional surface area

contacting the tissue. The circular cross section may extend over the length of the wire portion **124**, until the wire portion **124** terminates in the distal tip **126**. The circular cross section is formed because the wire portion **124** may be considered simply as a curved needle. In addition, the circular, constant cross section may be additionally beneficial if the wire is formed from, for example, stainless steel. The stainless steel wire may be work hardened, giving it a higher strength than wrought material. The circular cross section may therefore comprise an improvement over, for example, an anchor having a tapered shape.

[0116] The proximal portion **122** includes the molded portion **128** molded, or overmolded to the proximal portion **122** of the wire portion **124**. The molded portion **128** may include a pivot axle **130** with an axis that extends in a direction substantially perpendicular to a plane of rotation of the wire portion **124**. Further, the molded portion **128** may comprise an actuator pin **132** also extending in a direction substantially perpendicular to a plane of rotation of the wire portion **124**. The actuator pin **132** is spaced apart from the pivot axle **130**, preferably at a far, or the furthest distance available on the molded portion **128** from the pivot axle **130**. Thus, the actuator pin **132** may be spaced at one end of the molded portion **128** from the pivot axle **130**. In addition, the molded portion **128** may comprise a deploy pin **134** extending in a direction substantially perpendicular to a plane of rotation of the wire portion **124**.

[0117] The deploy pin **134** is spaced apart from the actuator pin **132** and the pivot axle **130**. The actuator pin **132** and deploy pin **134** may be formed during the molding process of the molded portion **128**, such that they represent a singular, continuous unit with the molded portion **128**. In the embodiment shown in FIG. 7, the actuator pin **132**, the deploy pin **134**, and the pivot axle **130**, all have a generally cylindrical shape extending

outwards from the surface of the molded portion **128**. In addition, the actuator pin **132**, the deploy pin **134**, and the pivot axle **130**, all have curved surfaces that allow the actuator **108** to pivotally engage the actuator pin **132** and the deploy pin **134**. In one embodiment, the actuator pin **132** and deploy pin **134** may have various equivalent shapes, may extend in various equivalent directions, and may not necessarily comprise a continuous unit with the molded portion **128**.

[0118] Referring back to FIG. 6A, the assembly of the access port **10** begins with the insertion of the anchor assemblies **100** into the housing **90**. The anchor assemblies **100** are coupled to the housing **90** by their pivot axles **130**, which snap into place. An axle mating feature **116** positioned along a side of the housing **90** retains one end of the pivot axle **130**. A portion of the housing **90** retains the other end of the pivot axle **130**. The compression ring **107** is pressed into place within the central cavity **104** to reinforce the plastic housing **90** for the interference fit with the pulspation ring **110** (more clearly shown in FIG. 14). The septum **102** is lowered into place within the compression ring **107** to form a covering over the fluid chamber **106**. The actuator **108** is then positioned concentric with the housing **90**, is engaged with the housing **90**, and is lowered to engage the anchor assemblies **100**. Engagement with the anchor assemblies **100** may be made at at least one of four locations. Preferably, the actuator **108** is engaged with the anchor assemblies **100** when they are in a half-deployed position, to allow for easy engagement between the actuator **108**, the actuator pin **132** and the deploy pin **134**. The pulspation ring **110** is then positioned concentric with the housing **90**. A compression force is applied to the pulspation ring **110** until the inner diameter of the pulspation ring snaps over an outer diameter of a portion of the housing **90**, as more clearly shown in FIG. 14.



[0119] FIG. 8A illustrates a perspective view of the assembled access port **10**. FIGS. 8B and 8C illustrate respective top and side views of the access port **10**. FIGS. 8A-8C illustrate additional features of the access port **10**, including suture holes **112** placed along the side of housing **90** and side cuts **114** placed on the side the housing **90**. The suture holes **112** allow a physician to suture the access port **10** to a patient's body, rather than utilizing the anchors **100**. The suture holes **112** may also be used in addition to the anchors **100**. The suture holes **112** may comprise three holes spaced, for example, 90 degrees apart. Furthermore, the side cuts **114** are used for engagement with the tool **14**, as further discussed in relation to FIGS. 15A-22B. FIG. 8A additionally displays actuator side cuts **105** placed along a periphery of the actuator **108**. The actuator side cuts **105** are used as an engagement mechanism with the tool **14**, and specifically the actuator cap **42**, as further discussed in relation to FIGS. 15A-22B.

[0120] Referring now to FIGS. 9A and 9B, one embodiment of the present invention may include an attachment material, for example, a mesh member **136** disposed along at least a portion of the base **92** for encouraging tissue ingrowth or tissue engagement after the access port **10** has been implanted in the patient. In the embodiment shown in FIGS. 9A and 9B, the mesh member **136** does not extend out beyond an outer circumference **146** or outer extent of the access port **10**. The mesh member **136** may have a generally web-shape or checkerboard shape, including a plurality of structures that cross in varied directions to form a series of intersections and spaces **139b** (shown in FIG. 9D) in between those intersections. In addition, the mesh member **136** may have a microstructure much smaller than shown in FIG. 9B, or may have a circular, triangular, or other equivalent mesh structure. In one embodiment, the mesh member **136** may comprise merely a porous material.

[0121] The mesh member **136** may encourage local tissue around the access port **10** to engage with the access port **10** after the access port **10** has been applied. The mesh member **136** aids to secure the access port **10** in place on the patient's tissue. In addition, the mesh member may aid to form a biological seal, or a dermal interface, around the interface between the tissue and the access port **10**. In addition, the mesh member **136** may prevent the local tissue from rejecting the access port **10** and may decrease the chance of medical complications related to the access port **10**.

[0122] Furthermore, a portion of the mesh member **136** may be used as an attachment point to suture, staple, or otherwise lock the access port **10** to the patient's body.

[0123] The mesh member **136** may be made of a bioresorbable material, such as silk, or the like, or may be made of a non-resorbable material such as polypropylene, or the like. In addition, the mesh member **136** may be made of a blend of both bioresorbable materials and non-resorbable materials such as a Covidien mesh, or the like.

[0124] The mesh member **136** may be used to engage bodily tissue in conjunction with either sutures extending from the suture holes **112** or with use of the anchor assemblies **100**, or both. If the anchor assemblies **100** are used to fix the access port **10** to bodily tissue, the mesh member **136** may include apertures **142** appropriately sized to allow a portion of the anchor assemblies **100** to pass through the mesh member **136**. In addition, the mesh member **136** may be sized to allow the anchor assemblies **100** to pass through the mesh member **136** without contacting or damaging the mesh member **136**. If the mesh member **136** is appropriately sized, no apertures **142** may be needed.

[0125] The mesh member **136** may be fixed to the base **92** of the housing **90**, through a mesh ring **138**, shown more clearly in FIG. 9E. The mesh ring **138** may have a generally disk-like or plate-

like shape that may have a central aperture **149**. The mesh ring **138** may have a top surface **145** and a bottom surface **147** (shown in FIG. 9B), wherein the top surface **145** is connected to the base **92** of the housing **90**, at a bottom surface **151** of the base **92**. The bottom surface **147** of the mesh ring **138** may be connected to a top surface **153** (referred to in FIG. 9F) of the mesh member **136**. The mesh ring **138** may be configured to not extend beyond an outer circumference **146** or outer extent of the access port **10**.

[0126] The mesh ring **138** may additionally include a plurality of apertures **144** that allow the anchor assemblies **100** to pass through the mesh ring **138** and engage tissue. These apertures **144** may be excluded if the anchor assemblies **100** are not used to fix the access port **10** to the patient. In addition, the mesh ring **138** may include a plurality of columns **140** that engage the base **92** of the housing **90**. If the suture holes **112** are not used to engage the access port **10** with bodily tissue, the plurality of columns **140** may engage with the suture holes **112**. The plurality of columns **140** may equivalently engage to other portions of the access port housing **90**. Other equivalent attachment means may also be used.

[0127] The mesh member **136** may be attached to the mesh ring **138** mechanically or by physically wrapping or tying the mesh member **136** to the mesh ring **138**. In addition, a latching mechanism may be used to attach the mesh member **136** to the mesh ring **138**.

[0128] The mesh ring **138** allows the physician, at the time the access port **10** is inserted, to determine whether or not to include the mesh member **136**. The detachable mesh ring **138**, removably fixed to the base **92**, allows a physician to choose whether or not to detach the mesh ring **138**. In addition, the mesh ring **138** may provide clearance for bodily tissue to better engage the mesh member **136**, by providing more distance between body tissue and the base **92**. In one embodiment, the mesh ring

**138** may be permanently fixed to the base **92** (e.g., an embodiment where the mesh ring **138** is not detachable from the base **92**).

[0129] FIGS. 9C and 9D illustrate an embodiment of the present invention utilizing the mesh member **136** and mesh ring **138**, where the mesh member **136** is welded to the mesh ring **138**. The welding process may include an ultrasonic welding process, and may be used as an alternative or in combination with the attachment methods disclosed in relation to FIGS. 9A and 9B. In addition, the mesh ring **138** may be adhered to the bottom surface **151** of the base **92**, for example, by gluing the mesh ring **138** to the base **92**, or through other equivalent means. In addition, in this embodiment, the mesh member **136** extends beyond the outer circumference **146** or outer extent of the access port housing **90**. The portion **143** of the mesh member **143** extending beyond the base **92** may extend outwardly from and substantially circumscribe the base **92**, or may extend only partially around the base **92**. In addition to an ultrasonic welding process, the mesh member **136** may be attached to the ring **138** through other equivalent attachment means. The mesh member **136** extends beyond the outer circumference **146** or outer extent of the access port housing **90** to allow a physician to cut the mesh member **136** to an appropriate size before implantation into a patient. In addition, the mesh member **136** may extend beyond the outer circumference **146** of the access port **10** to allow a physician to more easily suture or attach the mesh to a patient.

[0130] FIGS. 9F and 9G illustrate one embodiment of the present invention wherein the mesh member **136** is attached directly to the base **92** without the use of the mesh ring **138**. In this embodiment, the mesh member **136** may be ultrasonically welded to the base **92** of the access port **10**, or may be attached through other equivalent means. Other equivalent means may include crimping or folding a portion of the mesh member **136** to a portion of the base **92**. In this embodiment, a top surface **153**

of the mesh member **136** is fixed directly to a bottom surface **151** of the base **92**. A bottom surface **155** of the mesh member **136** contacts the body tissue.

[0131] FIGS. 9H and 9I illustrate an embodiment of the present invention wherein a portion of the mesh member **136** may wrap or fold around the outer circumference of the mesh ring **138**. In this embodiment, a portion of the mesh member **136** is sandwiched between the bottom surface **151** of the base **92** and the top surface **153** of the mesh ring **138** (shown in FIG. 9F). This is a press fit, where the mesh member **136** is not welded or bonded to the base **92**. The portion of the mesh member **136** that wraps around the outer circumference of the mesh ring **138** is then locked between the base **92** and the mesh ring **138**, holding it in place. The portion of the mesh member **136** that wraps around the mesh ring **138** may be firmly or loosely sandwiched between top surface **153** of the mesh ring **138** and the bottom surface **151** of the base **92**.

[0132] FIGS. 9J and 9K illustrate the mesh member **136** may be entirely sandwiched between the top surface **153** of the mesh ring **138** and the bottom surface **151** of the base **92**. In other words, the mesh member **136** may be held in place by the mesh ring **138** positioned on the bottom surface **147** of the mesh member **136**. A portion of the mesh ring **138** would fix to the bottom surface **151** of the base **92** by having an attachment mechanism pass through the mesh member **136**.

[0133] In one embodiment, the mesh member **136** may be integrally molded into or as part of the base **92** of the access port **10**. In this embodiment, the mesh member **136** and the base **92**, particularly the bottom surface **151** of the base **92**, may be molded as one piece. In addition, the mesh member **136** may be overmolded on to the base **92**, or a portion of the base **92**. The mesh member **136** and base **92** may be made of different materials or the same materials, particularly the materials discussed

above in relation to FIGS. 9A and 9B. If the mesh member **136** is overmolded to the base **92**, it may be easier to form the base **92** and mesh member **136** from different materials.

[0134] In one embodiment, the bottom surface **151** of the base **92** may be coated with a bioresorbable material, to encourage biological compatibility between the base **92** and the body tissue. FIG. 9L illustrates a coating **135** may cover the entirety of the bottom surface **151** of the base **92**, or only a portion of the bottom surface **151** of the base **92**. A thickness **137** of the coating **135** may be even, or may vary along the bottom surface **151** of the base **92**. The coating **135** may be deposited through a process including a spraying process, dipping process, molding process, wiping process, or other equivalent means of attaching the bioresorbable material to the base **92**. The coating thickness **137** may vary between approximately 0.001 inches and 0.25 inches. The bioresorbable material serves to form a biological seal between the access port **10** and the body tissue, and to encourage compatibility between the access port **10** and the body tissue.

[0135] Similarly, in one embodiment, the base **92** itself (particularly the bottom surface **151** of the base **92**), may be made entirely or partially from a bioresorbable material. Thus, a portion of the bottom surface **151** of the base **92** or the entirety of the bottom surface **151** of the base **92** may be made of a bioresorbable material. The bioresorbable base **92** may be formed through a process including a molding process, a forming process, a stamping process, or other equivalent means of forming a base **92** partially or entirely formed of bioresorbable material to the base **92**. The bioresorbable base **92**, as discussed above in relation to the coating of bioresorbable material, serves to form a biological seal between the access port **10** and the body tissue, and to encourage compatibility between the access port **10** and the body tissue.

[0136] FIGS. 10A-13E illustrate the deployment of the anchor assemblies **100** according to one embodiment of the present invention. FIG. 10A illustrates a top view of the access port **10** with the actuator **108** positioned at an angle with respect to the access port housing **90** and at an angle with, for example, the tube connector **94**. The initial, undeployed, angle may be offset 64 degrees from the deployed angle. In addition, the initial configuration represents the position of the tool **14** and the access port **10** in the retracted, undeployed, or unlocked state.

[0137] FIG. 10B illustrates a side view of an anchor assembly **100** housed within the access port housing **90**. The anchor assembly **100** is shown in the retracted position: a position where the distal tip **126** of the anchor assembly **100** has not yet exited the base **92** of the access port **10** through an aperture **152**.

[0138] FIGS. 10C-10E illustrate two components of the actuator **108** that engage portions of the anchor assembly **100** shown in FIG. 10C. A cam surface **148** is positioned near the deploy pin **134**, and an actuator surface **150** is positioned near the actuator pin **132**. The cam surface **148** comprises a generally vertical surface of the actuator **108** having a curved portion located towards the top of the cam surface **148**. The actuator surface **150** similarly comprises a vertical surface of the actuator **108**, but having a curved portion located towards the bottom of the actuator surface **150**. The cam surface **148** and actuator surface **150** may rotate along with the actuator **108**. A portion of the cam surface **148** passes between the deploy pin **134** and the actuator pin **132**. In addition, the actuator pin **132** rests against a locking surface **154**. The locking surface **154** prevents the actuator **108** from rotating in a clockwise direction (with respect to the view shown in FIG. 10A) once the actuator pin **132** contacts the locking surface **154**. FIG. 10E further illustrates

that the position and structure of the cam surface **148** prevents the actuator **108** from rotating clockwise beyond the actuator pin **132**, because a portion of the cam surface **148** contacts the actuator pin **132**. The cam surface **148** and actuator surface **150** may either be integral with, or separate from the actuator **108**.

[0139] During operation, the actuator **108** starts to rotate in a counter-clockwise manner (with respect to the view shown in FIG. 10A), and described in relation to FIGS. 15A-22B. It is noted that the actuator side cuts **105** shown in FIG. 10A will rotate with respect to the position of the tube connector **105**. FIGS. 10A, 12A, and 13A approximately represent the rotation of the actuator side cuts **105** and the actuator **108**. However, the positions of the actuator side cuts **105** shown in FIGS. 11B and 12D are not necessarily representative of the rotation of the actuator **108**, although the cross section views in FIGS. 11C and 12E accurately represent the positions of the anchor assemblies **100** during deployment according to one embodiment of the present invention.

[0140] In FIGS. 11A-11C, during initial deployment, the cam surface **148** engages the deploy pin **134** and lifts the actuator pin **132** off the locking surface **154**. The deploy pin **134** is positioned such that the motion of the cam surface **148** forces the deploy pin **134** in a direction tangential to a radius of rotation of the pivot axle **130**. The tangential force rotates the anchor assembly **100** with respect to the position of the pivot axle **130** and lifts the actuator pin **132**. As displayed in the configuration shown in FIG. 10E, if the actuator pin **132** was not initially lifted, and a force was applied to the actuator pin **132** by, for example, a cam surface, then the actuator surface **150** would not properly engage the actuator pin **132**. Thus, the deploy pin **134** serves to initiate the movement of the actuator pin **132**. The actuator pin **132** is preferably positioned at a maximum distance from the pivot axle **130** allowable, given



the dimensions of the molded portion **128**. The actuator pin **132** is positioned at a distant end of the molded portion **128** from the pivot axle **130** to maximize the driving torque to the anchor assembly **100**. The position of the actuator pin **132** assures maximum torque is delivered throughout the majority of the deployment.

[0141] As shown in FIG. 11C, once the actuator pin **132** is lifted from the locking surface **154**, the actuator surface **150** engages the actuator pin **132**. At this point, the force transmitted by the actuator surface **150** is directed in a direction substantially tangential to a radius of rotation of the pivot axle **130**, and is not substantially directed towards the pivot axle **130**. Thus, the tangential force continues to rotate the anchor assembly **100** in the anchor assembly's **100** plane of rotation. FIGS. 11A-11C also illustrate the distal tip **126** has penetrated through the aperture **152**. The apertures **152** are generally located in the base **92** of the access port **10**.

[0142] FIGS. 12A-12E illustrate the anchor assembly **100** at a half deployment position, when the torque applied from the actuator surface **150** to a actuator pin **132** is at a maximum or near maximum. Thus, the actuator surface **150** is forcing the actuator pin **132** in a direction substantially parallel to a radius of rotation of the pivot axle **130**. In other words, if a distance **162** is measured between the pivot axle **130** and the point of contact **164** between the actuator surface **150** and the actuator pin **132**; and an angle **160** is formed between the distance **162** and the direction of the actuator surface's force **158**, then the angle **160** at this point has a value near 90 degrees, or at a right angle with respect to the pivot axle **130**. Thus, the torque is at a maximum, or near maximum at this point. A similar torque analysis could be performed for the configurations shown in FIGS. 10E, 11C, and 13E.

[0143] It is beneficial if the torque is at a maximum, or at a near maximum at the position shown in FIG. 12E, because the distal tip **126** and wire portion **124** will need to penetrate more tissue as the anchor assembly **100** continues to move from the retracted position to the deployed position. Thus, as the total friction and work increases, the actuator surface **150** will need to transfer energy more effectively to the anchor assembly **100**.

[0144] FIGS. 13A-13E illustrate the anchor assembly **100** fully rotated to a deployed position. The tip **126** has now extended into another aperture **152** located on the base **92** of the access port **10**. In addition, as shown in FIG. 13E, the torque applied by the actuator surface **150** to the actuator pin **132** still remains high due to the geometry of the actuator surface **150** and the actuator pin **132**. The actuator surface **150** and the actuator pin **132** both have rounded contact surfaces, which allow the actuator surface **150** to now drive the actuator pin **132** in a downward direction, still substantially tangential to a radius of rotation of the pivot axle **130**. Thus, the torque remains at a maximum, or near maximum in this final deployed position. This large torque is especially desirable in the final deployed position because the tip **126** and the wire portion **124** have now passed through a large amount of tissue, as shown throughout the deployment stages in FIGS. 10A-13E. In addition, FIG. 13E illustrates the actuator pin **132** now is locked against locking surface **166**, preventing further rotation of the anchor assembly **100**. A horizontal portion **168** of the actuator surface **150** may additionally extend over the actuator pin **132**, locking or trapping it in place against the locking surface **166**. A small protruding step **170** of the actuator surface **150** may extend over the actuator pin **132**, providing a snap lock during the last portion of the actuator **108** rotation. Trapping the actuator pin **132** between the horizontal portion **168** and the locking surface **166** of the actuator **108** and the housing **90** prevents the anchors **100** from being back-driven against the actuator **108**.

[0145] To retract the anchor assembly **100** shown in FIGS. 10A-13E, the same process described is performed in reverse. However, in the reverse process, the cam surface **148** will now drive the actuator pin **132** in the opposite direction of rotation than that shown in FIGS. 10A-13E.

[0146] In the exemplary embodiments shown in FIGS. 10A-13E, it may be appreciated that the access port **10** has only two principle moving parts: the actuator **108** and the four anchor assemblies **100**. Each of the anchor assemblies **100** functions identically as discussed above in FIGS. 10A-13E with respect to rotation of the actuator **108**. The access port **10** is designed to maximize the transfer of force from the input torque of the actuator **108** to the output torque of the anchor assemblies **100**. This is achieved, in part, by driving the anchor assemblies **100** as their farthest point (e.g., actuator pin **132**) from their axes of rotation (e.g., pivot axle **130**).

[0147] Each anchor assembly **100** may be made from stainless steel wire that is bent and sharpened. Wire is an efficient geometry to penetrate tissue, because of the minimal cross section, but it may be difficult to manufacture complex geometry with accurate bends. However, the wire used to form the anchor assemblies **100** requires only two simple bends which can be produced with accuracy due to the simplicity of manufacture.

[0148] Additional benefits of the anchor assembly **100** design include a greatly reduced force required to deploy the anchor assemblies **100**, and that the anchors **100** do not require precision grinding for ample penetration into tissue. In addition, the design does not require high performance plastics such as PEEK. Furthermore, the manufacturing process is capable of 100% yield, the design does not require tight tolerances, there is a reduced high volume unit cost, the total number of components is low, and all complex parts are injection molded.

[0149] FIG. 14 illustrates an embodiment of the present invention including a pulpation ring **110** configured to prevent the fluid chamber **106** from leaking. The septum **102**, as discussed above in relation to FIG. 6A, is positioned above the fluid chamber **106**. The septum **102** is preferably composed of silicone, or another equivalent needle penetrable material. To access the fluid chamber **106**, a physician will insert a syringe needle through a patient's skin and will penetrate the septum **102**. The needle can then fill the fluid chamber **106** with fluid or remove fluid, to operate the gastric band **4**, as shown in FIG. 1. However, if the syringe needle is inserted improperly, for example, near an interface between the septum **102** and the housing **90**, then the septum **102** may no longer be able to seal the fluid chamber **106**. Fluid may leak from the fluid chamber **106**, eventually causing the gastric band **4** to fail. To remedy this problem, an upper rim **113** portion or top portion of the septum **102** may be housed within a ring shaped gap **172** formed between a bottom surface of the pulpation ring **110** and the housing **90**. The ring shaped gap **172**, as shown in FIG. 14, has a diameter (the length parallel to the base **92** of the access port **10** extending from one side of the gap **172** to the other side of the gap **172**) greater than a diameter of the central cavity **104**. In another words, the ring shaped gap **172** extends radially away from the center of the access port **10** further than the outward radial extent of the central cavity **104**.

[0150] This upper rim **113** portion may be compressed between the pulpation ring **110** and the compression ring **107**, to provide a tight seal for the fluid chamber **106**. The septum **102** may include a top portion **175**, a bottom portion **177**, and the upper rim **113** portion positioned near the top portion **175**. The upper rim **113** portion forms a concentric lip, or extended ridge, extending out further than the outer extent of the bottom portion **177** of the septum **102**, or a local top portion **175** of the septum **102** not comprising the upper rim **113** portion. This upper

rim **113** portion substantially encircles an outer circumference of the septum **102**.

[0151] In addition, the palpation ring **110** may include an inner annular ring portion **174** that extends in a direction towards the center of the top surface **176** of the septum **102**. The palpation ring **110** engages with a portion of the housing **90** including an inner circumference **179**. The length of the annular ring portion **174** may be increased, to decrease the incident angle a syringe needle must travel at towards the septum **102**, to contact the ring shaped gap **172**. If the length of the annular ring portion **174** increases sufficiently, a syringe needle may need to pass nearly horizontally towards the ring shaped gap **172** to breach the compressed septum **102** and cause the fluid chamber **106** to leak. Furthermore, a height **178** of the ring shaped gap **172** may be sufficiently small such that a syringe needle can not penetrate the ring shaped cavity. For example, the height **178** may be smaller than 0.010 inches, leaving a small gap with a size narrower than the diameter of a conventional syringe needle. Thus, a conventional syringe needle could not penetrate the ring shaped gap **172**. The ring shaped gap **172** helps to maintain the sealing integrity of the access port **10**. The annular ring portion **174**, and the ring shaped gap **172**, may all have an annular, concentric shape conforming to the shape of the central cavity **104**.

[0152] FIGS. 15A and 15B illustrate the tool **14** being used to deploy the access port **10**. The tool **14** is designed to minimize the linkage between the trigger **26** (shown in FIG. 3B) and the actuator cap **42** (shown in FIG. 3B), with the actuator cap **42** applying a torque to the actuator **108** (shown in 8A-8C) to deploy and retract the anchor assemblies **100**. The linkage is further designed to provide the user maximum tactile response while deploying and retrieving an access port **10**. The basic functionality involves loading the access port **10** into the

actuator head **18** of the tool **14**. Once the access port **10** is loaded, the user pulls the trigger **26** to deploy the anchors **100** and then reverses the trigger **26** to retract the anchors **100**. The deploying and reversing process has been discussed above in relation to FIGS. 10A-13E.

[0153] The actuator head **18** is configured to mate with the access port. The actuator head **18** generally has a cylindrical shape conforming to a cylindrical shape of the access port **10**, and receiving the access port **10**. Retaining clips (shown in FIG. 16C) located on the sides of the actuator head **18** engage with the side cuts **114** on the access port **10**. The retaining clips grip the access port **10** until the user deploys the access port **10**. FIG. 15B illustrates the access port **10** in a deployed state, where the anchor assemblies **100** extend outward from the anchor port **10** to the deployed position. The access port **10** then disengages from the retaining clips, and the physician may remove the tool **14** from the access port **10**.

[0154] FIGS. 16A-16D illustrate the tool **14** in the retracted or undeployed state. In addition, no access port **10** is shown engaged with the actuator head **18**. As shown in FIG. 16C, the actuator head **18** includes retaining clips **182** that grip the side cuts **114** on the access port **10** (shown in FIGS. 15A and 15B). The retaining clips **182** are fixed to flexible sidewalls **185** that are capable of rotating out away from the actuator head **18**. The flexible sidewalls **185** comprise a skirt portion **201** of the actuator head **18** that extends around an outer circumference of the access port **10**. The skirt portion **201** helps to hold and retain the access port **10**.

[0155] In addition, a set of actuator features **180**, shown in FIGS. 16B-D, are formed as part of the actuator cap **42**, which is rotatably coupled to the actuator head **18**. The shape and position of the actuator features **180** correspond to the actuator side cuts **105**, shown in FIGS. 8A-8C. The actuator features **180**

interface with the actuator side cuts **105** to rotate the actuator **108** and to correspondingly deploy the anchor assemblies **100**.

[0156] The actuator head **18** additionally includes cam protrusions **184**, shown in FIGS. 16C and 16D, that are positioned around the periphery of the actuator head **18** and are coupled to the retaining clips **182**. The cam protrusions **184** may be integral with the flexible sidewalls **185**. The cam protrusions **184** extend toward the center of the actuator head **18**. The cam protrusions **184** respond to the rotation of the actuator cap **54**, and are displaced when the actuator features **180** rotate when the tool **14** is deployed. The displacement of the cam protrusions **184** causes the flexible sidewalls **185** to be displaced away from the actuator head **18**. Thus, the cam protrusions **184** cause the retaining clips **182** to disengage from the side cuts **114** on the access port **10**.

[0157] In the retracted, or undeployed state shown in FIGS. 16A-16D, the four actuator features **180** align with the actuator side cuts **105** when the tool **14** is placed over the access port **10**. When the tool **14** is placed over the access port **10**, the retaining clips **182** spring open and close into the side cuts **114** of the access port **10** to retain it.

[0158] FIGS. 17A-17D illustrate the tool **14** in the deployed state. In this position, the user has pressed the trigger **26**, which has caused the actuator cap **42** to rotate. Pressing the trigger **26** pulls on the actuator cable assembly **40** (shown in FIG. 3B), which has been wrapped around a portion of the actuator cap **42**. The cam protrusions **184** have therefore now been displaced and the retaining clips **182** extend outwards to release from the side cuts **114** of an access port **10** (shown in FIGS. 15A and 15B).

[0159] The tool **14** can then be reapplied to the access port **10** in either the retracted or deployed state. In the deployed state the actuator head **18** is placed in contact with the access

port **10** and the trigger **26** is reversed to its retracted state. This operation retracts the anchor assemblies **100** and the retainer clips **182**, which capture the access port **10** for removal. The access port **10** can also be removed by the tool **14** when it is in the retracted state. By pushing the actuator head **18** onto the access port **10** the retainer clips **182** will spring out, allowing the actuator cap **54** to contact the access port actuator **108**. Because the actuator features **180** in the actuator cap **42** are not longer aligned with the actuator side cuts **105** in the actuator **108**, the retainer clips **182** cannot engage the side cut **114** of the access port **10**. However, pulling the trigger **26** to the deployed state will rotate the actuator cap **42** until it aligns with the access port actuator **108**. At the end of the trigger pull, the actuator features **180** in the actuator cap **42** will engage the actuator side cuts **105**. Reversing the trigger **26** will then retract the anchors **100** and capture the access port **10** for removal.

[0160] FIGS. 18A and 18B illustrate the access port **10** engaged with the tool **14** in the retracted position. FIGS. 18C and 18D illustrate the access port **10** engaged with the tool **14** in the deployed position. In FIG. 18D, the anchors **100** are displayed extended from the access port **10**.

[0161] FIGS. 19A-19D are substantially similar to the embodiment shown in FIGS. 16A-16D. However, in the embodiment shown in FIGS. 19A-19D, the actuator head **18** has a lower profile, allowing for easier horizontal and vertical engagement with the access port **10**. A front portion, or a half portion of the skirt portion **201** of actuator head **18** has been removed, increasing the total engagement area. Only one flexible sidewall **185** on each side of the actuator head **18** is used. The tool **14** may now be horizontally slid to capture the access port **10**. The shape of the actuator head **18** may also be considered a semi-circular shape, as a skirt portion **201** of the actuator head **18** does not



extend entirely around the actuator head **18**. The operation shown in FIGS. 20A-20D substantially mirrors the operation of the embodiment shown in FIGS. 17A-17D.

[0162] FIGS. 21A and 21B illustrate the embodiment of the tool **14** shown in FIGS. 19A-20D engaged with an access port **10**. The actuator head **18** in this embodiment similarly displays the exposed front portion, or skirt portion **201** of the access port **10**. As discussed above, the exposed or open portion of the actuator head **18** may allow for easier retrieval or placement of the access port **10**. FIGS. 22A and 22B illustrate the embodiment of the tool **14** shown in FIGS. 19A-20D in the deployed position. In FIG. 22B, the anchor assemblies visibly extend from the access port **10**.

[0163] FIGS. 23 and 24 illustrate a feature of the present invention including multiple orientations of the access port **10** with respect to the position of the tool **14** or handle **16**. As discussed above with regard to FIGS. 15A-17D, the actuator head **18** need only engage side cuts **114** of the access port **10** to retain the access port **10**. In addition, the actuator cap **42** need only mate with the actuator features **180** with the actuator side cuts **105**. Because the access port **10** and the actuator head **18** include generally symmetric features, the port side cuts **114** and actuator side cuts **105** may engaged with the tool **14** in varied positions. The skirt portion **201** (discussed above in relation to FIGS. 16A and 19A) may be shaped to allow an access port **10** to engage the actuator head **18** in multiple orientations. In the embodiment shown in FIGS. 23 and 24, the access port **10** is shown in two opposite positions with respect to the tool, yet extending parallel to an orientation of the actuator head **18**. However, it is also contemplated that the access port **10** may also be positioned in directions perpendicular to the orientation of the actuator head **18**. The variety of orientations generally improves the useful positions of the tool

**14** and access port **10**, similar to benefits of the pivotal actuator head **18**, discussed above in relation to FIGS. 4A and 4B.

**[0164]** The terms "a," "an," "the" and similar referents used in the context of describing the invention (especially in the context of the following claims) are to be construed to cover both the singular and the plural, unless otherwise indicated herein or clearly contradicted by context. Recitation of ranges of values herein is merely intended to serve as a shorthand method of referring individually to each separate value falling within the range. Unless otherwise indicated herein, each individual value is incorporated into the specification as if it were individually recited herein. All methods described herein can be performed in any suitable order unless otherwise indicated herein or otherwise clearly contradicted by context. The use of any and all examples, or exemplary language (e.g., "such as") provided herein is intended merely to better illuminate the invention and does not pose a limitation on the scope of the invention otherwise claimed. No language in the specification should be construed as indicating any non-claimed element essential to the practice of the invention.

**[0165]** Groupings of alternative elements or embodiments of the invention disclosed herein are not to be construed as limitations. Each group member may be referred to and claimed individually or in any combination with other members of the group or other elements found herein. It is anticipated that one or more members of a group may be included in, or deleted from, a group for reasons of convenience and/or patentability. When any such inclusion or deletion occurs, the specification is deemed to contain the group as modified thus fulfilling the written description of all Markush groups used in the appended claims.

**[0166]** Certain embodiments of this invention are described herein, including the best mode known to the inventors for carrying out the invention. Of course, variations on these described embodiments will become apparent to those of ordinary skill in the art upon reading the foregoing description. The inventor expects skilled artisans to employ such variations as appropriate, and the inventors intend for the invention to be practiced otherwise than specifically described herein. Accordingly, this invention includes all modifications and equivalents of the subject matter recited in the claims appended hereto as permitted by applicable law. Moreover, any combination of the above-described elements in all possible variations thereof is encompassed by the invention unless otherwise indicated herein or otherwise clearly contradicted by context.

**[0167]** Specific embodiments disclosed herein may be further limited in the claims using consisting of or and consisting essentially of language. When used in the claims, whether as filed or added per amendment, the transition term "consisting of" excludes any element, step, or ingredient not specified in the claims. The transition term "consisting essentially of" limits the scope of a claim to the specified materials or steps and those that do not materially affect the basic and novel characteristic(s). Embodiments of the invention so claimed are inherently or expressly described and enabled herein.

**[0168]** In closing, it is to be understood that the embodiments of the invention disclosed herein are illustrative of the principles of the present invention. Other modifications that may be employed are within the scope of the invention. Thus, by way of example, but not of limitation, alternative configurations of the present invention may be utilized in accordance with the teachings herein. Accordingly, the present

invention is not limited to that precisely as shown and described.

CLAIMS

## WHAT IS CLAIMED IS:

1. A system for attaching a fluid access port to a patient, the system comprising:
  - an access port including a plurality of rotatable anchor assemblies, each anchor assembly comprising a wire portion and a molded portion secured to the wire portion; and
  - a tool configured to facilitate attachment of the access port to the patient.
2. The system of claim 1 wherein the molded portion is molded to the wire portion.
3. The system of claim 1 wherein the molded portion is overmolded to the wire portion.
4. The system of claim 1 wherein the wire portion has a proximal portion and distal portion, the distal portion including a tip structured to penetrate and engage tissue, the molded portion molded to the proximal portion of the wire portion.
5. The system of claim 1 wherein the molded portion includes a pivot axle having an axis substantially perpendicular to a plane of rotation of the wire portion.
6. The system of claim 1 wherein the wire portion is made of metal and the molded portion is made of plastic.

7. The system of claim 1 wherein the molded portion includes an actuator pin and a deploy pin spaced apart from the actuator pin.

8. An implantable access port for providing fluid access to a patient, the access port comprising:

a septum;

a housing secured to the septum; and

a plurality of rotatable anchor assemblies fixed to the housing, each anchor assembly comprising a wire portion and a molded portion secured to the wire portion.

9. The access port of claim 8 wherein the molded portion is molded to the wire portion.

10. The access port of claim 8 wherein the molded portion is overmolded to the wire portion.

11. The access port of claim 8 wherein the wire portion has a proximal portion and distal portion, the distal portion including a tip structured to penetrate and engage tissue, the molded portion molded to the proximal portion of the wire portion.

12. The access port of claim 8 wherein the molded portion includes a pivot axle having an axis substantially perpendicular to a plane of rotation of the wire portion.

13. The access port of claim 8 wherein the wire portion is made of metal and the molded portion is made of plastic.

14. The access port of claim 8 wherein the molded portion includes an actuator pin and a deploy pin spaced apart from the actuator pin.

15. A tool for securing a fluid access port to a patient, the assembly comprising:

a handle having a trigger; and

an actuator head coupled to the trigger and configured to removably engage and deploy an access port;

the actuator head being pivotal with respect to the handle.

16. The tool of claim 15 wherein the actuator head is configured to removably engage an access port in more than one orientation.

17. The tool of claim 15 further comprising a pivot device pivotally coupling the actuator head to the handle.

18. The tool of claim 15 further comprising an extension tube coupling the actuator head to the handle, a length of the extension tube defining an axis of rotation, the actuator head being pivotal about the axis of rotation.

19. The tool of claim 18 wherein the actuator head is configured to pivot 360 degrees around the axis of rotation.

20. The tool of claim 15 further comprising an actuator cable assembly having a proximal portion coupled to the handle and a distal portion coupled to the actuator head, and a ball fixed to the proximal portion and connecting the proximal portion to the handle, the ball enabling the actuator head to pivot with respect to the handle.

21. A system for attaching a fluid access port to a patient, the system comprising:

an access port comprising a septum, a housing secured to the septum, and a plurality of rotatable anchor assemblies fixed to the housing, each anchor assembly comprising a wire portion and a molded portion overmolded to the wire portion; and

a tool configured to facilitate attachment of the access port to a patient, the tool comprising a handle having a trigger, and an actuator head coupled to the handle and configured to removably engage and deploy an access port, the actuator head being pivotal with respect to the handle.

22. The system of claim 21 wherein the actuator head is configured to removably engage an access port in more than one orientation.

23. The system of claim 21 further comprising a pivot device pivotally coupling the actuator head to the handle.

24. The system of claim 21 further comprising an extension tube coupling the actuator head to the handle, a length of the extension tube defining an axis of rotation, the actuator head being pivotal about the axis of rotation.

25. The system of claim 24 wherein the actuator head is configured to pivot 360 degrees around the axis of rotation.

26. The system of claim 21 further comprising an actuator cable assembly having a proximal portion coupled to the handle and a distal portion coupled to the actuator head, and a ball fixed to the proximal portion and connecting the proximal portion to the



handle, the ball enabling the actuator head to pivot with respect to the handle.

27. An implantable access port for providing fluid access to a patient, the access port comprising:

a septum;

a housing secured to the septum and including a base substantially opposing the septum, the base having a bottom surface; and

a mesh member having a top surface and a bottom surface, the top surface of the mesh member secured to the bottom surface of the base for encouraging tissue ingrowth when the access port is implanted in a patient.

28. The access port of claim 27 wherein the mesh member does not substantially extend beyond the base.

29. The access port of claim 27 wherein the mesh member includes a portion extending beyond the base.

30. The access port of claim 27 wherein the mesh member substantially circumscribes the base.

31. The access port of claim 27 wherein the mesh member extends substantially parallel to the base.

32. The access port of claim 27 wherein the mesh member is welded or adhered to the bottom surface of the base.

33. The access port of claim 27 further comprising a ring having a top surface and a bottom surface, the top surface of the ring removably or permanently fixed to the bottom surface of

the base, the bottom surface of the ring firmly fixed to the mesh member.

34. The access port of claim 27 further comprising a ring having a top surface and a bottom surface, the top surface of the ring removably or permanently fixed to the bottom surface of the base, a portion of the mesh member being firmly or loosely sandwiched between the top surface of the ring and a bottom surface of the base.

35. The access port of claim 27 wherein the mesh member is integrally molded as part of the base of the access port.

36. The access port of claim 27 wherein the mesh member is made of a material selected from a group consisting of a bioresorbable, a non-resorbable, and combinations therein.

37. An implantable access port for providing fluid access to a patient, the access port comprising:

a septum;

a housing secured to the septum and including a base substantially opposing the septum, the base having a bottom surface;

a plurality of rotatable anchor assemblies fixed to the housing; and

a coating of a bioresorbable material covering a portion of the bottom surface of the base.

38. The access port of claim 37 wherein the coating has an even thickness.

39. The access port of claim 37 wherein the coating has a thickness in a range between 0.001 inches and 0.25 inches.

40. The access port of claim 37 wherein the coating is deposited to the base by a process selected from a group consisting of a spraying process, a dipping process, a molding process, a wiping process, and combinations therein.

41. An implantable access port for providing fluid access to a patient, the access port comprising:

a septum;

a housing secured to the septum and including a base substantially opposing the septum, the base having a bottom surface, a portion of the bottom surface of the base being made of a bioresorbable material; and

a plurality of rotatable anchor assemblies fixed to the housing.

42. The access port of claim 41 wherein the entirety of the bottom surface of the base is made of a bioresorbable material.

43. The access port of claim 41 wherein the portion of the bottom surface of the base being made of a bioresorbable material is formed by a process selected from a group consisting of a molding process, a forming process, a stamping process, and combinations therein.

44. An implantable access port for providing fluid access to a patient, the access port comprising:

a housing defining a central cavity;

a palpation ring engaged with the housing, the engagement of the palpation ring and the housing defining a ring shaped gap having a diameter greater than a diameter of the central cavity;

a septum having a top portion, a bottom portion, and a rim located near the top portion, the bottom portion of the septum positioned in the central cavity, the rim of the septum positioned in the ring shaped gap; and

a plurality of rotatable anchor assemblies fixed to the housing.

45. The access port of claim 44 further comprising a compression ring positioned within the central cavity.

46. The access port of claim 45 wherein the rim of the septum is compressed between the palpation ring and the compression ring.

47. The access port of claim 44 wherein the ring shaped gap has a height of no more than 0.010 inches.

48. An implantable access port for providing fluid access to a patient, the access port comprising:

a septum;

a housing secured to the septum;

an actuator secured to the housing; and

an anchor assembly fixed to the housing, the anchor assembly having a distal portion and a proximal portion, the distal portion including a tip and the proximal portion including a pivot axle and an actuator pin spaced apart from the pivot axle, the anchor assembly being rotatable about the pivot axle from a retracted position to a deployed position, the actuator configured to engage the actuator pin to rotate the

anchor assembly from the retracted position to the deployed position.

49. The access port of claim 48 further comprising a deploy pin positioned on the proximal portion of the anchor assembly, the deploy pin spaced apart from the pivot axle and the actuator pin.

50. The access port of claim 49 further comprising a cam surface coupled to the housing, the cam surface configured to engage the deploy pin to start rotation of the anchor assembly from the retracted position to the deployed position.

51. The access port of claim 48 wherein a torque applied by the actuator to the actuator pin increases during rotation from the retracted position to the deployed position.

52. An implantable access port for providing fluid access to a patient, the access port comprising:

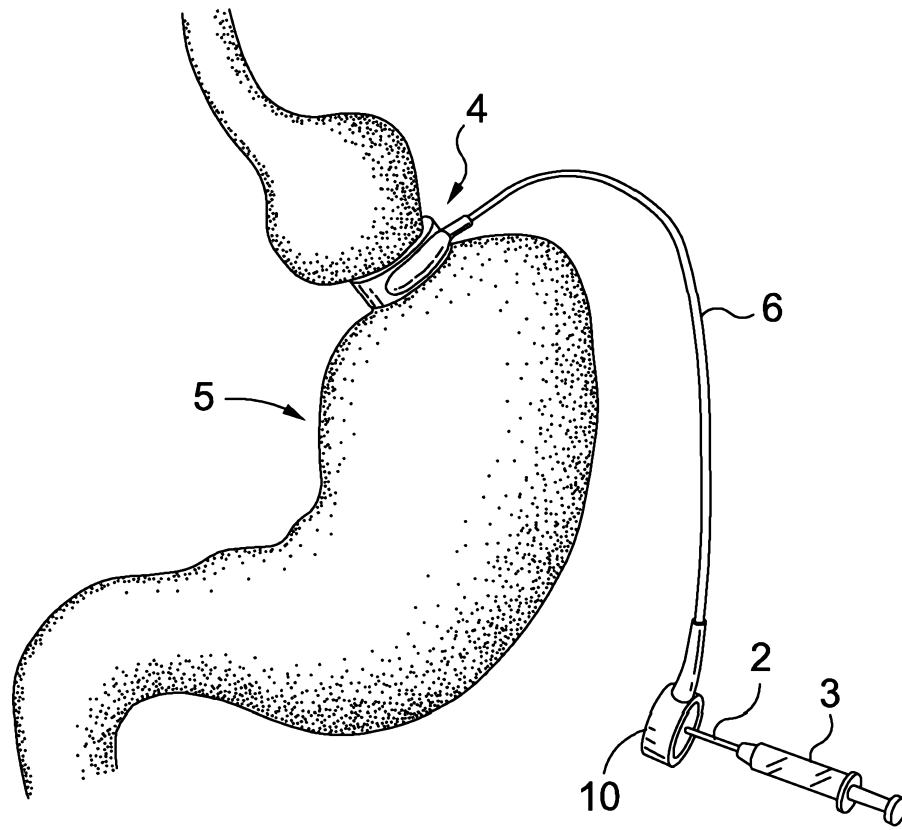
a septum;

a housing secured to the septum; and

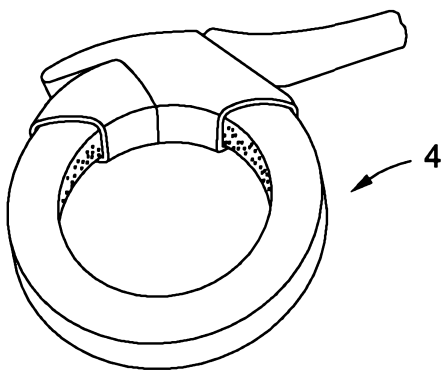
a plurality of rotatable anchor assemblies fixed to the housing, each anchor assembly being made of a bioresorbable material.

53. The access port of claim 52 wherein each anchor assembly is made entirely of a bioresorbable material.

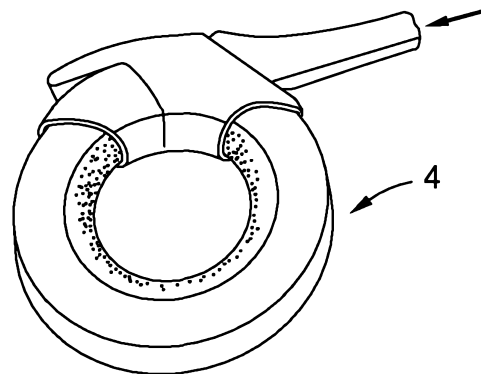
54. The access port of claim 52 wherein each anchor assembly is made of more than one bioresorbable material.



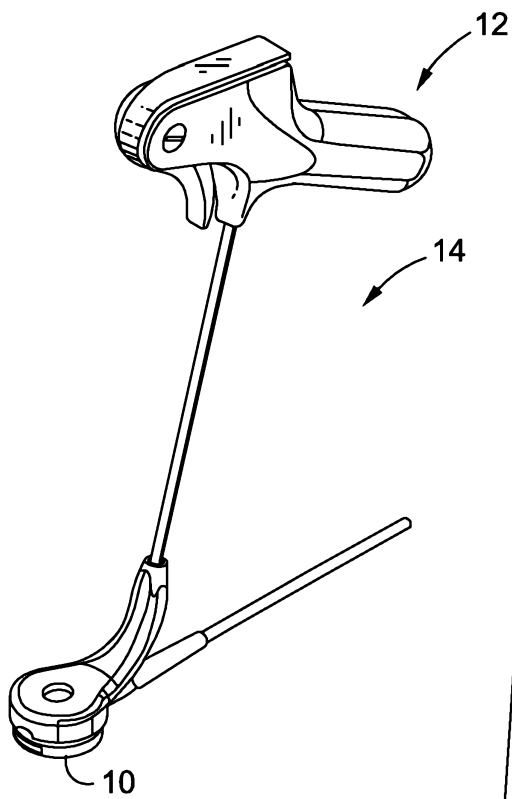
**FIG. 1**



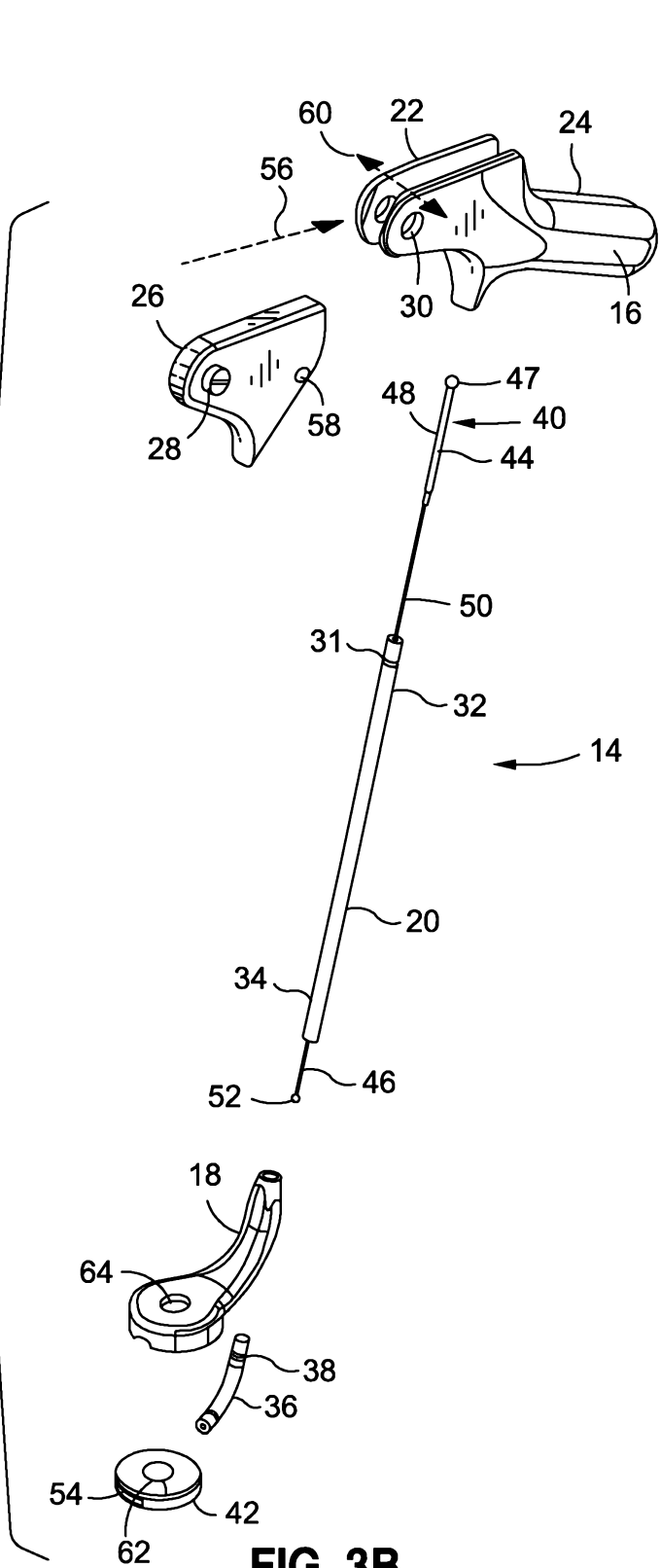
**FIG. 2A**



**FIG. 2B**



**FIG. 3A**



**FIG. 3B**

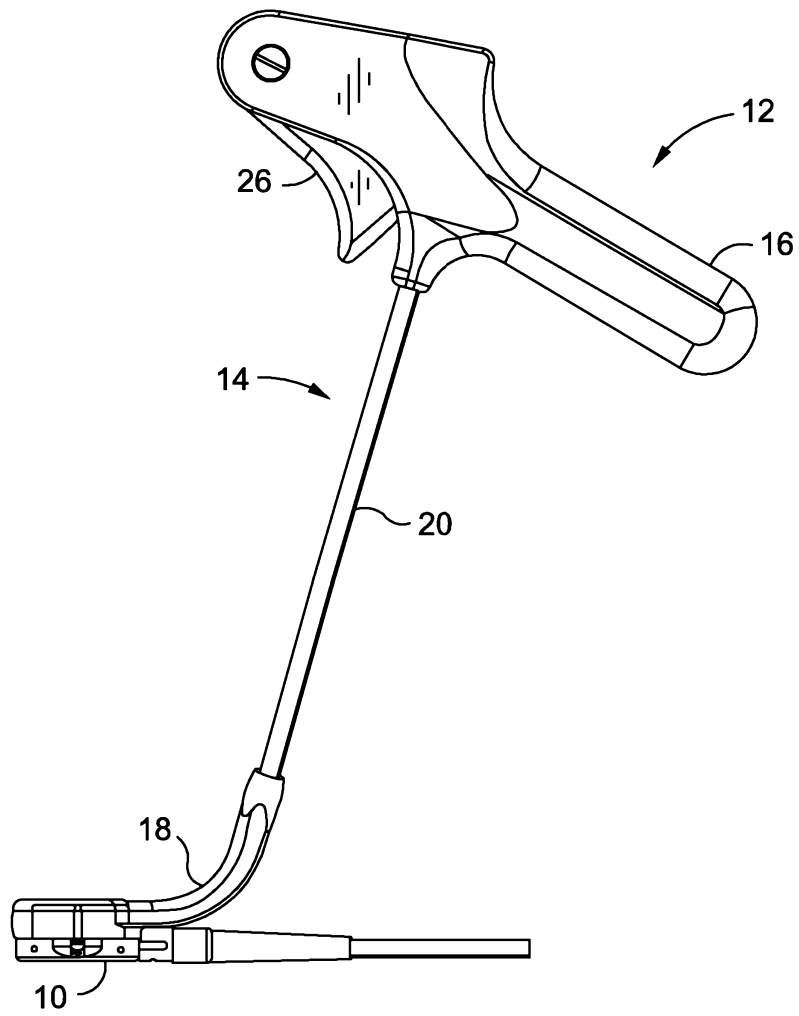
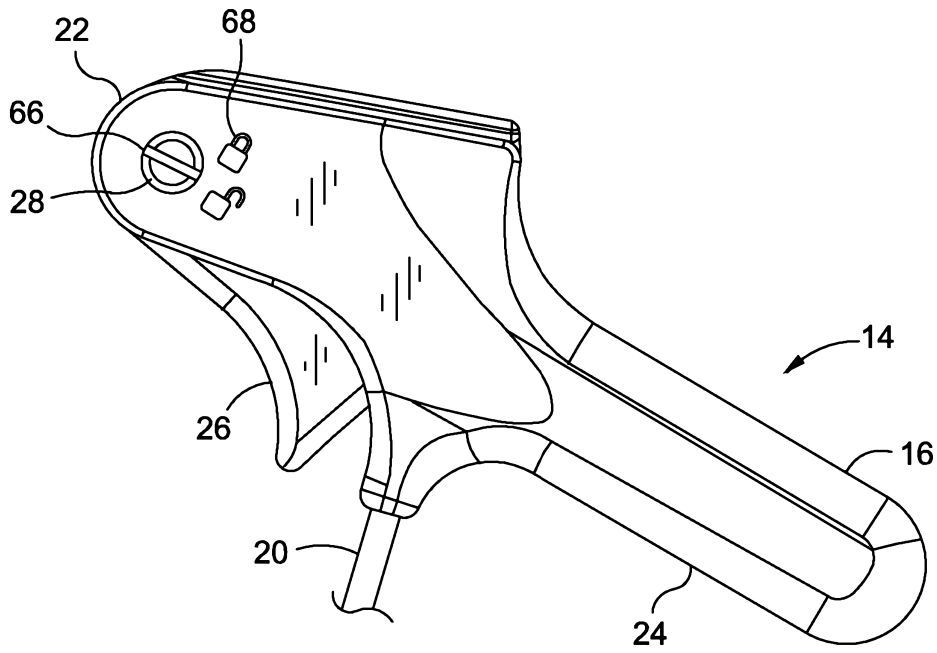
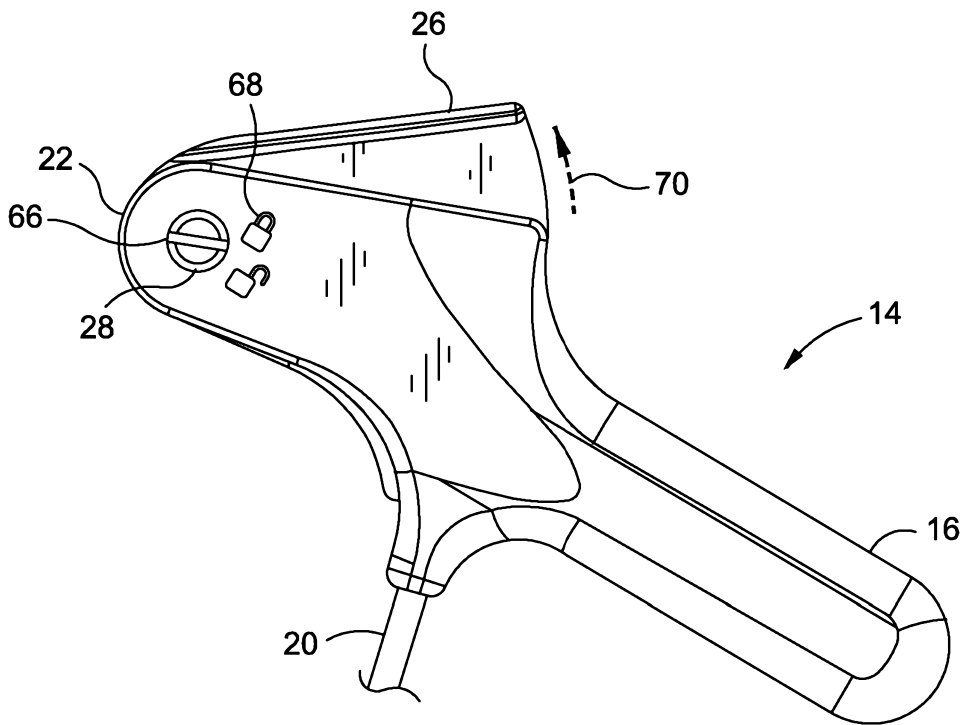


FIG. 3C



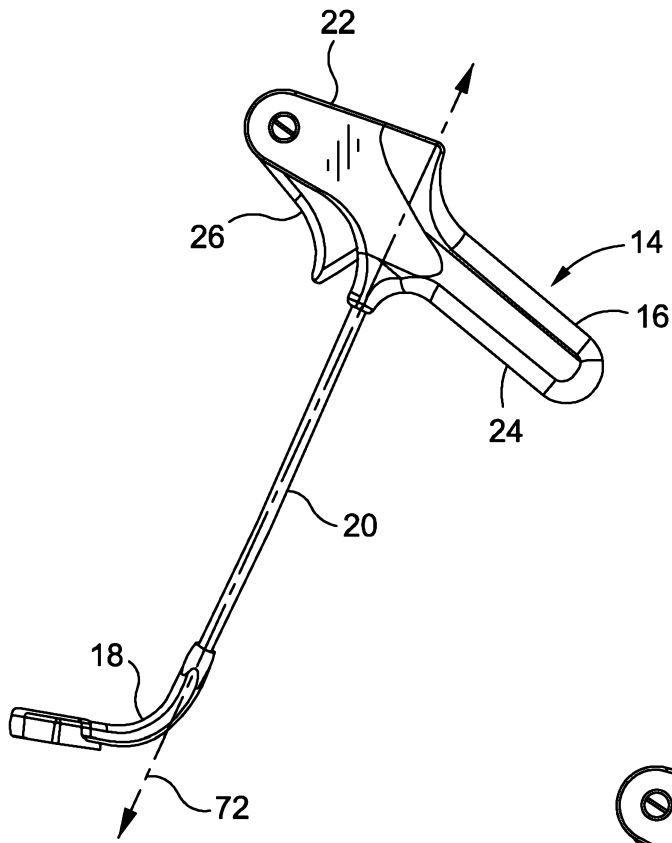


**FIG. 3D**

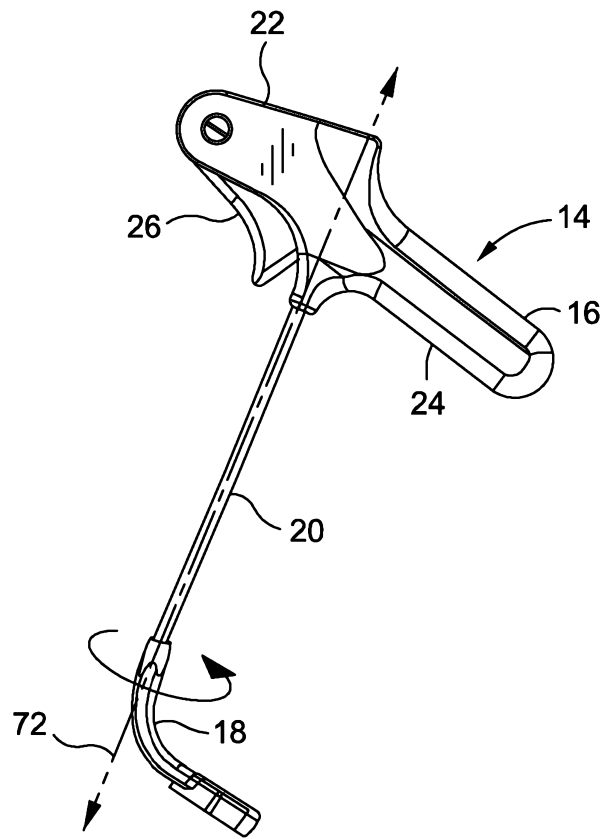


**FIG. 3E**

5/31



**FIG. 4A**



**FIG. 4B**

6/31

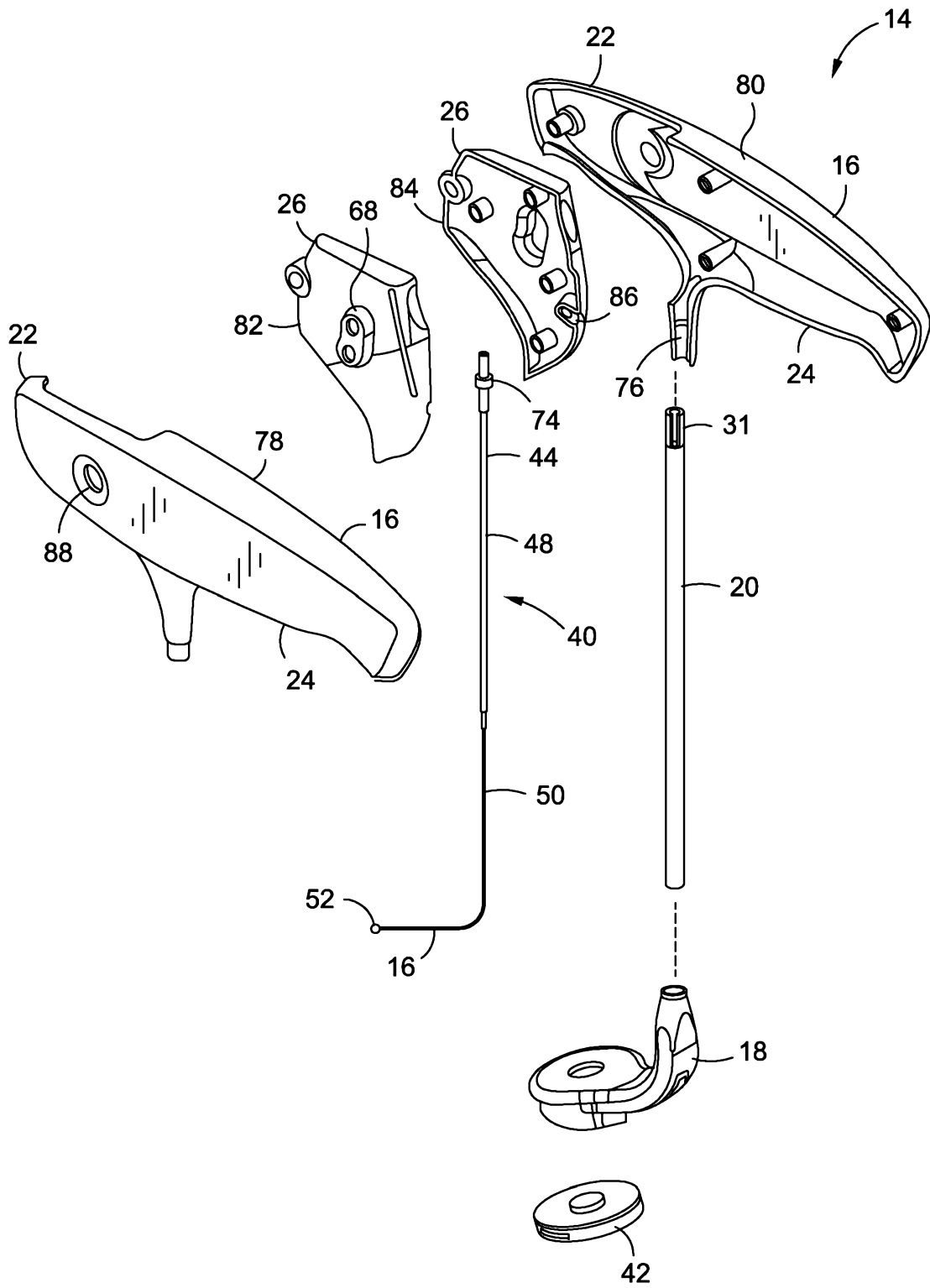
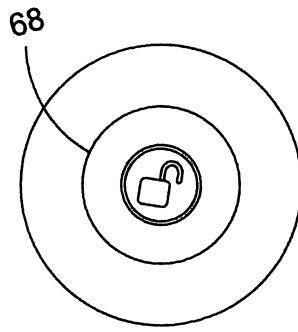
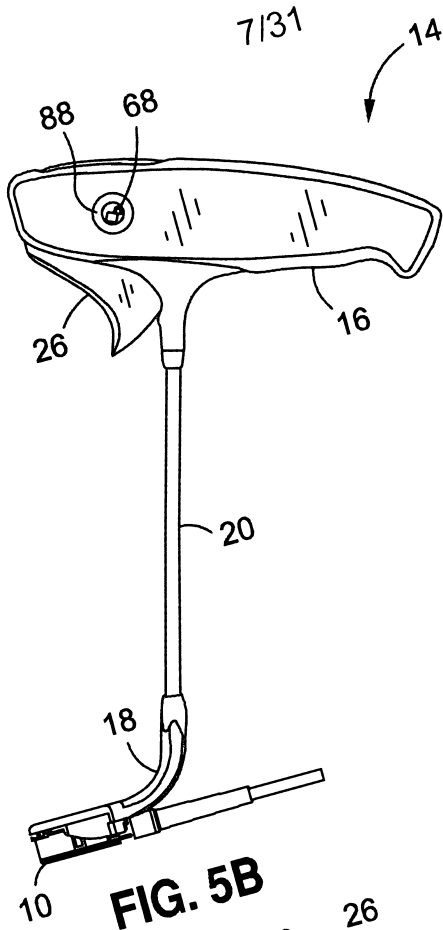
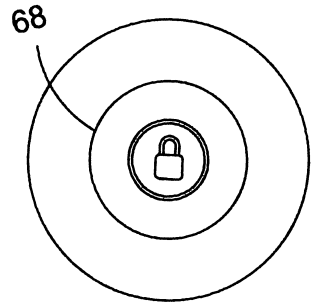
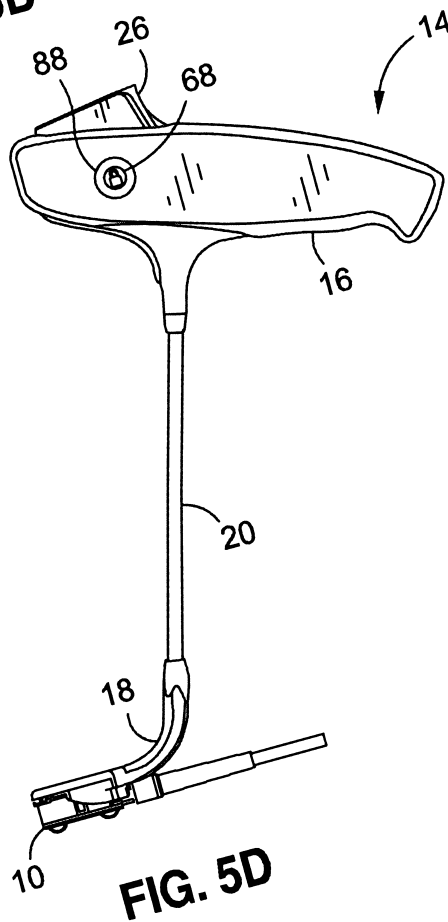


FIG. 5A

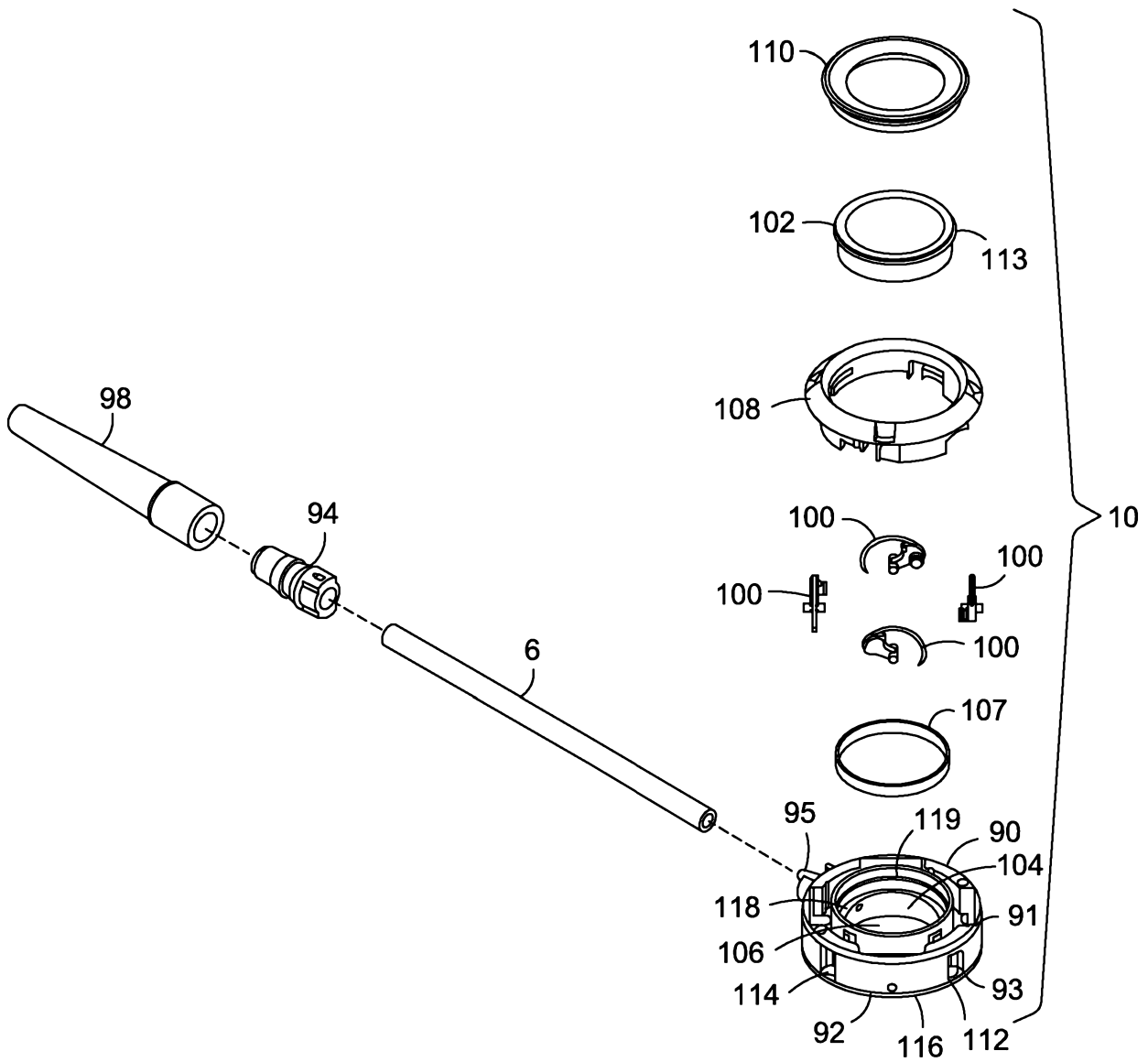


**FIG. 5C**

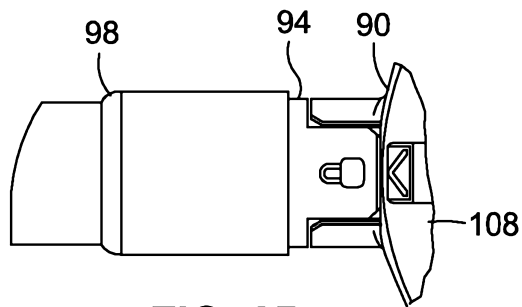


**FIG. 5E**

8/31

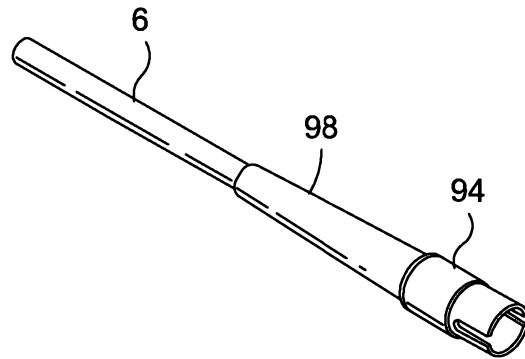


**FIG. 6A**

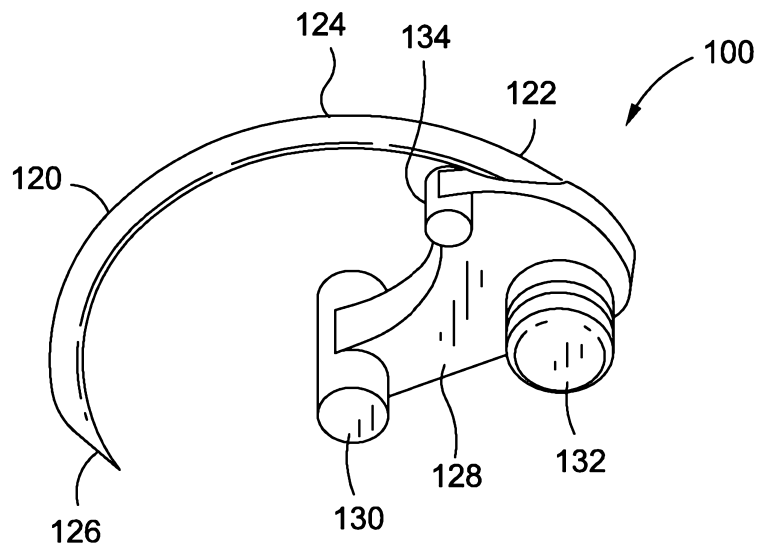


**FIG. 6B**

9/31



**FIG. 6C**



**FIG. 7**

10/31

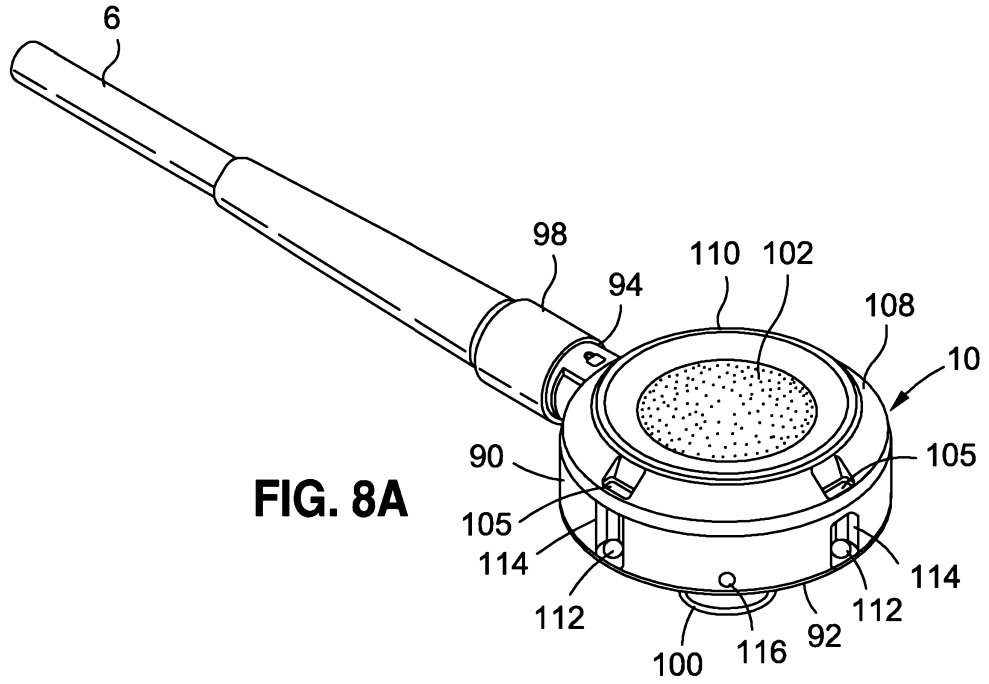


FIG. 8A

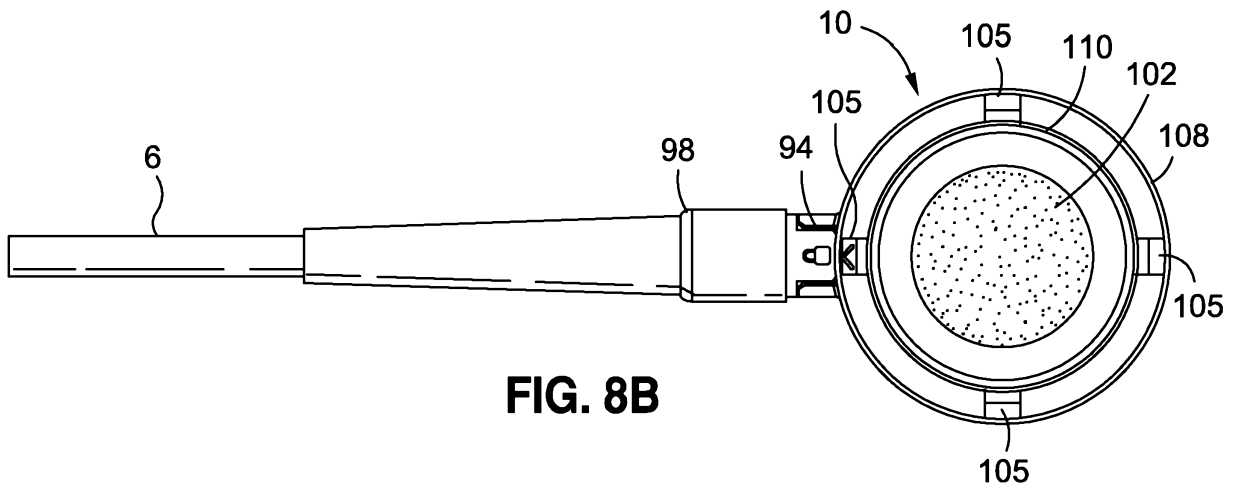


FIG. 8B

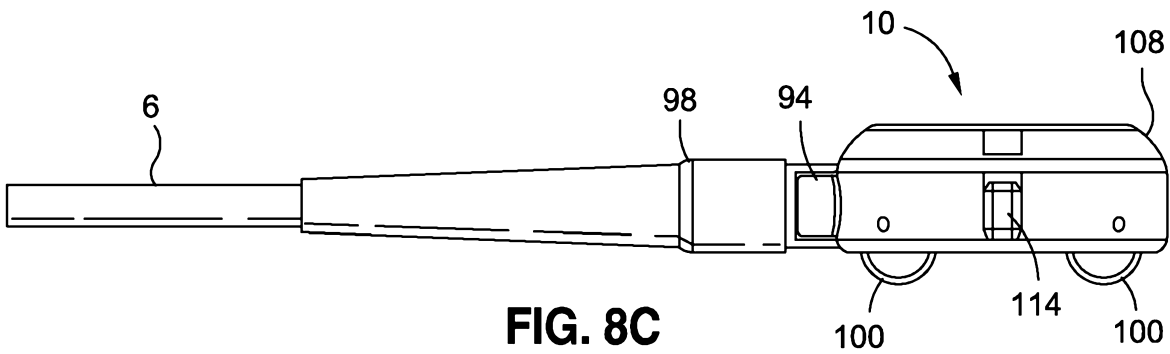


FIG. 8C

11/31

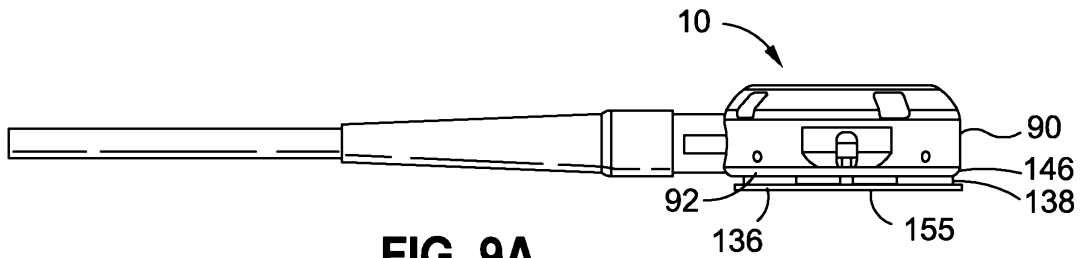


FIG. 9A

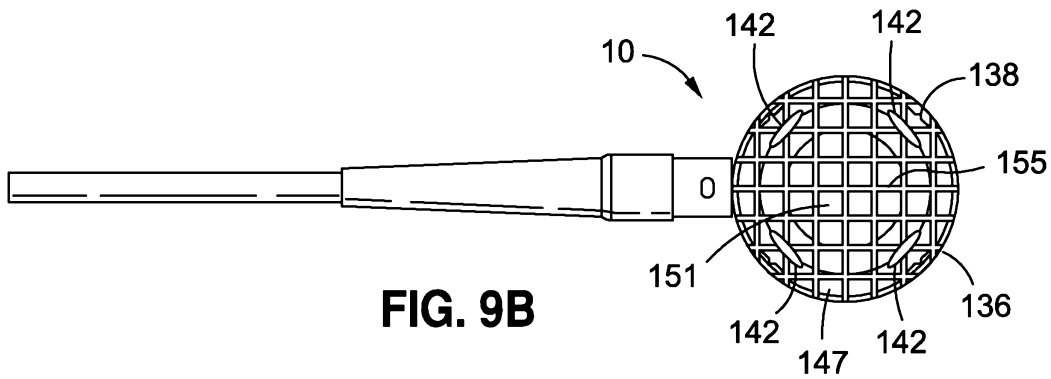


FIG. 9B

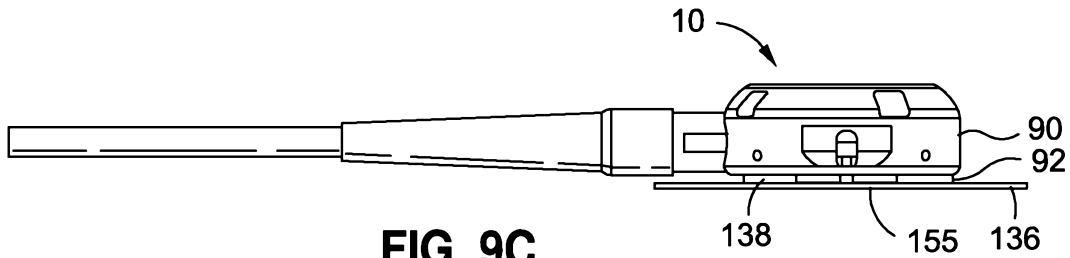


FIG. 9C

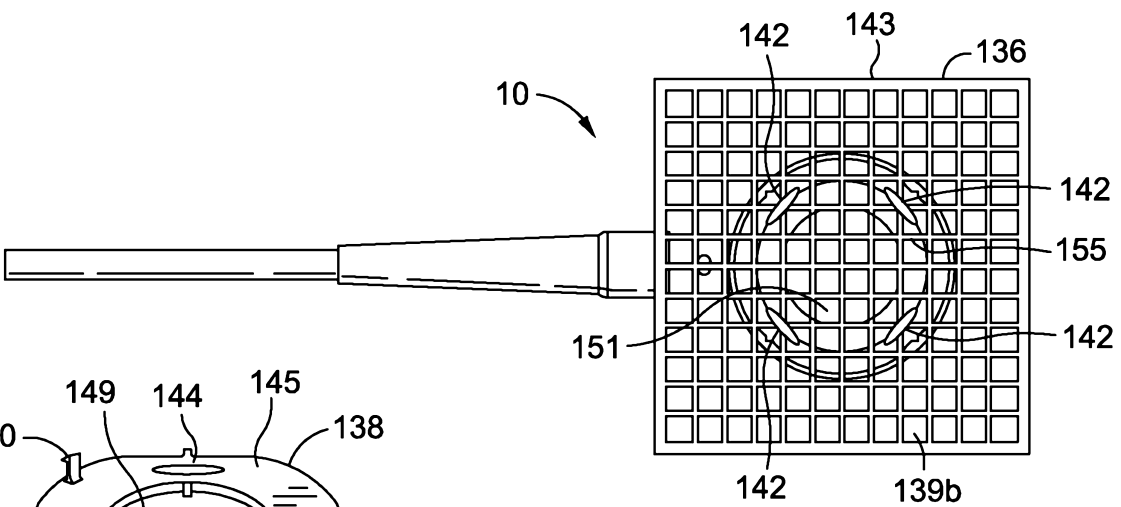


FIG. 9D

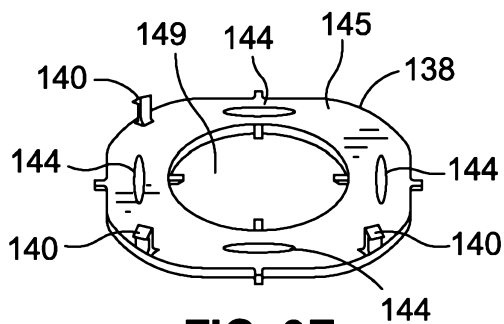


FIG. 9E



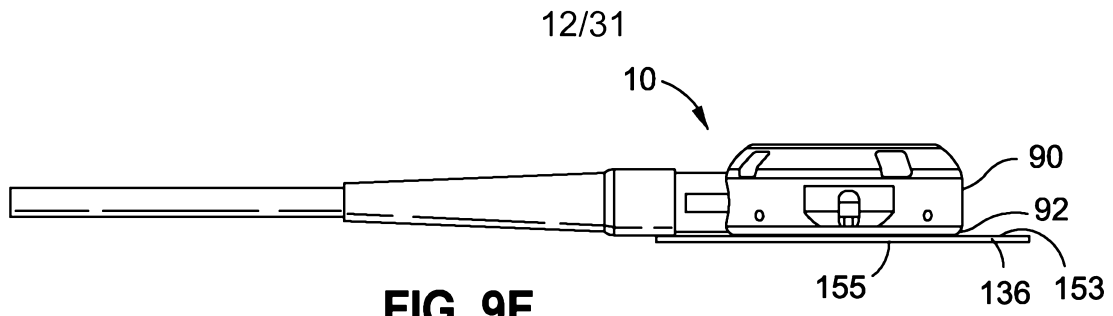


FIG. 9F

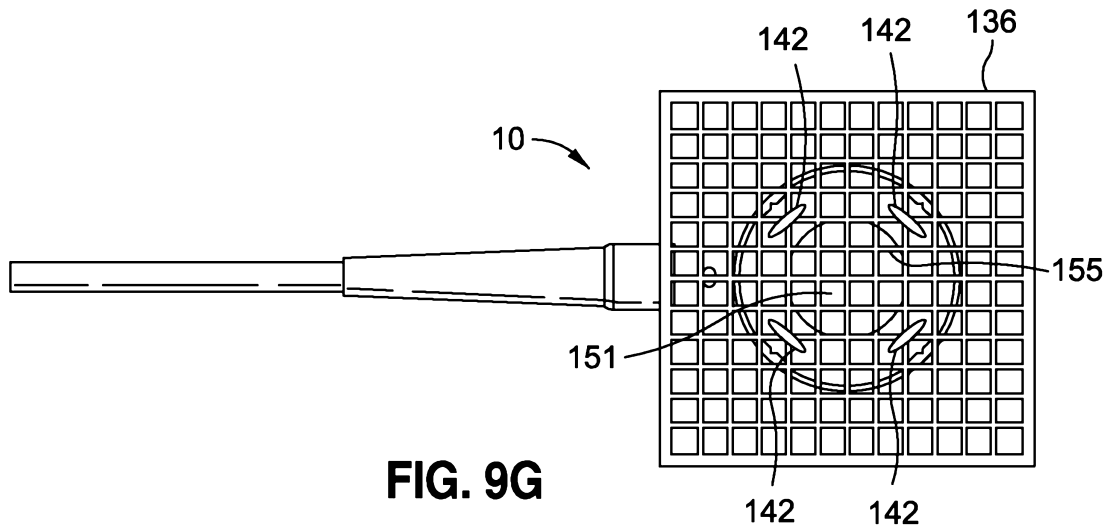


FIG. 9G

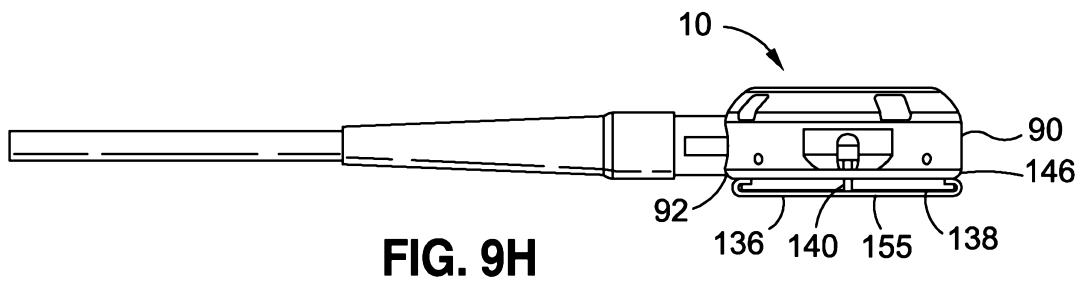


FIG. 9H

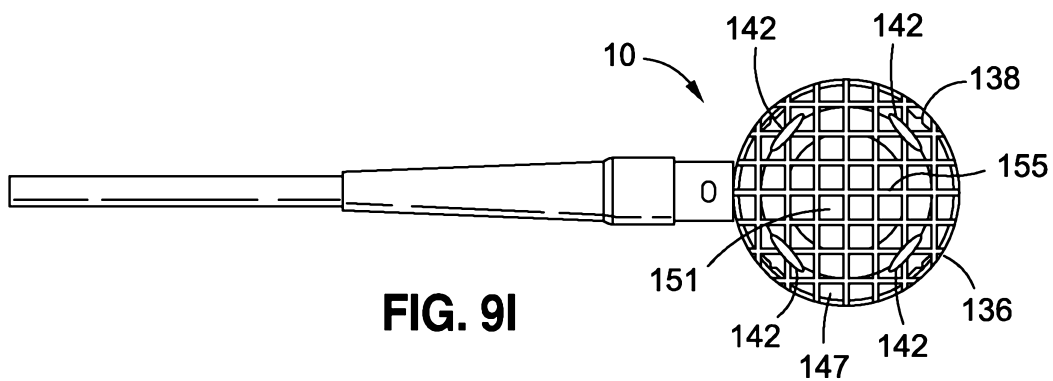


FIG. 9I

13/31

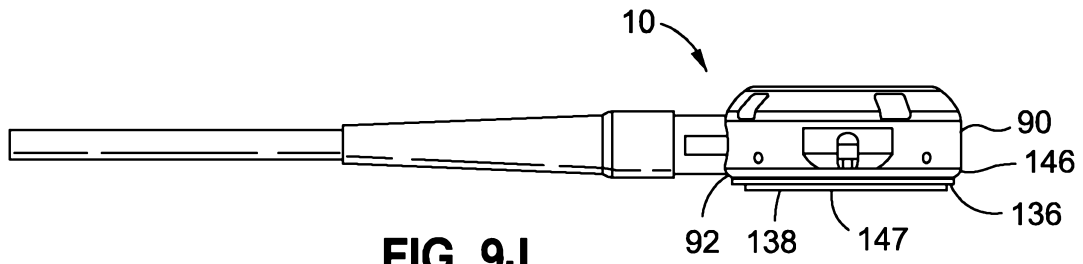


FIG. 9J

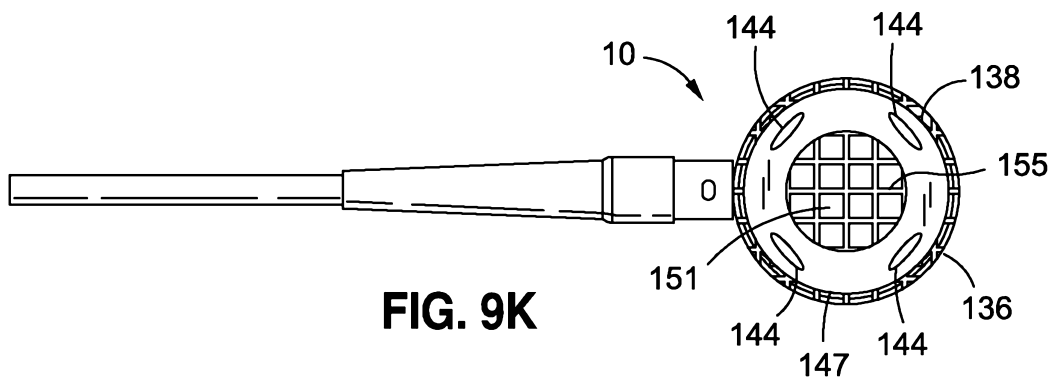


FIG. 9K

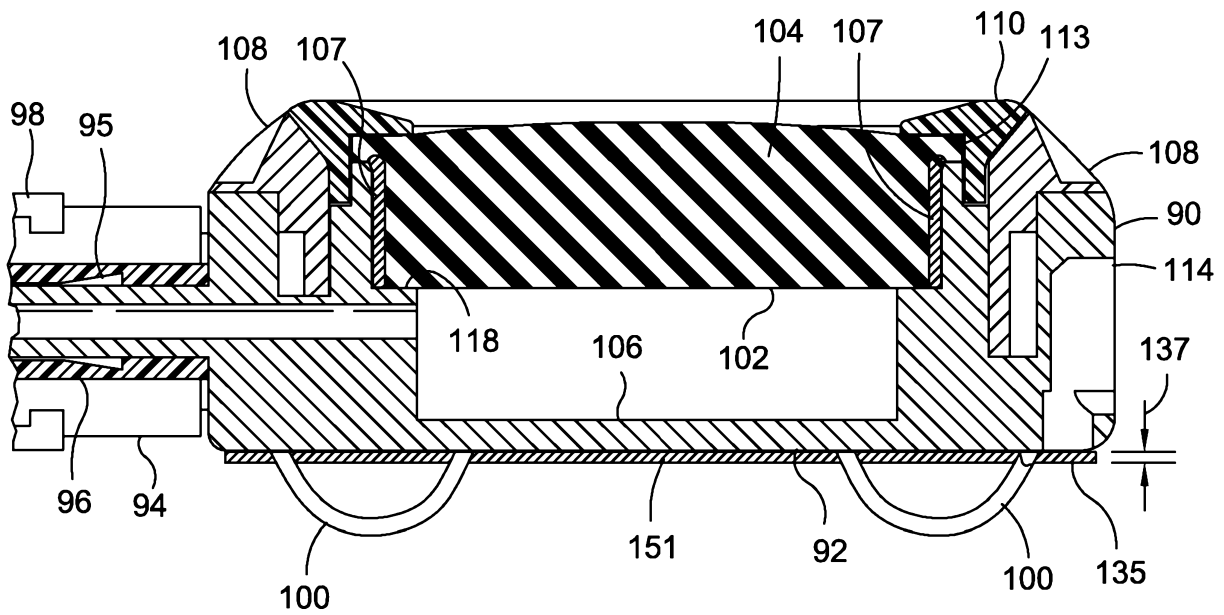
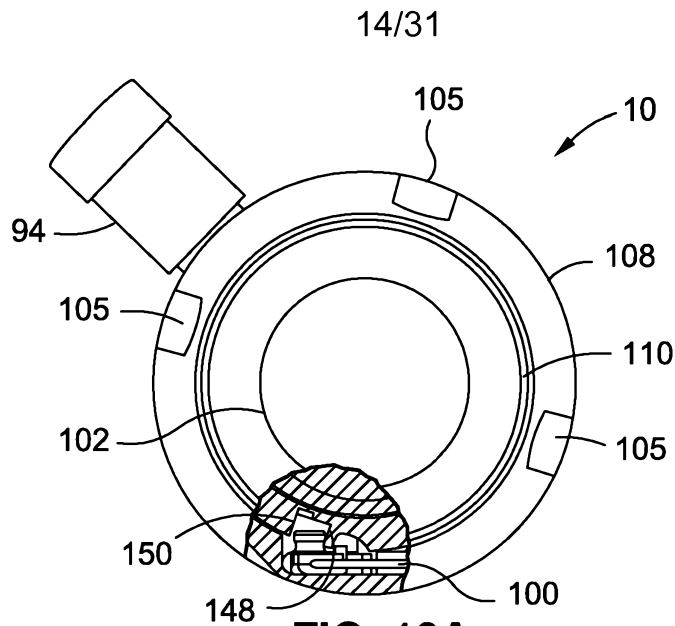
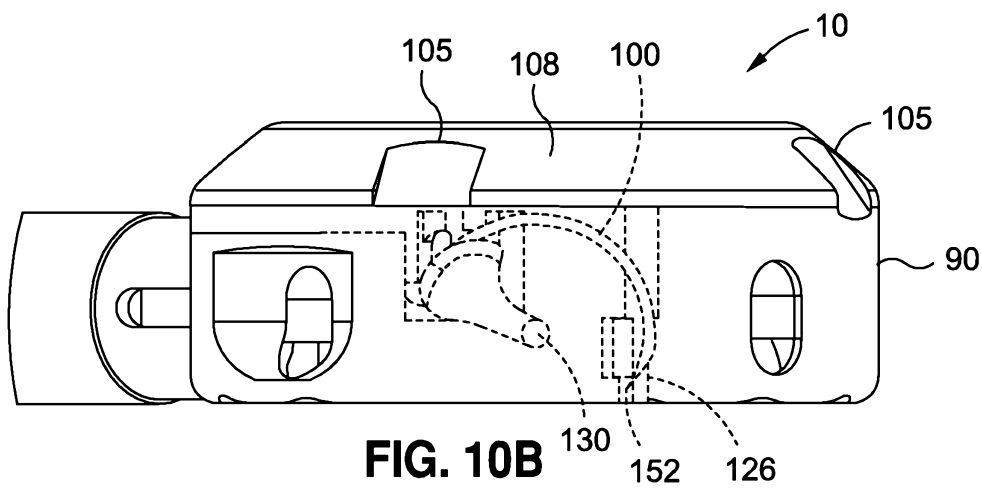


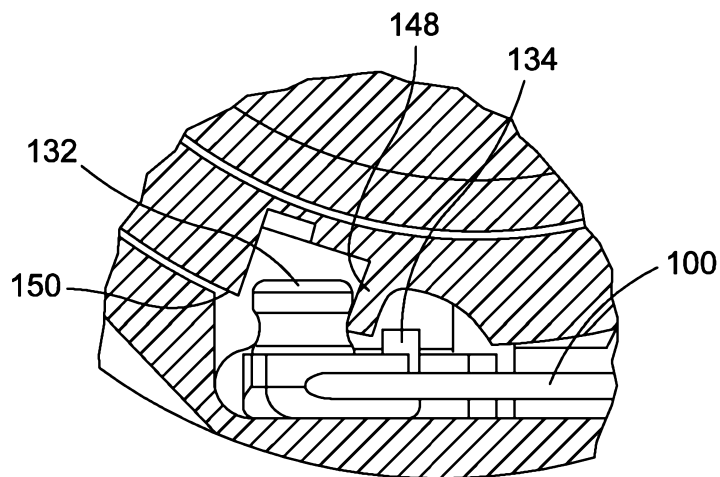
FIG. 9L



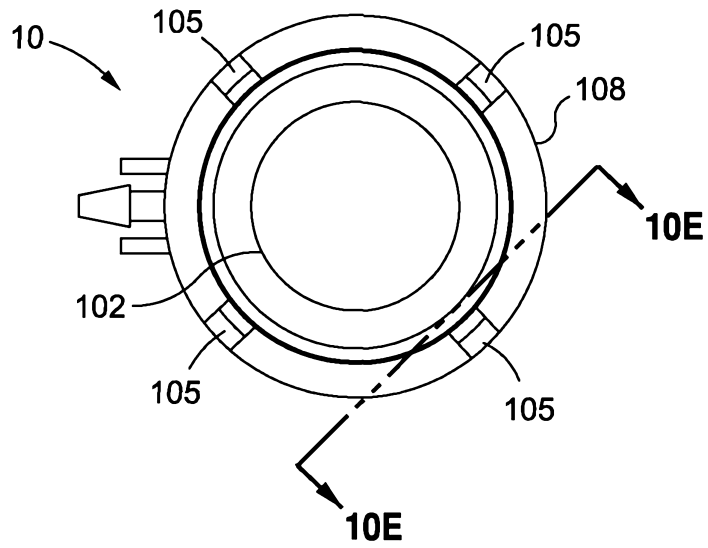
**FIG. 10A**



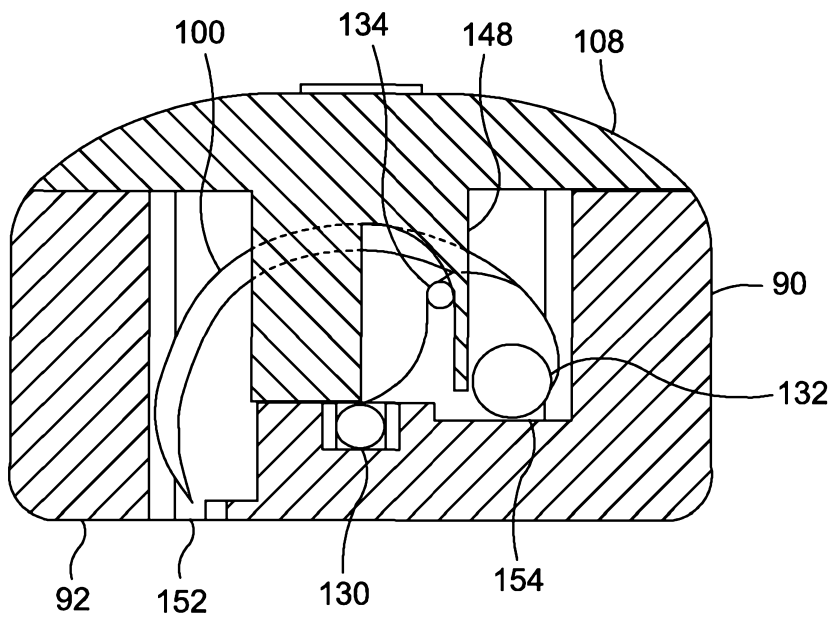
**FIG. 10B**



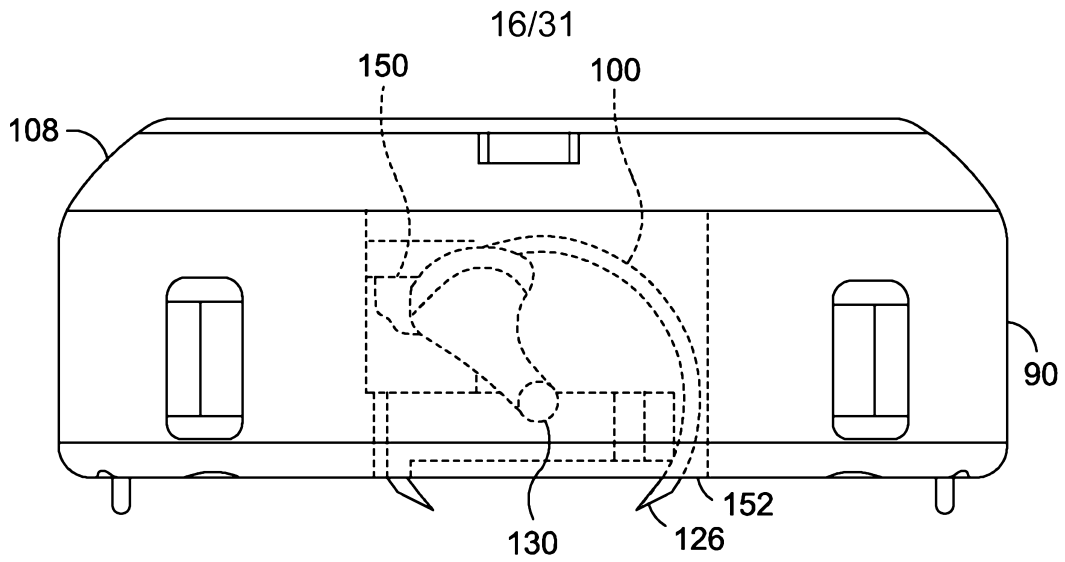
**FIG. 10C**



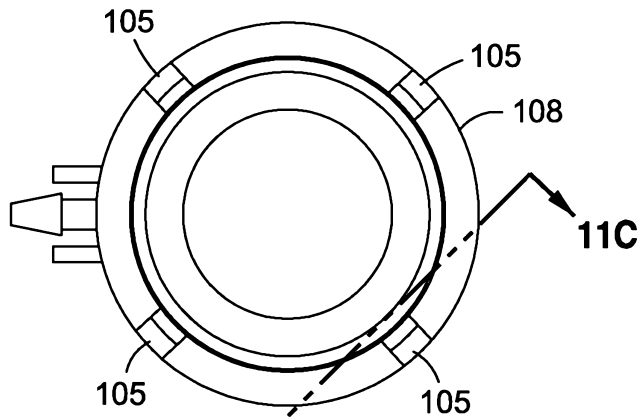
**FIG. 10D**



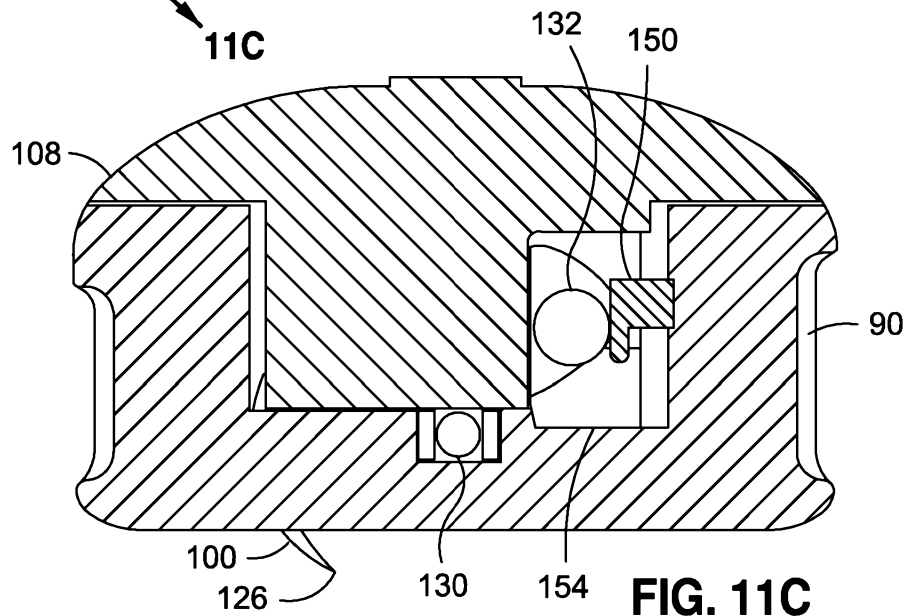
**FIG. 10E**



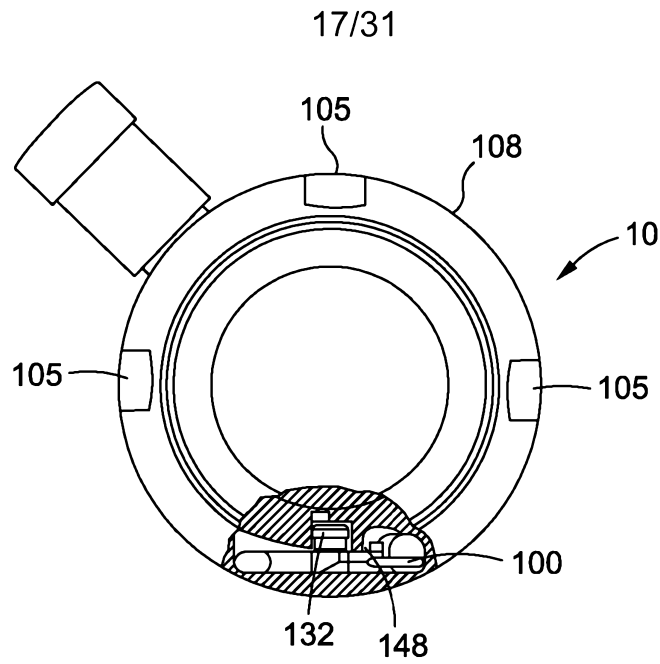
**FIG. 11A**



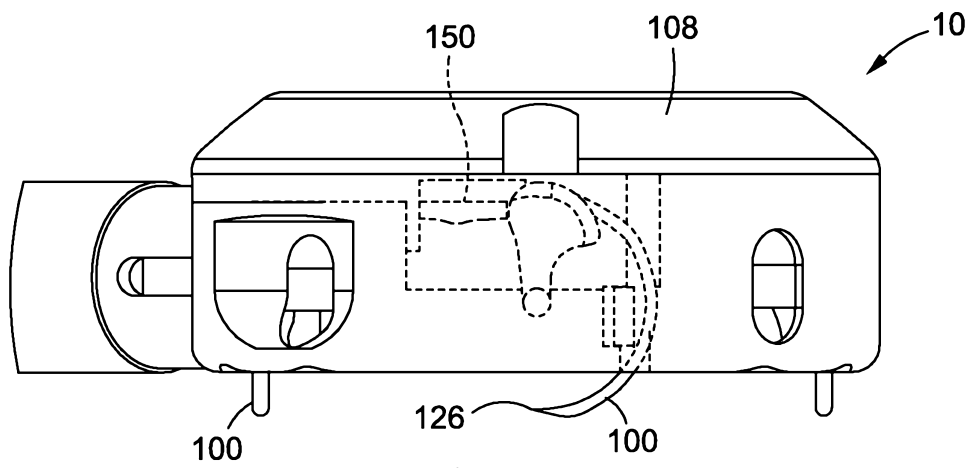
**FIG. 11B**



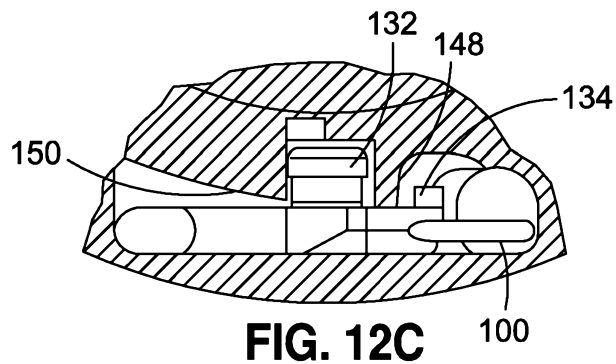
**FIG. 11C**



**FIG. 12A**



**FIG. 12B**



**FIG. 12C**

18/31

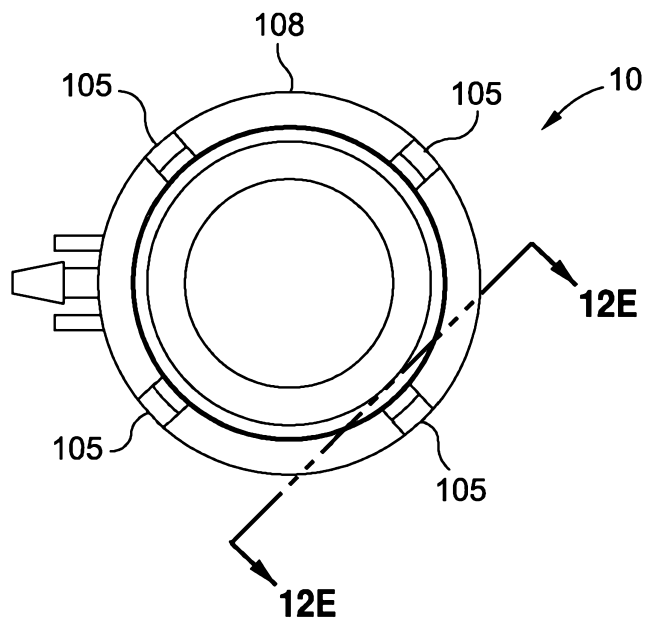


FIG. 12D

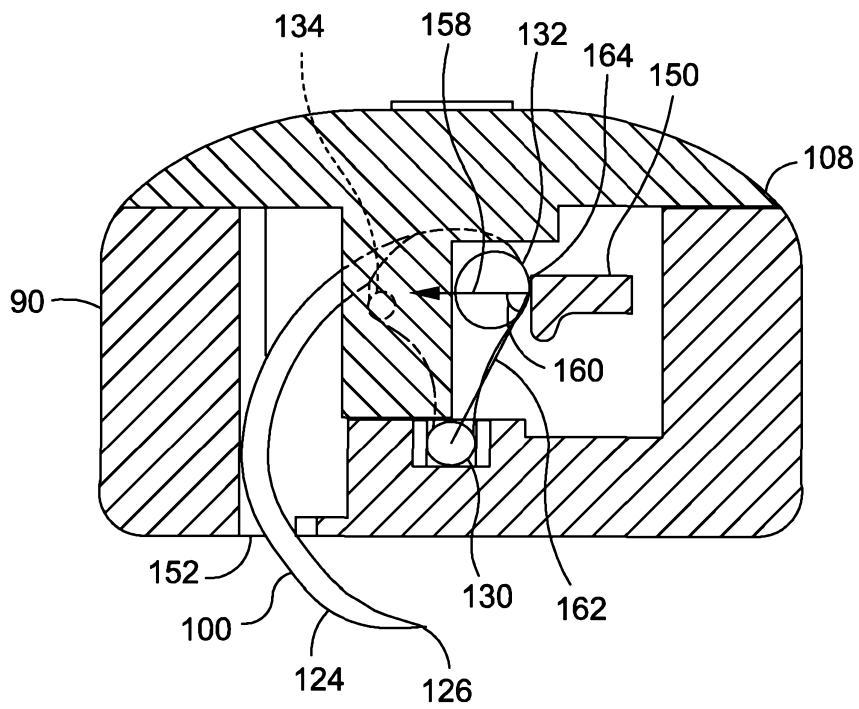
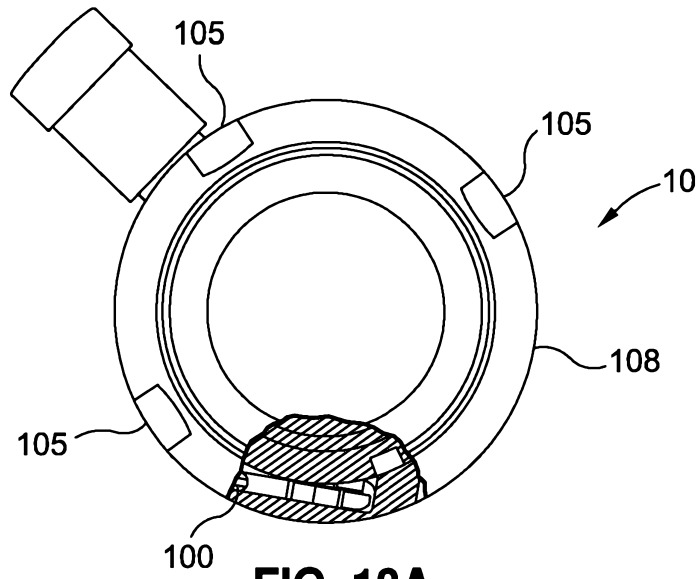
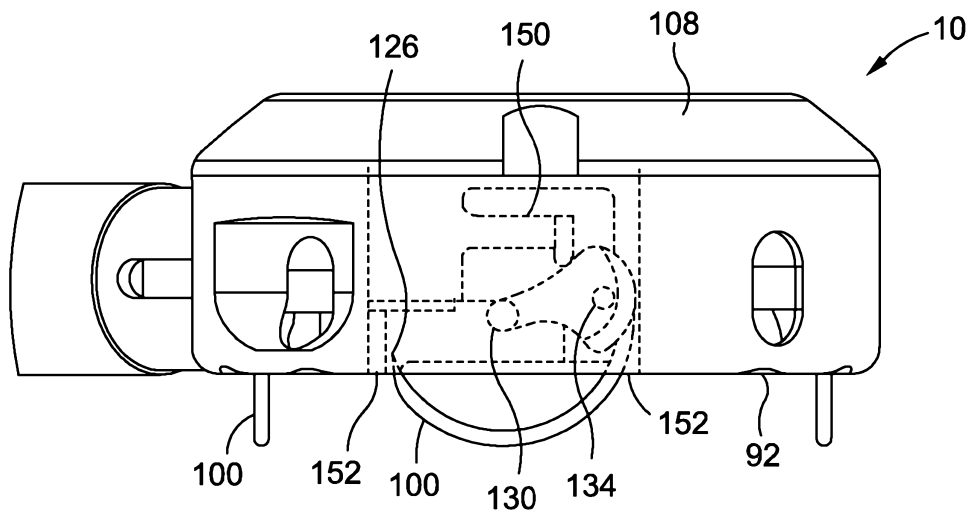


FIG. 12E

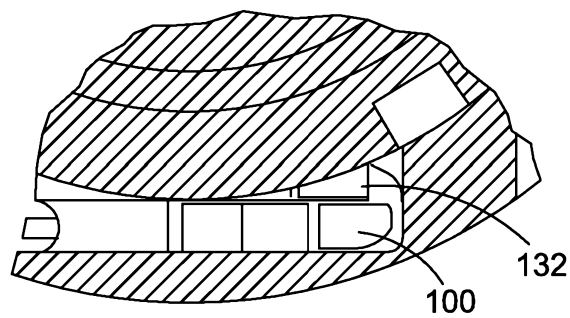
19/31



**FIG. 13A**



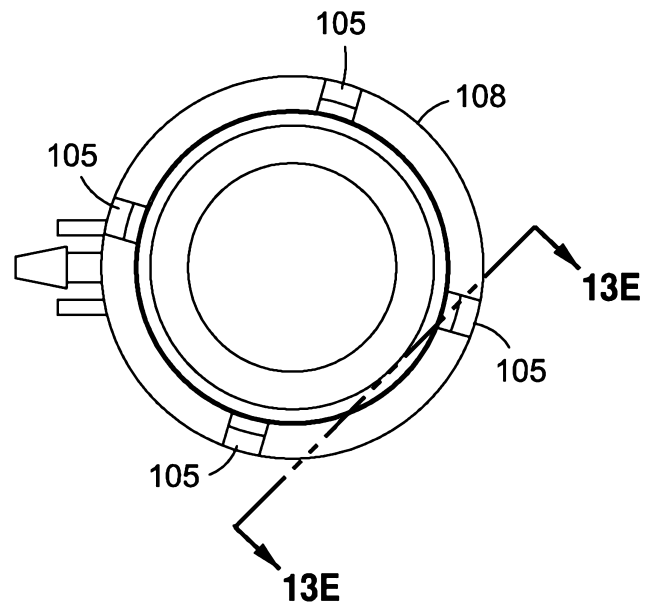
**FIG. 13B**



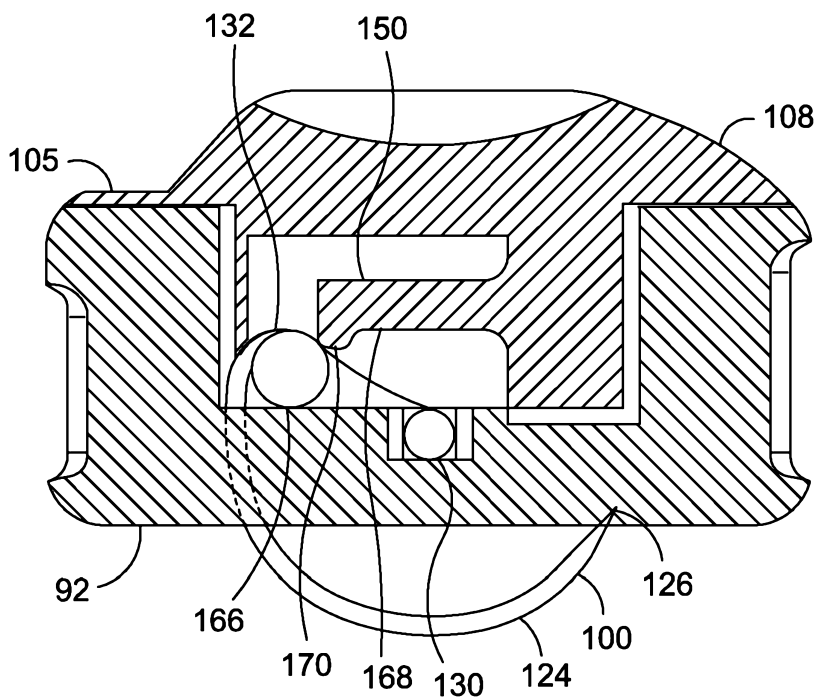
**FIG. 13C**



20/31



**FIG. 13D**



**FIG. 13E**

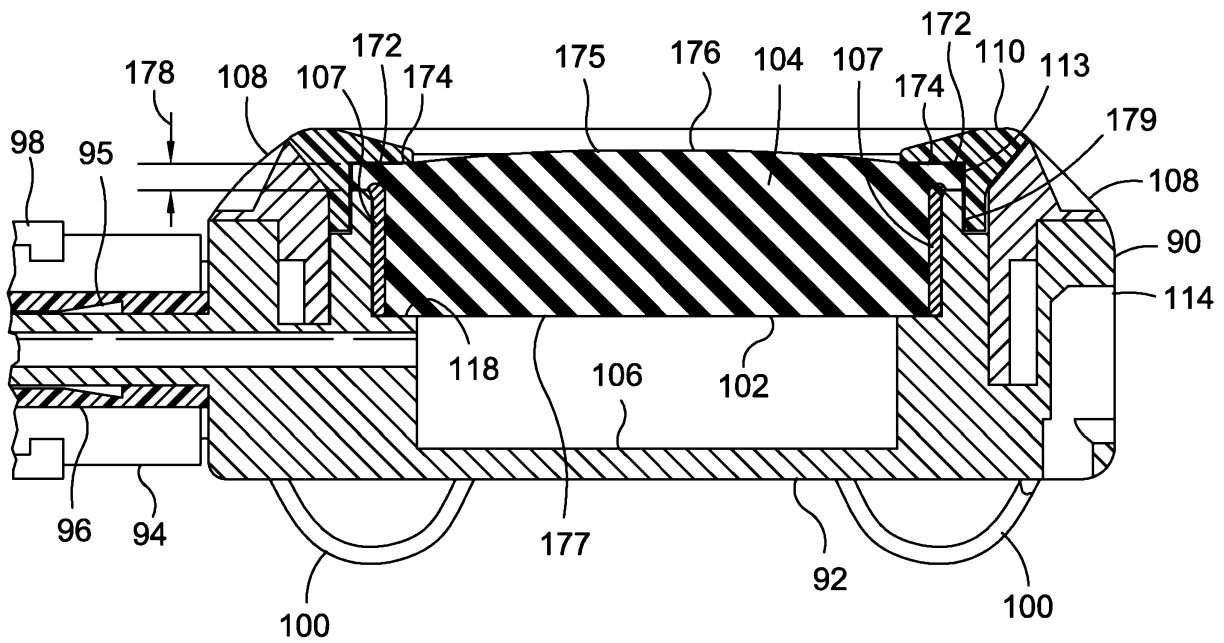


FIG. 14

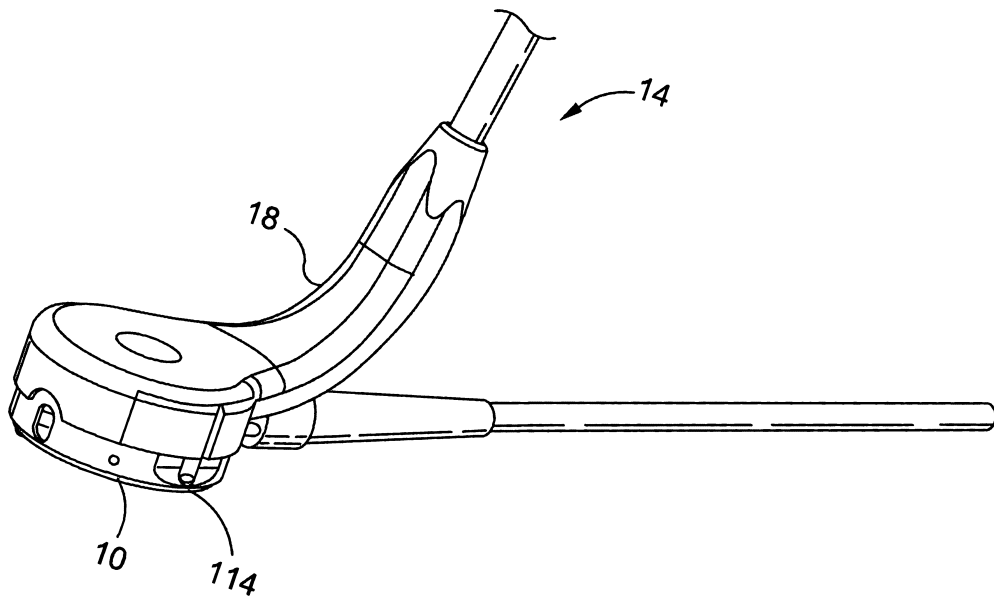


FIG. 15A

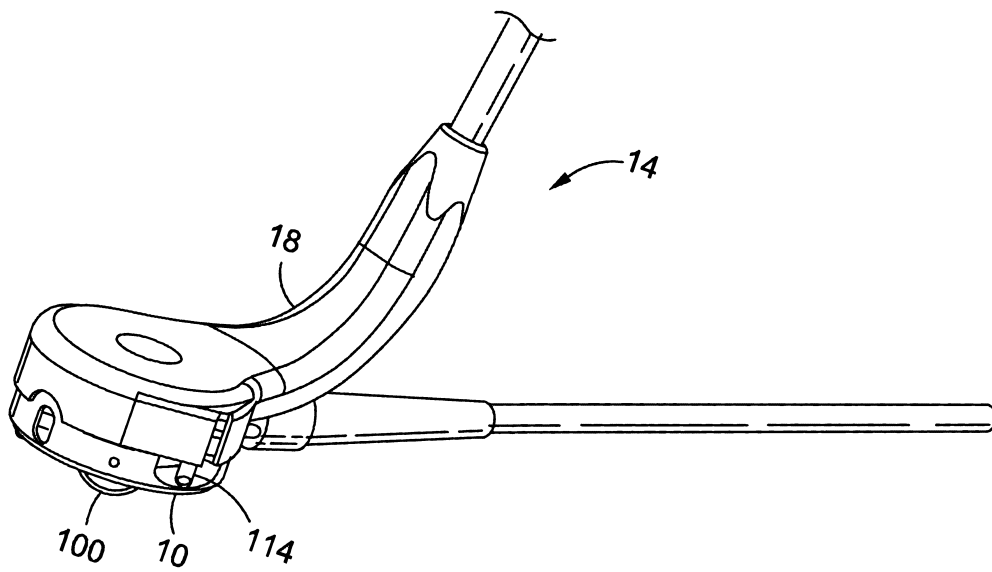
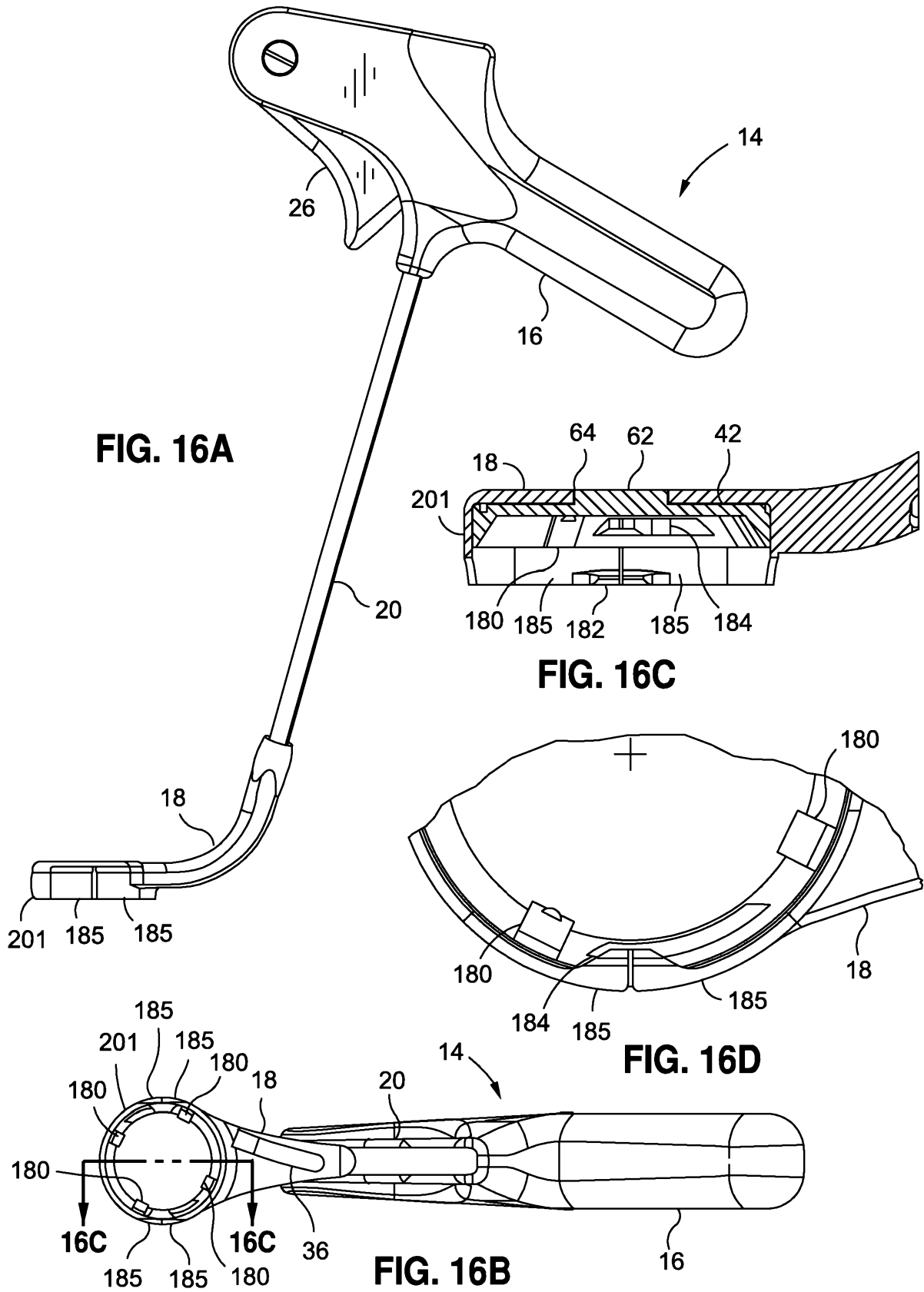
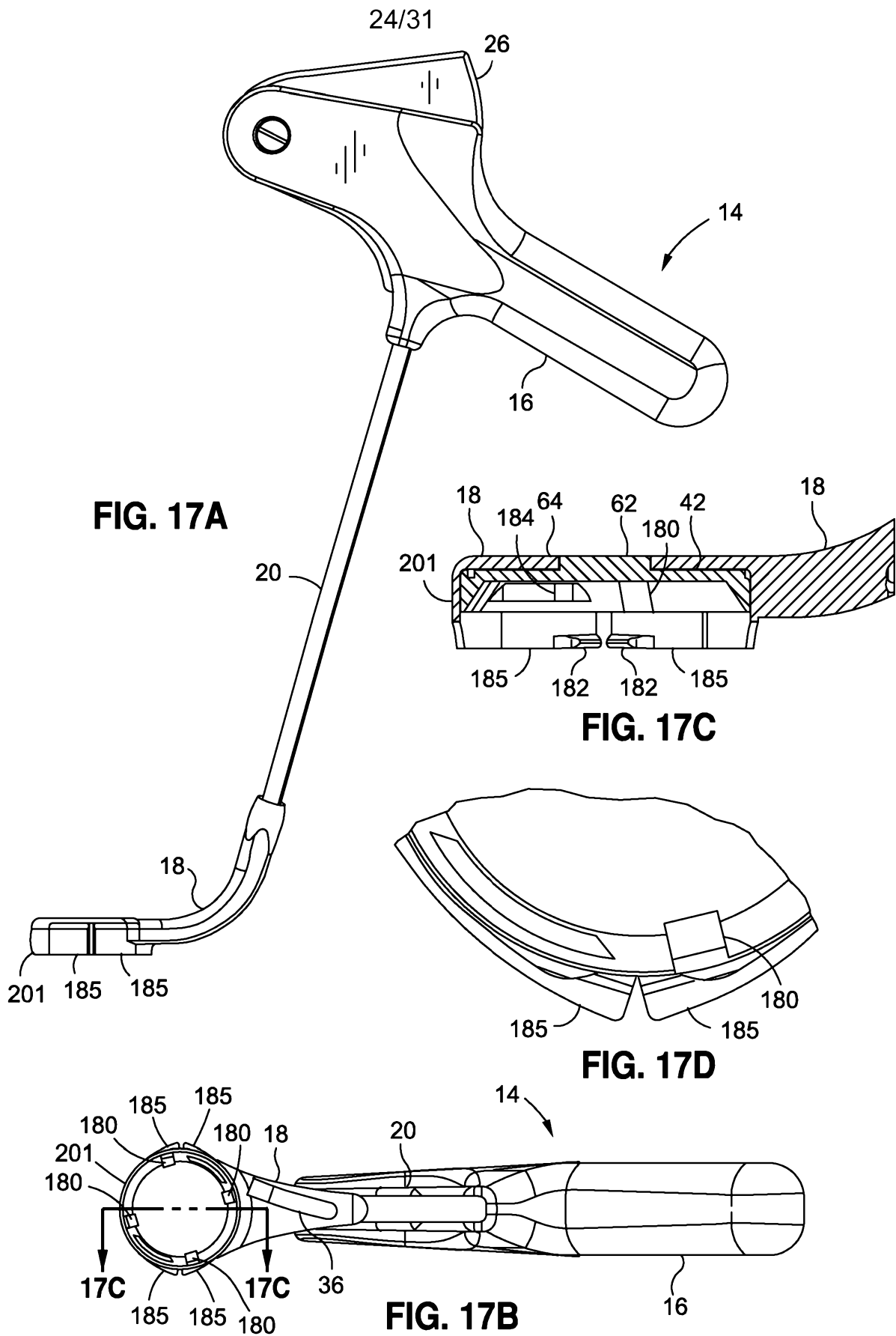
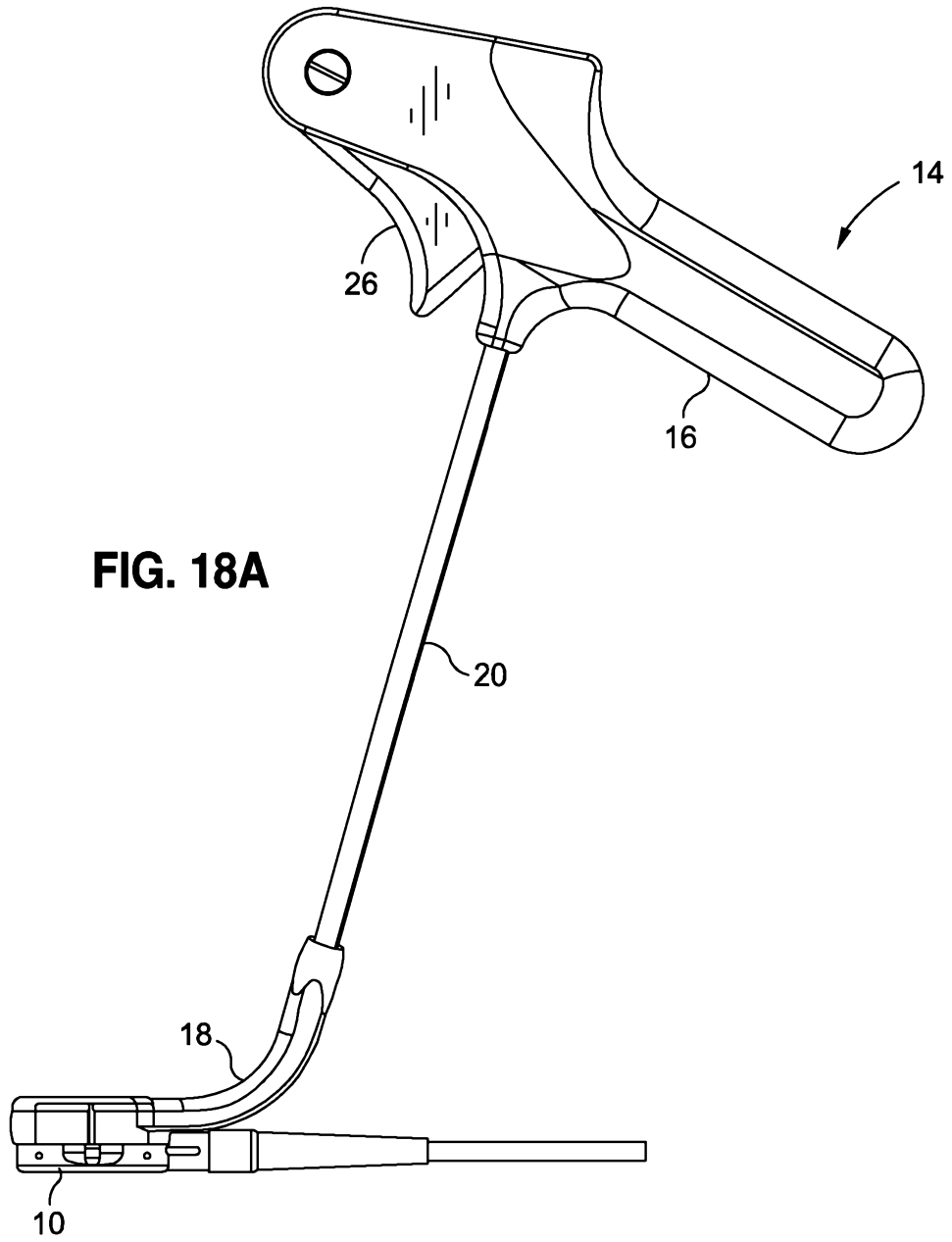


FIG. 15B

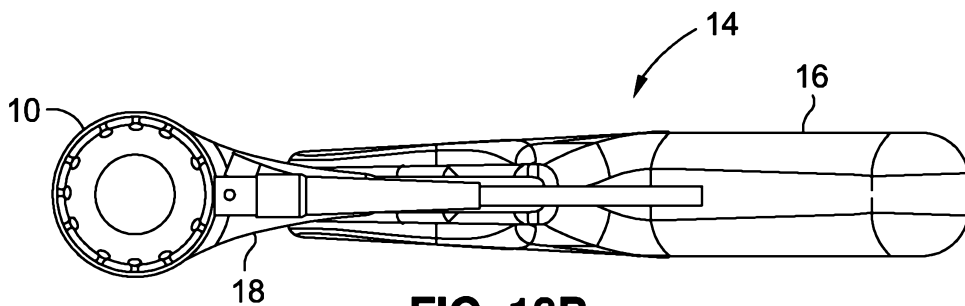




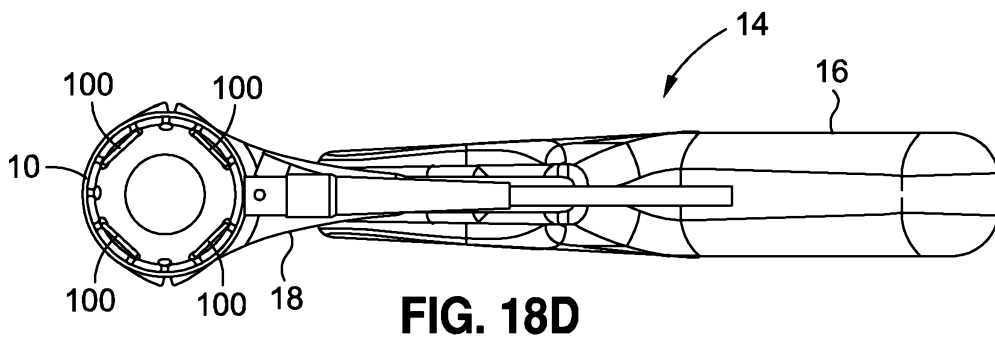
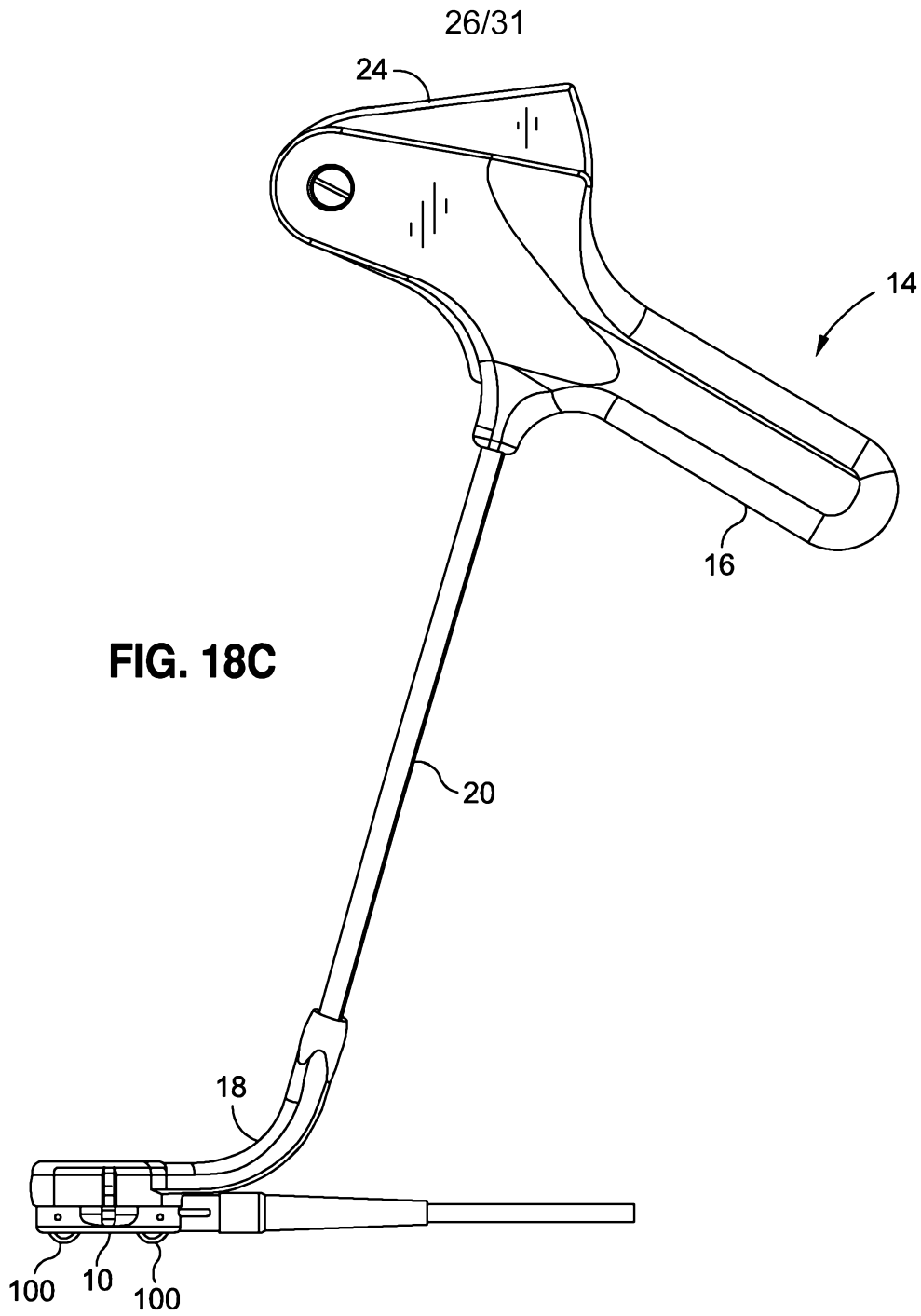
25/31

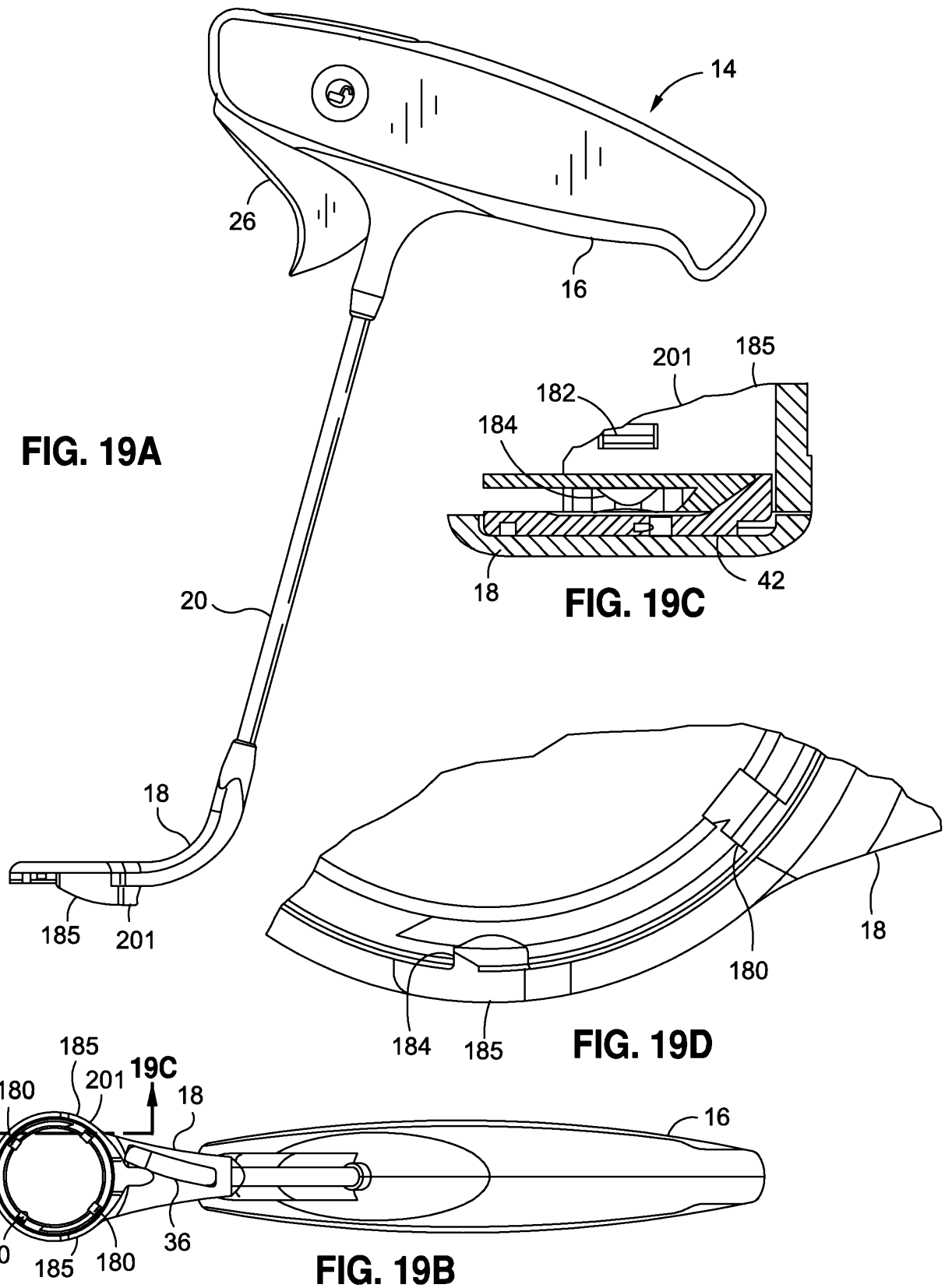


**FIG. 18A**



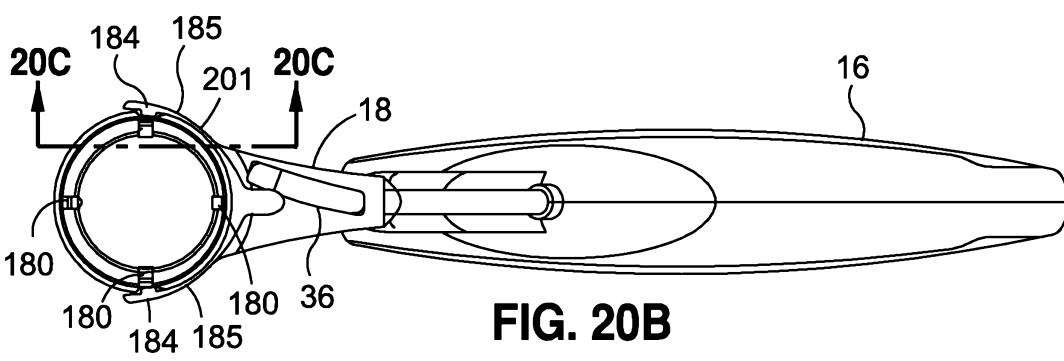
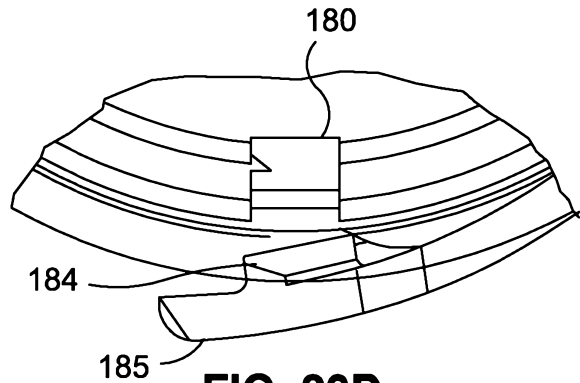
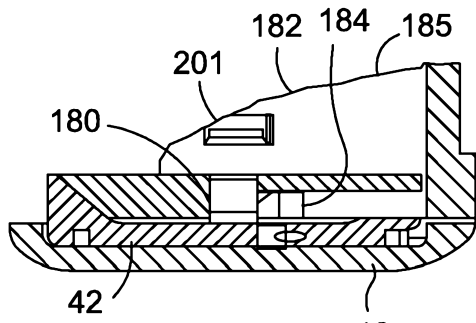
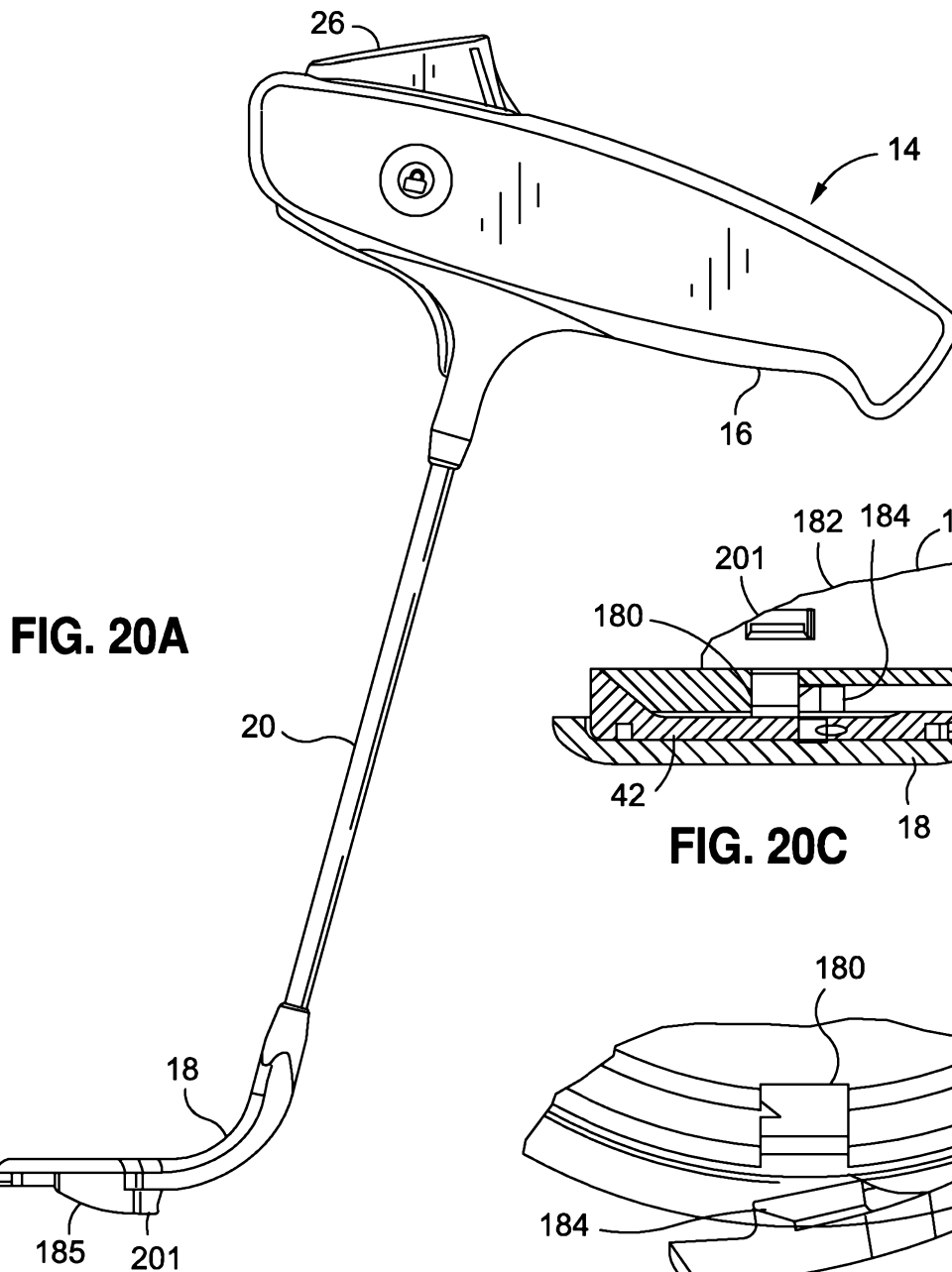
**FIG. 18B**







28/31



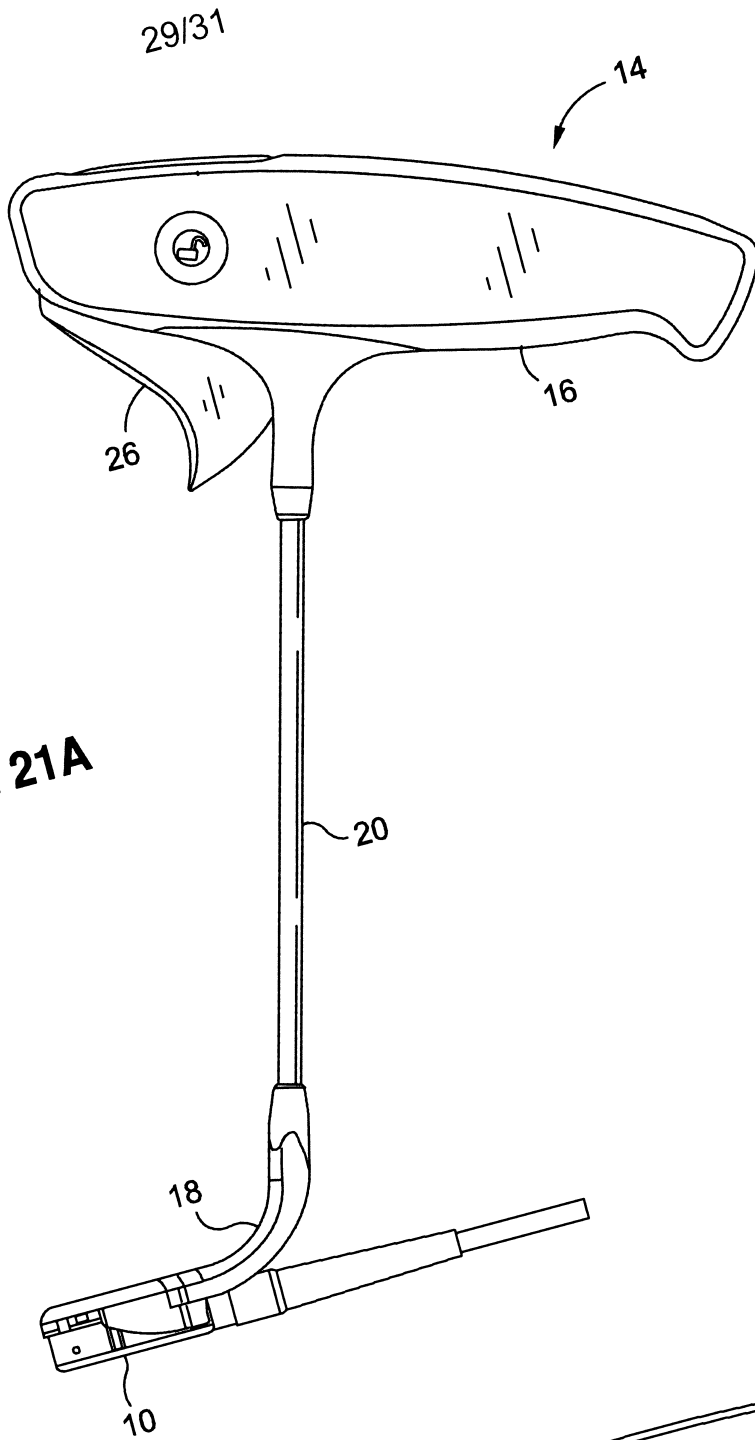


FIG. 21A

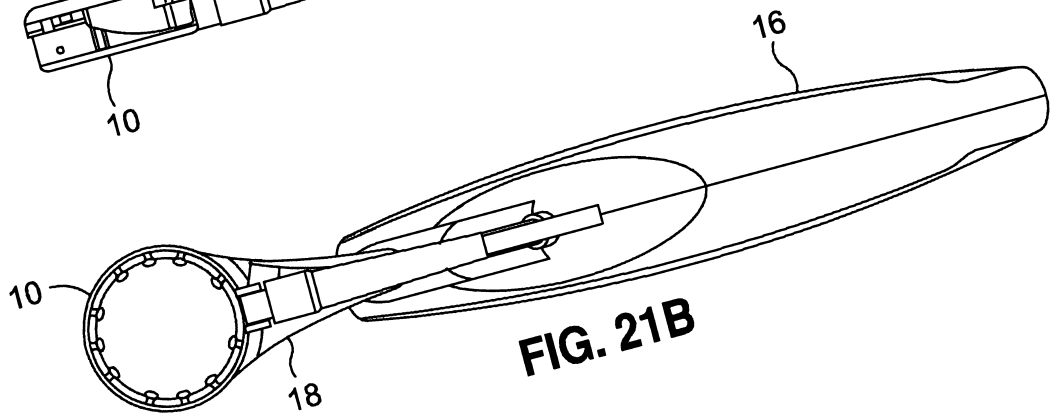
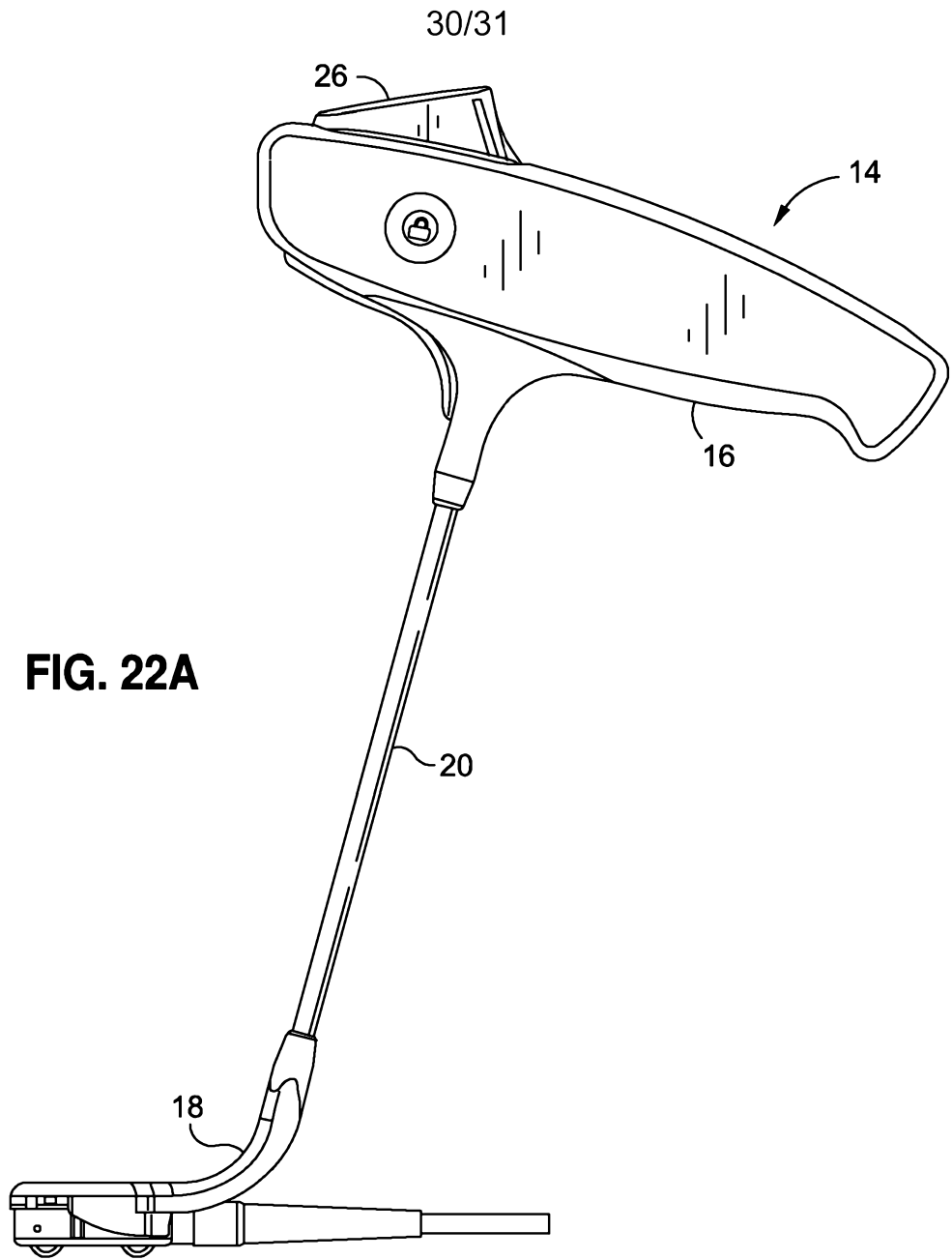
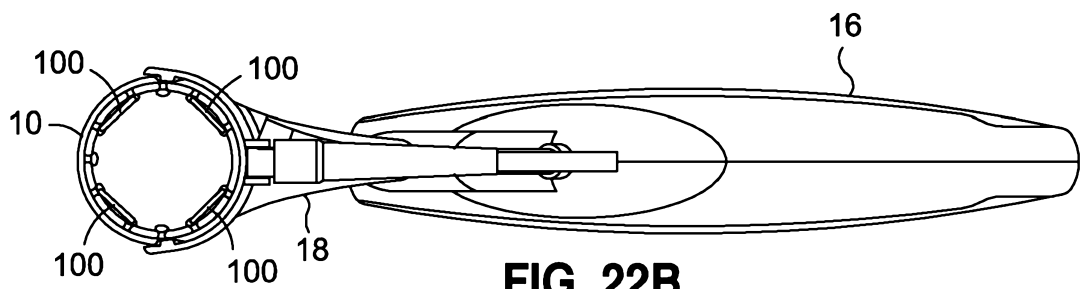


FIG. 21B

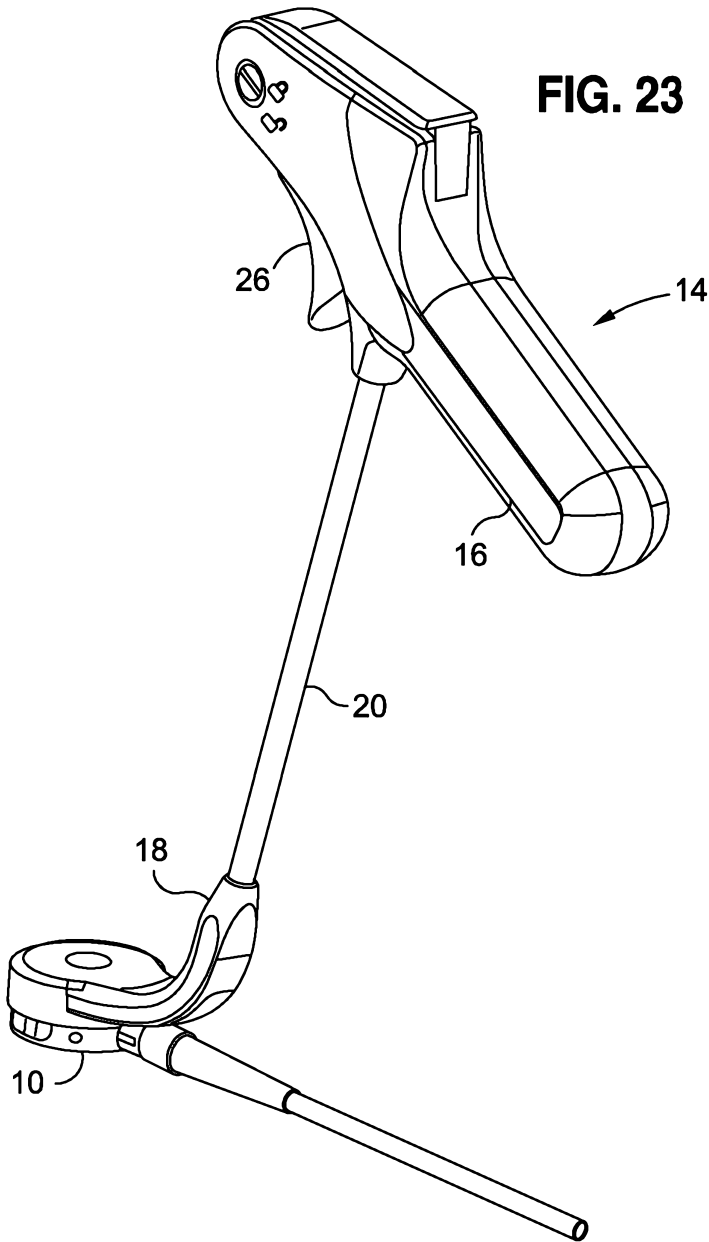


**FIG. 22A**



**FIG. 22B**

**FIG. 23**



**FIG. 24**

