

(19) World Intellectual Property Organization
International Bureau



(43) International Publication Date
2 October 2008 (02.10.2008)

PCT

(10) International Publication Number
WO 2008/118719 A1

(51) International Patent Classification:
A61B 1/267 (2006.01) A61B 1/273 (2006.01)

80138 (US). JUTTE, Leroy, D. [US/US]; 1226 W. Bri-arhollow Way, Highlands Ranch, Colorado 80129 (US).

(21) International Application Number:
PCT/US2008/057549

(74) Agent: TABOADA, Alan; 1030 Broad Street, 2nd Floor, Shrewsbury, New Jersey 07702 (US).

(22) International Filing Date: 19 March 2008 (19.03.2008)

(81) Designated States (unless otherwise indicated, for every kind of national protection available): AE, AG, AL, AM, AO, AT, AU, AZ, BA, BB, BG, BH, BR, BW, BY, BZ, CA, CH, CN, CO, CR, CU, CZ, DE, DK, DM, DO, DZ, EC, EE, EG, ES, FI, GB, GD, GE, GH, GM, GT, HN, HR, HU, ID, IL, IN, IS, JP, KE, KG, KM, KN, KP, KR, KZ, LA, LC, LK, LR, LS, LT, LU, LY, MA, MD, ME, MG, MK, MN, MW, MX, MY, MZ, NA, NG, NI, NO, NZ, OM, PG, PH, PL, PT, RO, RS, RU, SC, SD, SE, SG, SK, SL, SM, SV, SY, TJ, TM, TN, TR, TT, TZ, UA, UG, US, UZ, VC, VN, ZA, ZM, ZW.

(25) Filing Language: English

(26) Publication Language: English

(30) Priority Data:
11/726,689 22 March 2007 (22.03.2007) US

(71) Applicant (for all designated States except US): VITAL SIGNS, INC. [US/US]; 20 Campus Road, Totowa, New Jersey 07512 (US).

(84) Designated States (unless otherwise indicated, for every kind of regional protection available): ARIPO (BW, GH, GM, KE, LS, MW, MZ, NA, SD, SL, SZ, TZ, UG, ZM, ZW), Eurasian (AM, AZ, BY, KG, KZ, MD, RU, TJ, TM),

(72) Inventors; and

(75) Inventors/Applicants (for US only): GEIST, Leroy, D. [US/US]; 11487 South Regency Place, Parker, Colorado

[Continued on next page]

(54) Title: LARYNGOSCOPE BLADE

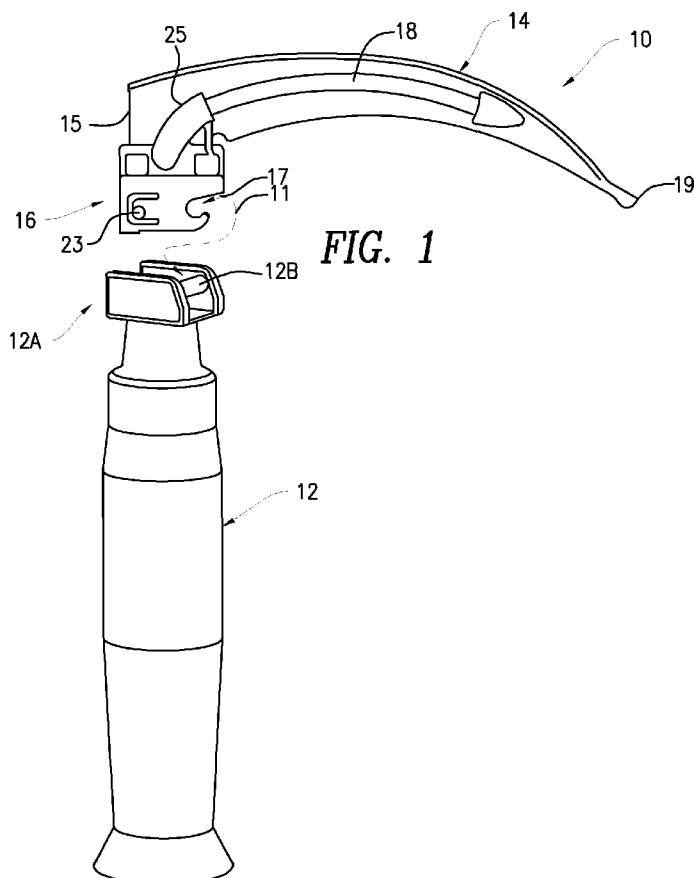

(57) Abstract: A laryngoscope blade comprising a blade portion, a base portion and an optic light pipe, the blade portion including a proximal end and a distal end provided with an optic window, the base portion including two base halves mounted to each other and to the proximal end of the blade portion, one of the base halves providing a resilient cantilever latch pin and the other of the base halves providing a rigid hook, the light pipe including a proximal end mounted between the two base halves and a distal end extending through the optic window.

WO 2008/118719 A1



European (AT, BE, BG, CH, CY, CZ, DE, DK, EE, ES, FI, FR, GB, GR, HR, HU, IE, IS, IT, LT, LU, LV, MC, MT, NL, NO, PL, PT, RO, SE, SI, SK, TR), OAPI (BF, BJ, CF, CG, CI, CM, GA, GN, GQ, GW, ML, MR, NE, SN, TD, TG).

— *before the expiration of the time limit for amending the claims and to be republished in the event of receipt of amendments*

Published:

— *with international search report*

LARYNGOSCOPE BLADE

BACKGROUND OF THE INVENTION

This invention relates generally to a laryngoscope blade and more particularly relates to a disposable laryngoscope blade particularly useful with laryngoscope handles commonly referred to as Fiber Illuminated System or Green System Handles. More particularly, this invention relates to a disposable laryngoscope blade of a reduced number of component parts with attendant reduced assembly and manufacturing costs.

Laryngoscope blades are known to the art for examining and visualizing a patient's upper airway and for aiding in placement of an endotracheal tube during intubations. For example, an endotracheal tube is inserted into a patient's trachea to supply oxygen to the patient during a surgical procedure. Generally, a patient's trachea, or wind pipe, is covered by the tongue and the epiglottis which is attached to the base of the tongue at the back of the patient's mouth. For access to the trachea and insertion of the endotracheal tube, the tongue and epiglottis must be lifted to expose the trachea for endotracheal tube insertion. The typical laryngoscope used for this procedure includes a laryngoscope blade mounted to a laryngoscope handle. The laryngoscope blade is inserted under the patient's tongue and upon appropriate movement of the laryngoscope handle the laryngoscope blade lifts the patient's tongue and epiglottis exposing the trachea. Further typically, the laryngoscope blade is provided with an inclined slot which mounts to a hinge pin provided at the upper end of the laryngoscope handle and about which hinge pin the laryngoscope blade pivots to latch into an operating position at the upper end of the laryngoscope handle. As the laryngoscope blade pivots into the operating position, and is locked therein by suitable detents, the laryngoscope blade engages a switch member which closes an energization circuit in the laryngoscope handle causing a light source in the handle to emit light which is transmitted to and through an optic light pipe mounted on the laryngoscope blade to provide light to the end of the laryngoscope blade and to illuminate a patient's exposed trachea to facilitate visualization and insertion of the endotracheal tube into the trachea.

A laryngoscope blade of the type noted above is disclosed in the United States patent no. 7,128,710 B1, patented October 31, 2006, entitled DISPOSABLE LARYNGOSCOPE BLADES, George D. Cranton, et al., inventors; this patent is hereby incorporated herein by reference as if fully reproduced herein. The disclosed laryngoscope blade, as will be noted from FIGS. 1-3 of this patent includes nine separate parts, namely, the blade 26, the heel portion 28, the light rod 34, ball poppets 46, 48 and 42 each of which poppet includes a ball and a springs for a total of the nine component parts. These component parts, particularly the poppets including the balls and springs, require considerable manual labor assembly with attendant unwanted assembly costs and expense.

Accordingly, there is a need in the art for a new and improved laryngoscope blade.

Further, there is a need in the art for a laryngoscope blade of a reduced number of parts and with attendant reduced assembly manufacturing costs which permit the blade to be made and sold at a price attractive and reasonable for a single use or disposable blade.

SUMMARY OF THE INVENTION

It is the object of the present invention to satisfy the foregoing needs in the laryngoscope blade art.

A laryngoscope blade satisfying such need and embodying the present invention may include a laryngoscope blade comprising a blade portion, a base portion and an optic light pipe, the blade portion including a proximal end and a distal end provided with an optic window, the base portion including two base halves mounted to each other and to the proximal end of the blade portion, one of the base halves providing a resilient cantilever latch pin and the other of the base halves providing a rigid hook, the light pipe including a proximal end mounted between the two base halves and a distal end extending through the optic window.

DETAILED DESCRIPTION OF THE DRAWINGS

FIG. 1 shows a laryngoscope blade embodying the present invention for removable mounting to a laryngoscope handle;

FIG. 1A is a top view of the laryngoscope handle of FIG. 1;

FIG. 1B is a diagrammatical illustration of the upper end of the laryngoscope handle of FIG. 1, with portions being broken away, to illustrate opposed locking slots or detents to assist in locking the laryngoscope blade into the operating or on position at the upper end of the laryngoscope handle;

FIG. 2 is an exploded view of the laryngoscope blade of FIG. 1;

FIG. 2A is a separate view of the optic light pipe shown in FIG. 1;

FIG. 3 is a view of the outside surface of one base half comprising the base portion of the laryngoscope blade of the present invention;

FIG. 4 is a view of the left edge of the base half of FIG. 3;

FIG. 5 is a rear view of the inner surface of the base half of FIG. 3;

FIG. 6 is a perspective view taken from FIG. 5;

FIG. 7 is a perspective view taken from FIG. 7;

FIG. 8 is a view of the outer surface of the other base half comprising the base portion of the laryngoscope blade of the present invention;

FIG. 9 is a view of the inner surface of the base half shown of FIG. 8;

FIG. 10 is a perspective view taken from FIG. 9;

FIG. 11 is a separate view of the laryngoscope blade shown in FIG. 1;

FIG. 12 is a rear view of FIG. 11;

FIG. 13 is a separate view of the blade portion of the laryngoscope blade of the present invention;

FIG. 14 is a rear perspective view of the blade portion shown in FIG. 13;

FIG. 15 is a perspective view taken from FIG. 13;

FIG. 16 is a view illustrating the force or load on the laryngoscope blade of the present invention during the lifting of a person's tongue and epiglottis;

FIG. 16 A is an enlarged view of the encircled portion of FIG. 16;

FIG. 17 is a side view of the upper portion of the laryngoscope handle with portions broken away to show the diameter of the hinge pin;

FIG. 18 is the base half of FIG. 8 reproduced to show the width of the inclined slot provided by the resilient cantilever latch pin; and

FIG. 19 is the base half of FIG. 3 reproduced to show the width of the inclined slot provided by the rigid hook.

DESCRIPTION OF THE PREFERRED EMBODIMENT

An embodiment of the laryngoscope blade of the present invention is shown in FIG. 1 and indicated by general numerical designation 10, and as indicated by the irregular line 11, is for being mounted removably to the laryngoscope handle indicated by general numerical designation 12 in FIG. 1. The laryngoscope blade 10 includes a blade portion indicated by general numerical designation 14, a base portion indicated by general numerical designation 16 and an optic light pipe 18. The laryngoscope handle 12 may be any suitable laryngoscope handle known to the art and may be, for example, a laryngoscope handle of the type commonly referred to as Fiber Illuminated System or Green System Handles and, by way of further example, may be the laryngoscope handle available from Vital Signs, Inc., 20 Campus Road, Totowa, New Jersey, and sold under the trademark Greenlight II. Solely for purposes of illustration of the use of the laryngoscope blade 10 of the present invention, it will be assumed that the laryngoscope handle 12 of FIG. 1 is the Greenlight II laryngoscope handle, model number 4558GSP, available from Vital Signs, Inc. Accordingly, it will be understood that the laryngoscope handle 12 includes an upper end 12A including a hinge pin 12B and a depressible cylindrical switch element 12C, note FIG. 1A. Referring further to FIG. 1, the laryngoscope blade 10 is mounted removably, as described in detail below, to the handle 12 by hooking or latching the laryngoscope blade base 16 to the hinge pin 12 which is received within the inclined opening 17 provided in the base 16. Upon the hinge pin 12B being received within the inclined opening 17 the laryngoscope blade 10 is pivoted into engagement with the upper end 12A of the laryngoscope handle 12 and locked into the operating or on position by engagement of the resilient ball detent 23 provided on the base portion 16 with the locking slot or detent 12F (FIG. 1B) provided at the upper end 12A of the handle 12. Generally, as the laryngoscope blade 10 is pivoted about the hinge pin 12B into the operating position, the base 16 of the laryngoscope blade 10 engages and depresses the circular depressible switch element 12C which then closes an energization

circuit (not shown) in the handle 12 to illuminate a light source (not shown) in the handle which emits light which is transmitted through the circular switch element 12C and to and through the optic light pipe 18 to the distal end 19 of the laryngoscope blade to illuminate the opening to a patient's trachea.

5 Referring further generally to the laryngoscope blade 10 shown in FIGS. 1 and 2, the blade portion 14 is made or formed from a suitable blank of 304 stainless steel using progressive dies of the type known to the art for stainless steel forming. The base portion 16, FIG. 1, is comprised of two base halves as shown in FIG. 2, one base half is indicated by general numerical designation 20 and the other base half is indicated by general
10 numerical designation 30. The base halves are made of ultrasonically weldable material and are ultrasonically welded together by suitable ultrasonic welding apparatus to mount the base halves to each other and to the proximal end 15, FIG. 1, of the blade portion 14. Further generally, it will be understood that in accordance to the present invention, the base half 20 is made of a more rigid material than the material of which the base half 30
15 is made and conversely, that the base half 30 is made of a more resilient material than the material of which the base half 20 is made. In the preferred embodiment, the base half 20 was made of relatively rigid glass-filled or glass reinforced nylon and the base half 30 was made of relatively resilient un-reinforced nylon; these materials are known ultrasonically weldable materials.

20 Referring to FIGS. 3-7, and to the detailed structure of the base half 20, the base half 20, made of such glass-filled nylon, includes a rigid hook 21 providing an inclined opening 22, a cantilever ball detent 23 surrounded by a generally U-shaped opening 24 extending through the base half 20, and a curved optic cover 25. Referring to FIG. 5, and to the inner surface of the base half 20, the base half 20 is provided with inwardly
25 extending alignment sockets 27a and 27b, inwardly extending tang sockets 28a and 28b, inwardly extending weld sockets 29a and 29b and an inwardly extending contoured optic channel 20a.

Referring to the detailed structure of the base half 30, and to FIGS. 8-10, the base half 30, made of such un-reinforced nylon, includes a resilient cantilever latch pin 31
30 providing an inclined opening 32 and, as shown in FIGS. 9 and 10, the inner surface of

the base half 30 is provided with a pair of outwardly extending alignment and weld pins 33a and 33b, outwardly extending weld ribs 34a and 34b and an outwardly extending member 36 providing an inwardly extending semi-circular straight optic channel 38.

5 The blade portion 14 of the laryngoscope blade 10 is shown in detail in FIGS. 12-15 with FIG. 11 being the same showing of the laryngoscope blade 10 of the present invention shown at the top of FIG. 1 but shown again for convenience of reference. Referring specifically to FIGS. 12-15, the metal blade portion 14 includes a medial wall 40 in which an optic window 41 is formed and in which a pair of blade portion attachment thru holes 42a and 42b are formed. The proximal end 15 of the metal
10 blade portion 14 is provided with a pair of perpendicularly, outwardly extending mode distribution and mounting tangs 43a and 43b. As best shown in FIG. 15, the metal blade portion 14 includes a flange 44 extending outwardly perpendicularly from the medial portion 40 and which provides the distal end 19 of the laryngoscope blade 10 and which, as will be understood from FIG. 15, provides a tongue engagement surface 45 which
15 provides the distal end 19 of the laryngoscope blade 10 of FIG. 1. It will be further understood from FIG. 15, that the distal portion of the flange 44 is spoon-shaped to reduce the possibility of trauma to the patient's oral cavity from the intubation process upon the laryngoscope blade 10 of the present invention being utilized to insert an endotracheal tube into a patient's trachea.

20 Referring to FIG. 2A, the optic light pipe 18 includes a contoured proximal portion 50 which includes a straight proximal end portion 52 and a curved distally adjacent portion 54. The contoured optic channel 20a, FIG. 5, formed in the base half 20 is complimentary in shape to and for receiving the outer side, as viewed in FIG. 2, of the contoured proximal end portion 50 of the optic light pipe 18. Similarly, the straight optic
25 channel 38, FIG. 10, of the base at 30, is complimentary in shape to and for receiving the inner side, as viewed in FIG. 2, of the straight proximal end section 52 of the optic light pipe 18.

In assembly, and prior to ultrasonic welding, and referring primarily to FIG. 2, the outer side of the contoured proximal portion 50 (FIG. 2A) of the light pipe 18 is inserted
30 into the contoured optic channel 20a (FIG. 5) of the base half 20, the distal end 55 of the

optic light pipe 18 is inserted through the optic window 41 formed in the blade portion 14 and the tangs 43a and 43b of the blade portion 14 are inserted into the tang sockets 28a and 28b (FIG. 5) provided in the base half 20, the alignment and ultrasonic weld pins 33a and 33b provided on the base half 30 are inserted through the thru holes 42a and 42b
5 formed in the proximal end 15 of the blade portion 15 and into the weld sockets 27a and 27b (FIG. 5) formed in the base half 30, and the weld ribs 34a and 34b formed on the base half 30 are inserted on to the weld sockets 29a and 29b (FIG. 5) formed in the base half 20. In this process the inner half, as viewed in FIG. 2, of the straight distal end 52 (FIG. 2A) of the optic light pipe 18 is received in the straight optic channel 38 formed in
10 the base half 30. Thereafter, the base halves 20 and 30 are ultrasonically welded to each other thereby mounting the base half to each other and to the distal end 15 of the metal blade portion 14 which is captured between the ultrasonically welded base halves. Insertion of the alignment and weld pins 33a and 33b formed on the base half 30 into the weld sockets 27a and 27b formed in the base half 20, and the insertion of the weld ribs
15 34a and 34b formed on the base half 30 into the weld sockets 29a and 29b formed in the base half 20, align the base halves and the distal end of the blade portion 14 with respect to each other and facilitate ultrasonic welding together of the base halves.

From FIGS. 1, 2 and 11, it will be understood that the curved optic cover 25 of the base half 20 covers the proximal end of the optic light pipe 18 on three sides, the outer
20 three sides as viewed in FIG. 2, and that the medial wall 40 of the blade portion 14 covers the fourth or inner side, as viewed in FIG. 2, of the proximal end of the optic light pipe and hence upon light being transmitted through the optic light pipe 18 to its distal end 55 to illuminate a patient's trachea, the coverage of the distal end of the optic light pipe 18 by the optic cover 25 and the medial wall 40 of the blade portion prevents light from
25 entering, and possibly at least partially blinding, the eyes of the laryngoscope blade 10 user during the patient intubation process.

Referring again to FIG. 1 and to the removable mounting of the laryngoscope blade 10 to the upper end 12a of the laryngoscope handle 12, it will be understood that it is the resilient cantilever latch pin 31, FIGS. 8-10, that wedgedly engages and removably
30 mounts the laryngoscope blade 10 to the hinge pin 12b and thereby to the laryngoscope

handle 12 while still permitting pivoting movement therebetween, and that it is the rigid hook 21, FIGS. 3-7, of the base half 20 that loosely engages the hinge pin 12b and withstands the load or force applied to the laryngoscope blade 10 when it engages and lifts up the tongue and epiglottis of a patient to expose the patient's trachea for intubation

5 More particularly, and referring to FIGS. 17-19, the diameter of the hinge pin 12B at the upper end of the handle 12 (FIG. 17) is 4.5 mm, and in the preferred embodiment for the resilient cantilever latch pin 31 (FIG. 18) to wedgedly and removably mount the laryngoscope blade 10 to the handle 12, the width W1 of the inclined slot 32 provided by the resilient cantilever latch pin 31 is 4.0 mm, 0.5 mm smaller than the diameter of the

10 hinge pin 12B, and as shown in FIG. 19, the width W2 of the inclined slot 22 provided by the rigid hook 21 is 4.7 mm, 0.2 mm larger than the diameter of the hinge pin 12B, which difference causes the rigid hook 21 to loosely engage the hinge pin 12B so as not to inhibit pivoting movement between the blade 10 and handle 12 and yet permit the rigid hook 21 to engage the hinge pin 12B and withstand the force and load noted above.

15 With further regard to the above-noted load and force exerted on the laryngoscope blade 10 during use, this loading and force is illustrated in FIGS. 16 and 16A. For insertion of an endotracheal tube (not shown) into the trachea of the patient, the laryngoscope blade 10 (FIG. 16) is inserted under the patient's tongue with the distal end 19 engaging the angled area at which the epiglottis is formed at the back of the tongue, and upon the

20 laryngoscope user, such as a physician, rotating the laryngoscope handle 12 in the direction indicated by the curved arrow 60, the laryngoscope blade 10 lifts the tongue and epiglottis of the patient to expose the trachea for the intubation process. In this tongue and epiglottis lifting procedure, the tongue exerts a force, a reaction force, F1 on the laryngoscope blade 10 and a force, a reaction force F2 (better seen in FIG. 16A) is

25 applied to the base 16 of the laryngoscope blade 10. It will be understood that it is the rigid hook 21 formed on the base half 20 that withstands the forces F1 and F2 and withstands the load applied to the laryngoscope blade 10 by such forces.

It will be understood that the foregoing description of the preferred embodiment of the present invention is merely illustrative thereof and that many variations and

modifications may be made in the present invention without departing from the spirit and scope thereof.

WHAT IS CLAIMED IS:

1. A laryngoscope blade comprising a blade portion, a base portion and an optic light pipe, said blade portion including a proximal end and a distal end provided with an optic window, said base portion including two base halves mounted to each other
5 and to said proximal end of said blade portion, one of said base halves providing a resilient cantilever latch pin and the other of said base halves providing a rigid hook, and said light pipe including a proximal end mounted between said two base halves and a distal end extending through said optic window.
2. The laryngoscope blade according to claim 1 wherein said other base half
10 is provided with a cantilever ball detent.
3. The laryngoscope blade according to claim 1 wherein said one base half is made of a material that is more rigid than the material of which said other base half is made.
4. The laryngoscope blade according to claim 1 wherein said base halves are
15 made of ultrasonically weldable material and wherein said base halves are ultrasonically welded together.
5. The laryngoscope blade according to claim 4 wherein said one base half is made of un-reinforced nylon and wherein said other base half is made of glass-filled nylon.
- 20 6. The laryngoscope blade according to claim 4 wherein said one base half includes an inner surface provided with a plurality of outwardly extending weld pins, wherein said proximal end of said blade portion is provided with a plurality of thru holes, wherein said other base half includes an inner surface provided with a plurality of inwardly extending alignment sockets and wherein said plurality of outward extending
25 alignment pins extend through said plurality of thru holes and into said plurality of alignment sockets to align said base halves and said proximal end of said blade portion with respect to each other.

7. The laryngoscope blade according to claim 4 wherein said inner surface of said one base half is provided with a plurality of outwardly extending weld ribs, wherein said inner surface of said other base half is provided with a plurality of inwardly extending weld cavities and wherein said outwardly extending weld ribs are inserted into
5 said inwardly extending weld cavities to enhance the ultrasonic welding of said base halves.

8. The laryngoscope blade according to claim 6 wherein said proximal end of said blade portion is provided with a plurality of outwardly extending tangs, wherein said inner surface of said other base half is provided with a plurality of inwardly extending
10 alignment sockets for receiving said plurality of outwardly extending tangs to further align said proximal end of said blade portion with said other base half.

9. The laryngoscope blade according to claim 8 wherein said proximal end of said light pipe is a contoured proximal end including a straight proximal end portion and a curved distally adjacent portion, wherein said inner surface of said one half is provided
15 with an outwardly extending member providing a semicircular inwardly extending straight optical channel for receiving one side of said straight proximal end of said optic light pipe and wherein said outer surface of said other base half is provided with an inwardly extending contoured optical channel for receiving the other side of said straight proximal end portion and one side of said curved distally adjacent portion of said
20 contoured portion of the proximal end of said optic light pipe.

10. The laryngoscope blade according to claim 9 wherein said outer surface of said other base half is provided with an outwardly extending curved optic cover for covering a portion of said proximal end of said optic light pipe.

11. The laryngoscope blade according to claim 1 wherein said distal end of
25 said blade portion includes a spoon-shaped tip.

12. The laryngoscope blade of claim 1, the laryngoscope blade for lifting the tongue and epiglottis of a person and for being mounted removably to the upper end of a laryngoscope handle including a hinge pin and an inwardly extending locking slot, wherein:

5 said two base halves of said base portion include a first base half and a second base half mounted to each other and to said proximal end of said blade portion, said first half being of a material sufficiently resilient to provide a resilient cantilever latch pin for wedgedly and removably engaging the hinge pin and for permitting pivoting between said laryngoscope blade and the laryngoscope handle, said second base half being of a
10 sufficiently rigid material to provide a rigid hook for loosely engaging said hinge pin and for withstanding load exerted on said laryngoscope blade during the lifting of the person's tongue and epiglottis, and said second base half provided with a cantilever ball detent for wedgedly engaging the locking slot to lock said laryngoscope blade to the upper end of the laryngoscope handle; and

15 wherein said proximal end of said optic light pipe is mounted between said first and said second half of said base portion.

13. The laryngoscope blade of claim 1, the laryngoscope blade for being mounted removably to the upper end of a laryngoscope handle including a hinge pin and
20 an inwardly extending locking slot, said laryngoscope blade for being mounted to and pivoting around the hinge pin and into engagement with a depressible member provided at the upper end of the laryngoscope handle to close an energization circuit for a light source which emits light, said laryngoscope blade having force applied thereto upon pivoting of the laryngoscope handle to lift the tongue and epiglottis of a person to expose
25 the person's trachea for insertion of an endotracheal tube, wherein:

 said two base halves of said base portion include a first base half and a second base half mounted to each other and to said proximal end of said blade portion, said first blade half being of a resilient material to provide a resilient cantilever latch pin for wedgedly engaging the hinge pin to mount said laryngoscope blade removably and
30 pivotably to the hinge pin, said second base half being of a sufficiently rigid material to

provide a rigid hook providing an inclined slot for receiving and loosely engaging the hinge pin, said rigid hook for withstanding the force applied to said laryngoscope blade upon lifting a person's tongue and epiglottis, said second base half providing a cantilever ball detent for wedgedly engaging the locking slot to latch said laryngoscope blade in the on position at the upper end of the laryngoscope handle; and

5 wherein said proximal end of the optic light pipe is mounted between said first base half and said second base half and a distal end extending through said optic window.

1/8

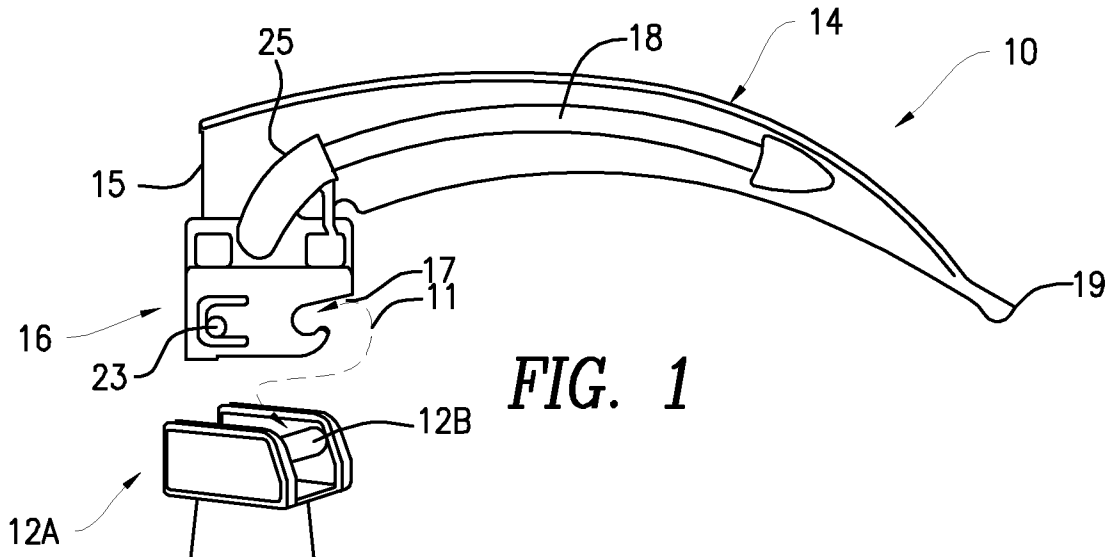

FIG. 1

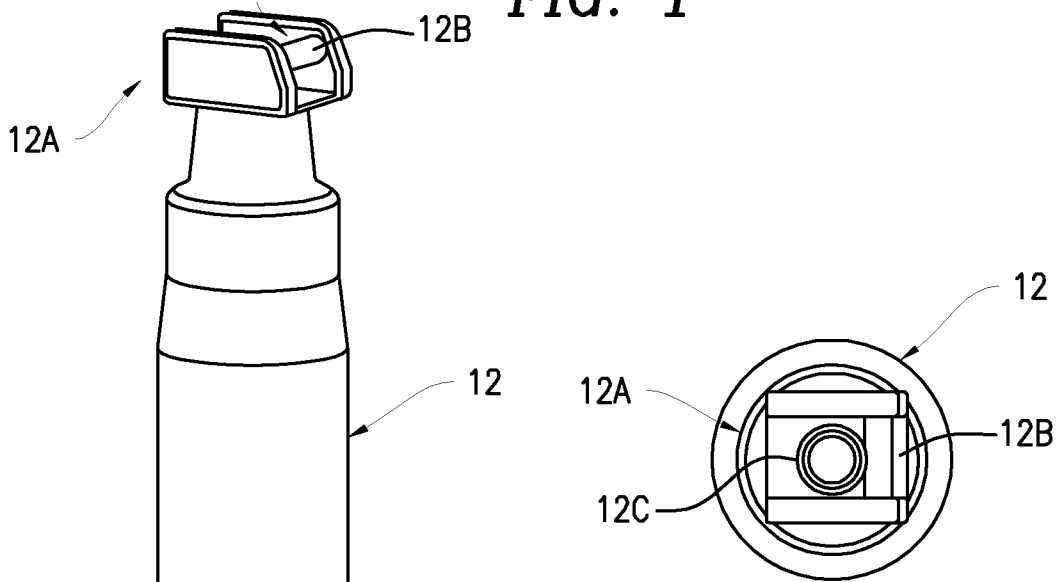

FIG. 1A

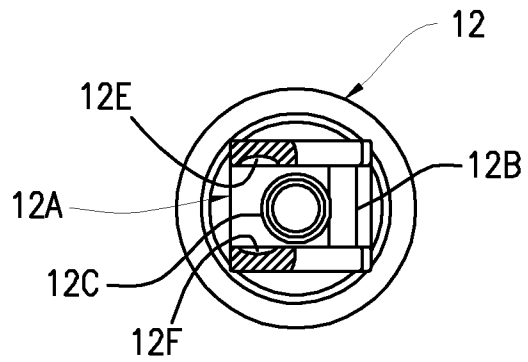

FIG. 1B

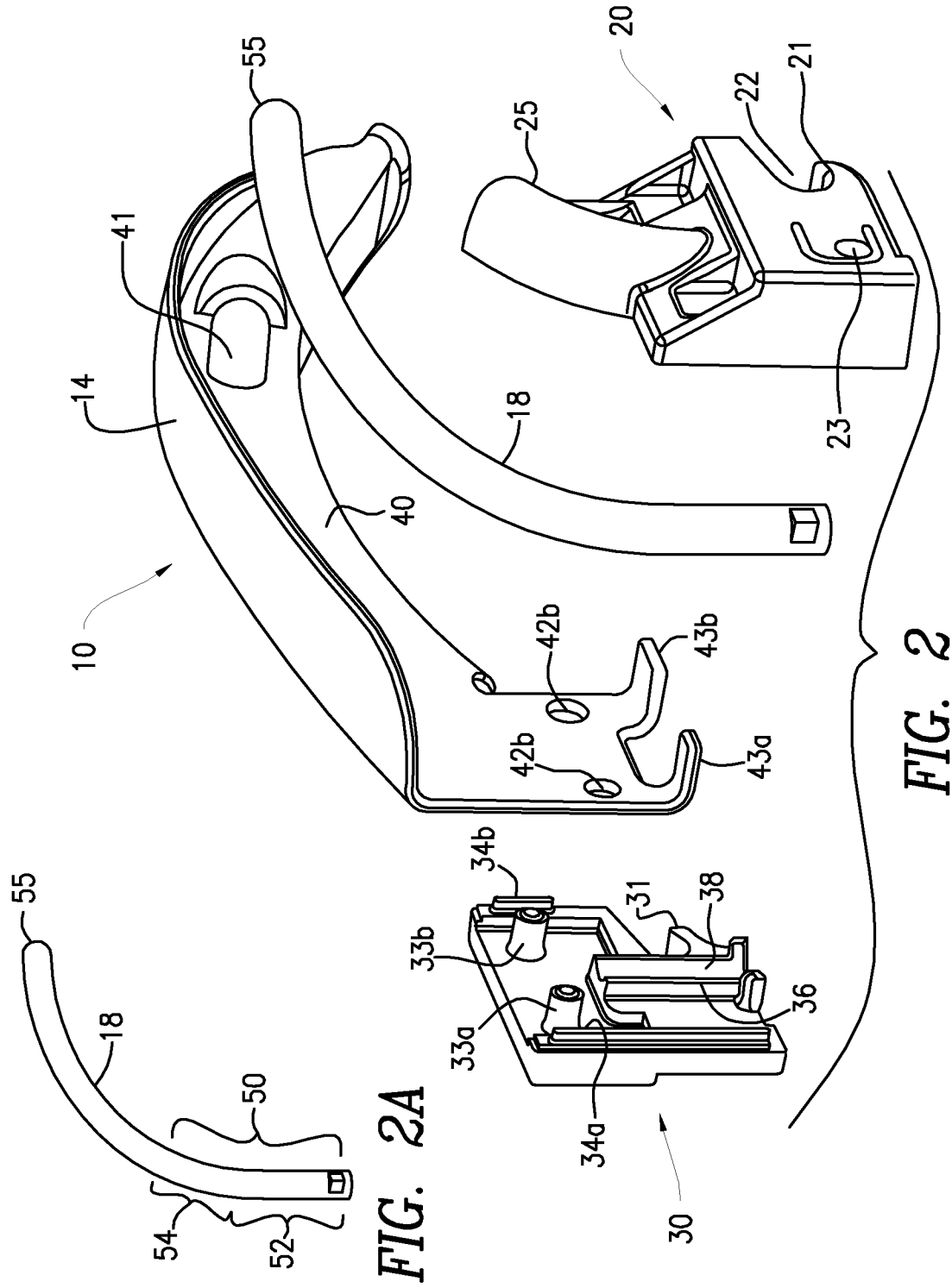

FIG. 2A

FIG. 2

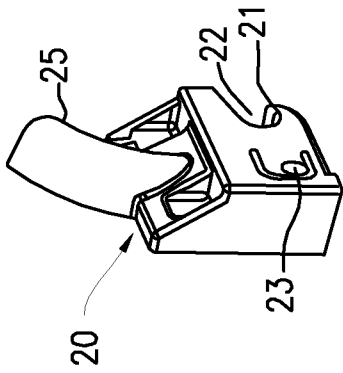

FIG. 7

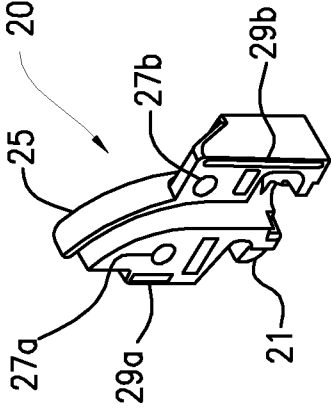

FIG. 6

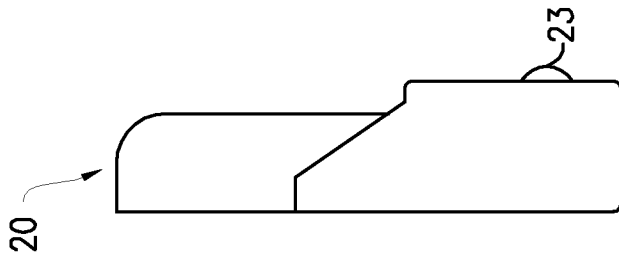

FIG. 4

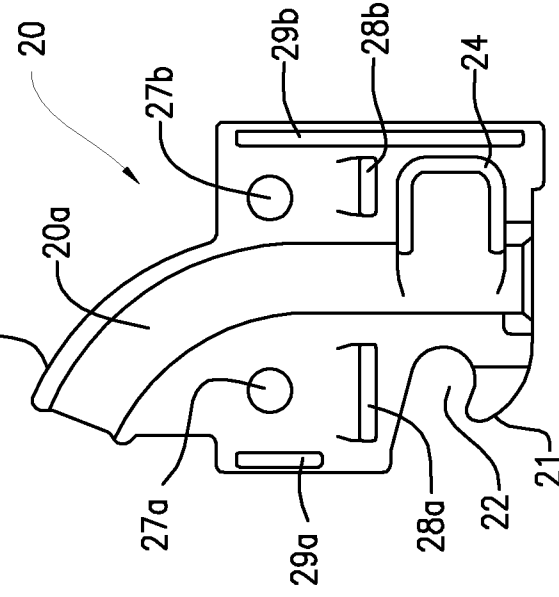

FIG. 5

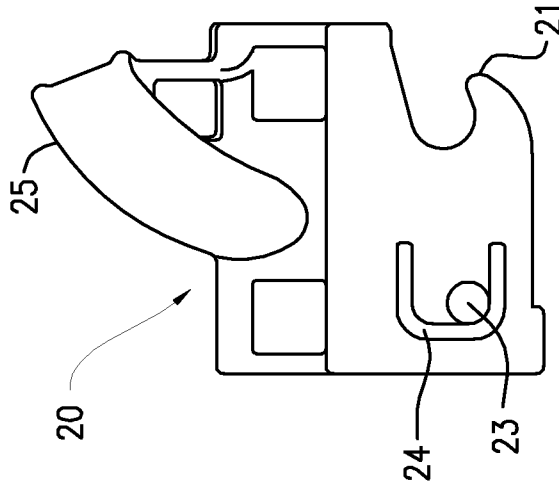

FIG. 3

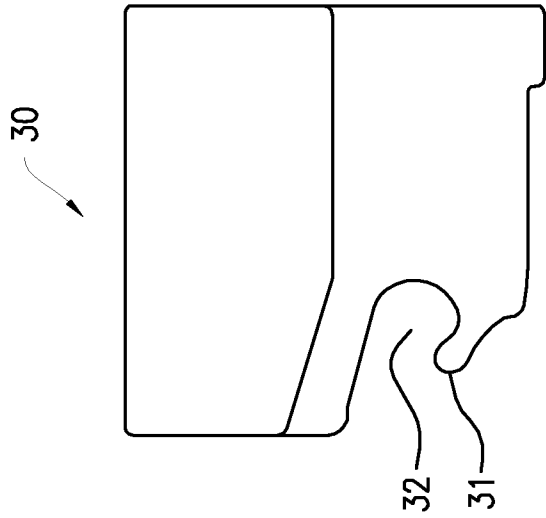

FIG. 8

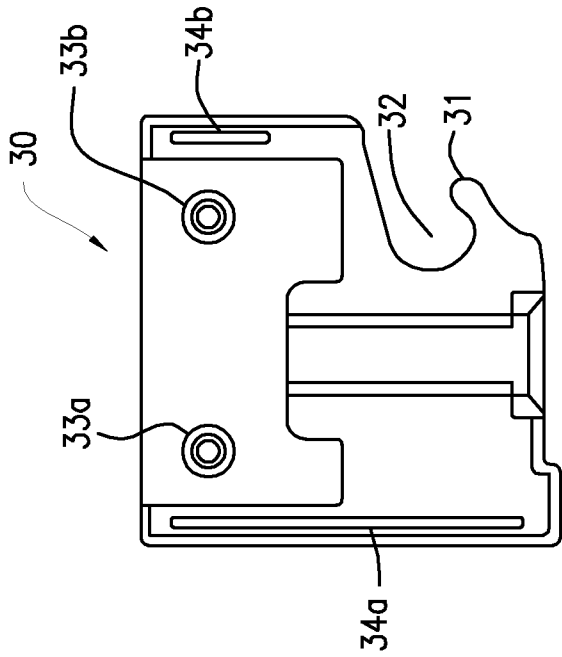

FIG. 9

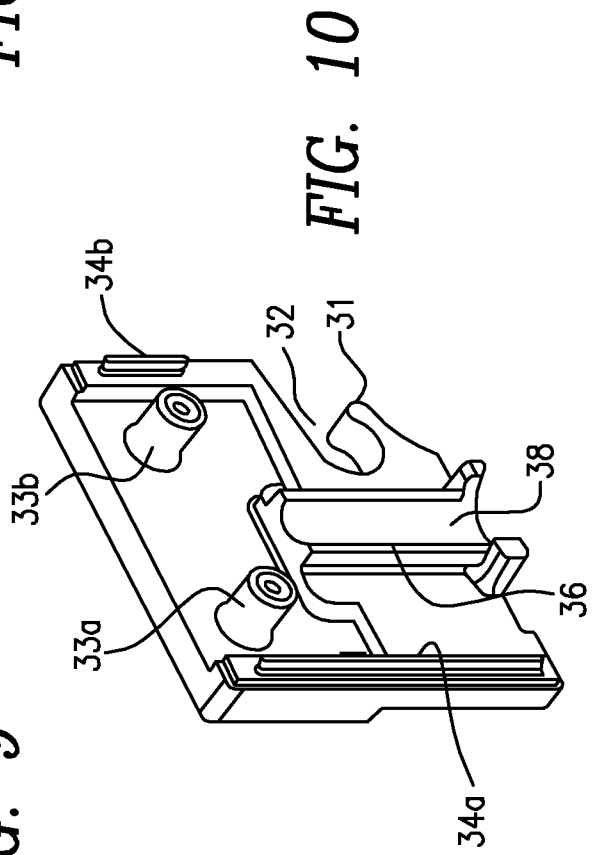

FIG. 10

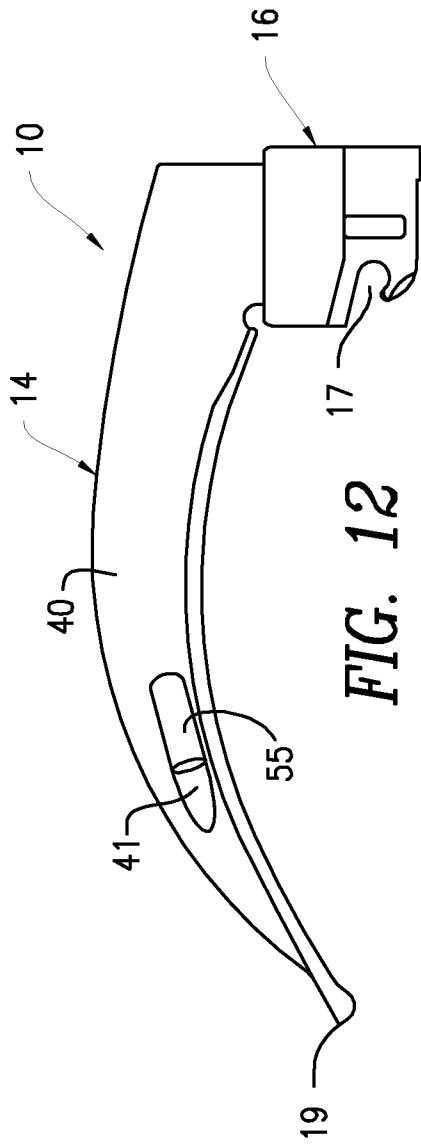

FIG. 12

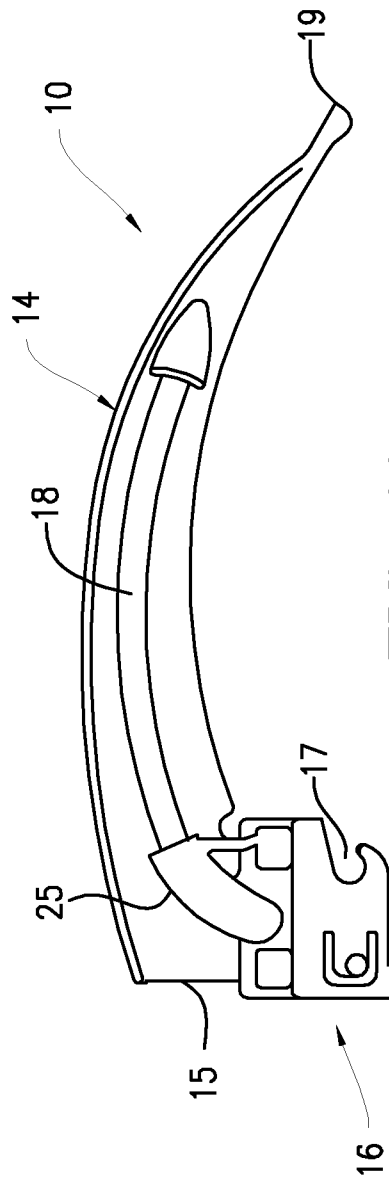
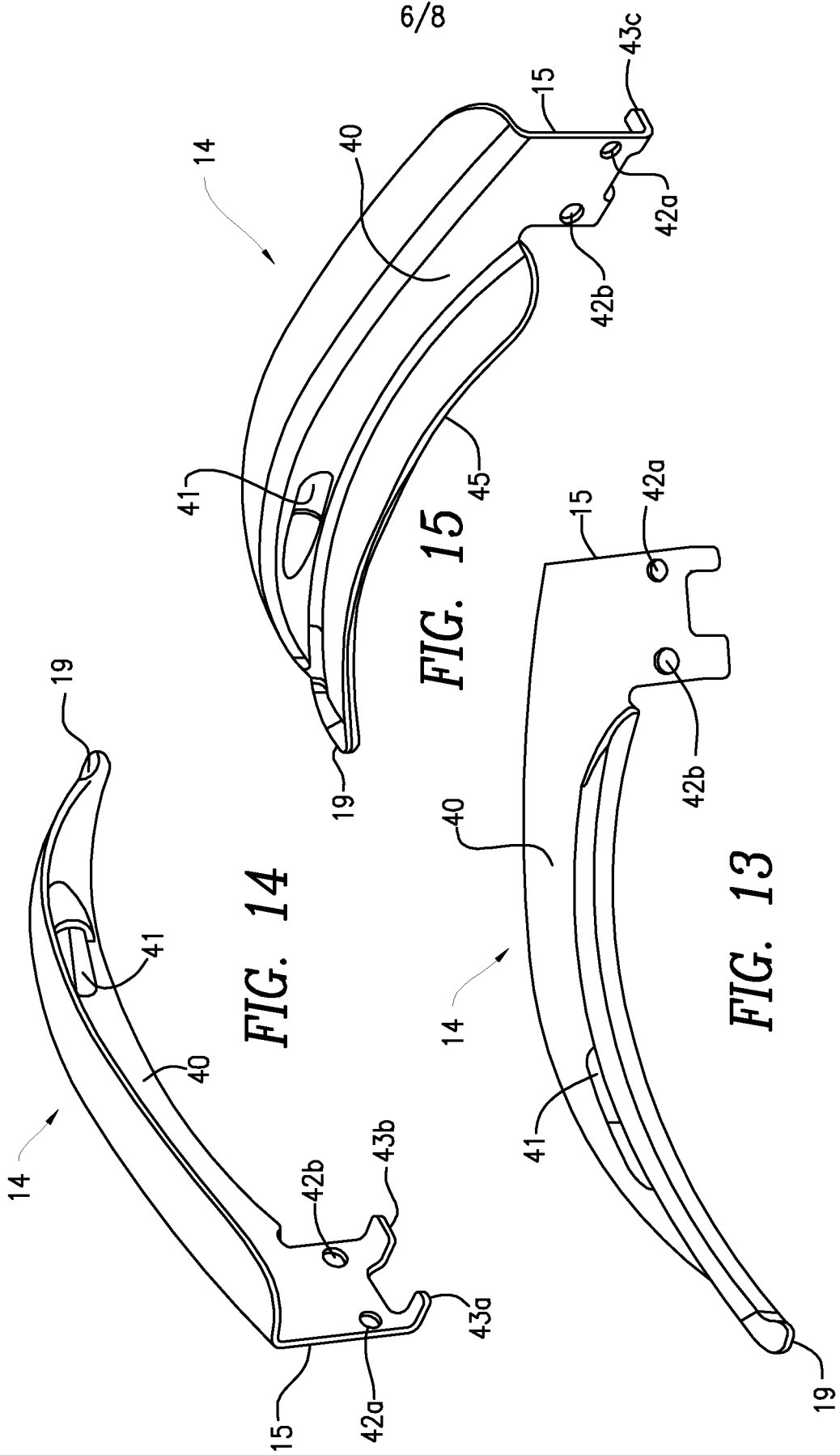

FIG. 11



7/8

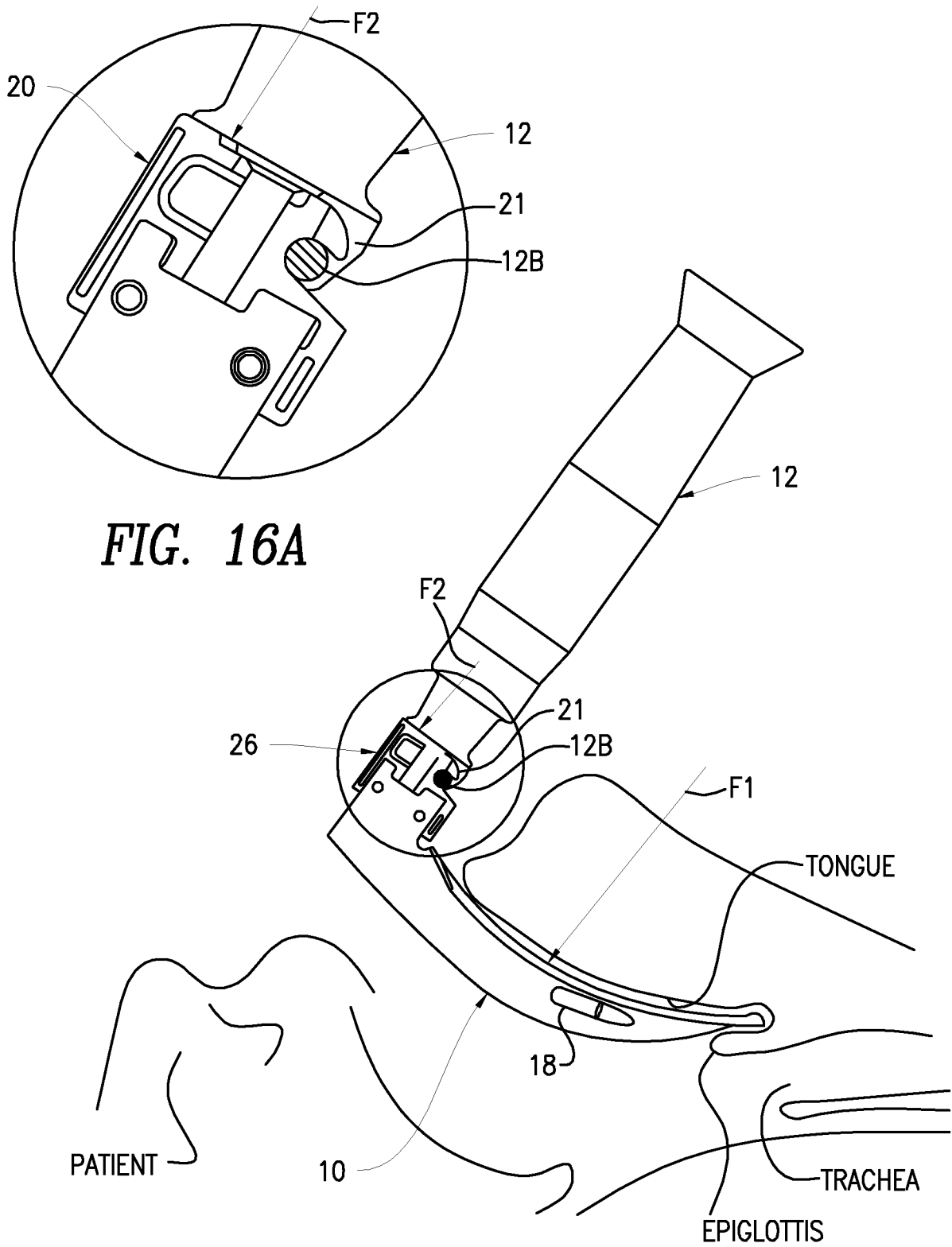

FIG. 16A

FIG. 16



FIG. 18

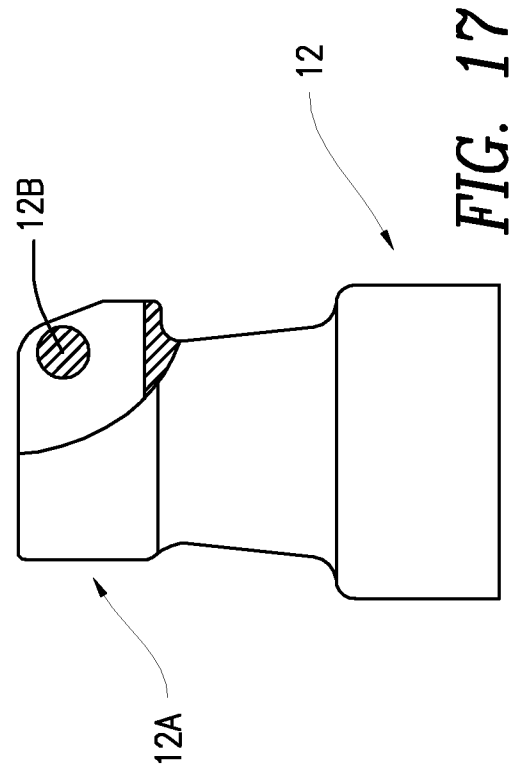

FIG. 17

FIG. 19

INTERNATIONAL SEARCH REPORT

International application No.
PCT/US2008/057549**A. CLASSIFICATION OF SUBJECT MATTER***A61B 1/267(2006.01)i, A61B 1/273(2006.01)i*

According to International Patent Classification (IPC) or to both national classification and IPC

B. FIELDS SEARCHED

Minimum documentation searched (classification system followed by classification symbols)

IPC 8: A61B 1/267, 1/273

Documentation searched other than minimum documentation to the extent that such documents are included in the fields searched

Korean Utility models and applications for Utility Models since 1975
Japanese Utility models and applications for Utility Models since 1975

Electronic data base consulted during the international search (name of data base and, where practicable, search terms used)

eKIPASS(KIPO internal) "laryngoscope", "blade", "base", "optic"

C. DOCUMENTS CONSIDERED TO BE RELEVANT

Category*	Citation of document, with indication, where appropriate, of the relevant passages	Relevant to claim No.
A	US 6213937 B1 (VIVENZIO, ROBERT L.) 10 April 2001 See the abstract; figure 3	1-13
A	US 7153260 B1 (GIRGIS, MAGDY S.) 26 December 2006 See the abstract; figure 5	1-13
A	US 5702351 A (BAR-OR, DAVID et al.) 30 December 1997 See the abstract; figure 2	1-13

 Further documents are listed in the continuation of Box C. See patent family annex.

* Special categories of cited documents:

"A" document defining the general state of the art which is not considered to be of particular relevance

"E" earlier application or patent but published on or after the international filing date

"L" document which may throw doubts on priority claim(s) or which is cited to establish the publication date of citation or other special reason (as specified)

"O" document referring to an oral disclosure, use, exhibition or other means

"P" document published prior to the international filing date but later than the priority date claimed

"T" later document published after the international filing date or priority date and not in conflict with the application but cited to understand the principle or theory underlying the invention

"X" document of particular relevance; the claimed invention cannot be considered novel or cannot be considered to involve an inventive step when the document is taken alone

"Y" document of particular relevance; the claimed invention cannot be considered to involve an inventive step when the document is combined with one or more other such documents, such combination being obvious to a person skilled in the art

"&" document member of the same patent family

Date of the actual completion of the international search

14 AUGUST 2008 (14.08.2008)

Date of mailing of the international search report

14 AUGUST 2008 (14.08.2008)

Name and mailing address of the ISA/KR

Korean Intellectual Property Office
Government Complex-Daejeon, 139 Seonsa-ro, Seo-
gu, Daejeon 302-701, Republic of Korea

Facsimile No. 82-42-472-7140

Authorized officer

HAN, SANG IL

Telephone No. 82-42-481-8185



INTERNATIONAL SEARCH REPORT

Information on patent family members

International application No.

PCT/US2008/057549

Patent document cited in search report	Publication date	Patent family member(s)	Publication date
US 6213937 B1	10.04.2001	None	
US 7153260 B1	26.12.2006	None	
US 5702351 A	30.12.1997	AU 1996-76822 A1 WO 97-17885 A2 WO 97-17885 A3	05.06.1997 22.05.1997 09.10.1997