

(19)



(11)

EP 2 709 488 B1

(12)

EUROPEAN PATENT SPECIFICATION

(45) Date of publication and mention of the grant of the patent:
11.03.2015 Bulletin 2015/11

(51) Int Cl.:
A47B 47/00 (2006.01) A47B 95/00 (2006.01)
A47B 91/00 (2006.01) A47B 77/14 (2006.01)

(21) Application number: **11728950.4**

(86) International application number:
PCT/IB2011/052159

(22) Date of filing: **17.05.2011**

(87) International publication number:
WO 2012/156781 (22.11.2012 Gazette 2012/47)

(54) **PIECE OF FURNITURE COMPOSED OF PANELS THAT CAN BE ASSEMBLED BY MEANS OF CONNECTING STRIPS**

MÖBELSTÜCK AUS MIT VERBINDUNGSLEISTEN MONTIERBAREN PLATTEN

MEUBLE CONSTITUÉ DE PANNEAUX POUVANT ÊTRE ASSEMBLÉS AU MOYEN DE BAGUETTES D'ACCOUPEMENT

(84) Designated Contracting States:
AL AT BE BG CH CY CZ DE DK EE ES FI FR GB GR HR HU IE IS IT LI LT LU LV MC MK MT NL NO PL PT RO RS SE SI SK SM TR

(74) Representative: **Modiano, Micaela Nadia Modiano & Partners (IT)**
Via Meravigli, 16
20123 Milano (IT)

(43) Date of publication of application:
26.03.2014 Bulletin 2014/13

(56) References cited:
WO-A2-2008/104490 CH-A5- 692 689
DE-A1- 10 260 461 DE-A1- 19 823 229
DE-U1- 20 300 351 FR-A1- 2 325 840
FR-A1- 2 350 487 GB-A- 2 141 924

(73) Proprietor: **Iterby Italiana Mobili S.p.A.**
61025 Montelabbate (IT)

(72) Inventor: **BERLONI, Massimo**
I-61122 Pesaro (IT)

EP 2 709 488 B1

Note: Within nine months of the publication of the mention of the grant of the European patent in the European Patent Bulletin, any person may give notice to the European Patent Office of opposition to that patent, in accordance with the Implementing Regulations. Notice of opposition shall not be deemed to have been filed until the opposition fee has been paid. (Art. 99(1) European Patent Convention).

Description**Technical field**

[0001] The present invention relates to a piece of furniture composed of panels that can be assembled by means of connecting strips adapted for the application of supporting feet, hangers, studs and the like. Hereinafter, for reasons of simplicity of description, the expression piece of furniture is used to identify more generally all types of furniture comprising one or more compartments, having a rectangular prism-like shape, such as lockers, cabinets and the like.

Background art

[0002] As is known, to connect at right angles two panels of a piece of furniture to each other one uses adapted pins in which one end is retained through the edge of a first panel and the opposite end is mushroom-shaped so as to be engaged by a coupling element, which is accommodated in an adapted seat of the wall of a second panel perpendicular to the first one.

[0003] For mutual connection of two panels, joints are also known which are constituted by strips which are arranged between the edges of the panels and to which the ends of the pins are coupled.

[0004] CH 692 689 A5 discloses a piece of furniture having a combination of elements as defined in the pre-characterizing portion of the appended claim 1.

Disclosure of the invention

[0005] The aim of the present invention is to propose a piece of furniture in which, in addition to an ingenious assembly of the panels that compose it, it is possible to provide the piece of furniture with applications that increase its practicality in use.

[0006] Within this aim, an object of the invention is to provide a piece of furniture that is conceived to make its placement on a surface and its hanging on a wall more functional.

[0007] Another object of the invention is to provide a piece of furniture equipped with means that allow the application of accessories adapted to make the piece of furniture comply with various furnishing purposes, such as tools for use in the kitchen or shelves for resting decorative items for various spaces and so forth.

[0008] In accordance with the invention, there is provided a piece of furniture as defined in the appended claims.

Brief description of the drawings

[0009] Further characteristics and advantages of the present invention will become more apparent from the following description of some embodiments, illustrated by way of non-limiting example in the accompanying

drawings, wherein:

Figure 1 is a perspective view of a piece of furniture according to the present invention;

Figure 2 is an exploded view of the piece of furniture of Figure 1;

Figure 3 is a view of a corner detail of the piece of furniture;

Figure 4 is a perspective view of the piece of furniture hung on a wall;

Figure 5 is a view of an element used to hang the piece of furniture on the wall;

Figure 6 is a sectional view of the element of Figure 4;

Figure 7 is a view of a corner detail of the piece of furniture provided with feet for resting on the ground;

Figure 8 is an exploded view of the lower panel of the piece of furniture of Figure 7;

Figure 9 is an enlarged-scale view of a detail of Figure 8;

Figure 10 is an exploded view of a lower panel of a piece of furniture equipped with an element for supporting tools.

Ways of carrying out the invention

[0010] With reference to Figures 1 and 2, the reference numeral 1 designates a piece of furniture according to the invention, which is composed of four panels 2, 3, 4, 5, made for example of wood or particlewood, which are assembled so as to form a rectangular prism. Assembly is performed by means of four strips 6, which join the panels in pairs, forming a right angle.

[0011] The strips 6 (see Figure 3) have a square cross-section, with faces whose height is equal to the thickness of the panels 2, 3, 4, 5. Advantageously, the strips 6 are constituted by a profile made of metal (for example aluminum) comprising a central tube 7 which defines a channel which has a square cross-section and from the edges of which four longitudinal wings 8 protrude outward along diagonal planes. The ends of the wings 8 are each provided with a pair of ribs 9 arranged at right angles and parallel to the faces of the central tube 7. The wings 8 lie along the bisecting line of the right angle formed by the ribs 9, which thus define the four outer faces of the strips 6 which are planar and parallel with respect to the faces of the inner tube 7. The ribs 9 that form each face of the strips have such a width as to remain mutually separated by a slit 10, which runs longitudinally along the centerline planes of the strip. In this manner, the wings 8, the tube

7 and the ribs 9 form four slots 11 which have a T-shaped trapezoidal cross-section and in which the ends of cylindrical pins 12 can engage. As shown more clearly in Figure 9, each pin 12 has an end 13 that is mushroom-shaped and has a profile complementary to the cross-section of the grooves 11, so as to be able to slide in them and allow the placement of the pins 12 at the desired distance. The opposite ends of the pins 12 also are mushroom-shaped, so as to form a head 14 which can be inserted in holes 15 (see Figures 2, 8, 9) provided in the thickness of the panels. The number of pins and therefore of the respective holes 15 is selected as a function of the size of the panels and of the requirements on strength with which the parts that compose the piece of furniture must be assembled. Each hole 15 (see Figure 8) leads into a cylindrical cavity 16, which forms a receptacle for accommodating a locking element of a known type. The length of the holes 15 is such that when the pin 12 is inserted in the hole its head 14 protrudes into the cavity 16.

[0012] The locking element is constituted by a hollow cylindrical body 17, which is of a known type and therefore not described in detail. The hollow body 17 has the same diameter as the cavity 16 and a slot which is provided circumferentially around it and through which the head 14 of the pin can be inserted. The cylindrical body 17 is further provided with a cross-shaped notch 18 (see Figure 3), which can be engaged by a tool, for example a screwdriver, and by means of which it is possible, by rotating the cylindrical body 17, to pull the pin 12 and thus lock the panel against the strip.

[0013] The assembly of the piece of furniture 1 can be intuited easily from the above description. In particular, it is noted that the pins 12 are not integral with the strip 6, and this makes it possible to adapt their distance to the distance of the holes 15.

[0014] A fundamental prerogative of the present invention resides in the presence of the tube 7, which makes it possible to make the installation of the piece of furniture more versatile. Figures 4, 5, 6 illustrate a first embodiment, which allows hanging the piece of furniture on a wall P (see Figure 4) so as to provide a wall-mounted cabinet. For this purpose there is an accessory, for example a hanger 19 composed of a disk 20, eccentrically to which a cylindrical pin 21 is integral which has such a diameter that it can be accommodated with adequate forcing in the channel of the tube 7 of the upper strips of the piece of furniture. The disk 20 is provided with a flange 22 which is concentric therewith and which, when the pin 21 is fully inserted in the tube 7, forms with the front of the strip 10 an annular slot 23, by means of which it is possible to engage and thus hang the piece of furniture 1 from a bar 24 which is fixed by means of screws 25 to the supporting wall P. Advantageously, the bar 24 is constituted by a flat strip which has a flat central region 26 and an edge 27 folded so as to be spaced from the wall P to allow engagement in the annular slot 23 and be retained by the flange 22. The eccentricity of the disk 20

with respect to the axis of the pin 21 makes it possible to adjust the horizontal leveling of the piece of furniture. For this purpose, a polygonal recess 28 is provided at the end of the pin 21 that lies opposite the disk 20 and can be accessed by an Allen wrench 29, which can be inserted in the tube 7 from the opposite end with respect to the one in which the hanger 19 is arranged. Once the piece of furniture has been fastened to the bar 24, by inserting the Allen wrench 29 in the tube 7 until engagement in the recess 28 of the pin 21 occurs, it is possible to turn the eccentric disk 20 and thus lift or lower the piece of furniture 1 to a horizontal level.

[0015] A further variation of the invention is shown in Figures 7, 8 and 9 and consists of feet 30 for supporting the piece of furniture on the ground, which are arranged at the corners of the base panel of the piece of furniture. The feet 30 are constituted by cylinders from the top of which a threaded stem 31 protrudes which passes through a plate 32 which is substantially shaped like a circular sector centered on the stem 31 and has an angular extension of approximately 90°.

[0016] The feet 30 are locked under the piece of furniture by screwing the stem 31 into a nut 33 which is located in the lower slot 11 of the strip 6, so as to fasten the plate 32 against the face of the lower panel.

[0017] Three holes 34 are provided along the circular peripheral region of the plate and are offset so that the central one is offset by approximately 45° with respect to the ones that are lateral thereto. If the feet must support a single piece of furniture, the plates are oriented and fixed by means of screws driven through the holes 34 so that they do not protrude laterally from the side walls of the piece of furniture. On the other hand, if the feet must support two pieces of furniture which are associated side by side on the same plane, the plates are oriented so as to protrude laterally below both pieces of furniture (see Figure 7) and are fixed so as to support both pieces of furniture.

[0018] The strips 6 according to the invention have further innovative prerogatives. In particular, it is possible to cover frontally the strip 6 with a sort of quadrangular stud 35 (see Figure 3), which has a quadrangular shank 36 shaped complementary to the channel of the tube 7 in which it is to be inserted. To ensure firm retention of the stud 35, the shank 36 has such dimensions as to be inserted with suitable forcing in the tube 7. Advantageously, in the stud 35 there is a hole 37 that extends into the shank 36 and in which it is possible to insert a plug 38 which, in addition to acting as an aesthetic improvement, is capable of producing an expansion of the shank 36 and of ensuring a safer anchoring of the stud.

[0019] The particular shape of the strips allows the provision of additional variations in application. Figure 10 illustrates a solution that relates to the possibility of equipping a small piece of furniture, having for example the function of a hanging cabinet, with a bar 39 for supporting various tools, for example ladles, pasta strainers, carving forks, and the like. The bar 39 passes through a pair of

posts 40, at the top of which there are threaded holes 41 in which threaded pins 42 are screwed or driven. The bar is hung from the two lateral strips 6 of the base of the wall-mounted unit by screwing the pins 42 of the posts 40 into nuts 33 which are accommodated and fastened in the lower slot 11 of the strips.

[0020] In the practical embodiment of the invention, the shapes and dimensions, as well as the materials used, may be any according to the requirements without thereby abandoning the protective scope of the appended claims.

[0021] Where technical features mentioned in any claim are followed by reference signs, those reference signs have been included for the sole purpose of increasing the intelligibility of the claims and accordingly such reference signs do not have any limiting effect on the interpretation of each element identified by way of example by such reference signs.

Claims

1. A piece of furniture composed of panels (2, 3, 4, 5) that can be assembled at right angles and in a mutually coplanar manner by means of strips (6) having a rectangular cross-section, which are provided with longitudinal slots (11) on their four faces and have a substantially T-shaped cross-section, and of means for coupling said panels to said strip, which are constituted by pins (12) in which one end (14) is contoured to be retained in said slots and the opposite end is coupled to coupling elements (17) which are accommodated in seats (16) of the panels associated with said strip, coupling elements (31, 33; 42, 43) for means for various uses being arranged in the slots (7) of said strips (6), said strips (61) being provided with a central tube (7) for accommodating hangers (19) for hanging said piece of furniture on a wall, **characterized in that** each one of said hangers (19) is composed of a disk (20), eccentrically to which a cylindrical pin (21) is integral which has such a diameter that it can be accommodated with adequate forcing in the channel of the tube (7), said disk (20) being provided with a flange (22) which is concentric thereto and which, when the pin (21) is fully inserted in the tube (7), forms, with the front of the strip (10), an annular slot (23), by means of which it is possible to fasten the piece of furniture (1) to a bar (24) which is fixed by means of screws (25) to the supporting wall (P) of the piece of furniture.
2. The piece of furniture according to claim 1, **characterized in that** said bar (24) is constituted by a strip which has a central flat region (26) and an edge (27) which is folded so as to be spaced from the wall (P) in order to allow it to engage the annular slot (23) and remain retained on the bar by said flange (22).
3. The piece of furniture according to claim 2, **characterized in that** at the end of the pin (21) that lies opposite said eccentric disk (20) there is a polygonal recess (28), which is accessible by means of an Allen wrench (29) driven through said tube (7) from the opposite end with respect to the one in which said hanger (19) is arranged and can be engaged in said recess of the pin (21) so as to rotate said eccentric disk (20) and adjust said piece of furniture to bring it to a horizontal level.
4. The piece of furniture according to one or more of the preceding claims, **characterized in that** it comprises feet (30) for supporting the piece of furniture on the ground, which are arranged at the corners of the base panel (5) of the piece of furniture, said feet (30) being constituted by cylinders from the top of which a threaded stem (31) protrudes which is driven through a plate (32), and can be screwed into a nut (33) which is arranged in the lower slot (11) of the lower strip (6) of the piece of furniture.
5. The piece of furniture according to claim 4, **characterized in that** it comprises a plate (32), which is centered on said threaded stem (31) and is adapted to be fastened between the top of said foot (30) and the lower face of the lower panel of the piece of furniture.
6. The piece of furniture according to claim 5, **characterized in that** said plate (32) is shaped like a circular sector which is centered on said stem (31) and has an angular extension of substantially 90°, along the circular peripheral region of the plate (32) there being holes (34) which can be engaged by screws and are adapted to allow the orientation of the plate between a position in which it remains below the piece of furniture and a position in which it protrudes laterally so as to support an adjacent piece of furniture.
7. The piece of furniture according to one or more of the preceding claims, **characterized in that** in order to cover frontally the strips (6) there is a sort of stud (35) provided with a shank (36) which can be inserted in the channel of the tube (7), said stud being provided with a hole (37) which extends into said shank (36) and in which it is possible to insert a plug (38) to produce an expansion adapted to block said shank in said channel (7).
8. The piece of furniture according to one or more of the preceding claims, **characterized in that** it comprises a bar (39) which is adapted to support various tools and is supported by a pair of posts (40) provided at the top with respective threaded pins (41) which can be screwed into nuts (43) which are accommodated and fastened in the lower slot of the strips.

Patentansprüche

1. Ein Möbelstück bestehend aus Platten (2, 3, 4, 5), die in rechten Winkeln und im Wesentlichen koplanar zueinander mit Hilfe von Leisten (6) montiert werden können, die einen rechteckigen Querschnitt haben, an ihren vier Flächen mit Längsschlitz (11) versehen sind und einen im Wesentlichen T-förmigen Querschnitt haben, und aus Mitteln zur Kopplung der Platten mit der Leiste, die aus Stiften (12) bestehen, deren eines Ende (14) geformt ist, um in den Schlitz gehalten zu werden, und deren gegenüberliegende Ende mit Kopplungselementen (17) gekoppelt ist, die in Sitze (16) der mit der Leiste verbundenen Platten eingeführt sind, wobei Kopplungselemente (31, 33; 42, 43) für Mittel für verschiedene Zwecke in den Schlitz (7) der Leisten (6) angeordnet sind, wobei die Leisten (61) mit einer zentralen Röhre (7) zur Aufnahme von Aufhängern (19) zum Aufhängen des Möbelstücks an einer Wand ausgestattet sind, **dadurch gekennzeichnet, dass** jeder der Aufhänger (19) aus einer Scheibe (20) besteht, exzentrisch zu der ein Zylinderstift (21) integral ist, der einen solchen Durchmesser hat, dass er mit angemessener Kraft in dem Kanal der Röhre (7) untergebracht werden kann, wobei die Scheibe (20) mit einem Flansch (22) versehen ist, der konzentrisch damit ist und der, wenn der Stift (21) vollständig in die Röhre (7) eingesetzt ist, mit der Vorderseite der Leiste (10) einen Kreisschlitz (23) bildet, mit dessen Hilfe es möglich ist, das Möbelstück (1) an einer Leiste (24) zu befestigen, die mit Schrauben (25) an der tragenden Wand (P) des Möbelstücks befestigt wird.
2. Das Möbelstück gemäß Anspruch 1, **dadurch gekennzeichnet, dass** die Leiste (24) aus einem Streifen besteht, der einen zentralen flachen Bereich (26) und eine Kante (27) hat, die geknickt ist, um von der Wand (P) beabstandet zu sein, um es ihr zu ermöglichen, in den Kreisschlitz (23) einzugreifen und von dem Flansch (22) auf der Leiste in Eingriff gehalten zu bleiben.
3. Das Möbelstück gemäß Anspruch 2, **dadurch gekennzeichnet, dass** an dem Ende des Stifts (21), das gegenüber der Exzentrerscheibe (20) liegt, sich eine polygonale Vertiefung (28) befindet, auf die mit Hilfe eines Inbus-Schlüssels (29) zugegriffen werden kann, der durch die Röhre (7) von dem Ende eingeführt werden kann, das demjenigen gegenüberliegt, in dem der Aufhänger (19) angebracht ist, und in die Vertiefung des Stifts (21) eingreifen kann, um die Exzentrerscheibe (20) zu drehen und das Möbelstück einzustellen, um es auf eine horizontale Ebene zu bringen.
4. Das Möbelstück gemäß einem oder mehreren der

obigen Ansprüche, **dadurch gekennzeichnet, dass** es Füße (30) zum Stützen des Möbelstücks auf dem Boden umfasst, die an den Ecken der Grundplatte (5) des Möbelstücks angeordnet sind, wobei die Füße (30) aus Zylindern bestehen, aus deren oberem Ende ein Gewindezapfen (31) herausragt, der durch eine Platte (32) getrieben wird, und in eine Mutter (33) eingeschraubt werden kann, die im unteren Schlitz (11) der unteren Leiste (6) des Möbelstücks angebracht ist.

5. Das Möbelstück gemäß Anspruch 4, **dadurch gekennzeichnet, dass** es eine Platte (32) umfasst, die auf dem Gewindezapfen (31) zentriert und ausgebildet ist, um zwischen dem oberen Ende des Fußes (30) und der unteren Fläche der unteren Platte des Möbelstücks befestigt zu werden.

6. Das Möbelstück gemäß Anspruch 5, **dadurch gekennzeichnet, dass** die Platte (32) wie ein Kreis-sektor geformt ist, der auf dem Zapfen (31) zentriert ist und eine Winkelausdehnung von im Wesentlichen 90° hat, wobei sich entlang dem kreisförmigen peripheren Bereich der Platte (32) Löcher (34) befinden, in die Schrauben eingreifen können und die ausgebildet sind, um die Ausrichtung der Platte zwischen einer Position, in der sie unterhalb des Möbelstücks bleibt, und einer Position zu ermöglichen, in der sie seitlich herausragt, um ein benachbartes Möbelstück zu tragen.

7. Das Möbelstück gemäß einem oder mehreren der obigen Ansprüche, **dadurch gekennzeichnet, dass** es, um die Leisten (6) an der Vorderseite zu bedecken, eine Art von Ständer (35), ausgestattet mit einem Schaft (36), gibt, der in den Kanal der Röhre (7) eingesetzt werden kann, wobei der Ständer mit einem Loch (37) versehen ist, das sich in den Schaft (36) erstreckt und in das ein Stöpsel (38) eingesetzt werden kann, um eine Expansion zu erzeugen, die geeignet ist, den Schaft in dem Kanal (7) zu blockieren.

8. Das Möbelstück gemäß einem oder mehreren der obigen Ansprüche, **dadurch gekennzeichnet, dass** es eine Stange (39) umfasst, die ausgebildet ist, um verschiedene Werkzeuge zu tragen, und von einem Paar von Pfosten (40) getragen wird, die oben mit entsprechenden Gewindestiften (41) versehen sind, welche in Muttern (43) eingeschraubt werden können, die im unteren Schlitz der Leisten untergebracht und befestigt sind.

Revendications

1. Meuble composé de panneaux (2, 3, 4, 5) qui peuvent être assemblés à angles droits et d'une façon

- mutuellement coplanaire au moyen de baguettes (6) qui présentent une section transversale rectangulaire, qui sont dotées de fentes longitudinales (11) situées sur leurs quatre faces et qui présentent une section transversale sensiblement en forme de T, et de moyens destinés à accoupler lesdits panneaux à ladite baguette, qui sont constitués par des broches (12) dans lesquelles une extrémité (14) est profilée de façon à être retenue dans lesdites fentes, et l'extrémité opposée est accouplée à des éléments d'accouplement (17) qui sont reçus dans des sièges (16) des panneaux associés à ladite baguette, des éléments d'accouplement (31, 33 ; 42, 43) de moyens destinés à diverses utilisations étant agencés dans les fentes (7) desdites baguettes (6), lesdites baguettes (61) étant dotées d'un tube central (7) destiné à recevoir des crochets (19) destinés à décrocher ledit meuble sur un mur, **caractérisé en ce que** chacun desdits crochets (19) se compose d'un disque (20), qui présente une broche cylindrique (21) d'un seul tenant disposée de manière excentrique par rapport à celui-ci, dont le diamètre est tel qu'elle peut être reçue en appliquant une force appropriée dans le canal du tube (7), ledit disque (20) étant doté d'une bride (22) qui est concentrique à celui-ci et qui, lorsque la broche (21) est entièrement insérée dans le tube (7), forme, avec l'avant de la baguette (10), une fente annulaire (23), au moyen de laquelle il est possible de fixer le meuble (1) à une barre (24) qui est fixée à l'aide de vis (25) sur le mur de support (P) du meuble.
2. Meuble selon la revendication 1, **caractérisé en ce que** ladite barre (24) est constituée par une baguette qui présente une région plate centrale (26) et un bord (27) qui est plié de façon à être éloigné du mur (P) de manière à lui permettre de venir en prise avec la fente annulaire (23) et de rester maintenu sur la barre par ladite bride (22).
3. Meuble selon la revendication 2, **caractérisé en ce que**, au niveau de l'extrémité de la broche (21) qui se situe à l'opposé dudit disque excentrique (20), il y a un renforcement polygonal (28), auquel il est possible d'accéder à l'aide d'une clé Allen (29) introduite à travers ledit tube (7) à partir de l'extrémité opposée par rapport à celle dans laquelle ledit crochet (19) est agencé, et qui peut être mis en prise dans ledit renforcement de la broche (21) de façon à faire tourner ledit disque excentrique (20) et à régler ledit meuble de manière à ce qu'il prenne un niveau horizontal.
4. Meuble selon l'une quelconque des revendications précédentes, **caractérisé en ce qu'il** comprend des pieds (30) destinés à supporter le meuble sur le sol, qui sont agencés au niveau des coins du panneau de base (5) du meuble, lesdits pieds (30) étant constitués par des cylindres à partir du sommet desquels fait saillie une tige filetée (31) qui passe à travers une plaque (32), et qui peut être vissée dans un écrou (33) qui est agencé dans la fente inférieure (11) de la baguette inférieure (6) du meuble.
5. Meuble selon la revendication 4, **caractérisé en ce qu'il** comprend une plaque (32), qui est centrée sur ladite tige filetée (31) et qui est adaptée de façon à être fixée entre le dessus dudit pied (30) et la face inférieure du panneau inférieur du meuble.
6. Meuble selon la revendication 5, **caractérisé en ce que** ladite plaque (32) présente une forme similaire à celle d'un secteur circulaire qui est centré sur ladite tige (31) et qui présente une extension angulaire sensiblement égale à 90°, et le long de la région périphérique circulaire de la plaque (32), il y a des trous (34) qui peuvent être mis en prise par des vis et qui sont adaptés de façon à permettre l'orientation de la plaque entre une position dans laquelle elle reste sous le meuble et une position dans laquelle elle fait saillie de manière latérale de façon à supporter un meuble adjacent.
7. Meuble selon l'une quelconque des revendications précédentes, **caractérisé en ce que**, afin de couvrir de manière frontale les baguettes (6), il y a une sorte de goujon (35) doté d'une tige (36) qu'il est possible d'insérer dans le canal du tube (7), ledit goujon étant doté d'un trou (37) qui s'étend dans ladite tige (36) et dans lequel il est possible d'insérer un bouchon (38) de façon à produire une expansion adaptée de manière à bloquer ladite tige dans ledit canal (7).
8. Meuble selon l'une quelconque des revendications précédentes, **caractérisé en ce qu'il** comprend une barre (39) qui est adaptée de façon à supporter divers outils et qui est supportée par une paire de montants (40) disposés au niveau du dessus avec des broches filetées respectives (41) qui peuvent être vissées dans des écrous (43) qui sont reçus et fixés dans la fente inférieure des baguettes.

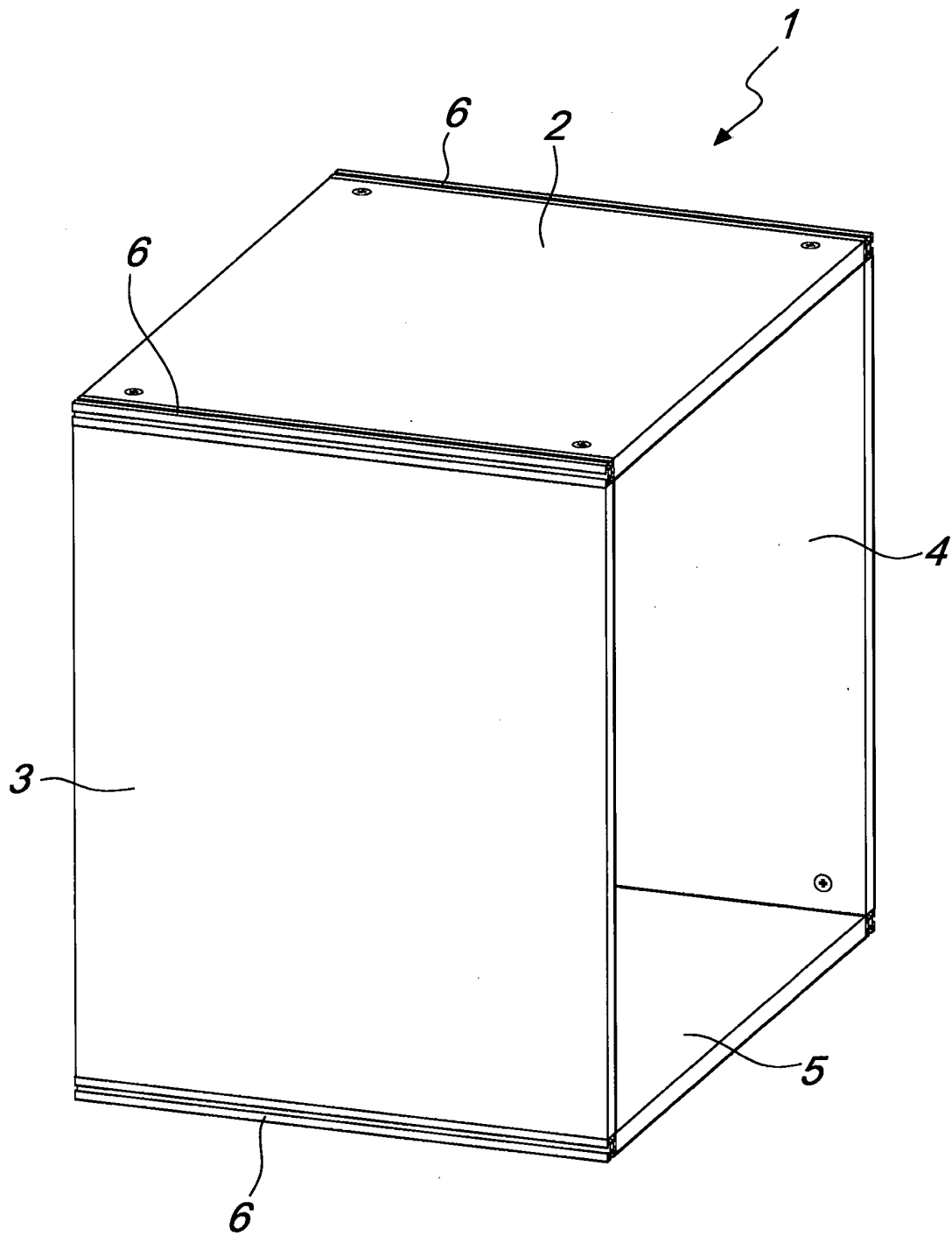

Fig. 1

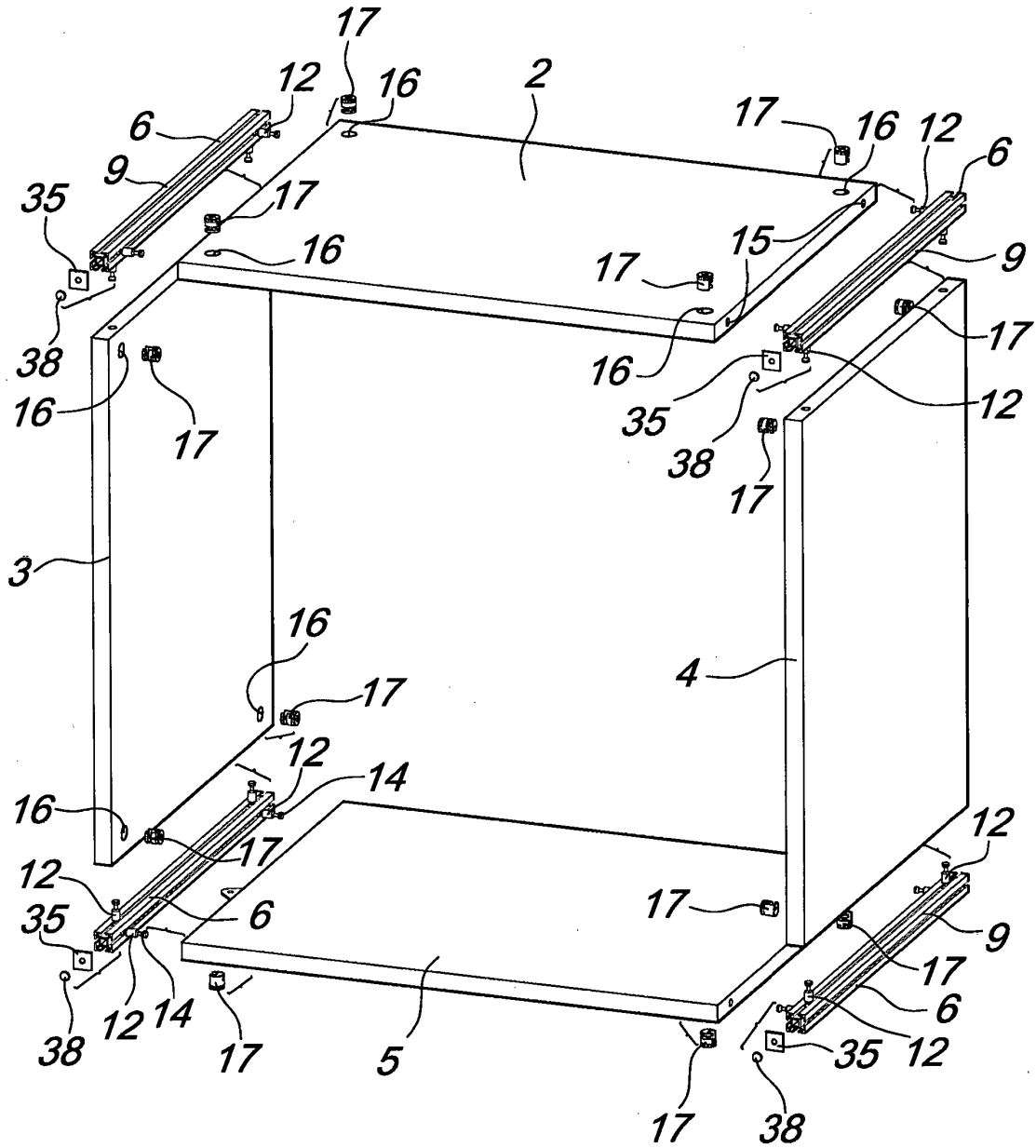

Fig. 2

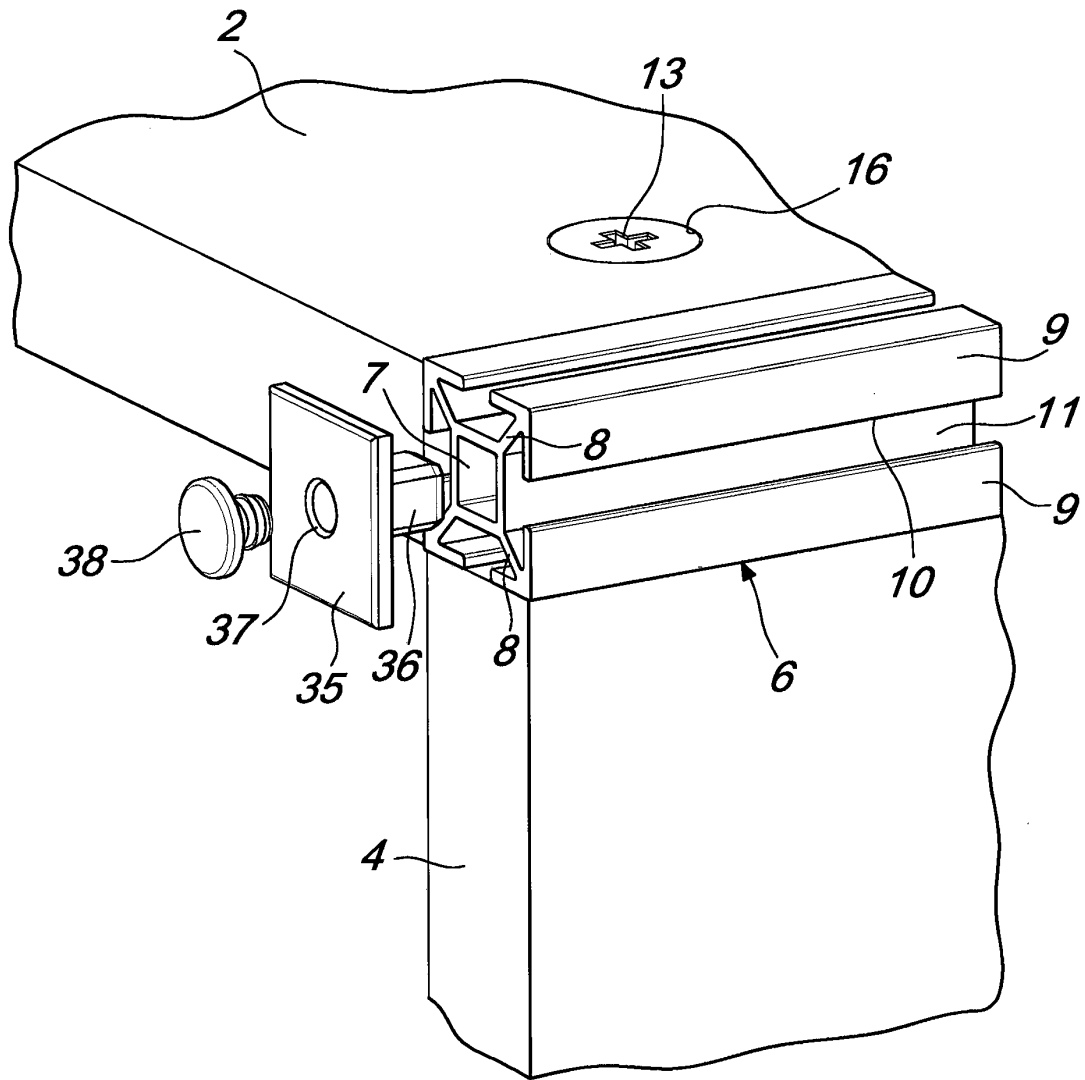
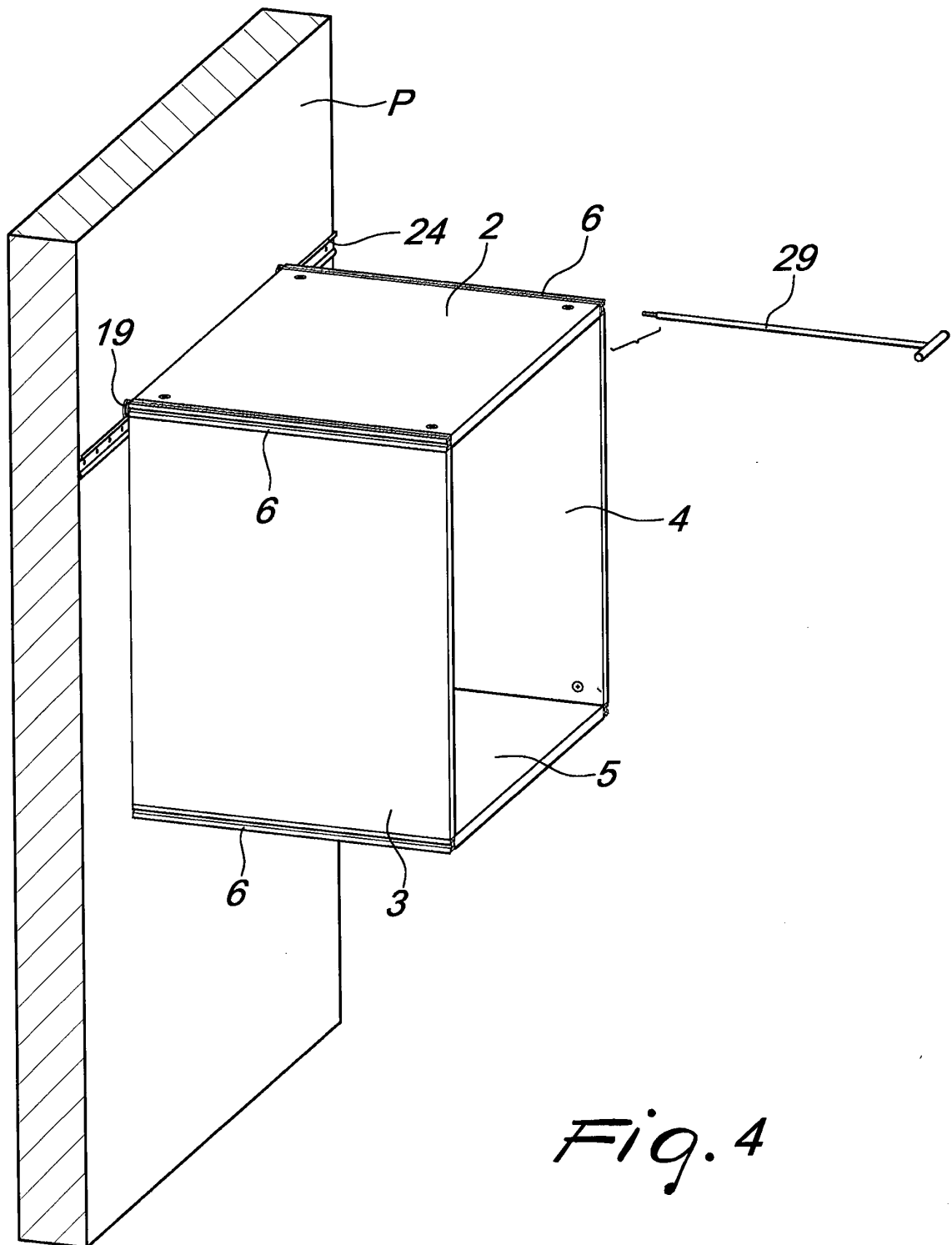

Fig. 3



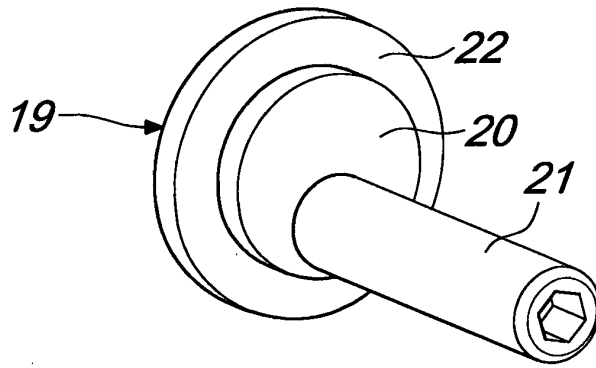

Fig. 5

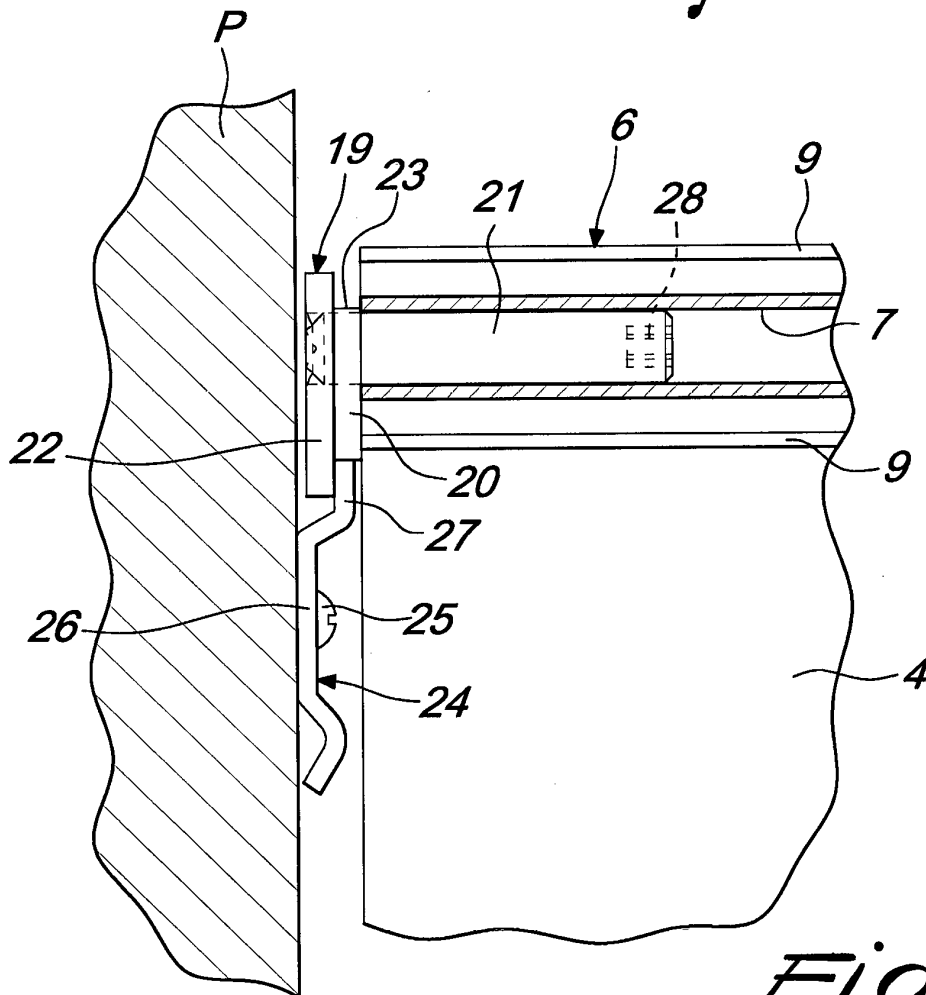

Fig. 6

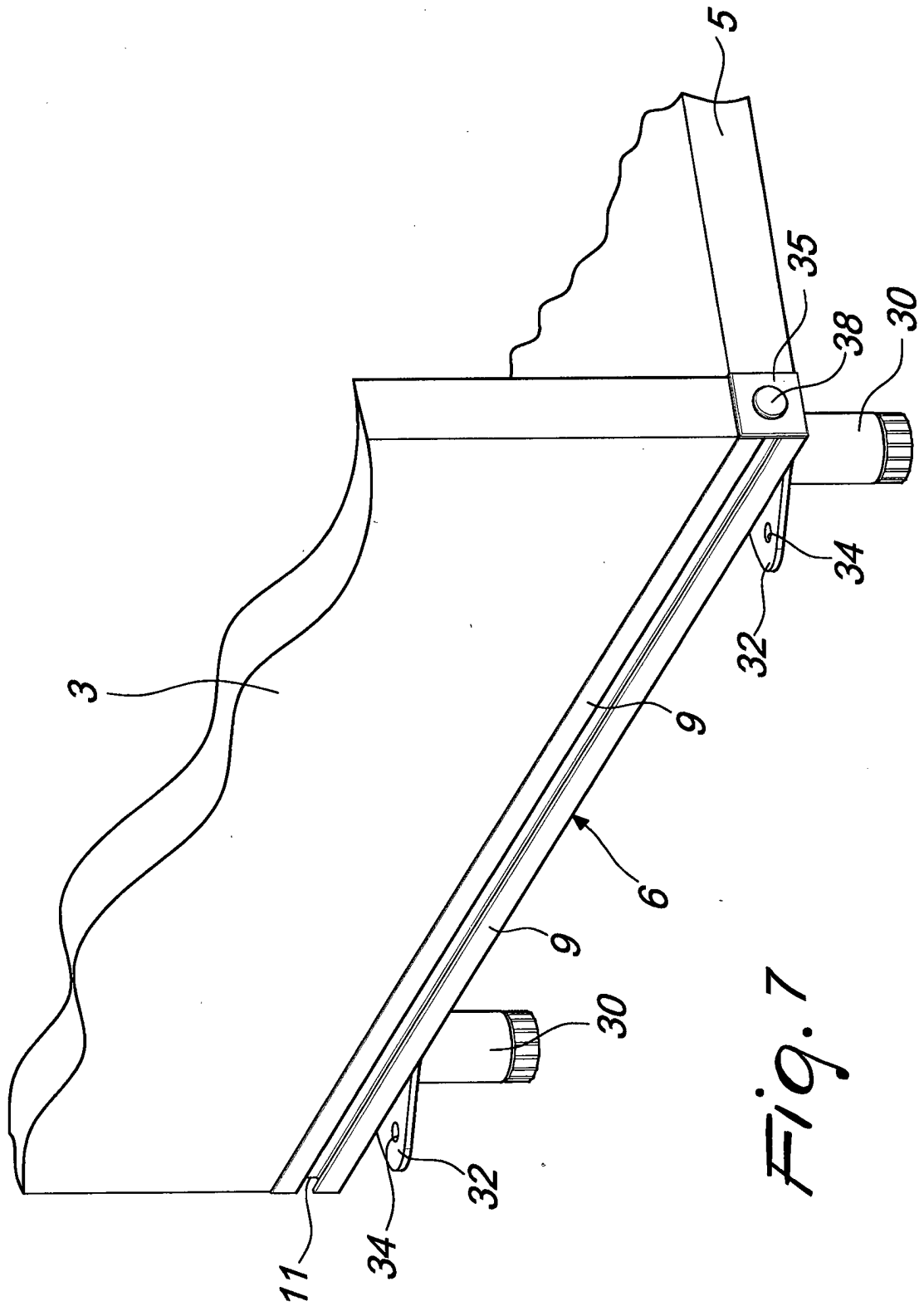

Fig. 7

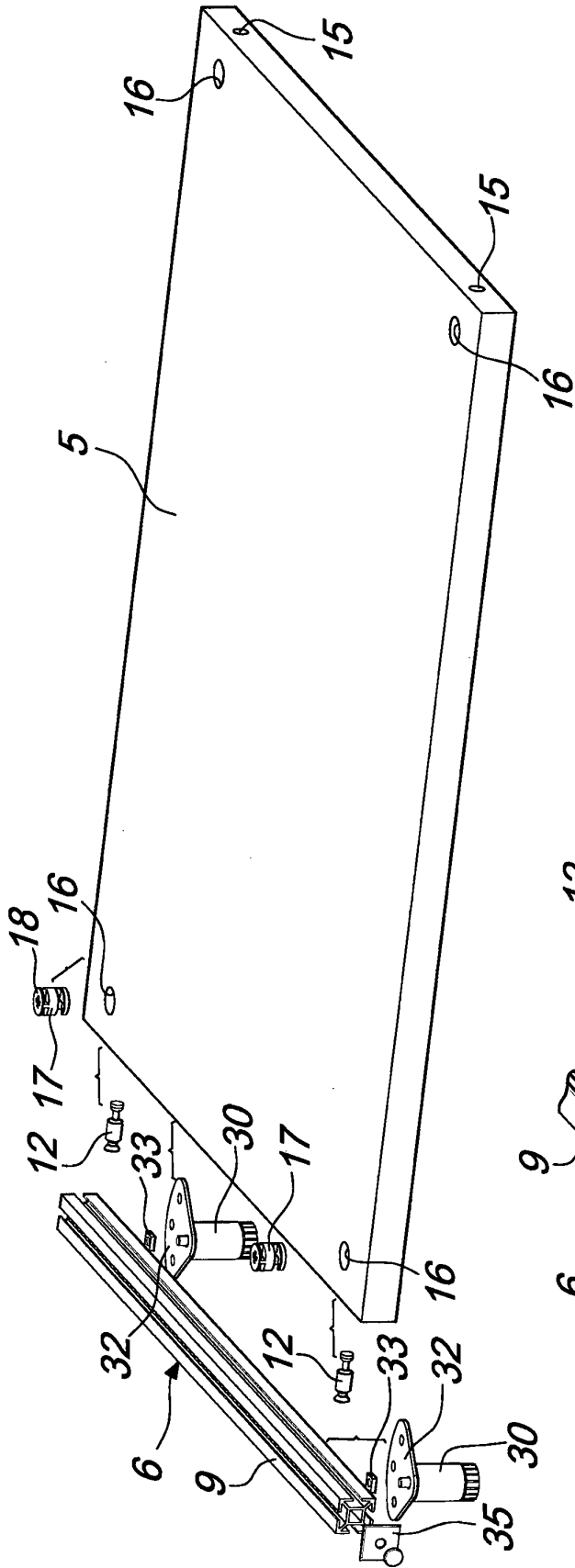

Fig. 8

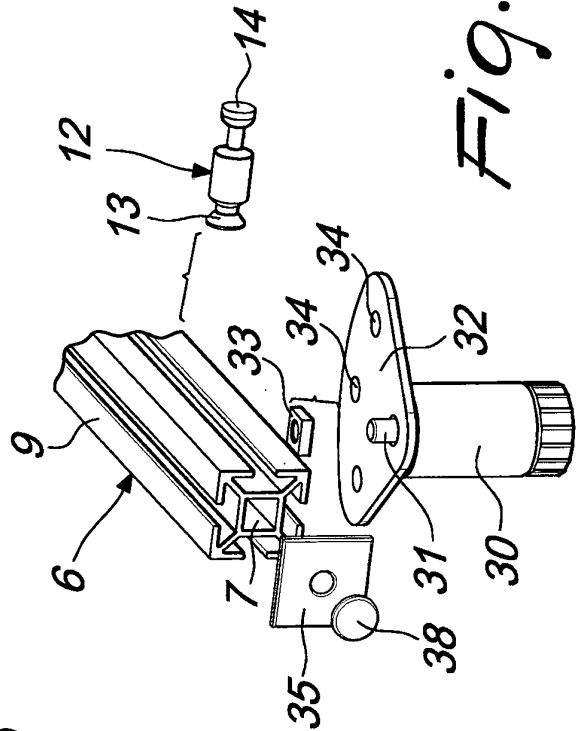

Fig. 9

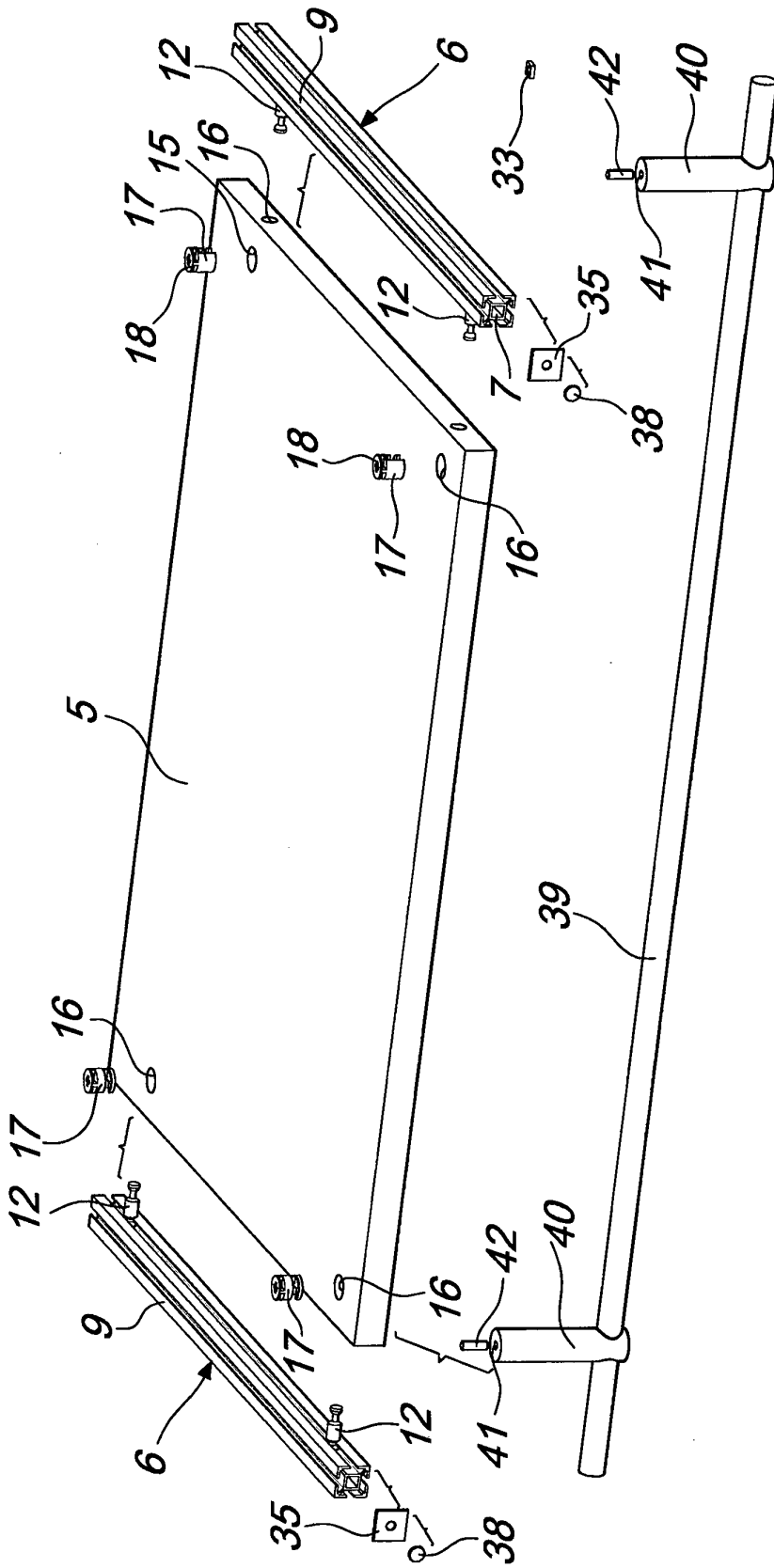

Fig. 10

REFERENCES CITED IN THE DESCRIPTION

This list of references cited by the applicant is for the reader's convenience only. It does not form part of the European patent document. Even though great care has been taken in compiling the references, errors or omissions cannot be excluded and the EPO disclaims all liability in this regard.

Patent documents cited in the description

- CH 692689 A5 [0004]