



## INTERNATIONAL APPLICATION PUBLISHED UNDER THE PATENT COOPERATION TREATY (PCT)

<p>(51) International Patent Classification <sup>6</sup> : <b>A63G 7/00</b></p>	<p><b>A1</b></p>	<p>(11) International Publication Number: <b>WO 99/22830</b></p> <p>(43) International Publication Date: 14 May 1999 (14.05.99)</p>
<p>(21) International Application Number: PCT/NL98/00617</p> <p>(22) International Filing Date: 26 October 1998 (26.10.98)</p> <p>(30) Priority Data: 1007411 31 October 1997 (31.10.97) NL</p> <p>(71) Applicant (for all designated States except US): VEKOMA TECHNOLOGY B.V. [NL/NL]; Schaapweg 18, NL-6063 BA Vlodrop (NL).</p> <p>(72) Inventors; and (75) Inventors/Applicants (for US only): CLERX, Petrus, Joseph, Hubertus [NL/NL]; Wapenstekereerf 12, NL-6043 Roermond (NL). PEETERS, Christiaan, Wilhelmus [NL/NL]; Tramstraat 46, NL-6088 EC Roggel (NL).</p> <p>(74) Agent: VAN KAN, J., J., H.; Algemeen Octrooibureau, World Trade Center, Pastoor Petersstraat 160, NL-5612 LV Eindhoven (NL).</p>	<p>(81) Designated States: AL, AM, AT, AT (Utility model), AU, AZ, BA, BB, BG, BR, BY, CA, CH, CN, CU, CZ, CZ (Utility model), DE, DE (Utility model), DK, DK (Utility model), EE, EE (Utility model), ES, FI, FI (Utility model), GB, GD, GE, GH, GM, HR, HU, ID, IL, IS, JP, KE, KG, KP, KR, KZ, LC, LK, LR, LS, LT, LU, LV, MD, MG, MK, MN, MW, MX, NO, NZ, PL, PT, RO, RU, SD, SE, SG, SI, SK, SK (Utility model), SL, TJ, TM, TR, TT, UA, UG, US, UZ, VN, YU, ZW, ARIPO patent (GH, GM, KE, LS, MW, SD, SZ, UG, ZW), Eurasian patent (AM, AZ, BY, KG, KZ, MD, RU, TJ, TM), European patent (AT, BE, CH, CY, DE, DK, ES, FI, FR, GB, GR, IE, IT, LU, MC, NL, PT, SE), OAPI patent (BF, BJ, CF, CG, CI, CM, GA, GN, GW, ML, MR, NE, SN, TD, TG).</p> <p><b>Published</b> With international search report. In English translation (filed in Dutch).</p>	

(54) Title: AMUSEMENT DEVICES AS WELL AS A HOLDER SUITABLE FOR SUCH AMUSEMENT DEVICES

## (57) Abstract

An amusement device comprising a guide construction forming a track, along which at least one vehicle is movable in a direction of transport, wherein the back of a person present in the vehicle extends substantially parallel to the track in use. The vehicle comprises a holder for said person, which at least comprises a seat support, a back support, a head support, an adjustable shoulder securing part and a leg securing part. The upper legs of said person abut against the seat support in use, wherein said person is moved along the track in a seated position, with his back parallel to the track.

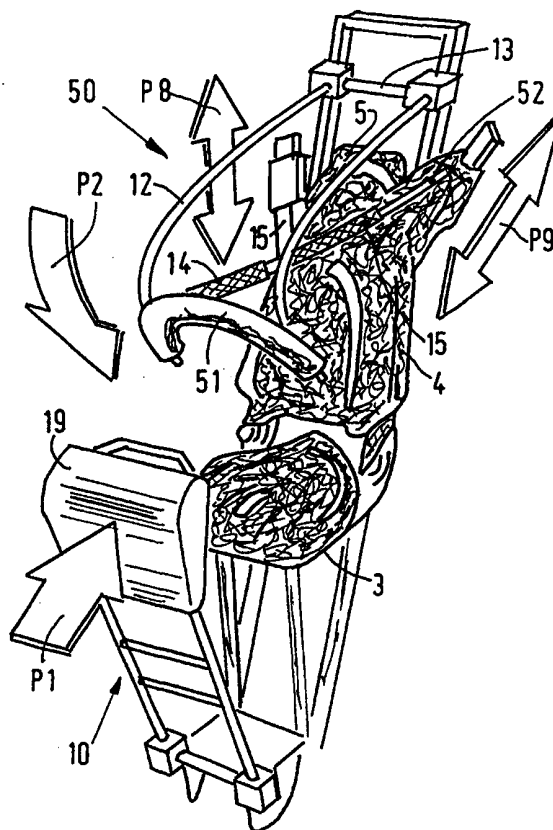

**FOR THE PURPOSES OF INFORMATION ONLY**

Codes used to identify States party to the PCT on the front pages of pamphlets publishing international applications under the PCT.

AL	Albania	ES	Spain	LS	Lesotho	SI	Slovenia
AM	Armenia	FI	Finland	LT	Lithuania	SK	Slovakia
AT	Austria	FR	France	LU	Luxembourg	SN	Senegal
AU	Australia	GA	Gabon	LV	Latvia	SZ	Swaziland
AZ	Azerbaijan	GB	United Kingdom	MC	Monaco	TD	Chad
BA	Bosnia and Herzegovina	GE	Georgia	MD	Republic of Moldova	TG	Togo
BB	Barbados	GH	Ghana	MG	Madagascar	TJ	Tajikistan
BE	Belgium	GN	Guinea	MK	The former Yugoslav Republic of Macedonia	TM	Turkmenistan
BF	Burkina Faso	GR	Greece			TR	Turkey
BG	Bulgaria	HU	Hungary	ML	Mali	TT	Trinidad and Tobago
BJ	Benin	IE	Ireland	MN	Mongolia	UA	Ukraine
BR	Brazil	IL	Israel	MR	Mauritania	UG	Uganda
BY	Belarus	IS	Iceland	MW	Malawi	US	United States of America
CA	Canada	IT	Italy	MX	Mexico	UZ	Uzbekistan
CF	Central African Republic	JP	Japan	NE	Niger	VN	Viet Nam
CG	Congo	KE	Kenya	NL	Netherlands	YU	Yugoslavia
CH	Switzerland	KG	Kyrgyzstan	NO	Norway	ZW	Zimbabwe
CI	Côte d'Ivoire	KP	Democratic People's Republic of Korea	NZ	New Zealand		
CM	Cameroon		Republic of Korea	PL	Poland		
CN	China	KR	Republic of Korea	PT	Portugal		
CU	Cuba	KZ	Kazakstan	RO	Romania		
CZ	Czech Republic	LC	Saint Lucia	RU	Russian Federation		
DE	Germany	LI	Liechtenstein	SD	Sudan		
DK	Denmark	LK	Sri Lanka	SE	Sweden		
EE	Estonia	LR	Liberia	SG	Singapore		

Amusement devices as well as a holder suitable for such amusement devices.

5 The invention relates to an amusement device comprising a guide construction forming a track, along which at least one vehicle is movable in a direction of transport, wherein the back of a person present in the vehicle extends substantially parallel to the track in use, which vehicle comprises a holder for said person, which at least comprises a seat support, a back support, a head support, an adjustable shoulder  
10 securing part and a leg securing part.

The invention furthermore relates to an amusement device comprising a guide construction forming a track, along which at least one vehicle, in which at least one person can be seated, is movable in a direction of transport, which vehicle comprises a holder for said person,  
15 which at least comprises a seat support, a back support, a head support, an adjustable shoulder securing part and a leg securing part.

The invention furthermore relates to a holder which is suitable for such amusement devices.

20 With a similar amusement device, which is known from International patent application WO 97/02878 of the applicant, the person is transported along the track in a position in which he hangs under said track. Said person's back, upper legs and lower legs extend parallel to the track thereby.

25 Since the person extends in fully stretched position along the track, the distance between two holders arranged one behind the other is partially determined by the length of the tallest person who can be seated in a holder. The persons who use the amusement device vary strongly in length, from a person 1.20 m tall to a relatively tall grown-up of 2.10 m.

30 Furthermore, the securing of a person in stretched position is relatively complicated.

Another drawback of transporting a person in fully stretched position is the fact that when a number of persons are positioned one behind the other, one person can look between the legs of the person  
35 positioned in front of him, which people find embarrassing.

The object of the invention is to provide an amusement device, wherein the person is transported along the track in a comfortable

position, whilst the distance between two successive holders can be relatively limited.

This objective is accomplished with the amusement device according to the invention in that at least the upper legs of said person abut against the seat support in use, wherein said person is moved along the track in a seated position, with his back parallel to the track.

Since the person has a position wherein his upper legs and his lower legs occupy a position which corresponds with a seated position, the total length of the person, seen in the direction of transport, is less than the length of said person in fully stretched position. This makes it possible to arrange the successive holders closer together than in the known device. Since both upper legs are furthermore supported by the seat support, skirt wearers in particular are protected against undesirable exposure.

One embodiment of the amusement device according to the invention is characterized in that said holder is furthermore provided with a hip securing device.

Said hip securing device provides an unequivocal fixation of a person in a direction parallel to and opposed to the direction of transport. The person is clamped between the seat support, the back support and the hip securing part, so that said person is unequivocally retained.

Another embodiment of the amusement device according to the invention is characterized in that said leg securing part comprises an adjustable knee securing part, which abuts at least against said person's knees in use.

A knee support is experienced as being relatively comfortable.

The position of a person's knees with respect to the seat support and the back support is determined by means of said knee securing part. With the amusement device according to the invention, the upper legs of the person are retained between the knee securing part and the seat support and/or the back support. At the same time, the lower legs are supported by the knee support.

Another object of the invention is to provide an amusement device which comprises a holder in which a person is secured in position in a simple and comfortable manner.

This objective is accomplished with the amusement device according to the invention in that said leg securing part comprises an adjustable knee securing part, which abuts against a person's knees in use, wherein said holder furthermore comprises a hip securing part.

5 It has become apparent that by securing a person's shoulders, hips and knees in with respect to the seat support and the back support, a person present in the holder is secured in position therein in a relatively adequate, simple and comfortable manner.

10 Another embodiment of the amusement device according to the invention is characterized in that said shoulder securing part, said hip securing part and said knee securing part are adjustable with respect to said seat support, wherein in use said person's seat is supported by said seat support.

15 Since the person is seated on the seat support, the adjustment of the three securing parts is relatively simple. As a result of the presence of the seat support, the position of the knees is known within relatively narrow bounds. The same applies to the hip position. With regard to the position of the shoulders, it applies that said position does not depend on the length of the person's legs, so that also the  
20 position of the shoulders will vary within relatively narrow bounds.

If a knee securing part is to be placed from a standing position, the height of the knees of different persons, that is, of a person about 1.20 m tall or of a relatively large grown-up having a length of 2.10 m, will vary within relatively wide bounds. The position of the  
25 shoulder part is not only determined by the length of the torso thereby, but also by the length of the legs.

Another embodiment of the amusement device according to the invention is characterized in that said shoulder securing part, said hip securing part and said knee securing part can be adjusted  
30 independently of each other.

Since the three securing parts, for the knees, the shoulders and the hip, are independently adjustable, the holder is suitable for persons of relatively widely varying dimensions.

35 The invention will be explained in more detail with respect to the drawings, wherein:

Figures 1A-1E are perspective views of a first embodiment of a holder according to the invention, showing said holder

in various positions thereof;

Figures 2A-2C are a perspective view, a side view and a front view respectively of a second embodiment of a holder according to the invention;

5                   Figures 3A-3C are a perspective view, a side view and a front view respectively of a holder according to a third embodiment of the invention;

10                   Figures 4A-4E are perspective views of the embodiment of Figure 3 of the holder according to the invention, showing various stages of the boarding procedure;

Figures 5A-5C are perspective views of a fourth embodiment of the invention, showing various positions thereof;

15                   Figures 6A and 6B show an amusement device according to the invention, which is provided with a holder according to the invention as shown in Figures 1A-1E.

Corresponding parts are indicated by the same numerals in the figures.

20                   Figure 1A shows a holder 1 for a person, which forms part of a vehicle of an amusement device according to the invention. Holder 1 is provided with a seat 2, which comprises a seat support 3, a back support 4 adjacent thereto, and a head support 5 adjacent to said back support. Seat 2 is mounted on a frame 6, which furthermore comprises a footboard 7. Holder 1 furthermore comprises a hip securing part 8, a shoulder securing part 9 and a knee securing part 10.

25                   Hip securing part 8 comprises a laterally extending bar 11, which is pivotally connected, by means of two pivoting arms 12 which are attached on either side thereof, to a laterally extending pivot pin 13, which is present near head support 5.

30                   Shoulder securing part 9 comprises two belts 14, which are attached to either side of head support 5 with one end 15 and which are attached to hip bar 11 with second end 16. Belts 14 are thereby crossed, as can be seen in Figure 1C, for example.

35                   Knee securing part 10 comprises a ladder-like construction 17, which pivots with a first end about a laterally extending pivot pin 18, which is present near footboard 7.

Ladder-like construction 17 comprises a dish-like portion 19 on a side remote from pivot pin 18, and a handle 20 which is

attached thereto.

The operation of holder 1 according to the invention is as follows. In the position of the securing parts 8, 9, 10 which is shown in Figure 1A, a person can step onto footboard 7 and seat himself on seat support 3. If said person is relatively small, he may use the steps of ladder-like construction 17 thereby. Once person 21 has seated himself on the seat support, he takes hold of handle 20 and pulls knee securing part 10 in the direction indicated by arrow P1, until dish-like portion 19 abuts against his knees 22. The person's upper legs 23 are now retained between dish-like portion 19 of knee securing part 10, seat support 3 and back support 4. His lower legs 24 abut against dish-like portion 19 thereby. Then person 21 takes hold of hip bar 11 and pivots it about pivot pin 13 in the direction indicated by arrow P2, until hip bar 11 abuts against the person at the transition between said person's torso 25 and his upper legs 23. By moving hip bar 13 in the direction indicated by arrow P2, belts 14 are simultaneously moved over the person's head 26, and the portions of belts 14 which are present near head support 5 are placed against the shoulders 27 of person 21. Once hip bar 11 has reached its end position, the first ends 15 of belts 14 are moved in a direction indicated by arrow P3, until the belts abut firmly against the shoulders 27 of person 21 (see Figure 1C). At that moment, person 21 is firmly retained in holder 1, with his head 26 supported against head support 5, his back supported against back support 4, his upper legs retained between dish-like portion 19 of knee securing part 10, seat support 3 and back support 4, and his lower legs supported against dish-like portion 19.

After it has been verified whether the shoulder securing part, the hip securing part and the knee securing part correctly secure the person in position, which can be done manually or by means of sensors, dish-like portion 19, hip bar 11 and belts 14 are locked in the end positions that have been reached. It is possible thereby to use locking arrangements which are known per se. The belts 14 may be used in combination with modified belt pensioners which are known from the automobile industry, which can be attached to the first ends 15 of belts 14. The belt pensioners which are used in the amusement device must keep the belts permanently tensioned and locked.

Figure 1D shows the eventual position of a person 21 who is secured in holder 1. Holder 1 forms part of a vehicle (not shown),

which can be moved by means of wheel sets 30 over a guide construction 31 forming a track. Such a track construction is known per se and will not be explained in more detail, therefore. Holder 1 is suitable for moving a person in seated position over a track. In addition to that, holder 1 is excellently suited for moving a person in a position in which he hangs under guide construction 31, as is shown in Figure 1E. After a person 21 has seated himself in holder 1, holder 1 with the person 21 retained therein is moved with respect to guide construction 31, in such a manner that the person comes to hang from the guide construction. In said hanging position, the total length of the person in the direction of transport is less than if said person would extend full length along the track, due to the fact that the person has pulled up his knees, as it were. As a result of this position, in which the persons are Z-shaped, as it were, the relative difference in length between tall and short persons in the direction of the track has been considerably reduced. Besides providing an adequate support for the person's seat, seat support 3 also protects said person against undesirable exposure. The manner in which the person is moved from a seated position on the track to a hanging position under the track forms part of another patent application of the applicant, and consequently it will be discussed only briefly herein with reference to Figures 6A-6D.

It is also possible to connect holder 1 to the guide construction near head support 5, whereby holder 1 can be moved to a position parallel to guide construction 31 in the manner indicated in WO 97/02878.

Figures 2A-2C are a perspective view, a side view and a front view respectively of a second embodiment of a holder 50 according to the invention, which largely corresponds with the embodiment of Figures 1A-1E. With the holder 50 as shown in Figures 2A-2C, hip bar 51 is curved more than hip bar 11. Belts 14 are connected with a first end 15 to belt pensioners 52, which are movable in directions obliquely away from head support 5, as indicated by double arrows P8 and P9 respectively. For a description of the operation of the holder 50 which is shown in Figures 2A-2C, reference is made to the description of the operation of holder 1.

Figures 3A-3C are a perspective view, a side view and a front view respectively of a third embodiment of a holder 35 according



to the invention. Holder 35 is provided with a seat 2, which comprises a seat support 3, a back support 4 adjacent thereto and a head support 5 adjacent to said back support. Seat 2 is mounted on a frame 6, which furthermore comprises a footboard 7. Holder 35 furthermore comprises a  
5 knee securing part 10 which corresponds with the knee securing part 10 as shown in Figures 1A-1E. Holder 35 furthermore comprises a hip securing part 36, which comprises a hip bar 37, which is pivotally connected, by means of two arms 38, to the laterally extending pivot pin 18, about which also ladder-like construction 17 of knee securing part 10 pivots.

10 Holder 35 is furthermore provided with a shoulder securing part 39, which comprises two shoulder bars 40 positioned on either side of head support 5, which each pivot on pivot pins 41 which extend in cranio-caudal direction. Pivot pins 41 are pivotally supported in supporting structures 42, which are movable in a direction substantially  
15 parallel to said cranio-caudal direction.

Figures 4A-4E show the operation of the holder 35 of Figures 3A-3C. In the position of securing parts 10, 35, 39 as shown in Figure 3A, a person 21 seats himself in seat 2. Then said person takes hold of hip bar 37 and pivots it about pivot pin 18 in the direction  
20 indicated by arrow P4 until said hip bar abuts against the transition between said person's torso 25 and his upper legs 23 (Figure 4B). Then person 21 pulls dish-like portion 19 of knee securing part 10 towards him, whereby said knee securing part 10 is pivoted in the direction indicated by arrow P1 (Figure 4C). Then the person takes hold of shoulder bars 40,  
25 one by one, and pivots them in the direction indicated by arrows P5 and P6 respectively. At the same time, said person pulls bars 40 in the cranio-caudal direction as indicated by arrow P7, as a result of which shoulder bars 40 come to abut against the shoulders of person 21 (Figure 4D). Then it is verified whether the shoulder securing part, the hip securing part  
30 and the knee securing part are correctly positioned, after which said securing parts are locked in their correct positions (Figure 4E). Person 21 is comfortably and securely retained in holder 35 in a relatively simple manner thereby. The person's head is freely movable in lateral direction, so that an unobstructed view in all directions is possible. The person's  
35 feet can be comfortably placed against one of the steps of ladder-like construction 17, thus enabling the person to actively support himself while the holder is being moved over the guide structure forming the track. This

is found to be pleasant.

Figures 5A-5C are perspective views of various positions of a holder 55 according to the invention. Holder 55 is provided with a seat 2, which comprises shoulder cushions 56 on either side of head support 5, through which the ends 15 of belts 14 extend. The ends 15 of belts 14 are attached to a rear side of seat 2 by means of belt tensioners. The ends of belts 14 remote from ends 15 are provided with belt tongues 57.

Holder 55 is furthermore provided with a hip bar 58, which can be pivoted, by means of an arm 59, about a pivot pin 18 which is present near footboard 7. Knee supports 60 are provided on either side of arm 59, which knee supports can be pivoted about pivot pin 18 by means of arms 61. Hip bar 58 is provided with two belt tongue locking mechanisms 62.

The operation of holder 55 is as follows. A person 21 seats himself in seat 2 in the position of holder 55 which is shown in Figure 5A. Then person 21 pulls hip bar 58 towards himself, whereby said hip bar is pivoted about pivot pin 18 in the direction indicated by arrow P10. Arm 59 is positioned between the upper legs 23 of said person thereby. Then said person takes hold of belt tongues 57 and inserts them into belt tongue locking mechanisms 62. Shoulder cushions 56 are bent, so that they will abut against said person's shoulders. This is shown in Figure 5C. Then the knee supports 60 are automatically pivoted about pivot pin 18, until the tiltable knee supports 60 abut against the knees of person 21. Once the belt tongues have been locked in position in the belt tongue locking mechanisms, hip bar 58 has been locked and knee supports 60 have been placed and subsequently locked, person 21 is securely retained in holder 55, after which holder 55 can be moved over a guide construction forming a track, whereby said person may occupy a seated position on said track or a hanging position under said track.

Figures 6A and 6B show the holder 1 of Figures 1A-1E in various positions A-F during boarding (positions A-D) and unboarding (positions D-E-F-A). In position A, the person seats himself in holder 1, after which hip securing part 8 and knee securing part 10 are pivoted in the direction indicated by arrows P2, P1 as discussed in great detail above with reference to Figures 1A-1E, and the holder takes up position B. Seat 2 is pivoted about pivot pin 75, in the direction indicated by arrow P21, to position C by means of a linear actuator 70, which is

pivotaly connected to seat 2 with one end 71 and to a chassis 74, which is provided with wheels 73, with another end 72. The person's back thereby extends parallel to guide construction 31 forming the track. Upper legs 23 and lower legs 24 are inclined at angles with respect to track 31, as  
5 a result of which the total length of holder 1 can be relatively limited. Holder 1 undergoes a rotation in a direction indicated by arrow P22 upon being moved in the direction of transport indicated by arrow P20, as a result of which holder 1 will be suspended from track 31. Subsequently, the holder is moved along track 31 in this position. At an unboarding  
10 station, the holder is successively moved from position D, via position E and position F to position A, from where the person can leave the amusement device.

## CLAIMS

1. An amusement device comprising a guide construction forming a track, along which at least one vehicle is movable in a direction of transport, wherein the back of a person present in the vehicle extends substantially parallel to the track in use, which vehicle comprises a holder for said person, which at least comprises a seat support, a back support, a head support, an adjustable shoulder securing part and a leg securing part, characterized in that at least the upper legs of said person abut against the seat support in use, wherein said person is moved along the track in a seated position, with his back parallel to the track.
2. An amusement device according to claim 1, characterized in that said holder furthermore comprises a hip securing part.
3. An amusement device according to claim 1 or 2, characterized in that said leg securing part comprises an adjustable knee securing part, which abuts at least against said person's knees in use.
4. An amusement device comprising a guide construction forming a track, along which at least one vehicle, in which at least one person can be seated, is movable in a direction of transport, which vehicle comprises a holder for said person, which at least comprises a seat support, a back support, a head support, an adjustable shoulder securing part and a leg securing part, characterized in that said leg securing part comprises an adjustable knee securing part, which abuts against a person's knees in use, wherein said holder furthermore comprises a hip securing part.
5. An amusement device according to any one of the preceding claims, characterized in that said shoulder securing part, said hip securing part and said knee securing part are adjustable with respect to said seat support, wherein said person's seat is supported by said seat support in use.
6. An amusement device according to any one of the preceding claims, characterized in that said shoulder securing part, said hip securing part and said knee securing part can be adjusted independently of each other.
7. An amusement device according to any one of the preceding claims, characterized in that said knee securing part furthermore comprises a lower leg support.

8. An amusement device according to any one of the preceding claims, characterized in that said knee securing part furthermore comprises a foot support.
- 5 9. An amusement device according to any one of the preceding claims, characterized in that said hip securing part comprises a bar which extends laterally with respect to said person, which bar pivots with at least one arm about a pivot pin which is present near said head support.
- 10 10. An amusement device according to any one of the preceding claims 1 - 8, characterized in that said hip securing part comprises a bar which extends laterally with respect to said person, which bar pivots about a laterally extending pivot pin which is present near said person's feet.
- 15 11. An amusement device according to any one of the preceding claims, characterized in that said knee securing part pivots about a laterally extending pivot pin which is present near said person's feet.
- 20 12. An amusement device according to any one of the preceding claims, characterized in that the pivot axis of the knee securing part coincides with the pivot axis of the hip securing part.
- 25 13. An amusement device according to any one of the preceding claims, characterized in that said shoulder securing part comprises at least two belts, which are each connected to said holder, near a shoulder, with a first end and which are connected to said hip securing part with a second end.
- 30 14. An amusement device according to claim 13, characterized in that the first ends of said belts are adjustable at least in cranio-caudal direction.
- 35 15. An amusement device according to claim 13 or 14, characterized in that said belts can be tensioned.
16. An amusement device according to any one of the preceding claims, characterized in that said holder can be tilted with respect to the track, to a position wherein the cranio-caudal direction of said person is parallel to the direction of transport.
17. An amusement device according to any one of the preceding claims, characterized in that said shoulder securing part comprises two shoulder bars, which pivot about a pivot pin which extends

substantially in cranio-caudal direction, and which are adjustable at least in cranio-caudal direction.

18. A holder according to any one of the preceding claims.

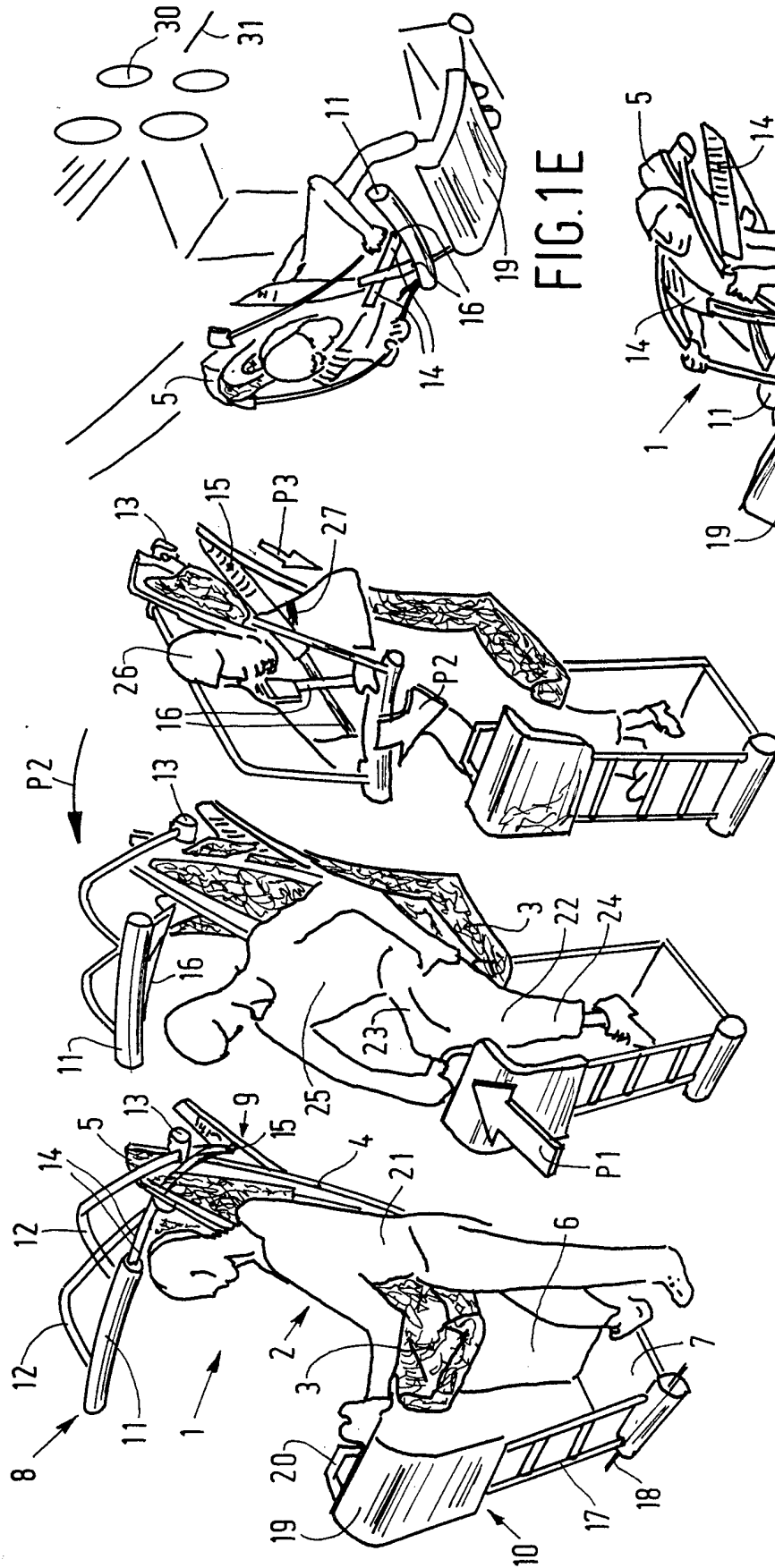

FIG. 1A

FIG. 1B

FIG. 1C

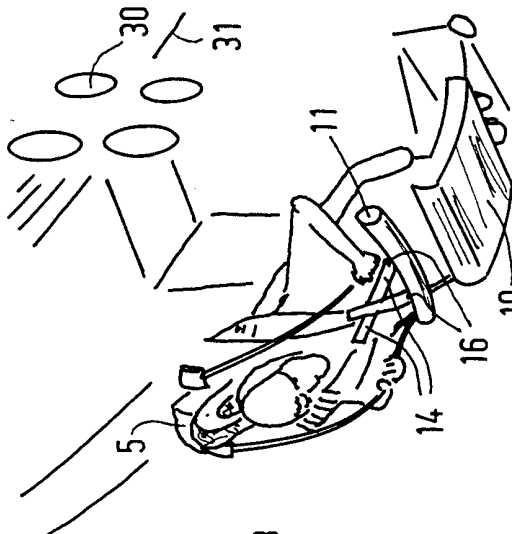

FIG. 1E

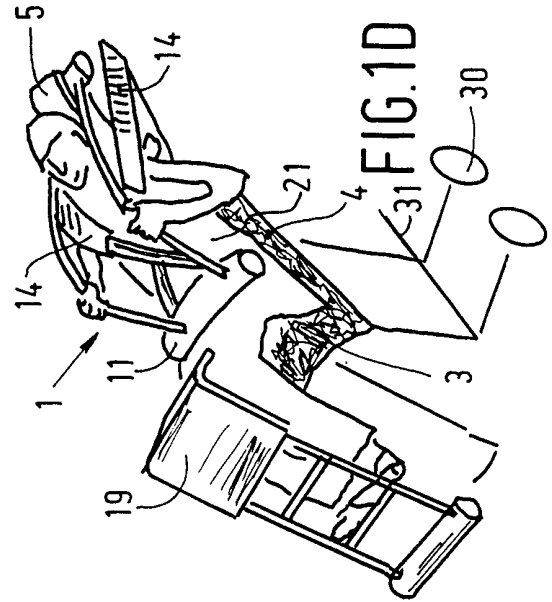

FIG. 1D

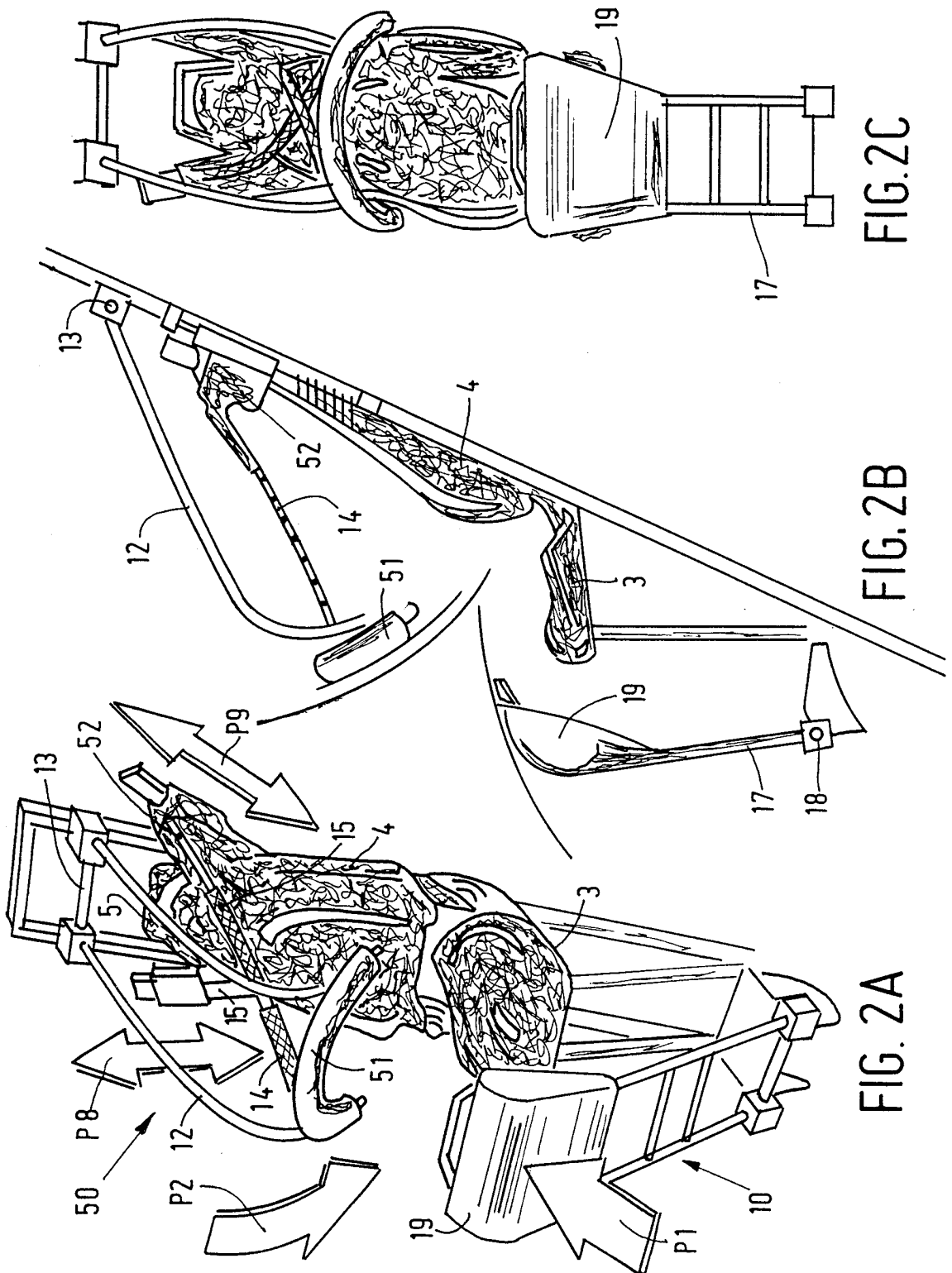

FIG. 2C

FIG. 2B

FIG. 2A



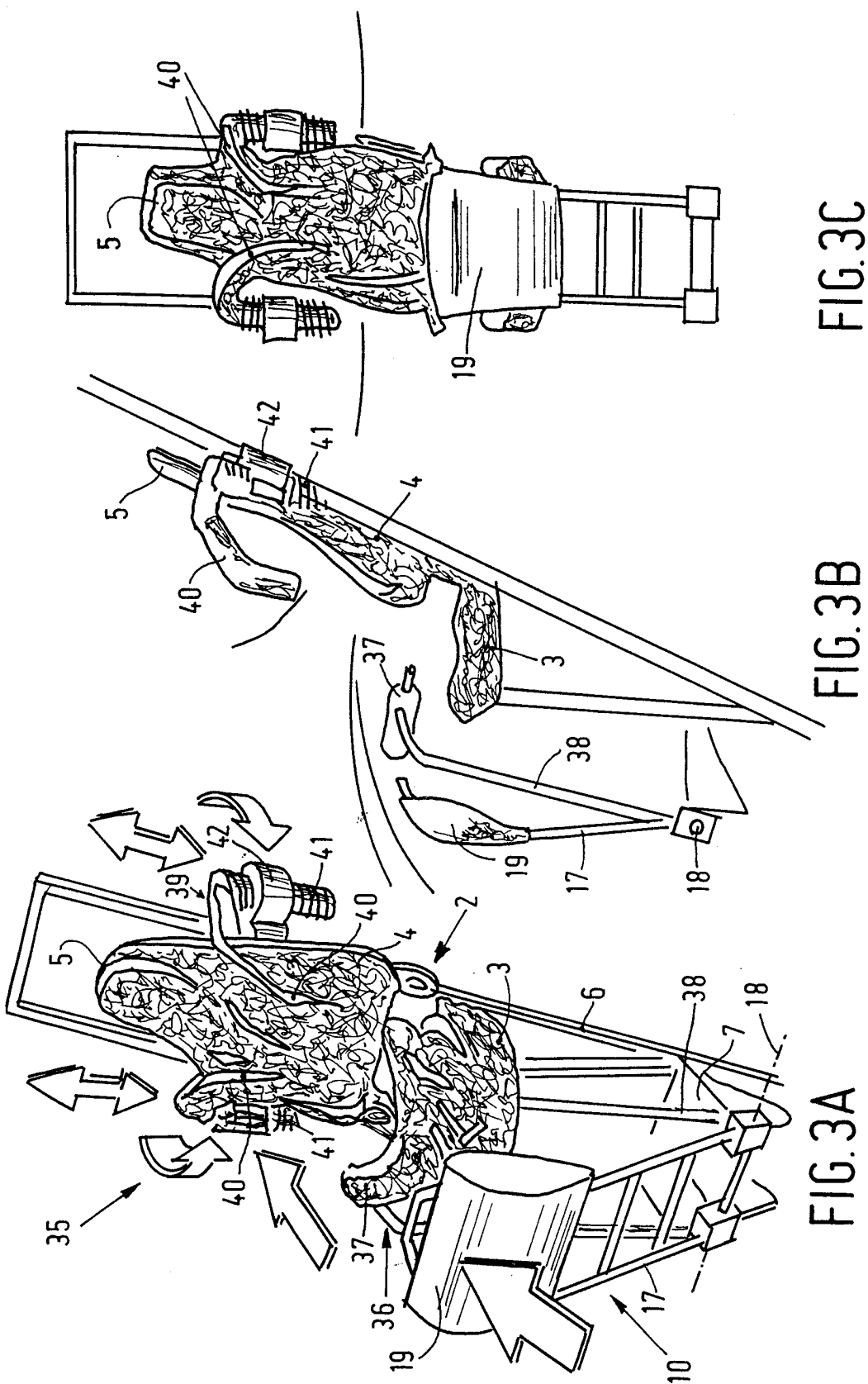

FIG. 3C

FIG. 3B

FIG. 3A

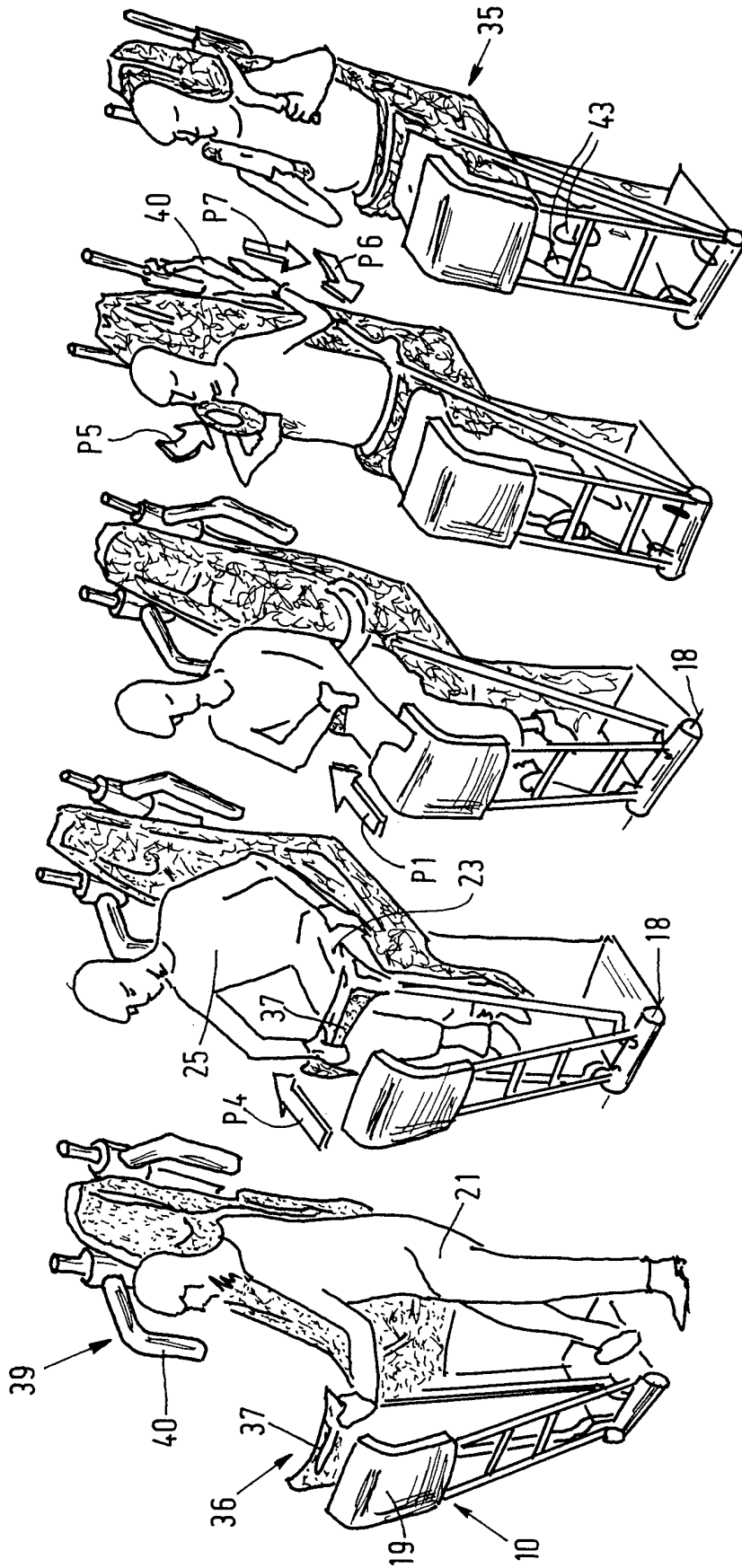

FIG. 4E

FIG. 4D

FIG. 4C

FIG. 4B

FIG. 4A

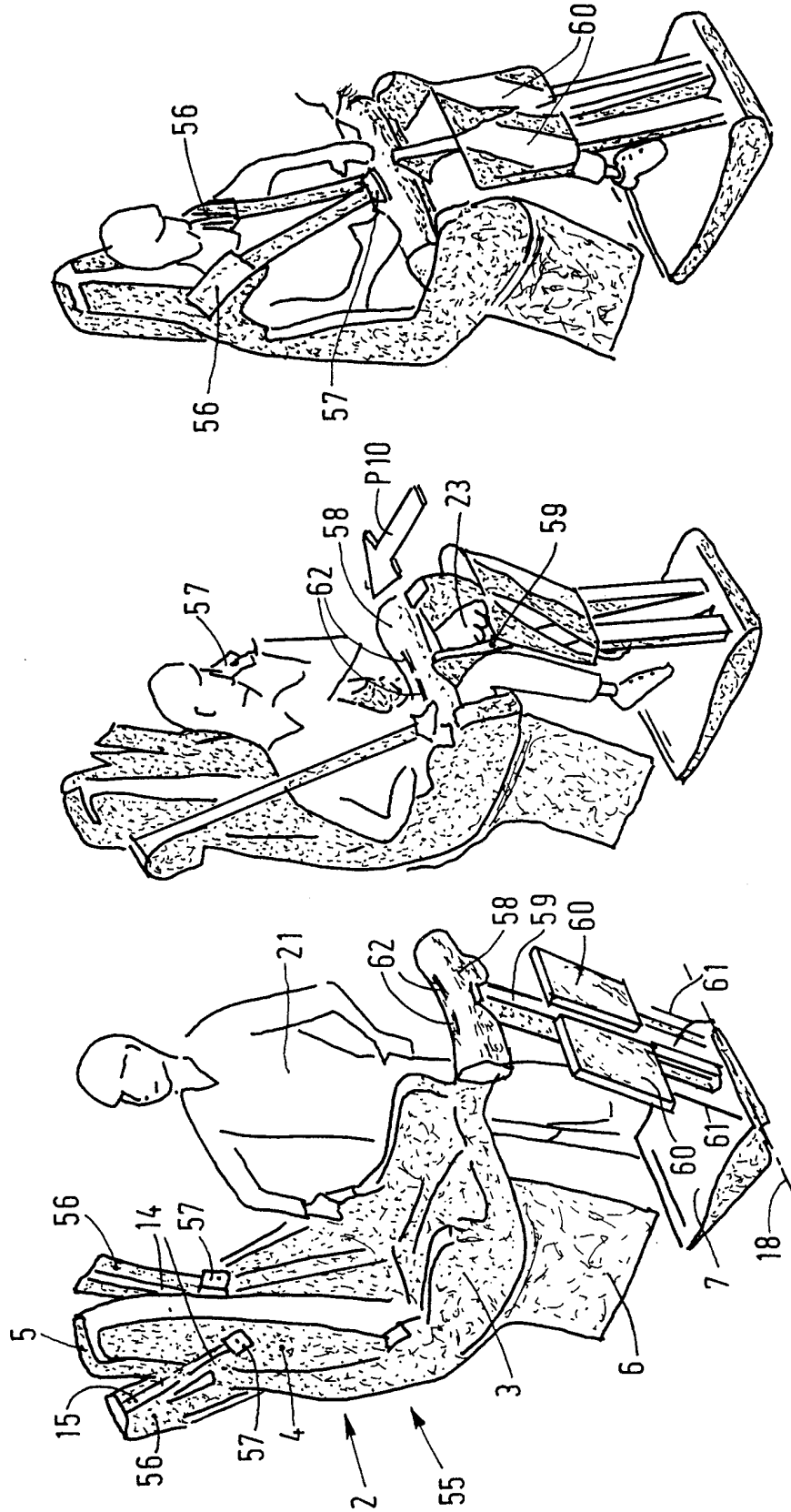

FIG. 5C

FIG. 5B

FIG. 5A

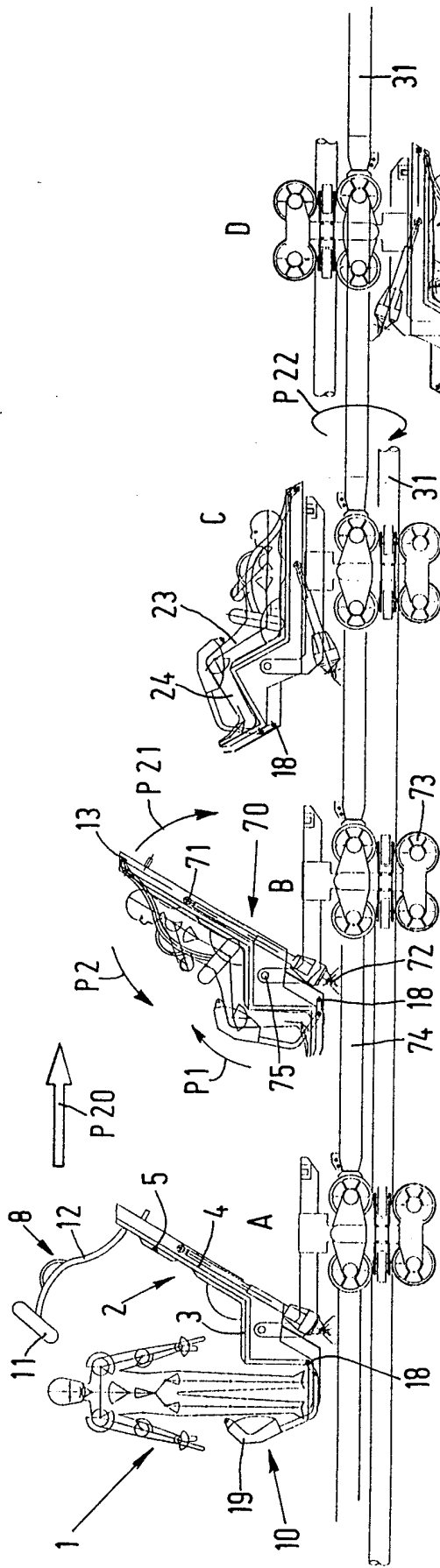

FIG. 6A

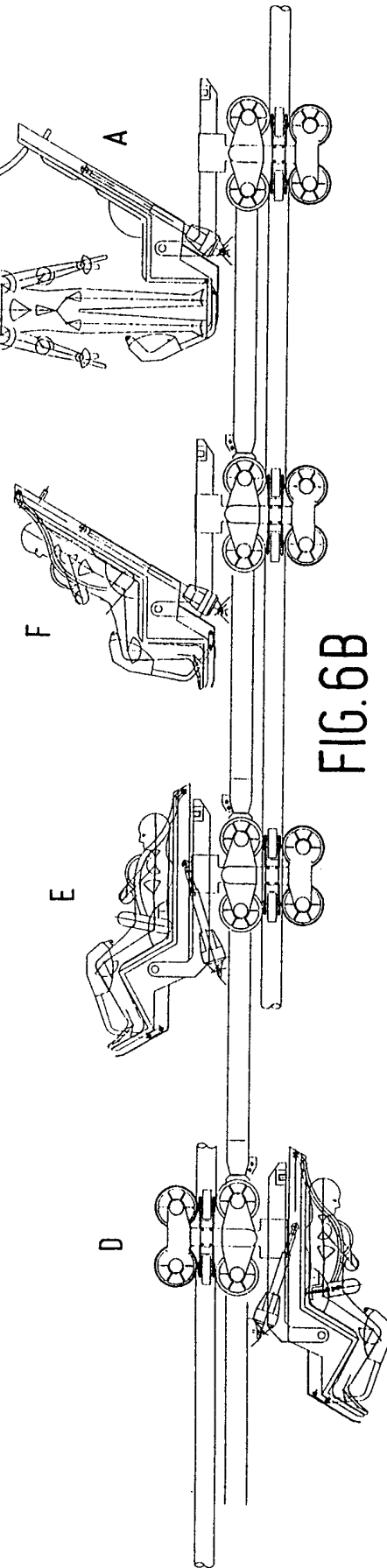

FIG. 6B

# INTERNATIONAL SEARCH REPORT

Int: ional Application No

PCT/NL 98/00617

**A. CLASSIFICATION OF SUBJECT MATTER**  
IPC 6 A63G7/00

According to International Patent Classification (IPC) or to both national classification and IPC

**B. FIELDS SEARCHED**

Minimum documentation searched (classification system followed by classification symbols)  
IPC 6 A63G

Documentation searched other than minimum documentation to the extent that such documents are included in the fields searched

Electronic data base consulted during the international search (name of data base and, where practical, search terms used)

**C. DOCUMENTS CONSIDERED TO BE RELEVANT**

Category °	Citation of document, with indication, where appropriate, of the relevant passages	Relevant to claim No.
A	WO 97 02878 A (VEKOMA INTERNATIONAL B V ;HUBEN JACOB HUBERT MARIE (BE); CLERX PE) 30 January 1997 cited in the application see the whole document	1, 4, 18
A	DE 32 37 684 A (TOGO KK) 28 April 1983 see claims 1-9; figures	1
A	DE 36 29 495 A (GIOVANOLA FRERES SA ;INTAMIN AG (CH)) 26 March 1987 see column 2, line 64 - column 3, line 54; figure 1	1

Further documents are listed in the continuation of box C.

Patent family members are listed in annex.

° Special categories of cited documents :

"A" document defining the general state of the art which is not considered to be of particular relevance

"E" earlier document but published on or after the international filing date

"L" document which may throw doubts on priority claim(s) or which is cited to establish the publication date of another citation or other special reason (as specified)

"O" document referring to an oral disclosure, use, exhibition or other means

"P" document published prior to the international filing date but later than the priority date claimed

"T" later document published after the international filing date or priority date and not in conflict with the application but cited to understand the principle or theory underlying the invention

"X" document of particular relevance; the claimed invention cannot be considered novel or cannot be considered to involve an inventive step when the document is taken alone

"Y" document of particular relevance; the claimed invention cannot be considered to involve an inventive step when the document is combined with one or more other such documents, such combination being obvious to a person skilled in the art.

"&" document member of the same patent family

Date of the actual completion of the international search

3 February 1999

Date of mailing of the international search report

09/02/1999

Name and mailing address of the ISA

European Patent Office, P.B. 5818 Patentlaan 2  
NL - 2280 HV Rijswijk  
Tel. (+31-70) 340-2040, Tx. 31 651 epo nl,  
Fax: (+31-70) 340-3016

Authorized officer

Baert, F

# INTERNATIONAL SEARCH REPORT

Information on patent family members

International Application No

PCT/NL 98/00617

Patent document cited in search report	A	Publication date	Patent family member(s)	Publication date
WO 9702878	A	30-01-1997	NL 1000774	C 14-01-1997
			AU 6293796	A 10-02-1997
			CA 2225171	A 30-01-1997
DE 3237684	A	28-04-1983	JP 58183333	A 26-10-1983
			JP 1609398	C 28-06-1991
			JP 2034811	B 07-08-1990
			JP 58183334	A 26-10-1983
			JP 58183335	A 26-10-1983
			JP 1038699	B 16-08-1989
			JP 1556279	C 23-04-1990
			JP 58065185	A 18-04-1983
			CA 1190569	A 16-07-1985
			GB 2114900	A, B 01-09-1983
			US 4531459	A 30-07-1985
DE 3629495	A	26-03-1987	CH 664502	A 15-03-1988
			US 4700632	A 20-10-1987