

(19) World Intellectual Property  
Organization

International Bureau

(43) International Publication Date  
14 September 2017 (14.09.2017)



(10) International Publication Number  
**WO 2017/155821 A8**

(51) International Patent Classification:  
A61B 17/14 (2006.01)

(21) International Application Number:  
PCT/US2017/020731

(22) International Filing Date:  
03 March 2017 (03.03.2017)

(25) Filing Language: English

(26) Publication Language: English

(30) Priority Data:  
62/304,160 05 March 2016 (05.03.2016) US

(71) Applicant: STRYKER EUROPEAN HOLDINGS I,  
LLC [US/US]; 2825 Airview Boulevard, Kalamazoo, MI  
49002 (US).

(72) Inventors: NUNAN, Gerard; Ballincollig, Co. Cork (IE).  
WALEN, James; 3621 Fleetwood Dr., Portage, MI 49024  
(US). GOLDENBERG, David; 65760 22nd Street, Mat-  
tawan, MI 49071 (US).

(74) Agent: WOOLBRIGHT, Jacob P.; Howard & Howard  
Attorneys PLLC, 450 West Fourth Street, Royal Oak, MI  
48067 (US).

(81) Designated States (unless otherwise indicated, for every  
kind of national protection available): AE, AG, AL, AM,  
AO, AT, AU, AZ, BA, BB, BG, BH, BN, BR, BW, BY, BZ,  
CA, CH, CL, CN, CO, CR, CU, CZ, DE, DJ, DK, DM, DO,  
DZ, EC, EE, EG, ES, FI, GB, GD, GE, GH, GM, GT, HN,  
HR, HU, ID, IL, IN, IR, IS, JP, KE, KG, KH, KN, KP, KR,  
KW, KZ, LA, LC, LK, LR, LS, LU, LY, MA, MD, ME, MG,  
MK, MN, MW, MX, MY, MZ, NA, NG, NI, NO, NZ, OM,  
PA, PE, PG, PH, PL, PT, QA, RO, RS, RU, RW, SA, SC,  
SD, SE, SG, SK, SL, SM, ST, SV, SY, TH, TJ, TM, TN, TR,  
TT, TZ, UA, UG, US, UZ, VC, VN, ZA, ZM, ZW.

(84) Designated States (unless otherwise indicated, for every  
kind of regional protection available): ARIPO (BW, GH,  
GM, KE, LR, LS, MW, MZ, NA, RW, SD, SL, ST, SZ, TZ,  
UG, ZM, ZW), Eurasian (AM, AZ, BY, KG, KZ, RU, TJ,  
TM), European (AL, AT, BE, BG, CH, CY, CZ, DE, DK,  
EE, ES, FI, FR, GB, GR, HR, HU, IE, IS, IT, LT, LU, LV,  
MC, MK, MT, NL, NO, PL, PT, RO, RS, SE, SI, SK, SM,

(54) Title: SURGICAL BLADE CARTRIDGE WITH A GUIDE BAR HAVING FEATURES TO CONTROL THE DEPTH OF THE CUT FORMED WITH THE CARTRIDGE

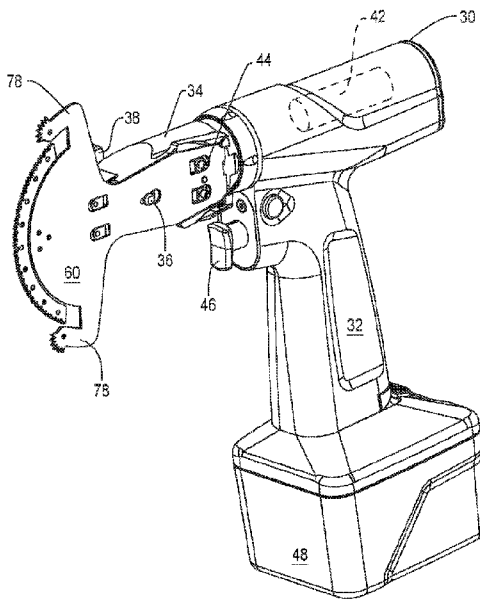

FIG. 1

(57) Abstract: A surgical saw blade cartridge that includes a static bar (62) adapted to be secured to a saw, a blade (150) that is movably attached to the bar and a drive link (130) that oscillates the blade. The bar also includes a feature (82, 84) that extends forward of the blade. The feature is positioned to abut tissue adjacent the tissue against which the blade is pressed so as to limit the movement of the bar and blade relative to the tissue.



WO 2017/155821 A8

TR), OAPI (BF, BJ, CF, CG, CI, CM, GA, GN, GQ, GW,  
KM, ML, MR, NE, SN, TD, TG).

**Published:**

— *with international search report (Art. 21(3))*

**(48) Date of publication of this corrected version:**

28 December 2017 (28.12.2017)

**(15) Information about Correction:**

see Notice of 28 December 2017 (28.12.2017)