



US00D937983S

(12) **United States Design Patent**
Para

(10) **Patent No.:** **US D937,983 S**

(45) **Date of Patent:** **** Dec. 7, 2021**

(54) **FAUCET BODY**

(71) Applicant: **DELTA FAUCET COMPANY,**
Indianapolis, IN (US)

(72) Inventor: **Lauren Para,** Lisle, IL (US)

(73) Assignee: **DELTA FAUCET COMPANY,**
Indianapolis, IN (US)

(**) Term: **15 Years**

(21) Appl. No.: **29/732,329**

(22) Filed: **Apr. 23, 2020**

(51) **LOC (13) Cl.** **23-01**

(52) **U.S. Cl.**
USPC **D23/249**

(58) **Field of Classification Search**
USPC D23/238-243, 249, 309, 250, 252, 254,
D23/255, 256, 257, 245; D8/300, 307,
D8/308

CPC Y10T 137/9464; E03C 1/00; E03C 1/02;
E03C 1/04; E03C 1/0412; E03C 1/042;
E03C 1/044; E03C 1/048; E03C 1/05;
E03C 1/052

See application file for complete search history.

(56) **References Cited**

U.S. PATENT DOCUMENTS

D328,850 S * 8/1992 Marques D8/308
D456,063 S * 4/2002 McKeone D23/249
D519,190 S * 4/2006 Lord D23/238

D526,049 S * 8/2006 Lord D23/249
D574,469 S * 8/2008 Soriano D23/255
D677,367 S * 3/2013 Chen D23/255
D695,381 S * 12/2013 Flowers D23/238
D713,939 S * 9/2014 Mazz D23/252
D762,286 S * 7/2016 Pony D23/238
D839,391 S * 1/2019 Eads D23/252
D870,853 S * 12/2019 Garland D23/238

FOREIGN PATENT DOCUMENTS

PH 3-2007-510 * 8/2007

* cited by examiner

Primary Examiner — Sheryl Lane

Assistant Examiner — Samantha N Wood

(74) *Attorney, Agent, or Firm* — Nirav D. Parikh; Edgar
A. Zarins

(57) **CLAIM**

The ornamental design for a faucet body, as shown and
described.

DESCRIPTION

FIG. 1 is a front perspective view of a faucet body showing
my new design;

FIG. 2 is a rear perspective view thereof;

FIG. 3 is a front elevational view thereof;

FIG. 4 is a left side view thereof;

FIG. 5 is a rear view thereof;

FIG. 6 is a right side view thereof;

FIG. 7 is a top plan view thereof; and,

FIG. 8 is a bottom view thereof.

1 Claim, 4 Drawing Sheets

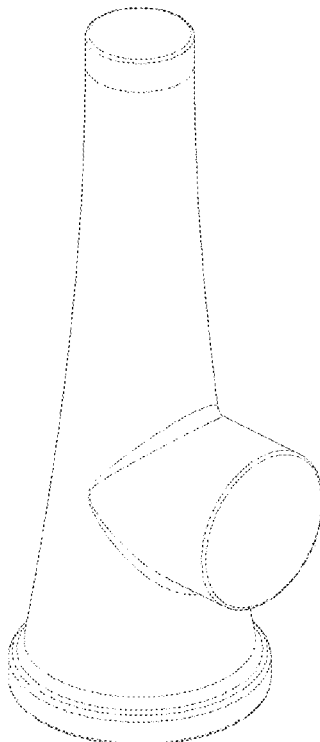

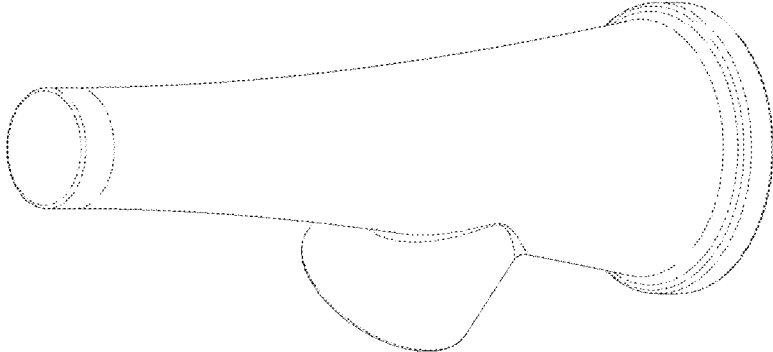

FIG - 2

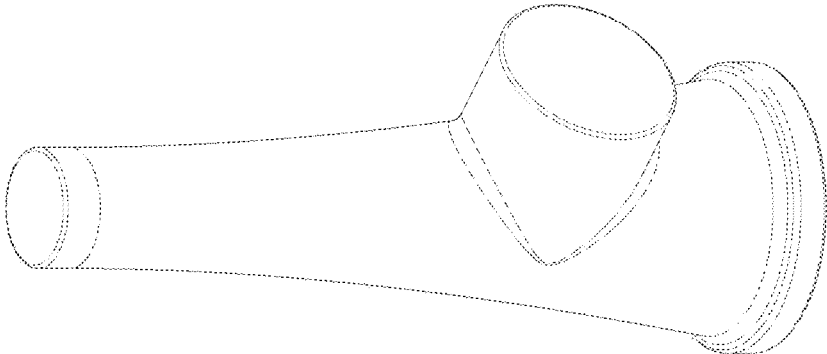

FIG - 1

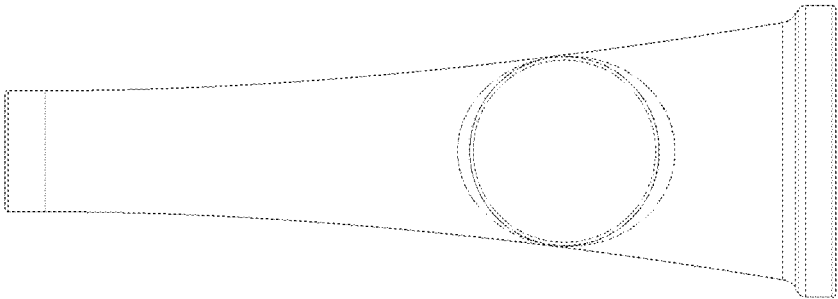

FIG - 4

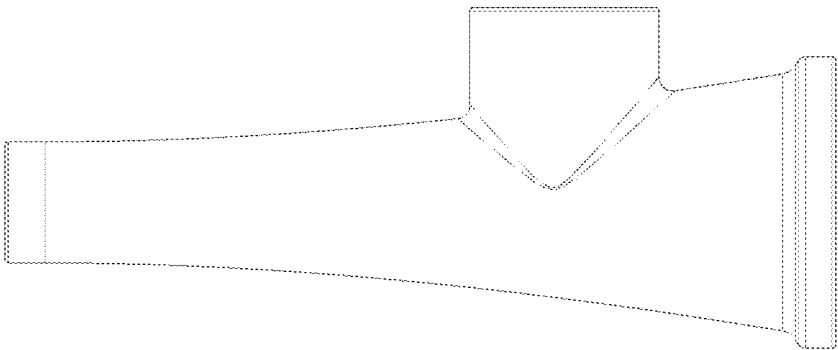

FIG - 3

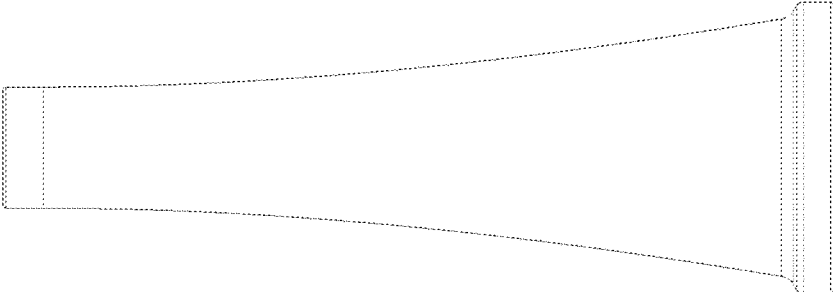

FIG. 6

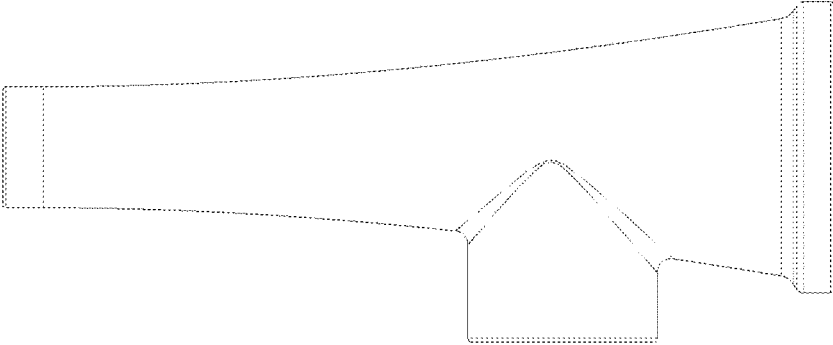

FIG. 5

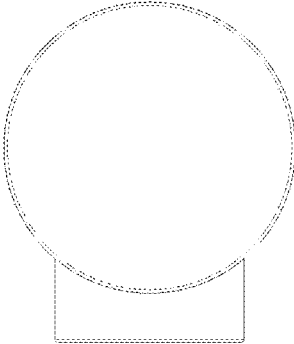

FIG. - 8

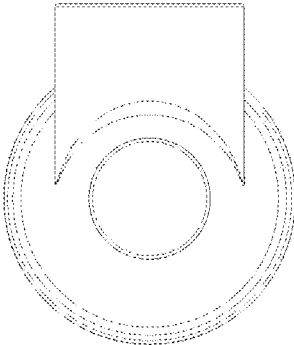

FIG. - 7