

(19) World Intellectual Property
Organization
International Bureau



(43) International Publication Date
4 August 2005 (04.08.2005)

PCT

(10) International Publication Number
WO 2005/071799 A1

- (51) International Patent Classification⁷: **H01R 13/41**, 13/422
- (21) International Application Number: PCT/US2005/002115
- (22) International Filing Date: 21 January 2005 (21.01.2005)
- (25) Filing Language: English
- (26) Publication Language: English
- (30) Priority Data: 10/763,715 23 January 2004 (23.01.2004) US
- (71) Applicant (for all designated States except US): **MOLEX INCORPORATED** [US/US]; 2222 Wellington Court, Lisle, IL 60532 (US).
- (72) Inventors: **AMARA, James, Frank**; 53396 Freda, Macomb, MI 48042 (US). **BUTCHER, Anthony**; 3800 Darleen Court, Troy, MI 48084 (US). **SYNNESTVEDT, Blake**; 1365 Puritan, Birmingham, MI 48009 (US).
- (74) Agent: **CALDWELL, Stacey, E.**; Molex Incorporated, 2222 Wellington Court, Lisle, IL 60532 (US).
- (81) Designated States (unless otherwise indicated, for every kind of national protection available): AE, AG, AL, AM, AT, AU, AZ, BA, BB, BG, BR, BW, BY, BZ, CA, CH, CN, CO, CR, CU, CZ, DE, DK, DM, DZ, EC, EE, EG, ES, FI, GB, GD, GE, GH, GM, HR, HU, ID, IL, IN, IS, JP, KE, KG, KP, KR, KZ, LC, LK, LR, LS, LT, LU, LV, MA, MD, MG, MK, MN, MW, MX, MZ, NA, NI, NO, NZ, OM, PG, PH, PL, PT, RO, RU, SC, SD, SE, SG, SK, SL, SY, TJ, TM, TN, TR, TT, TZ, UA, UG, US, UZ, VC, VN, YU, ZA, ZM, ZW.
- (84) Designated States (unless otherwise indicated, for every kind of regional protection available): ARIPO (BW, GH, GM, KE, LS, MW, MZ, NA, SD, SL, SZ, TZ, UG, ZM, ZW), Eurasian (AM, AZ, BY, KG, KZ, MD, RU, TJ, TM), European (AT, BE, BG, CH, CY, CZ, DE, DK, EE, ES, FI, FR, GB, GR, HU, IE, IS, IT, LT, LU, MC, NL, PL, PT, RO, SE, SI, SK, TR), OAPI (BF, BJ, CF, CG, CI, CM, GA, GN, GQ, GW, ML, MR, NE, SN, TD, TG).

[Continued on next page]

(54) Title: ELECTRICAL CONNECTOR INCLUDING AN IMPROVED TERMINAL

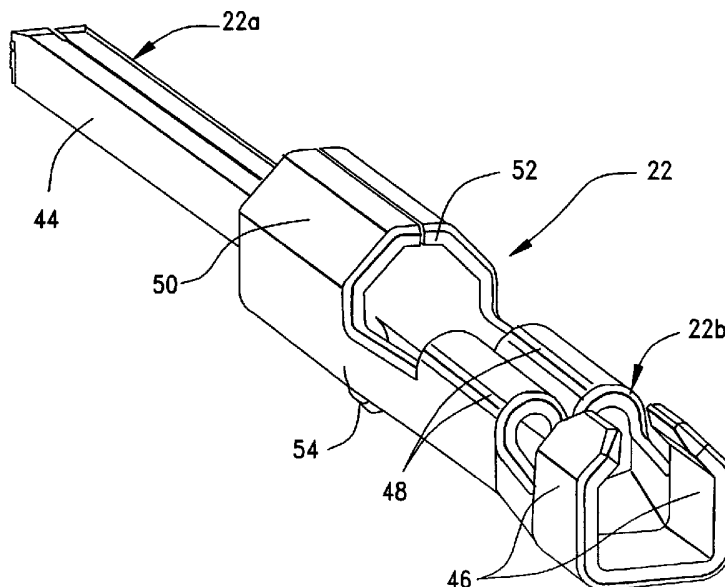

(57) Abstract: An electrical connector includes a dielectric housing having a plurality of terminal receiving passages. An end cap is coupled to a rear end of the housing and includes a plurality of through passages aligned with the terminal-receiving passages in the housing. A plurality of conductive terminals are insertable into the terminal-receiving passages in the housing from the rear termination end thereof through the through passages in the end cap. Each terminal includes a rear terminating end comprising a crimp section for crimping onto an electrical wire. The cross-sectional configuration of the crimp section and the cross-sectional configuration of the through passages in the end cap are such that the terminals are prevented from rotating as the crimp section passes through the through passages in the end cap.

WO 2005/071799 A1



Published:

- *with international search report*
- *before the expiration of the time limit for amending the claims and to be republished in the event of receipt of amendments*

For two-letter codes and other abbreviations, refer to the "Guidance Notes on Codes and Abbreviations" appearing at the beginning of each regular issue of the PCT Gazette.

ELECTRICAL CONNECTOR INCLUDING AN IMPROVED TERMINAL

FIELD OF THE INVENTION

This invention generally relates to the art of electrical connectors and, particularly, to
5 a connector assembly which prevents rotation of the connector terminals during insertion of
the terminals into the connector.

BACKGROUND OF THE INVENTION

Generally, a typical electrical connector includes some form of insulating or
10 dielectric housing which mounts a plurality of conductive terminals. For instance, the
housing may be molded of plastic material, and the terminals may be stamped and formed of
sheet metal material. The connector housing typically has a front mating end and a rear
termination end. Each terminal includes a front contact end and a rear terminating end. The
front mating end is constructed for mating with a complementary connecting device such as
15 a mating connector. The termination end of the housing is where the terminals are
terminated to appropriate conductors which can range from discrete electrical wires to the
circuit traces on a printed circuit board. For instance, the rear terminating ends of the
terminals may be crimped to the inner conductors of insulated electrical wires.

During assembly of an electrical connector as described above, the conductive
20 terminals often are inserted into a plurality of terminal-receiving passages through the rear
termination end of the connector housing. Problems continue to be encountered during this
process because of the tendency of the terminals to rotate out of their intended orientations
during their insertion into the housing. This problem is magnified when the connector
assembly includes such components as rear seals, rear end caps to hold the seals in assembly
25 or other additional connector components at the rear of the connector housing. These
additional components, in essence, lengthen the terminal-receiving passages into which the
terminals are inserted and, thereby, increase the probability that the terminals will rotate out
of their intended orientations during the terminal insertion process. This invention is
directed to solving these various problems.

SUMMARY OF THE INVENTION

An object, therefore, of the invention is to provide a new and improved electrical connector and an electrical terminal of the character described.

In the exemplary embodiment of the invention, the connector includes a dielectric housing having a front mating end, a rear termination end and a plurality of terminal-receiving passages extending between the ends. An end cap is coupled to the rear termination end of the housing and includes a plurality of through passages aligned with the terminal-receiving passages in the housing. Each through passage has a polygonal cross-sectional configuration. A plurality of conductive terminals are insertable into the terminal-receiving passages in the housing from the rear termination end thereof through the through passages in the end cap. Each terminal includes a front contact end for engaging an appropriate contact of a complementary mating connector and a rear terminating end comprising a crimp section for crimping onto an electrical wire. The crimp section has a polygonal cross-sectional configuration matching that of the through passages in the end cap to prevent rotation of the terminals when the contact ends are located in the terminal-receiving passages in the housing as the terminals are inserted thereinto.

As disclosed herein, the crimp section comprises a first crimp section and is sized for crimping onto an outer insulation of the electrical wire. A second crimp section is located forwardly of the first crimp section and is provided for crimping onto an inner conductor of the electrical wire.

According to one aspect of the invention, a reinforcing box section is provided between the front contact end and the rear crimp section of each terminal. The box section has a polygonal cross-sectional configuration matching that of the crimp section to initially align the terminals upon insertion into the polygonal through passages of the end cap.

Therefore, the invention contemplates an electrical terminal wherein the rear crimp section and the intermediate box section both are configured to prevent rotation of the terminal during insertion of the terminal into its respective terminal-receiving passage. The box section prevents rotation of the terminal during an initial stage of insertion, and the crimp section prevents rotation of the terminal during a later stage of insertion.

Other objects, features and advantages of the invention will be apparent from the following detailed description taken in connection with the accompanying drawings.

BRIEF DESCRIPTION OF THE DRAWINGS

The features of this invention which are believed to be novel are set forth with particularity in the appended claims. The invention, together with its objects and the advantages thereof, may be best understood by reference to the following description taken
5 in conjunction with the accompanying drawings, in which like reference numerals identify like elements in the figures and in which:

FIG. 1 is a perspective view of the front mating end of an electrical connector embodying the concepts of the invention;

FIG. 2 is a perspective view of the rear termination end of the connector;

10 FIG. 3 is an exploded perspective view of the connector;

FIG. 4 is an enlarged vertical section taken generally along line 4-4 of FIG. 2;

FIG. 5 is an enlarged perspective view of one of the conductive terminals, looking toward the terminating end thereof;

FIG. 6 is a perspective view of the terminal of FIG. 5, turned upside-down from the
15 orientation of FIG. 5; and

FIGS. 7-11 are sequential views of insertion of the terminals into the connector, taken generally along line 7-7 of FIG. 2.

DETAILED DESCRIPTION OF THE PREFERRED EMBODIMENT

20 Referring to the drawings in greater detail, and first to FIGS. 1-3, the invention is embodied in an electrical connector, generally designated 14, which includes a dielectric housing, generally designated 16; a rear seal, generally designated 18 and positionable at the rear of the housing; an end cap, generally designated 20 and latchable to the rear of the housing to hold the seal in position; a plurality of terminals, generally designated 22 and
25 insertable into the connector in the direction of arrow "A" (Fig. 3); and a primary lock reinforcement member, generally designated 24 and positionable into the front of housing 16. Each of the housing 16, end cap 20 and primary lock reinforcement member 24 may be a one-piece component molded of dielectric material such as plastic or the like. Seal 18 may be fabricated of an elastomeric material. Terminals 22 may be stamped and formed of
30 conductive sheet metal material.

Referring to FIG. 7 in conjunction with FIGS. 1-3, dielectric housing 16 includes an open front mating end 16a and an open rear termination end 16b. The front mating end

defines a front, rectangular receptacle 26 for matingly receiving a complementary connecting device such as a mating plug connector. Termination end 16b of the housing defines a rear receptacle 28 for receiving seal 18 and a front latching end of end cap 20. To that end, a plurality of latching holes 30 are formed through the top and bottom walls of the housing which define receptacle 28. The top of the housing may include a latch boss 32 for latching engagement with the mating connector. A plurality of terminal-receiving passages 34 extend front-to-rear in the housing and communicate between the open front and open rear ends 16a and 16b, respectively, of the housing. Finally, an integral, flexible primary locking arm 35 is cantilevered in each through passage. Each arm includes a terminal-engaging locking hook

5
10 35a.

Elastomeric seal 18 of connector 14 is positionable into rear receptacle 28 of housing 16 as can be seen in FIG. 7. When fully seated, the seal abuts against an interior shoulder 36 at the base of the receptacle. The seal is rectangular as seen in FIG. 3 and has flexible ridges 18a about the periphery thereof for establishing a sealing interference fit within rectangular receptacle 28. The seal has a plurality of through passages 38 aligned with terminal-receiving passages 34 in the housing and through which terminals 22 are inserted. Passages 38 through the seal are lined by flexible ridges 38a to establish a sealing interference fit about the terminals.

15

Still referring to FIG. 7 in conjunction with FIGS. 1-3, end cap 20 of connector 14 is generally rectangular in configuration and is inserted into rear receptacle 28 of the housing as best seen in FIGS. 2 and 7. The end cap has chamfered latching bosses 40 projecting from the top and bottom thereof for snapping engagement into latching holes 30 of the housing when the end cap is inserted into the receptacle in the direction of arrow "B" (Fig. 7). When fully inserted, latching bosses 40 snap into latching holes 30 and compress seal 18 between the front end of the end cap and interior shoulder 36 of the housing. As best seen in FIGS. 2, 4 and 7, end cap 20 has a plurality of through passages 42 which are aligned with through passages 38 in seal 18 and terminal-receiving passages 34 in housing 16. In this particular configuration of electrical connector 14, the passages are located in two rows, but the number of passages and the particular array of the passages can vary by the specific configuration and intended use of the connector. Passages 42 are polygonal in cross-sectional configuration as clearly seen in FIGS. 2 and 4. In the illustrated embodiment, the passages are hexagonal in cross-section, with an additional recess 42a located at one side of

20
25
30

each passage. As seen clearly in FIG. 4, recesses 42a are located at the tops of the passages in the top row thereof, and the recesses are located at the bottoms of the recesses in the bottom row thereof.

FIGS. 5 and 6 show in detail the configuration of terminals 22 which, as stated
5 above, may be stamped and formed of conductive sheet metal material. Specifically, each terminal includes a front contact end, generally designated 22a, and a rear terminating end, generally designated 22b. The front contact end is in the form of a terminal pin or contact blade 44 for engaging an appropriate contact of the complementary mating connector. For instance, the terminal pin may be inserted into a female terminal of the complementary
10 mating connector.

Rear terminating end 22b of each terminal 22 comprises a crimp section for crimping onto a discrete electrical wire. Specifically, the electrical wire (not shown) is typical as is known in the art and includes an outer insulating layer or cladding about an inner conductor or core, with the insulation removed to expose a distal end of the inner conductor. Rear
15 terminating end or crimp section 22b of each terminal 22 includes a first pair of crimp arms 46 for crimping onto the outer insulation of the electrical wire, and a second pair of crimp arms 48 for crimping onto the inner conductor of the electrical wire. It can be seen that crimp arms 46 are crimped into a generally polygonal cross-sectional configuration. Specifically, the crimp arms are crimped into a hexagonal configuration which matches the
20 hexagonal configuration of through passages 42 (Fig. 4) in end cap 20.

Each terminal 22 of connector 14 also includes an intermediate box section 50 between front contact end 22a and crimp section 22b. The box section performs three functions of providing reinforcement for the terminal along the length thereof, as well as providing for proper orientation of the terminal during its initial stage of insertion into the
25 electrical connector. The box section performs a third function of providing a locking shoulder 52 for engaging locking hook 35a of one of the primary locking arms 35, as will be seen hereinafter. Finally, box section 50 has a polygonal cross-sectional configuration. Specifically, the box section has a hexagonal configuration to match the cross-sectional configurations of through passages 42 (Fig. 4) in end cap 20.

30 Finally, each terminal 22 of connector 16 has an anti-rotation projection 54 formed at one side of box section 50. This projection moves into recess 42a (Fig. 4) of a respective one of the through passages 42 in end cap 20.

Referring to FIGS. 1, 3 and 7, primary lock reinforcement member 24 of connector 14 includes a generally rectangular plate portion 56 for insertion into rectangular receptacle 26 at front mating end 16a of housing 16. The plate portion has a number of holes for purposes not germane to the invention herein. The primary lock reinforcement member 5 includes a shelf portion 58 projecting forwardly of plate portion 56 to define a partition between the two rows of terminal pins 44 of terminals 22, as can be seen in FIG. 1. The terminal pins extend through a plurality of holes 60 (Fig. 7) in plate portion 56. Finally, primary lock reinforcement member 24 includes a locking plate 62 which projects rearwardly and is aligned between primary locking arms 35 as can be seen clearly in FIG. 7. 10 As will be understood hereinafter, locking plate 62 prevents primary locking arms 35 from moving out of locking engagement with the terminals.

FIGS. 7-11 are sequential views of insertion of terminals 22 into the connector and the final movement of primary lock reinforcement member 58 into its locking position. Basically, intermediate box section 50, along with anti-rotation projection 54, prevent 15 rotation of each terminal during an initial stage of insertion, and crimp arms 46 of rear crimp section 22b prevent rotation of the terminal during a later stage of insertion.

With those understandings, FIG. 7 shows a bottom one of the terminals 22 initially inserted into a respective one of the through passages 42 in end cap 20. Due to the fact that box section 50 has a polygonal cross-sectional configuration which matches the polygonal 20 cross-sectional configuration of passage 42, along with projection 54 of the terminal and recess 42a (Fig. 4) of the end cap, the terminal can be inserted into its respective passage in only one orientation. Once box section 50 is inserted into passage 42 in an initial stage of insertion as shown in FIG. 7, the terminal cannot rotate. This is true of all of the terminals as they are inserted into their respective through passages in the end cap. Only one bottom 25 terminal is shown in FIG. 7 to avoid cluttering the drawing and to facilitate a clear depiction of the other components of the connector.

FIG. 8 shows terminal 22 inserted further into the connector until both box section 50 and crimp arms 46 of the crimp section all are located within through passage 42. All of the box section, crimp arms and through passage have matching polygonal cross-sectional 30 configurations, and the terminal cannot possibly rotate during this stage of insertion.

FIG. 9 shows box section 50 and projection 54 of the terminal in a stage of insertion whereat the box section has left end cap 20 and has moved through seal 18 and begins to

enter terminal-receiving passage 34 in housing 16. Elastomeric seal 18 cannot prevent rotation of the terminal, and the box section may not be prevented from rotating as it enters the housing. However, crimp arms 46 of the rear crimp section of the terminal still are located within the polygonal through passage 42 of end cap 20, and the rear crimp section, 5 thereby, still prevents rotation of the terminal. In essence, the terminal cannot rotate out of its proper orientation during the insertion process as long as polygonal crimp section 46 (22b) is moving within through passage 42 in end cap 20.

FIG. 10 shows one of the terminals 22 (a top terminal in this depiction) in its fully inserted position. It can be seen that locking hook 35a of flexible primary locking arm 35 10 has snapped into locking engagement behind locking shoulder 52 of box section 50 of the terminal. The terminal now can no longer back out of its terminal-receiving passage 34 in housing 16. Although only one terminal is shown in FIG. 10, all of the primary locking arms 35 of the housing will snap into locking engagement with all of the terminals once they reach their fully inserted position.

15 Finally, FIG. 11 shows primary lock reinforcement member (PLR) 24 moved inwardly in the direction of arrow "C" until locking plate 62 of the PLR becomes disposed between primary locking arms 35. The primary locking arms are flexible, and locking plate 62 prevents the arms from flexing inwardly toward each other a sufficient distance that locking hooks 35a of the arms could move out of locking engagement with the locking 20 shoulders 52 of the terminals. In its fully inserted position, the PLR abuts against a stop shoulder 63 within the housing. In addition, the PLR has tapered mouths 64 around holes 60, the tapered mouths engaging tapered portions 66 of the terminals whereby the terminals become sandwiched between tapered mouths 64 of the PLR and locking hooks 35a of primary locking arms 35. The PLR is held in position against shoulder 63 by a secure press- 25 fit within front receptacle 26 of the housing or by an appropriate latching system.

It will be understood that the invention may be embodied in other specific forms without departing from the spirit or central characteristics thereof. The present examples and embodiments, therefore, are to be considered in all respects as illustrative and not restrictive, and the invention is not to be limited to the details given herein.

30

CLAIMS

What is claimed is:

1. An electrical connector, comprising:
 - 5 a dielectric housing including a front mating end, a rear termination end and a plurality of terminal-receiving passages extending between the ends;
an end cap coupled to the rear termination end of the housing and including a plurality of through passages aligned with the terminal-receiving passages in the housing, said through passages having a polygonal cross-sectional configuration; and
 - 10 a plurality of conductive terminals insertable into the terminal-receiving passages in the housing from the rear termination end thereof through the through passages in the end cap, each terminal including a front contact end for engaging an appropriate contact of a complementary mating connector and a rear terminating end comprising a crimp section for crimping onto an electrical wire, the crimp section having a polygonal cross-sectional
 - 15 configuration matching that of the through passages in the end cap to prevent rotation of the terminals when the contact ends are located in the terminal-receiving passages in the housing as the terminals are inserted thereinto.
2. The electrical connector of claim 1 wherein said crimp section of each
- 20 terminal comprises a first crimp section and is sized for crimping onto an outer insulation of the electrical wire, and including a second crimp section forwardly of said first crimp section for crimping onto an inner conductor of the electrical wire.
3. The electrical connector of claim 1 wherein each terminal includes a
- 25 reinforcing box section rearwardly of said front contact end.
4. The electrical connector of claim 3 wherein said box section has a polygonal cross-sectional configuration matching that of said crimp section to initially align the terminals upon insertion into the polygonal through passages in the end cap.

30

5. An electrical connector, comprising:
a dielectric housing including a front mating end, a rear termination end and a plurality of terminal-receiving passages extending between the ends;
an end cap coupled to the rear termination end of the housing and including a plurality of through passages aligned with the terminal-receiving passages in the housing;
5 a plurality of conductive terminals insertable into the terminal-receiving passages in the housing from the rear termination end thereof through the through passages in the end cap, each terminal including a front contact end for engaging an appropriate contact of a complementary mating connector and a rear terminating end comprising a crimp section for
10 crimping onto an electrical wire; and
the cross-sectional configuration of said crimp section of the terminals and the cross-sectional configuration of said through passages in the end cap being such that the terminals are prevented from rotating as the crimp sections pass through the through passages.
- 15 6. The electrical connector of claim 5 wherein said crimp section of each terminal comprises a first crimp section and is sized for crimping onto an outer insulation of the electrical wire, and including a second crimp section forwardly of said first crimp section for crimping onto an inner conductor of the electrical wire.
- 20 7. The electrical connector of claim 5 wherein each terminal includes a reinforcing box section rearwardly of said front contact end.
8. The electrical connector of claim 5 wherein said box section has a cross-sectional configuration matching that of said crimp section to initially align the terminals
25 upon insertion into the through passages in the end cap.
9. An electrical terminal for insertion into a terminal-receiving passage in a housing of an electrical connector, comprising:
a front contact end for engaging an appropriate contact of a complementary mating
30 connector;
a rear terminating end comprising a crimp section for crimping onto an electrical wire;

a reinforcing box section between the front contact end and the rear terminating end;
and

said crimp section and said box section both being configured to prevent rotation of the terminal during insertion of the terminal into the terminal-receiving passage in the housing, the box section preventing rotation during an initial stage of insertion and the crimp section preventing rotation during a later stage of insertion.

10. The electrical terminal of claim 9 wherein said crimp section has a polygonal cross-sectional configuration.

10

11. The electrical terminal of claim 10 wherein said box section has a polygonal cross-sectional configuration.

12. The electrical terminal of claim 9 wherein said crimp section comprises a first crimp section and is sized for crimping onto an outer insulation of the electrical wire, and including a second crimp section forwardly of said first crimp section for crimping onto an inner conductor of the electrical wire.

15

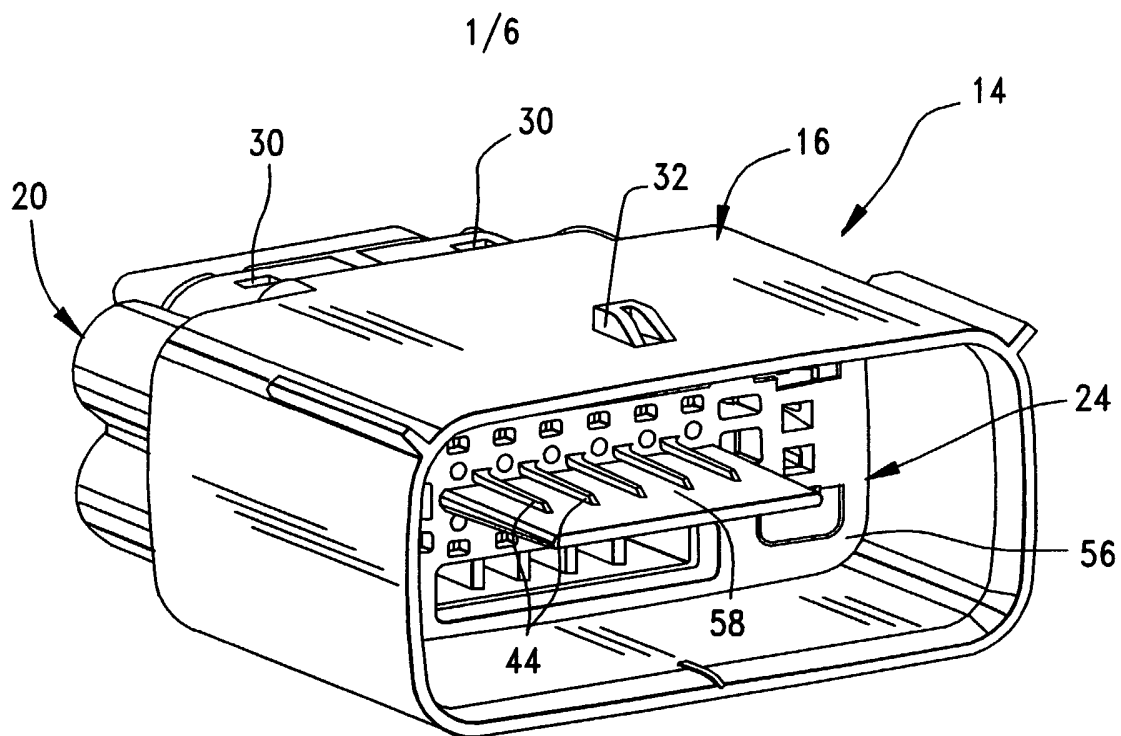

FIG. 1

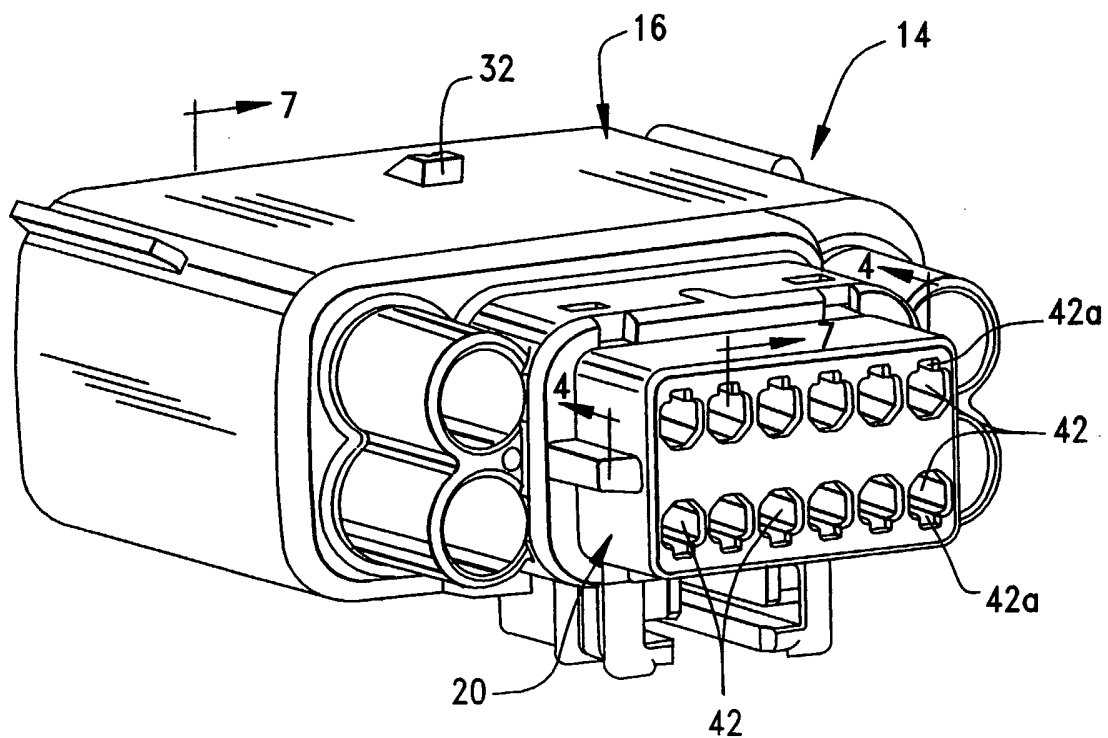

FIG. 2

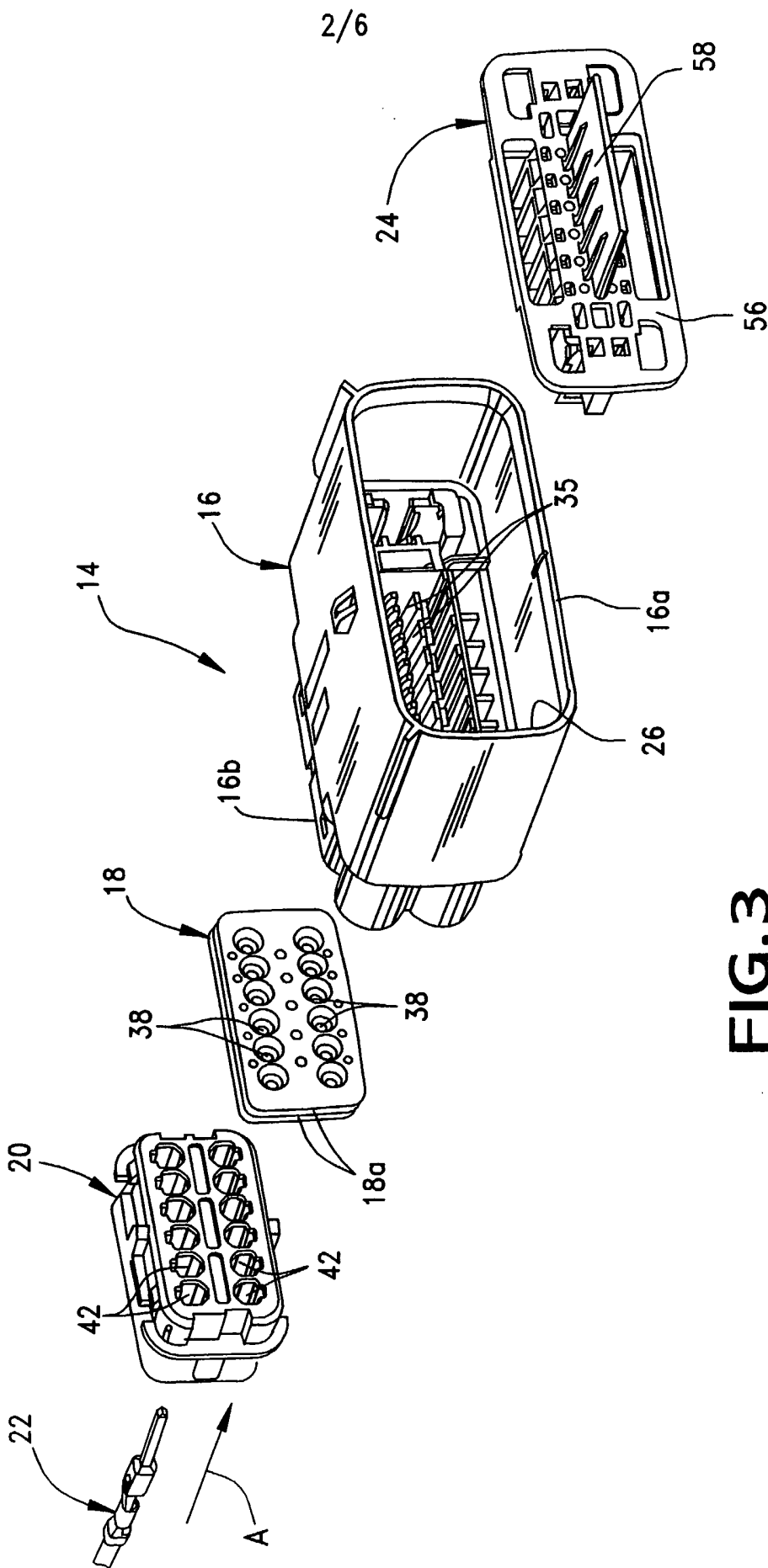

FIG. 3

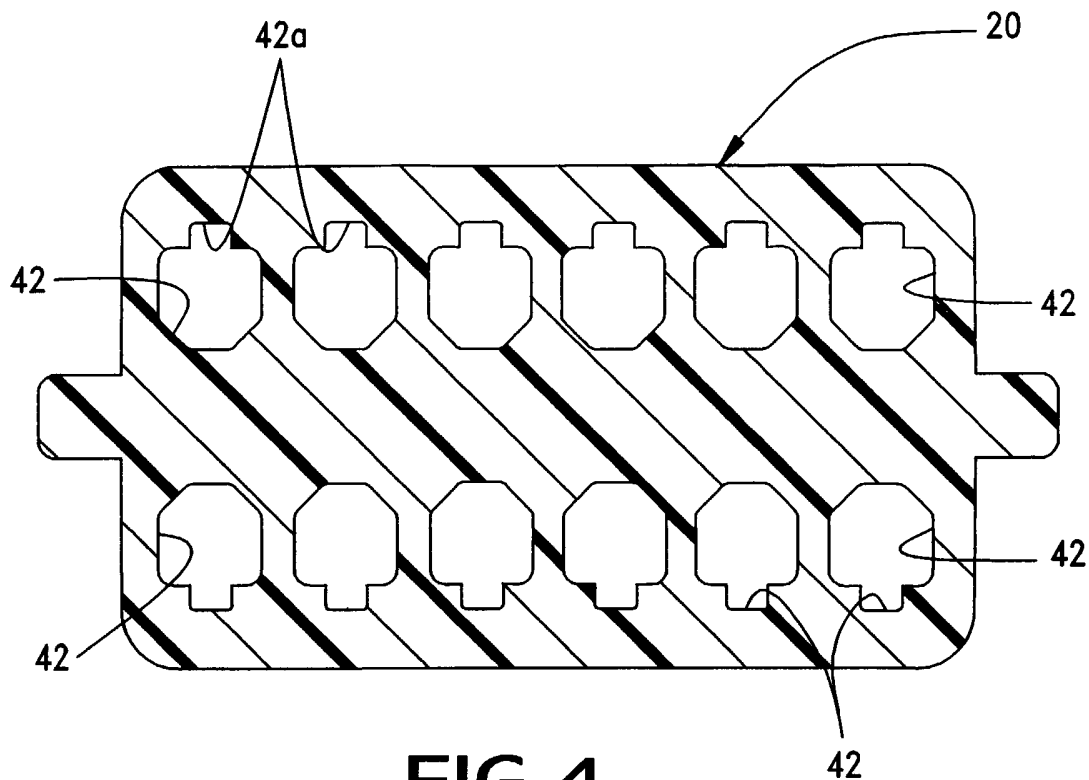

FIG. 4

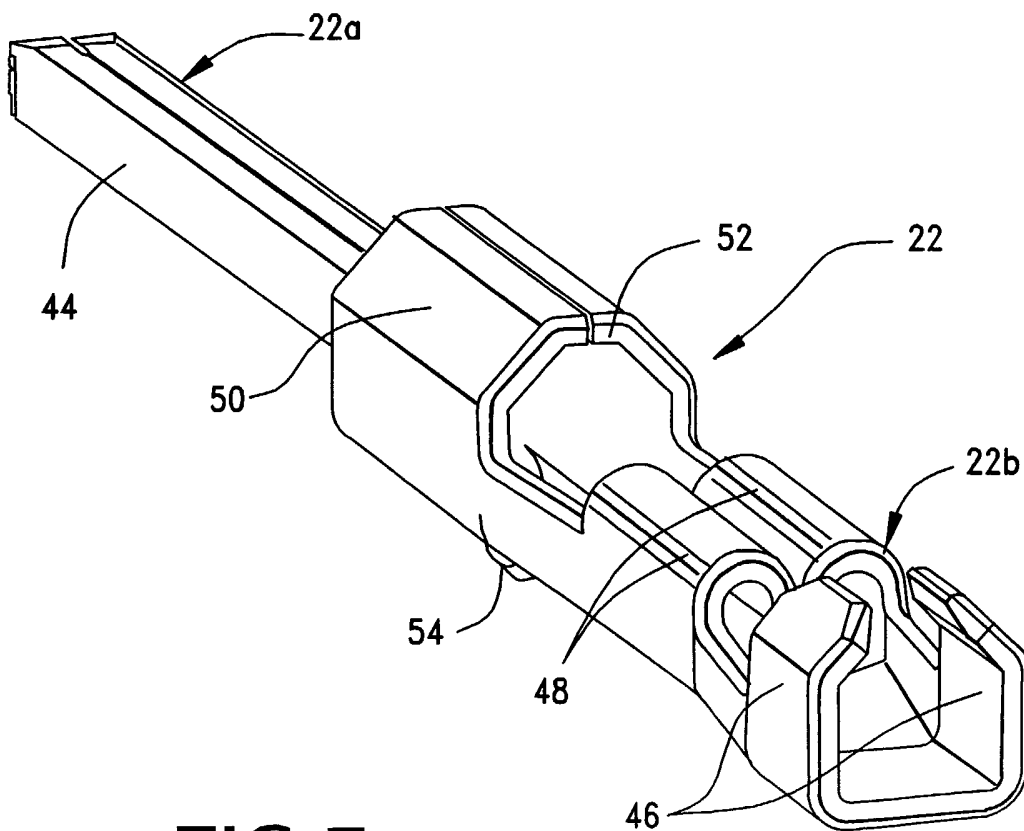

FIG. 5

4/6

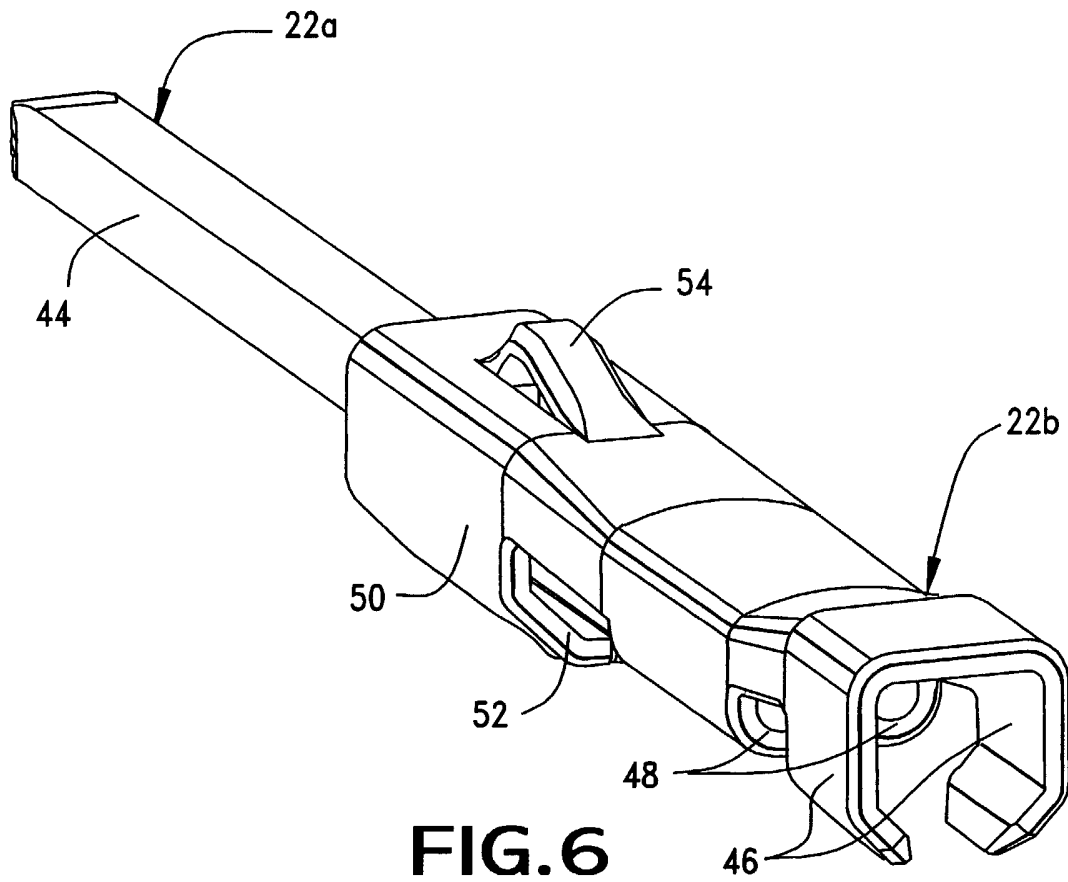

FIG. 6

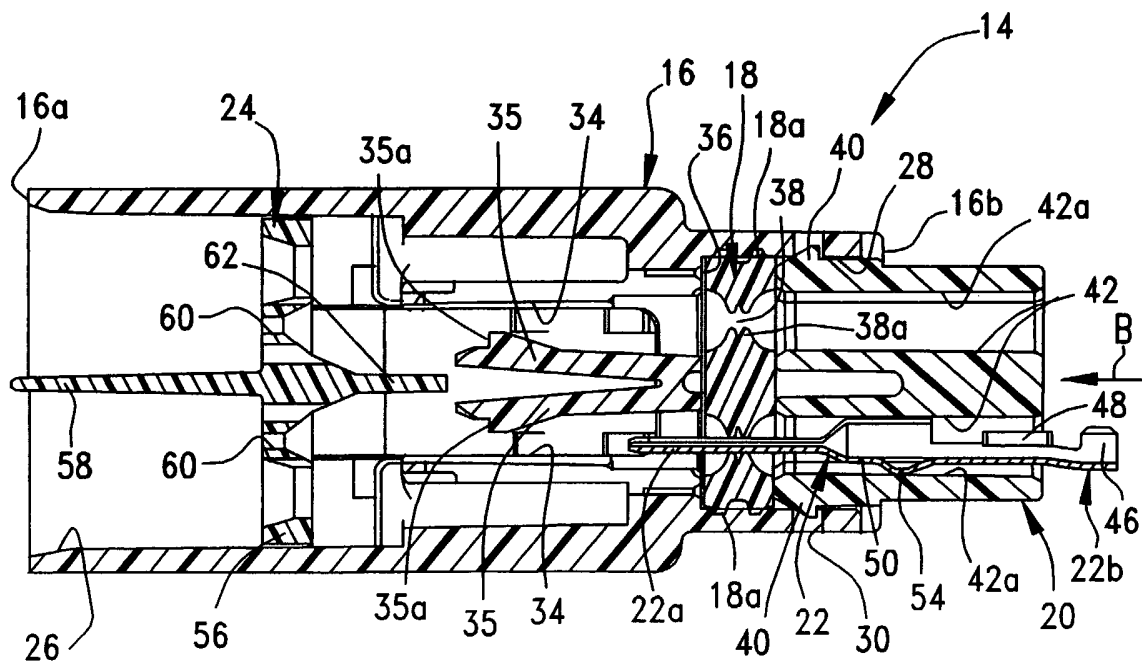

FIG. 7

5/6

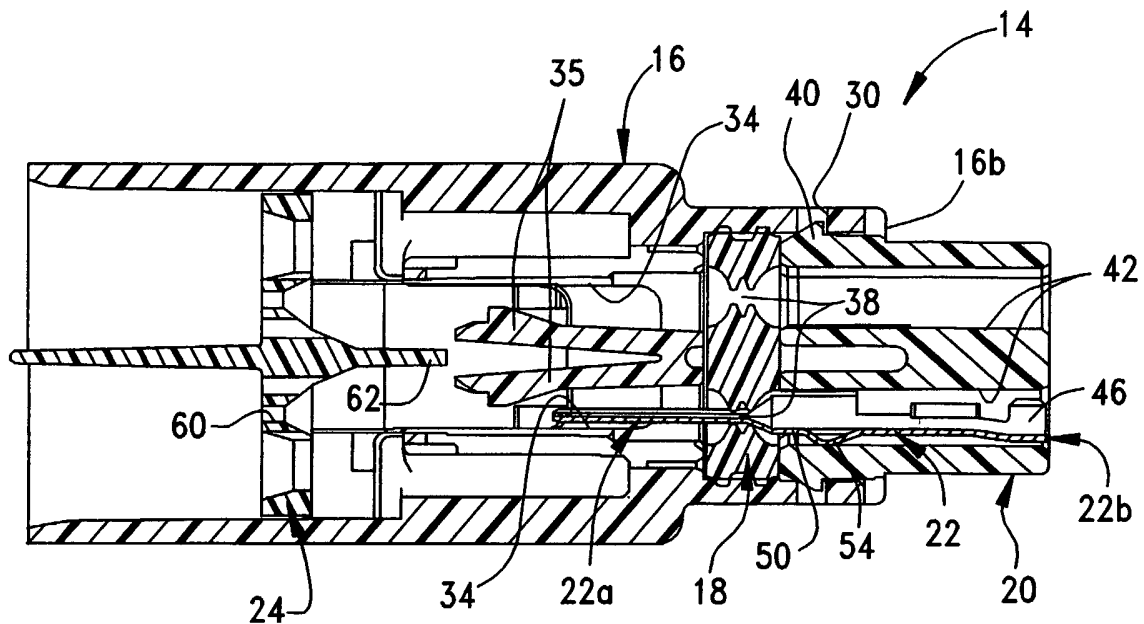

FIG. 8

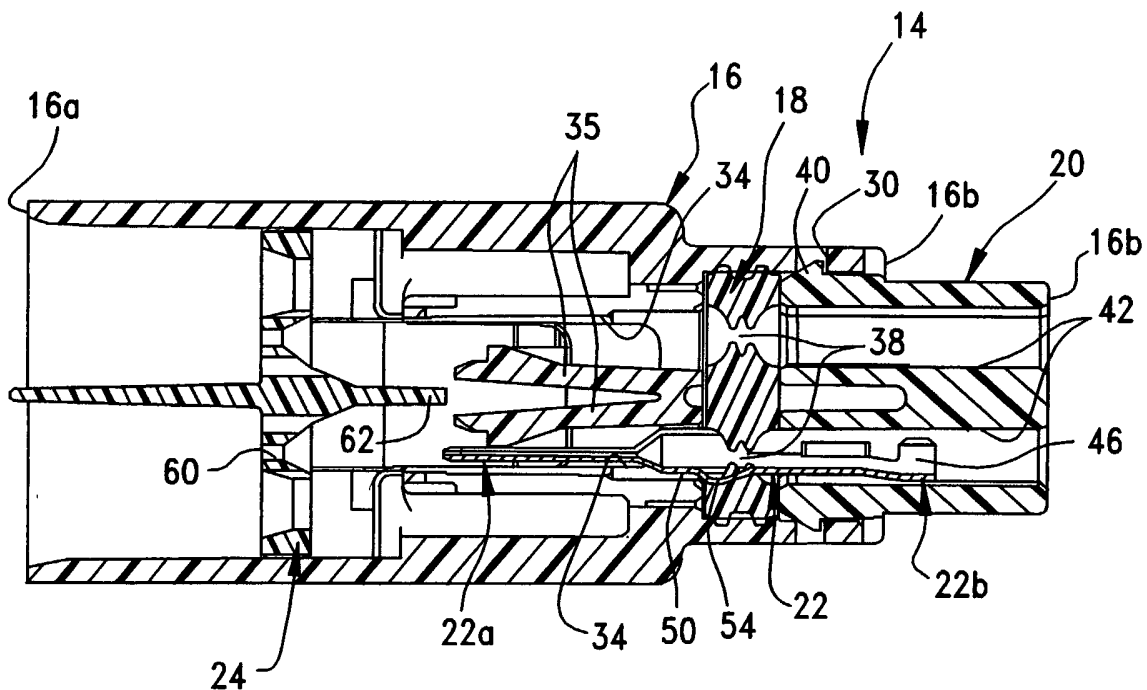

FIG. 9

6/6

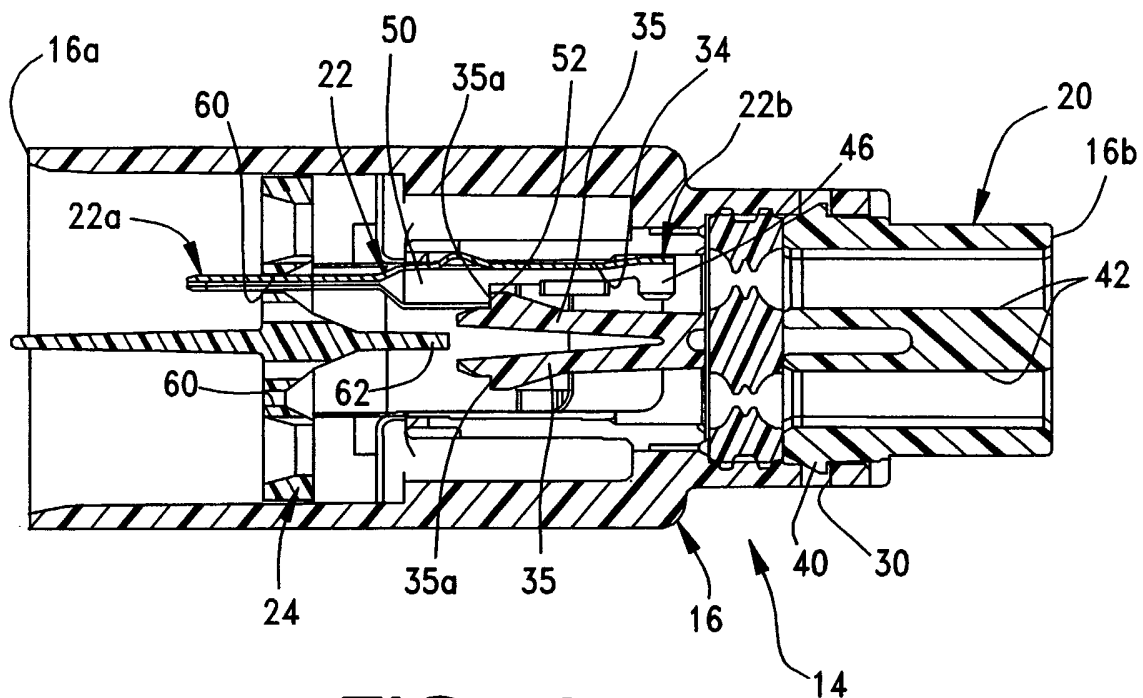

FIG. 10

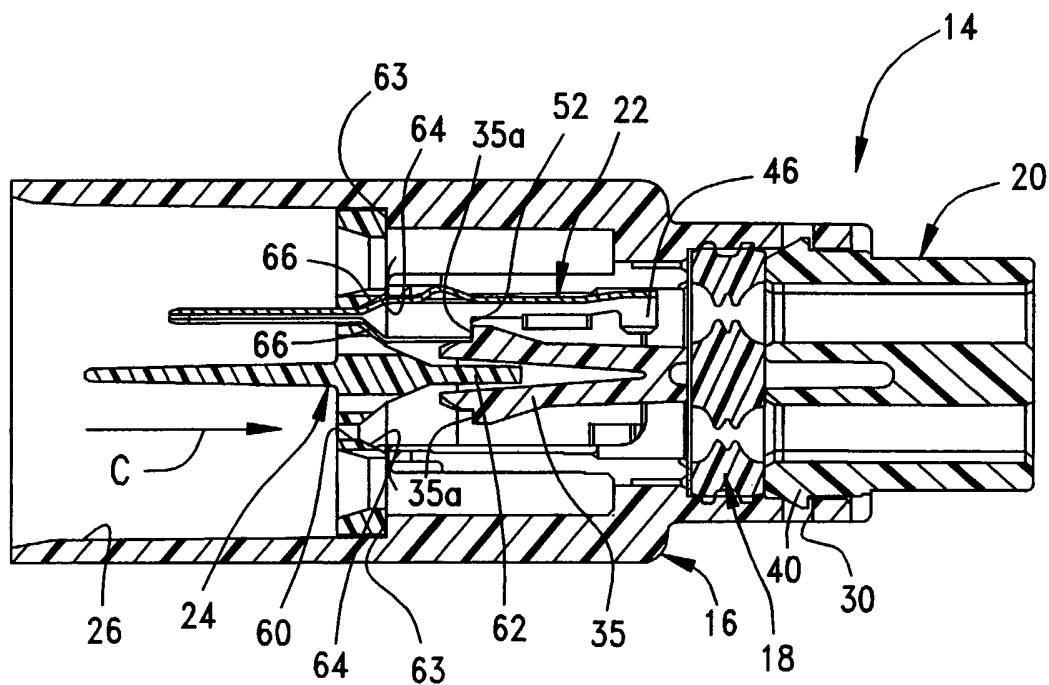

FIG. 11

INTERNATIONAL SEARCH REPORT

International Application No
PCT/US2005/002115

A. CLASSIFICATION OF SUBJECT MATTER IPC 7 H01R13/41 H01R13/422		
According to International Patent Classification (IPC) or to both national classification and IPC		
B. FIELDS SEARCHED		
Minimum documentation searched (classification system followed by classification symbols) IPC 7 H01R		
Documentation searched other than minimum documentation to the extent that such documents are included in the fields searched		
Electronic data base consulted during the international search (name of data base and, where practical, search terms used) EPO-Internal, WPI Data, PAJ		
C. DOCUMENTS CONSIDERED TO BE RELEVANT		
Category °	Citation of document, with indication, where appropriate, of the relevant passages	Relevant to claim No.
Y	EP 0 732 770 A (THE WHITAKER CORPORATION) 18 September 1996 (1996-09-18) abstract; figures column 4, line 22 - column 5, line 3 -----	5-9, 11, 12
Y	US 5 743 770 A (HAMAI ET AL) 28 April 1998 (1998-04-28) abstract; figures 1-3 column 3, line 10 - column 4, line 7 -----	5-9, 11, 12
A	US 5 626 499 A (YAGI ET AL) 6 May 1997 (1997-05-06) abstract; figures 1-4 column 3, line 44 - column 5, line 12 -----	1, 5, 9
A	US 4 374 604 A (HEMMER ET AL) 22 February 1983 (1983-02-22) column 1, line 66 - column 3, line 21 -----	11, 12
-/--		
<input checked="" type="checkbox"/> Further documents are listed in the continuation of box C. <input checked="" type="checkbox"/> Patent family members are listed in annex.		
° Special categories of cited documents :		
A document defining the general state of the art which is not considered to be of particular relevance *E* earlier document but published on or after the international filing date *L* document which may throw doubts on priority claim(s) or which is cited to establish the publication date of another citation or other special reason (as specified) *O* document referring to an oral disclosure, use, exhibition or other means *P* document published prior to the international filing date but later than the priority date claimed		*T* later document published after the international filing date or priority date and not in conflict with the application but cited to understand the principle or theory underlying the invention *X* document of particular relevance; the claimed invention cannot be considered novel or cannot be considered to involve an inventive step when the document is taken alone *Y* document of particular relevance; the claimed invention cannot be considered to involve an inventive step when the document is combined with one or more other such documents, such combination being obvious to a person skilled in the art. *&* document member of the same patent family
Date of the actual completion of the international search <p style="text-align: center;">25 May 2005</p>		Date of mailing of the international search report <p style="text-align: center;">07/06/2005</p>
Name and mailing address of the ISA European Patent Office, P.B. 5818 Patentlaan 2 NL - 2280 HV Rijswijk Tel. (+31-70) 340-2040, Tx. 31 651 epo nl, Fax: (+31-70) 340-3016		Authorized officer <p style="text-align: center;">Serrano Funcia, J</p>

INTERNATIONAL SEARCH REPORT

International Application No
PCT/US2005/002115

C.(Continuation) DOCUMENTS CONSIDERED TO BE RELEVANT

Category °	Citation of document, with indication, where appropriate, of the relevant passages	Relevant to claim No.
A	EP 1 378 967 A (SUMITOMO WIRING SYSTEMS, LTD) 7 January 2004 (2004-01-07) abstract; figures 1-10 paragraph '0027! - paragraph '0040! -----	9, 11, 12

INTERNATIONAL SEARCH REPORT

Information on patent family members

International Application No

PCT/US2005/002115

Patent document cited in search report		Publication date	Patent family member(s)	Publication date
EP 0732770	A	18-09-1996	US 5658168 A BR 9600962 A DE 69613501 D1 DE 69613501 T2 EP 0732770 A2 JP 8264224 A	19-08-1997 30-12-1997 02-08-2001 25-04-2002 18-09-1996 11-10-1996
US 5743770	A	28-04-1998	JP 9082395 A	28-03-1997
US 5626499	A	06-05-1997	JP 2896738 B2 JP 7226252 A	31-05-1999 22-08-1995
US 4374604	A	22-02-1983	FR 2501425 A1	10-09-1982
EP 1378967	A	07-01-2004	JP 3415140 B1 JP 2004039498 A CN 1466243 A CN 1467878 A EP 1378967 A1 EP 1378968 A1 US 2003190841 A1 US 2004005821 A1	09-06-2003 05-02-2004 07-01-2004 14-01-2004 07-01-2004 07-01-2004 09-10-2003 08-01-2004