

Nov. 8, 1927.

1,648,354

E. F. LIED

GOLF CLUB

Filed Aug. 21, 1926

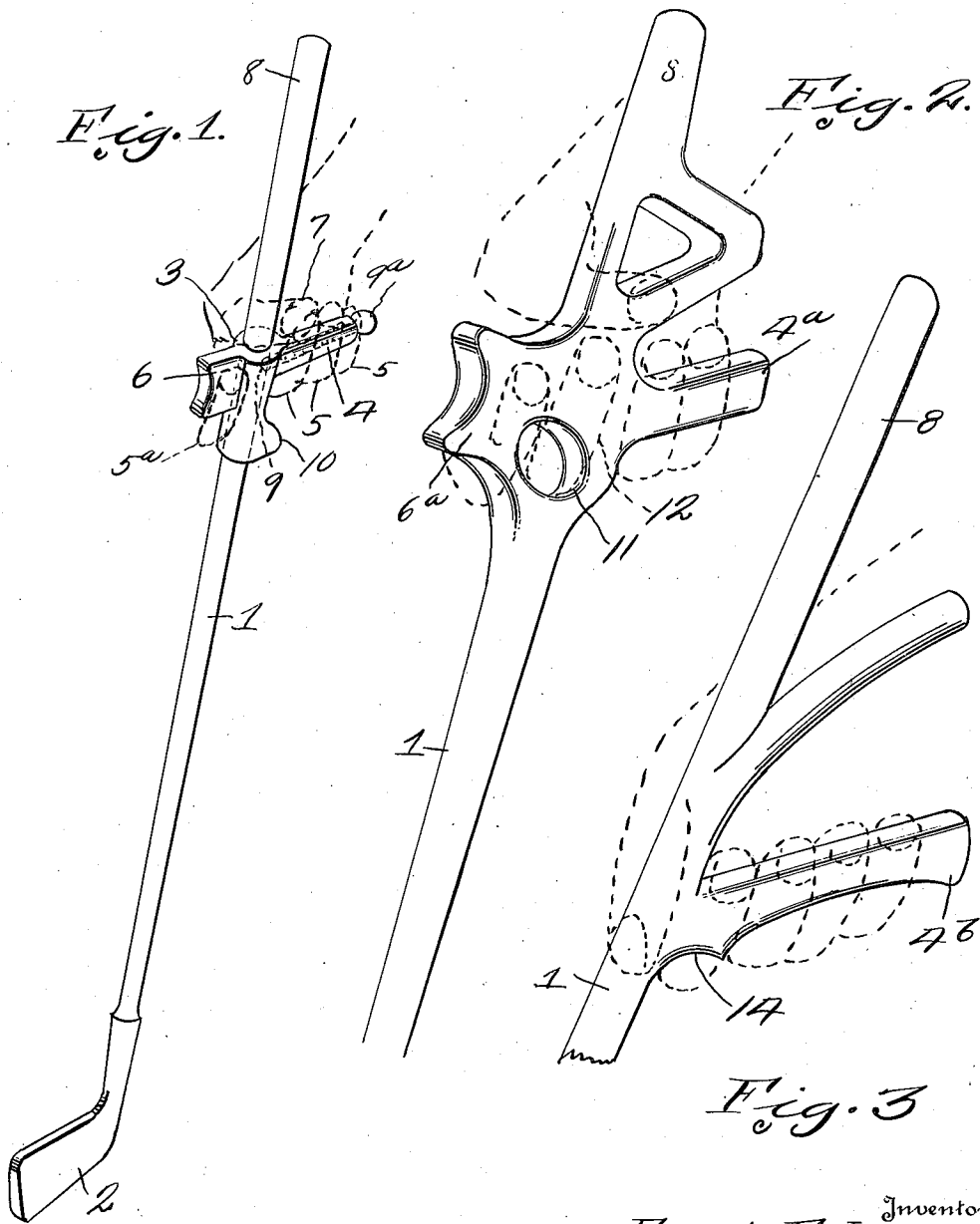

Inventor
Ernst F. Lied

By James W. Martin
Attorney

UNITED STATES PATENT OFFICE.

ERNST F. LIED, OF OMAHA, NEBRASKA.

GOLF CLUB.

Application filed August 21, 1926. Serial No. 130,705.

The invention relates to golf clubs and has for its object to provide a handle attachment for a golf club, which handle attachment when grasped by the player allows the player to swing the club accurately so that the lower end thereof will move in substantially a horizontal line and the club to have a pendulum movement, thereby insuring an accurate swinging of the club.

A further object is to provide a handle attachment for a golf club, which handle attachment when grasped by the hand of the operator prevents cramping of the muscles of the player, allows a gripping in a natural position and in a position there will be free movement of the wrists of the player, thereby insuring maximum efficiency while making a stroke.

A further object is to provide a golf club handle member comprising a gripping member having an arm extending outwardly from the rear side of the club and adapted to be gripped by the fingers of the operator, and an extension extending outwardly from the forward side of the club adapted to be gripped by the thumb of the player, thereby allowing the club to be supported in a normal position without cramping of the muscles of the arm.

A further object is to provide means whereby the gripping member may be adjusted upwardly and downwardly on the club for adjusting the same to the height of various players.

With the above and other objects in view the invention resides in the combination and arrangement of parts as hereinafter set forth, shown in the drawing, described and claimed, it being understood that changes in the precise embodiment of the invention may be made within the scope of what is claimed without departing from the spirit of the invention.

In the drawing:—

Figure 1 is a perspective view of the club showing the handle attachment applied thereto.

Figure 2 is another form of handle attachment.

Figure 3 is a further modified form of handle attachment.

Referring to the drawing, the numeral 1 designates the shaft of the golf club and 2 the head thereof. Mounted on the shaft 1 is a sleeve 3, one side of which sleeve is provided with an outwardly and upwardly in-

clined grip 4, which grip when the club is in position for use is substantially horizontally disposed, and around which grip the second and third fingers extend as clearly shown in Figure 1. Extending out from the opposite side of the sleeve 3, and to the front of the shaft 1 is a finger engaging member 6, which is engaged on its upper side by the thumb 7, and on its underside by the first finger 5^a of the player, therefore it will be seen the club is gripped in a natural position and the wrist is not twisted or the muscles of the arm strained or distorted, which is the common difficulty with clubs as at present constructed. It will also be seen that when the operator grasps the handle 8 of the shaft with his other hand in reverse relation to that shown in dotted lines, the wrists of the operator are in position where the real swing can be from the wrists for insuring an accurate driving of the ball with the head 2, and the head 2 will move in substantially a horizontal line at the bottom of the stroke, and the club will have a pendulum action. Extending through the extension 4 is a set screw 9, which set screw forms means for securely clamping the handle member on the shaft and at the same time allows the handle member to be adjusted to various positions on the shaft 1 according to the height of the player. The set screw 9 is provided with a ball weight 9^a for balancing purposes. Sleeve 3 is preferably provided with a rearwardly extending member 10 below the member 4, and which member 10 engages the under side of the second finger 5 and prevents any downward movement thereof.

Referring to Figure 2 wherein a modified form is shown, in this figure the member 4^a is substantially the same as the member 4 in Figure 1, as well as the member 6^a, and is gripped in substantially the same manner, however in this form a finger receiving hole 11 is provided through which the second finger 12 may be placed, and the first finger 13 is placed under the extension 6^a, otherwise the operation of the device is substantially the same as shown in Figure 1. In this form the grip is shown as formed integral with the shaft 1 for purposes of illustration, however it is to be understood that the same may be made adjustable if desired.

Referring to Figure 3 where a further modified form is shown, in this figure the extension member 4^b is provided with a finger receiving recess 14 adjacent its inner end,

and the extensions 6 and 6^a are eliminated, however the operation is substantially the same when swinging the club, as a pendulum swing free at the wrists is provided, which insures a maximum drive under perfect control and without cramping the muscles of the arms of the player.

From the above it will be seen that a golf club grip is provided which is simple in construction, may be easily applied to a conventional form of club, adjusted according to the height or length of the arms of a player, and a pendulum swing may be made, straight back and straight forward, that the hands are opposite each other, thereby allowing a swing from the wrists, eliminates jerking and jabbing at the ball and maintains the head or blade at proper angle and position during the swing.

The invention having been set forth what is claimed as new and useful is:—

1. The combination with a golf club shaft, of a grip carried thereby, said grip compris-

ing a sleeve surrounding the shaft, a hand engaging member extending angularly outwardly from the rear side of the shaft and sleeve, a finger engaging member carried by the forward side of the sleeve and a set screw extending through the rearwardly extending member and the sleeve and forming means whereby said sleeve may be adjusted to various positions on the shaft.

2. The combination with a golf club shaft, of a handle member adjustably mounted thereon, said handle member having a grip extending outwardly therefrom at the rear side of the shaft, a finger engaging member carried by the handle member and extending outwardly from the forward side of the shaft and a lug extending outwardly from the handle member under the finger gripping member.

In testimony whereof I hereunto affix my signature.

ERNST F. LIED.