



- (51) **International Patent Classification:**
A47L 15/50 (2006.01)
- (21) **International Application Number:**
PCT/EP2014/068528
- (22) **International Filing Date:**
1 September 2014 (01.09.2014)
- (25) **Filing Language:** English
- (26) **Publication Language:** English
- (71) **Applicant:** ELECTROLUX APPLIANCES AK-TIEBOLAG [SE/SE]; S:t Göransgatan 143, S-105 45 Stockholm (SE).
- (72) **Inventors:** MESA, Daniel; c/o AB Electrolux, S:t Göransgatan 143, S-105 45 Stockholm (SE). HEDERSTIERNA, Rickard; c/o AB Electrolux, S:t Göransgatan 143, S-105 45 Stockholm (SE).
- (74) **Agent:** LAURIN, Magnus; S:t Göransgatan 143, S-10545 Stockholm (SE).
- (81) **Designated States** (unless otherwise indicated, for every kind of national protection available): AE, AG, AL, AM,

AO, AT, AU, AZ, BA, BB, BG, BH, BN, BR, BW, BY, BZ, CA, CH, CL, CN, CO, CR, CU, CZ, DE, DK, DM, DO, DZ, EC, EE, EG, ES, FI, GB, GD, GE, GH, GM, GT, HN, HR, HU, ID, IL, IN, IR, IS, JP, KE, KG, KN, KP, KR, KZ, LA, LC, LK, LR, LS, LT, LU, LY, MA, MD, ME, MG, MK, MN, MW, MX, MY, MZ, NA, NG, NI, NO, NZ, OM, PA, PE, PG, PH, PL, PT, QA, RO, RS, RU, RW, SA, SC, SD, SE, SG, SK, SL, SM, ST, SV, SY, TH, TJ, TM, TN, TR, TT, TZ, UA, UG, US, UZ, VC, VN, ZA, ZM, ZW.

- (84) **Designated States** (unless otherwise indicated, for every kind of regional protection available): ARIPO (BW, GH, GM, KE, LR, LS, MW, MZ, NA, RW, SD, SL, ST, SZ, TZ, UG, ZM, ZW), Eurasian (AM, AZ, BY, KG, KZ, RU, TJ, TM), European (AL, AT, BE, BG, CH, CY, CZ, DE, DK, EE, ES, FI, FR, GB, GR, HR, HU, IE, IS, IT, LT, LU, LV, MC, MK, MT, NL, NO, PL, PT, RO, RS, SE, SI, SK, SM, TR), OAPI (BF, BJ, CF, CG, CI, CM, GA, GN, GQ, GW, KM, ML, MR, NE, SN, TD, TG).

Published:

— with international search report (Art. 21(3))

(54) **Title:** HOLDING ASSEMBLY

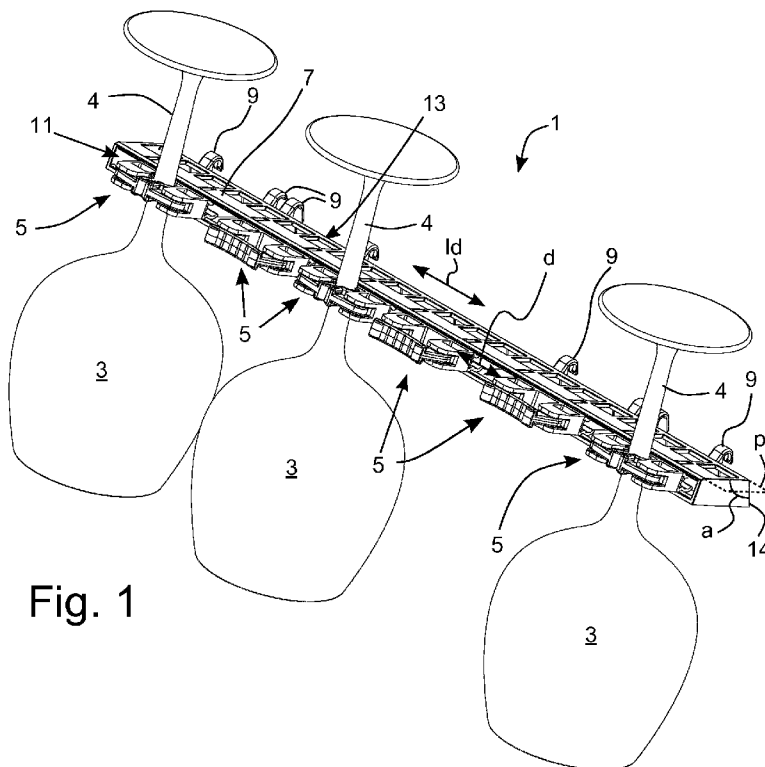

Fig. 1

(57) **Abstract:** A holding assembly (1) for holding one or more stemmed objects (3) in a dishwasher (2) is provided. The holding assembly (1) comprises an elongated gripping unit frame (7) and two or more gripping units (5) arranged at the elongated gripping unit frame (7). The two or more gripping units (5) are arranged to grip a respective stemmed portion (4) of the one or more stemmed objects (3). At least one of the two or more gripping units (5) is displaceably arranged along a longitudinal direction (ld) of the elongated gripping unit frame (7). The embodiments herein also relates to a rack of a dishwasher and a dishwasher comprising a rack.

HOLDING ASSEMBLY

TECHNICAL FIELD

Embodiments herein relate to a holding assembly for holding one or more stemmed
5 objects in a dishwasher. The embodiments herein also relates to a rack of a dishwasher
and a dishwasher comprising a rack.

BACKGROUND

Interior environments of today's dishwashers are not always adapted to receive delicate
10 items such as wine glasses, champagne glasses etc. The interior of a dishwasher is
usually designed to receive plates and it is desirably if the interior is robust enough to
receive heavy and bulky cookware such as pots and pans etc. Therefore, problems may
arise when delicate items such as wine glasses, champagne glasses etc., are loaded
15 into a rack, a user usually has to handle the rack with great care, not to cause such
items to fall. Even if a user does so, such items might fall anyway. Such falling may
cause such delicate items to break. An option is to dish such items by hand, but
dishwashing by hand is time consuming and many users also consider such activities to
be burdensome. Also, items to be washed which are loaded into a dishwasher can have
20 a variety of designs and sizes. This makes it difficult to design the interior of a
dishwasher such that it can handle such different kind of items to be washed.

In view of above, there is a need for an improved holding assembly which may overcome
some of the above mentioned problems.

25

SUMMARY

An object of the embodiments herein is to provide an improved holding assembly.

According to an aspect of the embodiments herein, the object is achieved by a holding
30 assembly for holding one or more stemmed objects in a dishwasher, the holding
assembly comprising an elongated gripping unit frame and two or more gripping units

arranged at the elongated gripping unit frame, where the two or more gripping units are arranged to grip a respective stemmed portion of the one or more stemmed objects, and where at least one of the two or more gripping units is displaceably arranged along a longitudinal direction of the elongated gripping unit frame. Since, at least one of the two or more gripping units is displaceably arranged along a longitudinal direction of the elongated gripping unit frame, positioning of the one or more stemmed objects, within the dishwasher, is facilitated.

As a result, the above mentioned object is achieved.

Also, since at least one of the two or more gripping units is displaceably arranged along a longitudinal direction of the elongated gripping unit frame, a distance between two or more gripping units may be adjusted. As a result, a holding assembly is provided where stemmed objects, such as wine glasses, having different diameters can be held. Further, a space within a dishwasher in which the holding assembly is positioned may be utilized more efficiently and space may be provided for accommodating other form of dish than stemmed objects.

Optionally, each gripping unit has a gripping mode and a releasing mode where the each gripping unit is arranged to release the respective stemmed portion in the releasing mode, and where the each gripping unit is arranged to grip the respective stemmed portion in the gripping mode. Since each gripping unit has a gripping mode and a releasing mode, holding of one or more stemmed objects may be ensured and removal of the one or more stemmed objects from the holding assembly may be facilitated.

Optionally, each gripping unit comprises a first arm and a second arm and a flexible strip arranged between the first and second arms. Since each gripping unit comprises a first arm and a second arm and a flexible strip arranged between the first and second arms, gripping of the one or more stemmed objects may be further improved.

Optionally, the flexible strip is arranged to at least partially enclose the stemmed portion of one of the one or more stemmed objects when the gripping unit is in the gripping mode. Since the flexible strip is arranged to at least partially enclose the stemmed

portion when each gripping unit is in the gripping mode, gripping of the one or more stemmed objects may be further improved.

5 Optionally, the first arm and the second arm are rotably arranged at the holding assembly and where a tip of the first arm and a tip of the second arm are arranged to be closer to each other when the gripping unit is in the gripping mode than in the releasing mode. Thereby, gripping of a stemmed portion of a stemmed object may be further improved.

10 Optionally, the elongated gripping unit frame comprises one or more snap fittings, and where the holding assembly is arranged to be snapped onto a rack of the dishwasher via the one or more snap fittings. Since the elongated gripping unit frame comprises one or more snap fittings, the holding assembly provided may easily be snapped onto, and removed from, a rack of the dishwasher. Thereby, a user may snap the holding
15 assembly onto an already existing rack of the dishwasher and may remove the holding assembly, from the rack, when it is not to be used.

Optionally, the one or more snap fittings are displaceably arranged along the longitudinal direction of the elongated gripping unit frame. Since the one or more snap fittings are
20 displaceably arranged along the longitudinal direction of the elongated gripping unit frame, a holding assembly is provided which may be snapped onto racks having different designs. That is, the holding assembly may be snapped onto racks having different distances between wires of the racks.

25 Optionally, the snap fittings are arranged to allow the holding assembly to be folded between at least a gripping position and a storing position in relation to the rack of the dishwasher. Thereby, the holding assembly may be folded into a storing position when it is not in use to thereby provide space to other items to be washed than stemmed objects, and which may be folded into the gripping position when it is to be used.

30

Optionally, the holding assembly comprises a gripping unit side comprising the two or more gripping units and a rear side opposite to the gripping unit side, where the rear side comprises a wall being arranged with an angle in the range of 100-120 degrees, preferably in the range of 105-115 degrees, more preferably approximately 110 degrees,

to a main extension plane of the holding assembly. Thereby, washing and drying of a stemmed object, being held in a dishwasher by a holding assembly provided, may be improved since water more easily may reach portions of such a stemmed object and water may run off such a stemmed object in a more efficient manner. In particular, drying
5 of stemmed objects, such as wine glasses and champagne flutes, may be improved since water may run off from a bowl-shaped foot portion of such a glass, due to the rear side comprising a wall being arranged with an angle in the range of 100-120 degrees, preferably in the range of 105-115 degrees, more preferably approximately 110 degrees, to a main extension plane of the holding assembly.

10

According to a second aspect of the embodiments herein, the object is achieved by a rack of a dishwasher comprising a holding assembly according to some embodiments.

15

According to a third aspect of the embodiments herein, the object is achieved by a dishwasher comprising a rack according to some embodiments.

20

Further features of, and advantages with, the embodiments herein will become apparent when studying the appended claims and the following detailed description. Those skilled in the art will realize that the different features described may be combined to create
embodiments other than those described in the following, without departing from the scope of the embodiments herein, as defined by the appended claims.

BRIEF DESCRIPTION OF THE DRAWINGS

25

The various aspects of the embodiments herein, including its particular features and advantages, will be readily understood from the following detailed description and the accompanying drawings, in which:

30

Fig. 1 illustrates a holding assembly for holding one or more stemmed objects in a dishwasher,

Fig. 2 illustrates a gripping unit of the holding assembly illustrated in Fig. 1 in a releasing mode,

Fig. 3 illustrates the gripping unit of the holding assembly in a releasing mode,

Fig. 4 illustrates a rack comprising a holding assembly according to some embodiments,

5 Fig. 5 illustrates the rack illustrated in Fig. 4 with the holding assembly in a storing position, and

Fig. 6 illustrates a dishwasher comprising the rack illustrated in Fig. 4 and Fig. 5.

10 DETAILED DESCRIPTION

The embodiments herein will now be described more fully with reference to the accompanying drawings, in which example embodiments are shown. Disclosed features of example embodiments may be combined. Like numbers refer to like elements throughout.

15

Well-known functions or constructions will not necessarily be described in detail for brevity and/or clarity.

Fig. 1 illustrates an exemplifying holding assembly 1 for holding one or more stemmed
20 objects 3 in a dishwasher. The holding assembly 1 comprises an elongated gripping unit frame 7 and two or more gripping units 5 arranged at the elongated gripping unit frame 7. The two or more gripping units 5 are arranged to grip a respective stemmed portion 4 of the one or more stemmed objects 3. At least one of the two or more gripping units 5 is displaceably arranged along a longitudinal direction l_d of the elongated gripping unit
25 frame 7.

Two or more of, or even all of, the gripping units 5 may be displaceably arranged along the longitudinal direction l_d of the elongated gripping unit frame 7. All six gripping units 5 of the holding assembly 1 illustrated in Fig. 1 are displaceably arranged along the
30 longitudinal direction l_d of the elongated gripping unit frame 7. The holding assembly 1 provided may comprise more than, or fewer than, six gripping units 5.

Since at least one of the two or more gripping units 5 is displaceably arranged, a distance d between the two or more gripping units 5 can be adjusted. Thereby, stemmed objects 3, such as wine glasses, having different diameters can be held in the holding assembly provided. Further, a space within a dishwasher in which the holding assembly is positioned may be utilized more efficiently and space may be provided for accommodating other form of dish than stemmed objects within a dishwasher.

As illustrated in Fig. 1, the elongated gripping unit frame 7 may comprise a rail structure in which the gripping units 5 are slidably arranged.

Each gripping unit 5 of the holding assembly 1 illustrated in Fig. 1 has a gripping mode and a releasing mode where each gripping unit 5 is arranged to release the respective stemmed portion 4 in the releasing mode, and where each gripping unit 5 is arranged to grip the respective stemmed portion 4 in the gripping mode.

Fig. 2 illustrates a gripping unit 5 of the holding assembly 1 illustrated in Fig. 1 in a releasing mode and Fig. 3 illustrates the gripping unit 5 of the holding assembly in a releasing mode. As can be seen in Fig. 2 and Fig. 3, each gripping unit 5 comprises a first arm 13.1 and a second arm 13.2 and a flexible strip 17 arranged between the first and second arms 13.1, 13.2. Also, as illustrated in Fig. 3 the flexible strip 17 is arranged to at least partially enclose the stemmed portion 4 of one of the one or more stemmed objects 3 when the gripping unit 5 is in the gripping mode.

Also, as can be seen in Fig. 2 and Fig. 3, the first arm 13.1 and the second arm 13.2 are rotatably arranged at the holding assembly and where a tip 15.1 of the first arm 13.1 and a tip 15.2 of the second arm 13.2 are arranged to be closer to each other when the gripping unit 5 is in the gripping mode than in the releasing mode.

The flexible strip 17 and/or the first arm 13.1 and the second arm 13.2 may be provided in a soft material. The soft material may be a ThermoPlastic Elastomers (TPE).

As illustrated in Fig.1 the elongated gripping unit frame 7 comprises one or more snap fittings 9. The snap fittings 9 allow the holding assembly 1 to be snapped onto a rack of a dishwasher. The snap fittings 9 may be displaceably arranged along the longitudinal

direction 1d of the elongated gripping unit frame 7. Thereby, a holding assembly 1 is provided which may be snapped onto racks having different designs. That is, a holding assembly 1 is provided which may be snapped onto racks having different distances between wires of the racks.

5

Fig. 4 illustrates a rack 15 comprising a holding assembly 1 according to some embodiments.

10 Snap fittings 9 of the holding assembly are arranged to allow the holding assembly 1 to be folded between at least a gripping position and a storing position in relation to the rack 15. In Fig. 4, the holding assembly 1 is illustrated in the gripping position.

15 Fig. 5 illustrates the rack illustrated in Fig. 4 with the holding assembly 1 in the storing position. As illustrated, the holding assembly may be tilted upwards to the storing position to thereby provide space for other form of dish than stemmed objects within the rack 15. Also, as can be seen in Fig. 4 and Fig. 5, tines 19 of the rack 15 has been folded to an upright position in Fig. 5 in comparison to the tines 19 illustrated in Fig. 4. Thereby, flat items to be washed, such as plates, can be accommodated in the rack 15 when the holding assembly 1 is in the storing position.

20

As can be seen in Fig. 1, Fig. 4 and Fig. 5 the holding assembly 1 comprises a gripping unit side 11 comprising the two or more gripping units 5 and a rear side 13 opposite to the gripping unit side 11. The rear side 13 comprises a wall 14 which is arranged with an angle α in the range of 100-120 degrees, preferably in the range of 105-115 degrees, more preferably approximately 110 degrees, to a main extension plane p of the holding assembly 1. The wall 14 is arranged to abut against wires of the rack 15 when the holding assembly is in the gripping position. Each gripping unit 5 are arranged to grip a stemmed portion of a stemmed object such that the stemmed portion, when gripped, is essentially perpendicular to the main extension plane p of the holding assembly 1.

25
30

The advantages with these features are illustrated in Fig. 4, namely that the main extension plane p will assume a corresponding angle to a main extension plane p_r of the rack 15, namely an angle α in the range of 100-120 degrees, preferably in the range of 105-115 degrees, more preferably approximately 110 degrees. Thereby, washing and

drying of a stemmed object 3, being held in a dishwasher by a holding assembly 1 provided, may be improved since water may more easily reach portions of such a stemmed object 3 and water may run off such a stemmed object 3 in a more efficient manner. In particular, drying of stemmed objects 3, such as wine glasses and champagne flutes, may be improved since water may run off from a bowl-shaped foot portion of such a glass. Further, stemmed objects 3, such as wine glasses and champagne flutes, may have a height exceeding a height h of the rack 15. Thus, these features may facilitate, and/or allow, positioning of such stemmed objects in the holding assembly 1.

10

Fig. 6 illustrates a dishwasher 2 comprising the rack 15 illustrated in Fig. 4 and Fig. 5. As illustrated, the rack 15 may be a lower rack of a dishwasher 2. According, a holding assembly 1 is provided which may allow the lower rack 15 of the dishwasher 2 to be used to accommodate delicate items such as wine glasses or champagne glasses in a safe manner.

15

It is to be understood that the foregoing is illustrative of various example embodiments and the embodiments herein is not to be limited to the specific embodiments disclosed and that modifications to the disclosed embodiments, combinations of features of disclosed embodiments as well as other embodiments are intended to be included within the scope of the appended claims.

20

CLAIMS

1. A holding assembly (1) for holding one or more stemmed objects (3) in a dishwasher (2), said holding assembly (1) comprising an elongated gripping unit frame (7) and two or more gripping units (5) arranged at said elongated gripping unit frame (7),
5 where said two or more gripping units (5) are arranged to grip a respective stemmed portion (4) of said one or more stemmed objects (3), and where at least one of said two or more gripping units (5) is displaceably arranged along a longitudinal direction (ld) of said elongated gripping unit frame (7).
- 10 2. The holding assembly (1) according to claim 1 where each gripping unit (5) has a gripping mode and a releasing mode where said each gripping unit (5) is arranged to release said respective stemmed portion (4) in said releasing mode, and where said each gripping unit (5) is arranged to grip said respective stemmed portion (4) in said gripping mode.
- 15 3. The holding assembly (1) according to claim 2, where said each gripping unit (5) comprises a first arm (13.1) and a second arm (13.2) and a flexible strip (17) arranged between said first and second arms (13.1, 13.2).
- 20 4. The holding assembly (1) according to claim 3, where said flexible strip (17) is arranged to at least partially enclose said stemmed portion (4) of one of said one or more stemmed objects (3) when said gripping unit (5) is in said gripping mode.
- 25 5. The holding assembly (1) according to claim 3 or 4, where said first arm (13.1) and said second arm (13.2) are rotably arranged at said holding assembly (1) and where a tip (15.1) of said first arm (13.1) and a tip (15.2) of said second arm (13.2) are arranged to be closer to each other when said gripping unit (5) is in said gripping mode than in said releasing mode.
- 30 6. The holding assembly (1) according to any one of the preceding claims where said elongated gripping unit frame (7) comprises one or more snap fittings (9), and where said holding assembly (1) is arranged to be snapped onto a rack (15) of the dishwasher (2) via said one or more snap fittings (9).

7. The holding assembly (1) according to claim 6, where said one or more snap fittings (9) are displaceably arranged along said longitudinal direction (ld) of said elongated gripping unit frame (7).
- 5 8. The holding assembly (1) according to claim 6 or 7, where said snap fittings (9) are arranged to allow said holding assembly (1) to be folded between at least a gripping position and a storing position in relation to said rack (15) of said dishwasher (2).
- 10 9. The holding assembly (1) according to any one of the preceding claims where said holding assembly (1) comprises a gripping unit side (11) comprising said two or more gripping units (5) and a rear side (13) opposite to said gripping unit side (11), where said rear side (13) comprises a wall (14) being arranged with an angle (a) in the range of 100-120 degrees, to a main extension plane (p) of said holding assembly (1).
- 15 10. A rack (15) of a dishwasher (2) comprising a holding assembly (1) according to any one of the claims 1-9.
- 20 11. A dishwasher (2) comprising a rack (15) according to claim 10.

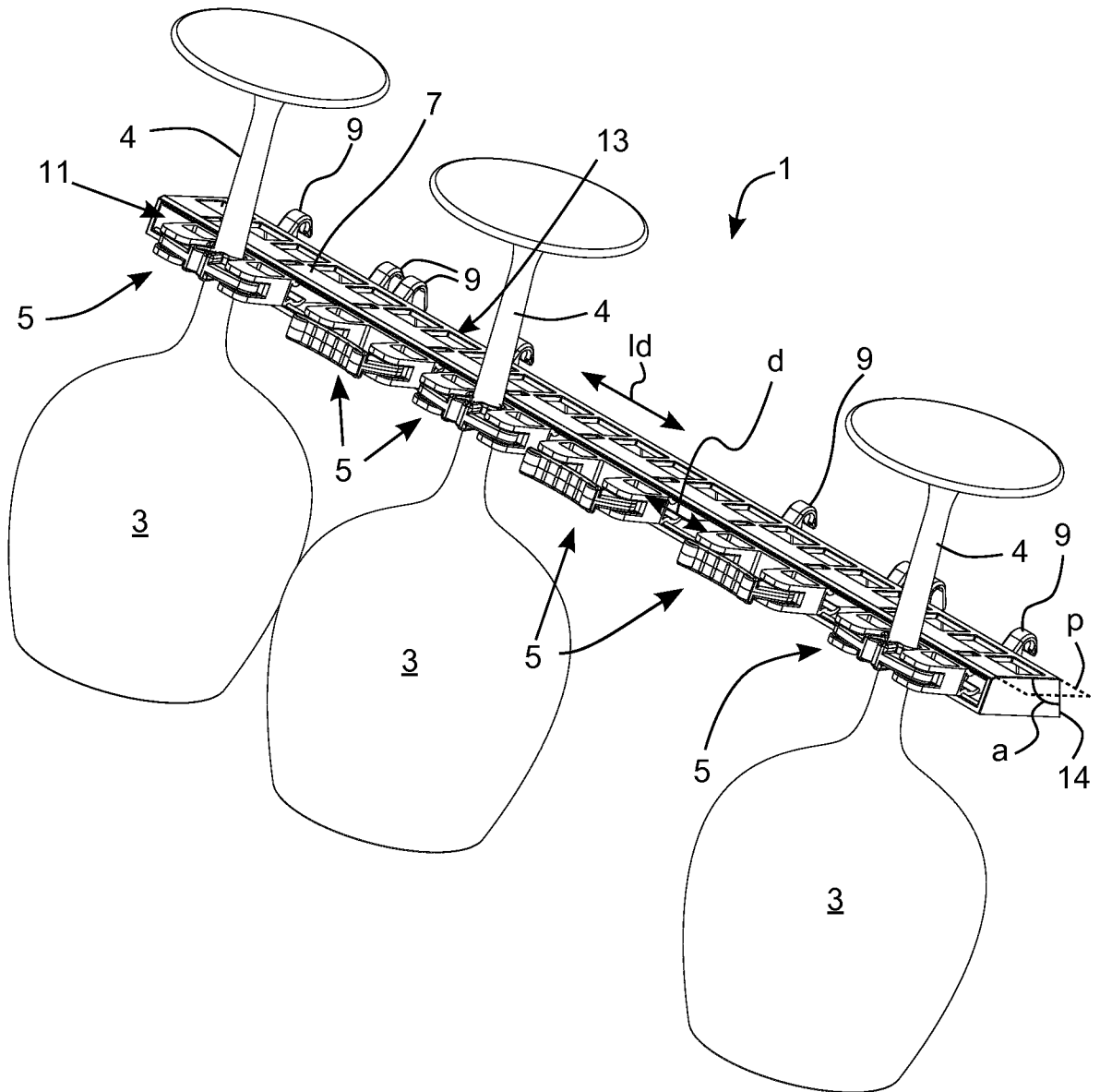

Fig. 1

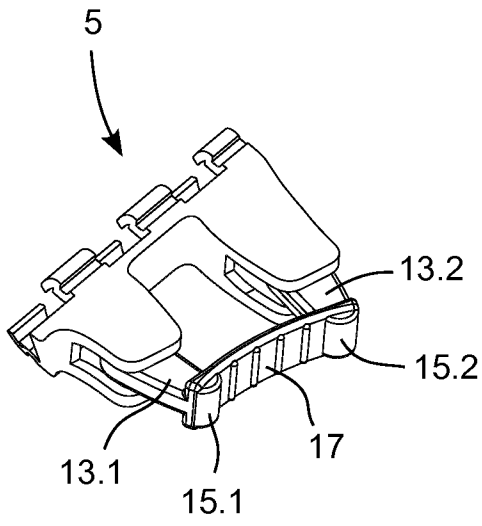

Fig. 2

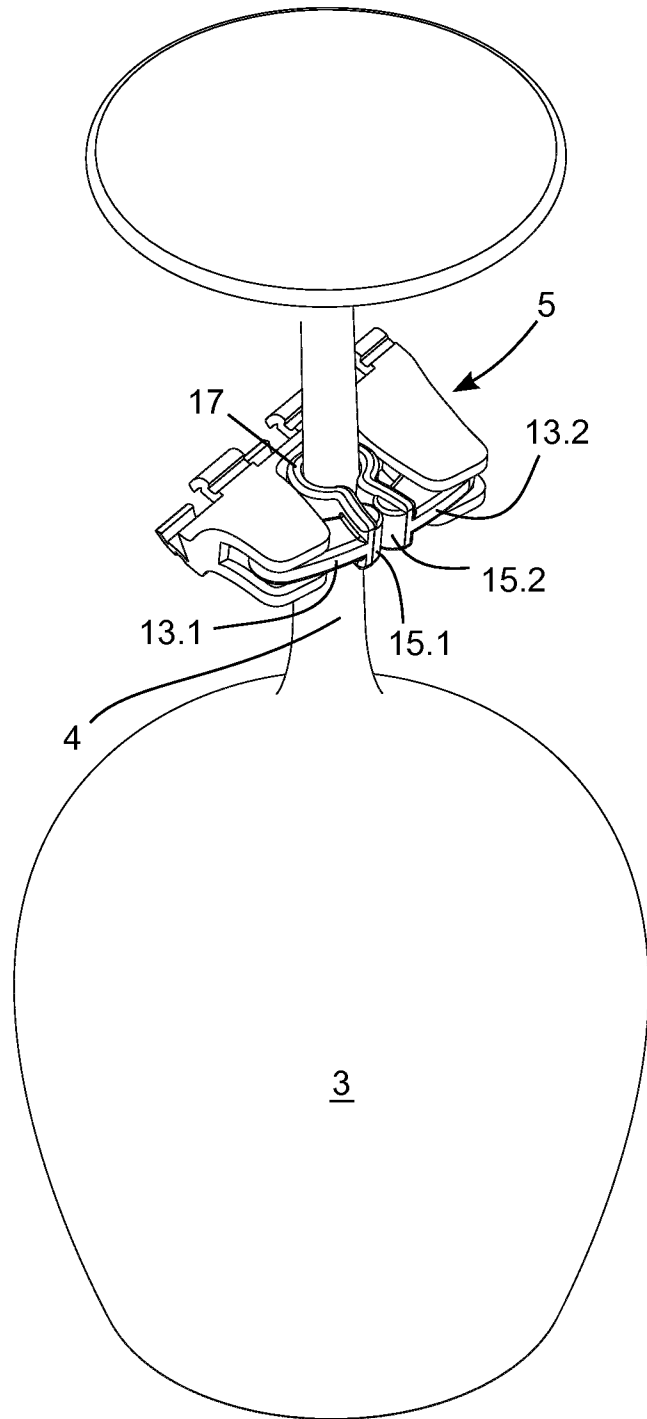

Fig. 3

3/5

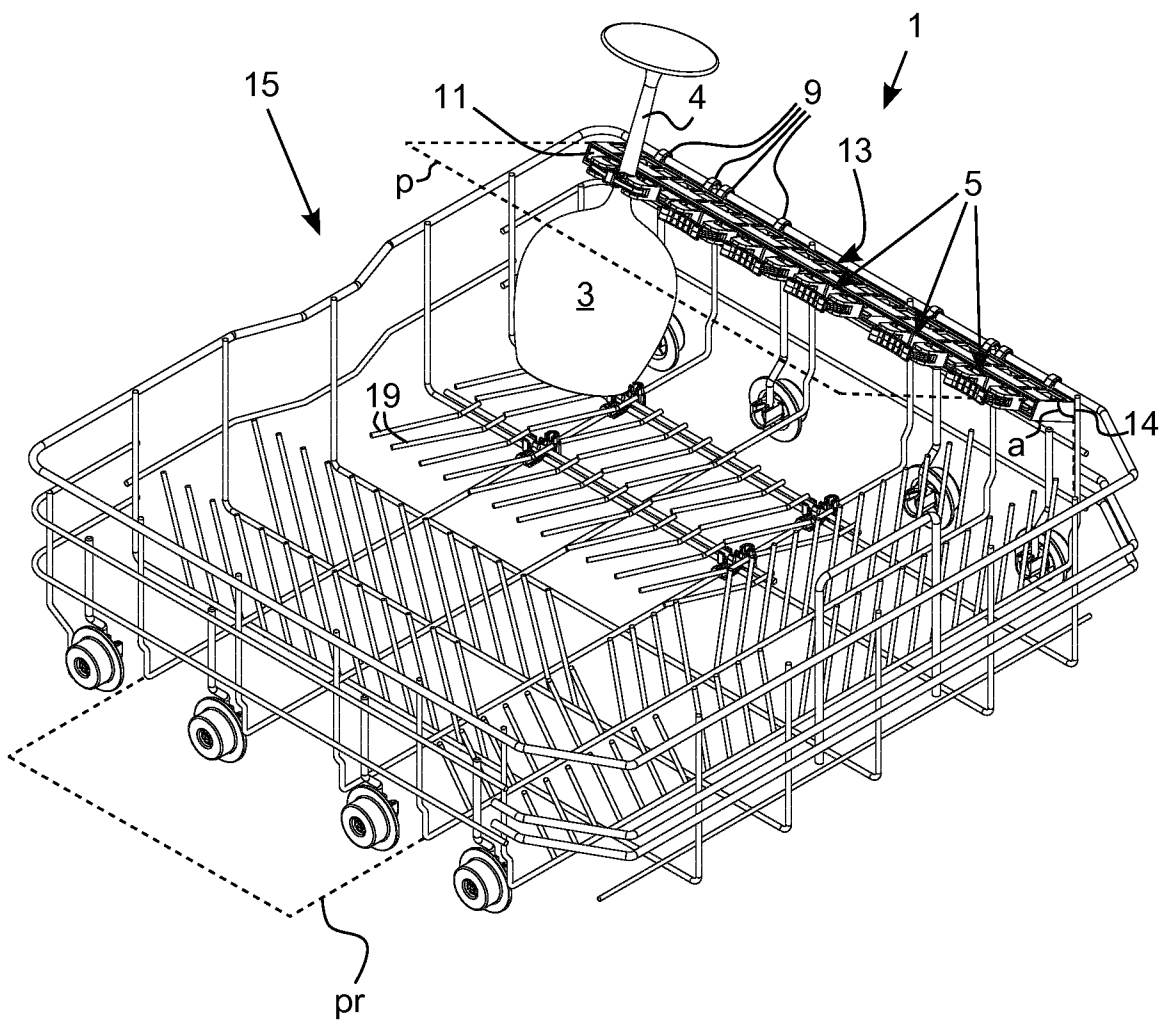

Fig. 4

4/5

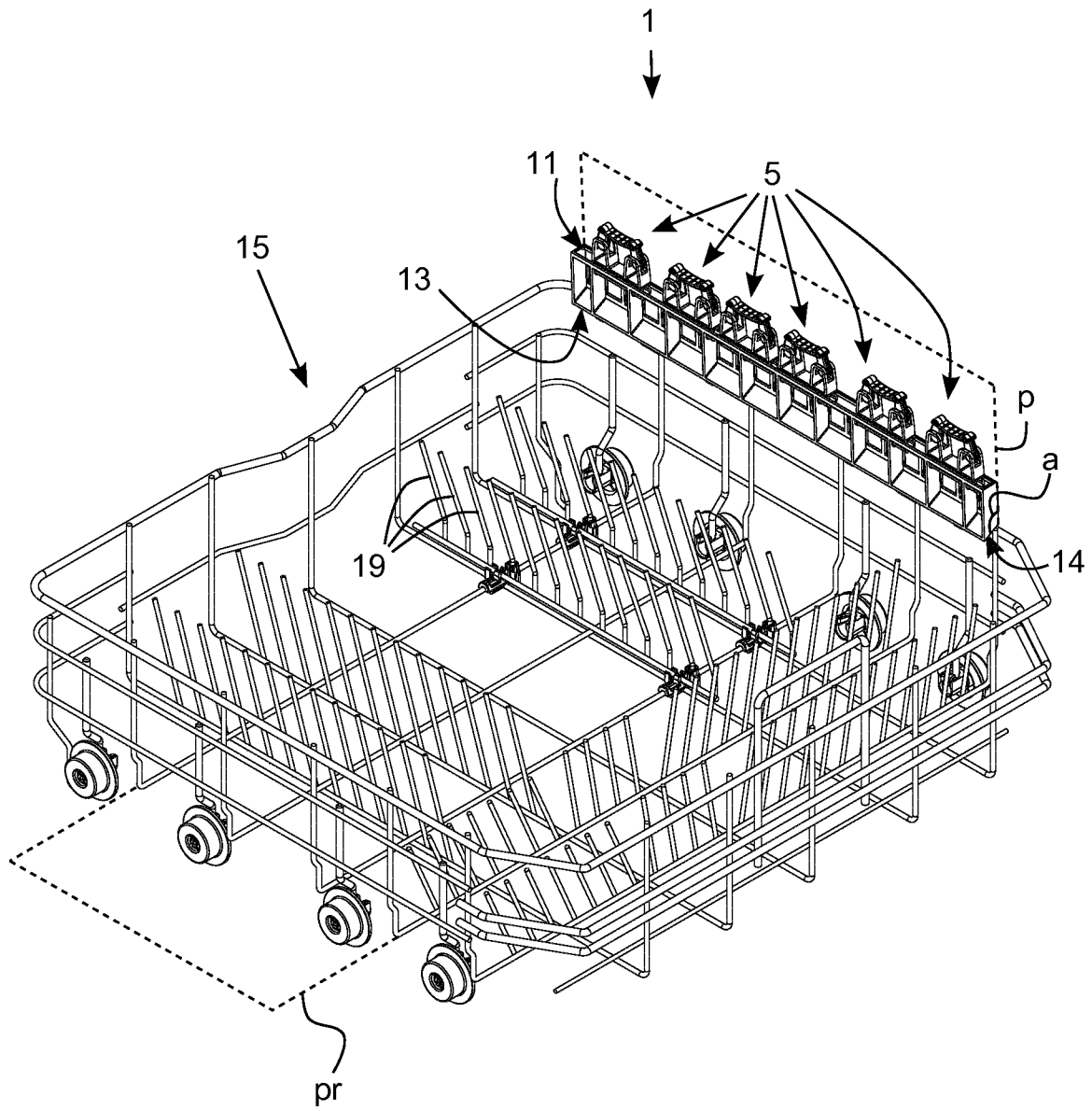

Fig. 5

5/5

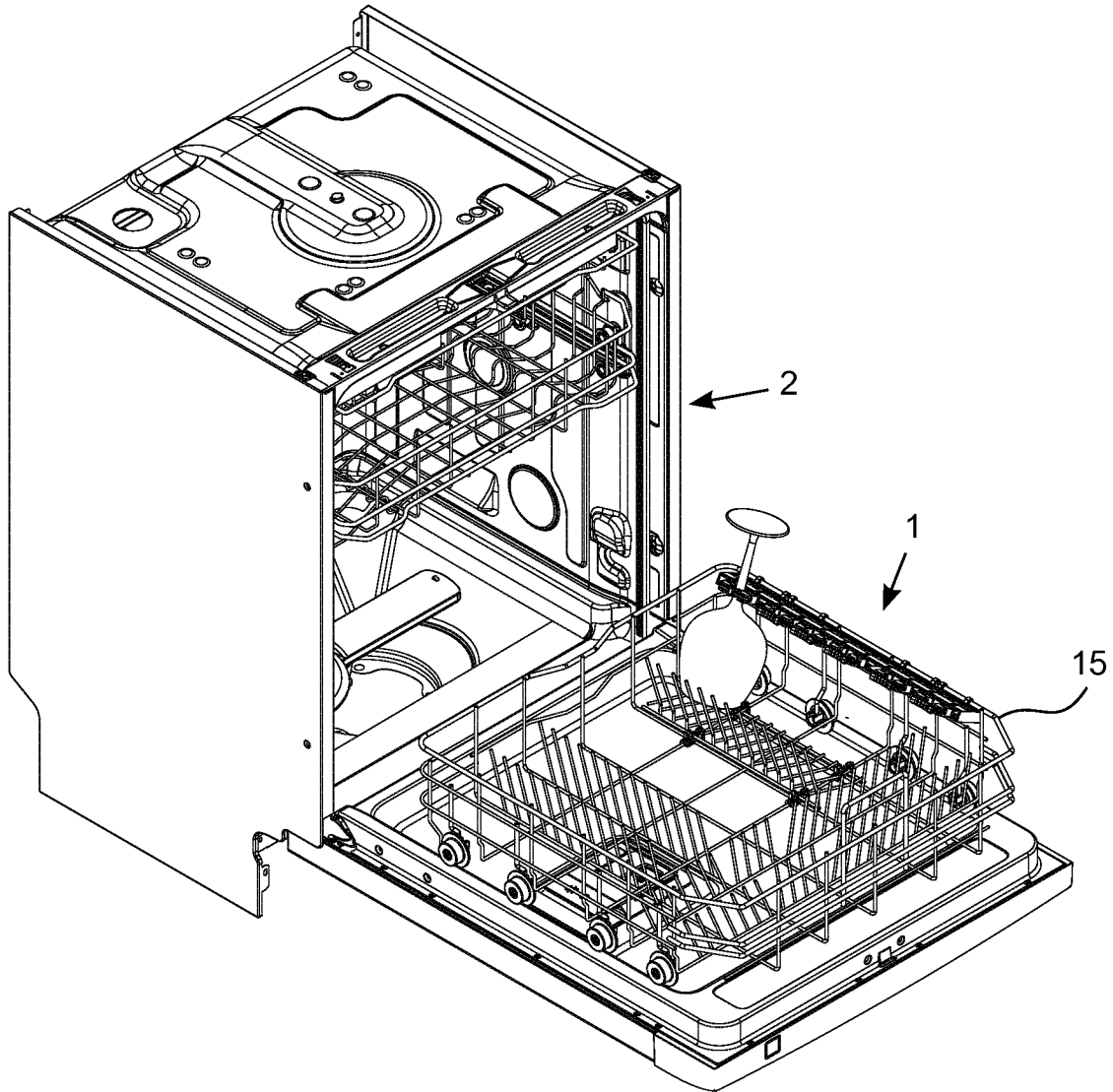

Fig. 6

INTERNATIONAL SEARCH REPORT

International application No
PCT/EP2014/068528

A. CLASSIFICATION OF SUBJECT MATTER
INV. A47L15/50
ADD.

According to International Patent Classification (IPC) or to both national classification and IPC

B. FIELDS SEARCHED
Minimum documentation searched (classification system followed by classification symbols)
A47L B60N A47G

Documentation searched other than minimum documentation to the extent that such documents are included in the fields searched

Electronic data base consulted during the international search (name of data base and, where practicable, search terms used)
EPO-Internal, WPI Data

C. DOCUMENTS CONSIDERED TO BE RELEVANT

Category*	Citation of document, with indication, where appropriate, of the relevant passages	Relevant to claim No.
X	US 2005/236345 A1 (HERBST STEVE M [US] ET AL) 27 October 2005 (2005-10-27)	1,2,6,7,10,11
Y	page 2, paragraph 21 - paragraph 28; figures 1,3,5	3-5,8,9
X	WO 2013/045543 A1 (ARCELIK AS [TR]; KILIC OSMAN [TR]; AKIN TOLGA [TR]; GOKSU SALIH [TR]) 4 April 2013 (2013-04-04)	1,6,7,10,11
Y	page 4, paragraph 23 - paragraph 26; figures 1-5	8,9
Y	WO 2014/094898 A1 (ELECTROLUX HOME PROD CORP [BE]) 26 June 2014 (2014-06-26)	3-5
Y	figures 1-4	
Y	WO 2014/108079 A1 (FOSHAN SHUNDE MIDEA WASHING APPLIANCES MFG CO LTD [CN]) 17 July 2014 (2014-07-17)	8,9
	figures 2,4,5	

Further documents are listed in the continuation of Box C.

See patent family annex.

* Special categories of cited documents :

- "A" document defining the general state of the art which is not considered to be of particular relevance
- "E" earlier application or patent but published on or after the international filing date
- "L" document which may throw doubts on priority claim(s) or which is cited to establish the publication date of another citation or other special reason (as specified)
- "O" document referring to an oral disclosure, use, exhibition or other means
- "P" document published prior to the international filing date but later than the priority date claimed

- "T" later document published after the international filing date or priority date and not in conflict with the application but cited to understand the principle or theory underlying the invention
- "X" document of particular relevance; the claimed invention cannot be considered novel or cannot be considered to involve an inventive step when the document is taken alone
- "Y" document of particular relevance; the claimed invention cannot be considered to involve an inventive step when the document is combined with one or more other such documents, such combination being obvious to a person skilled in the art
- "&" document member of the same patent family

Date of the actual completion of the international search
27 April 2015

Date of mailing of the international search report
11/05/2015

Name and mailing address of the ISA/
European Patent Office, P.B. 5818 Patentlaan 2
NL - 2280 HV Rijswijk
Tel. (+31-70) 340-2040,
Fax: (+31-70) 340-3016

Authorized officer
Lodato, Alessandra

INTERNATIONAL SEARCH REPORT

Information on patent family members

International application No PCT/EP2014/068528

Patent document cited in search report		Publication date		Patent family member(s)	Publication date
US 2005236345	A1	27-10-2005		NONE	
WO 2013045543	A1	04-04-2013		EP 2760326 A1	06-08-2014
				WO 2013045543 A1	04-04-2013
WO 2014094898	A1	26-06-2014		NONE	
WO 2014108079	A1	17-07-2014		CN 203089044 U	31-07-2013
				WO 2014108079 A1	17-07-2014