



US006392633B1

(12) **United States Patent**
Leiper

(10) **Patent No.:** **US 6,392,633 B1**
(45) **Date of Patent:** ***May 21, 2002**

(54) **APPARATUS FOR AUDIO DICTATION AND NAVIGATION OF ELECTRONIC IMAGES AND DOCUMENTS**

(76) Inventor: **Thomas Leiper**, 216 Cascade Rd., Stamford, CT (US) 06903

(*) Notice: This patent issued on a continued prosecution application filed under 37 CFR 1.53(d), and is subject to the twenty year patent term provisions of 35 U.S.C. 154(a)(2).

Subject to any disclaimer, the term of this patent is extended or adjusted under 35 U.S.C. 154(b) by 0 days.

This patent is subject to a terminal disclaimer.

(21) Appl. No.: **09/651,647**

(22) Filed: **Aug. 30, 2000**

Related U.S. Application Data

(63) Continuation of application No. 08/887,907, filed on Jul. 3, 1997.

(60) Provisional application No. 60/021,359, filed on Jul. 8, 1996.

(51) **Int. Cl.⁷** **G09G 5/08**

(52) **U.S. Cl.** **345/161**

(58) **Field of Search** 345/156, 157, 345/328, 327, 439, 979, 330, 329, 341, 342, 123, 167; 704/225, 233, 238, 275, 270, 201; 386/53, 54, 1.25, 46, 96; 353/25; 463/36-47

(56) **References Cited**

U.S. PATENT DOCUMENTS

4,599,489 A 7/1986 Cargile
4,622,013 A 11/1986 Cerchio

4,642,621 A	2/1987	Nemoto et al.
4,647,916 A	3/1987	Boughton
4,672,481 A	6/1987	Zieger et al.
4,764,965 A	8/1988	Yoshimura et al.
5,019,976 A	5/1991	Chiu et al.
5,072,408 A	12/1991	Ueda
5,077,666 A	12/1991	Brimm et al.
5,099,846 A	3/1992	Hardy
5,197,052 A	3/1993	Schroder et al.
5,204,947 A	4/1993	Bernstein et al.
5,220,611 A	6/1993	Nakamura et al.
5,235,510 A	8/1993	Yamada et al.
5,272,760 A	12/1993	Echerer et al.
5,274,759 A	12/1993	Yoshioka
5,293,313 A	3/1994	Cecil et al.
5,298,919 A	3/1994	Chang
5,313,567 A	5/1994	Civanlar et al.
5,365,500 A	11/1994	Park
5,388,197 A	2/1995	Rayner
5,402,518 A	3/1995	Lowery
5,414,808 A	5/1995	Williams
5,452,416 A	9/1995	Hilton et al.
5,477,511 A	12/1995	Englehardt
5,481,645 A	1/1996	Bertino et al.
5,485,171 A	1/1996	Copper et al.
5,519,809 A	5/1996	Husseiny et al.
5,530,455 A	6/1996	Gillick et al.
5,767,841 A	6/1998	Hartman
5,774,841 A	6/1998	Salazar et al.

Primary Examiner—Chanh Nguyen

(74) *Attorney, Agent, or Firm*—St. Onge Steward Johnston & Reens LLC

(57) **ABSTRACT**

Apparatus for annotation and navigation of electronic images comprising a handheld controller for use with a computer system. The controller comprises a microphone, voice dictation controls that generate commands to operate a digital audio recording and playback functions in the computer system, and image display controls to advance or back up through a series of images or files displayed in an image display unit of the computer system.

26 Claims, 5 Drawing Sheets

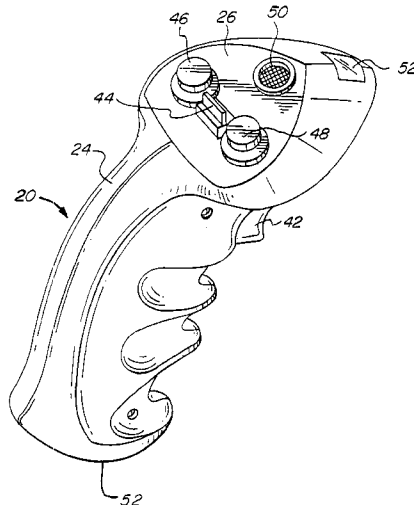

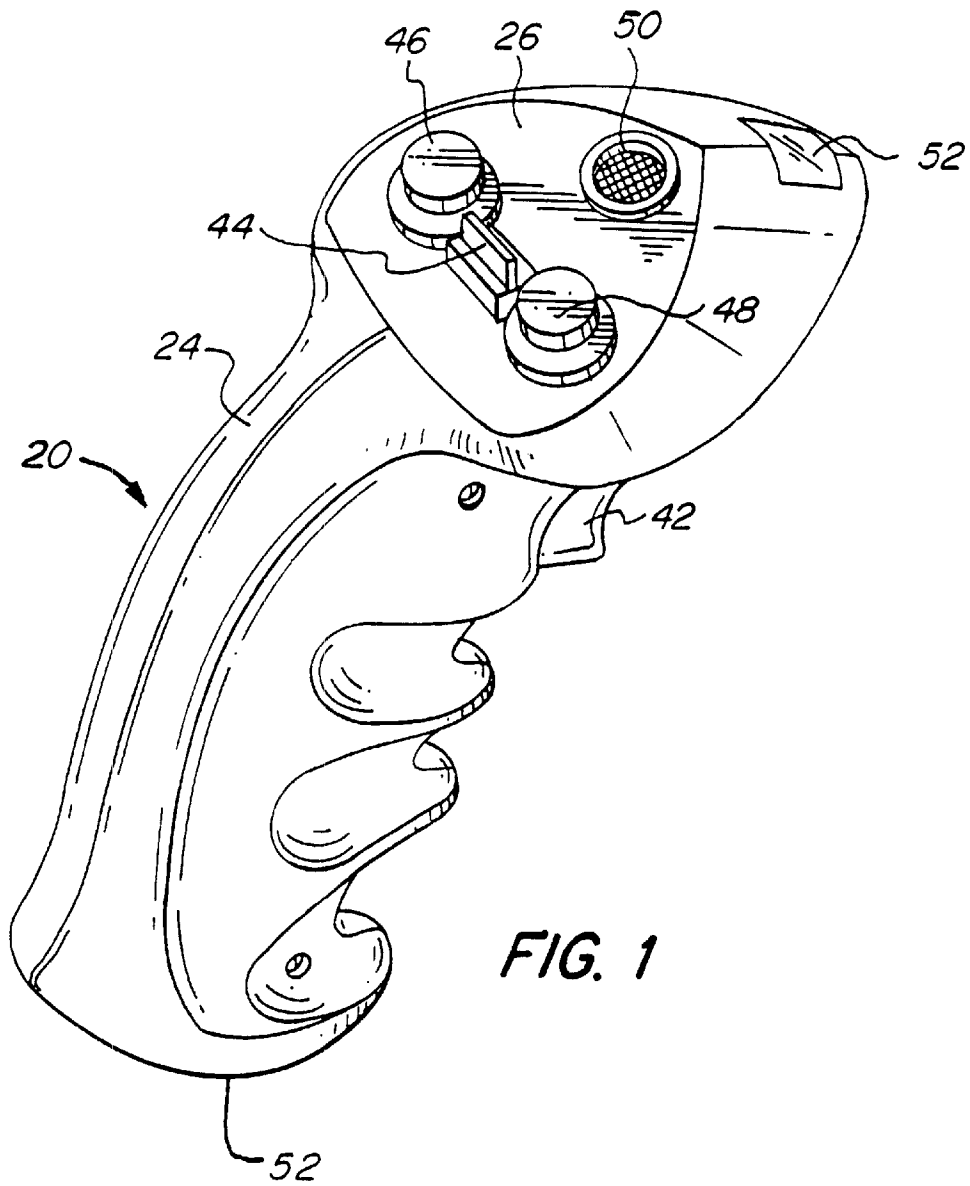
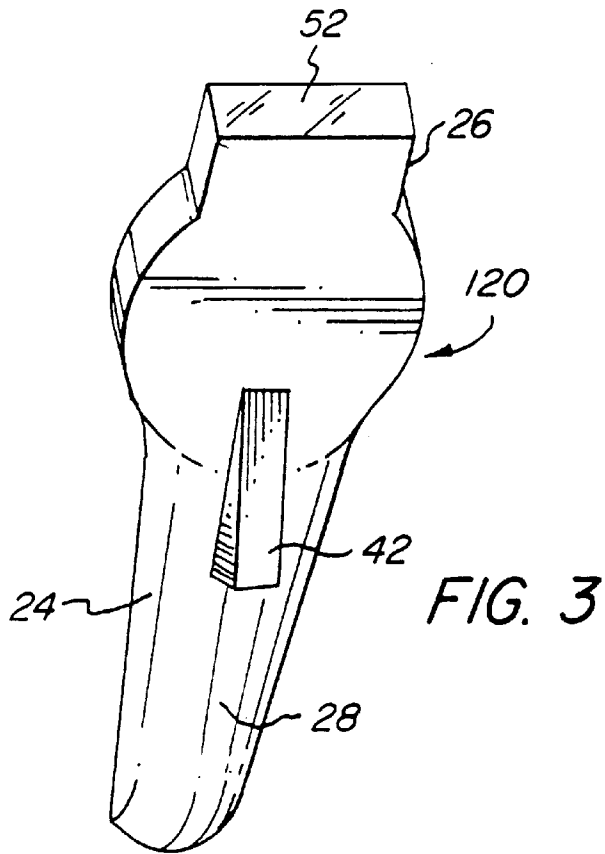
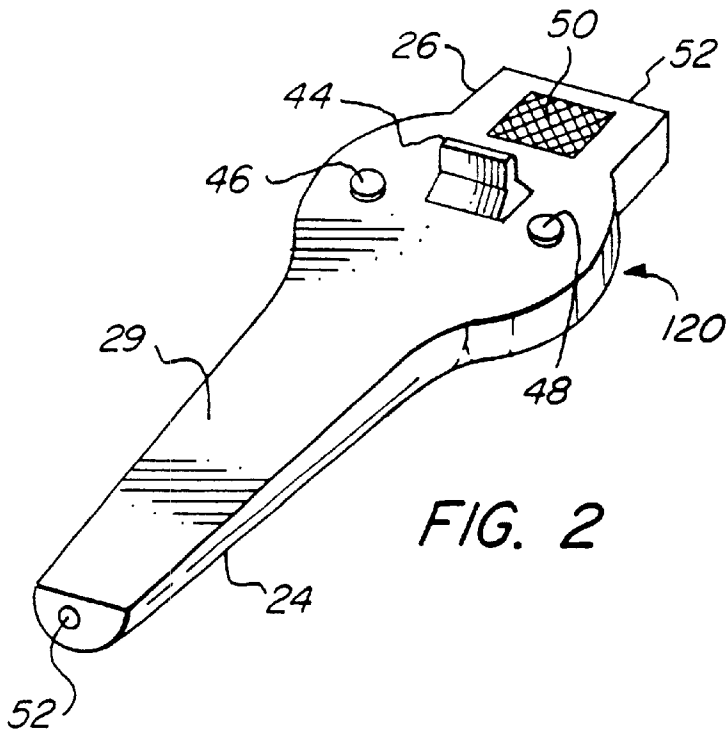

FIG. 1



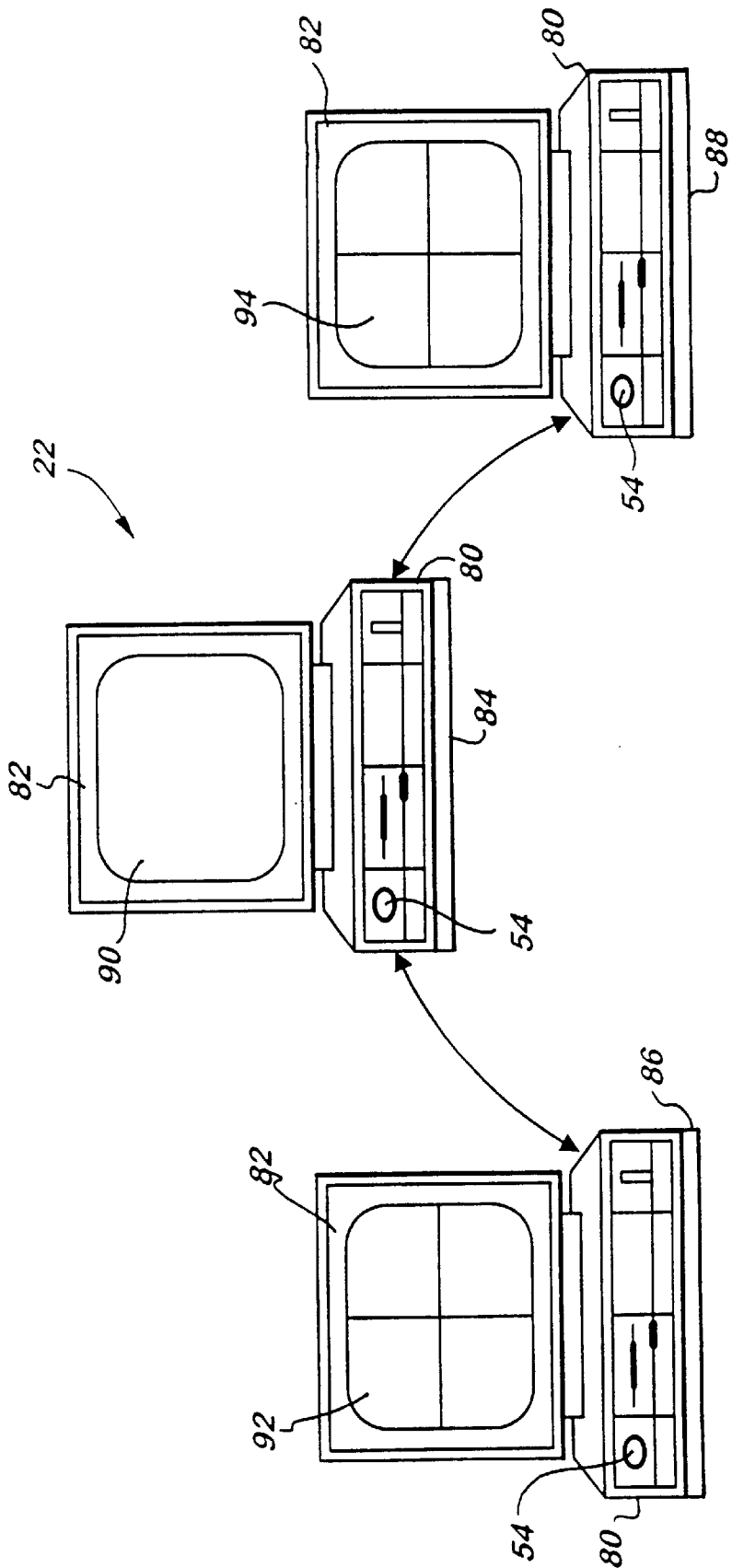

FIG. 4

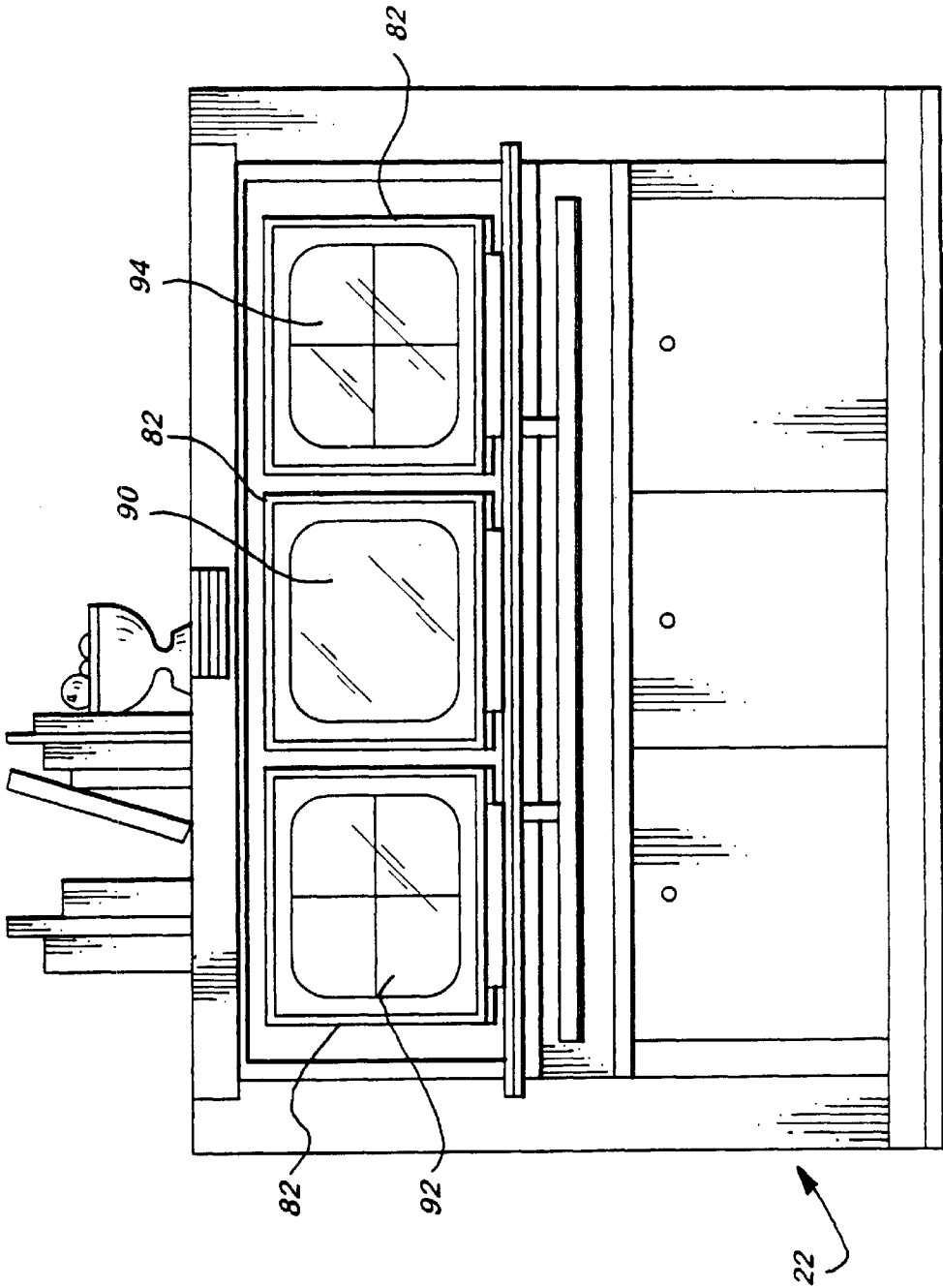

FIG. 5

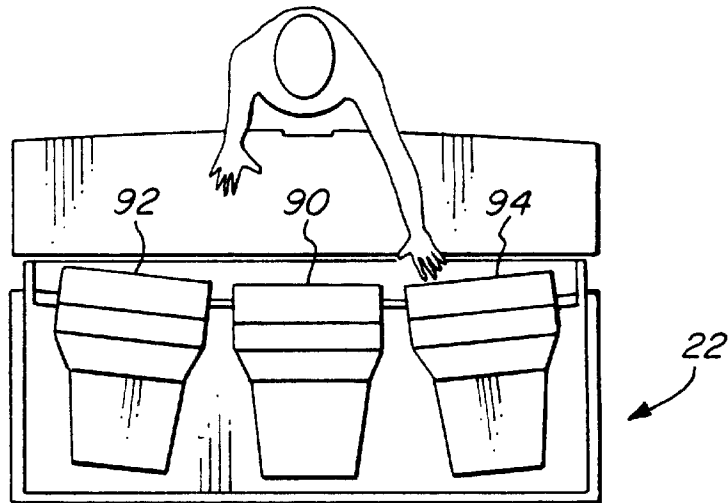

FIG. 6

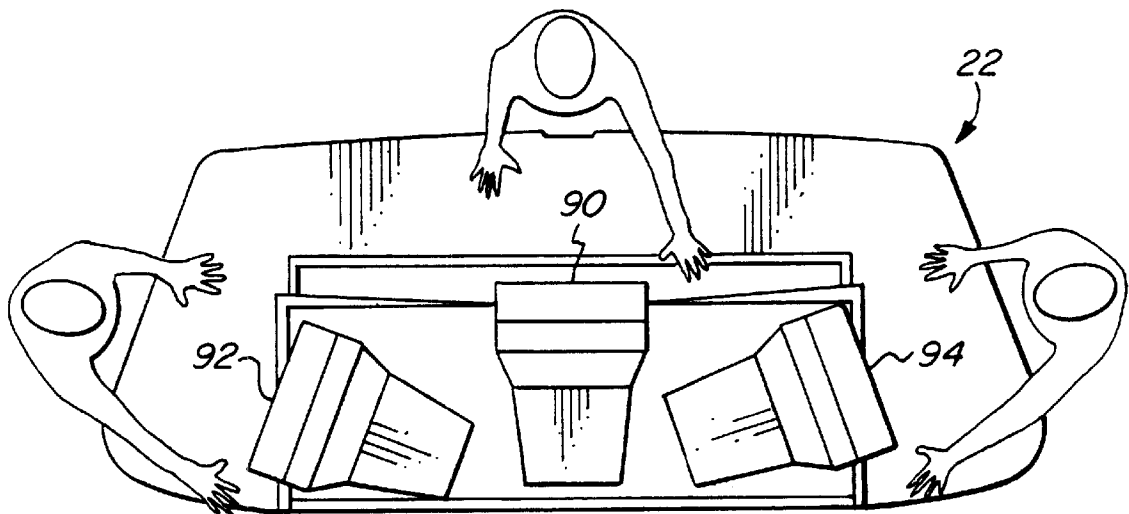

FIG. 7

APPARATUS FOR AUDIO DICTATION AND NAVIGATION OF ELECTRONIC IMAGES AND DOCUMENTS

This application is a continuation of U.S. patent application Ser. No. 08/887,907 filed Jul. 3, 1997 in the name of Thomas Leper and entitled "Apparatus for Audio Dictation and Navigation of Electronic Images and Documents"; which application is based on and claims priority under 35 U.S.C. § 119(e) from U.S. provisional patent application Ser. No. 60/021,359 filed Jul. 8, 1996.

FIELD OF THE INVENTION

The present invention relates generally to the field of computerized image acquisition, management and display, with particular use in the field of medical applications thereof.

BACKGROUND OF THE INVENTION

Radiographic images, such as X-ray films, and Magnetic resonance imaging ("MRI") and computerized tomograph (CT) transparencies have traditionally been reviewed by a diagnosing physician such as a radiologist on a film viewer, on which a series of images in a patient study are displayed in groups of two or more. Different image series, generated by processing the data captured during a patient scan in different ways, are typically provided. The different image series may display the same portions of the patient's anatomy but processing reduces the amount of information in the image to allow for films having sufficient pixel depth to provide the detail needed for diagnosis in the tissue of interest. The film viewer may be a static light box or a motorized film viewer. A motorized film viewer consists of vertically positioned light boxes and an endless belt on which the films are mounted and which passes the films in front of the light boxes. Motorized film viewers are controlled by the radiologist using foot pedals which activate the motorized viewer to cause the films to be moved to the left or to the right (or in some cases, up and down) to permit viewing of the desired portions of the film series. The images are usually presented in a standard sequence, usually in the order of image capture. The radiologist will typically dictate a medical study into a tape recorder while viewing the films, for later transcription. The films and transcribed dictation are stored in a patient's file.

Filmless image systems have also been proposed and used. Filmless systems have been used in connection with handling both MRI images, and computer tomography images generated by processing X-ray image data to generate a series of "slices" through the human body. Such systems historically have presented all the image data captured by the MRI or tomography equipment, as opposed to in film images (where the medical technician will expose films only for selected series of images of clinical interest). This mass of information has proven unwieldy to review and consider, as instead of filtering the image data through the selection of a skilled technician, all the image data is presented to the diagnosing physician. Another disadvantage of this approach is that it does not provide an "image of record," that is, the basic image(s) relied on by the physician in making the diagnosis. Given the limitations of the image processing equipment, it took a significant amount of time to review the numerous image series. Such systems are far less efficient than the conventional light boxes, which allowed the radiologist to rapidly review numerous series of images to find the few images showing the pathological condition of

interest. Other filmless systems have been proposed in which a series of images are presented to the diagnosing physician simultaneously. One such system is described in Hilton, U.S. Pat. No. 5,452,416.

However, all of these systems have proven awkward in actual use, as they require use of mouse, keyboard, trackball or other device to navigate through the image series. These control devices severely impair the diagnosing physician's ability to concentrate on the images presented and to relate the images to his knowledge built up through years of practicing medicine. The constant need to correctly position and actuate a mouse and trackball to navigate through images has made the use of such systems far less efficient than conventional film systems. In conventional film systems, the image navigation is effortless, requiring no more than movement of the eyes over a wall filled with film images, allowing the diagnosing physician to concentrate on the real work of interpreting the medical images to reach a diagnosis. Such control devices thus limit the fluid navigation by the diagnosing physician through the image series, and tie the physician to a single position. These control devices are also awkward for a diagnosing physician who may need to refer to materials such as textbooks or prior film-based medical studies for comparison. These devices also may impede the physician's ability to easily dictate the medical study, as most dictation equipment requires a handheld recorder or microphone, thus requiring the physician to either put down and pick up the microphone each time he needs to activate the mouse or trackball to see further images. Alternatively, the physician might learn to work two handedly, but this creates additional complications, for example, if the physician also desired to turn pages in or otherwise refer to a text or other reference material.

SUMMARY OF THE INVENTION

It is an object of the invention to provide a apparatus and method for annotation and navigation of electronic images and documents that increases the diagnosing physician's efficiency in using the system.

It is an object of the invention to provide such an apparatus that can be operated single handedly. It is an object of the invention to provide such a system which permits the diagnosing physician to move around in a work area to retrieve reference works, view past studies, or do other things while at the same time continuing with the medical study of the images.

These objects, and other objects as disclosed in this application, are achieved by an apparatus for audio dictation and navigation of electronic images for use with a personal computer system. The computer system is provided with at least one image display unit, random access memory, means for digital data storage, and an analog to digital conversion system. The apparatus comprises a handheld wireless controller having a combination of controls serving as an image control actuator and a dictation actuator. The image control actuator is operable to transmit wireless control signals to a wireless control signals receiving unit operably connected to the computer system to cause the computer system to display each one of a series of electronic images, in sequential order, and to select display of each next image or next preceding image, and to cause display of related image series in sequential order, and to select display of each next image series or next preceding image series. The dictation actuator is operable to activate wireless transmission of voice signals, generated by a microphone, to a wireless voice signals receiving unit operably connected to the com-

puter system to cause the computer system to convert the voice signals to digital signals and to record the digitized voice signals as digital audio files in the means for digital data storage, and to permit selective playback of such files. Further details of the invention are described below.

BRIEF DESCRIPTION OF THE DRAWINGS

The foregoing aspects and other features of the invention are explained in the following description, taken in connection with the accompanying drawings, wherein:

FIG. 1 is a top rear perspective view of a handheld apparatus for audio dictation and navigation of electronic images and documents in accordance with one embodiment of the invention.

FIG. 2 is a top rear perspective view of a handheld apparatus for audio dictation and navigation of electronic images and documents in accordance with another embodiment of the invention.

FIG. 3 is a bottom front perspective view of the handheld apparatus for audio dictation and navigation of electronic images and documents of FIG. 2.

FIG. 4 is a front schematic illustration of computers of an interpretation unit for use with the handheld apparatus of FIGS. 1, 2 and 3.

FIG. 5 is a front elevation view of an embodiment of an interpretation unit.

FIG. 6 is a top plan view of the monitors of an interpretation unit positioned for use by a single person.

FIG. 7 is a top plan view of the monitors of an interpretation unit positioned for use by multiple persons.

DETAILED DESCRIPTION OF THE INVENTION

Referring to FIGS. 1-7, where like numbered elements in the drawings represent the same elements, a handheld controller 20 for audio dictation and navigation of electronic images and documents is shown in FIG. 1, and another embodiment of such a controller is shown in FIGS. 2 and 3 as 120.

Controllers 20, 120 comprise two significant control subsystems. An image control subsystem permits navigation among the images to be displayed by a viewing unit. A dictation subsystem operates to receive voice dictation. Preferably, a wireless transmitter subsystem transmits commands from the image control subsystem and the dictation control subsystem to a personal computer based interpretation unit 22.

Referring now to FIGS. 4 and 5, the interpretation unit 22 is preferably provided with at least one conventional personal computer or workstation system 80. Most preferably, interpretation unit 22 comprises three conventional personal computer systems 80 which are linked together by a network system. Each personal computer system 80 is preferably a conventional personal computer such as an Intel processor based system running a Windows 95 or Windows NT operating system. Each personal computer system 80 includes an image display unit 82 such as a 20 inch by 20 inch 0.28 dpi non interlaced monitor, random access memory (preferably a minimum of 32 megabytes, and more preferably 128 megabytes), means for digital data storage such as a hard disk drive, and an analog to digital conversion system for converting analog audio signals to digital format. The use of three linked personal computers provides a simple and effective way of driving three separate monitors, which can be independently controlled by the handheld

controllers 20, 120 or which can be controlled by the handheld controllers 20, 120 via a selected "master" personal computer 84, with the flanking left personal computers 86 and right personal computer 88 acting as "slave" computers under the control of the "master" computer 84.

In the present invention, various fields of view are contemplated, including a main viewer 90, a left clipboard viewer 92, and a right clipboard viewer 94. As described below, the main viewer 90 will display an image which is then being studied, and the left and right clipboard viewers 92 and 94 serve auxiliary display functions.

In an embodiment of the interpretation unit 22 in which three personal computers are networked together, the monitor of the master computer 84 acts as the main viewer 90, the monitor of the left slave computer 86 will act as a left clipboard viewer 92 and the monitor of the right slave computer 88 will act as the right clipboard viewer 94. However, the viewers 90, 92 and 94 may also be implemented as separate windows displayed on a single monitor if interpretation unit 22 comprises a single personal computer or workstation. In addition, since patient medical images at this time generally consist of black and white images, it would also be possible to implement the three viewers as separate monitors driven by a single personal computer or workstation by appropriate software to drive each monitor in one of the R,G,B (red, green, blue) channels of the RGB color model.

In a preferred embodiment, the three monitors of interpretation unit 22 are mounted on a pivoting mountings, as shown in FIGS. 6 and 7. The pivoting mountings position the main viewer monitor 90 in a central position, with the left and right clipboard viewer monitors 92 and 94 angled inwardly to provide a convenient viewing of all three monitors simultaneously, as shown in FIG. 6. The pivoting mountings are also designed so that the left and right clipboard viewer monitors may be pivoted outwardly, to allow for use of the left and right clipboard viewer monitors 92 and 94 as separate main viewers by other medical personnel, as shown in FIG. 7.

Interpretation unit 22 will have installed in it a "Viewer" application software running on Windows 95 or Windows NT that responds to the diagnosing physician's use of the controllers 20, 120 to implement the commands transmitted from controllers 20, 120. Where interpretation unit 22 consists of three separate computers, each computer will have the "Viewer" software loaded on it, allowing each computer and its associated monitor to be simultaneously used by different persons if desired. The use of separate computers with "Viewer" software provides backup systems in the event of the failure of the "master" computer 84.

In the expected environment of use, the interpretation unit 22 will have received a digital "folder" for the patient to be diagnosed. The "folder" will contain patient identifying information, a patient medical history and/or chart; and a series of digital images to be reviewed by the diagnosing physician. Unlike current filmless systems, the patient images stored in the folder will be images selected by a skilled technician in the same way as is now done in conventional radiology film systems. The images in the patient file will be captured at the MRI or other imaging unit by placing a suitable digitizing tablet in the location where films are exposed by the technician. The exact same procedures as in selecting images for film exposure will apply to the filmless images to be captured for use in the present invention. The digital images are preferably provided in a bitmap format, although other formats may be used.

The patient "folder" will typically be named with the name of the patient, e.g. "John Smith." The interpretation unit **22** may receive such patient information via a hospital network, or a modem transmission, or directly from an image capture device such as a MRI unit.

Controller **20** uses a pistol grip with a control end **26** located in an upper end, similar in appearance to a computer joystick used for playing computer games. Controller **120** is a more elongate handheld device with a control end **26** at one end. In the specification following the term "controller **20**" shall be used to refer to both controllers **20** and **120**, as the functions thereof are identical, the sole difference being in their shape.

Controller **20** is preferably shaped to be comfortably held in one hand. At control end **26** of case **24** are provided the controls for operating the image control subsystem and the dictation control subsystem.

In the preferred embodiment, the controller **20** has only four switch elements or assemblies to operate as the dictation control and the image display control: a trigger switch **42** located at the underside **28** of controller **20**; a pressure switch **44** located on the upper surface **29** of controller **20**; and a left toss button **46** located on the upper surface **29** of controller **20** to the left of pressure switch **44**; and a right toss button **48** located on the upper surface **29** of controller **20** to the right of pressure switch **44**. With reference to FIG. 1, the trigger switch **42** is located where it may be actuated by the forefinger of the user, while the pressure switch **44** and the left and right toss buttons are located on the upper surface of controller **20** where they may be actuated by the user's thumb. These four switch elements or assemblies provide all necessary inputs to achieve the navigation of images and dictation control. If desired, of course, additional buttons and controls may be added, but it is expected that a minimum of controls will provide the most reliable and user friendly control. The present invention desirably has no more than six switch elements or assemblies for operation of all necessary functions. The reduction of controls is achieved in the present invention by allowing for different types of inputs to each switch assembly, such as double clicking or pressure sensitive switches, that allow for different outputs for each input. This is also achieved in the present invention by providing for the different switch assemblies to operate different functions depending on the current mode of operation of the image display and the audio dictation, or combination thereof, at the time of the input to the control.

It is to be appreciated that other switch elements may be substituted for the preferred switch embodiments described above in connection with the controller **20**. For example, in an alternative embodiment, the functions of pressure switch **44** and left and right toss buttons **46** and **48** described below may be implemented in a joystick type control that is movable from front to back and left to right, or by a four way rocker switch, or a thumbwheel, or a tiny trackball, or a sensitive touchpad, or set of directional arrow keys located in the controller **20**. Such variations are all within the scope of the invention.

In addition to the control switches **42**, **44**, **46**, and **48**, controller **20** is provided with a microphone **50** to receive voice dictation and convert the dictation to appropriate electrical impulses. In another embodiment, controller **20** may have a jack **52** for receiving a clip-on microphone instead of, or in addition to, the microphone in the controller **20**. Microphone **50** is preferably located on the upper surface **29** of controller **20** at its control end **26**.

Controller **20** may be attached to interpretation unit by suitable electrical cabling, however, in the preferred embodiment, controller **20** is a wireless unit that remotely communicates with interpretation unit **22**. Such wireless systems are known in the art and may include radio frequency, infrared, or other wireless communications systems. Preferably, controller **20** is provided with an infrared transmitter **52** at its control end **26** for communication with the interpretation unit **22**. In such case, the various keyboard interrupts and/or mouse interrupts generated by the controller **20** are communicated via modulated infrared beams transmitted from the infrared transmitter **52** to infrared receivers **54** associated with the computers or workstations of interpretation unit **22** to cause the desired actions. In addition, voice dictation received in microphone **50** and converted to electrical signals are also communicated from the infrared transmitter **52**. If desired, a single transmitter **52** may serve to communicate both the control signals and the dictation signals to the infrared receiver, or separate infrared transmitters may be used. In a wireless embodiment, controller **20** is provided with a power source such as suitable batteries to power the functions of the controller **20**.

The control switches **42**, **44**, **46** and **48** generate keyboard interrupt and mouse control signals that control the interpretation unit **22**. Such keyboard interrupt and mouse control signals are conventional signals in operation of personal computer operating systems which are generated, respectively, upon the entry of particular keystrokes or clicking the mouse buttons. In a conventional system, for example a Microsoft Windows operating system, event routines are actuated upon pressing a keyboard key as follows: the keyboard chip transmits a message, that a key or combination of keys are pressed, to a buffer, which notes the key and transmits a message identifying an "onkey-down" routine and the key or key combination pressed to the operating system. The operating system receives this message and posts a message to all open programs when a keyboard interrupt is received; and the program which is the active program (known as the program which has the "focus") responds to the keyboard input. Upon release of the key on the keyboard, the key chip transmits another key indication; the buffer notes the key and transmits a message identifying an "onkeyup" and the key or key combination pressed to the operating system, which then again transmits this message to all open programs, and the active program responds thereto. In the present invention, the controller switches actuate such keyboard interrupts to instruct a "Viewer" application software running on one or more of the master and slave computers **84**, **86**, and **88**.

It is to be appreciated that with the present invention, the controller **20** is intended to be the only necessary control, and thus the conventional keyboard and mouse controls may be omitted from the personal computers that constitute the interpretation unit **22**. However, of course, if desired, such interface devices may be included in the interpretation unit **22**, as for example, if the present invention is implemented in a single computer at a medical office where the computer may be used for other functions besides review of medical images for diagnosis. However, it is expected that when the "Viewer" software for operation of the personal computers in their function as an interpretation unit **22** is running, that the controller **20** will be the only interface device necessary for a diagnosing physician's control of the interpretation unit **22** to review patient images and to dictate a medical study.

In one preferred embodiment, the following switches and combinations of switches actuate the following functions. However, of course, the various functions described below

may be assigned to other switches or combinations of switches than described in connection with the preferred embodiment, such different assignments being all within the scope of the invention. As described below, image display control and the dictation control have multiple functions, and at least some of the functions of the image display control and the dictation control are both accomplished through commands generated by actuation of one or more of the switches. The particular control function provided by a switch or combination of switches is dependent on the mode of dictation or mode of image display or combination of modes of dictation and image display at the time of operation of such one or more switches.

The trigger switch **42** actuates the primary functions of the voice dictation system. If the trigger switch **42** is clicked and held down, the microphone **50** is connected to a power source, and a keyboard interrupt is sent to the interpretation unit **22**, where the "Viewer" software summons the "audio record" function, and voice dictation by the physician into the microphone is communicated to the interpretation station **22** and is recorded as a digital file.

Recording continues until the trigger switch **42** is released, which is transmitted as a keyboard interrupt that causes the "Viewer" software to summon a "stop audio record" function. A hold down of the trigger switch **42** will initiate the record function whether in stop or playback mode.

The audio record function, as well as rewind, playback and other audio functions described herein are conventional features in the Windows 95 operating system and are not described in detail herein. It is noted that a sound card will be required to cause the analog to digital conversion needed to store the voice dictation as a digital file. Voice dictation received by the interpretation unit **22** is stored as a Windows ".wav" file for playback using the conventional Windows based audio software. The file may be stored locally on the interpretation unit **22** or in a network file server as selected.

The "Viewer" software will automatically save the voice dictation file each time the trigger switch **42** is released. The "Viewer" software will automatically save voice dictation file under a file name such as "Study Dictation.wav." The file will preferably be automatically saved in the patient "folder."

When the audio system is in neither the record nor playback, if the trigger switch **42** is clicked and released, the playback function is activated. In the audio file currently open by the "Viewer" software, the recorded audio file will back up two seconds from the end of the file and then will playback that portion of the file to the end. When the recorded audio file is being played back, actuation of the trigger switch **42** by a click and release stops the playback. Also, when the recorded audio file is being played back, actuation of the trigger switch **42** by two clicks and release causes the "Viewer" software to jump to the end of the recorded audio file.

When the audio system is in neither the record nor playback, if the trigger switch **42** is clicked twice it will initiate a "rewind" sequence, in which the position in the audio file is moved back, with acceleration after an initial period of "rewind". "Rewind" may be halted by clicking trigger switch **42** once.

When the audio system is in playback mode, as a result of a single click of trigger switch **42**, toss buttons **44** and **46** can be used to call additional audio dictation functions. For example, the left toss button **44** can be used to toggle through various dictation functions (with a screen display in

a small window showing the various functions selected). These functions preferably include (1) insert additional audio; (2) overwrite audio; and (3) delete audio. Once a dictation function is selected, the right toss button **46** may be clicked during the desired position in playback to mark the position of the desired function, and clicked a second time, where applicable, to mark the end of the function. Thus, where insert additional audio is desired, the right toss button **46** will mark the position of the audio insert; and the trigger switch **42** may be activated to record the audio insert. Where overwrite audio is desired, the right toss button **46** may be clicked to mark the beginning of the portion of the audio file to be overwritten, and clicked again to mark the end of the portion to be overwritten, and the trigger switch **42** may be activated to record the audio insert to the overwritten portion. Where delete audio is desired, the right toss button **46** may be clicked to mark the beginning of the portion of the audio file to be deleted, and clicked again to mark the end of the portion to be deleted.

Other dictation switch designs may also be used in the handheld controller **20**. For example, the dictation control switch may be a slide switch actuated by forward and rearward motion. In such an embodiment, the standard dictation controls (record, off, play, fast forward, rewind) are actuated by positioning the slide switch along the longitudinal axis of the controller **20**. Thus, recording is actuated by positioning the slide switch at the forward position of its travel. Moving the slide switch backwardly actuates the following modes, in order: stop, playback, fast forward, and rewind. Other switch control systems may also be implemented in accordance with the invention.

The audio file comprising the diagnosing physician's dictated study of the patient images may be converted to a text file by a transcriptionist or by use of voice recognition software. At the time of the present invention, it is expected that a transcriptionist will be required to accurately transcribe the dictated study. However, as vendors such as IBM and others continue to improve voice recognition software, that the services of a transcriptionist may be less needed, and that voice recognition software may be used to convert the recorded audio file to a text file.

In a system using a transcriptionist in a distributed network, a central file server will maintain information on the status of the patient folder and the contents thereof, and will forward a copy of the audio to a transcription station to generate the corresponding text file.

The controller **20** also controls the "Viewer" software to permit the physician to review the images of the patient. Pressure switch **44** is the principal control for the image viewing system. Pressure switch **44** is a strain gauge switch that transmits different keyboard keys as keyboard interrupt instructions to the interpretation unit **22** depending on the amount of pressure applied to the switch. In the preferred embodiment, pressure switch **44** is a thumb actuated rocker bar switch that has a default centered position, and which may be pushed forwardly or pulled backwardly, against a bias that will tend to center the pressure switch in its centered position. Forward pushing on the edge **45** of switch **44** will cause the Viewer software to advance through the image series. Backwards pulling thereon will cause the Viewer software to back up through the image series. The different keys transmitted by pressure switch **44** instruct the interpretation station **22** to advance or back up through and display the image series at different speeds.

The image series stored in the patient folder in interpretation unit **22** is preferably stored as multiple files, identified

for example as 100010001, 100010002, where the terminal four digits identify the number of the image in the series, and the second through fifth digits indicate the number of the series. Actuation of the pressure switch **44** by a single push will cause the Viewer software to display each image file in numeric order, one image at a time, beginning from the first image of the first series. Actuation of the pressure switch **44** by pushing and holding the pressure switch **44** will cause the Viewer software to scroll through the images. The amount of pressure applied to pressure switch **44** will control the speed at which the Viewer software scrolls through the images in the series. The scrolling of images will halt when the end of an image series is reached (or the end of the set of all images reviewed during the study so far), whereupon the first image of the next series will be displayed, and the scrolling function will be terminated. The user may then step or scroll through the displayed next image series by again activating the pressure switch **44**. In the preferred embodiment, the physician will be required to step through the entire sets of image series before rapid scrolling will be permitted. This will help to insure that each image is reviewed initially, to prevent missing a potentially relevant image during rapid scrolling.

A serial display as described above is believed to be the most effective way of presenting the images in the patient file, as it maximizes the diagnosing physician's ability to interpret the image using lower cost, standard size computer monitors. However, it is also possible to present the image information in a matrix format with multiple images displayed in a monitor at one time. Such multiple images may comprise a tiled set of windows, each containing a separate image. In such case, the controls of controller **20** will be as described above, except that in stepping or scrolling through images, the Viewer program will step through the different windows.

However, it is believed that a serial display provides a preferable approach as it will force the physician (particularly the experienced physician) to review all the images presented, without the possibility of skipping over a potentially relevant image. With an experienced physician there is sometimes a temptation to leap to the most relevant image—and to reach the obvious diagnosis. With a serial display, a physician will be less likely to miss the less obvious diagnosis that might be reached after proper review of all images. The serial image display is also helpful to the inexperienced physician who will have a better awareness of the entire image set, and what he is looking at, by virtue of the preceding images already displayed. A final benefit of a serial display approach (as opposed to a multiwindow format) is that it allows presentation of a large image. In comparison to film, which has a quality of very high contrast resolution at a certain luminance, current monitors provide much less resolution. To compensate for the reduced contrast resolution, the spacial resolution is enhanced (the image is made larger) to give the user an image of subjective quality that approaches the resolution provided by film.

The "Viewer" software will also determine if the user has displayed a specific image for a predetermined period of time. If so, the Viewer software will "bookmark" for subsequent return. The "bookmark" may be inserted by adding an appropriate stop in the patient image file, or in a table containing a list of the images, or by storing the filename of the displayed image for later recall. Thus, if the diagnosing physician studies the third image in a first series for a period exceeding the predetermined period of time, then steps forward to the third image of the next series, the physician may jump back to the third image of the first series by

pulling back on the pressure switch **44**. The "Viewer" software, having bookmarked the third image of the first series, will stop backwards scrolling when that image is displayed. In another embodiment of the invention, images studied for a predetermined period of time may be selected to be automatically tossed to one of the clipboard viewer monitors; and/or tossed images may be auto-bookmarked.

As mentioned above, interpretation unit **22** preferably comprises three separate networked personal computers or workstations, operating a main viewer monitor **90**, a left clipboard viewer monitor **92**, and a right clipboard viewer monitor **94**. In a default mode of operation, the main viewer monitor **90** will have displayed on it the selected displayed image in an image series. The left clipboard viewer **92** will be set up to display a number of images in a tiled format, for example, in a 2x2 matrix of tiled images. Other matrix sizes may be used, however, for better image clarity, a 2x2 matrix size is preferred. A title block will be associated with each displayed image to identify the filename of the image.

The toss buttons **46** and **48** serve two functions. A quick click of a toss button **46** or **48** causes the image currently on view on the main viewer monitor **90** to be separately displayed on the respective clipboard viewer monitor **92** or **94**. This is again accomplished by the toss button generating a keyboard interrupt with instructs the "Viewer" program to display the selected image on the selected clipboard viewer monitor, for example, by copying the image to a new file containing images of interest, and displaying the new file. The use of the toss buttons **46** and **48** in this manner also marks the "tossed" image for later use of the comparison function described below. An image that has been "tossed" to a clipboard viewer monitor may be "untossed" (removed from the clipboard viewer) by clicking the toss button for the clipboard viewer when the main viewer monitor **90** has displayed on it the image to be "untossed".

It is anticipated that the right clipboard viewer will generally be used for assembling a summary study containing images of particular medical interest, while the left clipboard viewer will be used as a worksheet for displaying side by side comparisons of different series, or display of prior patient studies for comparison (or consultation as needed without interruption of the present study).

If a toss button **46** or **48** is pressed and held down, it will invoke a "mode selection" function in the main viewer program. The "Viewer" program will display a menu of the various modes on the main viewer monitor or one of the clipboard monitors. In the "mode selection" mode, the pressure switch **44** may be used to cycle through the various modes, accompanied by a display in which a highlighted selection bar down the menu of modes. A mode may then be selected by clicking on the toss button again. Of course, other control schemes may be implemented using the controller **20**, for example, upon entering a "mode selection" mode, the toss buttons could be used to cycle through the various modes by clicking the toss buttons to cycle one entry at a time through the various modes, and selection could be made by clicking the trigger switch **42**; or the trigger switch **42** could be used to cycle through the various modes and the selection could be made by pressing one of the toss buttons. If the toss buttons are used to cycle through the various modes, one toss button will cycle up through the mode selection menu and the other toss button will cycle down through the mode selection menu. In another embodiment, one toss button might be used to cycle through the mode selection menu and the other toss button would be used to select the particular mode to be implemented. Other mode selection and selection schemes are equally within the scope of the present invention.

The "modes" to be selected from may include one or more of the following functions.

(1) List Patients mode. This will cause the system to display the patient folders so that the folder of a patient to be studied can be selected.

(2) View mode. This will cause the system to return to the default viewing mode with controller **20** controlling the master computer **84** of the interpretation unit **22**.

(3) Compare mode. This will cause one clipboard viewer (preferably the left clipboard viewer monitor **92**) to display a side-by-side presentation of all images in two series starting with the first marked image in each series. For example, while in view mode, a diagnosing physician could select the third image of the second series and send it to the left clipboard viewer **92** by marking with toss button **46**, and could then select a fourth image of the fourth series and send this image to the left clipboard viewer **92** by marking with toss button **46**. The images would then be displayed with the third image in the second series in the top left quadrant of the monitor screen, and the fourth image of the fourth series in the top right quadrant of the monitor screen. The diagnosing physician would then summon the compare mode, which would cause the display of all subsequent images to the selected images in a side by side relationship, with the selected images on top, and the subsequent images below.

(4) Annotate mode. The master computer **84** may be set up with a light pen, allowing the diagnosing physician to annotate the patient image displayed on the main viewer **90**. The annotated image may then be saved as a separate file from the original image by using toss button **48** to save it to the right clipboard viewer **94**, or upon return to view mode. Screen buttons actuated by the light pen may be provided to step forward or back through the image series and to "toss" an annotated image to the left or right clipboard. A submenu may also be established to select the particular image to be annotated.

(5) Left clipboard control. This will cause the controller **20** to be acting on and controlling the left clipboard viewer monitor **92**. Thus for example, after invoking the compare function described above, the diagnosing physician could then select left clipboard control and use the controller **20** to step up and down or scroll up and down through the side by side comparison, using the pressure switch **44** and the navigation control.

(6) Right clipboard control. This will cause the controller **20** to be acting on and controlling the right clipboard viewer monitor **94**.

(7) Dictation special functions. This menu selection will call a submenu with the insert, overwrite, and delete the dictated audio file functions described above.

(8) End study. This will cause the system to close the open files being viewed, and the dictated audio file, and to save the summary study prepared by the diagnosing physician as a separate file or files.

Other modes might include a main menu mode, to call a main mode selection menu, if, for example, some or all of the above functions or additional functions are established as submenus to be selected; and a Mark image mode to bookmark the image currently on display in the main viewer, or to bookmark other images as may be selected from a submenu, to subsequently implement comparison and other functions. The light pen might also be used by a non-physician technician to operate various other functions of the computer.

When series of images in a patient study is first opened, the clipboards may be used to provide an overview of the

study. For example, the left and right clipboard viewers **92** and **94** might first have displayed in them the center image of each series of images. Other modes of initial display may be provided, such as the first and last image of a series, or all of the images in one or more series in the patient image file. In some patient image studies, there is a "scout slice", which is an orthogonal view of the patient anatomy of interest showing the location of the various slices constituting the image series. Where a scout slice is available, it will preferably remain on display, most preferably as the last image on display on the left clipboard viewer monitor **92**.

Upon tossing of a first image to a clipboard viewer monitor by the toss function, the initial image display will be cleared. Thus for example, upon invoking the toss function to transfer a copy of the image on the main viewer monitor **90** to the right clipboard viewer monitor **94**, the images placed on the right clipboard viewer monitor **94** at initial start-up will be cleared. As noted, it is anticipated that the right clipboard viewer **94** will generally be used for assembling a summary study containing images of particular medical interest, and may include annotated images as described above, while the left clipboard viewer **92** will be used as a worksheet. When the summary study is completed, it will be saved as a separate file from the original patient study. It is also possible to save the summary study in the form of a list specifying the images of particular interest from the original, complete, patient image file. The summary study images will typically be the images pertinent to the medical diagnosis, and may printed, and/or delivered back to a referring physician along with the text file comprising the dictated patient study, either in electronic or hard copy form.

The clipboard viewer monitors may also be used for a comparative image display as described above.

The clipboard viewers **92** and **94** also serve other functions. As noted above with regard to the master computer, one slave computer **86** or **88** may be set up with a light pen, allowing the diagnosing physician to annotate the patient image displayed on the clipboard viewer. In such case, the patient image will most likely be displayed in a full size image, rather than in a tiled matrix of smaller images, although, of course, such a smaller format may also be used. Also, the clipboard viewers **92** and **94** could be used to pull up and review a prior patient study without closing the study in progress, as, for example, if the diagnosing physician receives a telephone call seeking discussion of a past patient study, the diagnosing physician could call up, review, and discuss the past patient study, and then return the clipboard viewer to its slave functions as described above.

Control of the display on the clipboard viewer monitors may be accomplished via controller **20** or by separate controls associated with each of the main and clipboard viewers. When control is transferred to a slave computer, another copy of the "Viewer" software is launched in the slave computer and all functions thereof are available on the slave computer.

The display on the clipboard viewer monitors, as well as on the main viewer monitor, may also be controlled by means of an array of buttons placed on or near the monitors. Such buttons, like controller **20**, generate keyboard interrupts that provide the control of the images on the viewer monitor. For example, buttons may be provided that trigger a stepping forwards or backwards, or scrolling forwards or backwards, through the images that are selected for display on the particular monitor. Of course, other controls implemented through other interfaces such as a conventional keyboard, mouse, touch screen, light pen interface, and the like may also be used.

As prior noted the various functions described above may be assigned to a switch or combination of switches other than the described switch or combination of switches. In this respect, the invention is designed to provide a "context sensitive" control in which various switch combinations achieve different results. For example, as described above, in a dictation edit/revision mode, the physician will not be likely to need the "toss" or "compare" functions, so that the toss buttons **46** and **48** (or other switch elements) may be assigned dictation control functions instead of their usual toss functions. It would also be within the scope of the invention to disable the image advance and retreat functions of a switch such as pressure switch **44** during a dictation edit mode and to assign dictation control functions to that switch during dictation edit mode. Similarly, as described above, when the "mode selection" menu is displayed, the physician is not likely to need the dictation functions, and the trigger switch **42** may be assigned mode selection functions instead of the usual dictation functions.

A further feature of the present invention is a "multimedia" record function. This function will desirably be implemented automatically whenever the dictation trigger switch is activated, or may be limited to the final "Conclusion" which is conventional at the end of any medical diagnostic dictation, or may be applied in some other summary time period. The "multimedia record function" is to record the images being reviewed by the physician at the time the dictation is recorded, enabling a later playback of the dictation with simultaneous display of the images that the physician reviewed at the time of the dictation. The image display will be synchronized to the dictation so that on playback the precise image being viewed at the time of the specific dictation is displayed. The "multimedia record function" may be implemented by recording the file name of the image on display at the time of particular dictation, which may be embedded into the dictation file as a link or using other conventional techniques for slide show type presentations, or by other file list methods.

The above described serial display system for patient images is believed to be the most efficient and user friendly system that may be implemented. However, other possible control systems may also be implemented in accordance with the invention. In an alternative control system, using a pressure switch having additional left and right switch positions in addition to front and back switch settings, it would be possible to control the "Viewer" software to jump among the different image series. Thus instead of scrolling to the end of an image series to obtain the next series, a diagnosing physician could implement the display of the next preceding series at the same image number as being currently viewed by leftward pressure on the switch, or of the next succeeding series by rightward pressure on the switch. This would permit "lateral" movement among the various patient series. Once a new series sequence was selected, the physician could then scroll forwards or backwards through the series as in the above described serial display embodiment. An adjunct clipboard viewer display might also be provided in such case to provide a matrix containing thumbnail size images of all the images in the patient folder, arrayed in columns, with each column containing the images of a different series. The adjunct clipboard viewer would indicate the image being presented to the main viewer by appropriate highlighting or framing, as an aid to navigation among the images in the study.

Although the foregoing description has described an application of a combined image review/voice dictation function in a controller **20** operating in conjunction with a

medical interpretation unit, the present invention has broader application as well. It may be implemented for example in a legal or business environment. For example, using controller **20**, an attorney reviewing documents could dictate comments on the documents (as in reviewing electronically stored raster images of production documents in litigation) or revisions to a document (as in revisions to a contract). The images which may be controlled in this fashion may thus include graphic images, text documents, and other electronic files. The controller **20** in the first example would interface with a viewer software that controls viewing of the imaged documents. The controller **20** in the second example would interface with word processing software to insert a comment or margin note in the document for a transcriptionist to later type in the requested changes, or would work in conjunction with a speech to text conversion system to implement the revisions. Similarly, a business person might dictate comments or responses to electronically received faxes, and documents for typing or conversion to text.

The present invention provides a convenient and practical apparatus for review of radiographic medical images with integrated dictation control and has better operational flexibility than any device known in the art.

It is to be appreciated that the foregoing is illustrative and not limiting of the invention, and that various changes and modifications to the preferred embodiments described above will be apparent to those skilled in the art. For example, the invention has application in other fields where it is desired to have a handheld unit that can control image review with dictation abilities, such as in legal and business fields. Such changes and modifications can be made without departing from the spirit and scope of the present invention, and it is therefore intended that such changes and modifications be covered by the following claims.

What is claimed is:

1. Apparatus for navigation of electronic image files for use with a computer system, said computer system being provided with at least one image display unit, random access memory, means for digital data storage, comprising:

a handheld controller having a pistol grip and an upper end, said controller having a finger operated trigger switch mounted in said pistol grip, said trigger switch being operably connected to said computer system to cause said computer system to display image files in said at least one image display unit upon actuation of said trigger switch; said controller having a separate thumb operated switch located at said upper end of said controller, said thumb operated switch being operably connected to said computer system to cause said computer system to select images for separate display in said at least one image display unit upon actuation of said thumb operated switch.

2. Apparatus in accordance with claim 1, wherein said thumb operated switch comprises switches located on left and right sides of said upper end of said controller.

3. Apparatus in accordance with claim 2, further comprising a center thumb operated switch located between said switches located on left and right sides of said upper end of said controller.

4. Apparatus in accordance with claim 1, wherein said thumb operated switch comprises two button switches located at said upper end of said controller.

5. Apparatus in accordance with claim 4, wherein said two button switches are located on left and right sides of said upper end of said controller.

6. Apparatus in accordance with claim 5, wherein actuation of one of said two button switches generates commands

15

to cause said computer system to display a menu of available functional modes in said at least one image display unit.

7. Apparatus in accordance with claim 5, further comprising a center thumb operated switch located between said two button switches located on left and right sides of said upper end of said controller.

8. Apparatus in accordance with claim 1, wherein actuation of said trigger switch generates a command to cause said computer system to advance through a series of images displayed in said image display unit.

9. Apparatus in accordance with claim 1, wherein said controller is a wireless controller provided with wireless communication means for communicating with said computer system to control display of images in said at least one image display unit.

10. Apparatus in accordance with claim 9, wherein said wireless communication means comprises an infrared transmitter provided in said controller and an infrared receiver associated with said computer system.

11. Apparatus in accordance with claim 1, wherein said controller is provided with a wire for communicating with said computer system to control display of images in said at least one image display unit.

12. Apparatus for navigation of electronic image files for use with a computer system, said computer system being provided with at least one image display unit, random access memory, means for digital data storage, comprising:

a handheld controller having a pistol grip and an upper end, said controller having a finger operated trigger switch mounted in said pistol grip, said trigger switch being operably connected to said computer system to cause said computer system to display image files in said at least one image display unit upon actuation of said trigger switch; said controller having two thumb operated button switches located on left and right sides of said upper end of said controller, said thumb operated button switches being operably connected to said computer system to cause said computer system to select images for separate display in said at least one image display unit upon actuation of one of said thumb operated button switches.

13. Apparatus in accordance with claim 12, wherein actuation of said trigger switch generates a command to cause said computer system to advance through a series of images displayed in said image display unit until said trigger switch is released.

14. Apparatus in accordance with claim 12, wherein actuation of one of said two button switches generates commands to cause said computer system to display a menu of available functional modes in said at least one image display unit.

15. Apparatus in accordance with claim 12, wherein said controller is a wireless controller provided with wireless communication means for communicating with said computer system to control display of images in said at least one image display unit.

16. Apparatus in accordance with claim 12, wherein said controller is provided with a wire for communicating with

16

said computer system to control display of images in said at least one image display unit.

17. Apparatus in accordance with claim 12, further comprising a center thumb operated switch located between said two button switches located on left and right sides of said upper end of said controller.

18. Apparatus for navigation of electronic image files for use with a computer system, said computer system being provided with at least one image display unit, random access memory, means for digital data storage, comprising:

a handheld controller having a grip and an upper end, said controller having a finger operated trigger switch mounted in said grip, said trigger switch being operably connected to said computer system to cause said computer system to display image files in said at least one image display unit upon actuation of said trigger switch; said controller having at least two separate thumb operated switches located at said upper end of said controller, said thumb operated switches being operably connected to said computer system to cause said computer system to select images for separate display in said at least one image display unit upon actuation of said thumb operated switches.

19. Apparatus in accordance with claim 18, wherein said thumb operated switches comprises switches located on left and right sides of said upper end of said controller.

20. Apparatus in accordance with claim 19, wherein said thumb operated switches comprises two button switches located at said upper end of said controller.

21. Apparatus in accordance with claim 20, wherein said two button switches are located on left and right sides of said upper end of said controller.

22. Apparatus in accordance with claim 20, wherein actuation of one or both of said two button switches generates commands to cause said computer system to display a menu of available functional modes in said at least one image display unit.

23. Apparatus in accordance with claim 19, further comprising a center thumb operated switch located between said switches located on left and right sides of said upper end of said controller.

24. Apparatus in accordance with claim 18, wherein actuation of said trigger switch generates a command to cause said computer system to advance through a series of images displayed in said image display unit.

25. Apparatus in accordance with claim 18, wherein said controller is a wireless controller provided with wireless communication means for communicating with said computer system to control display of images in said at least one image display unit.

26. Apparatus in accordance with claim 18, wherein said controller is provided with a wire for communicating with said computer system to control display of images in said at least one image display unit.

* * * * *