



US 20120317953A1

(19) **United States**

(12) **Patent Application Publication**
Allochis

(10) **Pub. No.: US 2012/0317953 A1**

(43) **Pub. Date: Dec. 20, 2012**

(54) **FLEXIBLE PLATFORM JOINED TO A
CONVEYOR BELT FOR A COMBINE
HARVESTER**

Publication Classification

(51) **Int. Cl.**
A01D 43/06 (2006.01)
(52) **U.S. Cl.** **56/153**

(76) Inventor: **Jose Luis Allochis**, Buenos Aires (AR)

(21) Appl. No.: **13/593,555**

(22) Filed: **Aug. 24, 2012**

(57) **ABSTRACT**

Related U.S. Application Data

(63) Continuation-in-part of application No. 13/153,646,
filed on Jun. 6, 2011, now Pat. No. 8,272,198.

A flexible platform joined to a conveyor belt for a combined harvesting, chopping and spinning machine includes a central assembly of parallel augers and an oblique auger on each side of the assembly.

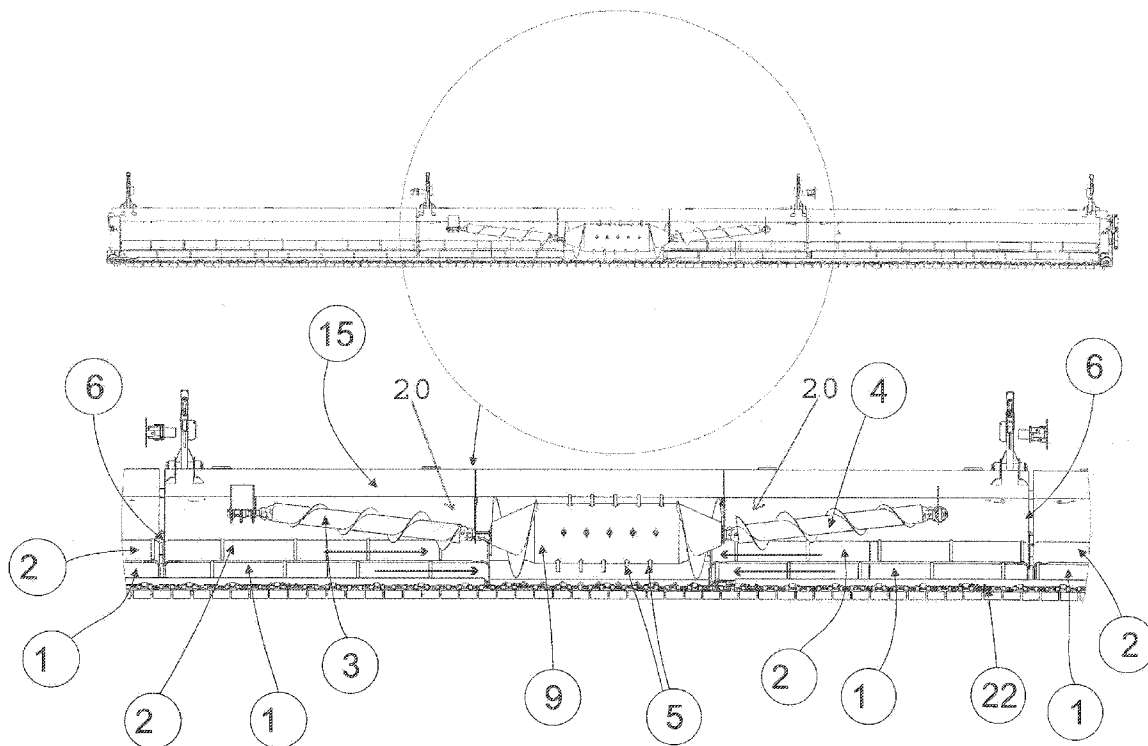

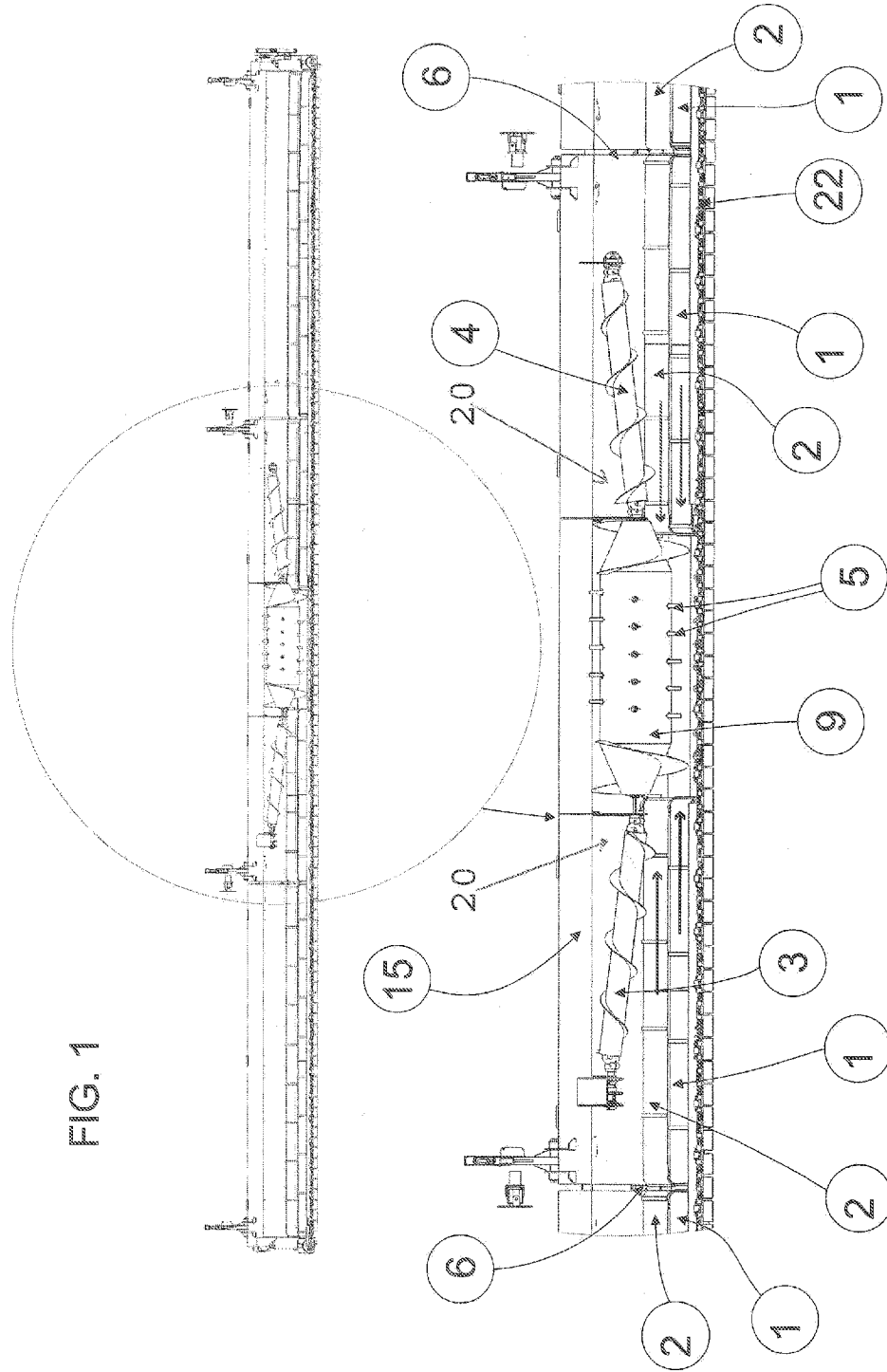

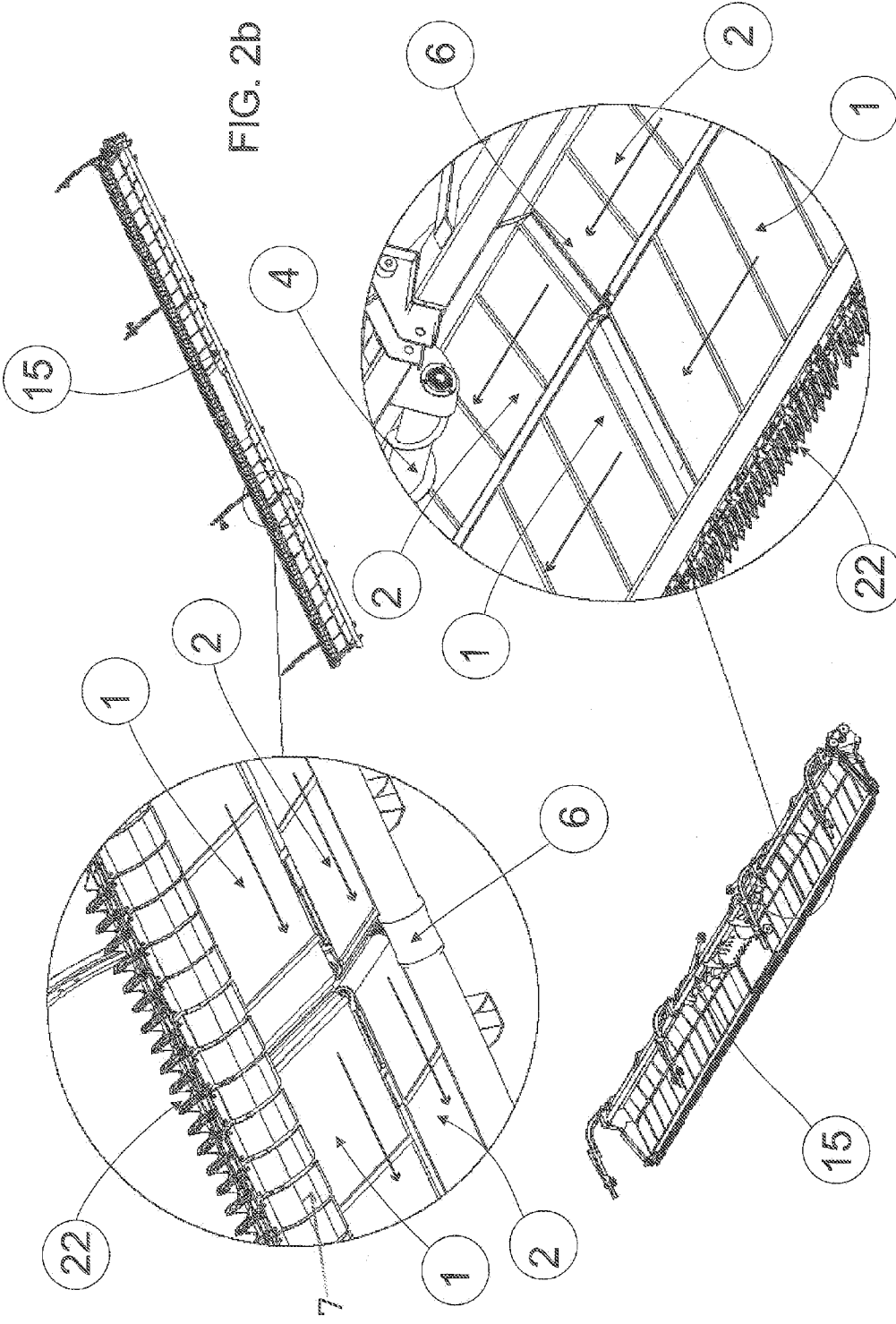

FIG. 2b

FIG. 2a

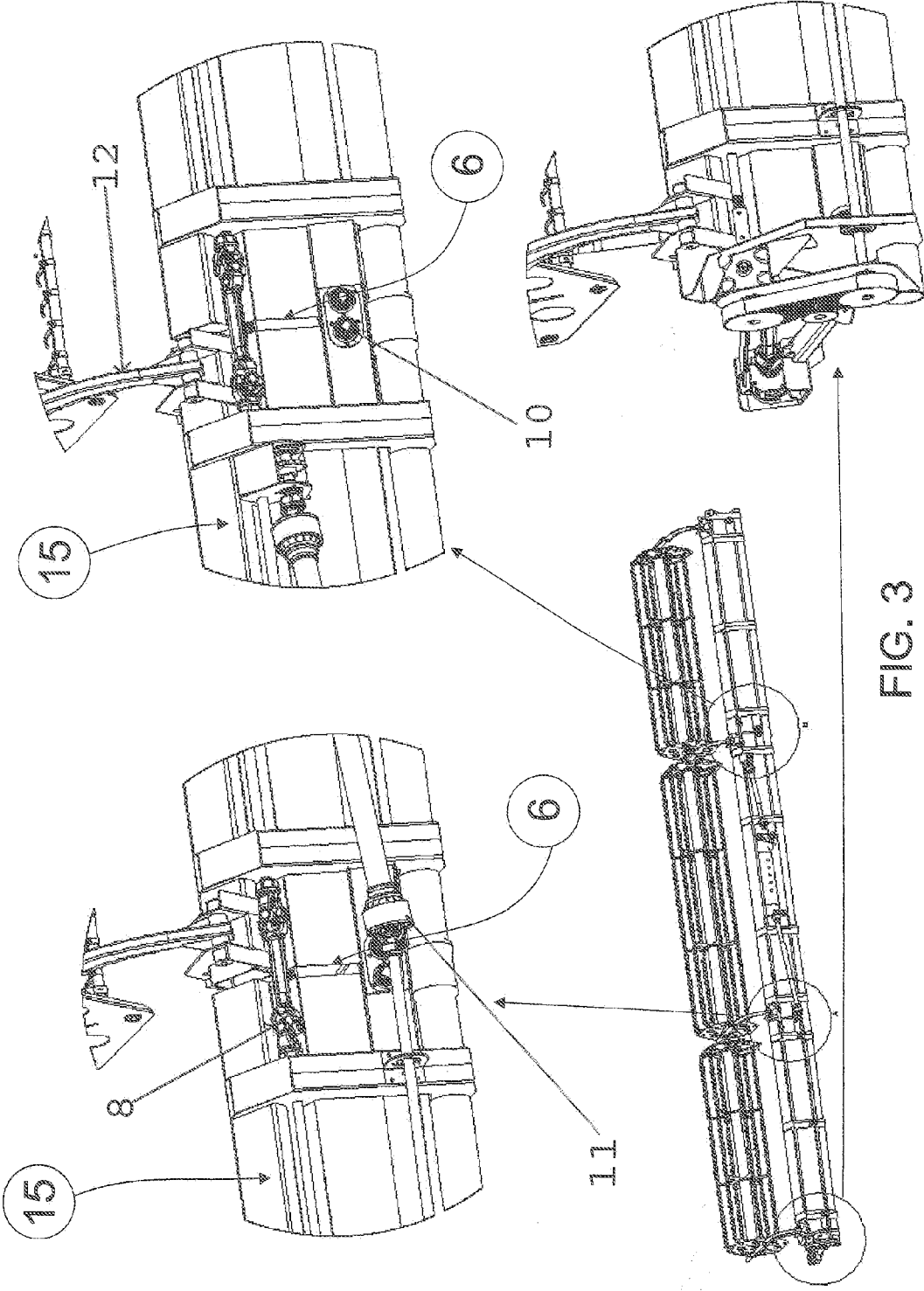

FIG. 3

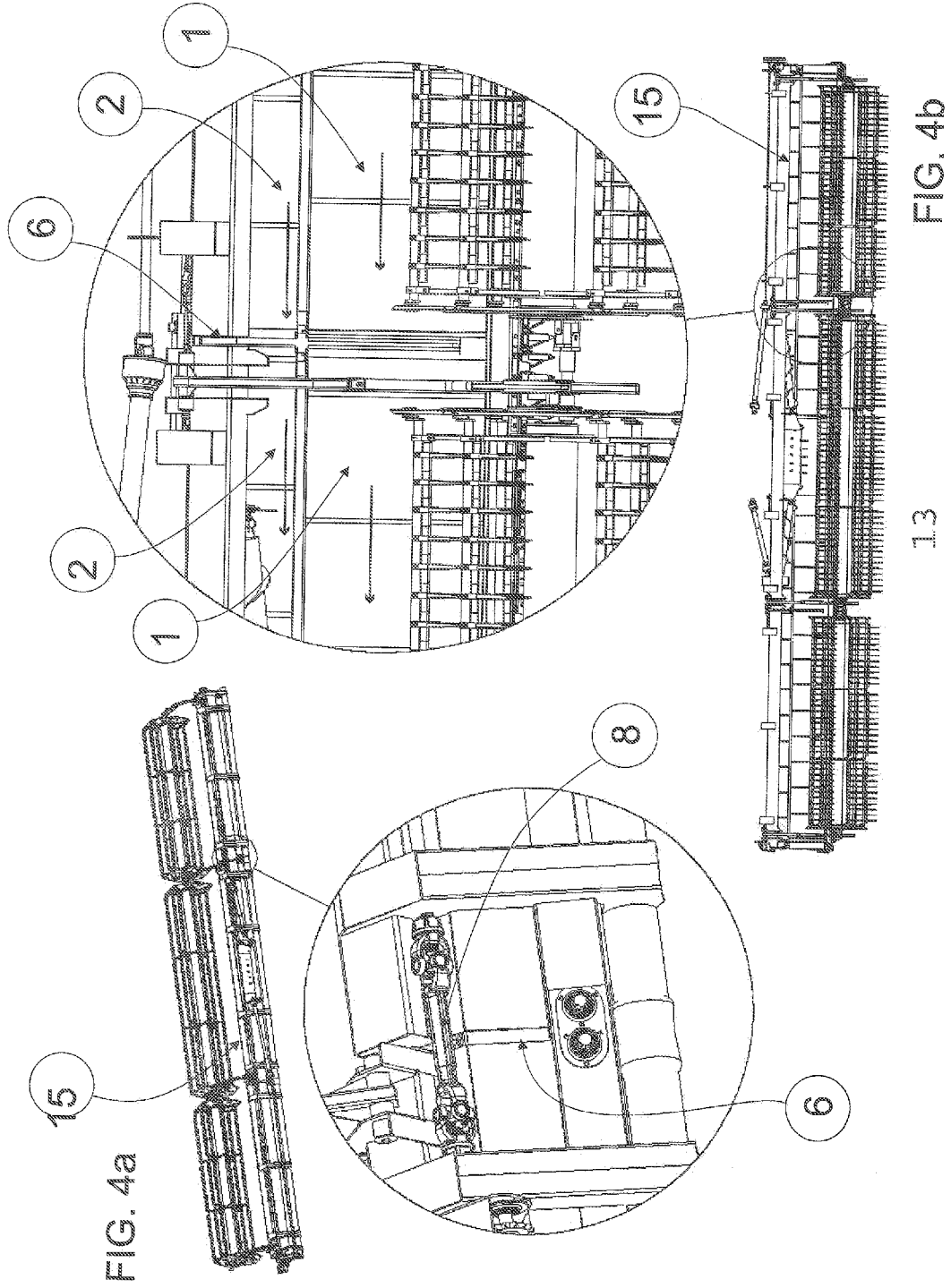
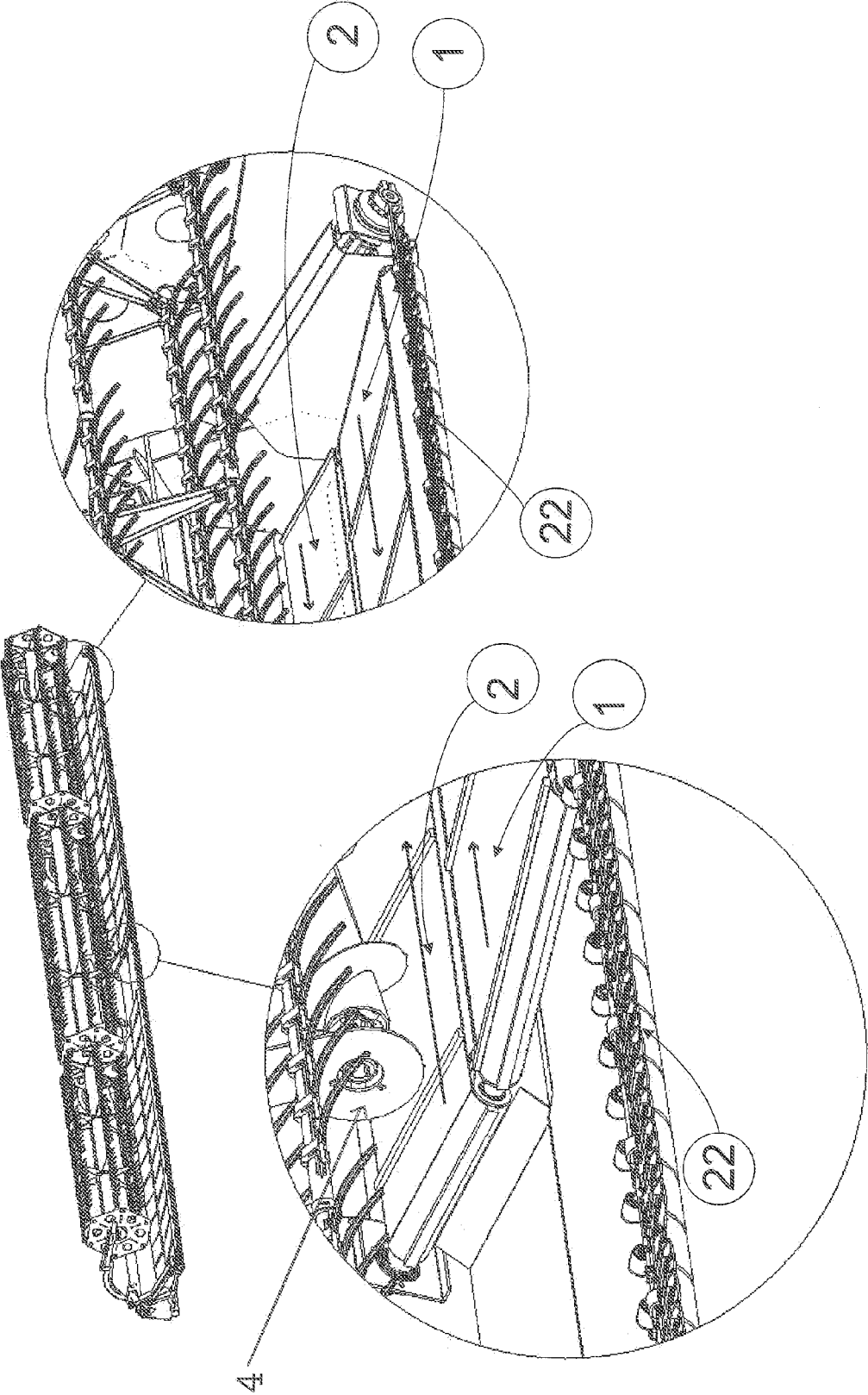

FIG. 4a

FIG. 4b

13

FIG. 5



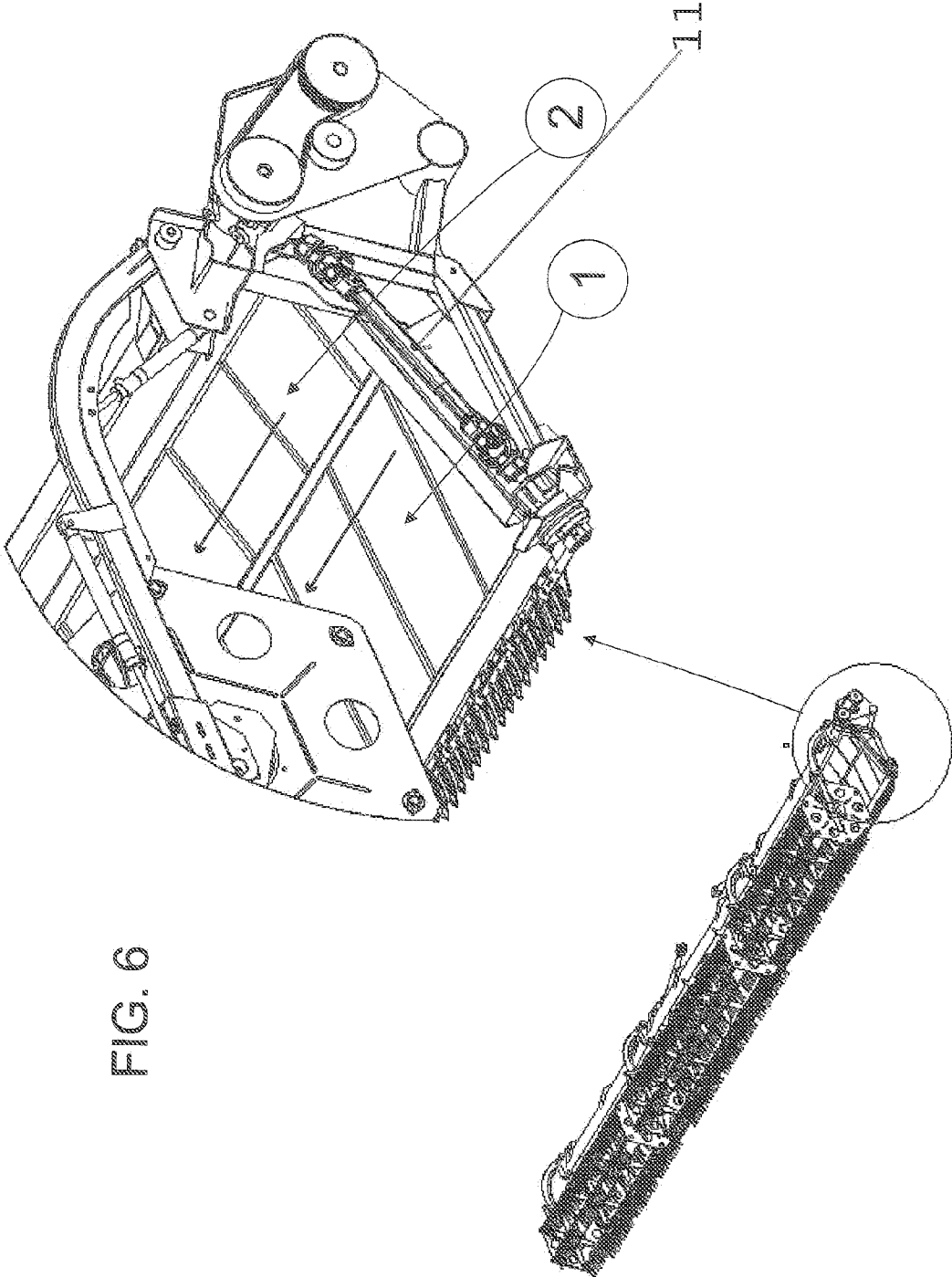
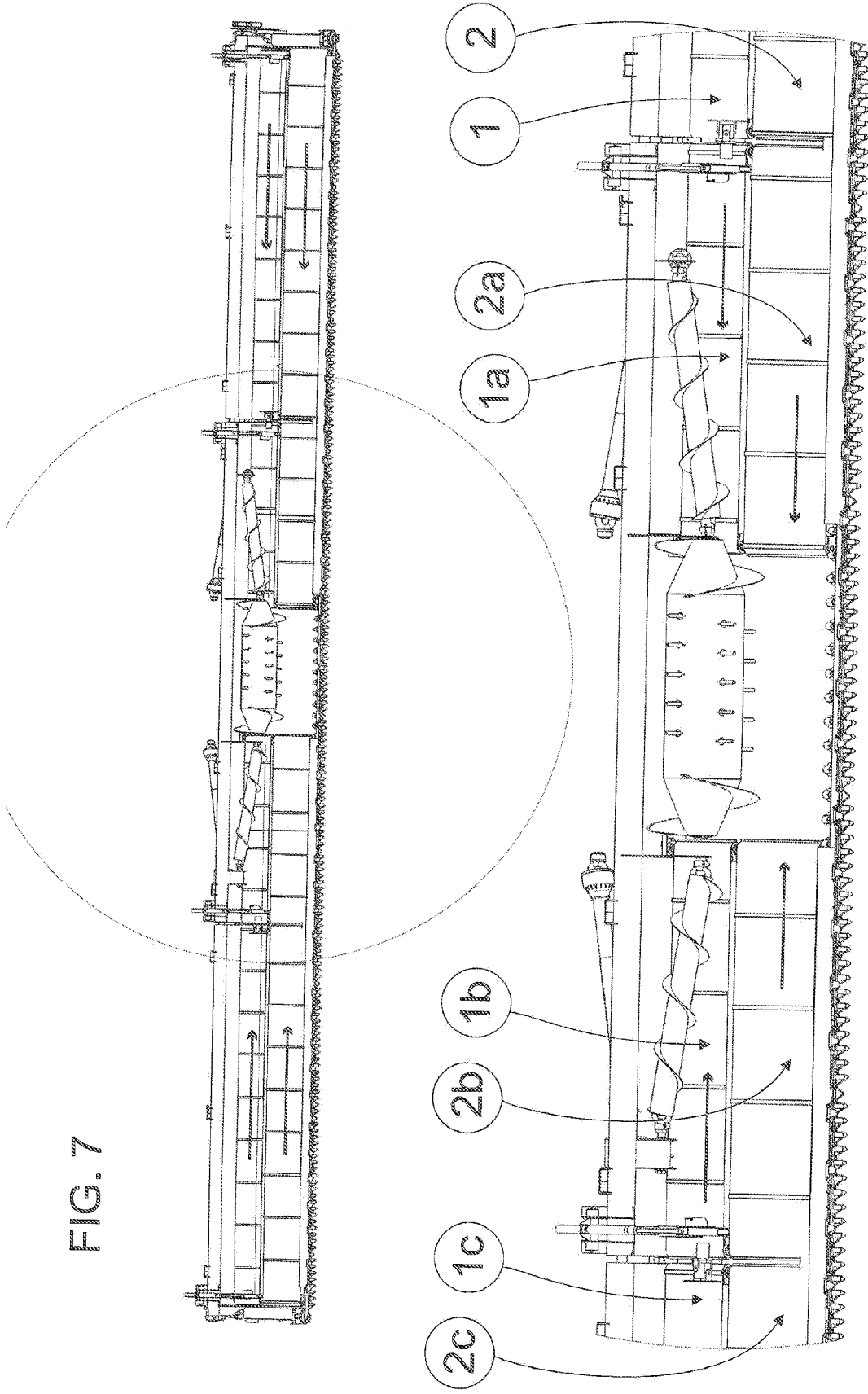
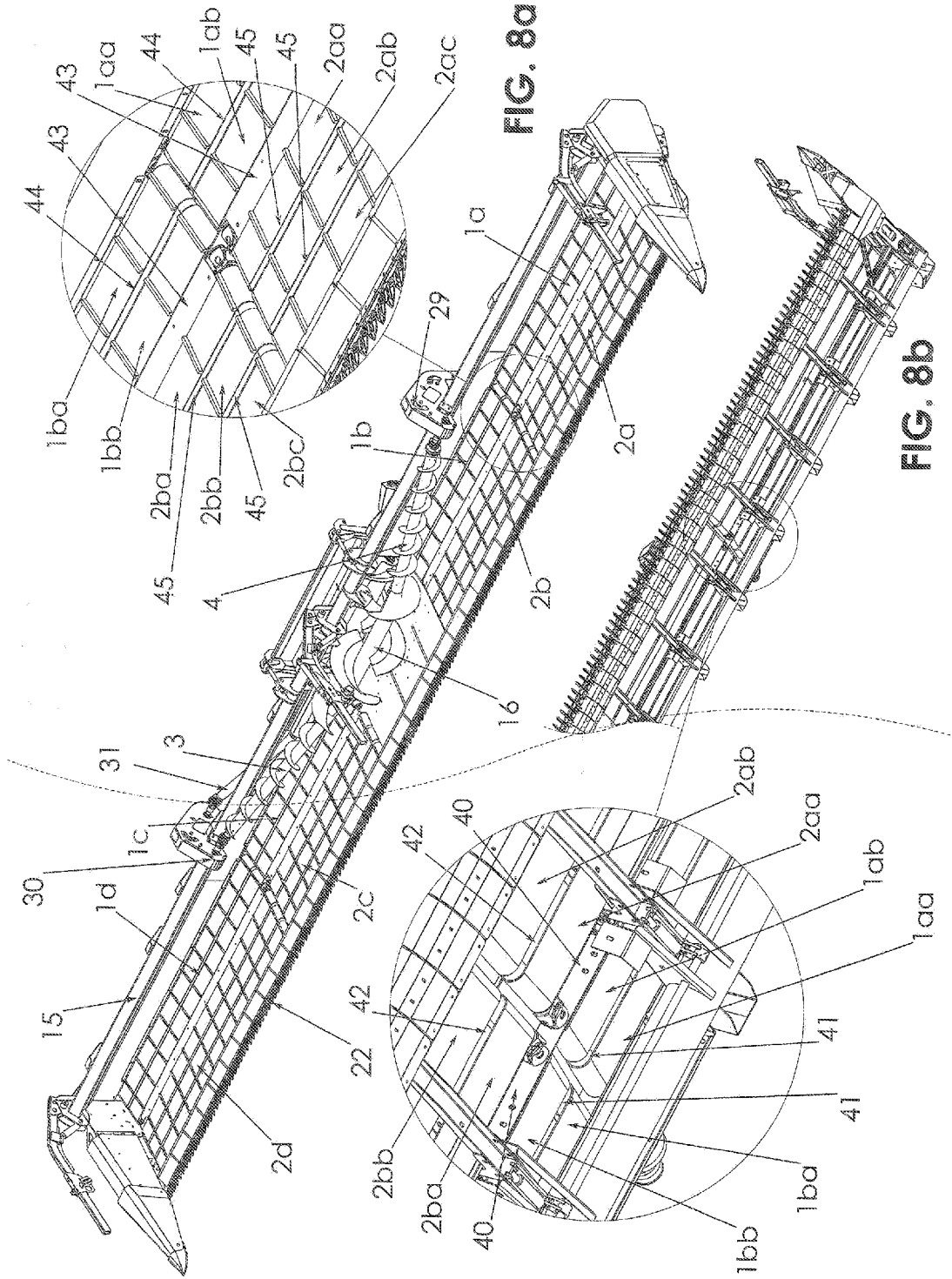

FIG. 6

FIG. 7





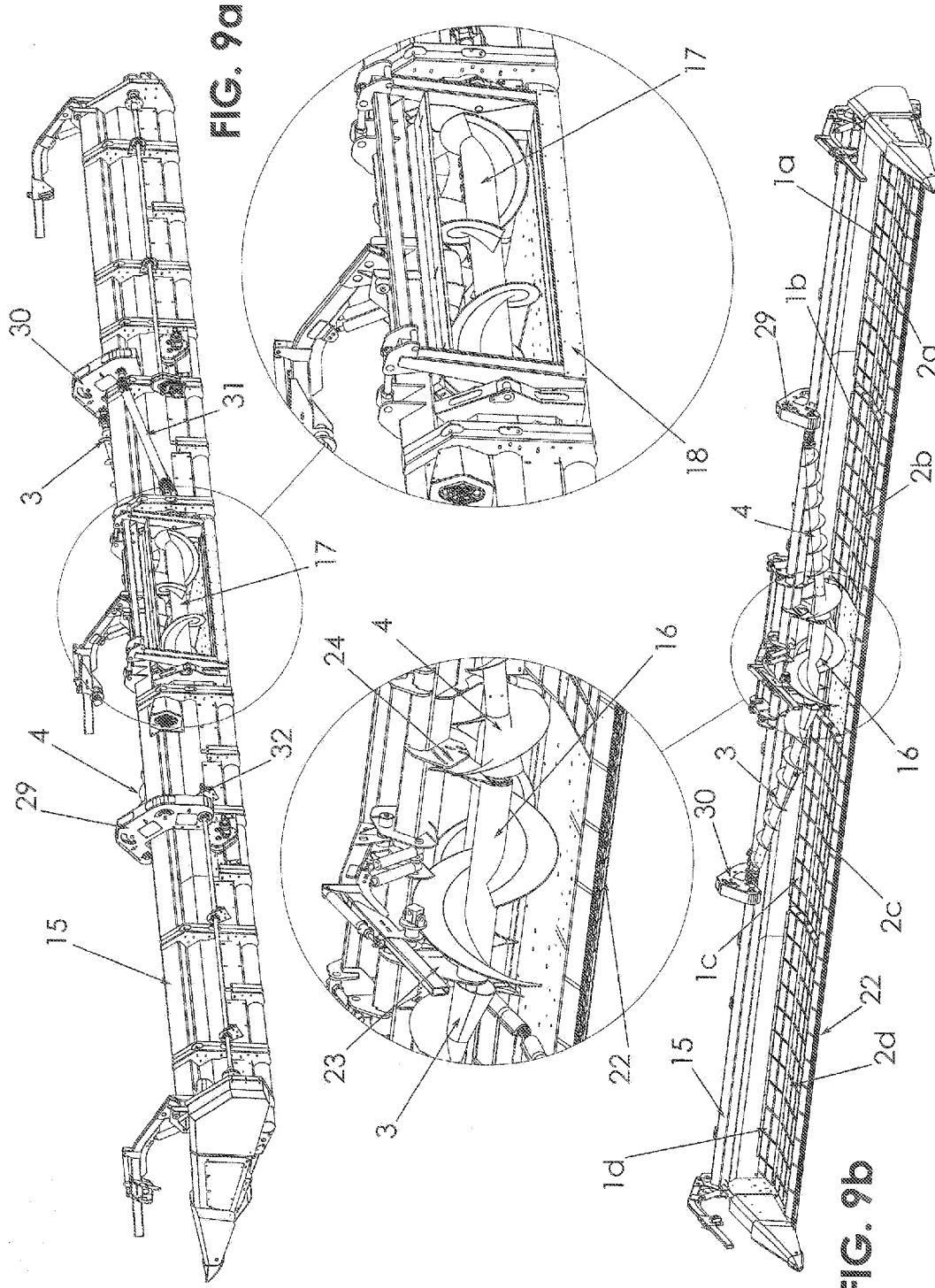

FIG. 9a

FIG. 9b

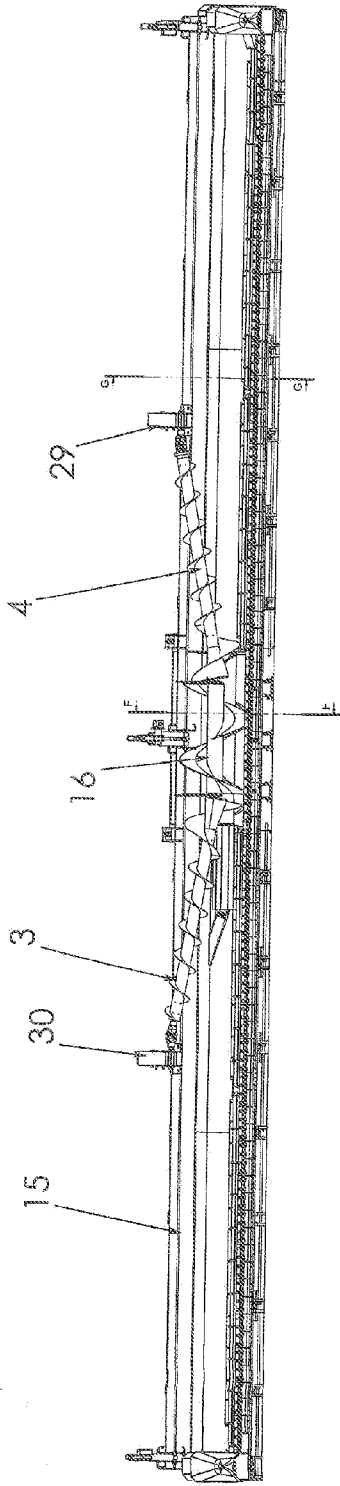

FIG. 10a

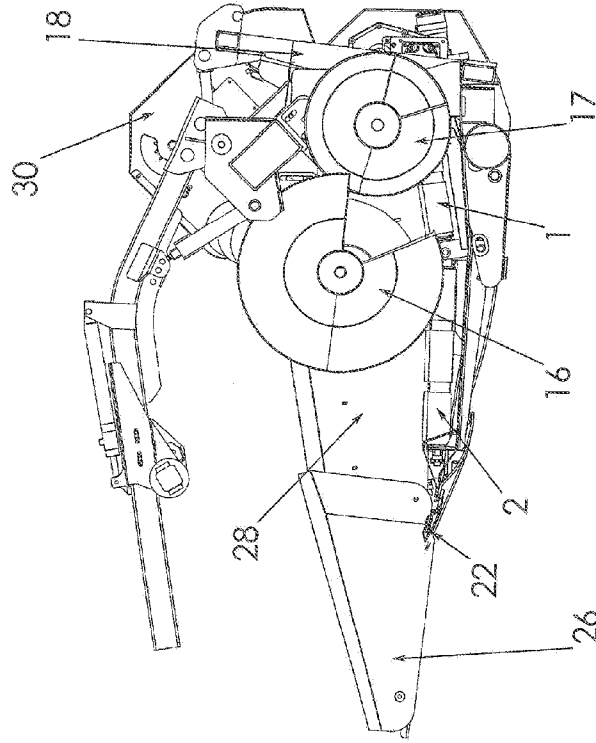

FIG. 10c

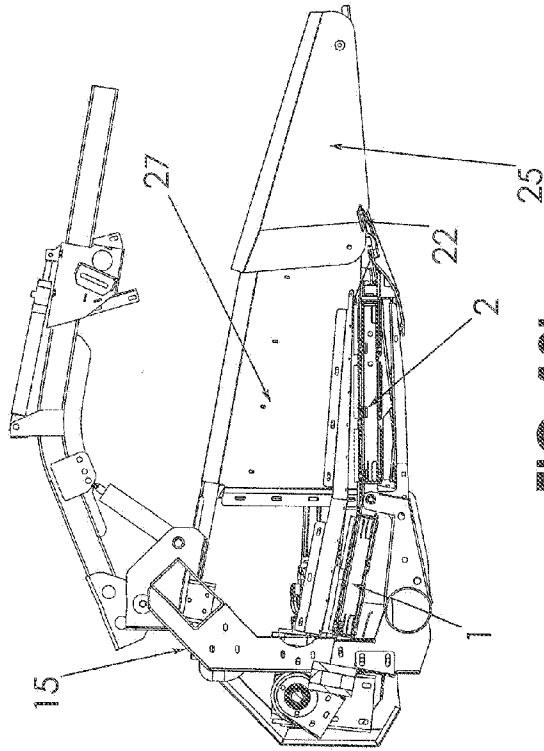

FIG. 10b

FLEXIBLE PLATFORM JOINED TO A CONVEYOR BELT FOR A COMBINE HARVESTER

CROSS REFERENCE TO RELATED APPLICATION

[0001] This application is a continuation-in-part of U.S. patent application Ser. No. 13/153,646 filed Jun. 6, 2011, allowed, entitled FLEXIBLE PLATFORM JOINED TO A CONVEYOR BELT FOR A COMBINED HARVESTING, CHOPPING AND SPINNING MACHINE, the contents of which are herein incorporated by reference.

TECHNICAL FIELD

[0002] The present invention relates to a flexible platform jointed to a conveyor belt for a harvesting, spinning, and chopping machine which improves the functioning of all the platform width, and eliminates deficiencies related to the material, cereal or grain transport, with a transporting auger in all its width, obtaining a more homogeneous and smoother material flow.

BACKGROUND OF THE INVENTION

[0003] In regards to the previous art of the present invention, it is worth highlighting platforms with transporting augers and conveyor belt platforms or canvas, as they were named in the past, which were rigid or without movement, except from its own turn, in all its length and without the possibility of copying the land in which they worked. This aforementioned canvas consisted of a conveyor belt on each side of the feeder and a central vertical belt.

[0004] It is worth mentioning that for some cereal harvesting or products, the aforementioned conveyor belts have to be flexible, that is to say, they must allow the belt to take such an angle that it must copy the land and said form to adapt to land irregularities, being one of the main objectives of the present invention to develop a cutting platform which fulfills the demands of farming in lands with irregularities.

[0005] The proposed platform in a preferential embodiment is built with high technology materials and low weight materials such as steel, plastic and aluminum or such material's alloys.

[0006] The present platform is developed with several conveyor belts, located parallel to one another on each lateral side of said platform, back belts being rigid or without movement (except for the belt's own turn) regardless of the land where it works; existing

[0007] front conveyor belts, which bend or joint in relation to the back conveyor belts, allowing to change its position and accepting land irregularities.

[0008] In a preferential embodiment, the proposed platform allows turn revolutions or belt velocity to be the same or different in back conveyor belts in relation to the belts' velocity of the front belts, likewise allowing it to be of a different width, length or material and to have different shapes.

[0009] Other important aspect is that both conveyor belts are split through its width into multiple pieces letting belts to have several clearance spacing, which brings the multiple point self-cleaning characteristic to conveyor floor.

[0010] The back conveyor belt and the front conveyor belt will carry the cereal, grain or material towards the central conveying system, that comprises of a set of synchronized

augers, where it is first taken by the oblique side augers and then moved to the combine feeder by the horizontal augers.

[0011] Likewise, the cutting system is also synchronized to eliminate cutting-blade vibration, for that reason it was built with a gear-box and a control gear, in order not to be slipped or moved in both sides.

[0012] The conveyor belts can be activated mechanically or hydraulically, with any of the mechanisms known today to give movement to these types of belts.

[0013] By being the flexible front conveyor belt, it can vary its angle in relation to the back conveyor belt, having up to 200 mm trajectory.

SUMMARY OF THE INVENTION

[0014] In one aspect of the present invention, a flexible platform jointed to a conveyor belt for a combined harvesting, chopping and spinning machine includes two adjacent parallel conveyor belts. The conveyor belt adjacent to the cutting blade is movable in relation to the other belt.

[0015] On the other side of the invention, the flexible platform jointed to a conveyor belt for a combined harvesting, chopping and spinning machine includes a central assembly of parallel augers and an oblique auger on each side of the assembly.

[0016] These and other features, aspects and advantages of the present invention will become better understood with reference to the following drawings, description and claims.

BRIEF DESCRIPTION OF THE DRAWINGS

[0017] In order for this present invention to be clearly understood and taken into practice easily, it has been presented in one of its preferred embodiments in the illustrative drawings and not limitative in which:

[0018] FIG. 1 shows a perspective front view of the flexible platform of the present invention and an amplifying detail of the same according to an exemplary embodiment of the present invention;

[0019] FIGS. 2a and 2b show detailed view of FIG. 1 showing the details of a platform

[0020] FIGS. 3, 4 and 5 show a plurality of jointed platforms and amplifying details of aforesaid figures;

[0021] FIG. 6 shows a perspective of the control box and of the blades and the activation of the same;

[0022] FIG. 7 shows a perspective front view of the flexible platform according to another exemplary embodiment of the present invention showing more than one first conveyor belt and more than one second conveyor belt;

[0023] FIG. 8 shows a detailed view of the front and back belts, amplifying details of the belt split;

[0024] FIG. 9 shows a detailed front and back view of the central conveying multiple augers system; and

[0025] FIG. 10 shows sectional views of the conveying system of the present invention augmenting details about its location over the platform.

[0026] In aforementioned figures, the reference numbers indicate same or corresponding elements of the invention.

DETAILED DESCRIPTION OF THE INVENTION

[0027] It is observed in FIGS. 1 to 7 a platform 15 having a first conveyor belt 1 and a second conveyor belt 2, which are turned by rollers located in their ends. The first conveyor belt 1 and the second conveyor belt 2 moves the cereal towards the center of the platform 15, where augers 3 and auger 4 are

located. Multiple synchronized augers moves the cereal coming to the center of the platform 15 to the combine feeder. In the embodiment, auger 16 moves the cereal to the auger 17 which takes it to the harvester feeder 20.

[0028] The second conveyor belt 2, has a rigid belt, without movement except from its own turn. The first conveyor belt 1 is located adjacent to the second conveyor belt 2. The first conveyor belt 1, which apart from its own turning movement, has flexibility and includes movement with regards to the second conveyor belt 2 that allows to adapt to the land irregularities.

[0029] It is evident that the number of first conveyor belts 1 and the second conveyor belts 2, depends on the width of the platform 15. In one embodiment, the platform 15 includes a first conveyor belt 1 and a second conveyor belt 2 on each side of the feeder 20. As aforementioned, the platform 15 contains two augers 3 and 4, and retractable fingers 5.

[0030] In the embodiment show on FIG. 7, when the platform 15 is wider than 10.50 meters (35 feet), the platform 15 includes two first conveyor belts 1a, 1b and two second conveyor belts 2a, 2b placed on one side of the platform 15 and two first conveyor belts 1c, 1d and two second conveyor belts 2c, 2d on the other side of the platform 15. This is also the case for an articulated flexible platform, since it is so wide that using only one first conveyor belt 1 and one second conveyor belt is not enough to cover the land irregularities. In this case, joints 6 are placed on the left and right sides as it is shown in FIG. 4. This joint 6 is activate by a pneumatic pump, hydraulic pump, or it can be a mechanical joint FIG. 2.

[0031] The present platform 15 includes a first conveyor belt 1 and a second conveyor belt 2, which differs from the currently known platforms that have a belt on each side with the total width of the first conveyor belt 1 plus the one of the second conveyor belt 2.

[0032] Likewise, in mentioned FIGS. 2a 2b it is possible to use skids 7 where in the joint 6 and the pneumatic pump or hydraulic pump is leaned on the ground. In FIG. 3 a control gear 8 is shown, which allows to synchronize the cutting blades 22 with an axis that goes from the chassis' one side to the other, central auger 9, conveyor belts' commands 10, blades-box's command 11 and finally the support mill base 12.

[0033] In FIG. 4 it is possible to additionally observe the joint 6 of both laterals 13.

[0034] FIG. 8a shows a perspective view of the whole platform 15 with the auger set comprising: left oblique auger 4, front center auger 16, back center auger 17 (see FIG. 9a) and right oblique auger 3. The detailed view shows how the first conveyor belts and second conveyor belts 2 were split into narrower belts. It can be seen in the embodiment that: belt 1a was split into belts 1aa and 1ab, belt 2a was split into belts 2aa, 2ab and 2ac, belt 1b was split into belts 1ba and 1bb, belt 2B was split into belts 2ba, 2bb and 2bc. It can also be seen that the spaces between belts 44 and 45, as well as the spaces 43 between the first conveyor belt 1 and the second conveyor belt 2, are covered to impede cereal falling to the ground through this openings.

[0035] It is obvious that the number of narrower belts can be changed and adjusted to fit several options. In a preferred manner first conveyor belts 1 and second conveyor belts 2 can all be divided to the same width, and this way gain an advantage in repair time as one new replacement belt can be used as the spare part of any first conveyor belt or any second conveyor belt; it can also be useful if the operator decide to do

belts rotation to help belt wear. As an example, first belt 1ab could be rotated with first belt 1ba and first belt 1aa rotated with first belt 1bb.

[0036] FIG. 8b shows a perspective down view of half platform 15. It can be seeing in the detailed view that, as opposed to the covered openings 43, covered openings 44 and covered openings 45 shown in FIG. 8a, the spaces among belts 40, spaces among belts 41 and spaces among belts 42 are all clear to allow trash and dirt to fall directly to the field, becoming this into a multiple points self-cleaning belt.

[0037] FIG. 9a shows a perspective back view of the platform 15 displaying one method to synchronize the multiple auger central conveying system. The power from the combine reaches the chain drive box 29 through back shaft 32, then passes to the left oblique auger 4 which is directly connected to the front center auger 16 and this to the right oblique auger 3. Movement from right oblique auger 3 passes to the telescopic shaft 31 by the right chain drive box 30, which propels the back central auger 17.

[0038] It can be seeing in the detailed view that the back central auger 17 is just inside the attachment frame opening 18, very close to the combine feeder house.

[0039] FIG. 9b shows a perspective front view of the multiple synchronized-augers central conveying system. The detailed view shows the adjustable support of the front center auger 16, which is composed by the left support 24 and the right support 23, and brings the auger the option to be regulated on height and it distance to the back central auger 17 to boost the flow for various crop conditions.

[0040] It has to be noted that in the case of the shown figure, the position adjustment of the front center auger 16 is just mechanical and offered by the supports, but it can be hydraulically adapted if a proper hydraulic circuit with a cylinder is installed.

[0041] FIG. 10a shows a front view of the platform 15 marking off the cutting plane F-F and the cutting plane G-G that are used in the next figures to show its sectional view.

[0042] FIG. 10b shows the section G-G generated by the cutting plane G-G shown in the FIG. 10a. It can be seeing how the first conveyor belts 1 and the second conveyor belts 2 are placed related to the platform 15 height.

[0043] FIG. 10c shows the section F-F generated by the cutting plane F-F shown in the FIG. 10a. It can be seeing how the front central auger 16 and the back central auger 17 are placed in relation to: the first conveyor belt 1 and the second conveyor belt 2; the cutter bar 22; the attachment frame opening 18; the right divider 26 and the main frame right side; etcetera.

[0044] It is important to note that the number of central augers is not limited to two (2). A third or more middle central augers could be disposed to gain length of crop propellers.

What is claimed is:

1. A flexible platform for a combined harvesting, chopping, and spinning machine comprising:

- a platform having a first side and a second side;
- cutting blades located on the second side of the platform;
- a back central auger located on the first side of the platform;
- a telescopic shaft connecting the back central auger to a right chain drive box;
- a right chain drive box connecting the telescopic shaft to the right oblique auger;
- a right oblique auger connected to a first side of the front central auger;

a front central auger located between the second side of the platform and the first side of the platform;
 a left oblique auger connected to a second side of the front central auger;
 a left chain drive box connecting the left oblique auger to the back shaft;
 a first conveyor belt located on each one of the sides of both, the front central auger back central auger;
 a second conveyor belt located on each one of the sides of both, the front central auger back central auger, each second conveyor belt is placed in parallel and adjacent to the corresponding first conveyor belt;
 each second conveyor belt is rigid and moves in only one direction towards the central auger;
 each first conveyor belt is flexible and moves in one direction towards the central auger and also moves in relation to the corresponding second conveyor belt;
 each first conveyor belt is split throw it width into multiple belts;
 each second conveyor belt is split throw it width into multiple belts; and
 each first conveyor belt is located between the cutting blades and the corresponding second conveyor belt.

2. The flexible platform according to claim 1, wherein each first conveyor belt moves at a speed different from a speed of the corresponding second conveyor belt.

3. The flexible platform according to claim 1, wherein each first conveyor belt has a shape different from a shape of the corresponding second conveyor belt.

4. The flexible platform according to claim 1, wherein each first conveyor belt has a width different from a width of the corresponding second conveyor belt.

5. The flexible platform according to claim 1, wherein each first conveyor belt is made of a material different from a material of the corresponding second conveyor belt.

6. The flexible platform according to claim 1, further including two first conveyor belts and two second conveyors belts on each one of both, the front central auger back central auger.

7. A flexible platform for a combined harvesting, chopping, and spinning machine comprising:
 a platform having a first side and a second side;
 cutting blades located on the second side of the platform
 a back central auger located on the first side of the platform;
 a telescopic shaft connecting the back central auger to a right chain drive box;
 a right chain drive box connecting the telescopic shaft to the right oblique auger;
 a right oblique auger connected to a first side of the front central auger;
 a front central auger located between the second side of the platform and the first side of the platform;
 a left oblique auger connected to a second side of the front central auger;

a left chain drive box connecting the left oblique auger to the back shaft;
 a first conveyor belt located on each one of the sides of both, the front central auger back central auger;
 a second conveyor belt located on each one of the sides of both, the front central auger back central auger, each second conveyor belt is placed in parallel and adjacent to each first conveyor belt;
 each second conveyor belt is rigid and moves in only one direction towards the central auger;
 each first conveyor belt is flexible and moves in one direction towards the central auger and also moves at an angle in relation to the corresponding second conveyor belt;
 each first conveyor belt is split throw it width into multiple belts;
 each second conveyor belt is split throw it width into multiple belts; and
 each first conveyor belt is located between the cutting blades and the corresponding second conveyor belt.

8. The flexible platform according to claim 7, where multiple belts that are part of each first conveyor belt have the same width.

9. The flexible platform according to claim 7, where multiple belts that are part of each second conveyor belt have the same width.

10. The flexible platform according to claim 7 where the front central auger is nearer to the cutter bar than the back central auger.

11. The flexible platform according to claim 7, where the position of front central auger is adjustable respect of the platform floor.

12. The flexible platform according to claim 7, where the position of front central auger is adjustable respect of the back central auger.

13. The flexible platform according to claim 7, where the back central auger, the right oblique angle, the front central auger, the left oblique angle are all synchronized.

14. The flexible platform according to claim 7, where the back central auger has a helical screw blade that moves material from right to left.

15. The flexible platform according to claim 7, where the back central auger has an helical screw blade that moves material from left to right.

16. The flexible platform according to claim 7, where the front central auger has an helical screw blade that moves material from right to left.

17. The flexible platform according to claim 11, where the front central auger has an helical screw blade that moves material from left to right.

18. The back central auger according to claim 16, where the helical screw blade of the back central auger, while rotating, is always in the same position that a helical screw blade of the front central auger.

* * * * *