

(12) STANDARD PATENT APPLICATION (11) Application No. **AU 2007249060 A1**
(19) AUSTRALIAN PATENT OFFICE

(54) Title
A road milling machine and method for measuring the milling depth

(51) International Patent Classification(s)
E01C 23/12 (2006.01)

(21) Application No: **2007249060** (22) Date of Filing: **2007.12.17**

(30) Priority Data

(31) Number (32) Date (33) Country
102006062129.8 **2006.12.22** **DE**

(43) Publication Date: **2008.07.10**

(43) Publication Journal Date: **2008.07.10**

(71) Applicant(s)
Wirtgen GmbH

(72) Inventor(s)
Berning, Christian;Simons, Dieter

(74) Agent / Attorney
FB Rice & Co, Level 23 44 Market Street, Sydney, NSW, 2000

Abstract of the disclosure

In a self-propelling road milling machine (1), particularly a (recycler or) cold-milling machine, comprising a machine frame (4) carried by a track assemblies (2,3) via lifting
5 columns (12,13), a milling roll (6) supported on the machine frame (4) for treatment of a ground or traffic surface (8), height-adjustable side plates (10) for edge protection, arranged to rest on the ground or traffic surface (8) to be treated, a height-adjustable stripping means (14) arranged in the moving direction behind the milling roll (6) and adapted to be lowered, during operation, into the milling track (17) generated by the
10 milling roll (6), and a control means (23) for controlling the milling depth of the milling roller (6), it is provided that at least one measuring means (16) is operative to detect the lifting, caused by the current milling depth, of a first sensor means resting on the ground or traffic surface (8), and/or the lowering of the stripping means (14) or a second sensor means onto the surface of the milling track (17), the control means (23) ob-
15 taining the current milling depth at the level of the stripping means (14) of the milling roller (6) or of the second sensor means from the measurement values of the at least one measuring means (16).

(Fig. 1)

AUSTRALIA

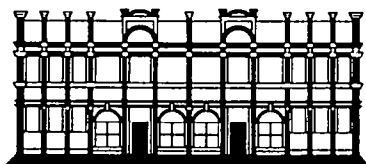

FB RICE & CO
Patent and Trade Mark Attorneys

Patents Act 1990

WIRTGEN GMBH

**COMPLETE SPECIFICATION
STANDARD PATENT**

Invention Title:

*A road milling machine and method for measuring the milling
depth*

The following statement is a full description of this invention
including the best method of performing it known to us:-

Title of the invention

A road milling machine and method for measuring the milling depth

5 Background of the invention

Related foreign application

The present application claims the priority of the German Patent Application No. 10
10 2006 062 129.8 of December 22, 2006, the disclosure of which is herewith incorpo-
rated herein by reference.

Field of the invention

15 The invention refers to a self-propelled road milling machine, especially a cold milling
machine, according to the preamble of claim 1, as well as a methods for measuring the
milling depth according to the preamble of claim 27.

Description of related art

20

With such road milling machines, the machine frame is supported by a track assembly
comprising wheels or caterpillar tracks connected to the machine frame through lifting
columns, the lifting columns allowing to maintain the machine frame in a horizontal
25 plane or in parallel to the ground or under a predetermined longitudinal and/or transver-
sal inclination.

A milling roll for working a ground or traffic surface is supported at the machine
frame.

30 Near the front end sides of the milling roll height-adjustable side plates are provided as
edge protectors at an outer wall of the road milling machine, which side plates, in op-
eration, rest on the ground or traffic surface at the lateral non-milled edges of the mill-
ing track. Behind the milling roll, seen in the travelling direction, a height-adjustable
stripping means is provided which, in operation, may be lowered into the milling track
35 formed by the milling roll to strip off milling material remaining in the milling track.

Further, the road milling machine has a control means for controlling the milling depth of the milling roll.

5 It is a problem with known road milling machines that the milling depth can not be controlled accurately enough and that, for this reason, the milling depth has to be measured repeatedly by hand during the milling operation. Especially in cases where a hard traffic surface, e.g. concrete, is milled, the tools are worn heavily so that the milling depth set is corrupted by the decreasing diameter of the cutting circle. For example, the wear of the tools, when milling concrete, can cause a difference in the milling radius of 15 mm after only a few 100 m, so that the measuring of an adjustment of side plates, for example, with respect to the machine frame is not sufficiently accurate. If the milling depth is insufficient, a time-consuming reworking of the milling track has to be carried out. Should the milling track be too deep, more building material has to be applied afterwards in order to achieve the desired ground or traffic surface level.

15

Summary of the invention

It is an object of the present invention to improve the accuracy of measuring the milling depth during the operation of a road milling machine and to thereby minimize deviations from a predetermined milling depth.

20

The invention advantageously provides that at least one measuring means detects the lifting of a first sensor means resting on the ground or traffic surface and/or the lowering of a second sensor means to the bottom of the milling track, the lifting or lowering being effected in correspondence with the present milling depth. From the measured values supplied by the at least one measuring means, the control means can determine the milling depth at the level of the measuring means of the milling roll or the second sensor means.

30 Here, the measurement is effected preferably at the level of the stripping means arranged closely behind the milling roll, or immediately behind the stripping means, if a separate sensor means is provided.

Using the stripping means as a sensor means is advantageous in that no measuring errors are caused by some unevenness in the milling track. It is another advantage that the stripping means is protected against wear at its bottom edge.

35

As an alternative, the control means can use the measurement values of the at least one measuring means to determine the current milling depth of the milling roll at the level of the milling roll axis. Preferably, this is done by a calculation that may also take into
5 account an inclined position of the machine frame.

The measuring means are preferably formed by position sensing means. In one embodiment it is provided that the first sensor means is formed by at least one of the side plates arranged on either side at the front sides of the milling roll so as to be height-
10 adjustable and pivotable with respect to the machine frame. The side plates rest on the ground or traffic surface or are pressed against these, so that a change of their position relative to the machine frame during operation allows for an exact detection of the milling depth, if a measurement of the change of the position of a second sensor means is performed additionally in the milling track relative to the machine frame.

15

Also for side plates, there is an advantage that their bottom edges are protected against wear.

Here, the measuring means may comprise cable lines coupled with the side plates
20 and/or the stripping means, and associated cable-line sensors as the position sensors which measure the changes of the position of the side plates and the stripping means relative to the machine frame or the relative displacement of at least one of the side plates in relation to the stripping means or the second sensor means.

25 Preferably, the cable lines coupled with the side plates and the stripping means are arranged transversely to the milling track in a substantially vertical plane extending approximately at the level of the stripping means.

Hereby, it can be avoided that a measurement error is caused by using different refer-
30 ence planes for the measurement at the side plates with respect to the measurement at the stripping plate.

To achieve this, it may be provided that a cable line is coupled on the one hand with the stripping means and, on the other hand, with at least one of the side plates via a guide
35 roller, such that a cable-line sensor immediately measures the milling depth, e.g. at the guide roller.

In another alternative it may be provided that the side plate has a respective measuring means at the side edges facing the side plates, which measures the relative displacement of the stripping means with respect to the at least one adjacent side plate or the relative displacement of at least one side plate with respect to the stripping means.

According to another alternative embodiment, the stripping means may include at least one height-adjustable beam as the first sensing means, which is guided vertically and linearly in the stripping means and extends transversely to the travelling direction, said beam resting on the ground or traffic surface beside the milling track, the position of the beam relative to the stripping means, preferably with respect to height and/or inclination, being measurable by the measuring means.

Due to gravity, the side plates may rest on the edges of the ground or traffic surface beside the milling track milled by the milling machine, or they may alternatively be pressed on the edges by hydraulic means.

The stripping means may also be pressed on the surface of the milling track using hydraulic means.

The hydraulic means for pressing the side plates on the ground or traffic surface or for pressing the stripping means on the bottom of the milling track may comprise integrated position sensing systems.

For lifting or lowering the side plates and/or the stripping means, a plurality of, preferably two respective piston/cylinder units with integrated position sensing systems may be provided, whose position sensing signals are used by the control means to calculate the current milling depth from the relative difference between the positions of the stripping means and the at least one first sensor means.

The control means that receives the position sensing signals from the measuring means is adapted to automatically control means the lifted condition of the rear lifting columns, seen in the travelling direction, to establish parallelism between the machine frame and the ground or traffic surface at a desired milling depth.

35

The side plates resting on the traffic surface so as to be pivotable with respect to the machine frame may comprise measuring means spaced apart in the travelling direction, the control means being capable to measure the longitudinal and/or the transversal inclination of the machine frame with respect to the ground or traffic surface from the
5 difference between the measurement signals from the side plates and the stripping means.

The front and/or rear lifting columns may include a position sensing system to detect the lifted condition. The control means that receives the position sensing signals from
10 the measuring means can control the condition of all lifting columns such that the machine frame has a predetermined inclination or a predetermined travel-distance-dependent transverse inclination across the travelling direction.

Preferably, the current set value for the milling depth of the milling roll is adjusted using the front lifting columns.
15

Brief description of the drawings

The following is a detailed description of a preferred embodiment of the invention with
20 reference to the accompanying drawings.

In the Figures:

Fig. 1 shows a cold milling machine,
25

Fig. 2 illustrates a first sensor means attached to the stripping plate,

Fig. 3 shows two piston/cylinder units for lifting or lowering the stripping plate of a stripping means,
30

Fig. 4 illustrates an optical device for measuring the positional difference between the side plates and the stripping means,

Fig. 5 shows a cable line measuring means provided between the side plates and the
35 stripping means,

Fig. 6 illustrates a preferred embodiment, and

Figs. 7a, b, are schematic illustrations of the measurement error occurring at the stripping plate of the stripping means in the absence of parallelism between the machine frame and the ground or traffic surface.

Description of preferred embodiments

The road milling machine illustrated in Fig. 1 comprises a machine frame 4 supported by a track assembly having two front chain tracks 2 and at least one rear chain track 3. The chain tracks 2, 3 are connected with the machine frame 4 via lifting columns 12, 13. It is understood that wheels may be used instead of the chain tracks 2, 3.

Using the lifting columns 12, 13, the machine frame 4 can be lifted or lowered or moved to take a predetermined inclined position with respect to the ground or traffic surface 8. The milling roll 6 supported in the machine frame 4 is enclosed by a roll case 9 which is open at the front, seen in the travelling direction, towards a conveyor belt 11 that conveys the milled material in a front part of the machine frame 4 to a second conveyor means 13. The second conveyor means 13 with which the milled material may be delivered onto a truck, for example, is not fully illustrated in Fig. 1 because of its length. Behind the milling roll 6, a height-adjustable stripping means 14 is arranged which, in operation, has a stripping plate 15 engage into the milling track 17 formed by the milling roll 6 and strip the bottom of the milling track 17 so that no milled material is left in the milling track 17 behind the stripping plate.

25

Above the milling roll 6, a driver's stand 5 with a control panel for the vehicle operator is provided for all control functions of the driving and milling operations. It also includes a control means 23 for controlling the milling depth of the milling roll 6.

The side plates 10, arranged on either side near the front end of the milling roll 6, and the stripping means 14 are provided with measuring means 16 that allow the determination of the current milling depth at the level of the stripping means 14 or the calculation of the milling depth at the level of the rotational axis of the milling roll. Here, the milling depth is determined in a plane orthogonal to the ground or traffic surface, which plane is parallel to the rotational axis of the milling roll and includes the rotational axis.

35

The position of a first sensor means, e.g. the side plates 10, on the ground or traffic surface 8 and/or the lowering of a second sensor means, e.g. the stripping means, can thus be detected. Measuring means 16, preferably formed by position sensing means, measure the displacements of the sensor means, e.g. the side plates 10 or a beam 20 or
5 the stripping plate 15, with respect to the machine frame 4 or relative to each other.

The embodiment illustrated in Fig. 2 shows a beam 20 as the sensor means, resting on the ground or traffic surface 8 and guided at the stripping plate 15 of the stripping means in a slot 24 extending linearly and orthogonally to the bottom edge 19 of the
10 stripping plate 15. It is understood that two mutually parallel slots 24 can be provided in the stripping plate 15 or that the beam 20, serving as the sensing means, can be guided in a different manner so as to be height-adjustable at the stripping means 14. The measuring means 16, provided in the form of a position sensing means, detects the displacement of the beam 20 with respect to the stripping means 14. Should two hori-
15 zontally spaced slots 24 be used, it is possible to separately detect the milling depth on the left side of the milling track 17 and on the right side of the milling track 17. Moreover, this offers the possibility to determine an inclination of the machine frame 4 with respect to the ground or traffic surface 8.

20 Fig. 3 illustrates another embodiment wherein the stripping plate 15 of the stripping means 14 can be lifted or lowered by means of hydraulic means. The hydraulic means are formed by piston/cylinder units 26, 28 with an integrated position sensing system. This means that the piston/cylinder units 26, 28 not only allow for the stroke movement of the stripping means, but moreover generate a position signal.

25

As is evident from Fig. 3, the piston/cylinder units 26, 28 have one end connected to the machine frame 4 and the other end connected to the stripping plate 15.

Fig. 4 illustrates an embodiment, wherein the relative movement between the side
30 plates 10 and the stripping plate 15 is measured directly in order to detect the milling depth of the milling track 17. To achieve this, elements 38, 40 of the measuring means 16 are provided, e.g., at the side plates 10 and opposite thereto at the stripping plate 15, which elements allow for the detection of the relative displacement of the stripping plate 15 with respect to the side plates 10. This displacement corresponds to the milling
35 depth s in Fig. 4. For example, such a measuring means, which measures relative dis-

placements, may be formed by an optical system, e.g. by reading a scale with an optical sensor, or by an electromagnetic or inductive system.

5 As an alternative and as illustrated in Fig. 5, the relative position sensing system between the side plates 10 and the stripping plate 15 may also be formed by a cable line 22 in combination with a cable-line sensor 21. the cable line 22 is coupled with the stripping plate 15 of the stripping means 14 on the one hand and, on the other hand, with at least one of the side plates 10 via a guide roller 35, so that the signal from the cable-line sensor 21 can immediately indicate the value of the current milling depth.

10

The side plates 10 themselves can be used as first sensor means by monitoring their position with respect to the machine frame 4 or the second sensor means by means of a cable line and a cable-line sensor or by means of piston/cylinder units 30, 32 with integrated position sensing means.

15

For example, the measuring means can also measure the displacement of the side plates 10 with respect to the machine frame 4. Should two measuring means be used, one in front of the side plates 10 and one behind the same, seen in the travelling direction, it is also possible to determine the longitudinal inclination of the machine frame 4 with respect to the ground or traffic surface 8 or to also determine the transverse inclination of the machine frame 4 by a comparison of the measured values for both side plates 10 on both sides of the milling roll 6.

25 Fig. 6 illustrates a preferred embodiment, wherein cable lines 22 comprising cable-line sensors 21 mounted to the machine frame 4 are arranged on both sides of the stripping means 15. On either side of the machine, the side plates 10 are also provided with cable lines 22 and cable-line sensors 21 fastened at the machine frame 4. The milling depth s is determined from the difference between the measured values of the cable-line sensors 21 for the side plates 10 and the cable-line sensors 21 of the stripping means 15. 30 Here, the measurement should preferably be made in the same substantially vertical plane in order to avoid measurement errors.

Figs. 7a to 7c illustrate the cable-line sensors 21 for the side plates 10 and the stripping plates 14, the drawings only indicating one cable-line sensor 21, since the cable-line 35 sensors are arranged one behind the other in substantially the same plane.

Figs. 7a, b, c are to illustrate the case where the ground or traffic surface 8 is not parallel to the machine frame 4, the measured milling depth value indicated by the measuring means having to be corrected because of an angle error, because a longitudinal inclination of the machine frame 4 corrupts the measurement signal at the level of the stripping plate 15 or a second sensor means near the stripping means 14. Due to the fixed geometrical relations, i.e. the distance of the stripping plate 15 from the rotational axis of the milling roll 6, the measured milling depth value can be corrected, knowing the angular deviation from the horizontal in the travelling direction, and the current milling depth at the level of the milling roll axis can be calculated. The angular deviation in the travelling direction may be determined, for example, from the position of the lifting columns 12, 13 of the caterpillar track assemblies 2, 3 or the piston/cylinder units 30, 32.

It is further evident from Figs. 7a to c, to which extent the side plates 10 are pivotable with respect to the machine frame 4. Since the piston/cylinder units 30, 32 are also provided with position sensing systems, these measuring signals may be used as an alternative to cable-line sensors 21 to determine the distance of the side plates 10 from the machine frame 4.

Fig. 7c illustrates the position of the at least one side plate 10 for a ground-parallel position of the machine frame 4. The stripping plate 15 illustrated in Figures 7a to 7c is located at the roll case 9, so that the distance of the stripping plate 14 from the rotational axis to the milling roll 6 can be determined unambiguously in order to allow for a calculation of the milling depth correction should the machine frame 4 not be parallel to the ground.

The control means 23 can calculate the current milling depth at the level of the milling roll axis from the position sensing signals received, and it can possibly also generate a control signal for a vertical adjustment of the milling roll 6.

Preferably, the control means 23 can automatically control the lifted condition of the at least one rear lifting column 13, seen in the travelling direction, to establish parallelism between the machine frame 4 and the ground or traffic surface 8 or to the horizontal plane or to a predetermined desired milling plane.

35

Although the invention has been described and illustrated with reference to specific embodiments thereof, it is not intended that the invention be limited to those illustrative embodiments. Those skilled in that art will recognize that variations and modifications can be made without departing from the true scope of the invention as defined by the
5 claims that follow. It is therefore intended to include within the invention all such variations and modifications as fall within the scope of the appended claims and equivalents thereof.

THE CLAIMS DEFINING THE INVENTION ARE AS FOLLOWS:-

1. A self-propelling road milling machine, particularly a cold-milling machine, comprising
 - 5 - a track assembly carrying the machine frame via lifting columns,
 - a milling roller supported on the machine frame for treatment of a ground or traffic surface,
 - height-adjustable side plates for edge protection, arranged to rest on the ground or traffic surface to be treated,
 - 10 - a height-adjustable stripping means arranged in the moving direction behind the milling roller and adapted to be lowered, during operation, into the milling track generated by the milling roller, and
 - a control means for controlling the milling depth of the milling roller,
c h a r a c t e r i z e d i n t h a t
 - 15 at least one measuring means is operative to detect the lifting, caused by the current milling depth, of a first sensor means resting on the ground or traffic surface to be treated, and/or the lowering of a second sensor means onto the surface of the milling track, the control means obtaining the milling depth of the milling roller from the measurement values of the at least one measuring means.
 - 20
2. The road milling machine of claim 1, wherein the control means obtains the milling depth of the milling roll at the level of the second sensor means from the measurement values of the at least one measuring means.
- 25 3. The road milling machine of claim 1, wherein the control means obtains the current milling depth of the milling roll at the level of the milling roll axis from the measurement values of the at least one measuring means.
4. The road milling machine of any one of claims 1 to 3, wherein the second sensor
30 means comprises the stripping means.
5. The road milling machine of any one of claims 1 to 4, wherein the measuring means comprise position-sensing means.
- 35 6. The road milling machine of any one of claims 1 to 5, wherein the first sensor means comprises at least one of the side plates which are arranged on both sides on the

end sides of the milling roll in a height-adjustable and pivotable manner relative to the machine frame.

7. The road milling machine of any one of claims 1 to 6, wherein the measuring
5 means comprise cable lines, coupled to the first sensor means and/or the second sensor means, and cable-line sensors as position-sensing means.

8. The road milling machine of any one of claims 1 to 7, wherein the measuring
10 means detect the displacement of the first sensor means relative to the second sensor means, or respectively the displacement of the first sensor means and the second sensor means relative to the machine frame.

9. The road milling machine of claim 7 or 8, wherein a cable line is coupled on the
15 one hand to the stripping means and on the other hand to at least one of the side plates via a deflection roll such that a cable-line sensor directly measures the milling depth.

10. The road milling machine of any one of claims 6 to 9, wherein the stripping
20 means on the side edges facing towards the side plates comprises respectively one measuring means for measuring the relative displacement of the stripping means relative to at least one side plate.

11. The road milling machine of claim 1 or 2, wherein the stripping means com-
25 prises at least one height-adjustable beam which in the stripping direction is guided orthogonally to the lower edge of the stripping means, and which extends transversely to the moving direction, said beam serving as a first sensor means, with said beam resting on the ground or traffic surface adjacent to the milling track, and with the position of the beam being measurable relative to the stripping means, preferably with respect to height and inclination, by the measuring means.

30 12. The road milling machine of any one of claims 6 to 11, wherein, under the effect of gravity, the side plates rest on the edges adjacent the milling track milled by the milling roll.

13. The road milling machine of any one of claims 6 to 12, wherein hydraulic means
35 are provided to press the side plates onto the edges adjacent to the milling track milled

by the milling roll and/or to press the stripping means onto the bottom of the milling track.

14. The road milling machine of claim 9, wherein the hydraulic means comprise
5 piston/cylinder units with integrated position-sensing means.

15. The road milling machine of any one of claims 6 to 14, wherein, for lifting or
lowering the side plates and/or the stripping means, a plurality, preferably respectively
two piston/cylinder units with integrated position-sensing systems are provided, the
10 position-sensing signals of the position-sensing systems relative to the machine frame
being used by the control means for computing the current milling depth.

16. The road milling machine of any one of claims 1 to 15, wherein the control
means receiving the position-sensing signals of the measuring means is operative to
15 automatically control the lifting condition of the rear lifting columns in the moving
direction for establishing parallelism between the machine frame and the ground or
traffic surface or a predetermined milling surface.

17. The road milling machine of claim 16, wherein the side plates resting on the
20 ground or traffic surface in a pivotable manner relative to the machine frame are pro-
vided with two measuring means arranged at a mutual distance in the moving direction
and wherein the control means is operative to measure, from the difference between the
measuring signals of the side plates, the longitudinal inclination and/or transverse incli-
nation of the machine frame relative to the ground or traffic surface.

25

18. The road milling machine of any one of claims 1 to 17, wherein the front and/or
rear lifting columns are provided with an position-sensing system for detecting the lift-
ing condition.

30 19. The road milling machine of any one of claims 1 to 18, wherein the control
means receiving the position-sensing signals of the measuring means, is operative to
control the lifting condition of all lifting columns such that the machine frame has a
predetermined transverse inclination or a predetermined travel-distance-dependent
course of the transverse inclination transversely to the moving direction.

35

20. The road milling machine of claim 18 or 19 , wherein the current desired value for the milling depth of the milling roll is adjustable by means of the front lifting columns.
- 5 21. The road milling machine of any one of claims 1 to 20, wherein the control means receiving the position-sensing signals of all measuring means of the side plates and/or stripping means as well as all lifting columns, is operative to set, in dependence on the position-sensing signals of the measuring means and/or on the desired position-dependent change of a desired value for the milling depth, the resultant lifting position
10 of the lifting columns in the course of the treated length of path.
22. The road milling machine of any one of claims 1 to 21, wherein the zero level of the measuring signals of the measuring means on the unmilled ground or traffic surface is settable.
- 15 23. The road milling machine of any one of claims 1 to 22, wherein each lifting column at its lower end comprises a carrier for a wheel or a caterpillar track assembly, and wherein a distance sensor is operative to measure the distance of the carrier from the ground or traffic surface and to transmit a measuring signal to a control means for the
20 lifting position of the lifting columns and/or to a control means for the milling depth of the milling roller.
24. The road milling machine of any one of claims 1 to 23, wherein the milling roller extends substantially across the whole working depth of the machine frame.
- 25 25. The road milling machine of any one of claims 1 to 24, wherein the milling roller is supported in a height-adjustable manner in the machine frame.
26. The road milling machine of any one of claims 1 to 25, wherein the control
30 means obtains the current milling depth from the received position-sensing signals and generates a control signal for the height adjustment of the milling roll.
27. A method for measuring the milling depth in road milling machines particularly in cold-milling machines, which are operative to mill a ground or traffic surface by
35 means of a milling roll in that, for milling, the road milling machine with the milling roll is lowered corresponding to the predetermined milling depth, in which road milling

machines a side plate will at least on one side be placed adjacent the milling track onto the untreated ground or traffic surface, and a stripping plate will be lowered into the milling track generated by the milling roll,

5 wherein the measuring of the milling depth of the milling track is performed by detecting the measurement values of at least one first sensor means sensing the position of the untreated ground or traffic surface in relation to the measurement values of a second sensor means sensing the position of the ground of the milling track or by measuring the measurement values of both sensor means in relation to the machine
10 frame.

28. The method according to claim 27, wherein the side edges adjacent to the milling track are held down by means of side plates and wherein at least one of the side plates is used as said first sensor means, the stripping plate for stripping the milled surface being used as said second sensor means.
15

29. The method according to claim 27 or 28, wherein a correction of the measured milling-depth value is performed in dependence on the distance between said second sensor means and the rotational axis of the milling roller when the machine frame of the
20 road milling machine does not extend parallel to the ground or traffic surface.

DATED this 14th day of December 2007

Wirtgen GmbH
Patent Attorneys for the Applicant:

F.B. RICE & CO.

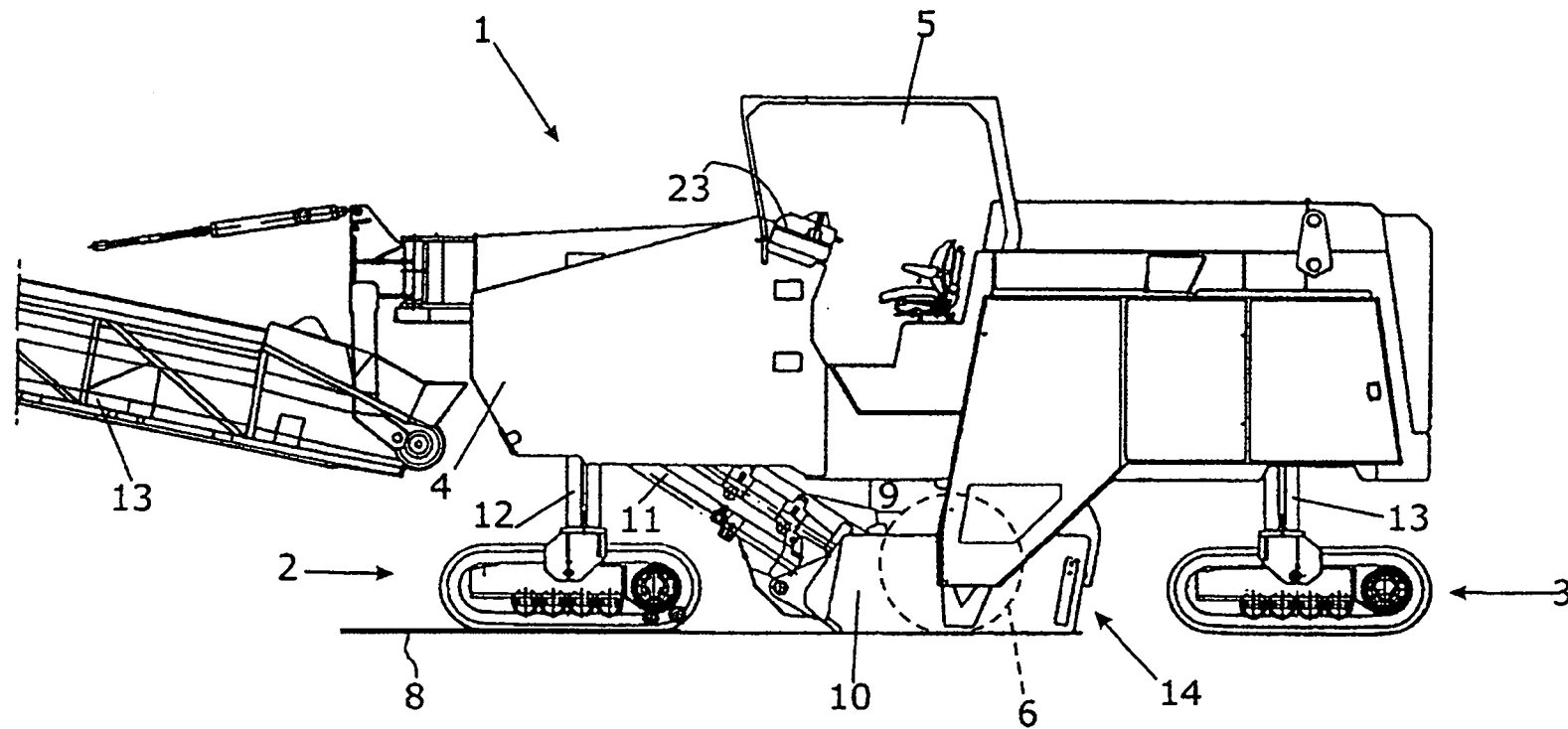

Fig.1

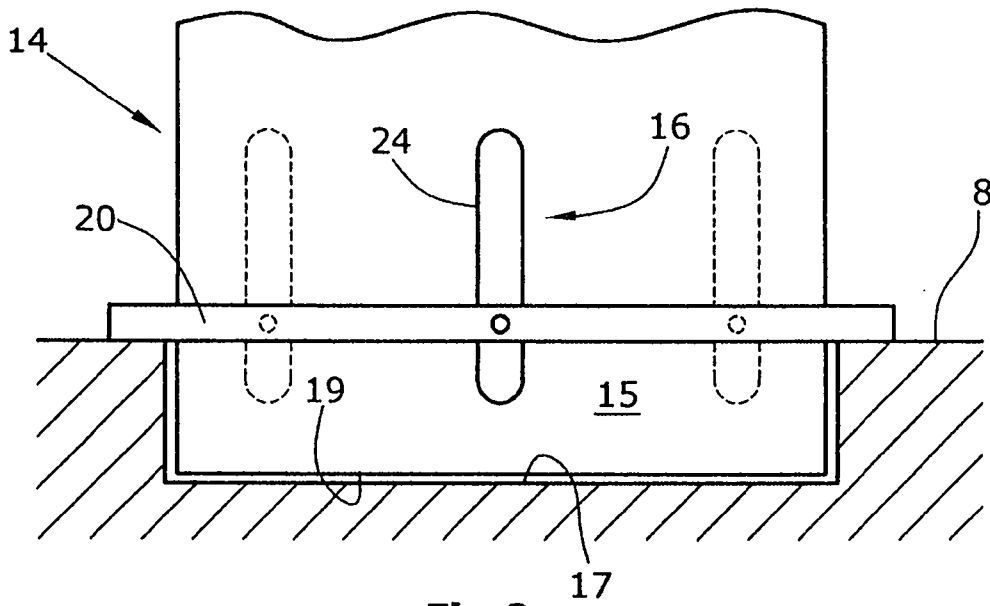

Fig. 2

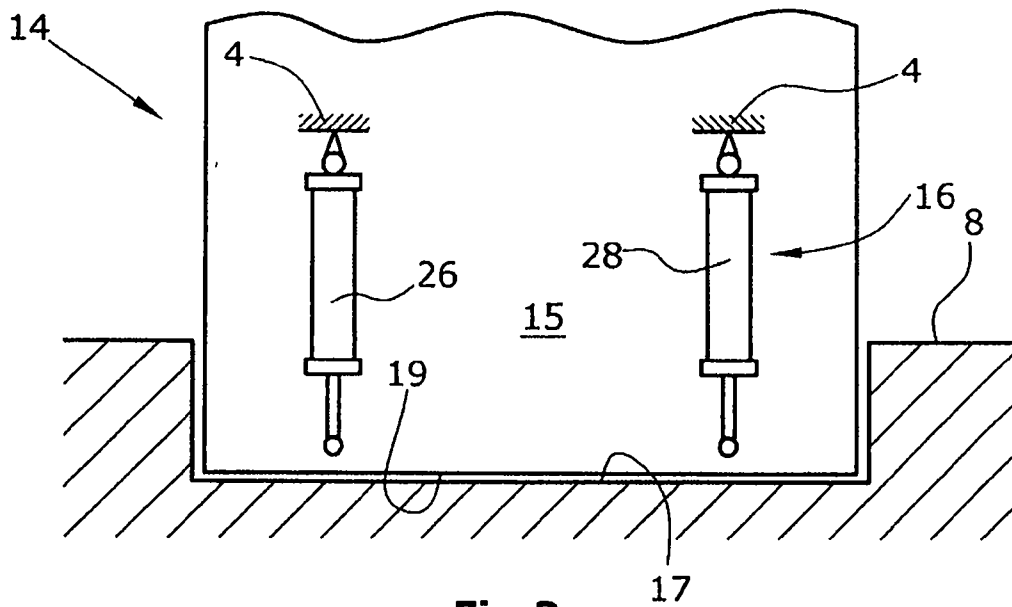

Fig. 3

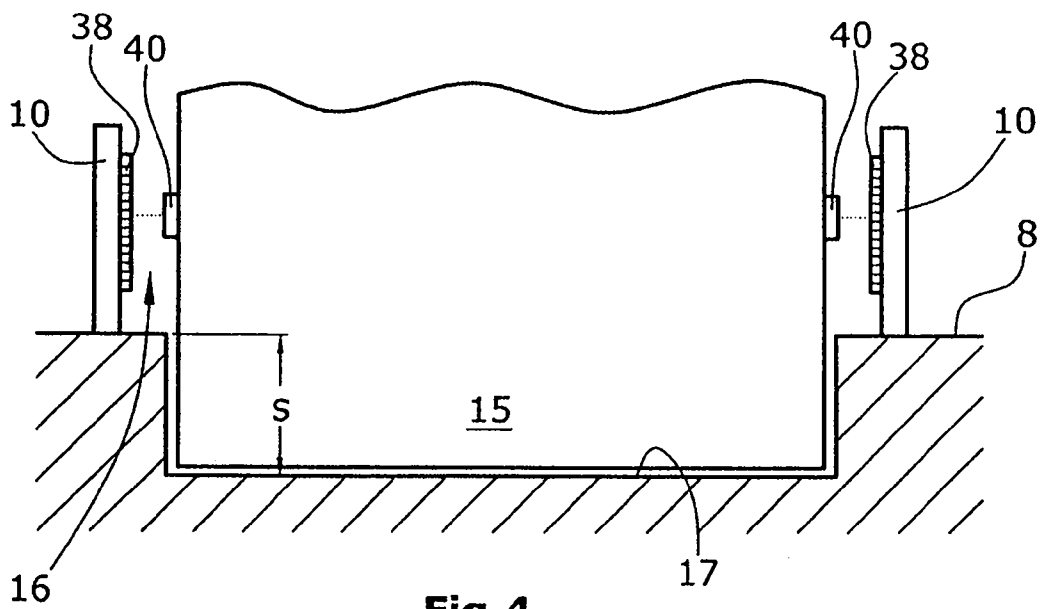

Fig. 4

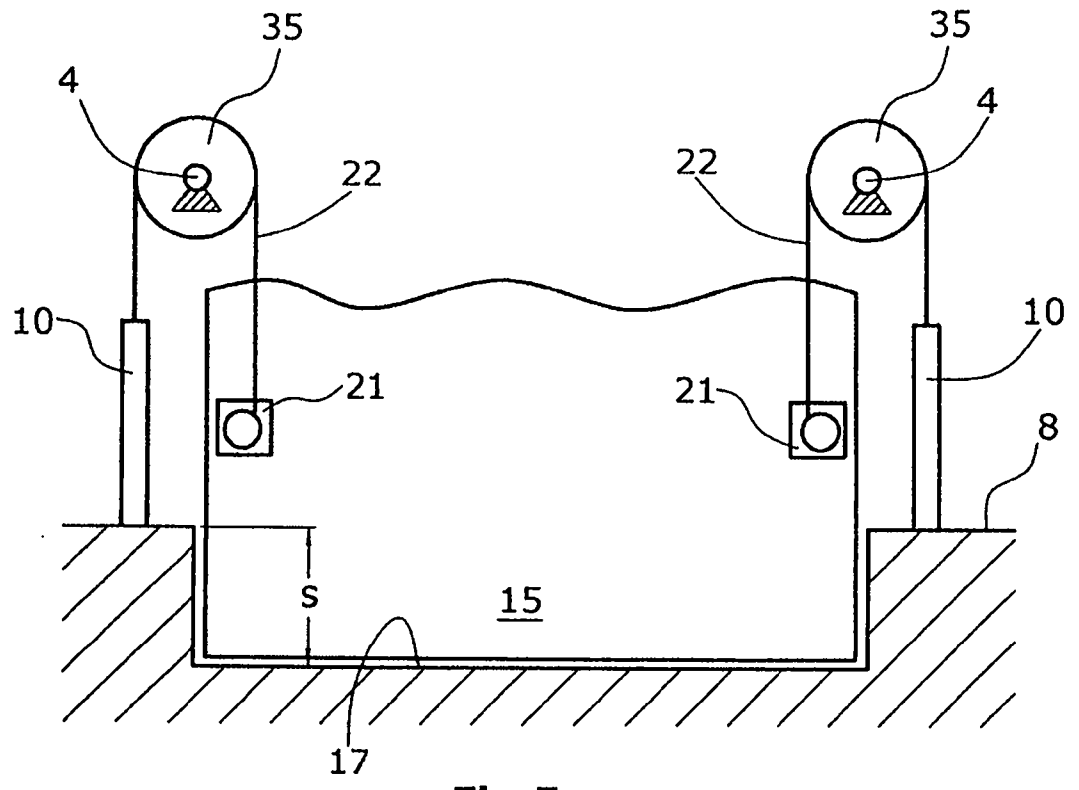

Fig. 5

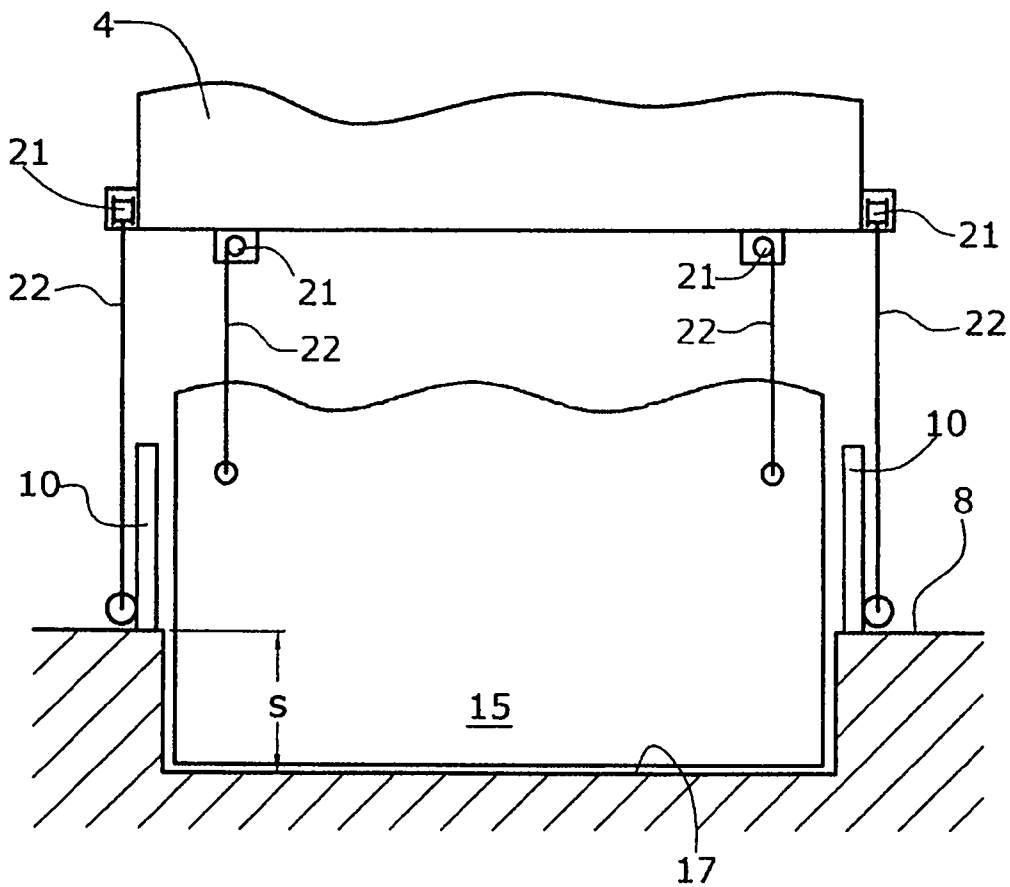

Fig.6

Fig.7a

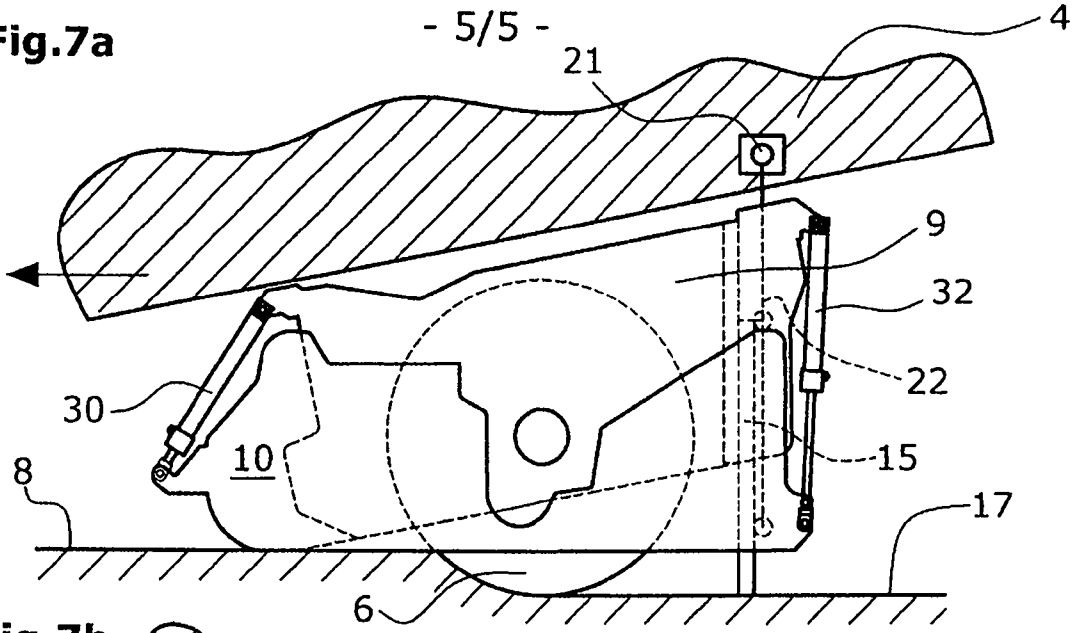

Fig.7b

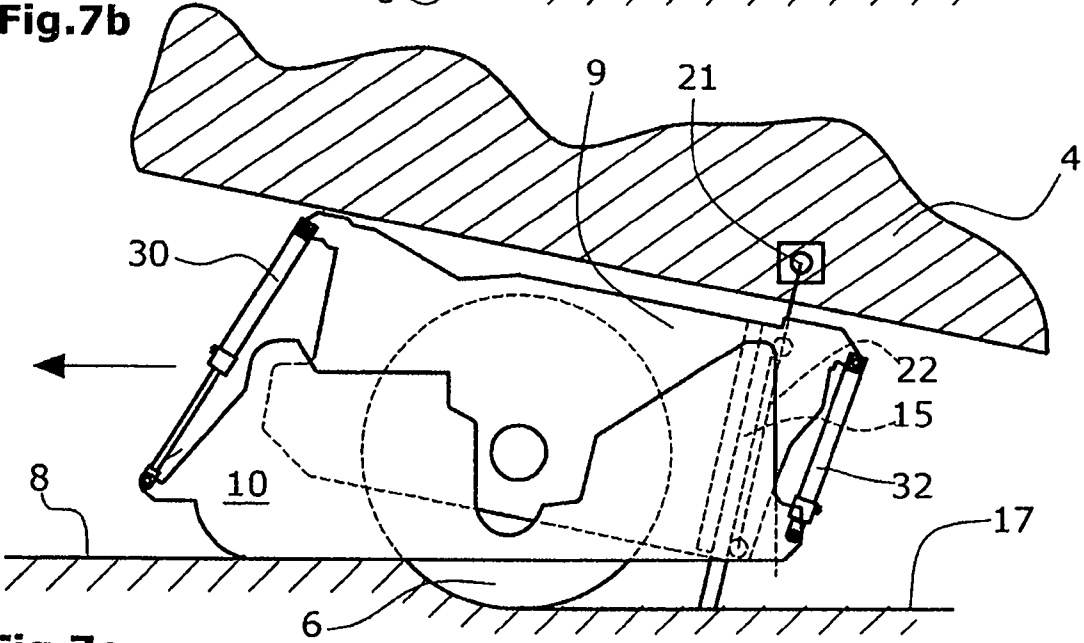

Fig.7c

