



US00D576171S

(12) **United States Design Patent**
Armendariz et al.

(10) **Patent No.:** **US D576,171 S**

(45) **Date of Patent:** **** Sep. 2, 2008**

(54) **USER INTERFACE FOR A PORTION OF A DISPLAY SCREEN**

(75) Inventors: **Nerea Armendariz**, Seattle, WA (US);
Jennifer L. Sadler, Seattle, WA (US)

(73) Assignee: **Microsoft Corporation**, Redmond, WA (US)

(**) Term: **14 Years**

(21) Appl. No.: **29/247,004**

(22) Filed: **May 23, 2006**

Related U.S. Application Data

(63) Continuation of application No. 29/246,933, filed on May 22, 2006.

(51) **LOC (8) Cl.** **14-04**

(52) **U.S. Cl.** **D14/486**

(58) **Field of Classification Search** D14/485-95;
D18/24-33; D19/6; D20/11; D21/324-33;
715/700-867, 973-77

See application file for complete search history.

(56) **References Cited**

U.S. PATENT DOCUMENTS

D459,361 S * 6/2002 Inagaki D14/486

D467,252 S * 12/2002 Lee D14/486
D470,857 S * 2/2003 Anderson et al. D14/485
D549,714 S * 8/2007 Sharma D14/485
D552,620 S * 10/2007 Sato et al. D14/486
D558,211 S * 12/2007 Dongen et al. D14/485
D558,778 S * 1/2008 Okaro et al. D14/487

* cited by examiner

Primary Examiner—Melanie H Tung

(74) *Attorney, Agent, or Firm*—Banner & Witcoff, Ltd.

(57) **CLAIM**

The ornamental design for a user interface for a portion of a display screen, as shown and described.

DESCRIPTION

The FIGURE is a front view of a user interface for a portion of a display screen showing our new design.

The broken line showing of the elements within the user interface and the unshaded areas within them form no part of the claimed design. The broken line showing of the portion of a display screen is for illustrative purposes only and forms no part of the claimed design.

1 Claim, 1 Drawing Sheet

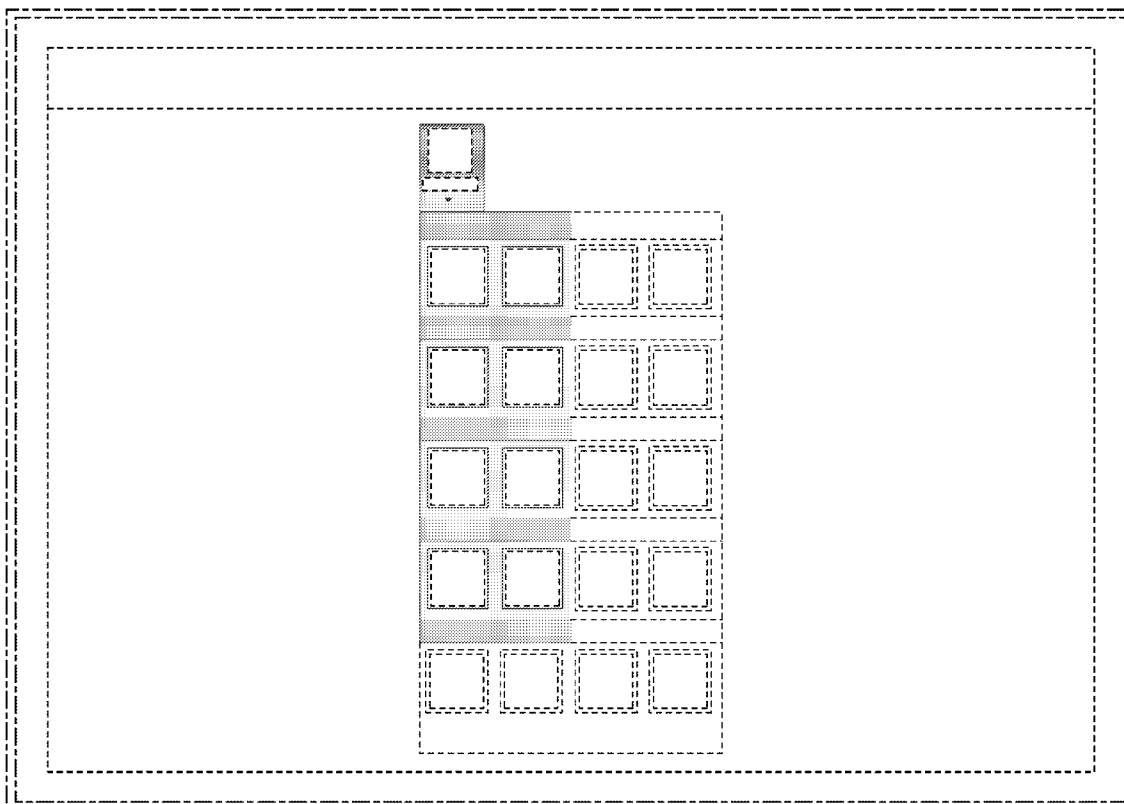

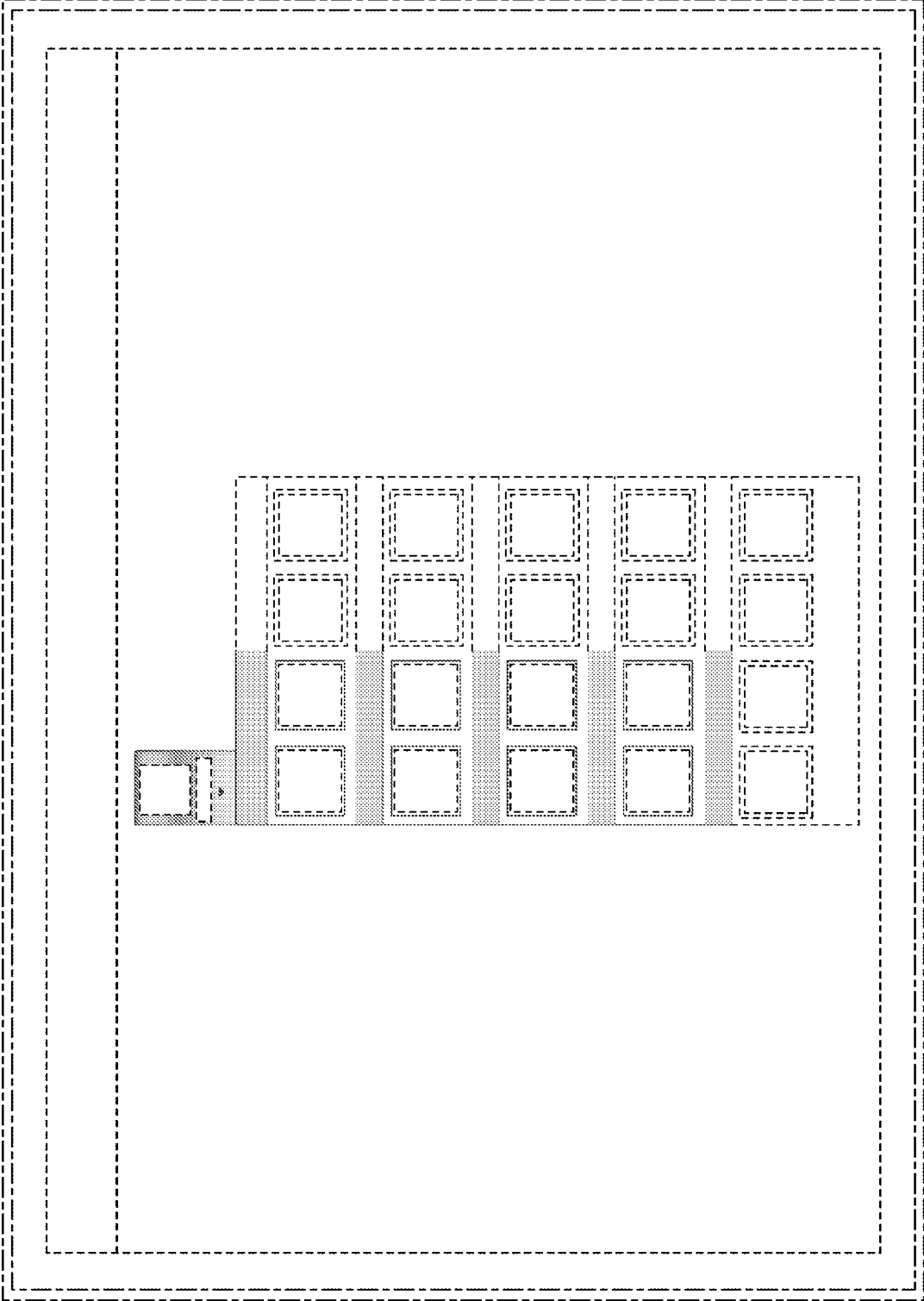

FIGURE