

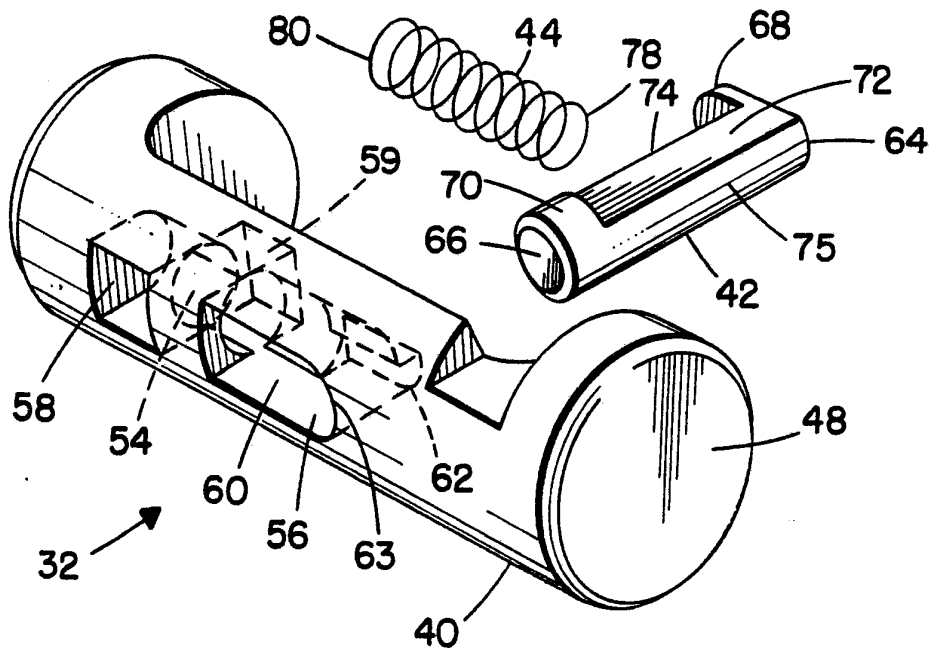

INTERNATIONAL APPLICATION PUBLISHED UNDER THE PATENT COOPERATION TREATY (PCT)

<p>(51) International Patent Classification⁵ : F41A 9/61</p>	<p>A1</p>	<p>(11) International Publication Number: WO 92/10713 (43) International Publication Date: 25 June 1992 (25.06.92)</p>
<p>(21) International Application Number: PCT/US91/08192 (22) International Filing Date: 4 November 1991 (04.11.91) (30) Priority data: 627,320 14 December 1990 (14.12.90) US (71) Applicant: COLT'S MANUFACTURING COMPANY, INC. [US/US]; 545 New Park Avenue, West Hartford, CT 06144 (US). (72) Inventors: LISHNESS, Bryant, L. ; 84 Lynn Road, Bristol, CT 60610 (US). SCIRICA, Paul, A. ; 5 Olde Flatbrood Road, East Hampton, CT 06424 (US).</p>		<p>(74) Agent: GREEN, Clarence, A.; Perman & Green, 425 Post Road, Fairfield, CT 06430 (US). (81) Designated States: AT (European patent), BE (European patent), CH (European patent), DE (European patent), DK (European patent), ES (European patent), FR (European patent), GB (European patent), GR (European patent), IT (European patent), LU (European patent), NL (European patent), SE (European patent). Published <i>With international search report.</i></p>

(54) Title: REVERSIBLE MAGAZINE CATCH ASSEMBLY AND METHOD OF MAKING THE SAME



(57) Abstract

A reversible magazine catch assembly (32) has a housing (40), a movable mounting pin (42) and a coiled spring (44). The housing has a spring channel (54) generally perpendicular to and intersecting a pin hole (56), and a magazine locking rib (52). The spring channel (54) is formed by drilling three parallel holes (58, 59, 62) into the housing at different directions to provide lateral support for the coiled spring (44). The spring biases the housing relative to the spin and forms a slidable friction hold of the pin. The pin has ledges (68, 70) that interact with the spring and housing to prevent it from being pushed out of the housing.

FOR THE PURPOSES OF INFORMATION ONLY

Codes used to identify States party to the PCT on the front pages of pamphlets publishing international applications under the PCT.

AT	Austria	ES	Spain	MG	Madagascar
AU	Australia	FI	Finland	ML	Mali
BB	Barbados	FR	France	MN	Mongolia
BE	Belgium	GA	Gabon	MR	Mauritania
BF	Burkina Faso	GB	United Kingdom	MW	Malawi
BG	Bulgaria	GN	Guinea	NL	Netherlands
BJ	Benin	GR	Greece	NO	Norway
BR	Brazil	HU	Hungary	PL	Poland
CA	Canada	IT	Italy	RO	Romania
CF	Central African Republic	JP	Japan	SD	Sudan
CG	Congo	KP	Democratic People's Republic of Korea	SE	Sweden
CH	Switzerland	KR	Republic of Korea	SN	Senegal
CI	Côte d'Ivoire	LI	Liechtenstein	SU ⁺	Soviet Union
CM	Cameroon	LK	Sri Lanka	TD	Chad
CS	Czechoslovakia	LU	Luxembourg	TG	Togo
DE*	Germany	MC	Monaco	US	United States of America
DK	Denmark				

+ Any designation of "SU" has effect in the Russian Federation. It is not yet known whether any such designation has effect in other States of the former Soviet Union.

Reversible Magazine Catch Assembly
And Method of Making The Same

5

BACKGROUND OF THE INVENTION

10 1. Field of the Invention

The present invention relates to firearms and, more particularly, to a magazine catch assembly for use in a firearm.

15

2. Prior Art

In the past, automatic and semi-automatic firearms have been used with removable cartridge magazines. These magazines are temporarily connected to the frame of the firearm by a catch assembly. The catch assembly usually has a button that is depressed or moved to release the magazine from the firearm. U.S. Patent 984,519 to Browning discloses a transversely mounted magazine catch with a projecting lug that prevents its housing from turning and a spiral spring and piston. U.S. patent 4,326,353 to Ludwig et al. discloses a magazine catch release operable from both sides of a pistol. Other U.S. Patents that disclose magazine catches include U.S. Patents 2,139,203; 4,031,648; and 30 4,420,899. Reversible magazine catches that can be reversed

for use with either a right or left handed user are also known to exist in the prior art.

5 A problem exists with the prior art in that no adequate reversible magazine catch has been provided that is relatively easy to manufacture and assemble, and does not easily disassemble when removed from the frame of the firearm.

10 It is therefore an objective of the present invention to overcome problems in the prior art as well as provide additional features and advantages.

SUMMARY OF THE INVENTION

15 The foregoing problems are overcome and other advantages are provided by a new and improved magazine catch assembly and method of manufacturing the same.

20 In accordance with one embodiment of the present invention, a magazine catch assembly is provided comprising a housing, a mounting pin, and a coiled spring. The housing has a pin hole, a spring channel generally perpendicular to and intersecting the pin hole, and a magazine locking rib. The
25 spring channel is formed from at least three interconnected holes transverse to a path of the channel. The mounting pin is movably located in the pin channel for movement in two perpendicular paths. The coiled spring is located in the spring channel with a first end adjacent a portion of the
30 housing and a second end adjacent the pin. The spring channel provides lateral support for the spring. The spring is adapted to friction hold the pin relative to the housing,

but the housing and pin can be moved relative to each other without substantial risk of disassembly of the assembly.

5 In accordance with one method of the present invention, a method of manufacturing a magazine catch assembly for use in a firearm is provided. The method comprises steps of forming a push button housing with a spring channel and a mounting pin channel transverse to the spring channel. The spring channel is comprised of at least three interconnected
10 holes. The method further comprises inserted a coiled spring in the spring channel, and inserting a mounting pin into the mounting pin channel with the coiled spring thereagainst wherein the mounting pin is adapted to move in the pin channel in two paths.

15 In accordance with another embodiment of the present invention, a firearm having a frame with a magazine receptacle, a barrel, a slide, a firing mechanism, and a reversible magazine catch assembly is provided. The magazine catch assembly comprises a button housing, a coiled
20 spring, a mounting pin, and means for preventing the spring from inadvertently being pushed out of the button housing. The button housing has a first channel, a transverse second channel, and a magazine locking section. The coiled spring is located in the first channel. The mounting pin is movably mounted in the second channel with the spring
25 thereagainst. The pin has a first ledge on a first end and a second ledge on a second end. The ledges are generally angularly offset from each other about a center axis of the pin to prevent the pin from being inadvertently pushed out
30 of the second channel.

BRIEF DESCRIPTION OF THE DRAWINGS

The foregoing aspects and other features of the invention are explained in the following description, taken in connection with the accompanying drawings, wherein:

5 Fig. 1 is a partial plan side view of the rear of a pistol incorporating features of the present invention.

10 Fig. 2 is an exploded perspective view of a reversible magazine catch assembly incorporating features of the present invention.

15 Fig. 3 is a perspective view of the pin of the assembly shown in Fig. 2.

Fig. 4 is a plan perspective top view of the housing shown in Fig. 2.

20 Fig. 5 is a cross sectional view of the assembly shown in Fig. 2.

Fig. 6 is a cross sectional view of the assembly shown in Fig. 5 taken along line 6--6.

25 Fig. 7 is a cross sectional view of the assembly shown in Fig. 5 taken along line 7-7.

DETAILED DESCRIPTION OF THE INVENTION

30

Referring to Fig. 1, there is shown a partial plan side view of the rear end of a semi-automatic pistol 10 having a

reversible magazine catch assembly 32 incorporating features of the present invention. Although the present invention will be described with reference to the embodiment shown in the drawings, it should be understood that the present invention can be incorporated into different types of embodiments and may be used with different types of firearms and in conjunction with different features of a firearm. In addition, any suitable size, shape and type of elements or materials could be used.

The pistol 10 generally comprises a frame 12, a slide 14, a barrel 16 under the slide, and a firing mechanism 18 in the frame. The pistol 10 is similar to a pistol disclosed in U.S. patent application serial number 447,601 filed December 8, 1989 which hereby is incorporated by reference in its entirety. The frame 12 may be comprised of any suitable material such as metal or plastic. In the embodiment shown, the frame 12 has a top section 20 on which the slide 14 can slide. The frame 12 also forms a pistol grip section 22. The pistol grip section 22 may be comprised of a portion of the frame 12 and removable pistol grip sides made of wood or any suitable material. Alternatively, such as when the frame 12 is made of plastic, the pistol grip section can be a unitary section. The pistol grip section 22 comprises an interior magazine channel or receptacle 24 which is adapted to removably receive cartridge magazine 26. The magazine receptacle 24 extends the length of the pistol grip section 22 from its bottom 28 up to the top section 20 of the frame 12. The pistol grip section 22 also comprises a button hole 30 that transversely extends through the pistol grip section 22 between its two sides and partially intersects the magazine receptacle 24. Removably mounted in the hole 30 is a reversible magazine catch assembly 32. In the embodiment

shown, the pistol grip section 22 also comprises a retaining pin hole 34 that transversely extends from the middle of the hole 30 to an opening 36 under the trigger guard 38.

5 Referring now also to Figs. 2-7, the catch assembly 32 will be described. The catch assembly 32 generally comprises a button housing 40, a retaining pin 42, and a coiled spring 44. The housing 40 is made of a suitable material such as metal or plastic and generally comprises a first end 46, a
10 second end 48, a U-shaped recess 50 with a keying portion or locking rib 52, spring channel 54, and a pin hole 56. As can be seen, in the embodiment shown, the housing 40 has a general circular side profile. The two ends 46 and 48 are intended to be positioned at the opposite openings to the
15 hole 30. The first end 46 is intended to be the push button side of the assembly 32 as will further be understood below. The keying portion or locking rib 52 comprises a portion of the housing 40 being cut away such that the locking rib 52 can be inserted into a notch in the front side of the
20 cartridge magazine 26. The cartridge magazine 26 has two locking rib openings in its front, one on each side such that the magazine 26 can be used with the pistol 10 with the catch assembly 32 being in either of its right or left handed configuration. The U-shaped recess 50 is
25 substantially the same size and shape of the front end of the cartridge magazine 26, or at least is suitably sized and shaped to allow the cartridge magazine 26 to be positioned in the magazine receptacle 24 with a portion of the magazine 26 being located in the U-shaped recess 50.

30

The spring channel 54, in the embodiment shown, is comprised of three parallel holes 58, 59, and 60 that have been drilled into the housing 40 perpendicular to the path of the

spring channel 54. The first and third holes 58 and 60, in the embodiment shown, are blind holes that extend into the housing 40 in a first direction. The second hole 59, in the embodiment shown, is also a blind hole located between the first and second holes 58 and 60 and extending into the housing 40 in a direction opposite the first and second holes 58 and 60. However, any suitable angles or orientations of the holes, and any suitable number of holes, may be provided to establish the spring channel.

The pin hole 56, in the embodiment shown, extends all the way through the housing 40 from a first side inside the U-shaped recess 50 to the opposite second side. The pin hole 56 transversely intersects the spring channel 54 at an end of the spring channel approximate the third hole 60 and has an irregular shaped opening approximate the U-shaped recess 50. The irregular opening 62 has a length longer than the width of the pin 42 with a curve side on one end, a width substantially the same height as the pin 42, and a depth shorter than the length of the pin 42.

The retaining pin 42 is made of a suitable material such as metal or plastic and comprises a first end 64, a second end 66, a first ledge 68 located at the first end 64, and a second ledge 70 located at the second end 66. In the embodiment shown, a side 72 from which the second ledge 70 extends is substantially flat. In the embodiment shown, the two ledges 68 and 70 are angularly offset relative to each other along the center axis of the pin 42 approximately 90° . The side 74 from which the first ledge 68 extends has one end 78 of the coiled spring 44 positioned thereagainst. The side 74 is relatively uniformly curved, but in an alternate embodiment of the present invention, the pin 42 may include

dimples 76 that cooperate with the end of the spring 44 to act as positive detents in positioning the pin 42 relative to the spring 44. In the embodiment shown, the height of the pin 42 measured from side 72 to its opposite side is substantially the same as the width of the hole 56. The flat side 72 is positioned adjacent a flat side of the pin hole 56 such that the pin 42 is prevented from axially rotating relative to the housing 40.

The spring 44 is generally comprised of an elongate coiled member made of a suitable material such as metal with a general tubular or column shape. The spring 44 has a first end 78 positioned adjacent the pin side 74 and a second end 80 positioned adjacent the housing 40 in the first hole 58. The spring 44 is located in the spring channel 54 and slightly compressed between its two ends 78 and 80. Thus, the spring 44 biases the pin 42 against the curved wall inside the pin hole 56. Due to the unique configuration of the spring channel 54 being formed from three parallel holes drilled into the housing 40, the spring channel 54 has lateral support on all sides without having to drill through the first or second ends 46 and 48 of the housing, thus preserving a clean uniform surface at the ends 46 and 48 while nonetheless providing appropriate lateral support for the spring 44 in the spring channel 54.

In order to assemble the magazine catch assembly 32, the pin 42 is first inserted into the housing 40 via the pin hole 56. The first end 64 of the pin 42 must first be inserted through the pin hole 56. The movement of the pin 42 through the housing 40 will be stopped when the second ledge 70 contacts the housing 40. The spring 44 can then be inserted and compressed into the spring channel 54 and positioned

below the first ledge 68 and released onto the second side 74 of the pin 42. This completes assembly of the catch assembly 32. With the catch assembly 32 assembled, the pin 42 is movable in two separate paths which are perpendicular to each other. The first path is a path along the pin's longitudinal axis. The second path is perpendicular to the pin's longitudinal axis and parallel to the center axis of the spring channel 54.

The movement of the pin 42 in its first path is for removably mounting the assembly 32 to the frame 12 in hole 30. In order to insert the assembly 32 into the hole 30, the pin 42 is positioned at a first position relative to the housing 40 wherein the first end 64 of the pin 42 projects in the recess 50, the curved wall 63 in the pin hole 56 has the wall 75 of the pin 42 thereagainst, and the side profile of the assembly 32 is circular without the pin 42 being seen projecting out from that profile. The assembly 32 can thus be inserted into the hole 30. Once positioned in the hole 30, with the pin 42 aligned with the pin hole 34, the assembler can insert his finger up the open magazine cavity 24 and push on the first end 64 of the pin to move the pin 42 along its first path into the pin hole 34. The advancement of the pin 42 is stopped when the second ledge 70 contacts the spring 44. The pin 42 is thus positioned in its second position relative to the housing 40 as shown in Figs. 5 and 7. With the pin 42 in its second position relative to the housing 40 and projecting into pin hole 34, the pin 42 prevents the housing 40 from axially rotating inside the assembly hole 30. In addition, because the housing 40 and pin 42 are biased against each other with the pin 42 in its first path, the pin 42 positions the housing 40 in a home longitudinal position in the assembly hole 30.

In this home position, the locking rib 52 projects into the magazine cavity 24 such that it can operably engage a magazine. No other additional steps to mount the assembly 32 in the frame 12 are necessary.

5

10

15

20

25

30

The use and operation of the assembly 32 is a push button type of action. When a user loads a magazine into the magazine receptacle 24, a top edge of the magazine 26 contacts the housing 40 inside the cavity 24 and automatically cams or wedges the housing 40 in a direction towards its second side 48. Because the length of the pin hole 56 is longer than the width of the pin 42, the pin 42 remains stationary relative to the frame 12 and the housing 40 can move relative to the pin 42 with the pin 42 laterally sliding in the pin hole 56 along its second path. The spring 44 merely compresses during this relative movement. The leading edge of the magazine 26 is thus able to pass beyond the assembly 32. The magazine 26 stops when the locking rib 52 comes into registry with the locking hole in the front of the magazine, at which point, because the magazine 26 no longer cams against the housing 40, the spring 44 biases the housing 40 back to its home position with the locking rib 52 moving into the locking hole of the magazine 26. The magazine 26 is thus connected to the frame 12 and cannot be removed unless the housing 40 is intentionally moved by the user to move the locking rib 52 out of the magazine locking hole. This intentional disconnection is accomplished by the user merely pushing on the housing first end 46 which, in turn, laterally moves the housing 40 in the hole 30 with the pin 42 sliding in the pin hole 56. Release of the pressure on the housing first end 46 results in the spring 44 returning the housing 40 back to its home position.

As noted above, the assembly 32, in the embodiment shown, is a reversible assembly intended to be used with either a right handed or left handed user. Thus, the housing first side 46, that is intended to be depressed by the user, can be positioned on either the right or left side of the pistol 10. Ordinarily, the pistol 10 would be shipped from the manufacturer with the housing first side 46 located on the right side of the pistol 10. In order to reconfigure the pistol for a left handed shooter, or for cleaning or repair, a tool such as a thin rod would be positioned through the pin hole aperture 36, into the pin hole 34, and against the second end 66 of the pin 42. By pushing on the second end 66 of the pin 42 with the tool, the pin 42 can be moved along its first path back to its first position. The contact of the second ledge ⁷⁰ with the housing 40 prevents the pin 42 from being pushed out of the housing 40. With the pin 42 out of the pin hole 34, the assembly 32 can be laterally removed from the frame 12. After cleaning, repair, or reversal, the assembly 32 can be reinserted into the frame 12 and reconnected therewith. When removed from the frame 12, the dual ledge configuration of the pin 42 and the laterally supported or keyed configuration of the housing 40 that establishes the spring channel 54 cooperate to prevent the assembly from becoming inadvertently disassembled.

BT
12-14-90
P3
12-14-90

Let it be understood that the foregoing description is only illustrative of the invention. Various alternatives and modifications can be devised by those skilled in the art without departing from the spirit of the invention. Accordingly, the present invention is intended to embrace all such alternatives, modifications and variances which fall within the scope of the appended claims.

CLAIMS

What is claimed is:

- 1 1. A magazine catch assembly comprising:
- 2 a housing having a pin hole, a spring channel generally
- 3 perpendicular to and intersecting said pin hole, and a
- 4 magazine locking rib, said spring channel being formed
- 5 from at least three interconnected holes transverse to
- 6 a path of said channel;
- 7 a mounting pin movably located in said pin channel in
- 8 two perpendicular paths; and
- 9 a coiled spring located in said spring channel with a
- 10 first end adjacent a portion of said housing and a
- 11 second end adjacent said pin wherein said spring
- 12 channel provides lateral support for said spring, said
- 13 spring is adapted to friction hold said pin relative to
- 14 said housing, and said housing and pin can be moved
- 15 relative to each other without substantial risk of
- 16 disassembly of the assembly.
- 1 2. An assembly as in Claim 1 wherein said
- 2 interconnected holes that form said spring channel are blind
- 3 holes.
- 1 3. An assembly as in Claim 2 wherein at least two of
- 2 said interconnected holes that form said spring channel are
- 3 in different directions into said housing.

1 4. An assembly as in Claim 3 wherein said
2 interconnected holes comprise two holes in one direction
3 into said housing and one hole between said two holes in a
4 different direction into said housing.

1 5. An assembly as in Claim 1 wherein said pin has two
2 ledges on opposite ends thereof to prevent said pin from
3 being pushed through said housing.

1 6. An assembly as in Claim 5 wherein one of said
2 ledges is adapted to contact said spring and one of said
3 ledges is adapted to contact said housing.

1 7. An assembly as in Claim 6 wherein said ledges are
2 oriented about 90 degrees offset from each other about a
3 center axis of said pin.

1 8. A method of manufacturing a magazine catch
2 assembly for use in a firearm, the method comprising steps
3 of:

4 forming a push button housing with a spring channel and
5 a mounting pin channel transverse to the spring
6 channel, the spring channel being comprised of at least
7 three interconnected holes;

8 inserting a coiled spring in the spring channel; and

9 inserting a mounting pin into the mounting pin channel
10 with the coiled spring thereagainst wherein the
11 mounting pin is adapted to move in the pin channel in
12 two paths.

1 9. A method as in Claim 8 wherein the steps of
2 forming the housing includes drilling the three holes into
3 the housing parallel to each other to form the spring
4 channel.

1 10. A method as in Claim 9 wherein the step of forming
2 the housing includes drilling a center hole in one direction
3 and two holes on opposite sides of the center hole in an
4 opposite direction to form the spring channel.

1 11. A firearm having a frame with a magazine
2 receptacle, a barrel, a slide, a firing mechanism, and a
3 reversible magazine catch assembly, the catch assembly
4 comprising:

5 a button housing having a first channel, a transverse
6 second channel, and a magazine locking section;

7 a coiled spring located in said first channel;

8 a mounting pin movably mounted in said second channel
9 with said spring thereagainst, said pin having a first
10 ledge on a first end and a second ledge on a second
11 end, said ledges being generally angularly offset from
12 each other about a center axis of said pin to prevent
13 said pin from being inadvertently pushed out of said
14 second channel; and

15 means for preventing said spring from inadvertently
16 being pushed out of said first channel.

1 12. A firearm as in Claim 11 wherein said pin is
2 movably mounted in said second channel in a first path

3 between a first recessed position wherein said pin does not
4 project past of a profile of said housing, and a second
5 extended position.

1 13. A firearm as in Claim 12 wherein the firearm frame
2 has a catch assembly chamber suitably sized and shaped to
3 receive said housing therein and a pin hole adapted to
4 receive a portion of said pin in its extended position and
5 thereby mount the assembly in the frame.

1 14. A firearm as in Claim 13 wherein said housing is
2 laterally movable in said chamber, with said pin in said pin
3 hole, to a magazine release position to move said magazine
4 locking section, but said pin prevents said housing from
5 being pushed out of said chamber and said spring is adapted
6 to move said housing back to a magazine retention position.

1 15. A firearm as in Claim 11 wherein said means for
2 preventing includes said first channel being comprised of
3 three interconnected holes.

1 16. A firearm as in Claim 15 wherein at least one of
2 said holes is a blind hole.

1 17. A firearm as in Claim 15 wherein said holes are
2 parallel to each other.

1 18. A firearm as in Claim 17 wherein said holes
2 comprise at least one hole in one direction and at least one
3 hole in a second direction.

FIG. 1.

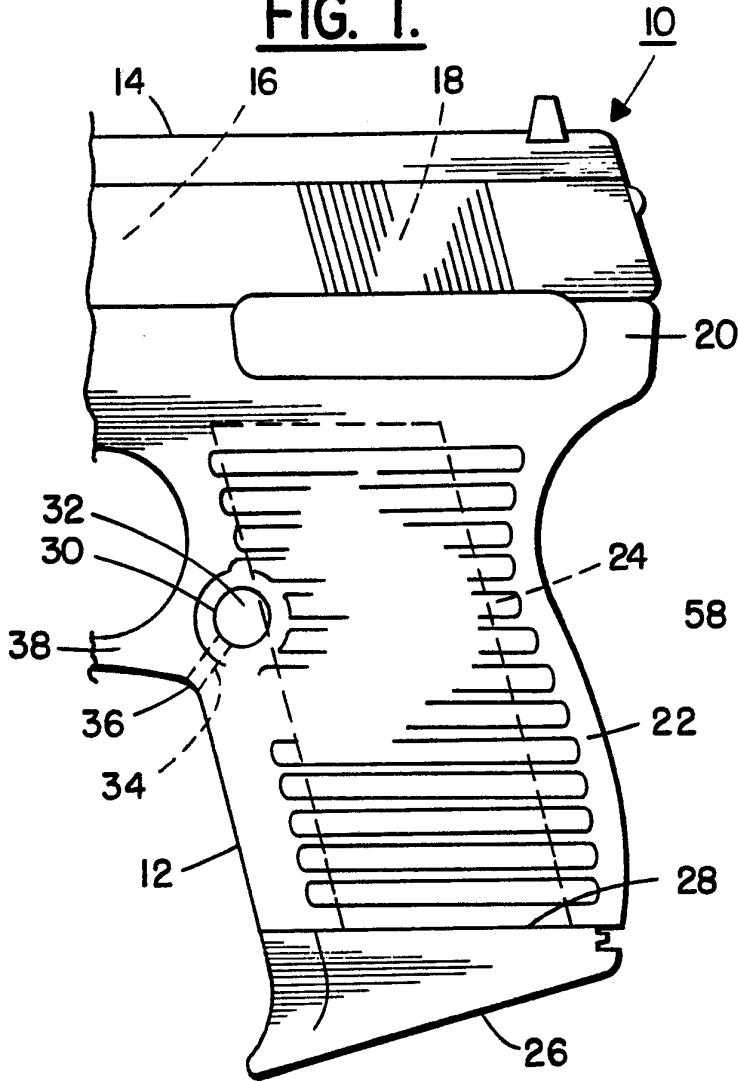

FIG. 4.

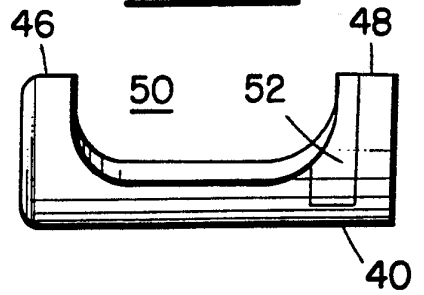

FIG. 5.

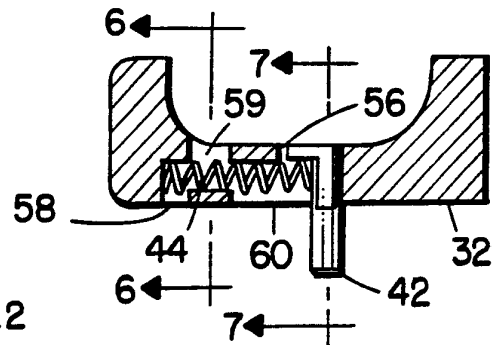

FIG. 6.

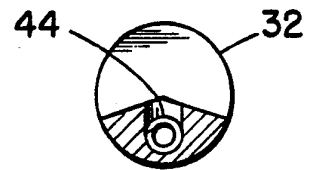

FIG. 7.

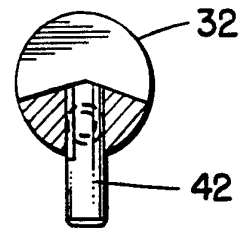

FIG. 2.

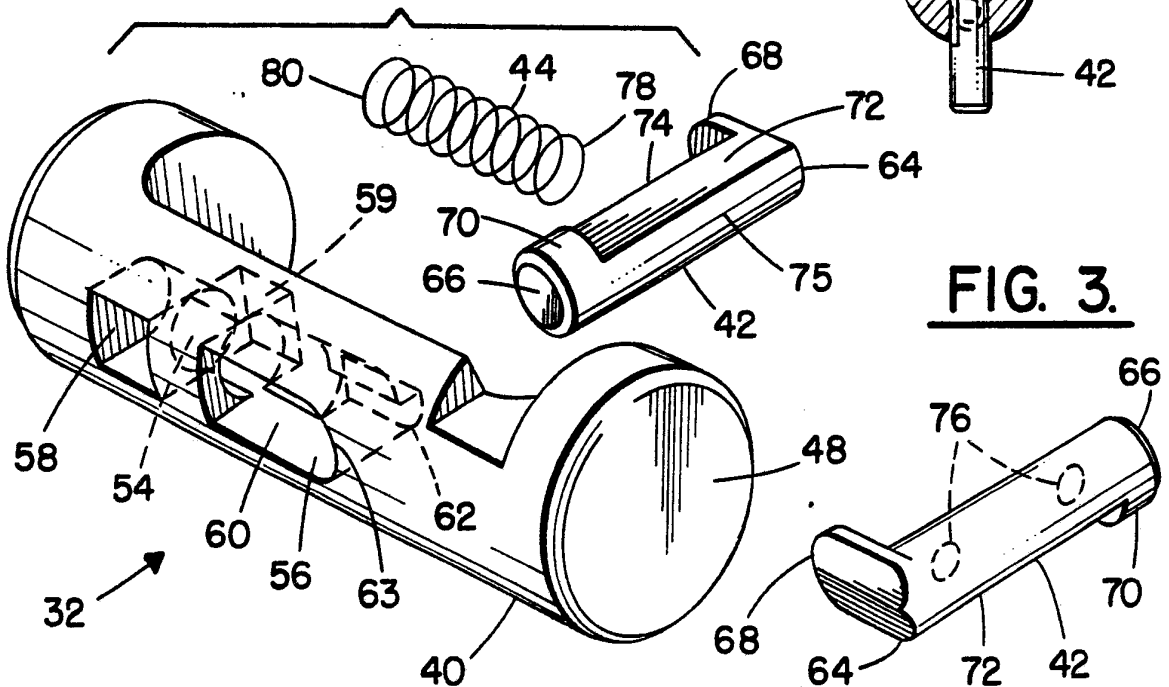
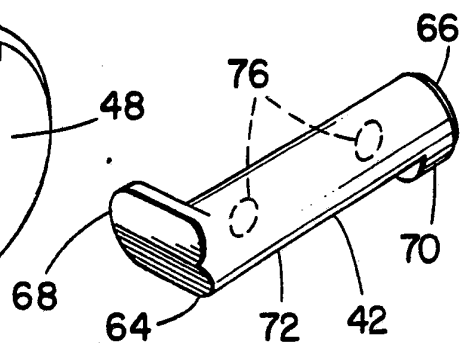
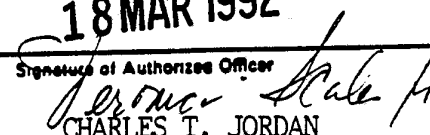

FIG. 3.



INTERNATIONAL SEARCH REPORT

International Application No. PCT/US91/08192

I. CLASSIFICATION OF SUBJECT MATTER (if several classification symbols apply, indicate all) ⁶		
According to International Patent Classification (IPC) or to both National Classification and IPC		
IPC(5): F41A 9/61		
US CL : 42/7		
II. FIELDS SEARCHED		
Minimum Documentation Searched ⁷		
Classification System	Classification Symbols	
U.S.	42/7	
Documentation Searched other than Minimum Documentation to the Extent that such Documents are included in the Fields Searched ⁸		
III. DOCUMENTS CONSIDERED TO BE RELEVANT ⁹		
Category ¹⁰	Citation of Document, ¹¹ with indication, where appropriate, of the relevant passages ¹²	Relevant to Claim No. ¹³
A	US, A, 984,519 (BROWNING) 14 FEBRUARY 1911	1-20
A	US, A, 1,397,109 (PEDERSEN) 15 NOVEMBER 1921	1-20
A	US, A, 2,139,203 (PETTER) 06 DECEMBER 1938	1-20
A	US, A, 4,031,648 (THOMAS) 28 JUNE 1977	1-20
A	US, A, 4,236,337 (BERETTA) 02 DECEMBER 1980	1-20
A	US, A, 4,245,418 (KENNEDY) 20 JANUARY 1981	1-20
A	US, A, 4,326,353 (LUDWIG ET AL.) 27 APRIL 1982	1-20
A	US, A, 4,420,899 (BOURLET ET AL.) 20 DECEMBER 1983	1-20
A	US, A, 4,449,311 (GIRAGOSIAN) 22 MAY 1984	1-20
A	US, A, 4,521,985 (SMITH ET AL.) 11 JUNE 1985	1-20
A	US, A, 4,539,770 (BORNANCINI) 10 SEPTEMBER 1985	1-20
<p>¹⁰ Special categories of cited documents: ¹⁰</p> <p>"A" document defining the general state of the art which is not considered to be of particular relevance</p> <p>"E" earlier document but published on or after the international filing date</p> <p>"L" document which may throw doubts on priority claim(s) or which is cited to establish the publication date of another citation or other special reason (as specified)</p> <p>"O" document referring to an oral disclosure, use, exhibition or other means</p> <p>"P" document published prior to the international filing date but later than the priority date claimed</p> <p>"T" later document published after the international filing date or priority date and not in conflict with the application but cited to understand the principle or theory underlying the invention</p> <p>"X" document of particular relevance: the claimed invention cannot be considered novel or cannot be considered to involve an inventive step</p> <p>"Y" document of particular relevance: the claimed invention cannot be considered to involve an inventive step when the document is combined with one or more other such documents, such combination being obvious to a person skilled in the art.</p> <p>"&" document member of the same patent family</p>		
IV. CERTIFICATION		
Date of the Actual Completion of the International Search	Date of Mailing of this International Search Report	
26 FEBRUARY 1992	18 MAR 1992	
International Searching Authority	Signature of Authorizing Officer	
ISA/US	 CHARLES T. JORDAN	

III. DOCUMENTS CONSIDERED TO BE RELEVANT (CONTINUED FROM THE SECOND SHEET)		
Category *	Citation of Document, with indication, where appropriate, of the relevant passages	Relevant to Claim No
A	US, A, 4,573,280 (MALHOTRA) 04 MARCH 1986	1-20
A	US, A, 4,599,818 (FEDORA ET AL.) 15 JULY 1986	1-20
A	US, A, 4,768,301 (THOMAS) 06 SEPTEMBER 1988	1-20
A	US, A, 4,899,476 (HINDLE) 13 FEBRUARY 1990	1-20