



Europäisches Patentamt  
European Patent Office  
Office européen des brevets



Publication number:

**0 296 829 A3**

12

## EUROPEAN PATENT APPLICATION

21 Application number: **88305694.7**

51 Int. Cl.<sup>5</sup>: **G11B 17/04**, G11B 17/028,  
G11B 19/12, G11B 19/10

22 Date of filing: **22.06.88**

30 Priority: **30.06.87 JP 163285/87**  
**23.06.87 JP 96259/87 U**

43 Date of publication of application:  
**28.12.88 Bulletin 88/52**

84 Designated Contracting States:  
**AT DE FR GB IT**

68 Date of deferred publication of the search report:  
**26.06.91 Bulletin 91/26**

71 Applicant: **SONY CORPORATION**  
**7-35 Kitashinagawa 6-Chome Shinagawa-ku**  
**Tokyo 141(JP)**

72 Inventor: **Toyoguchi, Tsutomu**  
**c/o Sony Corporation 7-35 Kitashinagawa**  
**6-chome**  
**Shinagawa-ku Tokyo(JP)**

74 Representative: **Ayers, Martyn Lewis Stanley**  
**et al**  
**J.A. KEMP & CO. 14 South Square Gray's Inn**  
**London, WC1R 5EU(GB)**

54 **Disc drive arrangement for CD player and the like capable of loading different size discs.**

57 When a large diameter disc is inserted into the disc drive, diameter sensing probes detect the large diameter and unlock movable disc guides and subsequently induce the guides to separate to levels wherein passage of the large diameter disc is facilitated. The guides are locked in a manner which prevents the same from returning to the positions suited for guiding small diameter discs until such time as the large diameter disc is unloaded from the device.

Lever means mounted in the drive respond to the diameter of the disc loaded and assume configurations relative to the diameter of the loaded disc. The lever means is locked in a configuration suited for small discs until such time as a large disc is introduced. At this time the lever means is unlocked. The means includes means which sense the peripheral edge of the disc and hold the arrangement in a configuration suited for the larger diameter.

**EP 0 296 829 A3**

**FIG. 1**

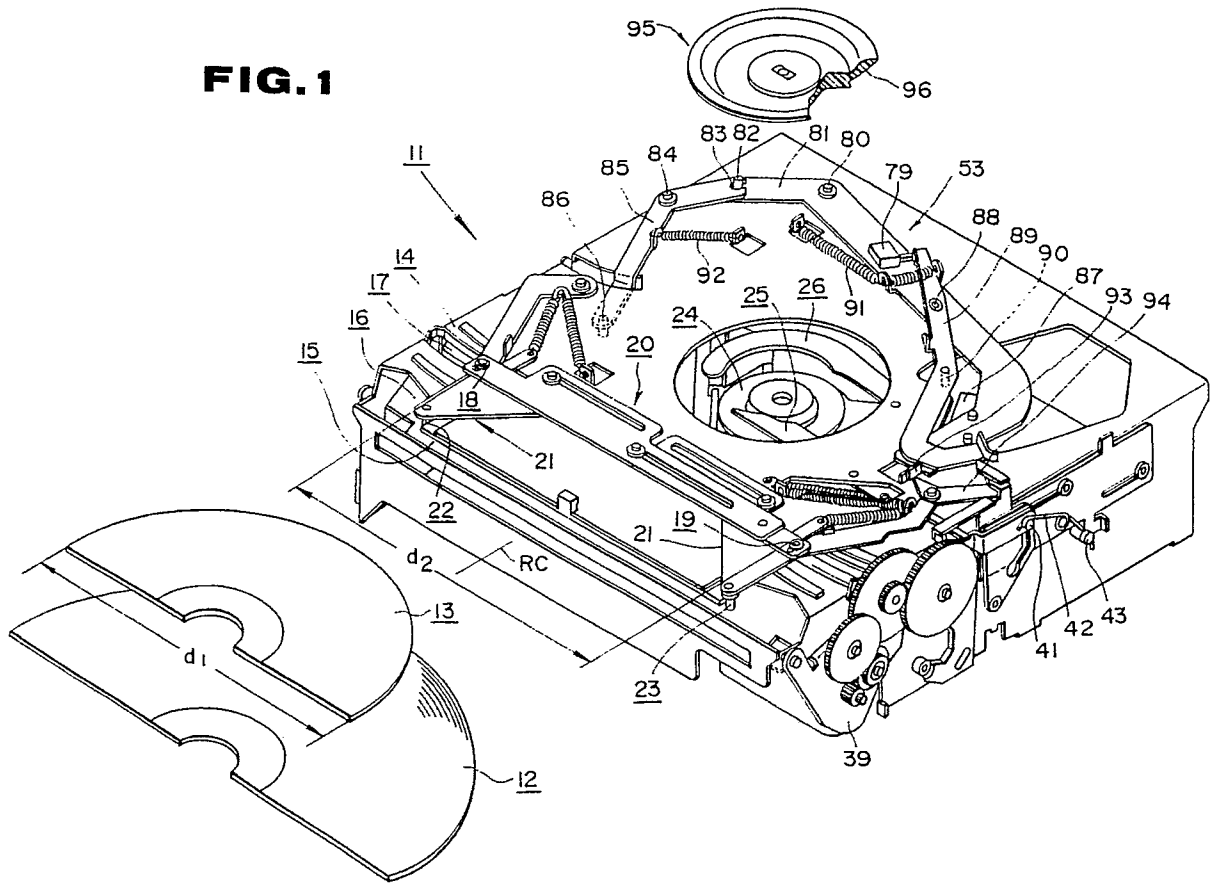



EUROPEAN SEARCH  
REPORT

DOCUMENTS CONSIDERED TO BE RELEVANT			
Category	Citation of document with indication, where appropriate, of relevant passages	Relevant to claim	CLASSIFICATION OF THE APPLICATION (Int. Cl.5)
A	FR-A-2 563 650 (SONY CORPORATION) * the whole document * - - -	1-3	G 11 B 17/04 G 11 B 17/027
A	US-A-4 302 832 (CHEESEBORO) * column 10, line 1 - column 12, line 55; figure 7 * - - -	1	G 11 B 19/12 G 11 B 19/10
A	PATENT ABSTRACTS OF JAPAN vol. 5, no. 185 (P-91)(857) 25 November 1981, & JP-A-56 114163 (PIONEER K.K.) 08 September 1981, * the whole document * - - -	1	
A	DE-A-3 513 040 (PIONEER ELECTRONIC CORP.) - - -		
A	US-A-4 561 085 (FUNABASHI) - - -		
A	US-A-4 523 306 (STAAR) - - -		
A	PATENT ABSTRACTS OF JAPAN vol. 10, no. 127 (P-455)(2184) 13 May 1986, & JP-A-60 251555 (MATSUSHITA DENKI SANGYO K.K.) 12 December 1985, * the whole document * - - - - -		
The present search report has been drawn up for all claims			TECHNICAL FIELDS SEARCHED (Int. Cl.5)
			G 11 B
Place of search	Date of completion of search	Examiner	
The Hague	25 April 91	DEVERGRANNE C.A.	
<b>CATEGORY OF CITED DOCUMENTS</b> X: particularly relevant if taken alone Y: particularly relevant if combined with another document of the same category A: technological background O: non-written disclosure P: intermediate document T: theory or principle underlying the invention		E: earlier patent document, but published on, or after the filing date D: document cited in the application L: document cited for other reasons ----- &: member of the same patent family, corresponding document	