

F. M. STOLL.
FOLDING CAMP STOVE.
APPLICATION FILED JULY 11, 1921.

1,435,346.

Patented Nov. 14, 1922.

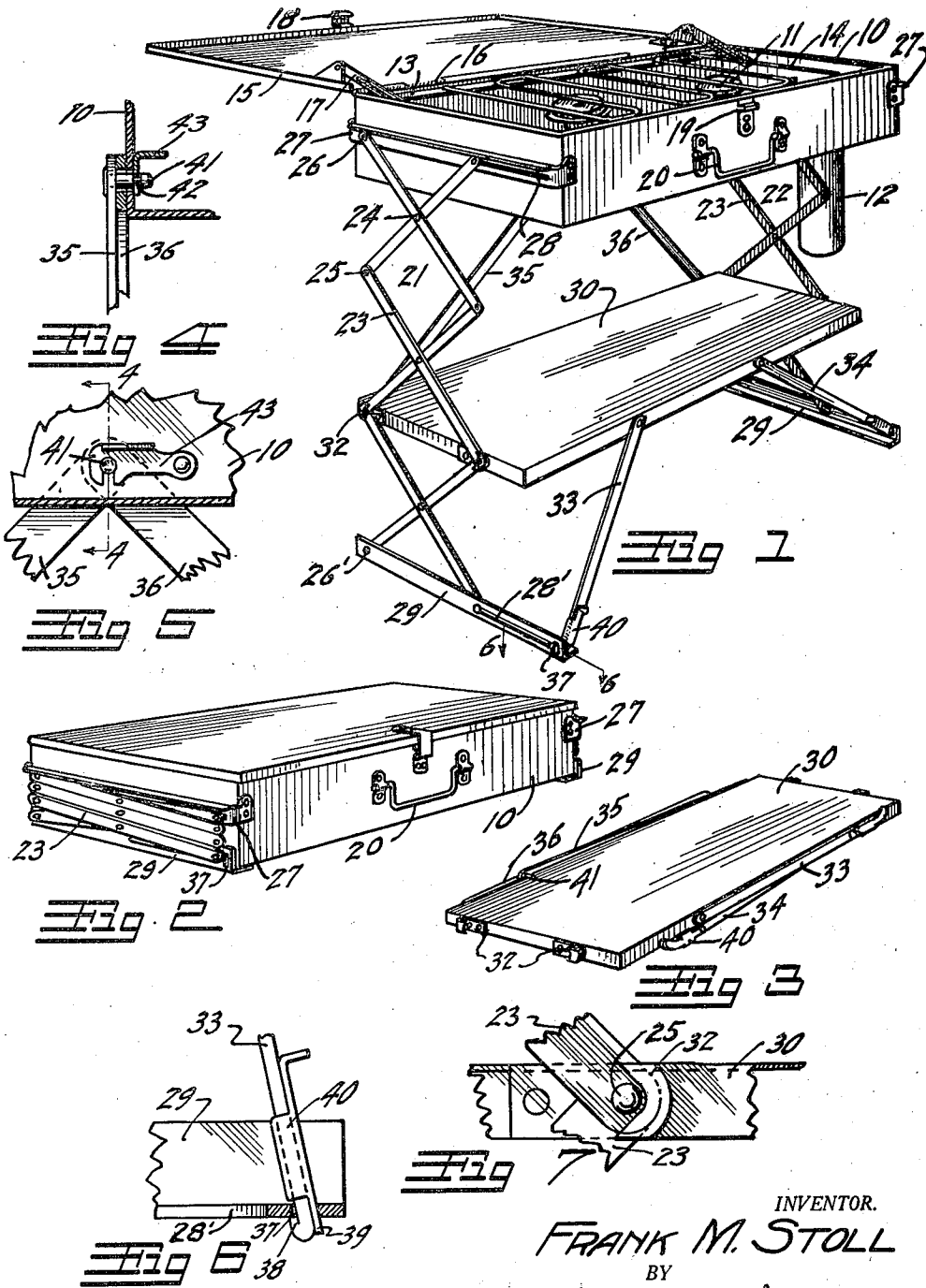

INVENTOR.
FRANK M. STOLL
BY
Frank M. Stoll
ATTORNEY.

UNITED STATES PATENT OFFICE.

FRANK M. STOLL, OF DENVER, COLORADO.

FOLDING CAMP STOVE.

Application filed July 11, 1921. Serial No. 483,867.

To all whom it may concern:

Be it known that I, FRANK M. STOLL, a citizen of the United States, and a resident of the city and county of Denver, State of Colorado, have invented certain new and useful Improvements in Folding Camp Stoves, of which the following is a clear, full, and exact description, such as will enable others skilled in the art to which it appertains to make and use the same, reference being had to the accompanying drawing, and to the figures of reference thereon, which forms a part of this specification.

The invention relates to collapsible camp stoves of the type adapted to use gasoline or other liquid fuel, and has for its object the provision of a case and substantial supporting structure for said stove capable of being folded to occupy a minimum of space when not in use.

Another object of the invention is to provide shelf and table space in connection with said stove.

With these and other objects in view, the invention will now be described in detail with reference to the accompanying drawing.

On the drawing,

Fig. 1 is a perspective view of the invention in its extended position ready for use;

Fig. 2, is a perspective view of the same in its collapsed or folded position ready for carrying or storing;

Fig. 3, is a perspective view of the shelf, shown under the stove proper in Fig. 1, in its folded position;

Fig. 4, is a cross sectional view taken on the line 4—4, Fig. 5;

Fig. 5, is a detail view showing the manner in which the back braces are attached to stove case;

Fig. 6, is detail, sectional view taken on the line 6—6, Fig. 1, showing the manner in which the front braces are attached to the base angles of the supporting structure.

Figure 7, is a detail view showing the manner in which the shelf is attached to the supporting structure.

Corresponding and like parts are referred to in the following description and indicated in all views of the accompanying drawing by the same reference characters.

Let the numeral 10 designate a case in which are arranged burners 11, fed with fuel from a reservoir 12 by means of com-

pressed air. Angles 13 are arranged within said case, upon each side thereof, and support a grill 14, formed of a bent iron rod, over said burners 11. Grill 14 is not fastened to said angles 13 and may be readily lifted from the case 10.

A lid 15 is hinged to case 10, as shown at 16, and is provided with slotted supporting bars 17 which support it in a horizontal position when open, thereby forming a table upon which utensils may be placed while using the stove. Lid 15 is provided with a spring catch 18 which slips over a projection 19 upon case 10, thereby holding the lid in its closed position. Case 10 is provided with a handle 20 by which the device may be carried when folded.

Case 10 is supported at each end thereof by supports 21 and 22 each consisting of a plurality of crossed bars 23, pivotally connected at their points of intersection as shown at 24, and at the meeting terminals of the pairs as shown at 25. One of the upper extremities of the upper pair of bars 23 in supports 21 and 22, is pivoted as shown at 26 to a cross member 27 fastened to each end of case 10, the other upper extremity of the upper pair of bars 23, being slidably mounted in a slot 28 formed in cross members 27.

The lower extremities of the lower pair of bars 23 are similarly attached to a base angle 29 as shown at 26' and 28'. When the supports 21 and 22 are extended, the slidably mounted bars 23 are at the inner ends of slots 28 and 28', when folded, at the outer ends.

Sockets 32 are riveted to each end of shelf 30, and are adapted to fit over the meeting terminals 25 as shown in Fig. 7, thus effectively locking supports 21 and 22 from collapsing and securely supporting the shelf thereon. Shelf 30 is formed of sheet iron or similar substance with the edges turned downward.

The whole structure is braced against end sway by means of two front braces 33 and 34, and two back braces 35 and 36. Front braces 33 and 34 are turned outwardly at their lower extremities to enter slots 37 formed in base angles 29. The tips of braces 33 and 34 are turned back as shown at 38, Fig. 6. Slots 37 are formed just wide enough to admit the braces and tips 38, after they have been passed through the slots as shown in Fig. 6 a tongue 39 formed on a

sliding member 40 is forced in the slot along side of the brace to prevent its removal. The upper extremities of braces 33 and 34 are pivoted to shelf 30.

5 The upper extremity of back brace 36 is pierced by an opening as shown in Fig. 4. The upper extremity of back brace 35 carries a pin 41 adapted to pass through the opening in brace 36 and through a similar opening in the case 10. A peripheral groove 10 42 is formed near the outer extremity of pin 41 and is adapted to be engaged by a slotted lever 43 pivoted upon the inside of case 10, thereby rigidly locking braces 35 and 36.

15 The lower extremities of braces 35 and 36 are pivoted to the shelf 30.

The operation of folding the device is performed as follows: Braces 33, 34, 35 and 36 are detached and folded parallel with the shelf as shown in Fig. 3. Case 10 is then 20 lifted which elongates and contracts supports 21 and 22 and releases them from sockets 32, thereby allowing shelf 30 to be removed. Supports 21 and 22 are collapsed to the position shown in Fig. 2. Grill 14 is 25 removed and reservoir 12 and shelf 30 are placed within case 10, grill 14 replaced and the lid 15 closed. The stove is then ready for carrying or storing as shown in Figure 2.

30 The operation of setting up the device is just the reverse.

No claim is made for burners, reservoir or their connections.

35 Having thus described my invention, what I claim and desire to secure by Letters Patent is:

1. A folding camp stove of the class described, comprising a case; a lid to said case adapted to form a table when open; "lazy 40 tongs" supporting said case and adapted to fold alongside thereof when closed; a shelf supported by and adapted to hold said "lazy tongs" in an extended position; detachable, 45 foldable braces adapted to prevent lateral movement of said "lazy tongs."

2. A folding camp stove, comprising a case, containing burners for use with liquid fuel, having a cover hingedly mounted thereon, said cover adapted to open to a horizontal 50 position forming a table; supports consisting of a plurality of pairs of crossed bars pivotally connected at the points of intersection and at the meeting terminals of the pairs and adapted to fold against said case; 55 a shelf having sockets adapted to fit over opposite meeting terminals of the bars to hold said crossed bars in their extended

position; detachable braces arranged to prevent endwise movement of said camp stove.

3. A folding camp stove, comprising a 60 case and hinged cover therefor, said case adapted to contain burners for liquid fuel; supports at each end of said case in the form of a "lazy tongs," one upper extremity of each "lazy tongs" being pivoted to a cross 65 member attached to each end of said case, the opposite upper extremity being adapted to travel in a slot in said cross member; base members pivoted to one extremity of each 70 tongs the opposite extremities being arranged to travel in a slot in said base member; means for preventing said "lazy tongs" from collapsing comprising a shelf removably 75 attached thereto; front braces pivotally mounted on said shelf and extending therefrom to said base members passing through slots therein, said front braces having obstructions thereon to prevent their removal from said slots; tongues or wedges slidably 80 mounted on said front braces adapted to fit into said slots in said base members and cause said obstructions to act; back braces pivotally mounted on said shelf and extending 85 to said case; means for attaching said back braces to said case comprising a pin carried by one of said braces adapted to pass through a hole formed in the other of said braces and said case, a lever pivoted in said case and adapted to engage a peripheral slot 90 formed on said pin; means for attaching said shelf to said "lazy tongs" comprising sockets attached to said shelf and adapted to be passed over the meeting terminals of the pairs of bars in said "lazy tongs."

4. A collapsible camp stove comprising a 95 case; "lazy tongs" mounted on the ends of said case and adapted to act as a support therefor when extended and to fold along side thereof when closed; an L shaped base member on said "lazy tongs" adapted to support same when same are extended and to fold over the edge of and act as reinforcement for said case when said "lazy tongs" are collapsed; means for holding said "lazy 100 tongs" in the extended position comprising a shelf adapted to prevent the joints of said "lazy tongs" from expanding and means for bracing the structure comprising diagonal braces pivoted to said shelf and adapted to be detachably connected to said base member and said case. 110

In testimony whereof I affix my signature.

FRANK M. STOLL.