



(51) International Patent Classification:

B60P 1/54 (2006.01) B66C 23/42 (2006.01)
B66C 23/36 (2006.01) B66C 23/44 (2006.01)

(21) International Application Number:

PCT/US2021/038081

(22) International Filing Date:

18 June 2021 (18.06.2021)

(25) Filing Language:

English

(26) Publication Language:

English

(30) Priority Data:

17/073,950 19 October 2020 (19.10.2020) US
17/335,177 01 June 2021 (01.06.2021) US

(71) Applicant (for MW only): **SANCHELIMA AND ASSOCIATES P.A.** [US/US]; 235 SW Le Jeune Road, Miami, FL 33134 (US).

(72) Inventor; and

(71) Applicant: **LAIDLER, Jason** [CA/CA]; 9921 Old Homestead Rd, Pefferlaw, Ontario, L0E 1N0 (CA).

(74) Agent: **SANCHELIMA, Christian**; 235 SW Le Jeune Road, Miami, FL 33134 (US).

(81) Designated States (unless otherwise indicated, for every kind of national protection available): AE, AG, AL, AM, AO, AT, AU, AZ, BA, BB, BG, BH, BN, BR, BW, BY, BZ, CA, CH, CL, CN, CO, CR, CU, CZ, DE, DJ, DK, DM, DO, DZ, EC, EE, EG, ES, FI, GB, GD, GE, GH, GM, GT, HN, HR, HU, ID, IL, IN, IR, IS, IT, JO, JP, KE, KG, KH, KN, KP, KR, KW, KZ, LA, LC, LK, LR, LS, LU, LY, MA, MD, ME, MG, MK, MN, MW, MX, MY, MZ, NA, NG, NI, NO, NZ, OM, PA, PE, PG, PH, PL, PT, QA, RO, RS, RU, RW, SA, SC, SD, SE, SG, SK, SL, ST, SV, SY, TH, TJ, TM, TN, TR, TT, TZ, UA, UG, US, UZ, VC, VN, WS, ZA, ZM, ZW.

(84) Designated States (unless otherwise indicated, for every kind of regional protection available): ARIPO (BW, GH,

(54) Title: SYSTEM FOR A VEHICLE WITH A DETACHABLE HOIST WITH A REINFORCED ARM

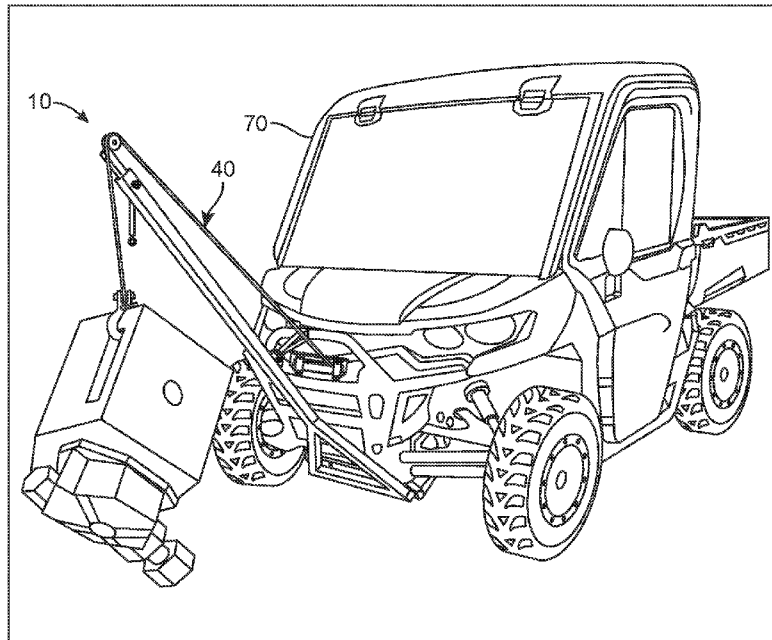

FIG. 1

(57) Abstract: A lifting system for a vehicle including a powered winch, a telescopic hoist, jib, or arm and an attachment means on the vehicle for allowing the hoist arm to be pivotally adjusted. The attachment means is provided as a mounting plate which is mounted beneath the vehicle. The mounting plate includes receiving sections that receive a bottom distal end of the telescopic hoist arm. The hoist arm then upwardly extends from the bottom of the mounting plate and is supported to the vehicle using turn buckles. The hoist arm includes an inner arm having a reinforced spine member. Furthermore, the winch is provided as an integral part of the vehicle which is then fed through to the hoist arm and received by a pulley member located on a distal top end of the hoist arm.



WO 2022/086601 A1

GM, KE, LR, LS, MW, MZ, NA, RW, SD, SL, ST, SZ, TZ,
UG, ZM, ZW), Eurasian (AM, AZ, BY, KG, KZ, RU, TJ,
TM), European (AL, AT, BE, BG, CH, CY, CZ, DE, DK,
EE, ES, FI, FR, GB, GR, HR, HU, IE, IS, IT, LT, LU, LV,
MC, MK, MT, NL, NO, PL, PT, RO, RS, SE, SI, SK, SM,
TR), OAPI (BF, BJ, CF, CG, CI, CM, GA, GN, GQ, GW,
KM, ML, MR, NE, SN, TD, TG).

Declarations under Rule 4.17:

— *of inventorship (Rule 4.17(iv))*

Published:

— *with international search report (Art. 21(3))*

I. TITLE: *SYSTEM FOR A VEHICLE WITH A DETACHABLE HOIST WITH A REINFORCED ARM*

II. BACKGROUND OF THE INVENTION

1. Field of the Invention.

[001] The present invention relates to a detachable hoist system and, more particularly, to a system for a vehicle with a detachable hoist that includes a powered winch, a telescopic hoist arm, and an attachment means for securing the telescopic hoist to the vehicle.

2. Description of the Related Art.

[002] Several designs for a detachable hoist for a vehicle have been designed in the past. None of them, however, include a lifting system for a vehicle comprising a powered winch, a telescopic hoist, jib, or arm and an attachment means on the vehicle for allowing the hoist arm to be pivotally adjusted. The attachment means is provided as a mounting plate which is mounted beneath the vehicle. The mounting plate includes receiving sections that receive a bottom distal end of the telescopic hoist arm. The hoist arm then upwardly extends from the bottom of the mounting plate and is supported to the vehicle using straps. Furthermore, the winch is provided as an integral part of the vehicle which is then fed through to the hoist arm and received by a pulley member located on a distal top end of the hoist arm. The winch is then secured to an anchor which is adapted to receive a load to be transported by the lifting system. Additionally, the arm may include a reinforced spine to allow for the arm to lift heavier objects. Also, the arm may also be supported onto the vehicle using turn buckles. It is known that individuals often have the need to transport heavy objects that are located in their yard areas or outdoor environments. The process of transporting these objects can be a difficult and expensive process requiring the need specialized equipment. Therefore, there is a need for a lifting system to allow users to easily maneuver heavy objects without the need of expensive equipment or additional help.

[003] Applicant believes that a related reference corresponds to U.S. patent No. 8,231,325 issued for a deer loader having a winch and an adjustable arm. Applicant believes that another related reference corresponds to U.S. patent No. 7,575,120 issued for a hoist that is demountably secured to a frame of an all-terrain vehicle. However, the cited references differ from the present invention because they fail to disclose a system including a powered winch, a telescopic hoist arm, and an attachment means on the vehicle for allowing the hoist arm to be pivotally adjusted. The references further fail to anticipate or disclose the reinforced spine or the turn buckles for support on the vehicle.

[004] Other documents describing the closest subject matter provide for a number of more or less complicated features that fail to solve the problem in an efficient and economical way. None of these patents suggest the novel features of the present invention.

III. SUMMARY OF THE INVENTION

[005] It is one of the objects of the present invention to provide a lifting system which is readily attachable to a vehicle thereby allowing an individual to transport heavy objects without the need of specialized expensive equipment.

[006] It is another object of this invention to provide a lifting system which features a powered winch thereby providing a user with an effortless means to lift and maneuver heavy objects.

[007] It is still another object of the present invention to provide a lifting system which includes a detachable hoist arm mounted to a bottom plate of a vehicle that is capable of lifting heavy objects having a weight of at least 550 pounds.

[008] It is still another object of the present invention to provide a lifting system which includes a hoist arm having a reinforced spine in order to increase the resistance to weight that is experienced by the arm.

[009] It is yet another object of this invention to provide such a device that is inexpensive to implement and maintain while retaining its effectiveness.

[010] Further objects of the invention will be brought out in the following part of the specification, wherein detailed description is for the purpose of fully disclosing the invention without placing limitations thereon.

IV. BRIEF DESCRIPTION OF THE DRAWINGS

[011] With the above and other related objects in view, the invention consists in the details of construction and combination of parts as will be more fully understood from the following description, when read in conjunction with the accompanying drawings in which:

Figure 1 represents an operational isometric view of lifting system **10** in accordance to an embodiment of the present invention.

Figure 2 shows a front perspective view of attachment assembly **20** and winch assembly **60** mounted on a vehicle **70** in accordance to an embodiment of the present invention.

Figure 3 illustrates a side perspective view of attachment assembly **20** mounted beneath vehicle **70** in accordance to an embodiment of the present invention.

Figure 4 is a representation of an isometric view of hoist arm assembly **40** in accordance to an embodiment of the present invention.

Figure 5 illustrates an enlarged view of inner arm **45** being extended from outer arm **44** and retained by pin and hole mechanism **46** in accordance to an embodiment of the present invention.

Figure 6 shows an enlarged perspective view of base **42** and mounting members **43** of hoist arm assembly **40** in accordance to an embodiment of the present invention.

Figure 7 illustrates an enlarged perspective view of attachment assembly **20** having hoist arm assembly **40** mounted thereon in accordance to an embodiment of the present invention.

Figure 8 represents another enlarged perspective view of attachment assembly **20** having hoist arm assembly **40** mounted thereon in accordance to an embodiment of the present invention.

Figure 9 shows a perspective operational side view of lifting system **10** depicting hoist arm assembly **20** lifting a heavy object in accordance to an embodiment of the present invention.

Figure 10 illustrates an enlarged isometric view of inner arm **45** having a reinforced spine **45A** in accordance with one embodiment of the present invention.

Figure 11 is a representation of an enlarged isometric view depicting turn buckles **49** which supports the hoist arm onto a support frame of the vehicle **70** in accordance with an embodiment of the present invention.

V. DETAILED DESCRIPTION OF THE EMBODIMENTS OF THE INVENTION

[012] Referring now to the drawings, where the present invention is generally referred to with numeral **10**, it can be observed a lifting system **10** attachable to a vehicle **70** which basically includes an attachment assembly **20**, a hoist arm assembly **40**, and a winch assembly **60**.

[013] Attachment assembly **20** includes a plate **22** which may be accurately observed in figures 2 and 3 of the provided drawings. In the present embodiment, plate **22** is provided as a metal attachment plate that is mounted to a vehicle **70** to aid in receiving hoist arm assembly **40**. As observed in figure 4, plate **22** is mounted to a bottom end of vehicle **70** and is further located beneath winch assembly **60**. Plate **22** may be mounted through fasteners which are inserted through the plate and attached to the vehicle **70**. Other embodiments may feature a plate **22** provided as integral to vehicle **70**. In one embodiment, as observed in the figures, vehicle **70** is an all-terrain vehicle having a bumper guard on a front end and specialized tires which allow the vehicle to traverse across harsh terrains. It should be understood that other types of vehicles such as pick-up trucks or cars may be implemented into the present system. Plate **22** includes at least one receiving section **24**. In one implementation, at least two receiving sections **24** are implemented on plate **22**. Figure 2 observes two receiving sections **24** located on opposite side ends of plate **22**. Other embodiments of the present invention may feature more than two receiving sections **24** for plate **22**. However, a preferred embodiment includes two receiving sections **24** to support the hoist arm assembly **40** when mounted thereon. Furthermore, receiving sections **24** are provided as an integral component to the plate and are made of the same metal material that is used for plate **22**.

[014] A clear depiction of receiving section **24** may be observed in figure 3 of the provided drawings. Receiving section **24** includes sidewalls **25** which includes top sidewall, a rear sidewall, and lateral sidewalls. Sidewalls **25** are integrally joined together to form a housing. Furthermore, a receiving member **26** is mounted to the within the housing. In the present embodiment, receiving member **26** is a cylindrical metallic rod structure which is in abutting engagement with lateral sidewalls of the receiving section **24**. In one implementation, lateral sidewalls of sidewalls **25** are provided as being perpendicular to the receiving member. The combination of sidewalls **25** and

receiving member **26** form a slot **27**. Slot **27** will be utilized to receive hoist arm assembly **40** as will be later described in the detailed description. Attachment assembly **20** further includes a support member **28** which extends across receiving sections **24** in the present embodiment of the invention. Figures 2 and 3 observe support member **28** being a metallic rod structure which extend across the plate **22**. In the present embodiment, support member **28** is in abutting engagement with an inner side of the lateral sides of sidewalls **25**. Support member **28** provides structural reinforcement to the integrity of the plate **22** to properly support hoist arm assembly **40** when received therein.

[015] Hoist arm assembly **40** may be properly observed in figure 4 and 5 of the provided drawings. Hoist arm assembly **40** includes a base **42** having a triangular frame with an inner triangular void. In the present embodiment, base **42** is made of a metal material. Base **42** includes a bottom side which includes mounting members **43** which protrude outwardly from the bottom side. It can be observed, that mounting members **43** have several types of shape that are used to be communicable engaged with attachment assembly **20**. In one embodiment, mounting members **43** include a convex or semi-circular shape. Other embodiments may also feature a U-shaped member or scooped member. C-shaped members may also be used for mounting members **43**. It is pertinent to the present invention that mounting members **43** have an arched configuration.

[016] Figures 7 and 8 depict hoist arm assembly **40** being attached to attachment assembly **20**. It can be observed that the mounting members **43** are received by the receiving member **26** and effectively inserted within slot **27** of the attachment assembly. As a result, a secure mounting connection is formed between the hoist arm assembly **40** and the attachment assembly **20**. The combination of the curved structure of mounting members **43** and the cylindrical shape of the receiving member **26** allow for the hoist arm to be pivotally adjusted when mounted to the attachment assembly **20**. This will provide a user with flexibility with regards to the angle at which they desire to hoist the hoist arm.

[017] Hoist arm assembly **40** further includes an outer arm **44** which extends from the pointed end of base **42**. In the present embodiment, outer arm **44** has a rectangular configuration and is made

of a metal material. Outer arm **44** is a hollow structure which includes inner arm **45** translated therein. Inner arm **45** may be translated outwardly from outer arm **44** in order to increase a length of the hoist arm. It should be understood, that inner arm **45** is provided as having a shape which will cooperate with the interior of outer arm **44**. Hoist arm assembly **40** further includes a pin **46** which is inserted within an opening of outer arm **44** and is communicably inserted through inner arm **45**. As a result, a securing means is provided for the inner arm **45** and the outer arm **44**. A user may translate inner arm **45** to a desired length and then insert pin **46** to effectively lock the hoist arm to a desired length. The provided structure forms a telescopic hoist for hoist assembly **40**. The telescopic nature of the hoist arm assembly **40** will allow for a user to more effectively mount and carry heavy objects using the vehicle **70**. In one embodiment, the system **10** is capable of supporting at least 550 pounds of weight. Figure 10 depicts an enlarged view of inner arm **45** in accordance with one embodiment of the invention. It can be observed that inner arm **45** may further include a reinforced spine member **45A** which may extend along a top surface of the inner arm **45**. In one embodiment, reinforced spine member **45A** may be provided as reinforced steel that is welded directly onto a sidewall of the inner arm. It should be understood the reinforced spine member **45A** may extend along the entire length of inner arm **45**. Reinforced spine member **45A** provides added strength to the inner arm in order to allow the hoist assembly to carry more weight.

[018] Hoist arm assembly **40** further includes a strap **47** which is located on a top portion of outer arm **44**. In the present embodiment, strap **47** is attached to the outer arm **44** through hooks that are received in openings of the top portion of the outer arm **44**. Strap **47** may be provided as an adjustable cloth strap and provides further structural support to the hoist arm assembly **40** when coupled to vehicle **70**. In one implementation, observed in figure 9 of the drawings, strap **47** is wrapped around and mounted to a bumper frame located on a front end of vehicle **70**. In the present embodiment, strap **47** will aid in supporting the weight that is being carried by the system **10**. Hoist arm assembly **40** further includes a pulley **48** which is mounted to a top distal end of inner arm **45**. Pulley **48** will be used to support the winch line that will be provided by winch assembly **60**. In the present embodiment, pulley **48** may be mounted using known mechanisms such as fasteners,

welding, and the like. In another embodiment observed in figure 11 of the provided drawings, hoist assembly **40** includes turn buckles **49**. As observed in the drawing, turn buckles **49** is an attachment member having hook attachments along opposing ends. In the present embodiment, hook attachments of a first end are engaged with outer arm **44** of hoist assembly **40**. These hook attachments may be coupled onto screw members that extend outwardly in a perpendicular configuration from the outer arm **44**. Additionally, the hook attachments of the second end are engaged with loop members that are coupled to the bumper frame of vehicle **70**. As a result, a secure engagement is created between the hoist arm assembly **40** and the vehicle **70**.

[019] Winch assembly **60** may be properly observed in figure 2 of the provided drawings. Winch assembly **60** includes a housing **62** which may be provided as an integral component of the vehicle **70**. As observed, housing **62** is located near a bottom end of the vehicle. Having the winch assembly **60** located near the bottom end of the vehicle will aid the system **10** when carrying a load. Winch assembly **60** further includes a winch line **64** which is stored within housing **62**. In one embodiment, winch line **64** is made of a material that is strong enough to support heavy loads of weight. A hook **66** is further attached to the winch line **64**. In one embodiment hook **66** includes a latch that will open and closed to allow for the member to be mounted to a chain or a load to be carried. The winch line **64** is then extended over a top end of the outer arm **44** as observed in figure 9. Winch line **64** is further received by the pulley **48** and then mounted to a chain or a load for carrying. In one implementation, winch assembly **60** is provided as a powered winch that is powered and controlled within vehicle **70**.

[020] The foregoing description conveys the best understanding of the objectives and advantages of the present invention. Different embodiments may be made of the inventive concept of this invention. It is to be understood that all matter disclosed herein is to be interpreted merely as illustrative, and not in a limiting sense.

VI. INDUSTRIAL APPLICABILITY

[021] The system for a vehicle having a detachable hoist has several embodiments for industrial applicability. In one embodiment, the system may be utilized in residential areas in homes that have large areas of land and often require the transportation of heavy objects. The present invention allows for a user to move objects of a heavy weight without the need of expensive industrial equipment. Additionally, the system features a powered winch thereby providing a user with an effortless means to lift and maneuver heavy objects. The lifting system includes a powered winch, a telescopic hoist, jib, or arm and an attachment means on the vehicle for allowing the hoist arm to be pivotally adjusted. The attachment means is provided as a mounting plate which is mounted beneath the vehicle. The mounting plate includes receiving sections that receive a bottom distal end of the telescopic hoist arm. The hoist arm then upwardly extends from the bottom of the mounting plate and is supported to the vehicle using turn buckles. The hoist arm includes an inner arm having a reinforced spine member.

VII. CLAIMS

What is claimed is:

1. A lifting system for a vehicle, comprising:
 - a) an attachment assembly including a plate having receiving sections on opposing sides, wherein said receiving sections each include sidewalls and a receiving member to form a slot;
 - b) a hoist arm assembly including a base and a hoist arm, wherein said hoist arm is a telescopic hoist arm having an outer arm and an inner arm, wherein said inner arm is translated within said outer arm and secured with a pin, wherein said base includes a bottom side end with protruding mounting members, wherein said mounting members are inserted within said receiving sections and received by said receiving member thereby allowing said hoist arm to be pivotally adjusted, wherein said inner arm includes a reinforced spine member positioned along an outer side end; and
 - c) a powered winch assembly including a housing which encloses a winch line having a hook mounted thereon, wherein said winch line extends over a top end of said hoist arm.
2. The lifting system of claim 1 wherein said sidewalls of said receiving section includes a top sidewall, a rear sidewall, and lateral sidewalls.
3. The lifting system of claim 2 wherein said receiving member extends across said lateral sidewalls.
4. The lifting system of claim 1 wherein said attachment assembly includes a support member extending across said plate and communicably mounted to said receiving sections.

5. The lifting system of claim 1 wherein said plate is mounted to a bottom end of a vehicle, said vehicle including a bumper frame.
6. The lifting system of claim 1 wherein said base is a triangular frame with a triangular void.
7. The lifting system of claim 1 wherein said mounting members each have an arched configuration.
8. The lifting system of claim 1 wherein said inner arm further includes a pulley at a topmost distal end.
9. The lifting system of claim 5 wherein said hoist arm assembly further includes a strap coupled to a bumper frame of said vehicle and an outer portion of said outer arm.
10. The lifting system of claim 5 wherein said hoist arm assembly further includes at least two turning buckles coupled to a bumper frame of the vehicle and outer portion of said outer arm.
11. The lifting system of claim 1 wherein said reinforced spine member is welded onto said inner arm.
12. A lifting system for a vehicle, comprising:
 - a) an all-terrain vehicle having a bumper frame;
 - b) an attachment assembly including a plate mounted to a bottom end of said all-terrain vehicle, wherein said plate includes fasteners to mount said plate to said bottom end, wherein said plate includes two receiving sections on opposing sides of said plate each having sidewalls and a receiving member, wherein said sidewalls include a top sidewall, a rear sidewall, and lateral sidewalls, wherein said receiving member is in abutting engagement with said

lateral sidewalls to form a slot, said plate further including a support member which extends between said two receiving sections;

- c) a hoist arm assembly including a base and a hoist arm, wherein said base is a triangular frame with a triangular void, said base further including two mounting members protruding from a bottom edge of said base, said two mounting members having a C-shaped configuration, wherein said two mounting members are received by said two receiving sections, wherein said two mounting members are coupled to each respective receiving member thereby allowing said hoist arm to be pivotally adjustable, said hoist arm including an outer arm and an inner arm translated within said outer arm, said inner arm coupled to said outer arm through a pin, wherein said hoist arm assembly also includes at least two turn buckles coupling said bumper frame and an outer portion of said outer arm, said inner arm also including a pulley at a top most distal end, wherein said inner arm includes a reinforced spine member positioned along an outer side end, wherein said reinforced spine member is welded onto said inner arm; and
- d) a powered winch assembly including a housing within said all-terrain vehicle which encloses a winch line having a hook mounted thereon, wherein said winch line extends over a top end of said hoist arm.

13. A lifting system for a vehicle, consisting of:

- a) an all-terrain vehicle having a bumper frame;
- b) an attachment assembly including a plate mounted to a bottom end of said all-terrain vehicle, wherein said plate includes fasteners to mount said plate to said bottom end, wherein said plate includes two receiving sections on opposing sides of said plate each having sidewalls and a receiving member, wherein said sidewalls include a top sidewall, a rear sidewall, and lateral sidewalls, wherein said receiving member is in abutting engagement with said

lateral sidewalls to form a slot, said plate further including a support member which extends between said two receiving sections;

- c) a hoist arm assembly including a base and a hoist arm, wherein said base is a triangular frame with a triangular void, said base further including two mounting members protruding from a bottom edge of said base, said two mounting members having a C-shaped configuration, wherein said two mounting members are received by said two receiving sections, wherein said two mounting members are coupled to each respective receiving member thereby allowing said hoist arm to be pivotally adjustable, said hoist arm including an outer arm and an inner arm translated within said outer arm, said inner arm coupled to said outer arm through a pin, wherein said hoist arm assembly also includes at least two turn buckles coupling said bumper frame and an outer portion of said outer arm, said inner arm also including a pulley at a top most distal end, wherein said inner arm includes a reinforced spine member positioned along an outer side end, wherein said reinforced spine member is welded onto said inner arm; and
- d) a powered winch assembly including a housing within said all-terrain vehicle which encloses a winch line having a hook mounted thereon, wherein said winch line extends over a top end of said hoist arm.

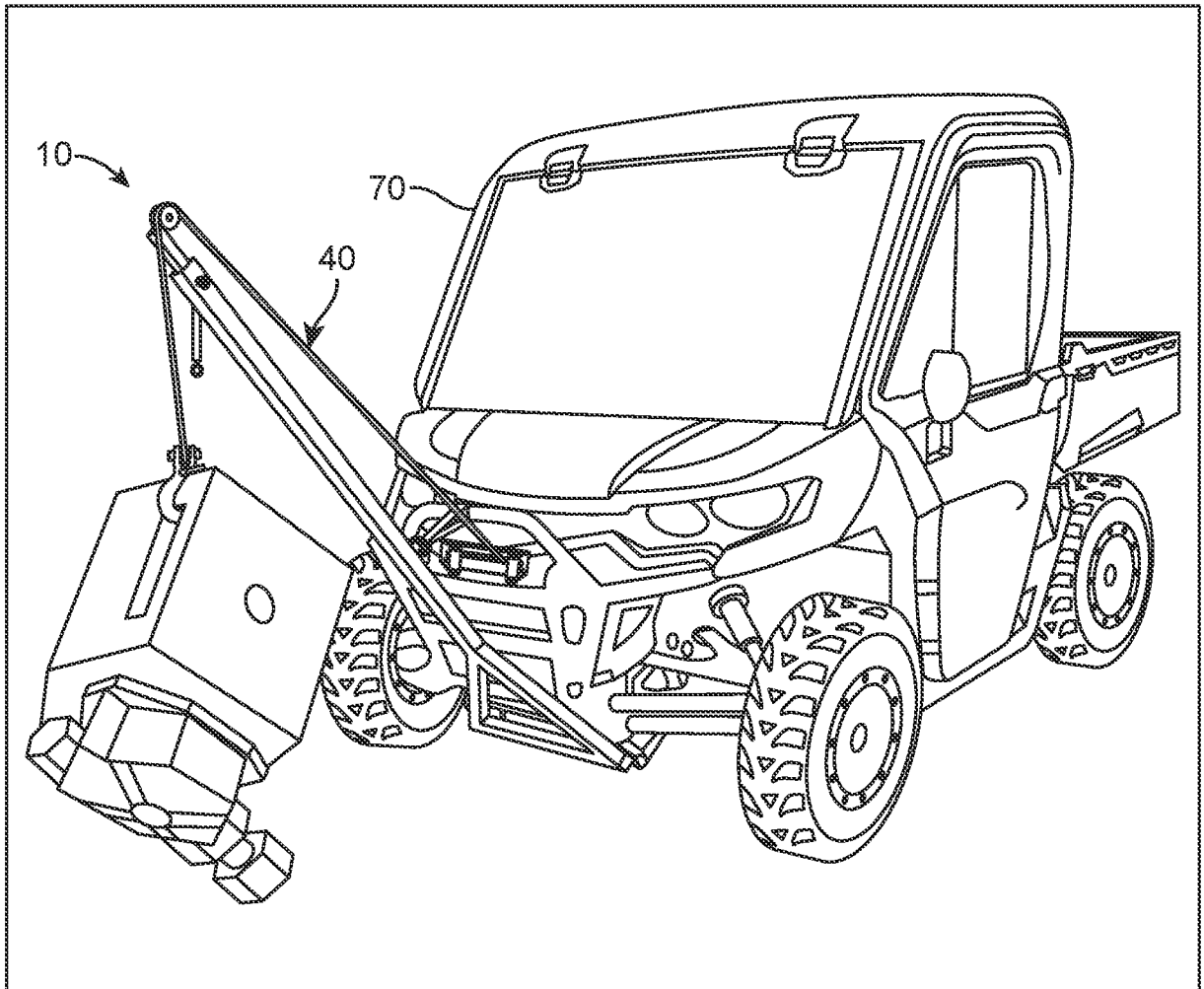

FIG. 1

2 / 8

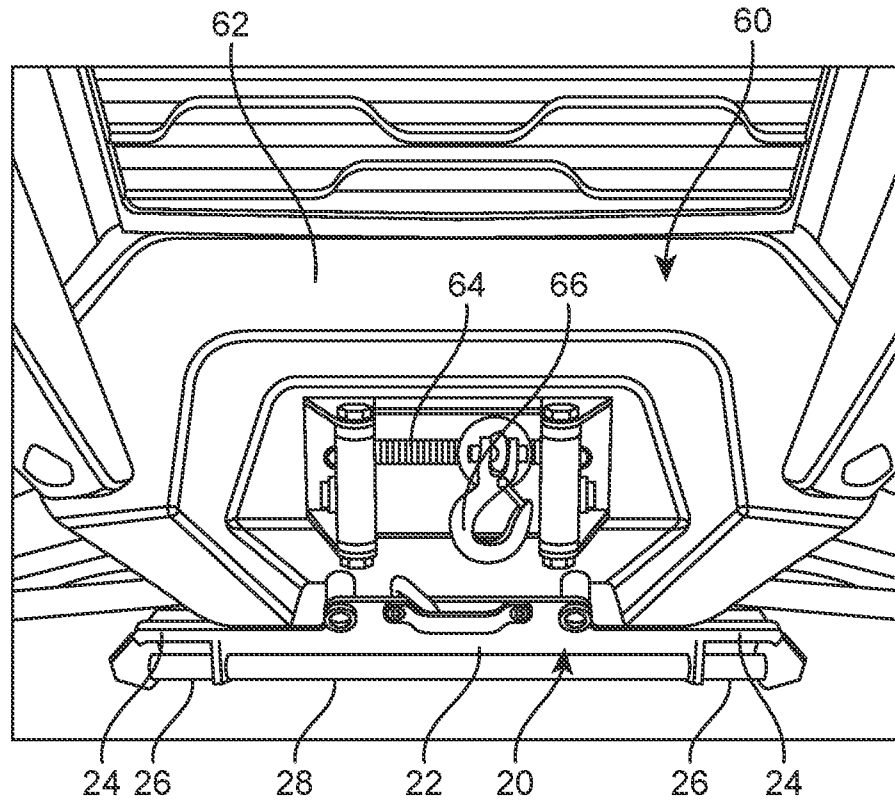

FIG. 2

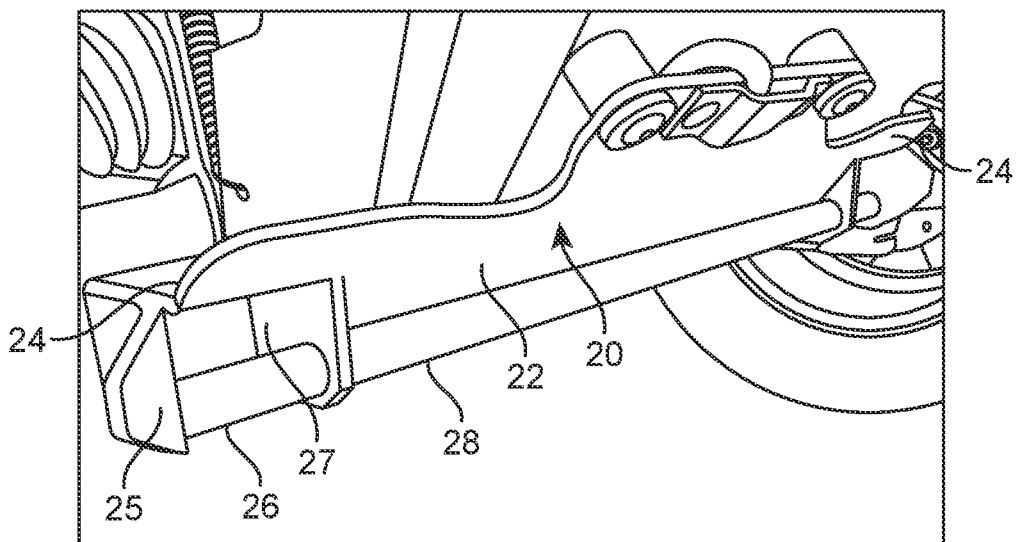

FIG. 3

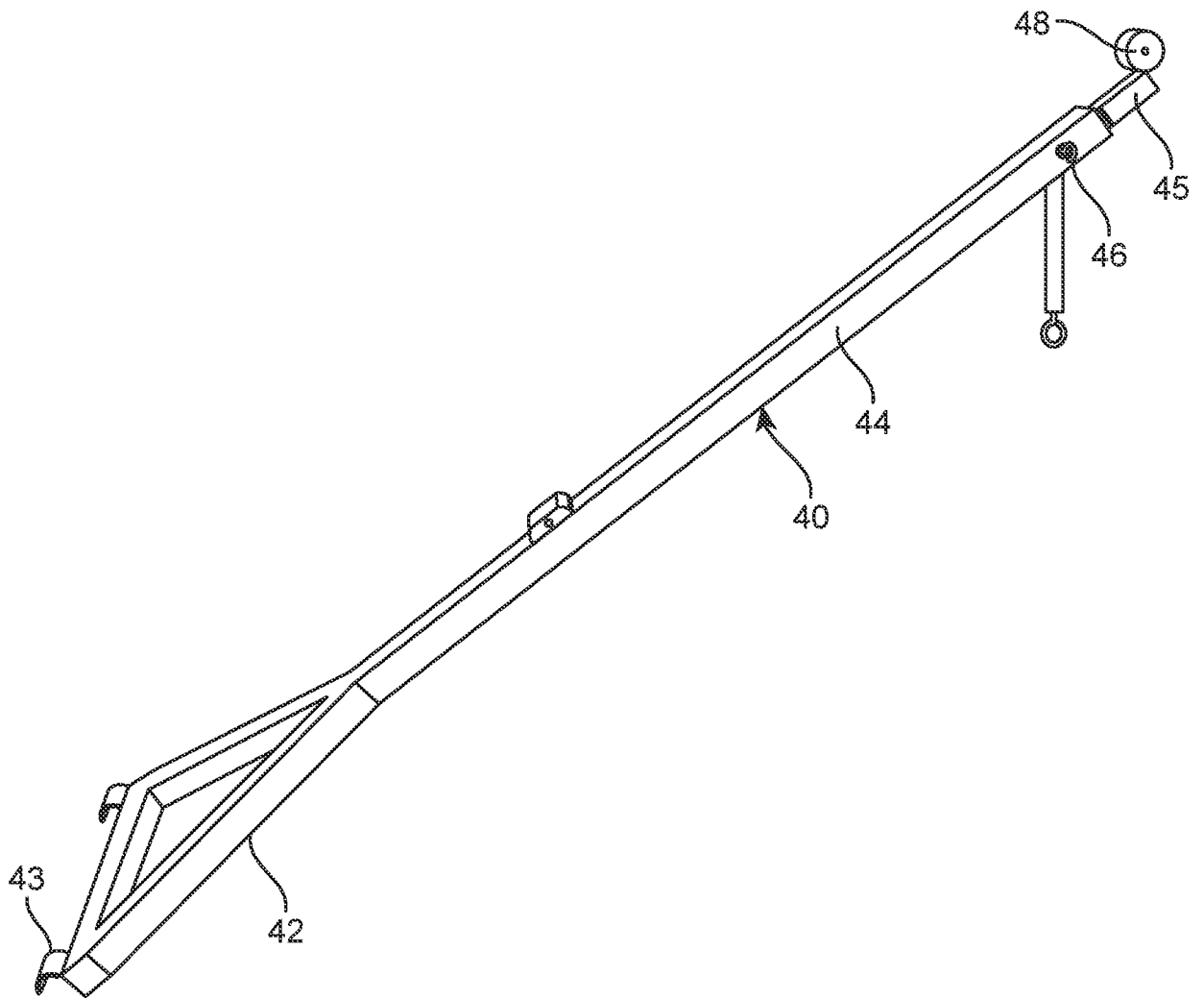

FIG. 4

4 / 8

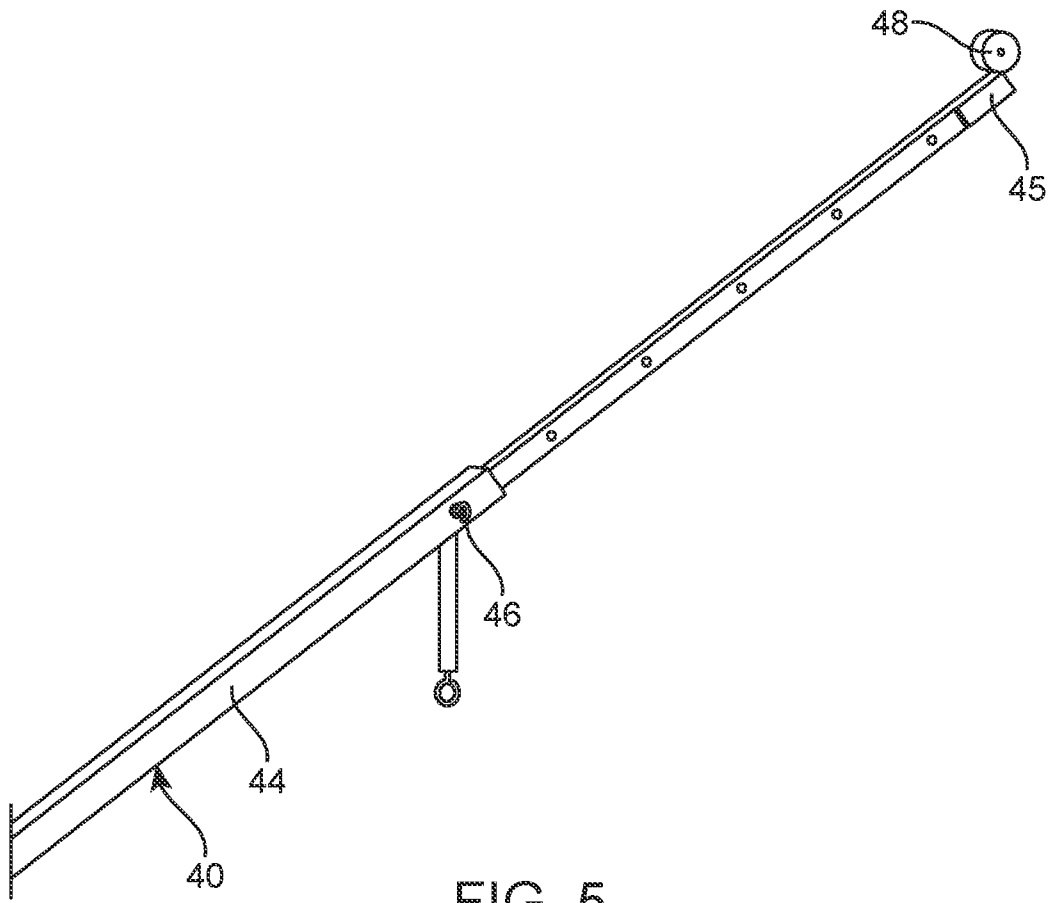

FIG. 5

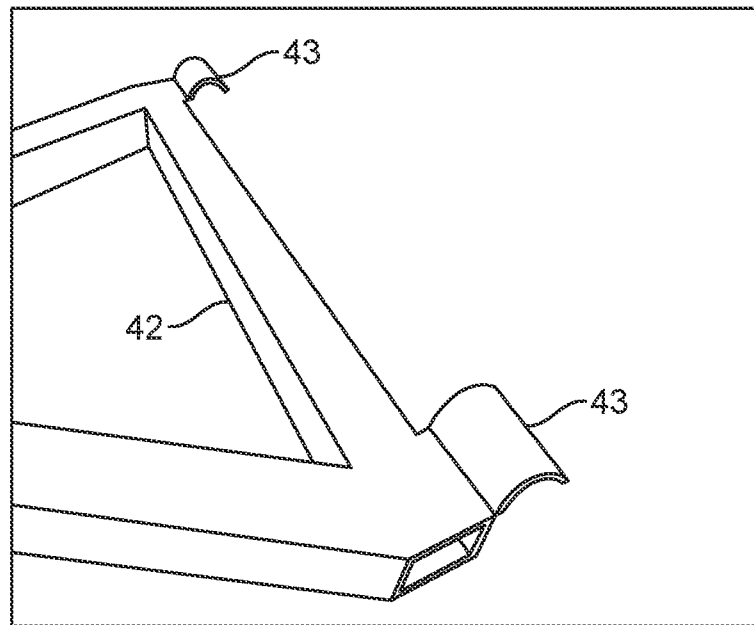

FIG. 6

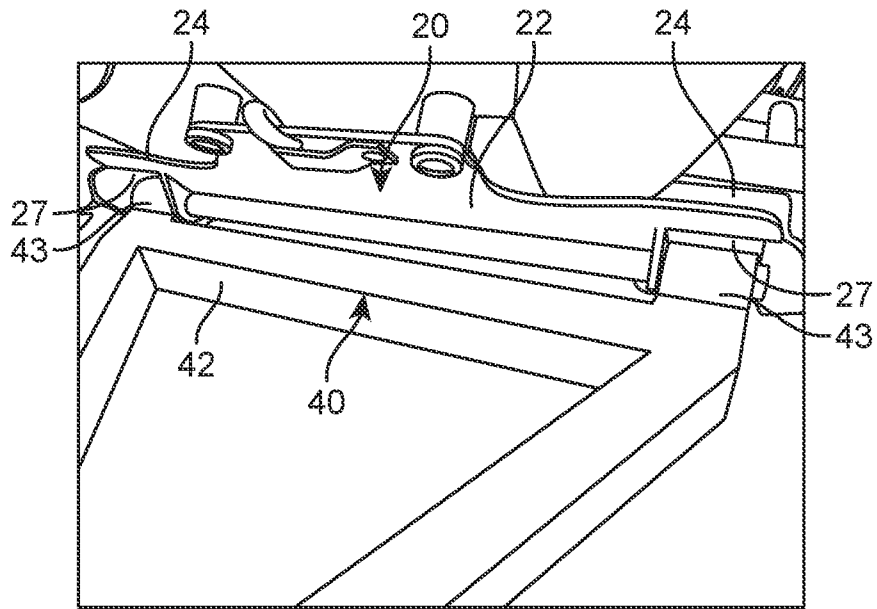

FIG. 7

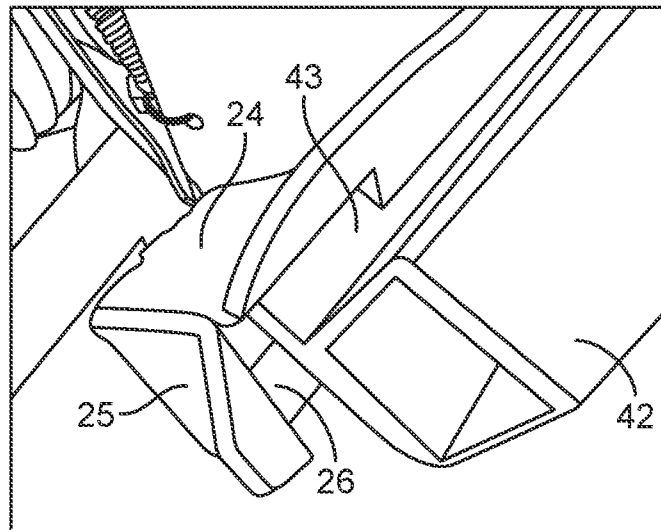

FIG. 8

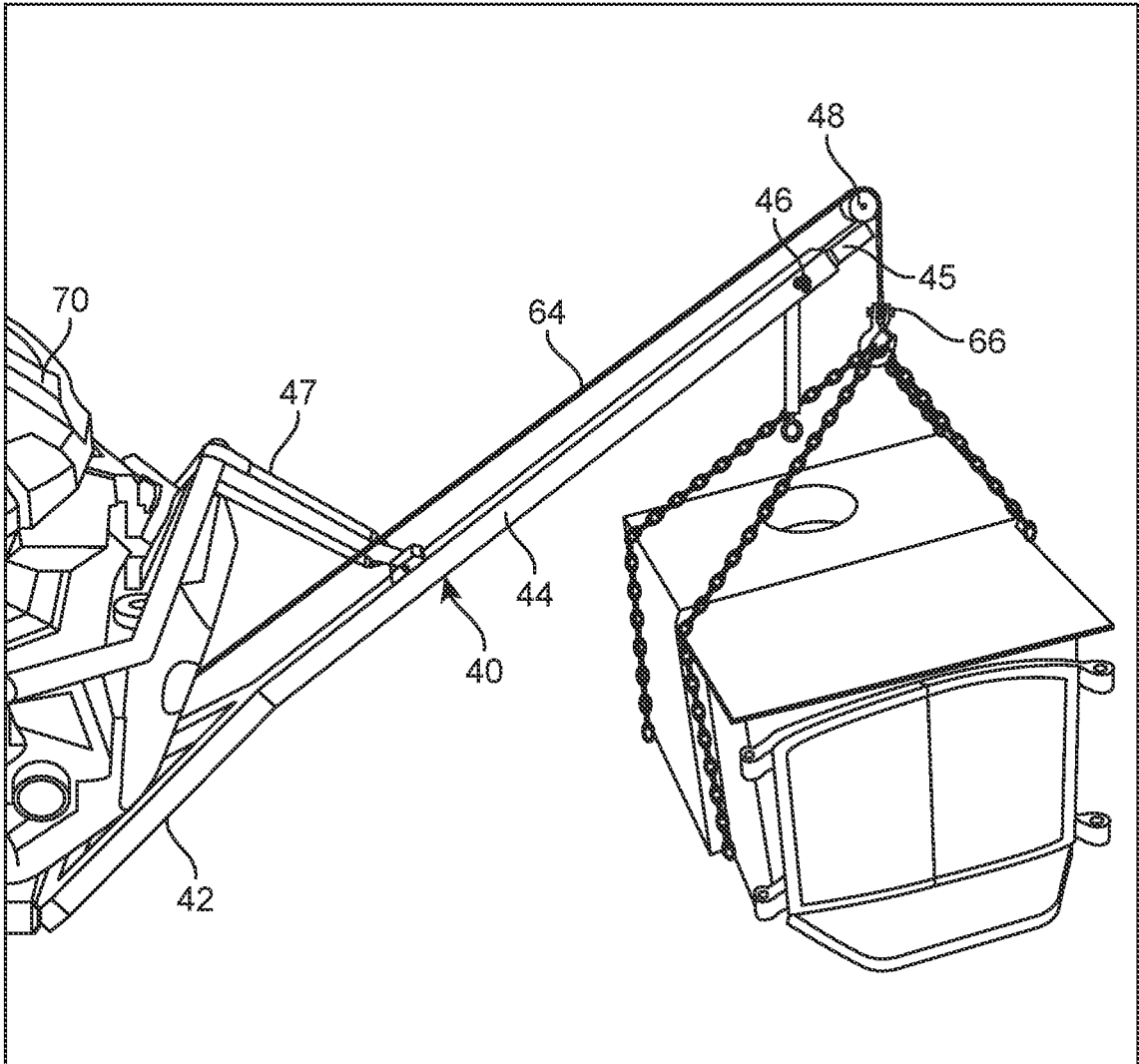

FIG. 9

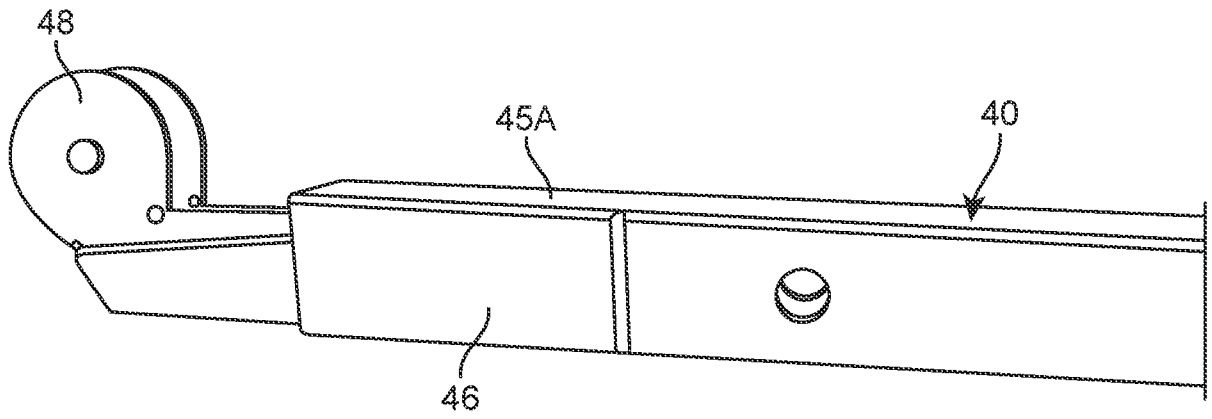

FIG. 10

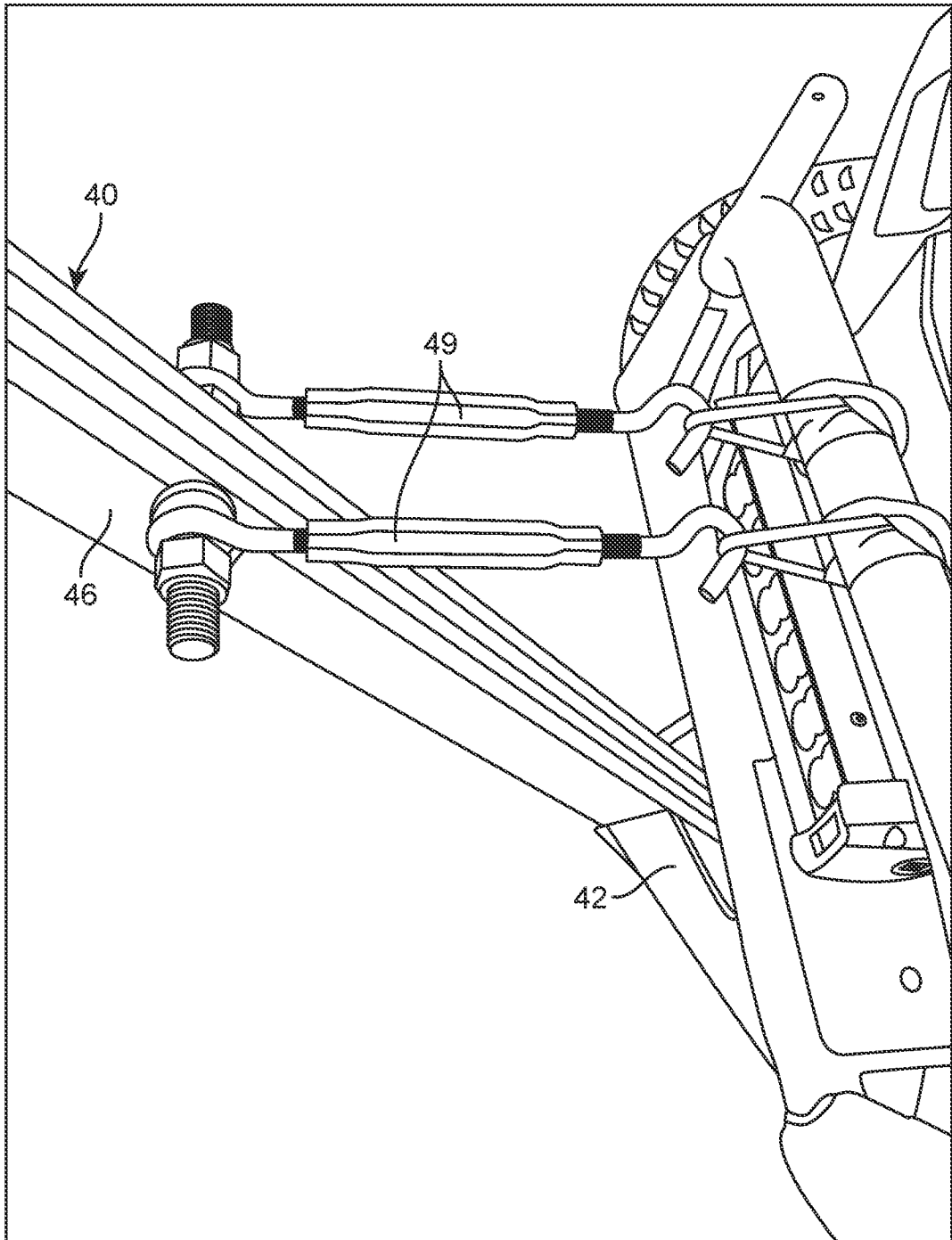

FIG. 11

INTERNATIONAL SEARCH REPORT

International application No.
PCT/US2021/038081

A. CLASSIFICATION OF SUBJECT MATTER
IPC(8) - B60P 1/54; B66C 23/36; B66C 23/42; B66C 23/44 (2021.01)
CPC - B60P 1/5471; B60P 1/5476; B60P 1/5485; B60P 1/549 (2021.08)

According to International Patent Classification (IPC) or to both national classification and IPC

B. FIELDS SEARCHED

Minimum documentation searched (classification system followed by classification symbols)
see Search History document

Documentation searched other than minimum documentation to the extent that such documents are included in the fields searched
see Search History document

Electronic data base consulted during the international search (name of data base and, where practicable, search terms used)
see Search History document

C. DOCUMENTS CONSIDERED TO BE RELEVANT

| Category* | Citation of document, with indication, where appropriate, of the relevant passages | Relevant to claim No. |
|-------------|--|--------------------------------|
| X — Y | US 2007/0045211 A1 (BEATTY) 01 March 2007 (01.03.2007) entire document. See page 9 of the ISA/237. | 1-4, 6, 8, 11 — 5, 9, 10 |
| Y | US 5,749,697 A (DAVIS) 12 May 1998 (12.05.1998) entire document. See page 10 of the ISA/237. | 5, 9, 10 |
| Y | US 2016/0167933 A1 (HOIST AROUND LLC) 16 June 2016 (16.06.2016) entire document | 9 |
| A | US 2010/0295005 A1 (RIGGS) 25 November 2010 (25.11.2010) entire document | 1-13 |
| A | US 5,064,078 A (VAN STAVEREN) 12 November 1991 (12.11.1991) entire document | 1-13 |

Further documents are listed in the continuation of Box C.

See patent family annex.

| | |
|---|--|
| * Special categories of cited documents: | "T" later document published after the international filing date or priority date and not in conflict with the application but cited to understand the principle or theory underlying the invention |
| "A" document defining the general state of the art which is not considered to be of particular relevance | "X" document of particular relevance; the claimed invention cannot be considered novel or cannot be considered to involve an inventive step when the document is taken alone |
| "D" document cited by the applicant in the international application | "Y" document of particular relevance; the claimed invention cannot be considered to involve an inventive step when the document is combined with one or more other such documents, such combination being obvious to a person skilled in the art |
| "E" earlier application or patent but published on or after the international filing date | "&" document member of the same patent family |
| "L" document which may throw doubts on priority claim(s) or which is cited to establish the publication date of another citation or other special reason (as specified) | |
| "O" document referring to an oral disclosure, use, exhibition or other means | |
| "P" document published prior to the international filing date but later than the priority date claimed | |

| | |
|---|---|
| Date of the actual completion of the international search 29 August 2021 | Date of mailing of the international search report SEP 23 2021 |
| Name and mailing address of the ISA/US Mail Stop PCT, Attn: ISA/US, Commissioner for Patents P.O. Box 1450, Alexandria, VA 22313-1450 Facsimile No. 571-273-8300 | Authorized officer Harry Kim Telephone No. PCT Helpdesk: 571-272-4300 |