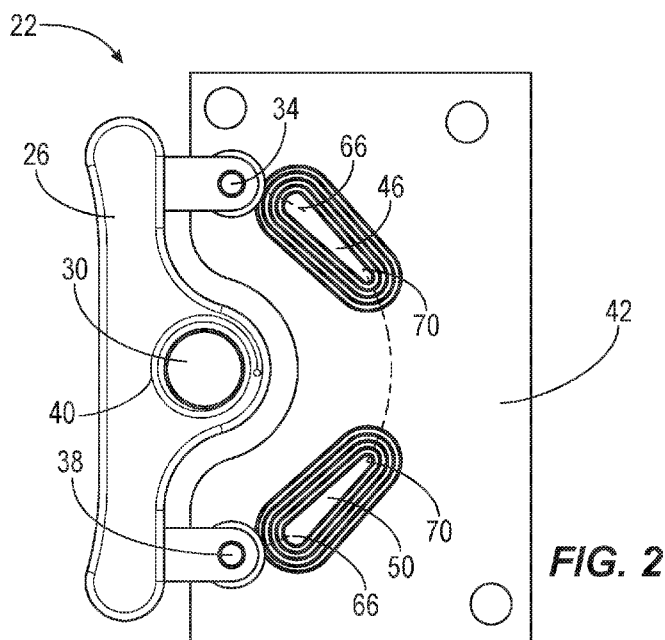




- (51) International Patent Classification:  
*B25F 5/00* (2006.01)      *H01H 23/14* (2006.01)
- (21) International Application Number:  
PCT/US2017/053215
- (22) International Filing Date:  
25 September 2017 (25.09.2017)
- (25) Filing Language: English
- (26) Publication Language: English
- (30) Priority Data:  
62/400,707      28 September 2016 (28.09.2016) US
- (71) Applicant: MILWAUKEE ELECTRIC TOOL CORPORATION [US/US]; 13135 West Lisbon Road, Brookfield, WI 53005 (US).
- (72) Inventors: DEY, IV, John, S.; 2550 N. Lake Drive, Apt. 6, Milwaukee, WI 53211 (US). SCHNEIDER, Jacob, P.; 1213 Delaware Boulevard, Madison, WI 53704 (US).
- (74) Agent: EVANS, Edward, J.; Michael Best & Friedrich LLP, 100 East Wisconsin Avenue, Suite 3300, Milwaukee, WI 53202-4108 (US).
- (81) Designated States (unless otherwise indicated, for every kind of national protection available): AE, AG, AL, AM, AO, AT, AU, AZ, BA, BB, BG, BH, BN, BR, BW, BY, BZ, CA, CH, CL, CN, CO, CR, CU, CZ, DE, DJ, DK, DM, DO, DZ, EC, EE, EG, ES, FI, GB, GD, GE, GH, GM, GT, HN, HR, HU, ID, IL, IN, IR, IS, JO, JP, KE, KG, KH, KN, KP, KR, KW, KZ, LA, LC, LK, LR, LS, LU, LY, MA, MD, ME, MG, MK, MN, MW, MX, MY, MZ, NA, NG, NI, NO, NZ, OM, PA, PE, PG, PH, PL, PT, QA, RO, RS, RU, RW, SA, SC, SD, SE, SG, SK, SL, SM, ST, SV, SY, TH, TJ, TM, TN, TR, TT, TZ, UA, UG, US, UZ, VC, VN, ZA, ZM, ZW.
- (84) Designated States (unless otherwise indicated, for every kind of regional protection available): ARIPO (BW, GH, GM, KE, LR, LS, MW, MZ, NA, RW, SD, SL, ST, SZ, TZ, UG, ZM, ZW), Eurasian (AM, AZ, BY, KG, KZ, RU, TJ, TM), European (AL, AT, BE, BG, CH, CY, CZ, DE, DK, EE, ES, FI, FR, GB, GR, HR, HU, IE, IS, IT, LT, LU, LV, MC, MK, MT, NL, NO, PL, PT, RO, RS, SE, SI, SK, SM,

(54) Title: TRIGGER ASSEMBLY



(57) Abstract: A trigger assembly, for use with a power tool having an electric motor, includes a trigger, a conductor coupled for movement with the trigger, and a printed circuit board. The printed circuit board has an inductive sensor thereon responsive to relative movement between the conductor and the inductive sensor caused by movement of the trigger. An output of the inductive sensor is used to activate the electric motor.



TR), OAPI (BF, BJ, CF, CG, CI, CM, GA, GN, GQ, GW,  
KM, ML, MR, NE, SN, TD, TG).

**Published:**

— *with international search report (Art. 21(3))*

## TRIGGER ASSEMBLY

### CROSS-REFERENCE TO RELATED APPLICATIONS

**[0001]** This application claims priority to U.S. Provisional Patent Application No. 62/400,707 filed on September 28, 2016, the entire content of which is incorporated herein by reference.

### FIELD OF THE INVENTION

**[0002]** The present invention relates to power tools, and more particularly to trigger assemblies for power tools.

### BACKGROUND OF THE INVENTION

**[0003]** Power tools have triggers that allow operators to activate the working element of the power tool when the working element is applied to an object. Depending on the type of power tool, triggers may be used to rotate, extend, retract, oscillate, reciprocate, speed up, and slow down the working element. Some triggers may allow an operator to cause the working element to perform more than one of these functions at the same time. Power tools may also include multiple triggers that are separately dedicated to these different functions.

### SUMMARY OF THE INVENTION

**[0004]** The present invention provides, in one aspect, a trigger assembly for use with a power tool having an electric motor. The trigger assembly includes a trigger, a conductor coupled for movement with the trigger, and a printed circuit board. The printed circuit board has an inductive sensor thereon responsive to relative movement between the conductor and the inductive sensor caused by movement of the trigger. An output of the inductive sensor is used to activate the electric motor.

**[0005]** The present invention provides, in another aspect, a power tool having an electric motor, a controller in electrical communication with the motor to activate and deactivate the motor, a trigger, a conductor coupled for movement with the trigger, and a printed circuit board. The printed circuit board has an inductive sensor thereon responsive to relative movement between the conductor and the inductive sensor caused by movement of

the trigger. An output of the inductive sensor is detected by the controller, which in response activates or deactivates the electric motor.

[0006] The present invention provides, in yet another aspect, a method of operating a power tool. The method includes pressing a trigger in a first direction, moving a conductor over an inductive sensor, outputting a signal from the inductive sensor, and activating an electric motor based on the signal.

[0007] Other features and aspects of the invention will become apparent by consideration of the following detailed description and accompanying drawings.

#### BRIEF DESCRIPTION OF THE DRAWINGS

[0008] FIG. 1 is a perspective view of a power tool in which a trigger assembly of the invention may be incorporated.

[0009] FIG. 2 is a plan view of a trigger assembly in accordance with an embodiment of the invention, with a trigger shown in a neutral position.

[0010] FIG. 3 is a plan view of the trigger assembly of FIG. 2, illustrating the trigger rotating in a clockwise direction over a first inductive sensor.

[0011] FIG. 4 is a plan view of the trigger assembly of FIG. 2, illustrating the trigger rotating in a counter-clockwise direction over a second inductive sensor.

[0012] FIG. 5 is a plan view of an alternate configuration of the first inductive sensor shown in FIGS. 2-4.

[0013] FIG. 6 is a plan view of an alternate configuration of the second inductive sensor shown in FIG. 2-4.

[0014] FIG. 7 is a plan view of a trigger assembly, with portions removed for clarity, in accordance with another embodiment of the invention.

[0015] FIG. 8 is a plan view of a trigger assembly in accordance with yet another embodiment of the invention.

[0016] FIG. 9 is a flow diagram showing the electrical communication between the first and second inductive sensors of the trigger assembly, a reference clock, a sensor unit, and a motor control unit on a printed circuit board.

[0017] Before any embodiments of the invention are explained in detail, it is to be understood that the invention is not limited in its application to the details of construction and the arrangement of components set forth in the following description or illustrated in the following drawings. The invention is capable of other embodiments and of being practiced or of being carried out in various ways. Also, it is to be understood that the phraseology and terminology used herein is for the purpose of description and should not be regarded as limiting.

#### DETAILED DESCRIPTION

[0018] FIG. 1 illustrates a power tool 10 (e.g., an impact wrench) including a housing 14, an electric motor (e.g., a brushless electric motor 16; FIG. 9) disposed within the housing 14, and an output shaft which, either directly or indirectly, performs work on a workpiece during operation of the tool 10. In the illustrated embodiment, the output shaft is configured as an anvil 18 having a square drive for attachment to a corresponding size socket. However, the output shaft may include a different configuration or may include a conventional chuck for receipt of any of a number of different tool bits. Furthermore, the power tool 10 may be configured as a non-impact rotary tool (e.g., a drill or screwdriver) or a non-rotary power tool.

[0019] With reference to FIG. 2, the power tool 10 also includes a trigger assembly 22 for activating and deactivating the motor 16. The trigger assembly 22 includes a trigger 26 pivotably coupled to the housing 14 by a pivot 30, first and second conductors 34, 38 (e.g., pieces of ferrous or non-ferrous metal) supported by the trigger 26 on opposite sides of the pivot 30, and a torsion spring 40 for biasing the trigger 26 toward a neutral or “home” position (shown in FIG. 2). The trigger assembly 22 also includes a printed circuit board (“PCB”) 42 having thereon first and second inductive sensors 46, 50, which are also components of a control system 54 shown in FIG. 9. The PCB 42 is positioned in close proximity to the trigger 26 in a grip portion 58 of the housing 14 (FIG. 1). A power source, such as a battery 62, provides power to the PCB 42 and the motor 16 when activated by the trigger assembly 22.

**[0020]** With reference to FIG. 2, the first and second inductive sensors 46, 50 are configured as coil traces on the PCB 42. When an AC voltage is applied to each of the sensors, 46, 50, an electromagnetic field is created. Based on Faraday's Law of Induction, a voltage will be induced in the conductors 34, 38 in response to relative movement between the conductors 34, 38 and the magnetic fields of the respective inductive sensors 46, 50 which, in turn, produces Eddy currents in the conductors 34, 38 that oppose the electromagnetic fields created by the respective inductive sensors 46, 50. This changes the inductance of the inductive sensors 46, 50, which can be measured and used as an indicator of the presence or physical proximity of the conductors 34, 38 relative to the sensors 46, 50. Although not schematically illustrated in FIG. 9, each of the inductive sensors 46, 50 is configured as an LC tank circuit, the frequency of which (hereinafter, the "sensor frequency") changes in response to a change in inductance.

**[0021]** As shown in FIG. 2, each of the inductive sensors 46, 50 is elongated and has a uniform number or density of windings throughout the length of the sensors 46, 50 between a proximal end 66 and a distal end 70 of each of the sensors 46, 50. In this embodiment of the trigger assembly 22, the measured change in inductance of the sensors 46, 50 in response to movement of the conductors 34, 38 relative to the sensors 46, 50 can be used to activate the motor 16 for rotation at a constant speed in either a forward or reverse direction, depending upon which direction the trigger 26 is pivoted.

**[0022]** As shown in FIG. 9, the control system 54 also includes a reference clock 74, which is also configured as an LC tank circuit. However, the reference clock 74 is isolated from the conductors 34, 38 and therefore is operable to output a constant reference frequency, the purpose of which is described in detail below. The control system 54 also includes a sensor unit 78, which receives the output of the inductive sensors 46, 50 and the reference clock 74, and a motor control unit ("MCU") 82 electrically coupled to the motor 16. The sensor unit 78 continuously receives a first frequency signal 86 indicative of the sensor frequency of the first inductive sensor 46, a second frequency signal 90 indicative of the sensor frequency of the second inductive sensor 50, and a reference frequency signal 94 indicative of the reference frequency of the reference clock 74.

**[0023]** Using the sensor frequency signals 86, 90 and the reference frequency signal 94 as inputs, the sensor unit 78 is operable to calculate a frequency ratio, which is a ratio of the sensor frequency to the reference frequency. Specifically, the sensor unit 78 calculates a

first frequency ratio and a second frequency ratio, and digitally outputs a first ratio signal 98 indicative of the first frequency ratio and a second ratio signal 102 indicative of the second frequency ratio to the MCU 82. The MCU 82 is operable to interpolate the first and second ratio signals 98, 102 to determine whether the trigger 26 has been depressed and in which direction (e.g., clockwise about the pivot 30 or counter-clockwise). Specifically, if the first ratio signal 98 deviates from an expected initial value (e.g., a ratio of 1:1) while the second ratio signal 102 remains unchanged, the MCU 82 associates this situation with the trigger 26 being pivoted in a clockwise direction from the neutral position shown in FIG. 2 toward the position shown in FIG. 3, coinciding with the first conductor 34 moving over the first inductive sensor 46. Furthermore, the MCU 82 associates pivoting the trigger 26 in a clockwise direction with activating the motor 16 in a forward direction at a constant and predetermined speed. Likewise, if the second ratio signal 102 deviates from an expected initial value (e.g., a ratio of 1:1) while the first ratio signal 98 remains unchanged, the MCU 82 associates this situation with the trigger 26 being pivoted in a counter-clockwise direction from the neutral position shown in FIG. 2 toward the position shown in FIG. 4, coinciding with the second conductor 38 moving over the second inductive sensor 50. Furthermore, the MCU 82 associates pivoting the trigger 26 in a counter-clockwise direction with activating the motor 16 in a reverse direction at a constant and predetermined speed.

**[0024]** In operation of the power tool 10 using the embodiment of the trigger assembly 22 shown in FIGS. 2-4, to activate the motor 16 in a forward direction, the operator pivots the trigger 26 from the neutral position shown in FIG. 2 to the position shown in FIG. 3, causing the first conductor 34 to move over the first inductive sensor 46. This changes the inductance of the first inductive sensor 46, which in turn also causes the sensor frequency of the first inductive sensor 46 to change. As described above, this change is detected by the MCU 82, which then activates the motor 16 in a forward direction at a constant speed. When the operator releases the trigger, it is returned to the neutral position shown in FIG. 2 by the torsion spring, again causing the first conductor 34 to move over the first inductive sensor 46. This action again causes a change in the sensor frequency of the first inductive sensor 46, which is interpolated by the MCU 82 (as a result of the first ratio signal 98 deviating from an initial value) as the trigger 26 returning to the neutral position. Thereafter, the MCU 82 deactivates the motor 16, thus stopping forward rotation of the anvil 18.

**[0025]** Likewise, to activate the motor 16 in a reverse direction, the operator pivots the trigger 26 from the neutral position shown in FIG. 2 to the position shown in FIG. 4, causing the second conductor 38 to move over the second inductive sensor 50. This changes the inductance of the second inductive sensor 50, which in turn also causes the sensor frequency of the second inductive sensor 50 to change. As described above, this change is detected by the MCU 82, which then activates the motor 16 in a reverse direction at a constant speed. When the operator releases the trigger 26, it is returned to the neutral position shown in FIG. 2 by the torsion spring, again causing the second conductor 38 to move over the second inductive sensor 50. This action again causes a change in the sensor frequency of the second inductive sensor 50, which is interpolated by the MCU 82 (as a result of the second ratio signal 102 deviating from an initial value) as the trigger 26 returning to the neutral position. Thereafter, the MCU 82 deactivates the motor 16, thus stopping reverse rotation of the anvil 18.

**[0026]** In another embodiment of the trigger assembly (with like features being identified with like reference numerals), the uniform inductive sensors 46, 50 shown in FIGS. 2-4 may be replaced with inductive sensors 146, 150 having a non-uniform winding density along the length of the inductive sensors 146, 150 (FIGS. 5 and 6). In other words, each of the inductive sensors 146, 150 includes a relatively low winding density at a proximal end 166 of the sensors 146, 150 (i.e., an end closest to the respective conductors 34, 38 when the trigger 26 is in the neutral position) and a relatively high winding density at a distal end 170 of the sensors 146, 150 (i.e., an end farthest from the respective conductors 34, 38 when the trigger 26 is in the neutral position). In this embodiment of the trigger assembly, the MCU 82 is also operable to control the speed at which the motor 16 operates in proportion to the degree to which the trigger 26 is pivoted.

**[0027]** In operation of the power tool 10 using the embodiment of the trigger assembly with the inductive sensors 146, 150 of FIGS. 5 and 6, to activate the motor 16 in a forward direction, the operator pivots the trigger 26 from the neutral position shown in FIG. 2 in a clockwise direction, causing the first conductor 34 to move over the first inductive sensor 146. This changes the inductance of the first inductive sensor 146, which in turn also causes the sensor frequency of the first inductive sensor 146 to change. However, rather than the first ratio signal changing between an expected initial value (e.g., 1:1) and an alternate value (e.g., one greater than or less than 1:1) as is the case when using the inductive sensors 46, 50



of FIG. 2 having a uniform winding density, the first ratio signal input 98 to the MCU 82 continuously changes from the initial value (e.g., 1:1) to a final (e.g., a maximum or minimum) value coinciding with placement of the first conductor 34 above the distal end 170 of the first inductive sensor 146. This change is detected by the MCU 82 which, depending upon the degree to which the trigger 26 is pivoted in the clockwise direction, activates the motor 16 in a forward direction at a rotational speed that is proportional to the degree to which the trigger 26 is pivoted.

**[0028]** If the trigger 26 is pivoted to an intermediate position and then held stationary, the MCU 82 will continue to drive the motor 16 at a constant rotational speed proportional to the degree to which the trigger 26 is initially pivoted, until the trigger 26 is either depressed to pivot the trigger 26 further in a clockwise direction (to thereby accelerate the motor 16 to a higher speed) or released to deactivate the motor 16. If the trigger 26 is further pivoted in the clockwise direction, the first conductor 34 is moved further along the length of the first inductive sensor 146, closer to the distal end 170 of the first inductive sensor 146. This action again causes a change in the sensor frequency of the first inductive sensor 146, with the magnitude of the first ratio signal 98 moving further from the initial value (e.g., 1:1) and toward the final (e.g., a maximum or minimum) value, prompting the MCU 82 to accelerate the motor 16 to a rotational speed proportional with the degree to which the trigger 26 is pivoted in the clockwise direction. The MCU 82 is also operable to drive the motor 16 at a variable rotational speed as described above, but in a reverse direction, in response to the trigger 26 being pivoted in a counter-clockwise direction from the neutral position shown in FIG. 2.

**[0029]** FIG. 7 illustrates a trigger assembly in accordance with another embodiment of the invention, with like features being shown with like reference numerals. The trigger assembly is similar to that described above using the inductive sensors 146, 150 shown in FIGS. 5 and 6, but the second conductor 38 and the second inductive sensor 150 are omitted. And, in the neutral position of the trigger 26, the first conductor 34 is located approximately between the proximal and distal ends 166, 170 of the first (and only) inductive sensor 146.

**[0030]** In this embodiment, the MCU 82 is programmed to activate and drive the motor 16 in a forward direction at a rotational speed proportional to the degree to which the trigger 26 is pivoted in a clockwise direction from the neutral position, which further displaces the first conductor 34 toward the distal end 170 of the first inductive sensor 146.

Likewise, the MCU 82 is programmed to activate and drive the motor 16 in a reverse direction at a rotational speed proportional to the degree to which the trigger 26 is pivoted in a counter-clockwise direction from the neutral position, which further displaces the first conductor 34 toward the proximal end 166 of the first inductive sensor 146. When the operator releases the trigger 26, it is returned to its neutral position by the torsion spring, again causing the first conductor 34 to move over the first inductive sensor 146. This action again causes a change in the sensor frequency of the first inductive sensor 146, which is interpolated by the MCU 82 as the trigger returning to the neutral position (coinciding with placement of the first conductor 34 approximately between the proximal and distal ends 166, 170 of the first inductive sensor 146). Thereafter, the MCU 82 deactivates the motor 16, thus stopping rotation of the anvil 18.

**[0031]** A trigger assembly 322 in accordance with yet another embodiment of the invention is shown in FIG. 8. In this embodiment, a slidable trigger 326 supporting a conductor 334 thereon is employed. The slidable trigger 326 is biased by a spring to a neutral position spaced from a single, linear inductive sensor 346 having a non-uniform winding density. In this embodiment, a separate direction switch (not shown) on the housing 14 of the power tool 10 is employed to toggle rotation of the motor 16 between forward and reverse directions. In the same manner as described above, the MCU 82 is programmed to increase the rotational speed of the motor 16 as the slidable trigger 326 slides over the inductive sensor 346 as the conductor 334 approaches the distal end 370 of the inductive sensor 346. Likewise, the MCU 82 is programmed to decrease the rotational speed of the motor 16 as the slidable trigger 326 slides over the inductive sensor 346 in an opposite direction as the conductor 334 approaches the proximal end 366 of the inductive sensor 346. And, the MCU 82 is programmed to hold the rotational speed of the motor 16 at a constant value if the slidable trigger 326 stops anywhere between the proximal and distal ends 366, 370 of the inductive sensor 346.

**[0032]** The trigger assemblies of FIGS. 2-7 allow the motor 16 to be controlled without a secondary direction switch to otherwise toggle the motor 16 between forward and reverse rotational directions, thus reducing the number of components required to manufacture the tool 10 and the attendant cost. Also, because the inductive sensors 46, 50, 146, 150, 346 function as non-contact switches, the trigger assemblies 22, 322 disclosed

herein are expected to have greater longevity than a traditional contact-based trigger switch, which can wear over time.

**[0033]** Various features of the invention are set forth in the following claims.

## CLAIMS

What is claimed is:

1. A trigger assembly for use with a power tool having an electric motor, the trigger assembly comprising:
  - a trigger;
  - a conductor coupled for movement with the trigger;
  - a printed circuit board having an inductive sensor thereon responsive to relative movement between the conductor and the inductive sensor caused by movement of the trigger,wherein an output of the inductive sensor is used to activate the electric motor.
2. The trigger assembly of claim 1, wherein the inductive sensor is first inductive sensor, the conductor is a first conductor, and the output is a first output, and wherein the trigger assembly further comprises
  - a second conductor coupled for movement with the trigger, and
  - a second inductive sensor on the printed circuit board responsive to relative movement between the second conductor and the second inductive sensor caused by movement of the trigger, wherein a second output of the second inductive sensor is used to activate the electric motor.
3. The trigger assembly of claim 2, wherein the first output of the first inductive sensor is used to activate the electric motor in a first rotational direction, and wherein the second output of the second inductive sensor is used to activate the electric motor in a second rotational direction that is different than the first rotational direction.
4. The trigger assembly of claim 1, wherein the inductive sensor is a coil trace having a proximal end located proximate the trigger and a distal end, and wherein the distal end has a different winding density than the proximal end.

5. The trigger assembly of claim 4, wherein, in response to the conductor moving away from the proximal end of the inductive sensor and towards the distal end, a rotational speed of the motor is accelerated, and wherein in response to the conductor moving away from the distal end of the inductive sensor and towards the proximal end, the rotational speed of the motor is decelerated.

6. The trigger assembly of claim 5, further comprising a spring biasing the trigger toward a neutral position in which the conductor is closer to the proximal end than the distal end.

7. The trigger assembly of claim 6, wherein the coil trace is linear.

8. The trigger assembly of claim 6, wherein the coil trace is curvilinear.

9. The trigger assembly of claim 8, wherein the conductor is a first conductor, the coil trace is a first coil trace, and the output is a first output used to activate the motor in a first rotational direction, and wherein the trigger assembly further comprises  
a second conductor coupled for movement with the trigger, and  
a second inductive sensor configured as a second coil trace on the printed circuit board having a proximal end located proximate the trigger and a distal end, wherein the distal end of the second coil trace has a different winding density than the proximal end of the second coil trace,

wherein the second inductive sensor is responsive to relative movement between the second conductor and the second inductive sensor caused by movement of the trigger, and wherein a second output of the second inductive sensor is used to activate the motor in a second rotational direction that is different than the first rotational direction,

wherein, in response to the second conductor moving away from the proximal end of the second coil trace and towards the distal end of the second coil trace, a rotational speed of the electric motor is accelerated, and wherein in response to the second conductor moving away from the distal end of the second coil trace and towards the proximal end of the second coil trace, the rotational speed of the motor is decelerated.

10. The trigger assembly of claim 1, wherein the inductive sensor is a coil trace having a first end and a second end that has a different coil density than the first end, and wherein the trigger assembly further comprises

- a spring biasing the trigger to a position in which the conductor is located in a neutral position between the first end and the second end,
- wherein, in response to the conductor moving away from the neutral position and towards the first end of the coil trace, the output of the inductive sensor is used to activate the motor in a first rotational direction and to accelerate a rotational speed of the motor, and
- wherein, in response to the conductor moving away from the neutral position and towards the second end of the coil trace, the output of the inductive sensor is used to activate the motor in an opposite, second rotational direction and to accelerate a rotational speed of the motor.

11. A power tool comprising:

- an electric motor;
- a controller in electrical communication with the motor to activate and deactivate the motor;
- a trigger;
- a conductor coupled for movement with the trigger; and
- a printed circuit board having an inductive sensor thereon responsive to relative movement between the conductor and the inductive sensor caused by movement of the trigger;

wherein an output of the inductive sensor is detected by the controller, which in response activates or deactivates the electric motor.

12. The power tool of claim 11, wherein the inductive sensor is first inductive sensor, the conductor is a first conductor, and the output is a first output, and wherein the power tool further comprises

a second conductor coupled for movement with the trigger, and  
a second inductive sensor on the printed circuit board responsive to relative movement between the second conductor and the second inductive sensor caused by movement of the trigger, wherein a second output of the second inductive sensor is detected by the controller, which in response activatea the electric motor.

13. The power tool of claim 12, wherein the first output of the first inductive sensor is detected by the controller, which in response activates the electric motor in a first rotational direction, and wherein the second output of the second inductive sensor is detected by the controller, which in response activates the electric motor in a second rotational direction that is different than the first rotational direction.

14. The power tool of claim 11, wherein the inductive sensor is a coil trace having a proximal end located proximate the trigger and a distal end, and wherein the distal end has a different winding density than the proximal end.

15. The power tool of claim 14, wherein, in response to the conductor moving away from the proximal end of the inductive sensor and towards the distal end, a rotational speed of the motor is accelerated by the controller, and wherein, in response to the conductor moving away from the distal end of the inductive sensor and towards the proximal end, the rotational speed of the motor is decelerated by the controller.

16. The power tool of claim 15, further comprising a spring biasing the trigger toward a neutral position in which the conductor is closer to the proximal end than the distal end.

17. The power tool of claim 16, wherein the conductor is a first conductor, the coil trace is a first coil trace, and the output is a first output detected by the controller to activate the motor in a first rotational direction, and wherein the power tool further comprises  
a second conductor coupled for movement with the trigger, and  
a second inductive sensor configured as a second coil trace on the printed circuit board having a proximal end located proximate the trigger and a distal end, wherein the distal end of the second coil trace has a different winding density than the proximal end of the second coil trace,

wherein the second inductive sensor is responsive to relative movement between the second conductor and the second inductive sensor caused by movement of the trigger, and wherein a second output of the second inductive sensor is detected by the controller, which in response activates the motor in a second rotational direction that is different than the first rotational direction,

wherein, in response to the second conductor moving away from the proximal end of the second coil trace and towards the distal end of the second coil trace, a rotational speed of the electric motor is accelerated by the controller, and wherein in response to the second conductor moving away from the distal end of the second coil trace and towards the proximal end of the second coil trace, the rotational speed of the motor is decelerated by the controller.



18. The power tool of claim 11, wherein the inductive sensor is a coil trace having a first end and a second end that has a different coil density than the first end, and wherein the power tool further comprises

a spring biasing the trigger to a position in which the conductor is located in a neutral position between the first end and the second end,

wherein, in response to the conductor moving away from the neutral position and towards the first end of the coil trace, the output of the inductive sensor is detected by the controller, which in response activates the motor in a first rotational direction and accelerates a rotational speed of the motor, and

wherein, in response to the conductor moving away from the neutral position and towards the second end of the coil trace, the output of the inductive sensor is detected by the controller, which in response activates the motor in an opposite, second rotational direction and accelerates the rotational speed of the motor.

19. The power tool of claim 11, further comprising:

a sensor unit in communication with the controller; and

a reference clock configured to provide a reference frequency signal to the sensor unit that is indicative of a reference frequency of the reference clock,

wherein the output of the inductive sensor is a sensor frequency signal indicative of a sensor frequency of the inductive sensor, wherein the sensor frequency of the inductive sensor is configured to change based on relative movement between the conductor and the inductive sensor,

wherein the sensor unit is configured to receive the sensor frequency signal from the inductive sensor and output a ratio signal to the controller, which is a ratio of the sensor frequency to the reference frequency, and wherein the controller activates or deactivates the motor based upon the ratio signal.

20. The power tool of claim 19, wherein the controller is configured to activate the motor in one of a first rotational direction or an opposite, second rotational direction in response to a change in the first ratio signal.

21. A method of operating a power tool, the method comprising:  
pressing a trigger in a first direction;  
moving a conductor over an inductive sensor;  
outputting a signal from the inductive sensor; and  
activating an electric motor based on the signal.

22. The method of claim 21, wherein the inductive sensor is a coil trace having a proximal end located proximate the trigger and a distal end, and wherein the distal end has a different winding density than the proximal end, and wherein the method further comprises:

moving the conductor away from the proximal end of the inductive sensor and towards the distal end of the inductive sensor; and

accelerating the rotational speed of the motor as the conductor is moved from the proximal end of the inductive sensor towards the distal end.

23. The method of claim 22, further comprising:  
releasing the trigger;  
biasing the trigger in a second direction that is opposite the first direction;  
moving the conductor away from the distal end of the inductive sensor and towards the proximal end of the inductive sensor; and  
decelerating the rotational speed of the motor as the conductor is moved from the distal end of the inductive sensor to towards the proximal end.

24. The method of claim 21, wherein activating the electric motor comprises activating the electric motor in a first rotational direction.

25. The method of claim 24, wherein pressing the trigger in the first direction comprises pivoting the trigger in a first pivotal direction, wherein the conductor is a first conductor and the inductive sensor is a first inductive sensor, and wherein the method further comprises:

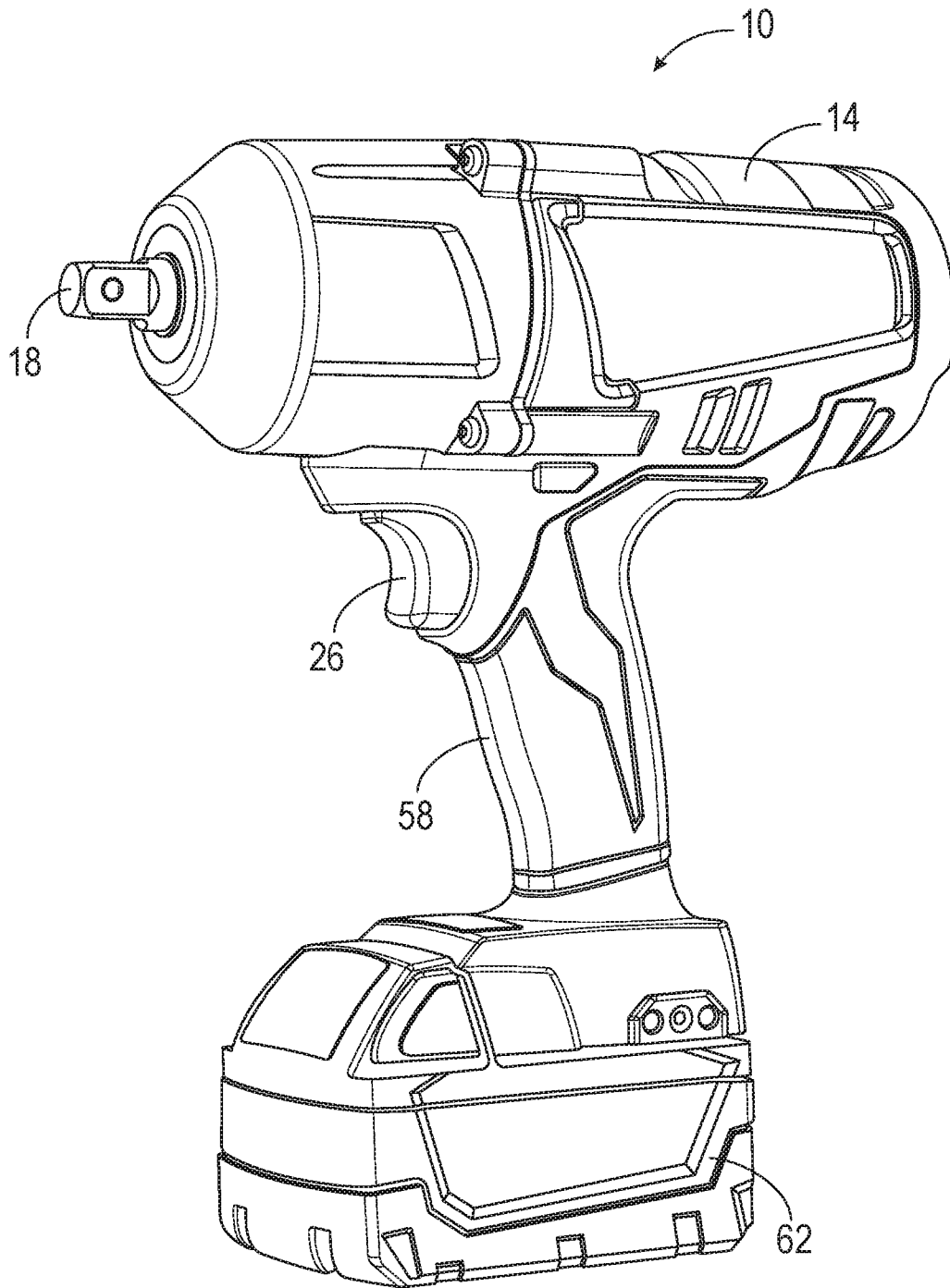
pivoting the trigger in a second pivotal direction that is opposite the first pivotal direction;

moving a second conductor over a second inductive sensor;

outputting a second signal from the second inductive sensor; and

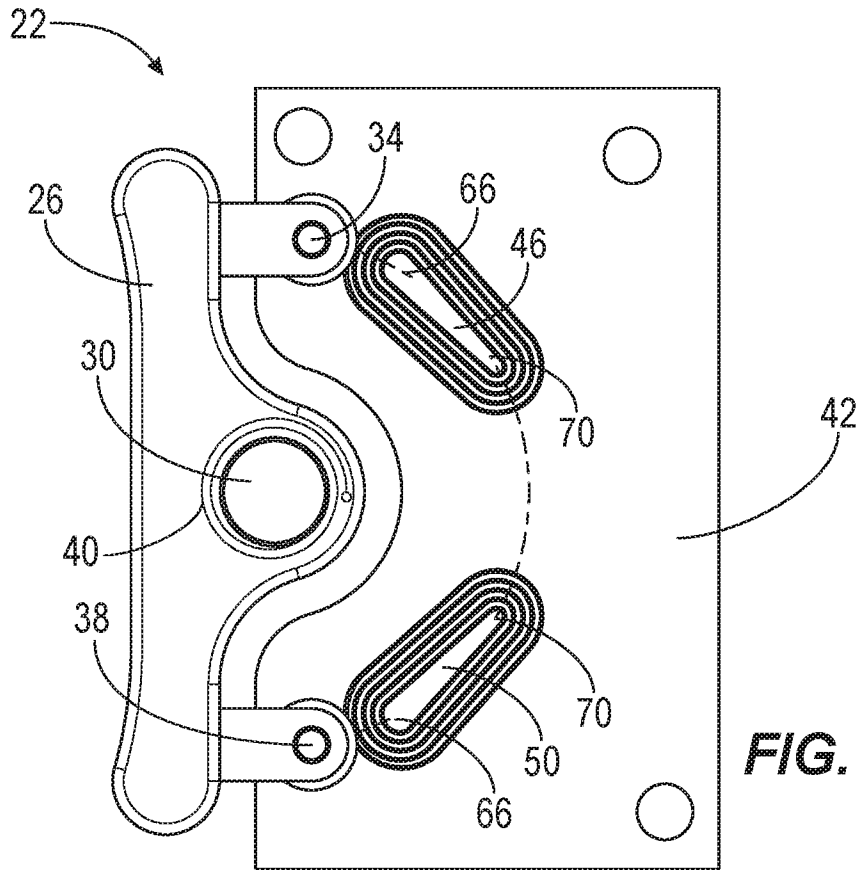
activating the electric motor in a second rotational direction that is different than the first rotational direction based on the second signal.

1/6

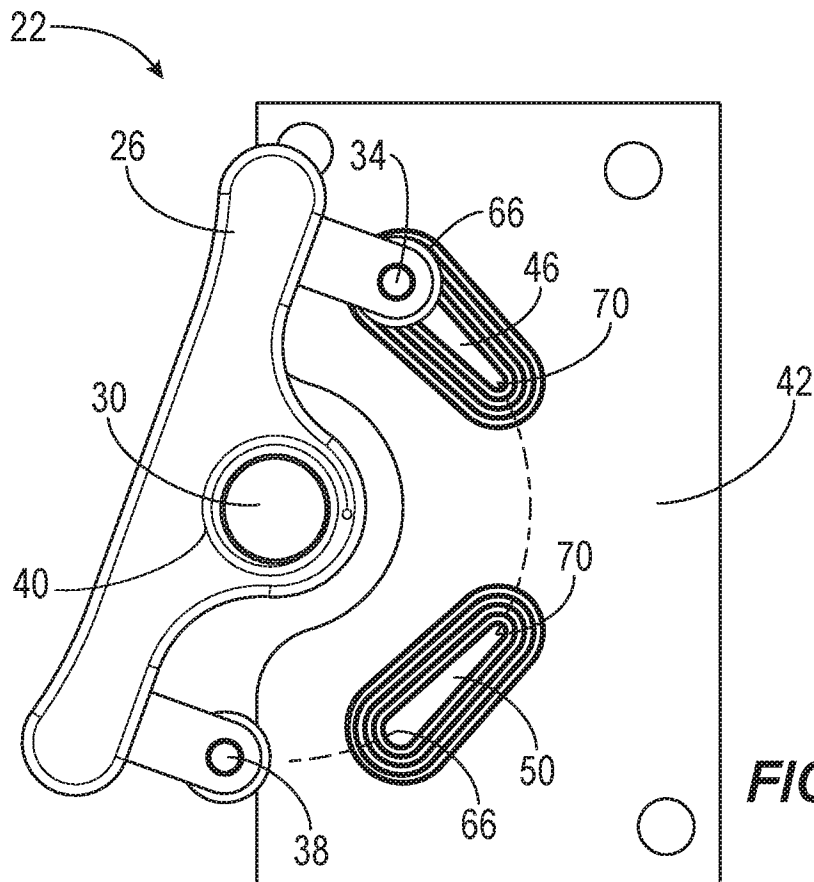


**FIG. 1**

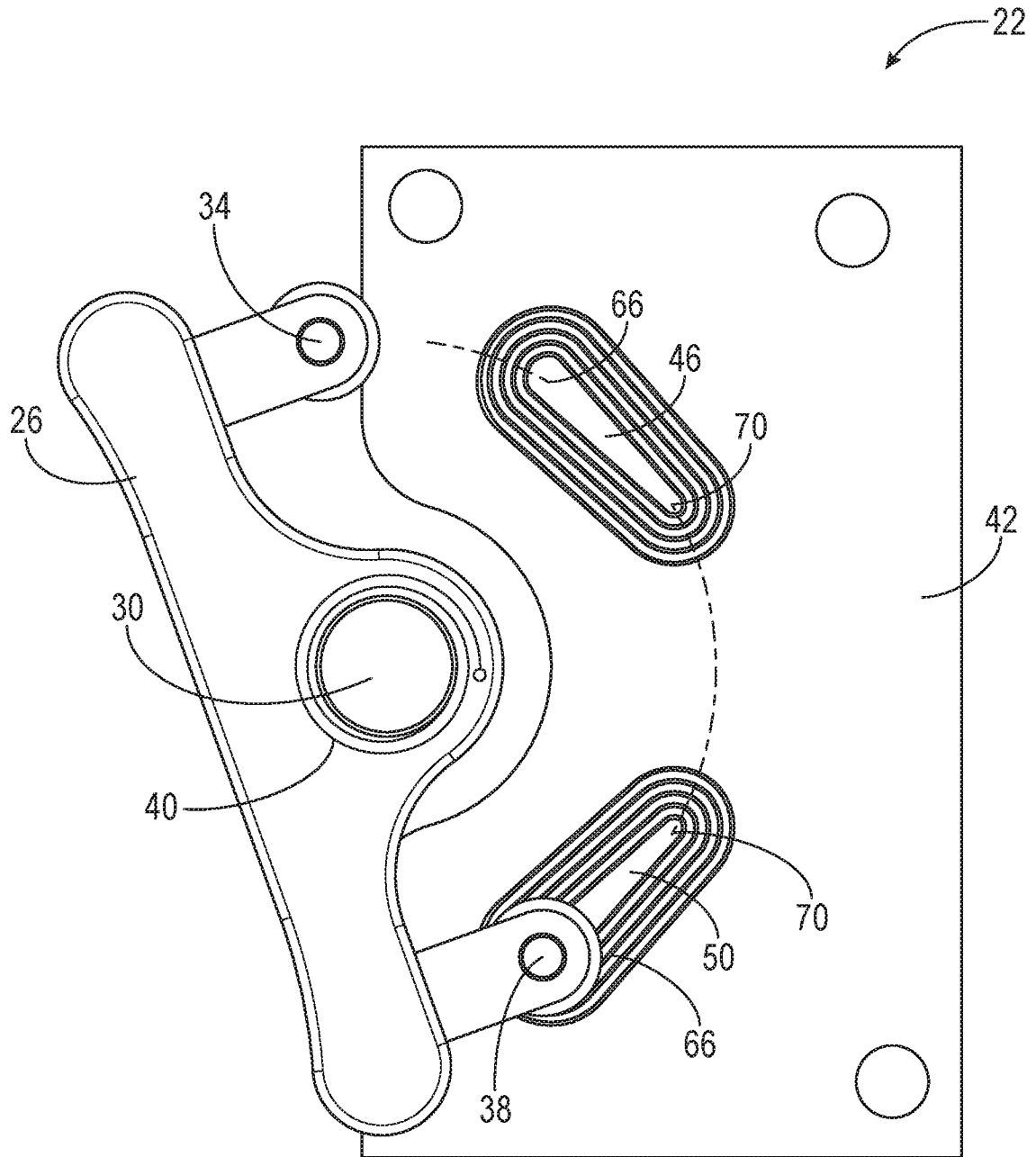
2/6



**FIG. 2**

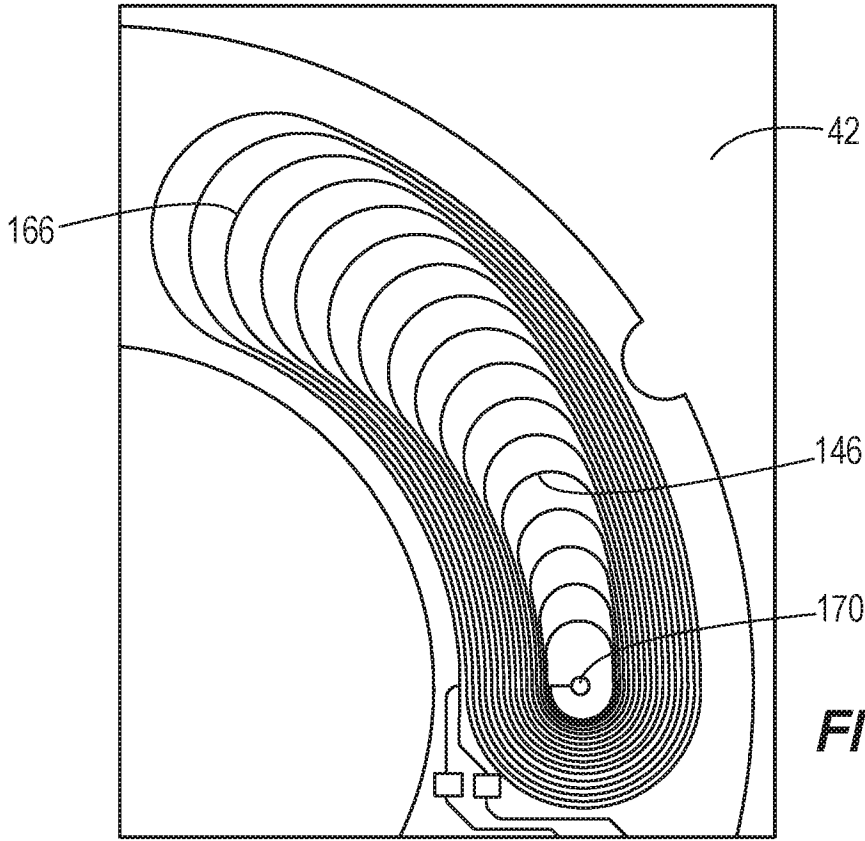


**FIG. 3**

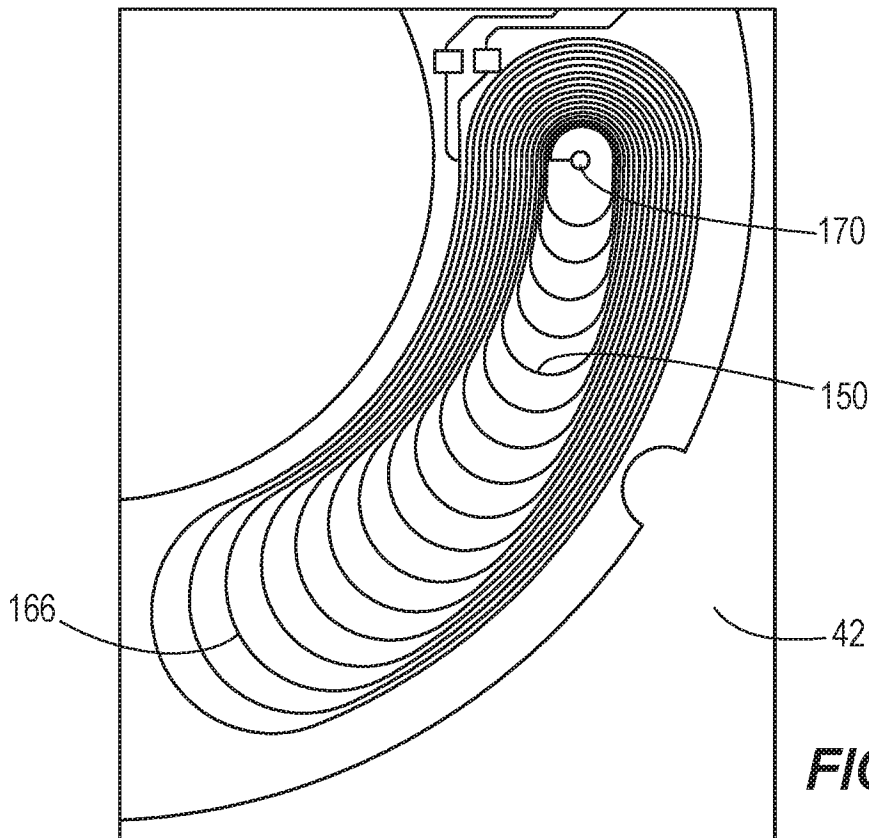


**FIG. 4**

4/6

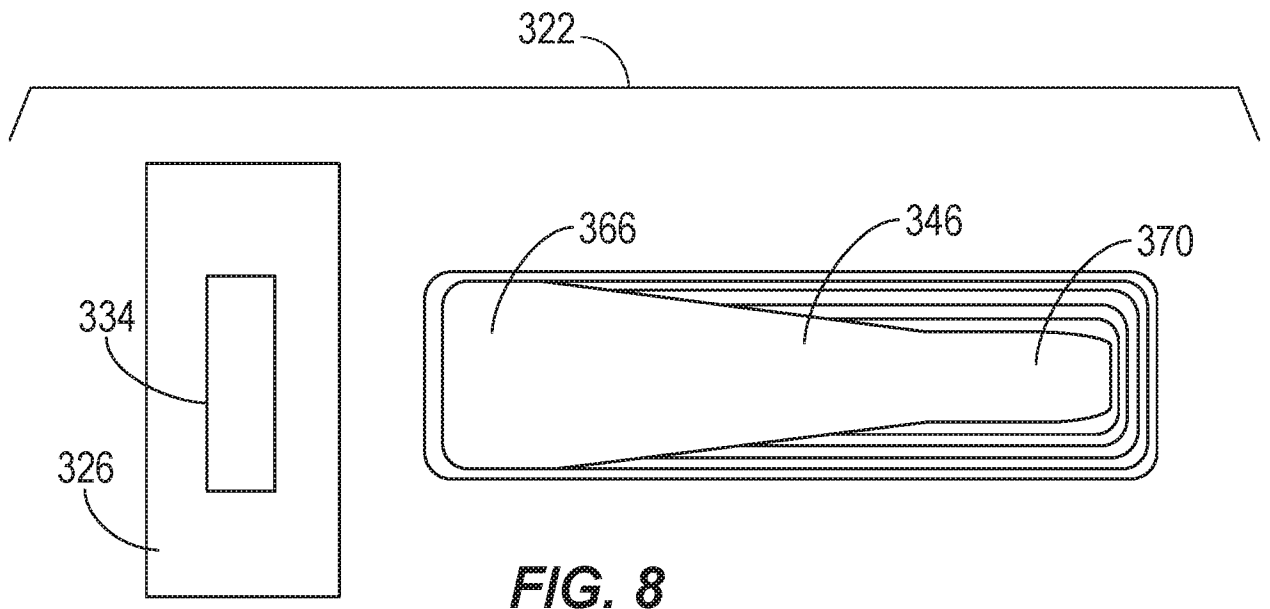
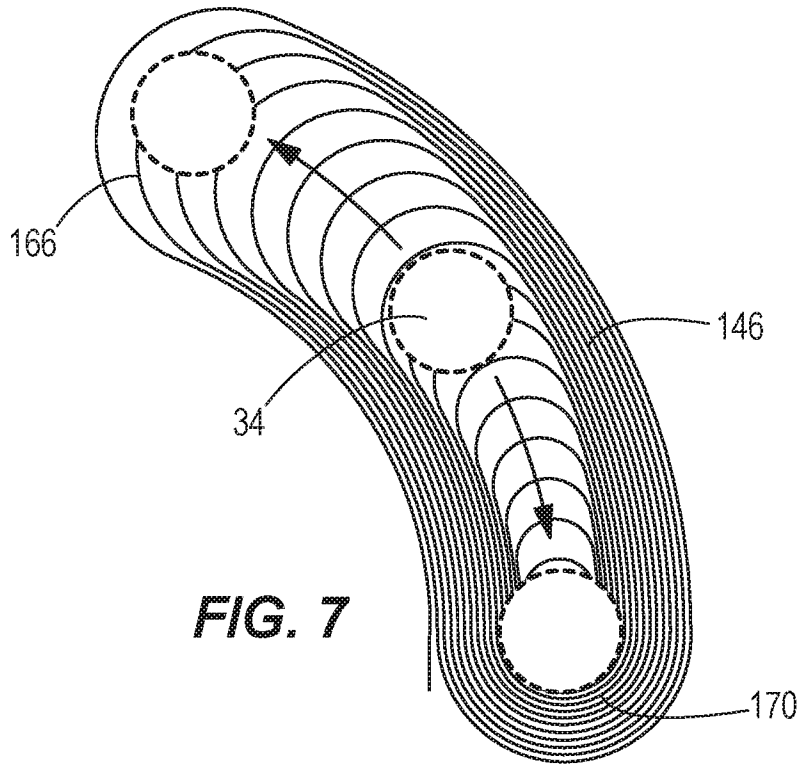


**FIG. 5**

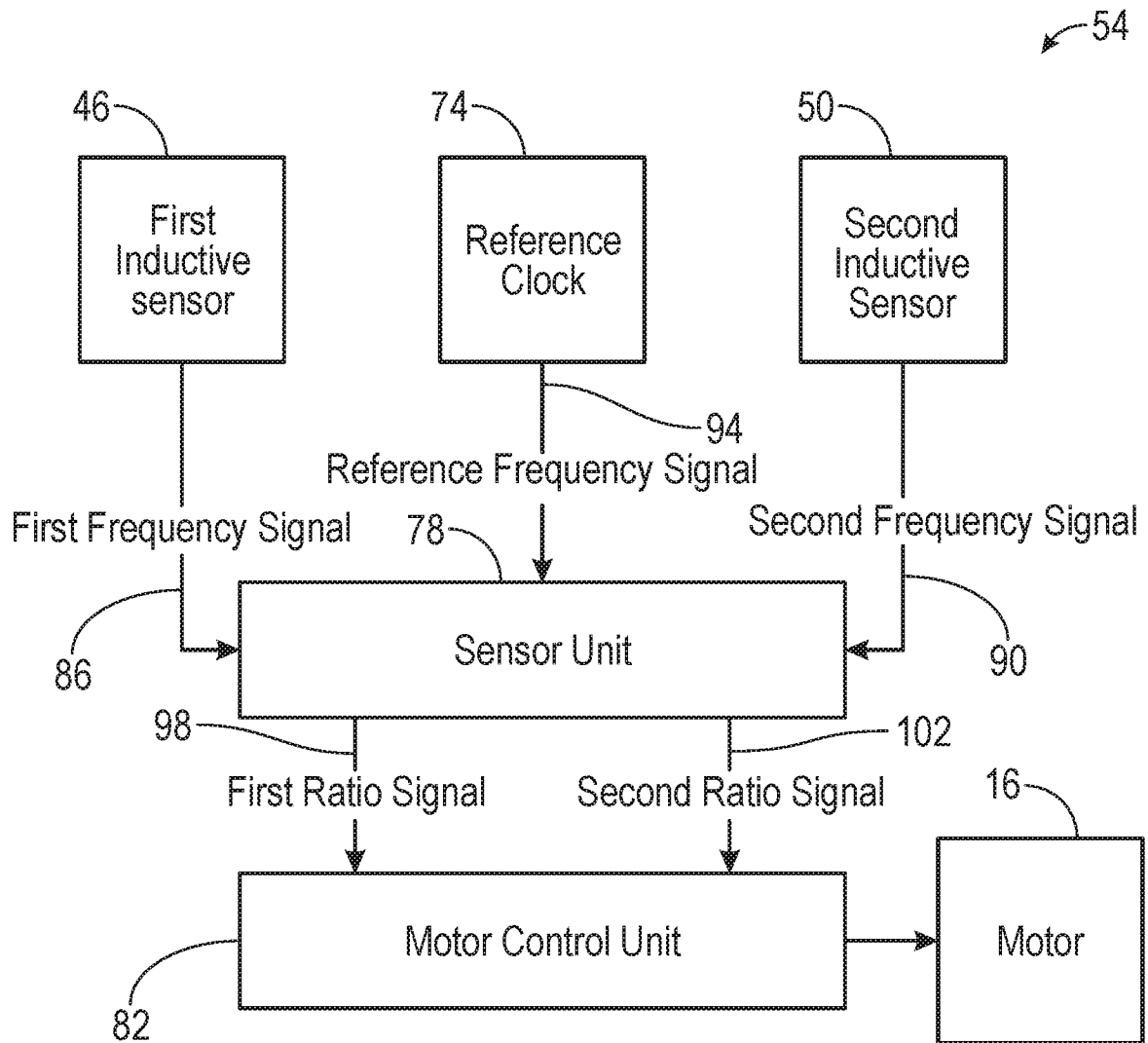


**FIG. 6**

5/6







**FIG. 9**

**A. CLASSIFICATION OF SUBJECT MATTER****B25F 5/00(2006.01)i, H01H 23/14(2006.01)i**

According to International Patent Classification (IPC) or to both national classification and IPC

**B. FIELDS SEARCHED**

Minimum documentation searched (classification system followed by classification symbols)

B25F 5/00; G01D 5/20; H02P 3/18; H01H 83/22; H02P 7/14; H02P 1/24; H01F 27/28; H01H 23/24; H02P 1/22; H01H 23/14

Documentation searched other than minimum documentation to the extent that such documents are included in the fields searched

Korean utility models and applications for utility models

Japanese utility models and applications for utility models

Electronic data base consulted during the international search (name of data base and, where practicable, search terms used)

eKOMPASS(KIPO internal) &amp; Keywords: electric motor, trigger, conductor, printed circuit board, inductive sensor

**C. DOCUMENTS CONSIDERED TO BE RELEVANT**

Category*	Citation of document, with indication, where appropriate, of the relevant passages	Relevant to claim No.
Y	US 4459522 A (HUBER, SIEGFRIED) 10 July 1984 See column 2, line 64 - column 5, line 35; and figures 1a-1c, 2-4.	1-18, 21-25
A		19-20
Y	US 2015-0369631 A1 (TEXAS INSTRUMENTS INCORPORATED) 24 December 2015 See paragraphs [0018]-[0035]; and figures 1-4.	1-18, 21-25
A	WO 2013-048776 A1 (SNAP-ON INCORPORATED et al.) 04 April 2013 See page 5, line 6 - page 15, line 3; and figures 1-6.	1-25
A	US 2013-0119915 A1 (PUSATERI et al.) 16 May 2013 See paragraphs [0021]-[0036]; and figures 1-8.	1-25
A	US 4543515 A (SUZUKI, MASARU) 24 September 1985 See column 3, line 19 - column 7, line 28; and figures 1-7.	1-25

 Further documents are listed in the continuation of Box C. See patent family annex.

\* Special categories of cited documents:

"A" document defining the general state of the art which is not considered to be of particular relevance

"E" earlier application or patent but published on or after the international filing date

"L" document which may throw doubts on priority claim(s) or which is cited to establish the publication date of another citation or other special reason (as specified)

"O" document referring to an oral disclosure, use, exhibition or other means

"P" document published prior to the international filing date but later than the priority date claimed

"T" later document published after the international filing date or priority date and not in conflict with the application but cited to understand the principle or theory underlying the invention

"X" document of particular relevance; the claimed invention cannot be considered novel or cannot be considered to involve an inventive step when the document is taken alone

"Y" document of particular relevance; the claimed invention cannot be considered to involve an inventive step when the document is combined with one or more other such documents, such combination being obvious to a person skilled in the art

"&amp;" document member of the same patent family

Date of the actual completion of the international search

03 January 2018 (03.01.2018)

Date of mailing of the international search report

**04 January 2018 (04.01.2018)**

Name and mailing address of the ISA/KR

International Application Division

Korean Intellectual Property Office

189 Cheongsa-ro, Seo-gu, Daejeon, 35208, Republic of Korea

Facsimile No. +82-42-481-8578

Authorized officer

LEE, Jong Kyung

Telephone No. +82-42-481-3360



**INTERNATIONAL SEARCH REPORT**

Information on patent family members

International application No.

**PCT/US2017/053215**

Patent document cited in search report	Publication date	Patent family member(s)	Publication date
US 4459522 A	10/07/1984	DE 000003201036 A1	28/07/1983
US 2015-0369631 A1	24/12/2015	None	
WO 2013-048776 A1	04/04/2013	AU 2012-316545 A1 AU 2012-316545 A8 AU 2012-316545 B2 AU 2012-316545 B8 CA 2846401 A1 CA 2846401 C CN 103843096 A CN 103843096 B GB 2509469 A HK 1199141 A1 TW 201328822 A TW I581908 B US 2013-0082816 A1 US 2013-0285789 A1 US 8493172 B2 US 8665058 B2	13/03/2014 20/03/2014 30/07/2015 06/08/2015 04/04/2013 08/11/2016 04/06/2014 29/03/2017 02/07/2014 19/06/2015 16/07/2013 11/05/2017 04/04/2013 31/10/2013 23/07/2013 04/03/2014
US 2013-0119915 A1	16/05/2013	AU 2012-336085 A1 AU 2012-336085 B2 CA 2851162 A1 CA 2851162 C CN 104488185 A CN 104488185 B GB 2509674 A TW 201335964 A TW I474356 B US 8716962 B2 WO 2013-070580 A2 WO 2013-070580 A3	10/04/2014 24/09/2015 16/05/2013 06/06/2017 01/04/2015 24/05/2017 09/07/2014 01/09/2013 21/02/2015 06/05/2014 16/05/2013 11/06/2015
US 4543515 A	24/09/1985	JP 60-003817 A	10/01/1985