

(21) Application No: 1414738.3
(22) Date of Filing: 19.08.2014

(51) INT CL: F16B 7/14 (2006.01) B25G 3/28 (2006.01)

(71) Applicant(s):
Thomas Lin
No 18 Wei 6th Road, Wuci Township,
Taichung County 435, Taiwan

(56) Documents Cited:
GB 2445928 A US 20090047065 A1
US 20030213330 A1

(72) Inventor(s):
Thomas Lin

(58) Field of Search:
INT CL A01G, B25G, F16B
Other: EPODOC, WPI

(74) Agent and/or Address for Service:
Marks & Clerk LLP
Alpha Tower, Suffolk Street Queensway,
BIRMINGHAM, B1 1TT, United Kingdom

(54) Title of the Invention: **Rotary extension rod**
Abstract Title: **Extending rods with internal rotational expanding locking mechanism**

(57) A telescopic outer 20 and inner 30 rod assembly includes a knob or handle 41, fixing seat or bracket 42 and link bar 43. The handle 41 is at one end of the outer tube and can be swiveled between locked and unlocked position. Seat 42 is fixed to one end of the inner tube. Link 43 is connected at one end to the twisting handle 41, passing through seat 42 at its other end, and has two opposite first protrusions 432 on its outer surface. A locking positioning ring 50, mounted around the bracket 42 with link 43 passing through it, has two oppositely arranged wedges 62 formed on its inner surface. In the locking position first protrusions 432 on link 43 abut the second upstanding tabs of ring 50, expanding the ring's outer face against the inner wall of the outer tube (fig.5). When unlocked, protrusions 432 of link 43 depart from the positioning ring's raised keys 62, shrinking the locking ring's outer surface from the inner wall of the outer tube (fig.8). Band 50 may have retaining nodes next to the second protrusions (64, fig.5). When locked, link 43 abuts these retaining slots. Locking ring 50 may include a friction member (70, fig.5) on its outer surface and the ring may be C shaped. There may be guide blocks 24 situated on an end cap 22. Knob 41 may contain a curved channel (412, fig.4) which cooperates with the guide blocks to stop its over rotation.

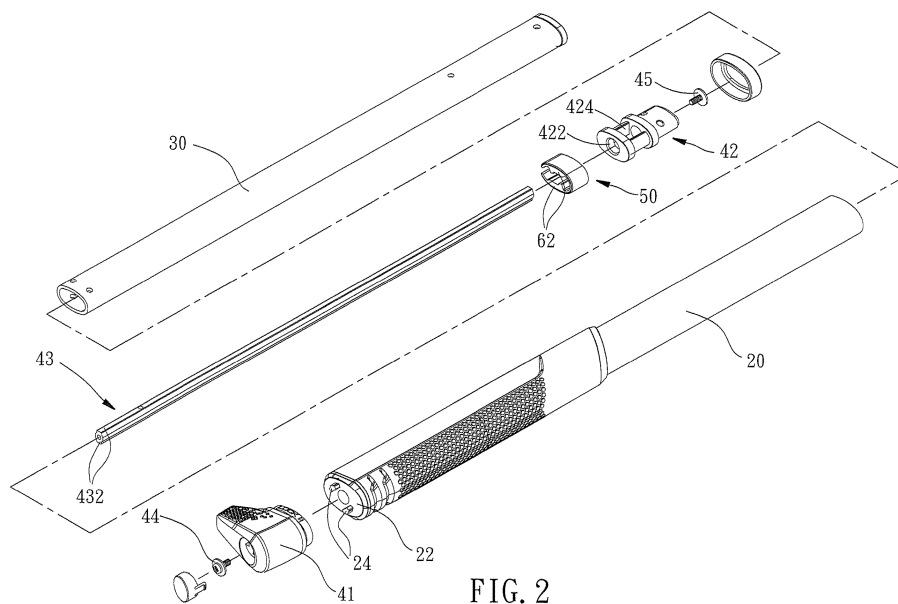

FIG. 2

1/1

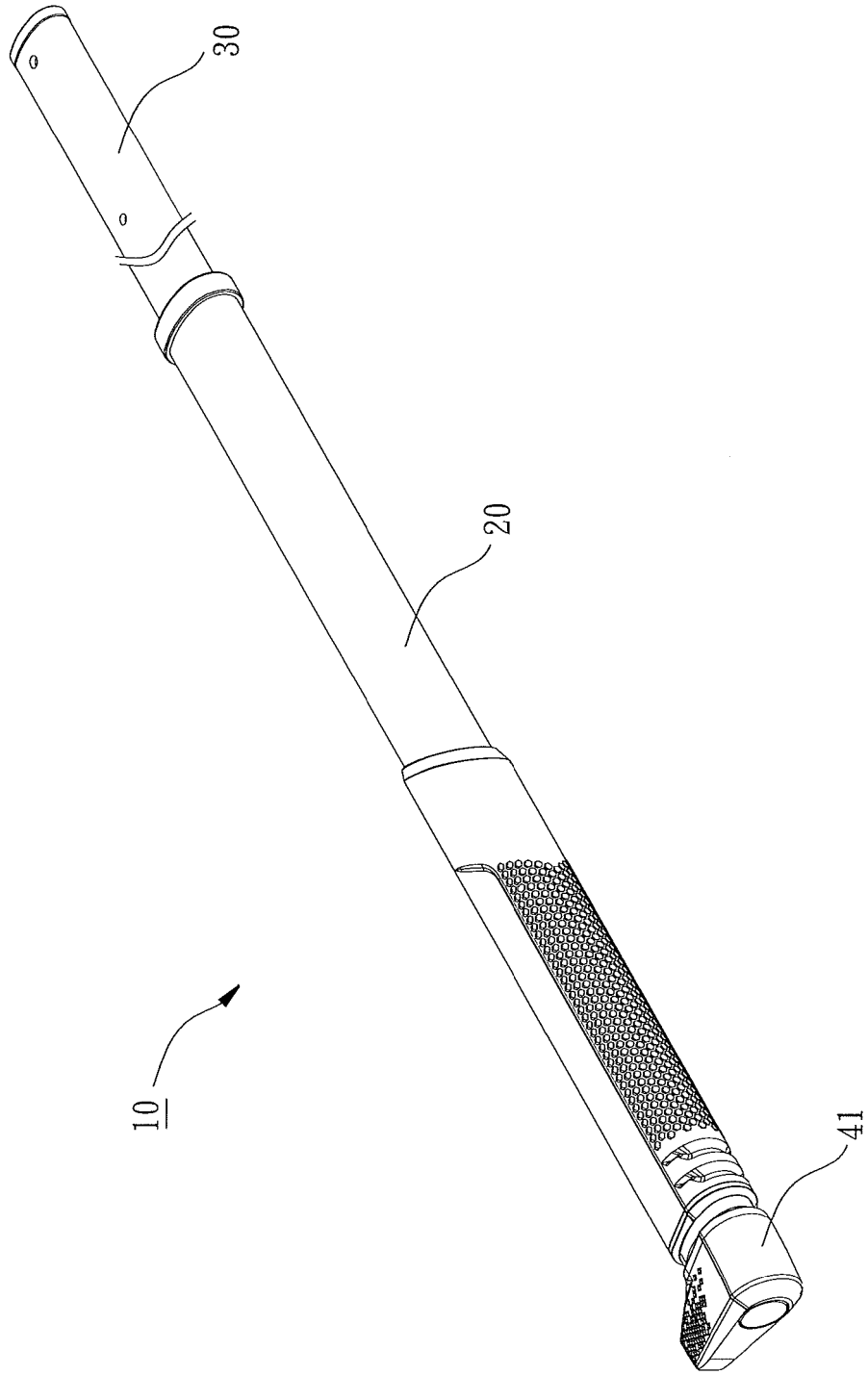

FIG. 1

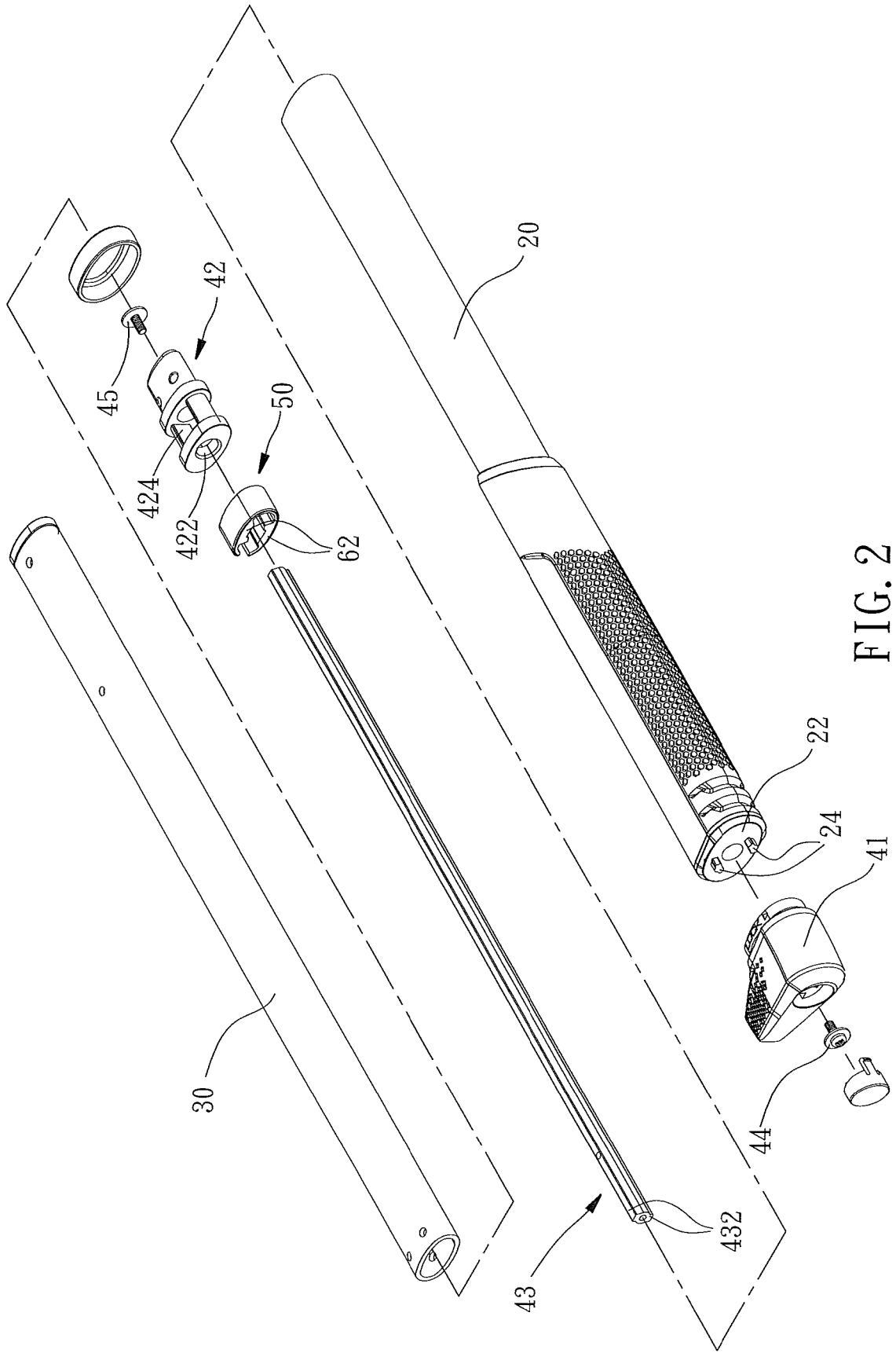

FIG. 2

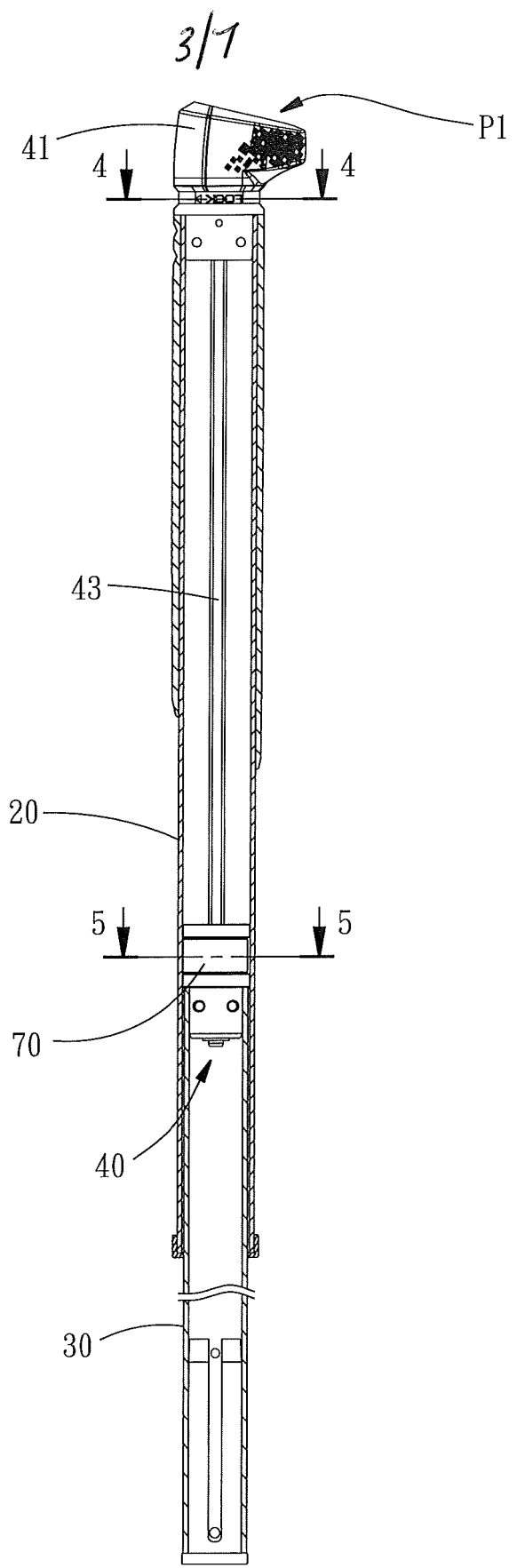

FIG. 3

4/7

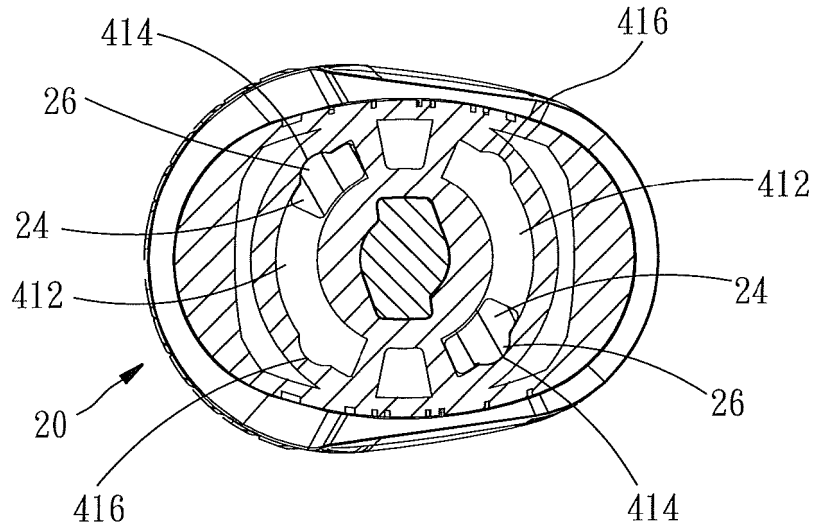

FIG. 4

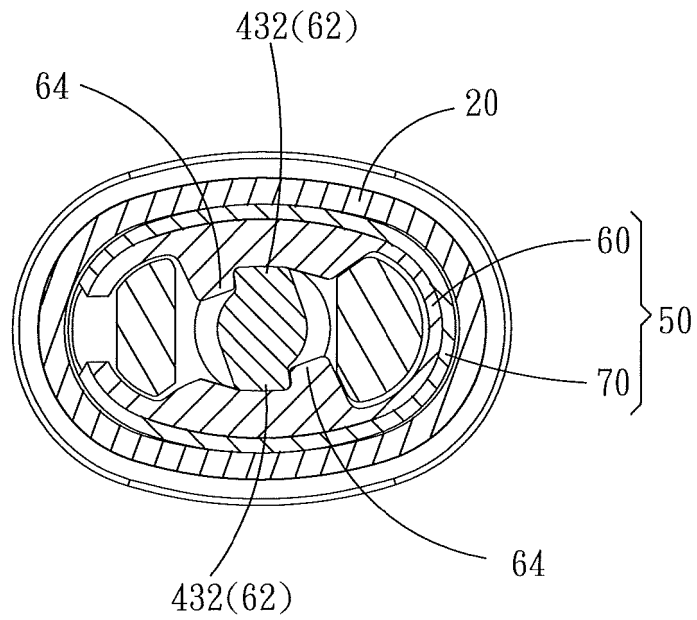

FIG. 5

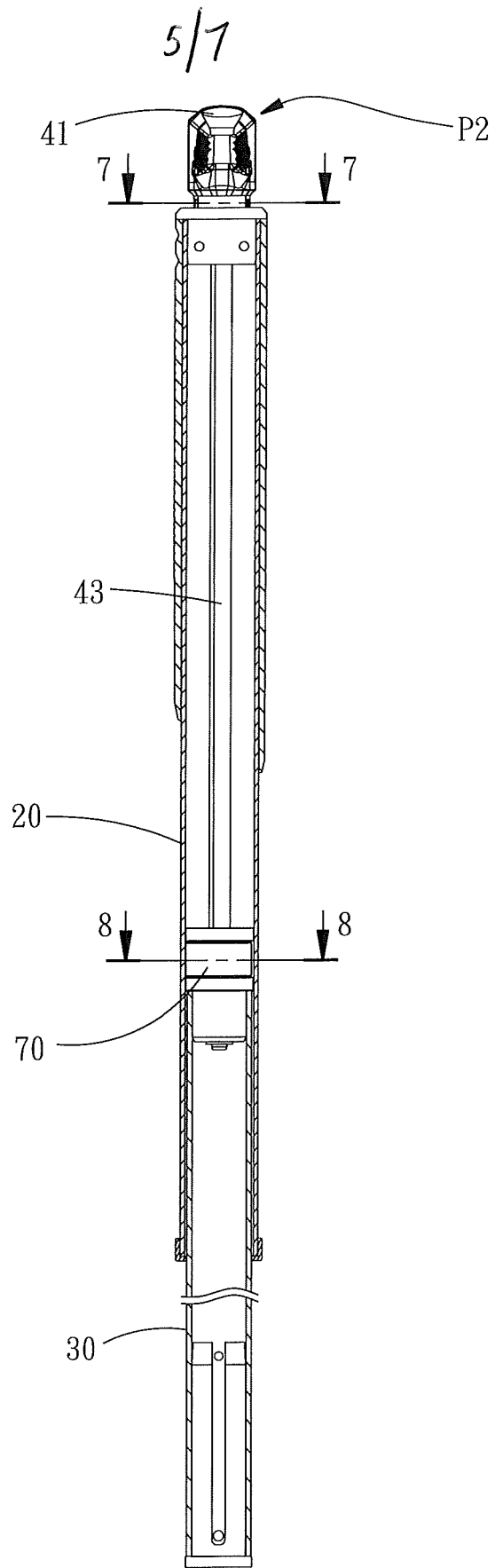

FIG. 6

6/7

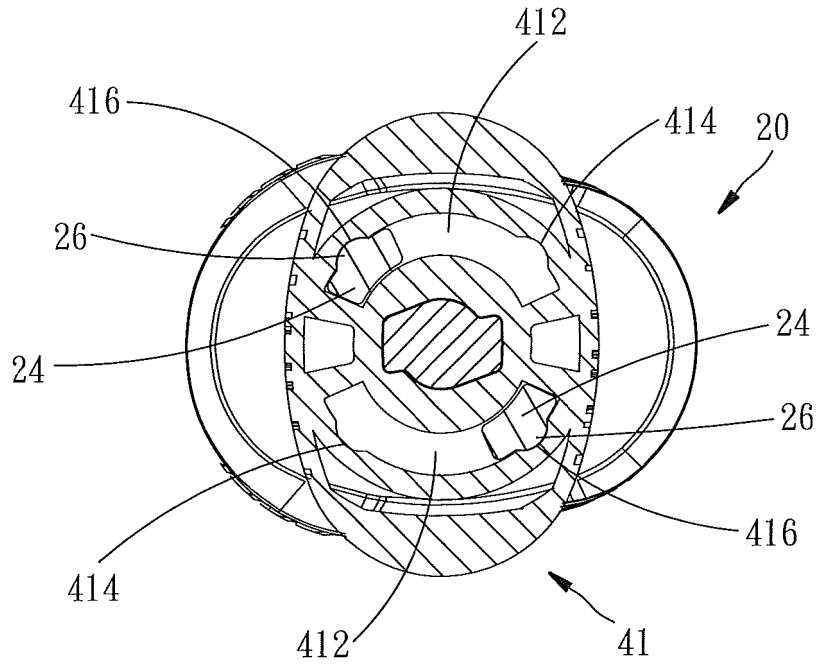

FIG. 7

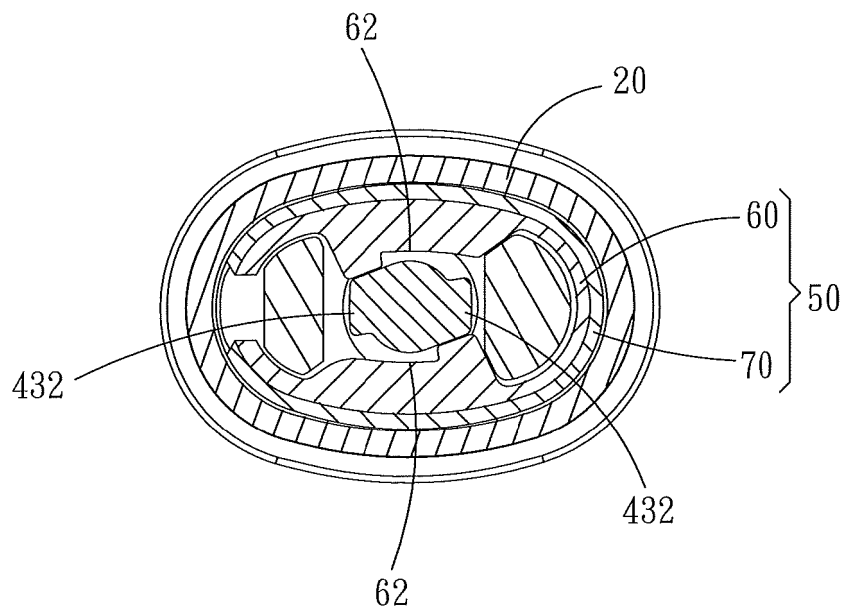

FIG. 8

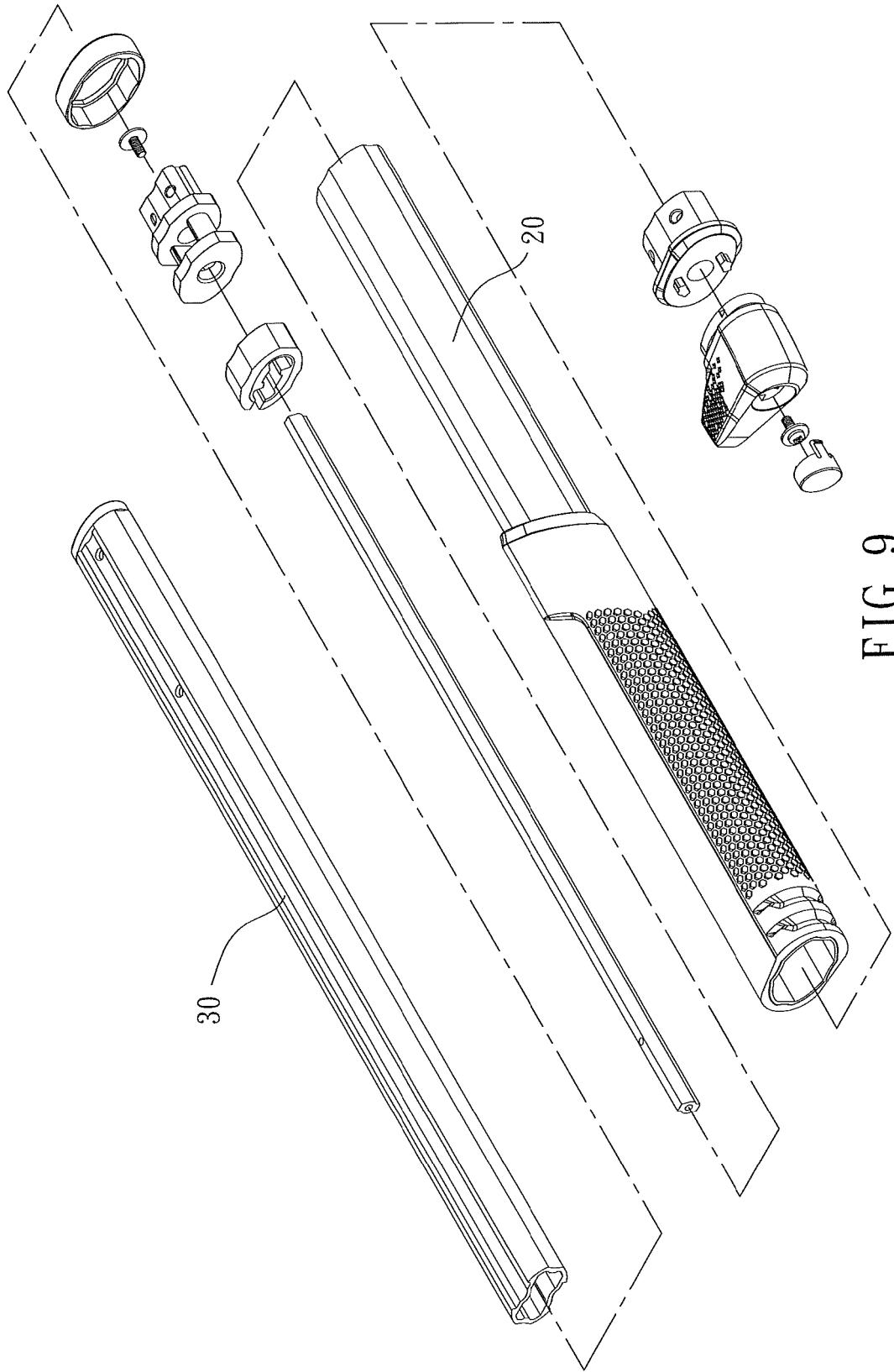

FIG. 9

ROTARY EXTENSION ROD

BACKGROUND OF THE INVENTION

[0001] 1. Technical Field

[0002] The present invention relates to extension rods used with hand tools, and more particularly, to a rotary extension rod.

[0003] 2. Description of Related Art

[0004] For providing various levels of reach and convenient use, many hand tools (such as garden shears) are designed to work with an extension rod so as to be adjustable in length. For example, one prior-art patent owned by the applicant, Taiwan Patent No. M268476, has disclosed an extension rod that uses a knob to control a rotatory member to deflect. When the major-radius portions of the rotatory member press against the inner wall of the positioning ring, the rubber part of the positioning ring abuts against the inner wall of the outer tube and prevents the outer tube from moving with respect to the inner tube, thereby providing positioning effect. When the major-radius portions of rotatory member separate from the inner wall of the positioning ring, the rubber part of the positioning ring leaves from the inner wall of the outer tube, thereby allowing the outer tube to be repositioned as desired.

[0005] However, in practical use, the major-radius portions of the rotatory member and the inner wall of the positioning ring hardly contact with each other as expected. As a result, the positioning ring is not effectively opened wide by the rotatory member and the friction to the outer tube is therefore impaired. Consequently, when the outer tube receives a relatively large axial force, the tubes tend to slide and the total length of the inner and outer tubes of the known extension rod is likely to unexpectedly change in use. Hence, the prior art needs to be improved.

SUMMARY OF THE INVENTION

[0006] The primary objective of the present invention is to provide a rotary extension rod that is configured to secure the relative position of its inner and outer tubes, and thereby its overall length, as adjusted.

[0007] For achieving the foregoing objective, the disclosed rotary extension rod comprises an outer tube, an inner tube, a rotatable assembly, and a positioning ring. The inner tube has one end passing through the outer tube in an axially movable manner. The rotatable assembly includes a knob, a fixing seat, and a link. The knob is rotatably deposited at one end of the outer tube. The fixing seat is received in the outer tube and fixed to one end of the inner tube. The link has one end fixed to the knob and an opposite end rotatably deposited in the fixing seat, so that the link can be driven by the knob. The outer periphery of the link is provided with two opposite first radially raised portions. The positioning ring is mounted on the fixing seat and has the link passing therethrough. The inner annular surface of the positioning ring is provided with two opposite second radially raised portions.

[0008] Thereby, when the knob is at the locking position, the first radially raised portions of the link abut against the second radially raised portions of the positioning ring, so that the outer annular surface of the positioning ring presses against the inner wall of the outer tube. At this time, the inner and outer tubes are relatively positioned. When the knob is at the releasing position, the first radially raised portions of the link depart from the second radially raised portions of the positioning ring, so that the outer annular surface of the positioning ring separates from the inner wall of the outer tube, thereby allowing the relative position of the inner and outer tubes, or the overall length of the extension rod, to be adjusted.

BRIEF DESCRIPTION OF THE DRAWINGS

[0009] FIG. 1 is a perspective view of a first embodiment of the present invention.

[0010] FIG. 2 is an exploded view of the first embodiment of the present invention.

[0011] FIG. 3 is a lengthwise cross-sectional view of the first embodiment of the present invention, showing the knob at its locking position.

[0012] FIG. 4 is a cross-sectional view taken along Line 4-4 of FIG. 3.

[0013] FIG. 5 is a cross-sectional view taken along Line 5-5 of FIG. 3.

[0014] FIG. 6, similar to FIG. 3, shows the knob at its releasing position.

[0015] FIG. 7 is a cross-sectional view taken along Line 7-7 of FIG. 6.

[0016] FIG. 8 is a cross-sectional view taken along Line 8-8 of FIG. 6.

[0017] FIG. 9 is an exploded view of a second embodiment of the present invention.

DETAILED DESCRIPTION OF THE INVENTION

[0018] Referring to FIG. 1 and FIG. 2, according to the present invention, an extension rod 10 is designed to work with a hand tool (such as garden shears), and structurally comprises an outer tube 20, an inner tube 30, a rotatable assembly 40, and a positioning ring 50.

[0019] The outer tube 20 may have an elliptic sectional shape. The outer tube 20 has one end covered by an end cap 22. The end cap 22 has its outer end formed with two opposite guiding blocks 24. Each of the guiding blocks 24 has a positioning node 26 formed on its outer periphery.

[0020] The inner tube 30 may also have an elliptic sectional shape. The inner tube 30 is inserted into the outer tube 20 from an opposite end of the outer tube 20, and can move with respect to the outer tube 20 under an external force.

[0021] The rotatable assembly 40 includes a knob 41. The knob 41 has its inner end surface formed with two opposite curved channels 412, as shown in FIG. 4 and FIG. 7. Each of the curved channels 412 has two ends that are provided with a first positioning indentation 414 and a second positioning indentation 416, respectively. To assemble the components, the curved channel 412 engages with the guiding blocks 24 on the end cap 22

of the outer tube 20, so that the knob 41 can move with respect to the outer tube 20 between a locking position P1 and a releasing position P2. When the knob 41 is at the locking position P1, as shown in FIG. 3 and FIG. 4, the first positioning indentation 414 of curved channel 412 of the knob 41 engages with the positioning node 26 of the end cap 22 of the outer tube 20. When the knob 41 is at the releasing position P2, as shown in FIG. 6 and FIG. 7, the second positioning indentation 416 of the curved channel 412 of the knob 41 engages with the positioning node 26 of the end cap 22 of the outer tube 20. In addition, the rotatable assembly 40 further has a fixing seat 42 and a link 43. The fixing seat 42 is set in the outer tube 20 and fixed to one end of the inner tube 30, while having an axial hole 422 and a hollowed-out portion 424 communicated with the axial hole 422. The link 43 has its outer periphery formed with two opposite first radially raised portions 432. The link 43 is inserted into the outer tube 20 and has one end fixed to the knob 41 by a screw 44, so that the link 43 can be synchronously driven by the knob 41. The link 43 has its opposite end rotatably passing through the axial hole 422 of the fixing seat 42, and another screw 45 is used to secure the combination between the link 43 and the fixing seat 42, so that the fixing seat 42 does not rotate with the link 43.

[0022] The positioning ring 50 has a C-like sectional shape and includes a supporting member 60 and a friction member 70, as shown in FIG. 5 and FIG. 8. The supporting member 60 has two opposite second radially raised portions 62 on its inner annular surface. Each of the second radially raised portions 62 is next to a retaining portion 64. The friction member 70 stays close to the outer annular surface of the supporting member 60, for providing friction to the inner wall of the outer tube 20. The positioning ring 50 is mounted around the fixing seat 42, so that the second radially raised portions 62 and the retaining portions 64 of the supporting member 60 of the positioning ring 50 are inlaid in the hollowed-out portion 424 of the fixing seat 42 (as shown in FIG. 2). It is to be noted that the supporting member 60 is preferably made of a rigid material,

such as metal, fiber-reinforced plastic and hardened plastic. The friction member 70 is preferably made of a soft material with high friction coefficient, such as plastic and rubber. The components may be combined by gluing or overmolding.

[0023] For adjusting the relative position of the outer tube 20 and the inner tube 30, the knob 41 is first rotated to the releasing position P2 as shown in FIG. 6. At this time, the knob 41 drives the link 43 to rotate with respect to the positioning ring 50, making the first radially raised portions 432 of the link 43 leaving from the second radially raised portions 62 of the supporting member 60 of the positioning ring 50, as shown in FIG. 8. Thereby, the outer annular surface of the friction member 70 of the positioning ring 50 release the inner wall of the outer tube 20 from press, so the outer tube 20 can be moved with respect to the inner tube 30 to change the overall length of the extension rod.

[0024] When the outer tube 20 is positioned as desired, the knob 41 is rotated to the locking position P1 as shown in FIG. 3, where the first radially raised portions 432 of the link 43 press against the second radially raised portions 62 of the supporting member 60 of the positioning ring 50, and the first radially raised portions 432 of the link 43 abut against the retaining portions 64 of the supporting member 60 of the positioning ring 50. At this time, the positioning ring 50 is radially expanded, with the outer annular surface of the friction member 70 pressing against the inner wall of the outer tube 20, thereby holding the outer tube 20 in position.

[0025] To sum up, with the cooperation between the first radially raised portions 432 of the link 43 and the second radially raised portions 62 of the positioning ring 50, the contact between the link 43 and the positioning ring 50 is significantly improved, so that the positioning ring 50 and the outer tube 20 can be well positioned with respect to each other, in turn maintaining the relative position of the adjusted inner and outer tubes 30, 20. At last, it is to be noted that the outer tube 20 and the inner tube 30 may have the same sectional shape that is not elliptic (such as the polygonal shape as shown in FIG. 9), so as

to provide enhanced structural strength.

WHAT IS CLAIMED IS:

1. A rotary extension rod (10), comprising:

an outer tube (20);

an inner tube (30), received in the outer tube (20) in an axially movable manner;

a rotatable assembly (40), having a knob (41), a fixing seat (42), and a link (43); the

knob (41) being deposited at one end of the outer tube (20) and rotatable between a

locking position (P1) and a releasing position (P2); the fixing seat (42) being

received in the outer tube (20) and fixed to one end of the inner tube (30); and the

link (43) having one end fixed to the knob (41) and an opposite end rotatably

received in the fixing seat (42), and including two opposite first radially raised

portions (432) formed on an outer periphery thereof; and

a positioning ring (50), being mounted around the fixing seat (42) and having the link

(43) passing therethrough, and the positioning ring (50) further having two

opposite second radially raised portions (62) formed on an inner annular surface

thereof;

wherein, when the knob (41) is at the locking position (P1), the first radially raised

portions (432) of the link (43) abut against the second radially raised portions (62)

of the positioning ring (50), so that an outer annular surface of the positioning ring

(50) presses against an inner wall of the outer tube (20), and when the knob (41) is

at the releasing position (P2), the first radially raised portions (432) of the link (43)

depart from the second radially raised portions (62) of the positioning ring (50), so

as to make the outer annular surface of the positioning ring (50) separate from the

inner wall of the outer tube (20).

2. The rotary extension rod (10) of Claim 1, wherein the inner annular surface of the positioning ring (50) further has two opposite retaining portions (64), in which each said retaining portion (64) is next to one said second radially raised portion (62), so that when

the knob (41) is at the locking position (P1), the first radially raised portions (432) of the link (43) abut against the retaining portions (64) of the positioning ring (50).

3. The rotary extension rod (10) of Claim 1, wherein the positioning ring (50) has a supporting member (60) and a friction member (70), in which the supporting member (60) has the second radially raised portions (62) formed on an inner annular surface thereof, and the friction member (70) is formed on an outer annular surface of the supporting member (60).

4. The rotary extension rod (10) of Claim 3, wherein the inner annular surface of the supporting member (60) of the positioning ring (50) further has two opposite retaining portions (64), in which each said retaining portion (64) is next to one said second radially raised portion (62), so that when the knob (41) is at the locking position (P1), the first radially raised portions (432) of the link (43) abut against the retaining portions (64) of the supporting member (60) of the positioning ring (50).

5. The rotary extension rod (10) of any of Claims 1 through 4, wherein the positioning ring (50) has a C-like sectional shape.

6. The rotary extension rod (10) of Claim 1, wherein an end cap (22) is provided at one end of the outer tube (20), and the end cap (22) has an outer end surface provided with a guiding block (24), the guiding block (24) having a positioning node (26) formed on an outer periphery thereof, the knob (41) having a curved channel (412) formed on an inner end surface thereof, the curved channel (412) receiving the guiding block (24) of the end cap (22), and the curved channel (412) having two ends thereof provided with a first positioning indentation (414) and a second positioning indentation (416), respectively, so that when the knob (41) is at the locking position (P1), the first positioning indentation (414) of the channel of the knob (41) engages with the positioning node (26) of the end cap (22) of the outer tube (20), and when the knob (41) is at the releasing position (P2),

the second positioning indentation (416) of the channel of the knob (41) engages with the positioning node (26) of the end cap (22) of the outer tube (20).

7. A rotary extension rod substantially as hereinbefore described with reference to the accompanying drawings.

WHAT IS CLAIMED IS:

I. A rotary extension rod (10), comprising:

an outer tube (20);

an inner tube (30), received in the outer tube (20) in an axially movable manner;

a rotatable assembly (40), having a knob (41), a fixing seat (42), and a link (43); the

knob (41) being deposited at one end of the outer tube (20) and rotatable between a

locking position (P1) and a releasing position (P2); the fixing seat (42) being

received in the outer tube (20) and fixed to one end of the inner tube (30), the

fixing seat (42) having an axial hole (422) for the link (43) to extend therethrough

and two axial rods defining a hollowed-out portion (424) communicated with the

axial hole (422); and the link (43) having one end fixed to the knob (41) and an

opposite end rotatably received in the fixing seat (42) and located between the two

axial rods, and including two opposite first radially raised portions (432) formed

on an outer periphery thereof; and

a positioning ring (50), being mounted around the fixing seat (42) and having the link

(43) passing therethrough, and the positioning ring (50) further having two

opposite second radially raised portions (62) formed on an inner annular surface

thereof, the positioning ring (50) having a C-like sectional shape and being adapted

to clamp the two axial rods of the fixing seat (42) therein;

wherein, when the knob (41) is at the locking position (P1), the first radially raised

portions (432) of the link (43) abut against the second radially raised portions (62)

of the positioning ring (50), so that an outer annular surface of the positioning ring

(50) presses against an inner wall of the outer tube (20), and when the knob (41) is

at the releasing position (P2), the first radially raised portions (432) of the link (43)

depart from the second radially raised portions (62) of the positioning ring (50), so

as to make the outer annular surface of the positioning ring (50) separate from the inner wall of the outer tube (20).

2. The rotary extension rod (10) of Claim 1, wherein the inner annular surface of the positioning ring (50) further has two opposite retaining portions (64), in which each said retaining portion (64) is next to one said second radially raised portion (62), so that when the knob (41) is at the locking position (P1), the first radially raised portions (432) of the link (43) abut against the retaining portions (64) of the positioning ring (50).

3. The rotary extension rod (10) of Claim 1, wherein the positioning ring (50) has a supporting member (60) and a friction member (70), in which the supporting member (60) has the second radially raised portions (62) formed on an inner annular surface thereof, and the friction member (70) is formed on an outer annular surface of the supporting member (60).

4. The rotary extension rod (10) of Claim 3, wherein the inner annular surface of the supporting member (60) of the positioning ring (50) further has two opposite retaining portions (64), in which each said retaining portion (64) is next to one said second radially raised portion (62), so that when the knob (41) is at the locking position (P1), the first radially raised portions (432) of the link (43) abut against the retaining portions (64) of the supporting member (60) of the positioning ring (50).

5. The rotary extension rod (10) of Claim 1, wherein an end cap (22) is provided at one end of the outer tube (20), and the end cap (22) has an outer end surface provided with a guiding block (24), the guiding block (24) having a positioning node (26) formed on an outer periphery thereof, the knob (41) having a curved channel (412) formed on an inner end surface thereof, the curved channel (412) receiving the guiding block (24) of the end cap (22), and the curved channel (412) having two ends thereof provided with a first positioning indentation (414) and a second positioning indentation (416), respectively, so that when the knob (41) is at the locking position (P1), the first positioning indentation

(414) of the channel of the knob (41) engages with the positioning node (26) of the end cap (22) of the outer tube (20), and when the knob (41) is at the releasing position (P2), the second positioning indentation (416) of the channel of the knob (41) engages with the positioning node (26) of the end cap (22) of the outer tube (20).

09 11 15



Application No: GB1414738.3

Examiner: Mr Daniel Davies

Claims searched: 1-6

Date of search: 18 December 2014

Patents Act 1977: Search Report under Section 17

Documents considered to be relevant:

Category	Relevant to claims	Identity of document and passage or figure of particular relevance
X	1, 2 & 4-6	GB 2445928 A (HO CHENG GARDEN TOOLS CO LTD) See abstract; figs. 1-8; pages 3, 4 & 6-9
X	1 & 6	US 2009/0047065 A1 (CHENG) See abstract; figs. 6, 8-10; para. [0010] & [0028]
X	1 & 3	US 2003/0213330 A1 (WANG) See abstract; figs 1, 3-5; para. [0008], [0009] & [0022]-[0027]

Categories:

X	Document indicating lack of novelty or inventive step	A	Document indicating technological background and/or state of the art.
Y	Document indicating lack of inventive step if combined with one or more other documents of same category.	P	Document published on or after the declared priority date but before the filing date of this invention.
&	Member of the same patent family	E	Patent document published on or after, but with priority date earlier than, the filing date of this application.

Field of Search:

Search of GB, EP, WO & US patent documents classified in the following areas of the UKC^X :

Worldwide search of patent documents classified in the following areas of the IPC

A01G; B25G; F16B

The following online and other databases have been used in the preparation of this search report

EPODOC, WPI

International Classification:

Subclass	Subgroup	Valid From
F16B	0007/14	01/01/2006
B25G	0003/28	01/01/2006