

FOR THE PURPOSES OF INFORMATION ONLY

Codes used to identify States party to the PCT on the front pages of pamphlets publishing international applications under the PCT.

AT	Austria	FR	France	ML	Mali
AU	Australia	GA	Gabon	MR	Mauritania
BB	Barbados	GB	United Kingdom	MW	Malawi
BE	Belgium	HU	Hungary	NL	Netherlands
BG	Bulgaria	IT	Italy	NO	Norway
BJ	Benin	JP	Japan	RO	Romania
BR	Brazil	KP	Democratic People's Republic of Korea	SD	Sudan
CF	Central African Republic	KR	Republic of Korea	SE	Sweden
CG	Congo	LI	Liechtenstein	SN	Senegal
CH	Switzerland	LK	Sri Lanka	SU	Soviet Union
CM	Cameroon	LU	Luxembourg	TD	Chad
DE	Germany, Federal Republic of	MC	Monaco	TG	Togo
DK	Denmark	MG	Madagascar	US	United States of America
FI	Finland				

NEEDLE GUARD

This application is a continuation in part application of concurrently pending applications
5 entitled "COMBINATION NEEDLE SHIELD/NEEDLE GUARD DEVICE POSITIVELY LOCKED ONTO DETACHABLE NEEDLE ASSEMBLIES FOR AN EVACUATED BLOOD COLLECTION SYSTEM AND HYPODERMIC SYRINGE" and "COMBINATION NEEDLE
10 SHIELD/NEEDLE GUARD DEVICE FOR A HYPODERMIC SYRINGE WITH A PERMANENTLY ATTACHED NEEDLE", assigned Serial Nos. 918,020, 919,373, filed on October 14, 1986, October 16, 1986, respectively, and describing inventions by the present inventors.

15 Background of the Invention

1. Field of the Invention

The present invention relates to a guard device
20 for hypodermic needles and, more particularly, to guard devices for single and double ended needles.

2. Description of the Prior Art

25 A needle shield which must be removed from a needle hub before a syringe needle can be used for a medical procedure is described in each of United States Patents Nos. 3,381,813, 3,934,722, 4,113,090 and 4,121,588. Each of these removable needle
30 shields reveals several limitations, including: (1) after a liquid medicament has been drawn up in a

syringe, medical personnel may occasionally delay the administration of the medicament, which delay requires retrieval and replacement of the needle shield to prevent contamination of the sterile needle and creates extra steps for busy medical personnel;

5 (2) medical personnel often remove this needle shield by holding the needle shield between their teeth or lips. This practice has been associated with accidental self-puncture in the face or other bodily parts; (3) in order to re-cover a used needle with a previously removed needle shield, it is necessary to replace the needle shield back over the pointed end of the used needle, which replacement increases the risk to medical personnel of accidentally puncturing themselves with the pointed end of the used needle;

10 and, (4) if the needle has been accidentally bent during a medical procedure or if the needle shield is replaced over the needle at an incorrect angle, the needle point may inadvertently pierce the side of the needle shield and puncture the fingers or hand.

15
20

Other United States Patents have issued which are directed to aspects of the present invention. No. 4,425,120 describes a needle guard for a removable needle which guard is attached to a syringe barrel. To remove the detachable needle from the syringe barrel, it is necessary to recover the used needle with a separate needle shield, which recovery increases the risk of puncture to medical personnel by the used needle point. In addition, the needle shield has an open end, which precludes sterility of the needle. No. 4,139,009 describes four

25
30

longitudinal arms which are brought into lateral side-to-side contact with the intention of covering and protecting an enclosed needle. The front end of the cover and the lateral arms in side-to-side contact represent discontinuous locations which could permit microorganism penetration and contamination of the enclosed sterile needle. In addition, the arms in their normal unstressed condition are slightly bowed away from the longitudinal axis of the needle so that casual touching of the device could contaminate the needle through the interstices between the separated arms. When this device is pushed against a skin surface during the injection process, the arms must bow away from the longitudinal axis of the needle which bowing blocks visualization of the needle as it penetrates the skin and creates a hazard to the patient.

Various configurations of a double needle assembly are disclosed in United States Patents Nos. 3,734,080 and 3,931,815, 2,460,641, 4,154,229, 4,295,476, 4,295,477, 4,312,362 and 4,340,068 for use in conjunction with evacuated blood collection systems and having removable needle shields.

With a double ended needle the risk of accidental contact with or puncture by either needle is substantially increased. In addition to the inherent danger from two potentially contaminated needles, other problems attendant a double needle blood collection system exist. For example, the needle engaging threads and lock (if used) of a

normally reuseable container holder can become sufficiently worn to permit threaded disengagement during use. Such disengagement during the blood collection process exposes medical personnel to contact with or puncture by a potentially contaminated part of the posterior needle and the fluid being withdrawn. Withdrawal of blood in the blood collection process would also be interrupted. If the anterior needle is also inadvertently withdrawn, the potential for further exposure to contagious fluids exists.

After use, a single or a double ended needle assembly may contain, interiorly or exteriorly, a potentially infectious fluid which fluid may drip onto or otherwise come in contact with personnel, other equipment or a surface and pose a health hazard.

Summary of the Invention

A needle guard for a hypodermic needle attached to a syringe barrel includes an axially translatable generally cylindrical sleeve slidably secured to the syringe barrel and having a removable tab at the proximal end for developing an aperture to accommodate exteriorization of the contained needle. A locking mechanism interconnects the syringe barrel with the distal end of the sleeve for fixating the sleeve and shielding the needle prior to and subsequent to removal of the tab. After removal of the tab a guide mechanism accommodates translation of the sleeve along the barrel to expose the needle for

use; after use, the sleeve is slidable proximally to a locked position for receiving and containing the needle. All manipulation of the sleeve is from rearwardly of the needle to minimize the potential for accidental contact with the needle by medical personnel or other users of the hypodermic syringe. For double ended needles, an attached non-removable guard may be incorporated to extend over the anterior needle end and a further attached non-removable guard is extendable over the posterior needle end. Upon extension, either or both guards may be locked in place to prevent access to and further use of the potentially contaminated needle(s). To secure the double ended needle with the holder of a blood collection system, a further locking mechanism interconnecting the guard with the holder may be employed. A variant of the double needle assembly forming the present invention can accommodate an acute angular penetration of the blood vessel to be punctured despite a substantial girth that may be associated with the holder. Preferably, each needle guard, whether for a single or double ended needle, includes an annular trough for restraining outflow of fluid which may drip from the shielded needle. And, each needle guard is translatable between the retracted and extended position with one or two digits of one hand to leave free the other hand of a user.

It is therefore a primary object of the present invention to provide an attached non-removable needle guard for maintaining sterile a hypodermic needle

prior to use and for guarding the hypodermic needle against inadvertent contact by a user after use.

5 Another object of the present invention is to provide a syringe barrel mounted non-detachable guard for a hypodermic needle extending from the barrel which guard is manipulatable from a location rearwardly of the hypodermic needle.

10 Still another object of the present invention is to provide a device positionally lockable about a needle of a hypodermic syringe to prevent inadvertent contact with the needle and any fluids dripping therefrom.

15

Yet another object of the present invention is to provide apparatus for protecting a user of a hypodermic syringe or hypodermic needle, whether single or double, against accidental transmission of blood borne infections, such as AIDS, hepatitis, syphilis and other infectious diseases through contact with the needle .

20 A further object of the present invention is to provide a double ended needle assembly having a guard for circumscribingly enclosing the anterior and posterior needle ends prior to and after use.

25 A still further object of the present invention is to provide a guard lockable in place to prevent reuse of a hypodermic needle.

30

A yet further object of the present invention is to provide apparatus for precluding inadvertent disengagement of the double ended needle from the container holder during use.

5

A yet further object of the present invention is to provide guards for each end of a double ended needle assembly which are operable independently and from a location posterior of the needle end to be enclosed.

10

A yet further object of the present invention is to provide more shallow angle of access during blood withdrawal irrespective of the girth of the container holder or syringe barrel.

15

A yet further object of the present invention is to provide telescoping cylindrical segments of a needle guard which will allow enclosure of long needles without creating long and unwieldy needle assemblies.

20

These and other objects of the invention will become apparent to those skilled in the art as the description thereof proceeds.

25

Brief Description of the Drawings

The present invention will be described with greater specificity and clarity with reference to the following drawings, in which:

30

Figure 1 illustrates a hypodermic syringe having an attached needle guard;

Figure 2 illustrates the needle guard;

5

Figure 3 is a partial cross-sectional view taken along lines 3-3, as shown in Figure 2;

10

Figure 4 is a cutaway view of the upper end of the hypodermic syringe illustrated in Figure 1;

15

Figure 5 is a partial cross-sectional view of the syringe barrel taken along lines 5-5, as shown in Figure 4;

20

Figure 6 is a further partial cross-sectional view of the syringe barrel taken along lines 6-6, as shown in Figure 4;

Figure 7 illustrates a step in the use of the present invention;

25

Figure 8 illustrates a further step in the use of the present invention;

30

Figure 9 illustrates the primary components of a blood collection system employing a double ended needle;

Figure 10 illustrates a needle guard for a

double ended needle;

Figure 11 is a cross-sectional view taken along lines 11-11, as shown in Figure 10;

5

Figure 12 illustrates a needle guard protecting one needle end of a double ended needle prior to use of the needle;

10 Figure 13 illustrates an exploded view of the double ended needle and needle guard;

Figure 14 is a cross-sectional view taken along lines 14-14, as shown in Figure 11;

15

Figure 15 is a partial cross-sectional view taken along lines 15-15, as shown in Figure 13;

20 Figure 16 is a detailed view of the guide mechanism for the needle guard taken along lines 16-16 as shown in Figure 13;

Figure 17 is a cross-sectional view taken along lines 17-17, as shown in Figure 16;

25

Figure 18 is a cross-sectional view taken along lines 18-18, as shown in Figure 16;

30 Figure 19 illustrates further features of the guide mechanism for the needle guard;

Figure 20 illustrates a part of a lock mechanism

disposed upon and formed as part of a container holder;

5 Figure 21 is a cross-sectional view taken along lines 21-21, as shown in Figure 20;

Figure 22 is a detailed view illustrating the interconnection between a double ended needle and a container holder;

10

Figure 23 illustrates an initial step in the operation of a needle guard for a double ended needle;

15

Figure 24 illustrates a further step in the operation of a needle guard for a double ended needle;

20

Figure 25 illustrates a needle guard usable with a variant of a double ended needle;

Figure 26 illustrates the configuration of the double ended needle variant;

25

Figure 27 is a cross-sectional view illustrating the double ended needle variant in use;

Figure 28 illustrates a needle guard for use with a variant of a detachable single needle;

30

Figure 29 illustrates the needle guard in use with the detachable single needle variant;

Figure 30 illustrates a variant of the needle guard;

5 Figure 31 illustrates a variant of a double ended needle;

 Figure 32 is a partial cross-sectional view taken along lines 32-32, shown in Figure 31;

10

 Figures 33 and 34 illustrate apparatus embodying the present invention for withdrawing blood and delivery into a large sized container;

15 Figures 35, 36, 37, 38 and 39 illustrate the structure and operation of a telescoping variant of the present invention for a double ended needle;

 Figure 40 is a cross-sectional view taken along lines 40-40, as shown in Figure 38;

20

 Figure 41 is a partial cross-sectional view taken along lines 41-41, as shown in Figure 35;

25 Figures 42, 43, 44 and 45 illustrate the structure and operation of a telescoping variant of the present invention for a single needle;

 Figure 46 is a cross-sectional view taken along lines 46-46, as shown in Figure 42;

30

 Figure 47 is a cross-sectional view taken along

lines 47-47, as shown in Figure 46;

Figure 48 is a cross-sectional view taken along lines 48-48, as shown in Figure 46;

5

Figure 49 is a cross-sectional view taken along lines 49-49, as shown in Figure 46;

10

Figure 50 is a cross-sectional view taken along lines 50-50, as shown in Figure 45;

Figure 51 illustrates a variant of a key associated with a needle guard;

15

Figure 52 is a cross-sectional view taken along lines 52-52, as shown in Figure 51;

Figure 53 illustrates a cap usable to seal the anterior end of the sleeve;

20

Figure 54 is a cross sectional view illustrating the mating structure between the cap and sleeve shown in Figure 53;

25

Figure 55 is a perspective view illustrating a variant pull off tab;

Figure 56 is a perspective view illustrating another variant of the pull off tab;

30

Figure 57 is a perspective view illustrating the removed variant shown in Figure 56;

5 Figure 58 illustrates a manner of manufacturing a double ended needle body, such as that illustrated in Figure 13;

10 Figure 59 illustrates a prong usable to maintain the double needle body halves illustrated in Figure 58 in joined relationship;

15 Figure 60 illustrates the joined configuration of the double ended needle body halves illustrated in Figure 58;

20 Figure 61 illustrates a tapered double ended needle body with a matching tapered needle guard;

25 Figure 62 illustrates a manner for mounting the needle guard upon the needle body depicted in Figure 61; and

30 Figure 63 is a partial cross sectional view illustrating the interference lock between a tapered double ended needle body and a tapered needle guard.

Detailed Description of the Preferred Embodiment

Referring to Figure 1, there is shown a hypodermic syringe 10 having a barrel 12 and a needle 14. The needle may be attached to or detachable from the barrel. A needle guard 16 is secured to proximal end 18 of barrel 12. The needle guard serves the

function of preventing injury and injection from the needle to a user or damage to the needle; it may also serve the function of maintaining the needle sterile.

5

Needle guard 16 includes a sleeve 20 of an internal diameter to concentrically and snugly, but slidably receive barrel 12. Preferably, the sleeve is of transparent or translucent material to permit
10 view of any graduations 21 upon the barrel or the fluid level within the syringe.

As shown in Figures 2 and 3, proximal end 22 of needle guard 16 includes a tab 24 extending
15 thereacross in sealed relationship. A handle 26 is formed as part of the tab. An annular weakened zone, represented by numeral 28 is formed as part of the tab and serves as a weakened junction between the tab and proximal end 22. As illustrated in Figure 7, a
20 pull on handle 26 will fracture and sever tab 24 from proximal end 22 along annular zone 28 to sever the tab from needle guard 16 and develop an aperture 48 through which the needle may protrude. A key 30 extends radially inwardly from inner surface 32 of
25 sleeve 20. The key may be rectangular in planform and undercut on all four sides, as illustrated; other configurations of the key are contemplated. An inwardly radially extending ridge 29 may be formed in the interior of proximal end 22 to serve as a dam an
30 discourage outflow of any fluids dripping from the needle outside the guard.

Referring jointly to Figures 4, 5 and 6, the structure attendant barrel 12 for receiving/engaging key 30 to regulate and control movement of needle guard 16 relative to the barrel and needle 14 will be described. A tapered longitudinally oriented channel 32 extending radially at proximal end 18 receives key 30 of needle guard 16 for the purpose of mounting the needle guard upon barrel 12. The recess includes a step 33 from channel 32 to prevent passage of the key back into the channel. The channel leads to a recess 34 for nestingly receiving key 30. An annular channel 36 extends from recess 34. Sides 38, 40 at the junction between recess 34 and channel 36 may be necked down to serve as a constraint against passage of key 30 from the recess to the channel. A longitudinal channel 42 extends from channel 36 for a distance equivalent to the distance through which needle guard 16 is to be translated. A recess 44 is disposed at the terminal end of channel 42. Passage of key 30 into recess 44 may be restrained by a ridge 46 extending across the floor of channel 42 and defining one end of the recess. Channels 36 and/or 42 and the channels to be described hereafter may be undercut to lock key 30 therein.

25

Figures 7 and 8 illustrate the operation of needle guard 16 with respect to barrel 12 to uncover and recover needle 14. When syringe 10 is to be used, handle 26 of tab 24 is pulled to sever the tab from proximal end 22 of needle guard 16. The severance produces an aperture 48 at the proximal end to permit protrusion of needle 14 therethrough. In

30

the initial position of the needle guard, key 30 is disposed in recess 34, which recess prevents/restrains both longitudinal and rotational movement of the needle guard with respect to the barrel.

5 After aperture 48 has been formed, needle guard 16 is grasped by an operator, preferably from a location rearwardly of the needle, and the needle guard is rotated counterclockwise. The resulting rotational movement causes key 30 to enter annular channel 36
10 past the restraint effected by necked sides 38, 40. Thereafter, translation by manipulation of the needle guard toward the distal end of syringe 10 will draw the needle guard along barrel 12 until key 30 becomes lodged within recess 44 at the end of channel 42
15 after having been forced past ridge 46. In this position, particularly illustrated in Figure 8, needle 14 is fully exposed and the syringe is ready for use. If the needle guard is translucent or transparent, medical personnel operating syringe 10
20 will be able to note any graduations 21 upon barrel 12 and the level of fluid therein.

After use of the syringe for its intended purpose and to protect medical personnel against
25 inadvertent contact with needle 14, needle guard 16 is grasped, preferably from a point rearwardly of needle 14, and slid forwardly with sufficient force to overcome the restraining effect of ridge 46 upon key 30. Upon full extension of the needle guard, it
30 is rotated clockwise to place key 30 in annular channel 36 and ultimately force the key into recess 34 past the restraining effects of sides 38, 40. The

needle guard will again be in the position
illustrated in Figure 7. In this position, the
needle guard serves in the manner of a shield to
prevent inadvertent contact with needle 14. Thereby,
5 transmission of any infectious diseases by any fluids
in or about the needle will be avoided. Moreover,
the dam provided by annular ridge 29 (see Figure 3)
serves to contain outflow from within the needle
guard of any fluid which may have dripped from needle
10 14.

It may be noted that the function and purpose of
channel 32 is that of initially engaging needle guard
16 with barrel 12. Furthermore, if a particular need
15 arises, the needle guard can be disengaged from the
barrel by forcing key 30 out of recess 34 and into
channel 32. Further longitudinal movement of the
needle guard will result in disengagement of the key
with channel 32. It may be further noted that
20 syringe 10 may be used without needle guard 16 or
such a needle guard may be added to barrel 12 by a
user when circumstances warrant.

The purpose of tab 24 is that of enclosing a
25 needle to locate the needle within an enclosure which
will permit and accommodate maintaining the needle
sterile. It is therefore conceivable that for many
reasons, such as manufacturing ease, selection of
materials, production cost and/or ease of use, means
30 other than tab 24 for sealing the end of sleeve 20
may be employed without departing from the purpose
and function of the tab. Accordingly, the previous

and following discussion of the tab, such as tab 24, is for the purpose of identifying the best mode presently contemplated as a sealing means for the end of the sleeve but other configurations may be
5 incorporated for any or all of the reasons stated above. In example, a snap fit tab or cap which will sealingly engage, in the manner of a concentric shroud, the proximal end of the sleeve and maintain sterility of the enclosed needle may be incorporated.
10 Removal of such tab or cap to develop the aperture through which the enclosed needle can be exteriorized can be by a twist off action or a direct pull action.

15 Blood collection apparatus having a variant 62 of needle guard 16 for use with a double ended needle 64 is illustrated in Figure 9. The double ended needle mates with container holder 66 to locate therein the posterior needle 78 of double ended
20 needle 64. An evacuated collection tube 68 includes a rubber stopper 70. To collect blood, the collection tube is forced into container holder 66 until the posterior needle penetrates stopper 70 and blood will be drawn into the collection tube 68.

25 Details of double ended needle 64 and guard variant 62 will be described with joint reference to Figures 10-15. Prior to use, double ended needle 64 is enclosed within guard variant 62 disposed
30 generally about the anterior needle and a shield 72 generally disposed about the posterior needle. A tape 74 circumscribingly engages the mating ends of

the guard variant and shield to seal and to maintain sterile the enclosed double ended needle. Upon removal of tape 74, shield 72 may be disengaged from about double ended needle 64. The exposed portion of the double ended needle includes a posterior needle sheathed within a flexible sheath 76. The purpose of sheath 76 is to maintain enclosed posterior needle sterile prior to penetration by the needle of stopper 70. Sheath 76 also functions as a valve to recover the posterior needle after removal of a collection tube 68, so that the user can attach a second or more collection tubes to collect multiple blood samples. That is, upon insertion of collection tube 68 within container holder 66, the stopper will bear against the needle to force penetration of sheath 76 by the needle and subsequent penetration of stopper 70. Upon withdrawal of collection tube 68 within the container holder, the resulting disengagement with the posterior needle will permit the sheath to extend and again enclose the needle. Hub 80, from which posterior needle 78 extends and to which sheath 76 is attached, is in threadable engagement with threads of boss 82 of container holder 66. In this manner, the double ended needle is secured to the container holder.

Body 84 of double ended needle 64 may include a plurality of longitudinal ridges 86, as illustrated, to assist in manipulation. An adjacent pair of parallel longitudinally aligned flanges 88, 90 define a channel 92 extending longitudinally along body 84. These flanges, in combination with ridges 86, provide

support and guidance for guard variant 62, as illustrated particularly in Figure 14, during translation along body 84. Guard variant 62 includes a cylindrical section 94 terminated at proximal end 96 by a tab 98 having a handle 100. An annular weakened zone 102 joins tab 98 with proximal end 96. Upon removal of the tab by pulling upon handle 100, the tab will be severed essentially along zone 102 to produce an aperture 104 at proximal end 96. A cylindrical ridge 106 is disposed at proximal end 96 to define, in combination with cylindrical section 94, an annular trough 108. A key 30 extends radially inwardly from interior surface 110 of cylindrical section 94. The key may be undercut, as illustrated by the dashed line in Figure 15.

Referring primarily to Figures 16 to 19, the interconnecting relationship between guard variant 62 and double ended needle 64 of guard variant 62 will be described. Guard variant 62 is brought into mating relationship with body 84 by locating key 30 into and past threshold channel 120 to a first position in guide channel 122 defined by end wall 124, side wall 126, barrier 128 and restraining means, such as ridge 130. In this position, key 30, and hence guard variant 62, will be inhibited from rotational movement with respect to body 84 and longitudinal movement toward anterior needle 112 by end wall 124 and restrained against movement in the other direction by ridge 130.

To prevent inadvertent disengagement

between guard variant 62 and double ended needle 64 through traverse of key 30 over end wall 124, it is preferable to have the end wall extend radially outwardly as far as possible and yet permit mounting of the guard variant upon the body. If the material of which end wall is fabricated is resiliently compressible, accommodation of the key therepast through compression of the end wall will permit a higher or radially outwardly extending end wall than otherwise. Such radially extended sidewall will also tend to inhibit to a greater degree inadvertent disengagement between the guard variant and the needle body.

When anterior needle 112 is to be exposed, tab 98 is pulled away to form aperture 104. Guard variant 62 is gripped and pulled longitudinally toward posterior needle 78. The force of such a pull will cause key 30 to ride over ridge 130. Simultaneously, sidewall 126 will guide the key into channel 92, which channel extends longitudinally along body 84. To reenclose anterior needle 112 within guard variant 62, the guard variant is translated longitudinally along body 64 with key 30 riding in channel 92. Translation will occur until the key comes to a stop against end wall 132. Upon rotation of the guard variant in a clockwise direction, the key will ride over sloping side 134 of flange 136 and into recess 138. Rotation in the other direction of guard variant 62 will be precluded by vertical wall 140 of flange 136. The walls of the recess, in combination with flange 136 will preclude

either longitudinal or lateral movement of guard variant 62. Without the capability of any further movement, further exposure, and hence use, of anterior needle 112 is precluded.

5

To secure body 84 with boss 82 of container holder 66, a detent mechanism may be employed to preclude inadvertent unthreading of hub 80 with boss 82. Diametrically opposed detents 142, 144 extending
10 longitudinally from end 146 mate with equivalently located slots 148, 150 in end surface 152 of boss 82. A longitudinally aligned channel section 154 is formed in boss 82. A circumferentially (annularly) extending channel 156 interconnects with channel
15 section 154 at its terminal end. Restraining means, such as a ridge 158, extends across channel 156 to define a recess 160 at its terminal end. Upon threaded engagement of hub 80 with boss 82, channel 92 in body 84 will be aligned with channel section
20 154 of the boss. Alternatively, annular channel 156 may be omitted and ridge 158 may be located thereacross to serve as a restraint against disengagement between boss 82 and guard variant 62.

25

When guard variant 62 is to be longitudinally translated to expose needle 112, key 30 is guided from guide channel 122 into channel 92 and into
channel section 154 to its terminal end. Subsequent counterclockwise rotation of the guard variant will
30 translate key 30 into channel 156 to recess 160. Because of ridge 158, movement of the key out of recess 160 will be restrained. The translatory

movement of guard variant 62 is particularly illustrated in Figures 23 and 24 with the resulting effect of exposing anterior needle 112. It may be pointed out that by appropriate dimensioning of the guard variant, cylindrical ridge 106 (see Figure 15), may be dimensioned to bear against end 162 of body 84 when key 30 is engaged with channel 156 at location 158 of boss 82. Such engagement in combination with the engagement of location 158 will provide a mechanical restraint against inadvertent and potentially unfortunate results should double ended needle 64 become disengaged from container holder 66. Accordingly, a positive lock to maintain the double ended needle in place can be provided by guard variant 62.

Figure 21 illustrates a hub 82 of container holder 66 having a pair of diametrically opposed circumferentially oriented channels 156, including respective ridges 158. The purpose of this figure is to suggest the use of a pair of diametrically opposed keys in guard variant 62 with a pair of diametrically opposed channels 92 in body 84 along with guide channels 122. Such duality may provide a more stable apparatus for locating and guiding the guard variant.

Referring jointly to Figures 25, 26 and 27 there is illustrated a variant 170 of container holder 66 and an accompanying variant 172 of body 84 (Figure 13) of double ended needle 64. With this and other variants disclosed, the preferred needle angle access

may be achieved even with large girth container holders due to the resulting longitudinal displacement of the container holder. Boss 82 is substantially extended longitudinally and includes an equivalently extended channel section 154. This channel section terminates in a channel 156, as described with reference to Figure 20. Body variant 172 includes guide channel 122 as described above along with a section of channel 92 with its terminating recess 132. Hub 80 supports posterior needle 78 which has been substantially lengthened in portion to boss 82. This needle is terminated by a flexible sheath 76, as discussed above. Guard variant 62, as described above is mechanically and operatively engaged with body variant 172 as it is with body 86. A shield, like shield 72 shown in Figure 11, may be employed to house and protect posterior needle 78 and its enclosing sheath 76. The attachment of body variant 172 of the double ended needle with boss 82 is as described above. Similarly, the translatory movement of guard variant 62 to uncover and recover anterior needle 112 is as described above.

Referring jointly to Figures 28 and 29 there is shown a variant 180 of a single needle detachably attachable to a hypodermic syringe 182 and including a needle guard variant 184. The hypodermic syringe includes a cylinder 186 circumscribing a hub 188. Interior surface 190 of the cylinder includes a helical ridge 192, or thread, for threadedly securing variant 180 to the hypodermic syringe, such as with a

Luer lock.

The single needle variant includes a pair of diametrically opposed dogs 194, 196 for engaging helical ridge 192 to threadedly secure single needle variant 180 with the hypodermic syringe. Upon such threaded engagement by dogs 194, 196, hub 188, which is cone shaped, penetrably engages and sealingly mates with a similarly cone shaped recess 198 within cylindrical section 200 of single needle variant 180. An annular flange 202 is located with respect to cylinder 200 to contactingly engage end 204 of cylinder 186 upon mating engagement of hub 188 with recess 198. Unnecessary over-tightening of the pressure fit Luer lock is prevented by contact of annular flange 202 with end 204; thereby, a constant tightening pressure upon the Luer-lock is provided. As particularly illustrated in Figure 29, upon such engagement, fluid communication between needle 206 and passageway 208 through hub 188 is established.

Guard variant 184 includes a key 30, which may be of the shape and configuration discussed above, extending radially inwardly from the interior of cylindrical section 94. A longitudinally aligned channel 210 is disposed in body 212 of single needle variant 180 to receive and accommodate translation therealong of key 30. Restraining means, such as ridge 214 is disposed across the channel proximate the anterior end of the channel to define a recess 216. A similar ridge 218 is disposed across the channel proximate the posterior end to define a

recess 220. These ridges serve to restrain movement of key 30 out of the respective recess unless a substantial force applied longitudinally to guard variant 184 occurs. Accordingly, the guard variant will normally be and remain located in a position to maintain needle 206 covered or uncovered.

Guard variant 184 includes a tab 222, which may be like tab 98 described above. Furthermore, the guard variant may include an annular trough, such as trough 108 illustrated in Figure 15 and described above. Aperture 224, formed in the proximal end of guard variant 184 upon removal of tab 222 may be sized to accommodate penetration of boss 226 supporting needle 206.

Figure 30 illustrates a variation in the external configuration applicable to any one of the needle guards discussed above. Further variant 230 of a needle guard includes one or more annular flanges, such as any or all of flanges 232, 234 and 236. The purpose and function of these flanges is to permit medical personnel to use with facility, only one or two digits of one hand to engage and effect translatory movement of the guard. This will free the other hand for associated or related functions, such as administering a medication or drawing blood. Depending upon dimensional considerations, key 30 may be disposed adjacent the posterior end of the guard variant, as illustrated in Figure 30, or further longitudinally forwardly therefrom, as illustrated previously. Anterior end 238 of the guard variant

may be cone shaped to better define or more easily define the annular weakened zone which defines the aperture to the guard variant upon removal of tab 240. Moreover, an interior cone shaped anterior end, whether or not an annular trough is disposed therein, will tend to discourage outflow of any fluids dripping from the needle enclosed within the guard variant after the needle has been used.

10 Figures 31 and 32 illustrates a further variant 250 of body 252 supporting the double ended needle. Guide channel 254 is essentially straight and defines a relatively shallow angle with respect to longitudinal channel 256. The resulting reduction in rotation rate of an engaged guard with respect to longitudinal movement of the guard is somewhat more preferable to a user. It may be noted that the floor or base 258 of the guide channel is somewhat outwardly radially displaced from base 260 of longitudinal channel 256 to form a lip 262 along the line of demarcation therebetween. This lip will discourage, if not prohibit, translation of key 30 of a needle guard from the longitudinal channel into the guide channel during recovering of anterior needle 264. The anterior end of guide channel 254 includes a receiving recess 255 defined by a cut down end wall 257, a side wall 259, a further end wall 261 and a longitudinally aligned wall 263. After passage of a key 30 across end wall 257, the key will be retained within the receiving recess by the three sides and wall defining the receiving recess. More specifically, an inadvertently applied force having a

longitudinally oriented component and applied to a mounted needle guard will not cause the needle guard to be displaced longitudinally due to the interference with key 30 presented by further end wall 261. To obtain translation of key 30 (and the needle guard) within and along guide channel 254, the needle guard will have to be deliberately translated anteriorly and then rotated (clockwise) to pass key 30 past longitudinal wall 263 and into the anterior end of the guide channel.

The anterior end of longitudinal channel 256 includes a recess 266 defined by end wall 268 and step 270. This end wall and step will preclude longitudinal translation of key 30 when the latter has been pushed into recess 266. The posterior end of longitudinal channel 256 includes restraining means, such as ridge 272 extending across base 260. The ridge, in combination with end wall 274 provides a detent function to maintain an interacting guard in the retracted position. A hub 80 is formed at the posterior end of body 252 to support a posterior needle enclosed within sheath 76.

Apparatus 280 for drawing blood from a patient and into a large volume container is illustrated in Figures 33 and 34, which apparatus incorporates one of the needle guards described above along with its advantages. A needle 282 is secured to and extends from a body 284. The needle, through the body, is in fluid communication with a length of conduit 286. A second needle 288 is secured to and extends from a

second body 290; this needle, through the body, is also in fluid communication with conduit 286. A needle guard, such as guard variant 230 illustrated in Figure 30, is in engagement with body 284. The engagement means may include guide channel 254 and longitudinal channel 256 of the configuration illustrated in Figure 31. Similarly, the guard associated with needle 288 and body 290 may be like guard variant 230 illustrated in Figure 30. The means disposed in body 284 for engaging and regulating translation of the associated guard variant may also include guide channel 254 and longitudinal channel 256, as illustrated in Figure 31.

15

In operation, needles 282 and 288 are covered by the respective guard variant 230 prior to use. To use apparatus 280, needle 282 is exposed by pulling on tab 240 to permit exteriorization of the needle by translatory movement of guard variant 230. Thereafter, the needle is inserted in a patient's blood vessel. Needle 288 is exteriorized from guard variant 230 by pulling on tab 240 and translating the guard posteriorly along body 290. Needle 288 is subsequently inserted through the stopper of a container for receiving the blood withdrawn. On completion of the procedure, each guard variant is translated anteriorly to recover the associated needle to protect medical personnel against inadvertent contact with either of the needles and any fluid that might drip therefrom.

30

Referring jointly to Figures 35 to 41, a telescoping double guard assembly 300 for a double ended needle 302 will be described. Body 304 includes a longitudinally oriented channel 306 having

5 restraining means, such as ridge 308 disposed distal to the anterior end of body 304 to define a first location 310. Further restraining means, such as ridge 312 defines a second location 314 proximate the posterior end of body 304. Needle guard 316,

10 disposed at the anterior end of the body to cover anterior needle 318, includes a key 320 extending radially inwardly for translatable engagement with channel 306. The guard may include a cylindrical ridge 322 for defining an annular trough 324. A tab

15 326 is removably attached to the guard via an annular weakened zone 328. Upon pulling on tab 326, the tab will be severed along the line of the zone to develop aperture 330 for penetrable engagement by needle 318. Guard 316 is translatable from first location 310 to

20 second location 314 and return. However, ridges 308 and 312 restrain translation out of each respective location to prevent inadvertent or unwanted translation and concomitant uncovering/covering of needle 318.

25

Needle guard 316 includes a longitudinally oriented channel 340 disposed in the peripheral surface of the needle guard. The posterior end of channel 340 includes a first location 342 defined by

30 restraining means, such as ridge 344. A second location 346 is disposed at the anterior end of channel 340 and is defined by restraining means, such

as ridge 348. A needle guard 350 extends posteriorly over body 304 to enclose and cover posterior needle 352 and its associated sheath 354 along with hub 356. A tab 358 is disposed at the posterior end of needle guard 350. The tab is secured to the needle guard via a weakened annular zone 360. Upon pulling on tab 358, it will sever from needle guard 350 along zone 360 to define an aperture 362. A cylindrical ridge 364 may encircle aperture 362 and define an annular trough 366.

A key 368 extends radially inwardly within needle guard 350 for engagement with channel 340. Translatory movement of needle guard 350 from first location 342 to second location 346 is restrained by the respective ridges. Thereby, needle guard 350 will tend to remain positioned relative to needle guard 316 unless an external force of a certain magnitude is applied to cause disengagement or repositioning of key 368 from the first or second locations. In operation, tab 358 is severed from needle guard 350; upon such severance, translation of the needle guard from the first location to the second location and into concentric overlap with needle guard 316 will uncover needle 352 enclosed within sheath 354, as illustrated in Figure 37. Threaded engagement of hub 356 with boss 370 of container holder 372 may be effected by rotationally manipulating double ended needle assembly 300 by gripping and rotating relocated needle shield 350. It may be noted that translation of needle guard 350 may be from a position rearwardly of posterior needle

352 to avoid inadvertent contact with or puncture by the needle.

Once hub 356 is threadedly secured to the
5 container holder, tab 326 is severed from needle
guard 316. In the position illustrated in Figure 37,
needle guard 350 has been placed in its second
location, as discussed with respect to Figure 41.
Upon application of a pulling force upon needle guard
10 350, key 320 of needle guard 316 will be translated
from first location 310 along channel 306 to second
location 314. This position is illustrated in Figure
38. Commensurate therewith, anterior needle 318 will
have penetrated through aperture 330 and become
15 exposed. The manipulation of double ended needle
assembly 300 to expose needle 318 may be performed
rearwardly of the needle to minimize the possibility
of needle prick or penetration. It may be noted that
in the position illustrated in Figure 38, needle
20 guard 316 is in its second location, as illustrated
in Figure 41.

On completion of the procedure, anterior needle
318 must be covered to prevent contact therewith by
25 medical personnel and avoid the possibility of
transmission of an infectious disease which might
otherwise result. To recover the needle, needle
guard 350 is gripped and translated in the direction
of needle 318 to relocate needle guard 316 in its
30 first location, as illustrated in Figures 35, 36 and
37. Upon rotation of needle guard 350, hub 356 may
be disengaged from boss 370. Translation of needle

guard 350 posteriorly for the purpose of recovering posterior needle 352 and its enclosing sheath 354 may be effected without relocating needle guard 316 as the latter will tend to remain in its first location due to the restraining effect of ridge 308 (see Figure 41) Upon translation of needle guard 350 from its second position back to its first position, posterior needle will be fully covered as illustrated in Figure 39.

10

Referring jointly to Figures 42 through 50 there is illustrated a detachable single needle telescoping guard assembly 380 for attachment to a hypodermic syringe. The hypodermic syringe may be of the type illustrated and described with respect to Figures 28 and 29 or other type. Assembly 380 includes a body 384, a cylindrical section 406 and a guard 420 concentrically nestable with one another, as illustrated in Figure 45. In this nested position, needle 392 is exposed to administer a medication. Body 384, supporting needle 392, includes a pair of dogs 386, 388 for threaded engagement with cylinder 186 of hypodermic syringe 182 to locate hub 188 within cone shaped recess 390. A first pair of diametrically opposed channels 394, 396 extend longitudinally along body 384. Each channel includes a first location 398 at the proximal end and defined by restraining means, such as ridge 400 and a second location 402 at the distal end, which location may be defined by restraining means, like ridge 400 or a step 404, as shown.

30

Cylindrical section 406 includes a pair of diametrically opposed keys 408, 410 disposed at the distal end for sliding engagement with a respective one of channels 394, 396. A pair of diametrically opposed longitudinal channels are formed in the exterior surface of cylindrical section 406. Each channel includes a first location 416 at the proximal end and defined by restraining means, such as ridge 418. A second location, like those for channels 394, 396 may be included. Guard 420 includes a sleeve 422 having a pair of radially inwardly extending keys 424, 426 located at the distal end of the guard. These keys slidably engage respective ones of channels 412, 414 in cylindrical section 406. The proximal end of the guard includes a tab 428 secured at a weakened annular zone 430. Upon removal of the tab, annular weakened zone 430 will be fractured and an aperture 432 will be developed in the guard, as described previously. A cylindrical ridge 434 is incorporated in the proximal end of the guard to define an annular trough 436.

As particularly illustrated in Figures 47 to 50, pairs of diametrically opposed channels with corresponding keys may be employed to provide four points of support intermediate the guard, the sleeve and the body, which support is equicircumferentially located. It is also to be noted that variations of structure attendant the needle supporting body and needle guards, as described above with respect to one or another of the figures, may be incorporated in assembly 380.

In operation, single needle assembly 380 is attached to hypodermic syringe 182 by engaging dogs 386, 388 with cylinder 186, as illustrated in Figure 43. Upon tearing away of tab 428, aperture 432 in guard 420 is developed to permit protrusion of needle 392 from within the guard, as illustrated in Figure 44. By grasping guard 420 from a position rearwardly of needle 392 and exerting a force to translate the guard toward the hypodermic syringe, the restraining forces exerted by ridges 418 upon keys 424 and 426 (see Figure 46) and by ridges 400 upon keys 398, cylindrical section 406 and guard 420 will become longitudinally translated toward the hypodermic syringe. During such translation, the keys will traverse their respective channels. At the point of full contraction of assembly 380, keys 398 will become lodged in second locations 402. Keys 424 and 426 will be located at the distal end of channels 412 and 414 at a second location (not identified); it is to be noted that a second location, with restraining means, such as second locations 402 may be developed in cylindrical section 406 for the purpose of engaging keys 424, 426. In the contracted state of assembly 380, as illustrated in Figure 45, end 438 of cylindrical section 406 may bear against cylindrical ridge 434 or another part of the proximal end of guard 420. Hypodermic syringe 182 may now be used to inject a medicament.

30

After use of the needle and to protect the medical personnel against transmission of any

infectious disease through contact with the needle or fluids dripping therefrom, guard 420 may be gripped from a location rearwardly of the needle and pushed anteriorly. The resulting movement of the guard will
5 extend the sleeve and the guard with respect to body 384 to recover the needle and shield it against inadvertent contact. Upon such extension of the sleeve and the guard, the respective keys will be relocated in their respective first locations.
10 Inadvertent contraction of the telescoping elements will be restrained by the respective ridges which interferingly engage with an associated key.

Figures 51 and 52 illustrate a variant 440 of
15 the key associated with any of the needle guards illustrated and described previously. For manufacturing or other reasons, it may be difficult to develop a key 30 internal to a needle guard. To avoid such difficulty, variant 440 may be employed.
20 The variant may be located at each of diametrically opposed locations of a needle guard, representatively identified by numeral 442, or only a single variant on one side of needle guard 442 may be incorporated.

25 Variant 440 extends longitudinally from sleeve 444 and may be formed as a part thereof. It includes an extension 446 terminated by a key 448. The extension is inwardly rotatable, as depicted by arrow
30 450 in Figure 52, to locate the extension adjacent the internal surface of sleeve 444, as illustrated on the right hand side of Figure 52. In this position, key 448 serves the identical function(s) described

above with respect to key 30. Moreover, the bias force that may be provided by the bent portion 452 of extension 446 may urge key 448 radially internally to remain in engagement with any channels or restraining means associated with the key.

Depending upon numerous factors, the junction between needle guard 442 and extension 446 may be modified to facilitate the positioning of key 448 internal to the needle guard. To prevent lateral circumferential displacement of key 448 internal of sleeve 444 in response to forces imposed upon the key, a slot or groove 456 may be formed in the sleeve. This groove is configured in breadth, depth and length to relatively snugly receive extension 446, including the extended part thereof beneath key 448. The resulting mating relationship is illustrated on the right hand side of sleeve 444 in Figure 52. It may be noted that the resilience of bent portion 452 will urge the key radially inwardly into a receiving guide channel.

For various manufacturing reasons, the pull off tabs discussed and illustrated previously, such as tab 24, may present manufacturing problems and attendant expenses of some concern. Referring jointly to Figures 53 and 54, there is illustrated a pop off cap 460 which may be employed as a substitute for one or another of the above described pull off tabs. As illustrated, the cap is configured to matingly receive an anterior (needle enclosing) end of a sleeve 462 forming a part of a needle guard 464.

The cap includes an outer cylindrical shroud 466 for circumferentially engaging the exterior cylindrical surface of sleeve 462. An inwardly radially displaced cylindrical shroud 468 is located to mate with the interior cylindrical surface of sleeve 462. Thereby, cap 460 nestingly receives the open end of sleeve 462. Retaining means may be employed to constrain removal of the cap and for developing a seal of sufficient quality to maintain the sleeve enclosed needle sterile. Such retaining means may include a pair of adjacent radially inwardly extending annular beads 470, 472 disposed upon the interior circumferential surface of sleeve 462. A mating annular bead 474 may extend radially outwardly from the exterior cylindrical surface of shroud 468. The relative positioning along the longitudinal axis of annular beads 470, 472 with annular bead 474 is set to provide a snap fit like engagement of annular bead 474 intermediate annular beads 470, 472. Depending upon the material, cross sectional configurations and resiliency, the mating engagement of the annular beads may be capable of providing a seal sufficient to maintain sterility of a needle enclosed within sleeve 462. To ensure sterility a length of tape may be wrapped about the sleeve and posterior end 474 of the cap.

A further variant of the pull off tabs is illustrated in Figure 55. Herein, a sleeve 476 of a needle guard 478 includes an end 480. The end has formed as part thereof a disc like member 482. A weakened annular zone 484 extends circumferentially

about member 482. To remove member 482 and permit exteriorization of the needle enclosed within sleeve 476, annular zone 484 is fractured to permit severance of the member. Such fracturing may be
5 assisted by employment of a flange like handle 486 secured to or formed as a part of member 482 and extending therefrom. Such handle will permit manual gripping of the member by any user. Upon such
10 gripping and exertion of a force upon handle 486 to rotate it, as depicted by double headed arrow 488, sufficient stresses can be imposed upon weakened annular zone 484 to permit fracturing of the zone and severance of member 482 from end 480.

15 A variant handle 490 of handle 486 is illustrated in Figure 56. Handle 490 extends laterally in diametrically opposed directions from member 482. Such lateral extension permits the application of a substantially leveraged force upon
20 the member to increase the ease with which the member may be rotated relative to sleeve 476 to bring about fracturing of and along weakened annular zone 484. As depicted by double headed arrow 488, handle 490 may be rotated clockwise or counterclockwise.

25 Figure 57 illustrates the effect of rotating member 482. That is, rotation of the member in either direction, as depicted by arrow 488, will result in fracturing of annular zone 484. Upon such
30 fracture, member 482 becomes severed from end 480. Upon severance, an aperture 492 is developed in end 480 through which needle 494 may be exteriorized by

sliding posteriorly sleeve 476.

Body 84 for double ended needle 64, as illustrated in Figure 13, may be difficult to manufacture in one piece or the expenses attendant such manufacture may be commercially unacceptable. Referring jointly to Figures 58, 59 and 60, there is illustrated a structural configuration of body 84 which may be less expensive to manufacture. It is to be understood that the structure and configuration to be described may be equally applicable to various of the double ended needle bodies described above and not just body 84. For ease of manufacture, particularly where body 84 is to be formed by man made plastic molding techniques, a mold may be developed to form the body from two halves joined together by a living hinge. More specifically, the body may be formed to have a first half 500 joined to a second half 502 by a narrow hinge 504. Body half 500 would include a trough 506 longitudinally centered therein for receiving the central part of a double ended needle 508; a similar trough 510 is longitudinally centered in and disposed along body half 502. Semi-cylindrical annular cavities 512, 514 may be disposed at one end of body 84 in axial alignment with troughs 506, 510, respectively. These cavities may be employed to retainingly receive the needle 508 and to fixedly retain the needle within body 84.

30

After body 84 has been formed in the configuration depicted in Figure 58, needle 508 is

inserted in one of troughs 506, 510. The two body halves are thereafter folded upon one another along hinge 504 to capture the needle within the opposing troughs and semicylindrical cavities. Alternatively, 5 needle 508 could be staked and secured into body 84 after the body halves have been joined. To retain the body in the assembled state, a plurality of barbed prongs 520 may extend from body half 502. These prongs penetrably engage commensurately located 10 cavities 522 in body half 500. As particularly illustrated in Figure 59, prong 520 may include a split point 522 which must be squeezed together upon insertion into cavity 522. Barbs 524, 526 may extend laterally to mechanically engage the sidewalls of a 15 cavity within which prong 520 is inserted. Frictional engagement between barbs 524, 526 with the corresponding walls is encouraged by the lateral forces imposed by split point 522. It is to be understood that variants of prong 520 may be 20 developed and employed. Furthermore, prong/cavity combination may be a simple key/keyway combination to effect alignment between body halves 500, 502. In such event, retention of the body halves in the assembled state may be effected by an adhesive, 25 mastic or an element encircling body 84; other means for securing the body halves to one another may also become apparent to those skilled in the plastics art.

As particularly depicted in Figure 60, it is 30 preferable that the line of demarcation 518 between body halves 500, 502 not interfere with the channels within the body and along which key 30 of an attached

needle guard is translated. It may also be appreciated that with the employment of body halves, each body half may be easily formed to incorporate the channel structures for one of a pair of diametrically opposed keys of an attached needle guard.

Under ham handed treatment, it may be possible to inadvertently disengage anteriorly a needle guard associated with one of the double ended needle bodies described above. While the interconnection between key(s) 30 extending from the needle guard with the corresponding channel in the guarded double ended needle body will prevent inadvertent disengagement anteriorly under normal operating circumstances and if due care is used, further insurance against such disengagement may be of benefit. Referring to Figure 61, there is shown a variant 530 having a double ended needle body 532 which is tapered posteriorly from the anterior end. A similarly tapered needle guard 534 is shown mounted upon the tapered double ended needle body. This needle guard may be of the type illustrated in Figures 53, 54 having a cap 460 for enclosing or sealing the anterior end of the needle guard.

Figure 62 illustrates a suggested procedure for assembling double ended needle apparatus variant 530 illustrated in Figure 61. Anterior end 536 of sleeve 538 forming needle guard 534 penetrably receives sheath 76 enclosing the posterior needle (78) extending from tapered double ended needle body 532.

Upon engagement of the needle guard with the tapered double ended needle body, key 30 within sleeve 538 is brought into engagement with a guide channel 540 disposed in the body. It is to be understood that this channel may be any one of several of the configurations of channels previously illustrated. Upon positioning of needle guard 534 in its anterior most position, the anterior needle of tapered double ended needle body 532 will be encircled by end 536 of sleeve 538. Cap 460 is mated with end 536, such as in the manner described with respect to Figures 53 and 54. It may be noted that the attachment of cap 460 may be intended to be permanent. In such case and to exteriorize the enclosed needle, a fracturably removable member, such as member 482 illustrated in Figures 55, 56 and 57, may be developed upon cap 460.

As more particularly illustrated in Figure 63, at the anterior most position of needle guard 534 with respect to tapered double ended needle body 532, the interior tapered cylindrical surface 542 of sleeve 538 will interferingly engage with the diametrically enlarged end 544 of tapered double ended needle body 532. Such interference will preclude further displacement of the needle guard with respect to the tapered double ended needle body except upon splitting or other mechanically destructive relief of the physical interference therebetween. The point at which interference will occur may be coincident with the travel of key 30 within channel 540 to the anterior most position. Or, as illustrated in Figure 63, the interference may

begin to be of a restraint to translational movement just prior to engagement of key 30 with end wall 546 of channel 540. In the latter event, the interference between end 544 and surface 542 will be significant and the further mechanical constraint provided by key 30 butting against end wall 546 will be a near absolute restraint against further anterior translational movement of the needle guard without breakage.

10

To assist in assembly of needle guard 534 upon tapered double ended needle body 530, as illustrated in Figure 62, a ramp 548 may be employed at the posterior end of tapered double ended needle body 532, which ramp is in general alignment with channel 540. The ramp will permit key 30 to ride up over it and into channel 540 with only a slight, if any, distention of sleeve 538 of the needle guard. End wall 550 formed by the ramp will limit posterior translation of the needle guard relative to the tapered double ended needle body.

15
20

In operation, an operator would receive variant 530, as illustrated in Figure 61, except that a shield would probably enclose the posterior end of the tapered double ended needle body and the posterior needle extending therefrom. After securing the tapered double ended needle body to a container holder syringe, or the like, anterior needle 112 would be exposed by initial removal of cap 460 or a member 482 thereof. Thereafter, needle guard 534 would be translated posteriorly directly or after an

25
30

initial twist or turn, depending upon the configuration of the guide channel 540 employed. Posterior translation of the needle guard would be terminated by interference between key 30 and end wall 550. After use, an operator would grasp needle guard 534 from a location posterior of needle 112 and slide the needle guard anteriorly. By appropriate matching of tapers between tapered double ended needle body 532 and tapered needle guard 524, physical interference therebetween to constrain further translational movement would occur at or about the point at which the tip of needle 112 would become encircled by the sleeve of a needle guard. Further anterior translational movement of the needle guard would frictionally lockingly locate the needle guard in it's anterior most position. Commensurate with such position, key 30 may or may not be in butting relationship with end wall 546. Further translation of the needle guard anteriorly would be precluded by the previously discussed interference fit, except upon breakage or physical damage to the components. Posterior translation of the needle guard would be restrained by the locking effect of the physical interference between the tapered double ended needle body and needle guard, with or without a positionally locked key 30, as described previously.

Various structural features and operational benefits have been described and illustrated pertinent to each of the needle guards, single needle bodies, double ended needle bodies and syringes,

container holders or conduit. It is to be understood that, to the extent feasible and operationally beneficial, a feature of one element can be incorporated ab initio or as a substitute in another element even though such alternate embodiment might not have been specifically discussed and illustrated above.

While the principles of the invention have now been made clear in an illustrative embodiment, there will be immediately obvious to those skilled in the art many modifications of structure, arrangement, proportions, elements, materials, and components, used in the practice of the invention which are particularly adapted for specific environments and operating requirement without departing from those principles.

WE CLAIM:

1. Apparatus for shielding a hypodermic
needle against inadvertent contact by a user, said
5 apparatus comprising in combination:

(a) a needle body having the hypodermic needle
extending therefrom;

10 (b) a needle guard, said needle guard including
a cylindrical sleeve translationally engagable with
said needle body

(c) means for sealing one end of said sleeve
15 anteriorly relative to said needle body to seal the
needle within said sleeve;

(d) means for breaking the seal provided by said
sealing means to exteriorize the needle;

20 (e) means for retaining said sleeve in a needle
enclosing position upon said needle body to prevent
rotation and translation of said sleeve relative to
said needle body;

25 (f) means for translating said sleeve
longitudinally to a terminal end posteriorly relative
to said needle body to exteriorize the needle from
within said sleeve;

30 (g) further means for retaining said sleeve at

the terminal end of translatory movement of said sleeve during use of the needle; and

(h) means for repositioning said sleeve
5 anteriorly relative to said needle body to reenclose
the needle within said sleeve.

2. The apparatus set forth in Claim 1 wherein
said sealing means comprises a removable member.
10

3. The apparatus set forth in Claim 2 wherein
said breaking means comprises a weakened annular zone
at the anterior end of said sleeve.

4. The apparatus set forth in Claim 1 wherein
said translating means and said repositioning means
include a key extending from one of said sleeve and
said needle body and a channel disposed in the other
of said sleeve and said needle body for receiving
said key.
20

5. The apparatus as set forth in Claim 4
wherein said key extends from said sleeve.

6. The apparatus as set forth in Claim 4
wherein said channel and said key are common to said
translatory means and said repositioning means.
25

7. The apparatus as set forth in Claim 6
30 wherein at least one of said retaining means and said
further retaining means includes a necked down
section of said channel for interfering with

relocation of said key therepast.

8. The apparatus as set forth in Claim 6
wherein at least one of said retaining means and said
5 further retaining means includes a ridge extending
across said channel for interference with relocation
of said key therepast.

9. The apparatus as set forth in Claim 1
10 including a container holder having a boss in
operative engagement with said needle body and
wherein said translating means extends into and is a
part of said boss.

15 10. The apparatus as set forth in Claim 9
wherein said translatory means and said repositioning
means include a key extending from said sleeve, a
channel disposed in said needle body and a channel
section disposed in said boss in operative engagement
20 with said channel.

11. The apparatus as set forth in Claim 10
wherein said further retaining means comprises an
annular channel formed as part of said channel
25 section to preclude longitudinal displacement of said
sleeve upon engagement of said key with said annular
channel.

12. The apparatus as set forth in Claim 11
30 wherein said boss comprises a cylindrical extension
to displace said needle body from said container
holder.

13. The apparatus as set forth in Claim 11 wherein said sleeve is dimensioned to bear against the anterior end of said needle body upon engagement of said key with said annular channel to lock said needle body with said boss.

14. The apparatus as set forth in Claim 1 wherein said sleeve includes a key and wherein said translating means includes a longitudinal channel disposed in said needle body for receiving said key and for longitudinally locating said sleeve during translation and repositioning of said sleeve relative to said needle body and a guide channel intersecting with said longitudinal channel for guiding said key into said longitudinal channel upon initiation of translatable movement of said sleeve.

15. The apparatus as set forth in Claim 14 wherein said retaining means includes means formed as part of said guide channel for discouraging passage of said key along said guide channel and translatable movement of said sleeve to maintain the needle enclosed within said sleeve.

16. The apparatus as set forth in Claim 15 wherein said discouraging means includes a ridge extending across said guide channel.

17. The apparatus as set forth in Claim 14 including means disposed at the intersection of said guide channel and said longitudinal channel for

preventing passage of said key from said longitudinal channel into said guide channel.

18. The apparatus as set forth in Claim 17
5 wherein said retaining means includes means formed as part of said guide channel for discouraging passage of said key along said guide channel and translatory movement of said sleeve to maintain the needle enclosed within said sleeve.

10
19. The apparatus as set forth in Claim 14 wherein said longitudinal channel includes an annular channel for receiving said key upon repositioning of said sleeve anteriorly, said annular channel
15 including means for capturing said key to preclude further rotational and translatory movement of said sleeve relative to said needle body to maintain the needle within said sleeve upon anterior repositioning of said sleeve.

20
20. The apparatus as set forth in Claim 19 wherein said retaining means includes means formed as part of said guide channel for discouraging passage of said key along said guide channel and translatory
25 movement of said sleeve to maintain the needle enclosed within said sleeve.

21. The apparatus as set forth in Claim 20 including means disposed at the intersection of said
30 guide channel and said longitudinal channel for preventing passage of said key from said longitudinal channel into said guide channel.

22. The apparatus as set forth in Claim 14 wherein said further retaining means includes a ridge disposed posteriorly in said longitudinal channel and extending across said longitudinal channel for interferingly engaging said key.

23. The apparatus as set forth in Claim 1 wherein said sleeve includes means for providing purchase by a single digit of a user's hand to facilitate translation of said sleeve by a user from a position posterior of the enclosed and enclosable needle.

24. The apparatus as set forth in Claim 23 wherein said providing means comprises at least one annularly oriented ridge segment.

25. The apparatus as set forth in Claim 24 wherein each of said ridge segments extends annularly about said sleeve.

26. The apparatus as set forth in Claim 1 wherein said needle body includes an anterior end and tapers posteriorly from the anterior end and wherein said sleeve includes an anterior end proximate said sealing means and tapers posteriorly from the anterior end, whereby said needle guard will interferingly engage said needle body upon enclosure within said needle guard of the hypodermic needle to preclude inadvertent disengagement of said needle guard from said needle body upon anterior translation

of said needle guard relative to said needle body.

27. The apparatus as set forth in Claim 1 wherein said needle body includes an anterior end proximate the hypodermic needle extension and wherein said needle guard includes an anterior end proximate said sealing means and tapers posteriorly from the anterior end and wherein said repositioning means comprises an interference fit between the posterior end of said needle guard and the anterior end of said needle body upon translation anteriorly of said needle guard, which interference fit precludes inadvertent separation of said needle guard from said needle body.

15

28. The apparatus as set forth in Claim 1 wherein said needle body includes a double ended needle and wherein said needle guard shields the anterior end of the double ended needle and including a second needle guard for shielding the posterior end of the double ended needle guard, said second needle guard comprising in combination:

(a) a second cylindrical sleeve translationally engagable with said needle body;

(b) second means for sealing one end of said second sleeve posteriorly relative to said needle body to seal the posterior needle within said second sleeve;

30

(c) second means for breaking the seal provided

by said second sealing means to exteriorize the posterior needle;

5 (d) second means for retaining said second sleeve in a posterior needle enclosing position upon said sleeve and for preventing rotation and translation of said second sleeve relative to said sleeve;

10 (e) second means for translating said second sleeve longitudinally to a terminal end anteriorly relative to said sleeve to exteriorize the posterior needle from within said second sleeve;

15 (f) further second means for retaining said second sleeve at the terminal end of translatory movement of said second sleeve during use of the double ended needle; and

20 (g) second means for repositioning said second sleeve posteriorly relative to said sleeve to reenclose the posterior needle within said second sleeve.

25 29. The apparatus as set forth in Claim 28 wherein said second sealing means comprises a second removable member.

30 30. The apparatus as set forth in Claim 29 wherein said second breaking means comprises a second weakened annular zone at the posterior end of said second sleeve.

31. The apparatus as set forth in Claim 28
wherein said second translating means and said second
repositioning means include a second key extending
5 from one of said sleeve and said second sleeve and a
second channel disposed in the other of said sleeve
and said second sleeve.

32. The apparatus as set forth in Claim 31
10 wherein said second key extends from said second
sleeve.

33. The apparatus as set forth in Claim 31
wherein said second channel and said second key are
15 common to said second translating means and said
second repositioning means.

34. The apparatus as set forth in Claim 33
wherein at least one of said second retaining means
20 and said second further retaining means includes a
second ridge extending across said second channel for
interference with relocation of said second key
therepast.

25 35. The apparatus as set forth in Claim 29
wherein said sealing means comprises a removable
member.

30 36. The apparatus as set forth in Claim 30
wherein said breaking means comprises a weakened
annular zone at the anterior end of said sleeve.

37. The apparatus as set forth in Claim 31 wherein said translating means and said repositioning means include a key extending from one of said sleeve and said needle body and a channel disposed in the other of said sleeve and said needle body for receiving said key.

38. The apparatus as set forth in Claim 33 wherein said translating means and said repositioning means include a key extending from one of said sleeve and said needle body and a channel disposed in the other of said sleeve and said needle body for receiving said key.

39. The apparatus as set forth in Claim 38 wherein said channel and said key are common to said translatable means and said repositioning means.

40. The apparatus as set forth in Claim 34 wherein said translating means and said repositioning means include a key extending from one of said sleeve and said needle body and a channel disposed in the other of said sleeve and said needle body for receiving said key.

41. The apparatus as set forth in Claim 40 wherein said channel and said key are common to said translatable means and said repositioning means.

42. The apparatus as set forth in Claim 41 wherein at least one of said retaining means and said

further retaining means includes a necked down section of said channel for interfering with relocation of said key therepast.

5

43. The apparatus as set forth in Claim 41 wherein at least one of said retaining means and said further retaining means includes a ridge extending across said channel for interfering with relocation of said key therepast.

10

44. The apparatus as set forth in Claim 1 including a cylindrical section disposed concentrically intermediate said sleeve and said needle body, said sleeve, said cylindrical section and said needle body being in telescoping relationship to one another.

15

45. The apparatus as set forth in Claim 44 wherein said retaining means includes first retaining means disposed intermediate said sleeve and said cylindrical section and second retaining means disposed intermediate said cylindrical section and said needle body.

20

25

46. The apparatus as set forth in Claim 44 wherein said translating means includes first translating means disposed intermediate said sleeve and said cylindrical section and second translating means disposed intermediate said cylindrical section and said needle body.

30

47. The apparatus as set forth in Claim 44 wherein said further retaining means includes first further retaining means disposed intermediate said sleeve and said cylindrical section and second
5 further retaining means disposed intermediate said cylindrical section and said needle body.

48. The apparatus as set forth in Claim 44 wherein said repositioning means includes first
10 repositioning means disposed intermediate said sleeve and said cylindrical section and second repositioning means disposed intermediate said cylindrical section and said needle body.

49. The apparatus as set forth in Claim 44 wherein each of said retaining means, said
15 translating means, said further retaining means and said repositioning means is disposed at least at diametrically opposed locations.

20

50. The apparatus as set forth in Claim 45 wherein said translating means includes first
25 translating means disposed intermediate said sleeve and said cylindrical section and second translating means disposed intermediate said cylindrical section and said needle body.

51. The apparatus as set forth in Claim 50 wherein said further retaining means includes first
30 further retaining means disposed intermediate said sleeve and said cylindrical section and second further retaining means disposed intermediate said

cylindrical section and said needle body.

52. The apparatus as set forth in Claim 51 wherein said repositioning means includes first
5 repositioning means disposed intermediate said sleeve and said cylindrical section and second repositioning means disposed intermediate said cylindrical section and said needle body.

10 53. The apparatus as set forth in Claim 28 wherein said needle body includes an anterior end and tapers posteriorly from the anterior end and wherein said sleeve includes an anterior end proximate said sealing means and tapers posteriorly from the
15 anterior end, whereby said needle guard will interferingly engage said needle body upon enclosure within said needle guard of the hypodermic needle to preclude inadvertent disengagement of said needle
20 guard from said needle body upon anterior translation of said needle guard relative to said needle body.

54. The apparatus as set forth in Claim 28 wherein said needle body includes an anterior end proximate the hypodermic needle extension and wherein
25 said needle guard includes an anterior end proximate said sealing means and tapers posteriorly from the anterior end and wherein said repositioning means comprises an interference fit between the posterior end of said needle guard and the anterior end of said
30 needle body upon translation anteriorly of said needle guard, which interference fit precludes inadvertent separation of said needle guard from said

needle body.

5 55. A method for shielding a hypodermic needle
extending from a needle body with a needle guard
operatively associated with and extending from the
needle body and having a closed end anterior of the
enclosed needle, said method comprising the steps of:

10 (a) breaking the closure provided by the closed
end of the needle guard to permit exteriorizing the
enclosed needle;

15 (b) retaining the needle guard in a needle
enclosing position relative to the needle body to
discourage rotation and translation of the needle
guard relative to the needle body;

20 (c) translating the needle guard generally
longitudinally to a terminal end posteriorly relative
to the needle body to exteriorize the needle from
within the needle guard;

25 (d) further retaining the needle guard at the
terminal end of translatory movement of the needle
guard during use of the needle;

30 (e) repositioning the needle guard anteriorly
relative to the needle body to reenclose the needle
within the needle guard after use of the needle; and

(f) manually exercising said steps of

translating, further retaining and repositioning from a point generally coincident with the needle body and posterior of the tip of the needle.

5 56. The method as set forth in Claim 55 wherein the closure includes a weakened annular zone and said step of breaking includes the step of fracturing the annular zone.

10 57. The method as set forth in Claim 55 wherein a key extends from one of the needle body and the needle guard and a channel for receiving the key is disposed in the other of the needle body and the needle guard and wherein said step of retaining
15 includes the step of discouraging displacement of the key along the channel.

 58. The method as set forth in Claim 55 wherein a key extends from one of the needle body and the
20 needle guard and a channel for receiving the key is disposed in the other of the needle body and the needle guard and wherein said step of translating includes the step of displacing the key along the channel.

25 59. The method as set forth in Claim 55 wherein a key extends from one of the needle body and the needle guard and a channel for receiving the key is disposed in the other of the needle body and the
30 needle guard and wherein said step of further retaining includes the step of discouraging displacement of the key along the channel.

5 60. The method as set forth in Claim 55 wherein
a key extends from one of the needle body and the
needle guard and a channel for receiving the key is
disposed in the other of the needle body and needle
guard and wherein said step of repositioning includes
the step of displacing the key along the channel.

10 61. The method as set forth in Claim 55 wherein
the needle body is secured to a boss of a container
holder and wherein said step of translating includes
the step of translating the needle guard into
operative engagement with the boss.

15 62. The method as set forth in Claim 61 wherein
said step of further retaining includes the step of
further retaining the needle guard in engagement with
the boss.

20 63. The method as set forth in Claim 58 wherein
the channel includes a longitudinal channel and a
guide channel and wherein said step of translating
includes the step of translating the key along the
guide channel into and along the longitudinal channel
25 in one direction and wherein said step of
repositioning includes the step of repositioning the
key along the longitudinal channel in the other
direction.

30 64. The method as set forth in Claim 63 wherein
said step of repositioning includes the step of
immobilizing the needle guard on termination of said

repositioning step.

65. The method as set forth in Claim 64
including the step of preventing relocation of the
5 key from the longitudinal channel into the guide
channel.

66. The method as set forth in Claim 63
including the step of preventing relocation of the
10 key from the longitudinal channel to the guide
channel.

67. The method as set forth in Claim 55 wherein
said step of repositioning includes the step of
15 immobilizing the needle guard on termination of said
repositioning step.

68. The method as set forth in Claim 55 wherein
the needle body includes an anterior end proximate
20 the hypodermic needle extension and wherein the
needle guard includes an anterior end proximate the
closed end and tapers posteriorly from the anterior
end and wherein said step of repositioning includes
the step of interferingly engaging the anterior end
25 of the needle body with the posterior end of the
needle guard, which interfering engagement precludes
inadvertent separation of the needle guard from the
needle body.

69. The method as set forth in Claim 55 wherein
30 the needle body includes a double ended needle having
an anterior needle end shielded by the needle guard

and a posterior needle end shielded by a further
needle guard which further needle guard is
operatively associated with and extending from the
double ended needle body and having a closed end
5 posterior of the enclosed posterior needle end, said
method including the steps of:

(a) breaking the closure provided by the closed
end of the further needle guard to permit
10 exteriorizing of the enclosed posterior needle end;

(b) retaining the further needle guard in a
needle enclosing position relative to the needle body
to discourage rotation and translation of the further
15 needle guard relative to the needle body;

(c) translating the further needle guard
generally longitudinally to a terminal end anteriorly
relative to the needle body to exteriorize the
20 posterior needle end from within the further needle
guard;

(d) further retaining the further needle guard
at the terminal end of translatory movement of the
25 further needle guard during use of the posterior
needle end;

(e) repositioning the further needle guard
posteriorly relative to the needle body to reenclose
30 the posterior needle end within the further needle
guard after use of the posterior needle end; and

(f) manually exercising said steps of translating, further retaining and repositioning of the further needle guard from a point generally coincident with the needle body and posterior to the tip of the posterior needle.

70. The method as set forth in Claim 69 wherein the closure of the further needle guard includes a weakened annular zone and said step of breaking includes the step of fracturing the annular zone of the further needle guard.

71. The method as set forth in Claim 69 wherein the needle guard and the further needle guard are concentric with one another and extend about the needle body and wherein said steps of translating and repositioning include the step of telescopingly relocating the needle guard and the further needle guard relative to one another.

72. The method as set forth in Claim 69 wherein a key extends from one of the needle body and the needle guard and a channel for receiving the key is disposed in the other of the needle body and the needle guard and wherein said step of retaining includes the step of discouraging displacement of the key along the channel and wherein a further key extends from one of the needle guard and the further needle guard and a further channel for receiving the further key is disposed in the other of the needle guard and the further needle guard and wherein the step of retaining the further needle guard includes

the step of discouraging displacement of the further key along the further channel.

73. The method as set forth in Claim 69 wherein
5 a further key extends from one of the needle guard
and the further needle guard and a further channel
for receiving the further key is disposed in the
other of the needle guard and the further needle
guard and wherein said step of translating the
10 further needle guard includes the step of displacing
the further key along the further channel.

74. The method as set forth in Claim 69 wherein
15 a further key extends from one of the needle guard
and the further needle guard and a further channel
for receiving the further key is disposed in the
other of the needle guard and the further needle
guard and wherein said step of further retaining the
further needle guard includes the step of
20 discouraging displacement of the further key along
the further channel.

75. The method as set forth in Claim 69 wherein
25 a further key extends from one of the needle guard
and the further needle guard and a channel for
receiving the key is disposed in the other of the
needle guard and the further needle guard and wherein
said step of repositioning the further needle guard
includes the step of displacing the further key along
30 the further channel.

76. The method as set forth in Claim 69 wherein

the needle body includes an anterior end proximate
the hypodermic needle extension and wherein the
needle guard includes an anterior end proximate the
closed end and tapers posteriorly from the anterior
5 end and wherein said step of repositioning includes
the step of interferingly engaging the anterior end
of the needle body with the posterior end of the
needle guard, which interfering engagement precludes
inadvertent separation of the needle guard from the
10 needle body.

77. The method as set forth in Claim 55
including a cylindrical section disposed
15 concentrically intermediate the needle body and the
needle guard and wherein said steps of translating
and repositioning include the step of telescopingly
relocating the needle guard, the cylindrical section
and the needle body relative to one another.

20

78. The method as set forth in Claim 77 wherein
said step of retaining includes the step of retaining
the needle guard relative to the cylindrical section
and the cylindrical section relative to the needle
25 body.

79. The method as set forth in Claim 77 wherein
said step of further retaining includes the step of
retaining the needle guard relative to the
30 cylindrical section and the cylindrical section
relative to the needle body.

80. The method as set forth in Claim 77 including the step of disengagably engaging the needle body with the barrel of a hypodermic syringe.

5 81. A double ended hypodermic needle having a body for supporting the needle and a needle guard for protecting a user against inadvertent contact with the needle after use, the needle guard being translatable along the body to exteriorize and
10 enclose at least one end of the needle, said body comprising in combination:

 (a) a first body half having a first trough for receivingly retaining the needle;

15

 (b) a second body half having a second trough for receivingly retaining, in conjunction with said first trough, the needle; and

20

 (c) means for securing said first and second body halves to one another and retain the needle therebetween.

25

82. The body as set forth in Claim 81 wherein said securing means includes a hinge.

30

83. The body as set forth in Claim 82 wherein said hinge extends longitudinally along mating sides of said first and second half bodies.

84. The body as set forth in Claim 82 including means for locking said first and second body halves

to one another.

5 85. The body as set forth in Claim 84 wherein
said locking means comprises at least one prong
extending from one of said first and second body
halves and a cavity disposed in the other of said
first and second body halves for matingly engaging
said prong.

10 86. The body as set forth in Claim 81 wherein
at least one of said first and second body halves
includes a channel for guiding the needle guard
longitudinally along said body.

15 87. The body as set forth in Claim 86 wherein
each of said first and second body halves includes a
channel for guiding the needle guard longitudinally
along said body.

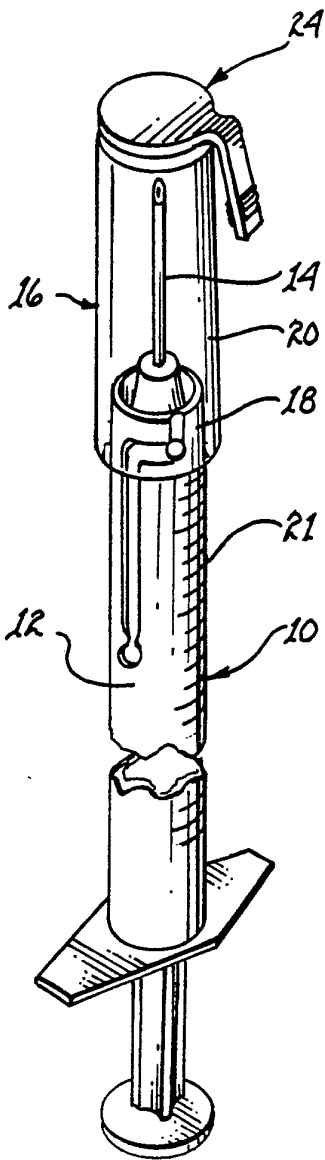

fig. 1

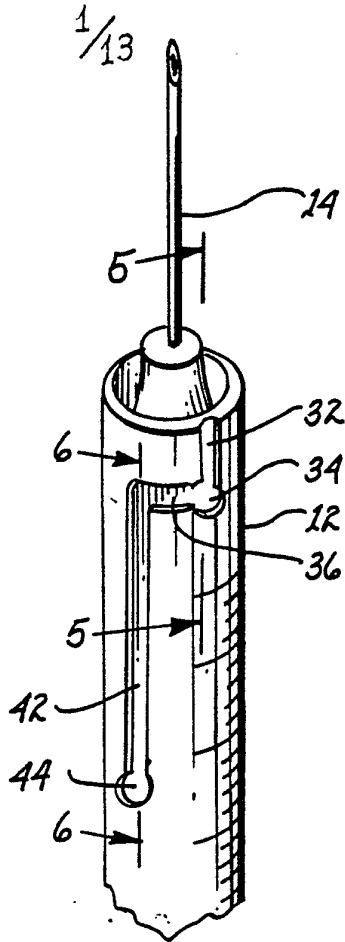

fig. 4

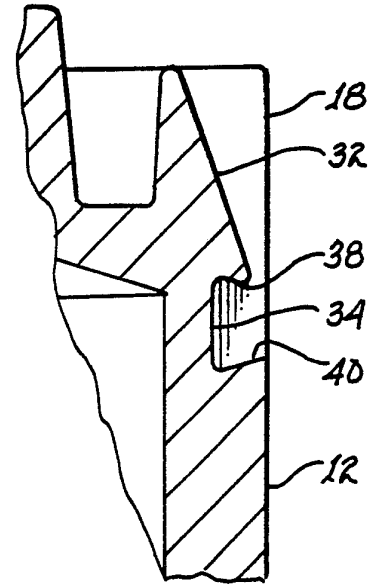

fig. 5

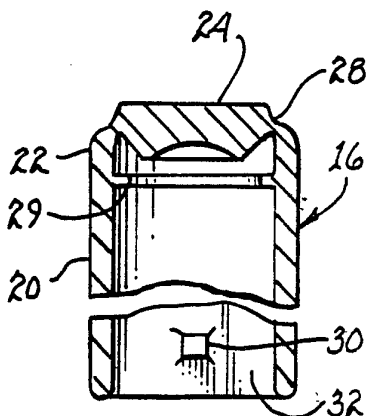

fig. 3

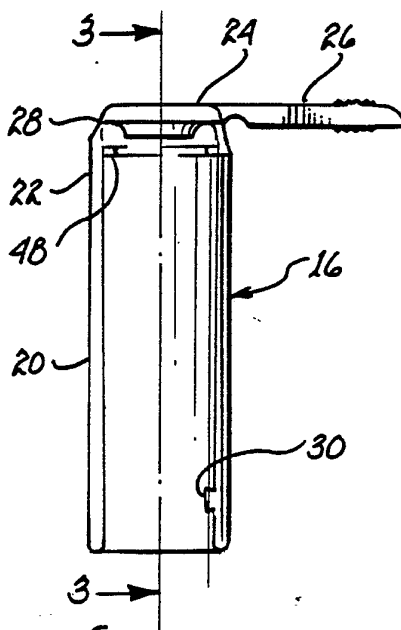

fig. 2

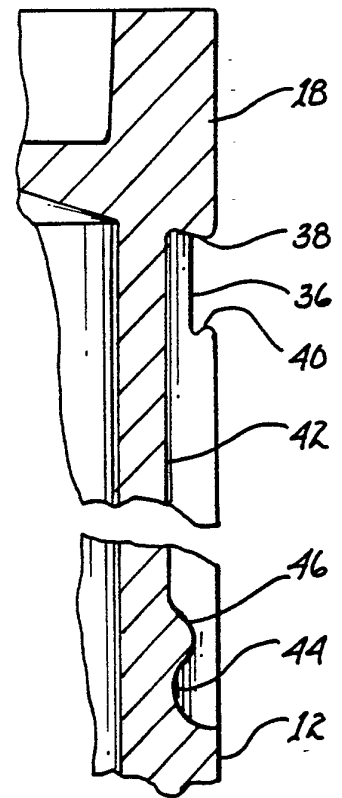
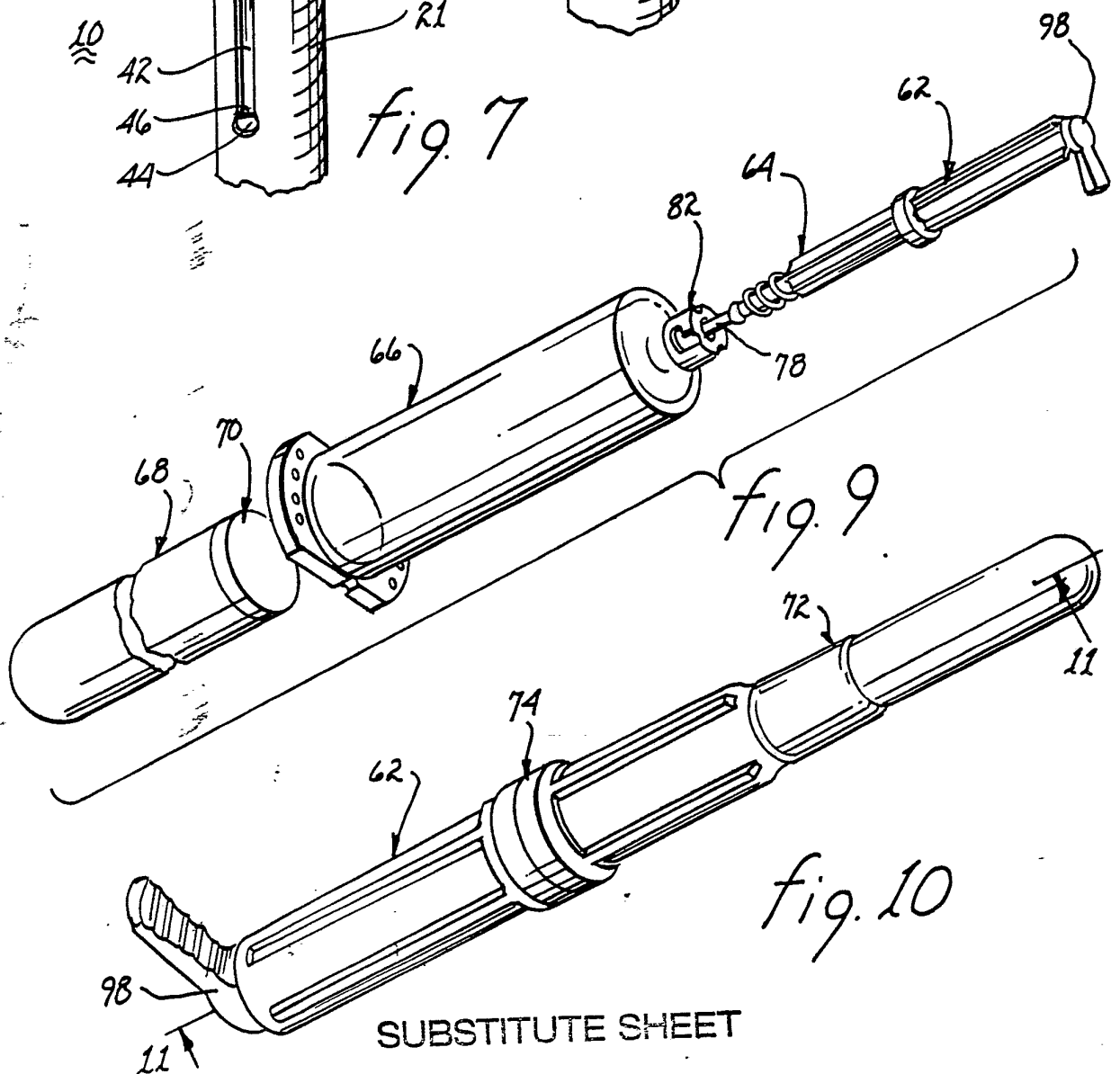
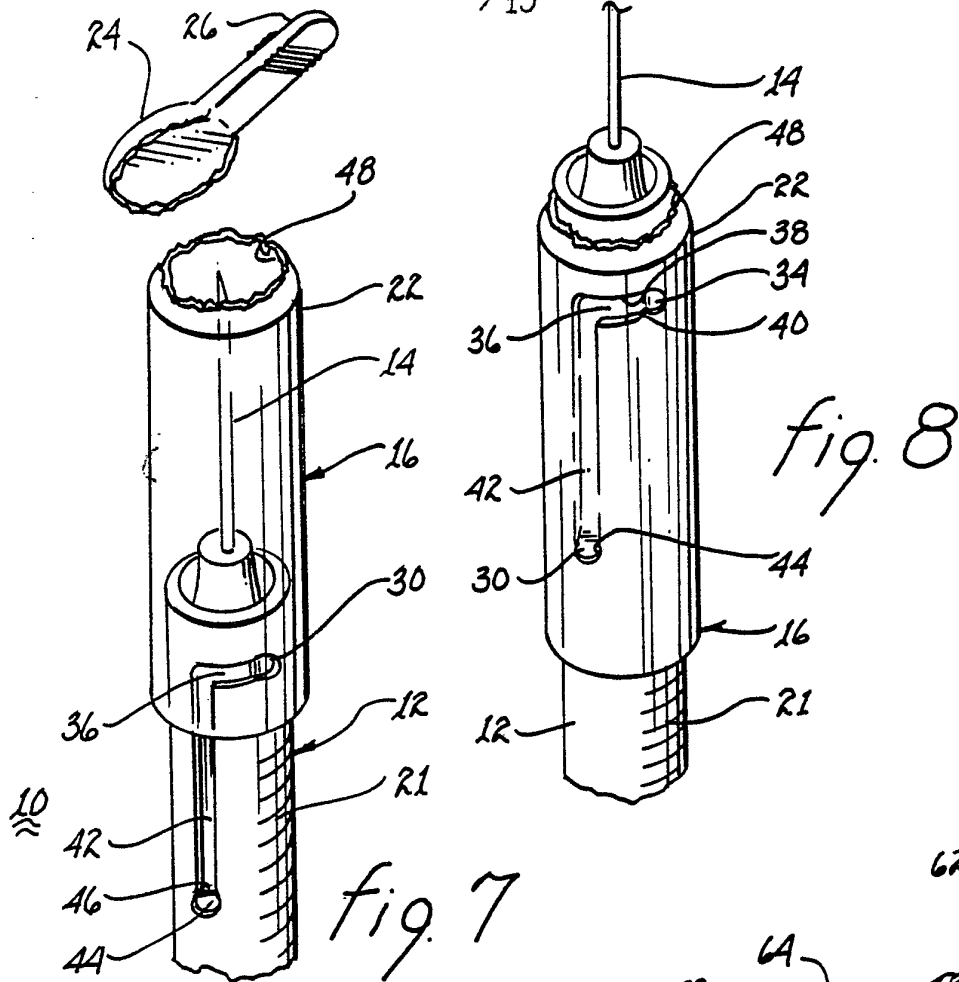

fig. 6

2/13



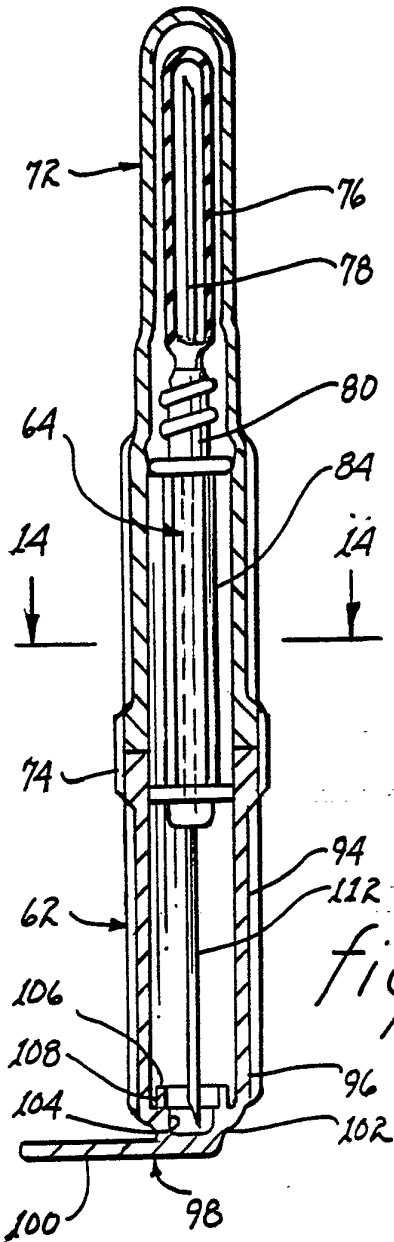

fig. 11

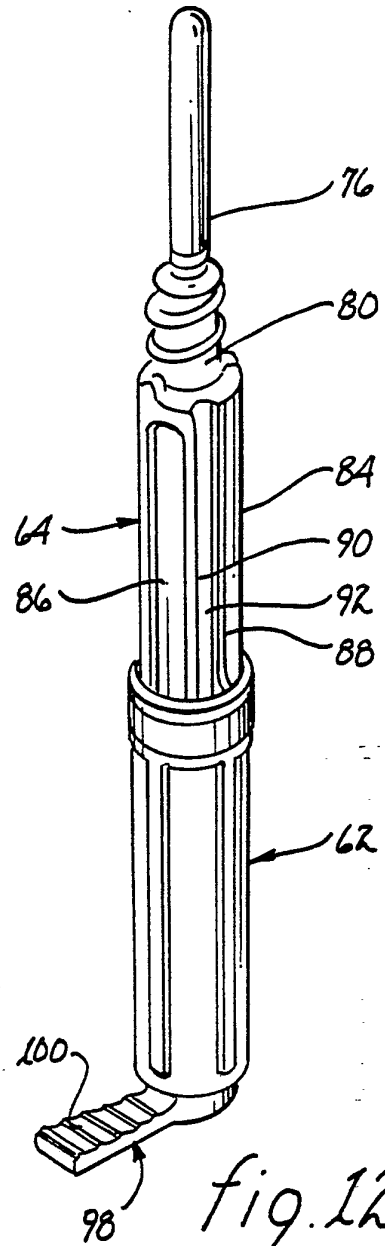

fig. 12

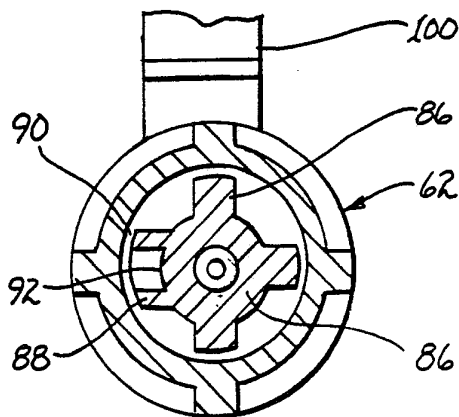

fig. 14

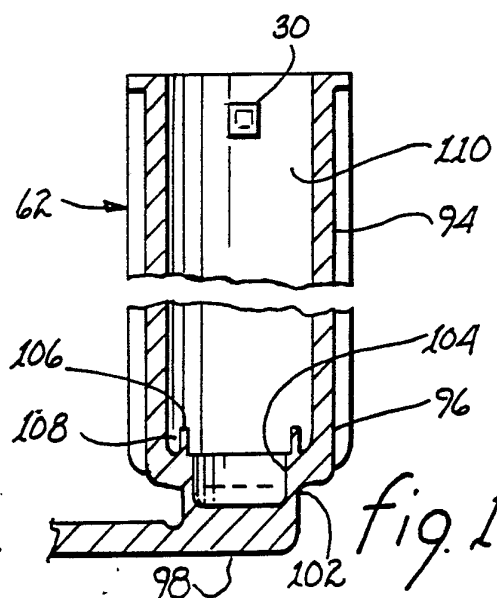

fig. 15

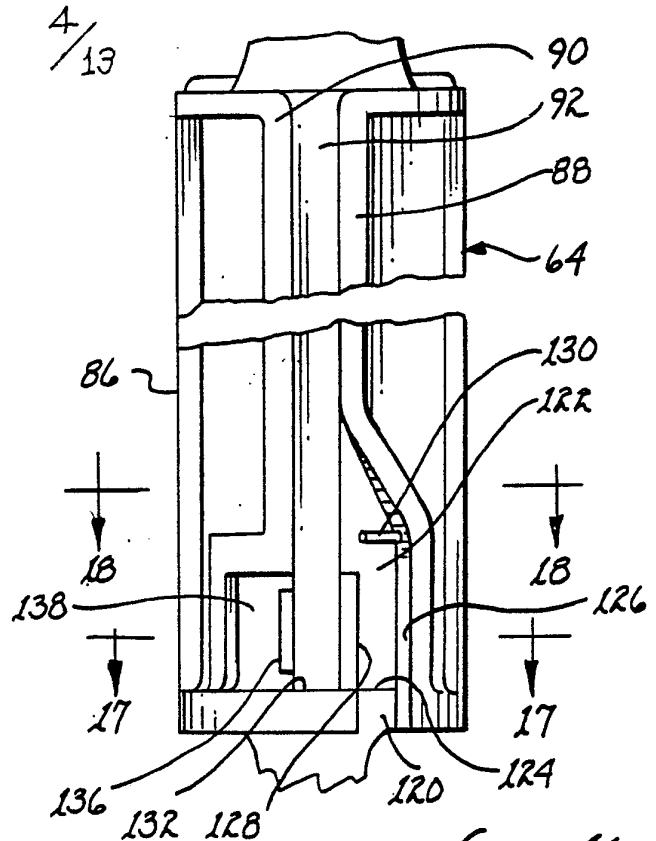
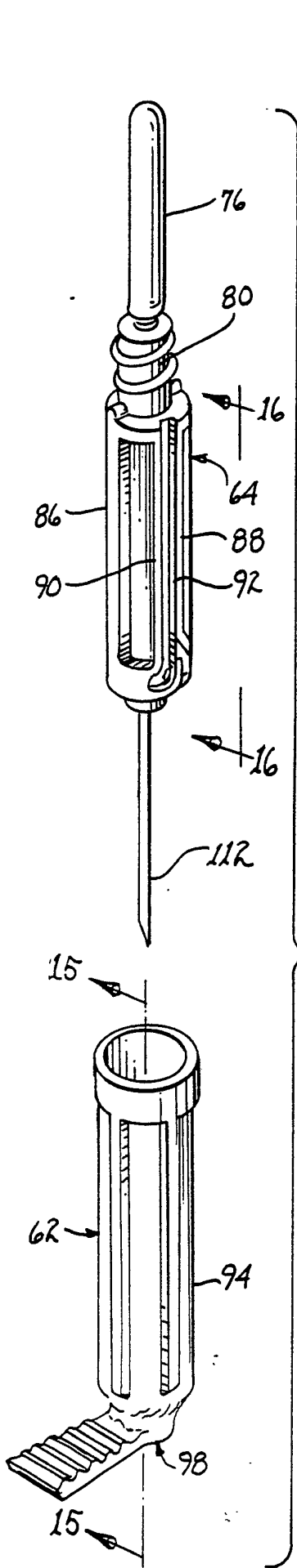

fig 16

fig 13

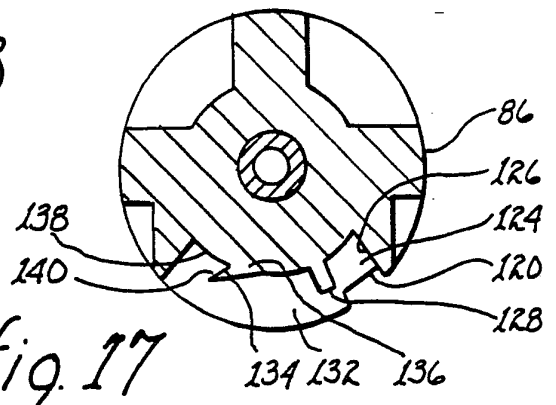

fig 17

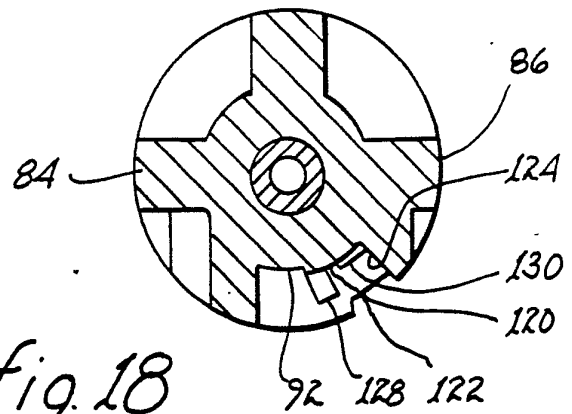

fig 18

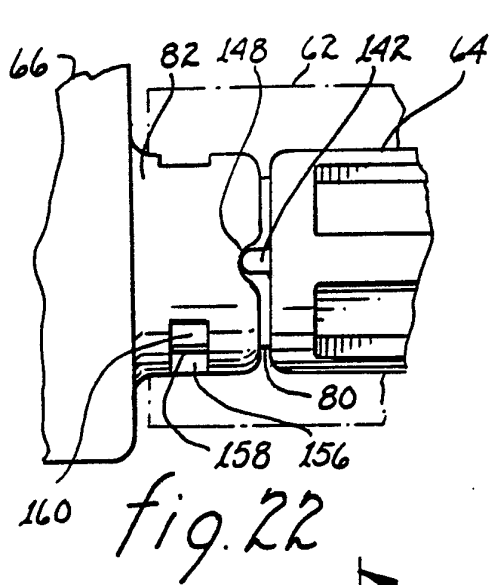

fig. 22

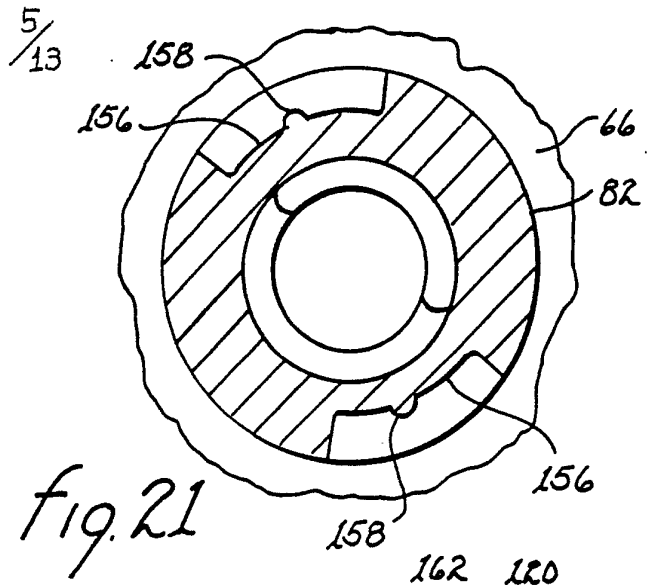

fig. 21

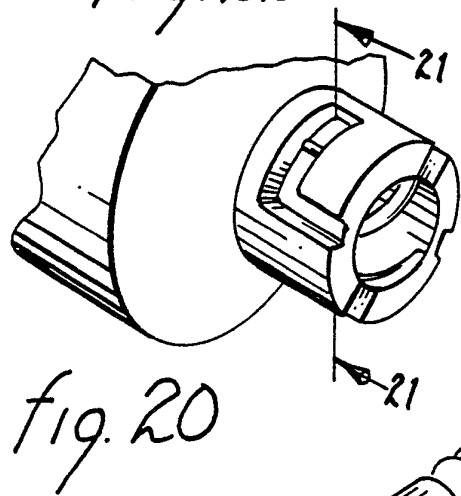

fig. 20

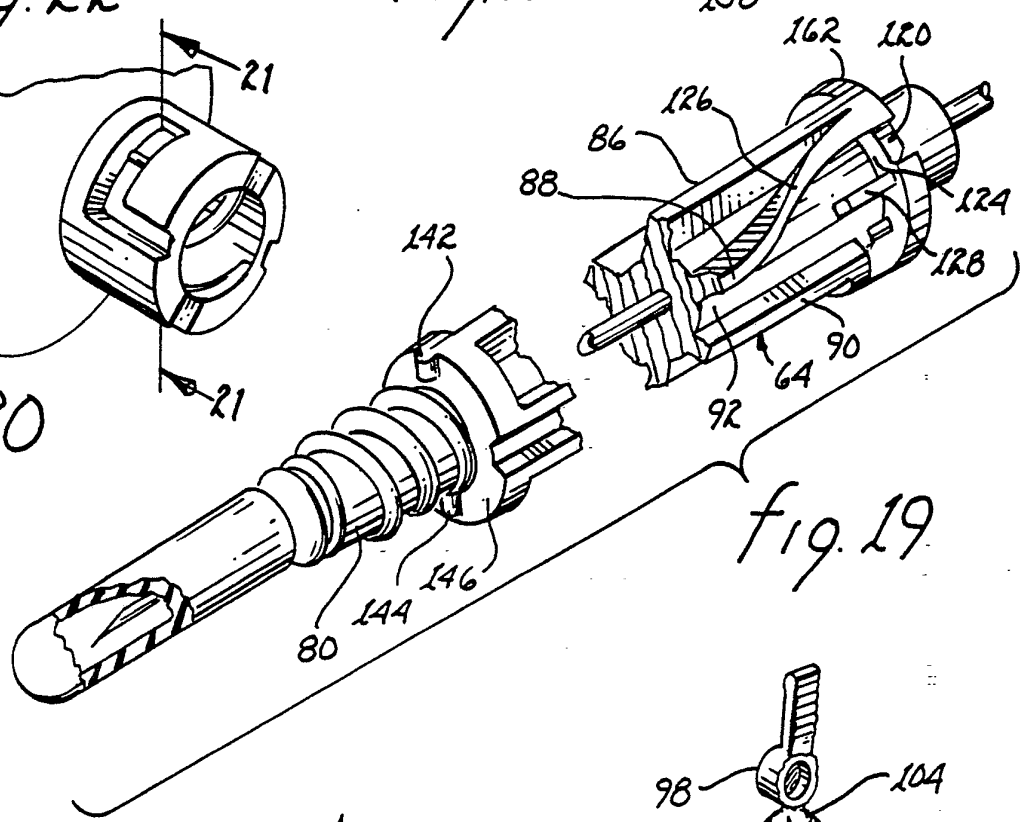

fig. 19

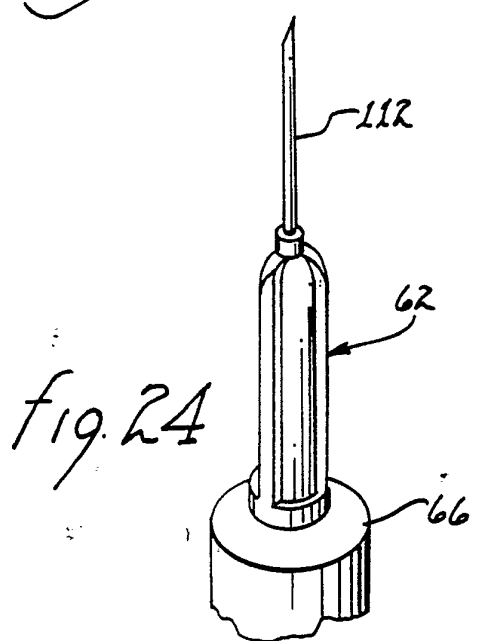

fig. 24

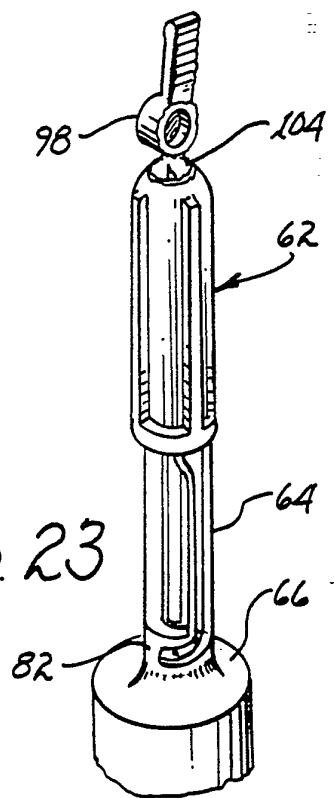

fig. 23

6/13

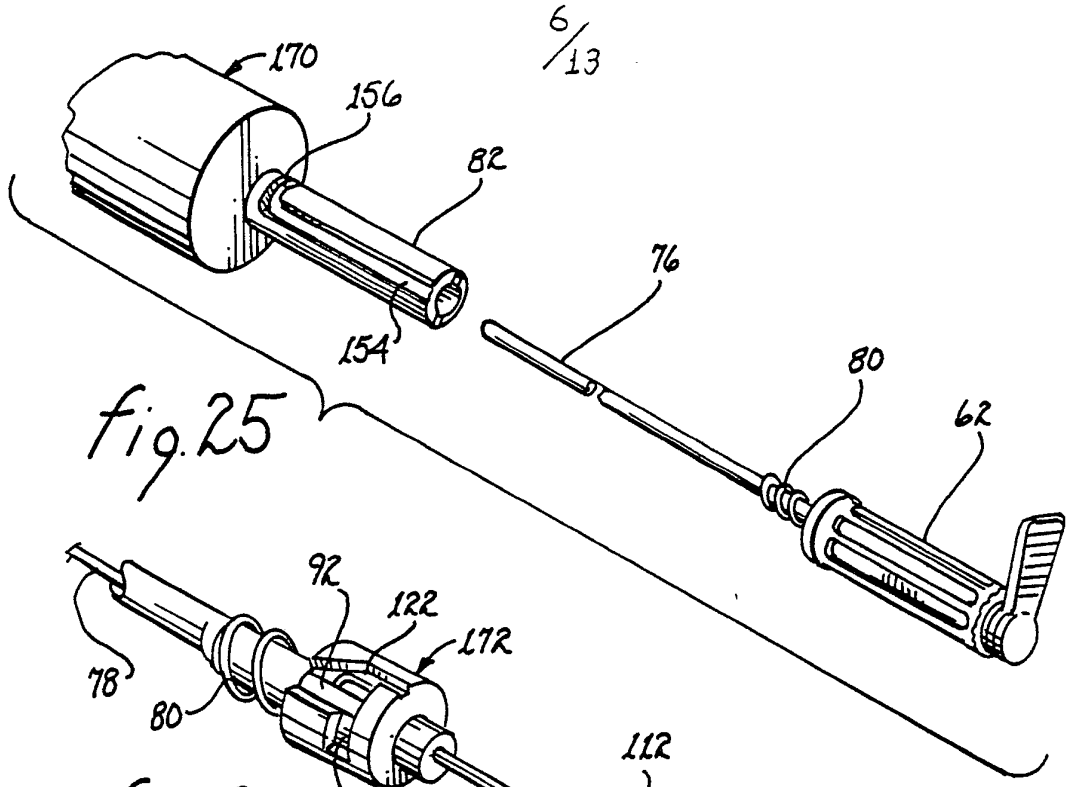

fig. 25

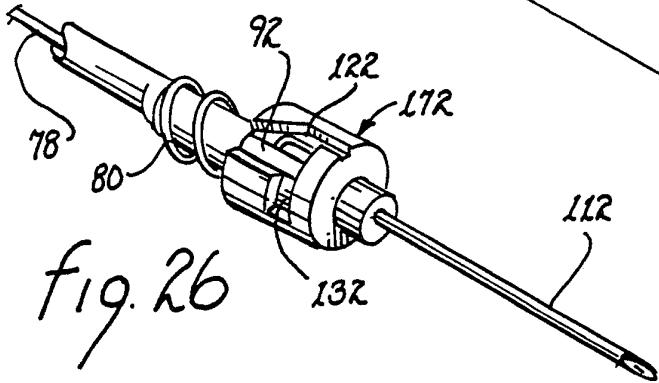

fig. 26

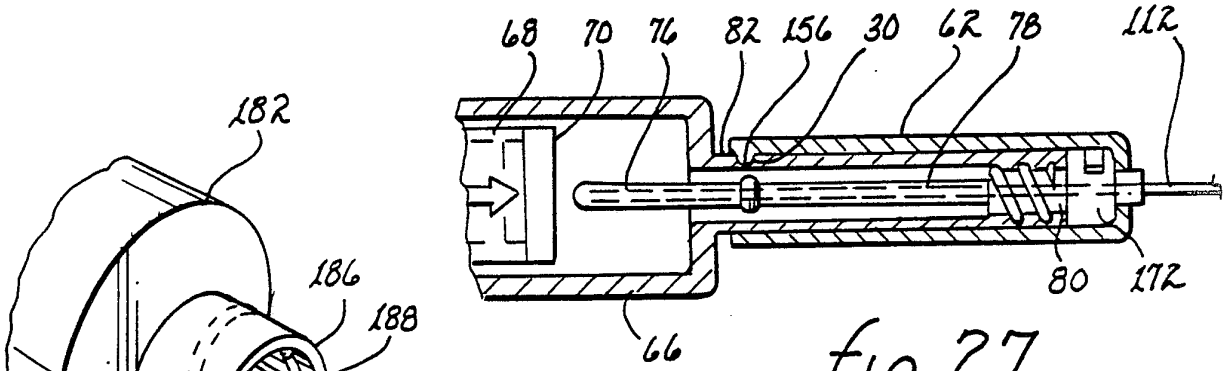

fig. 27

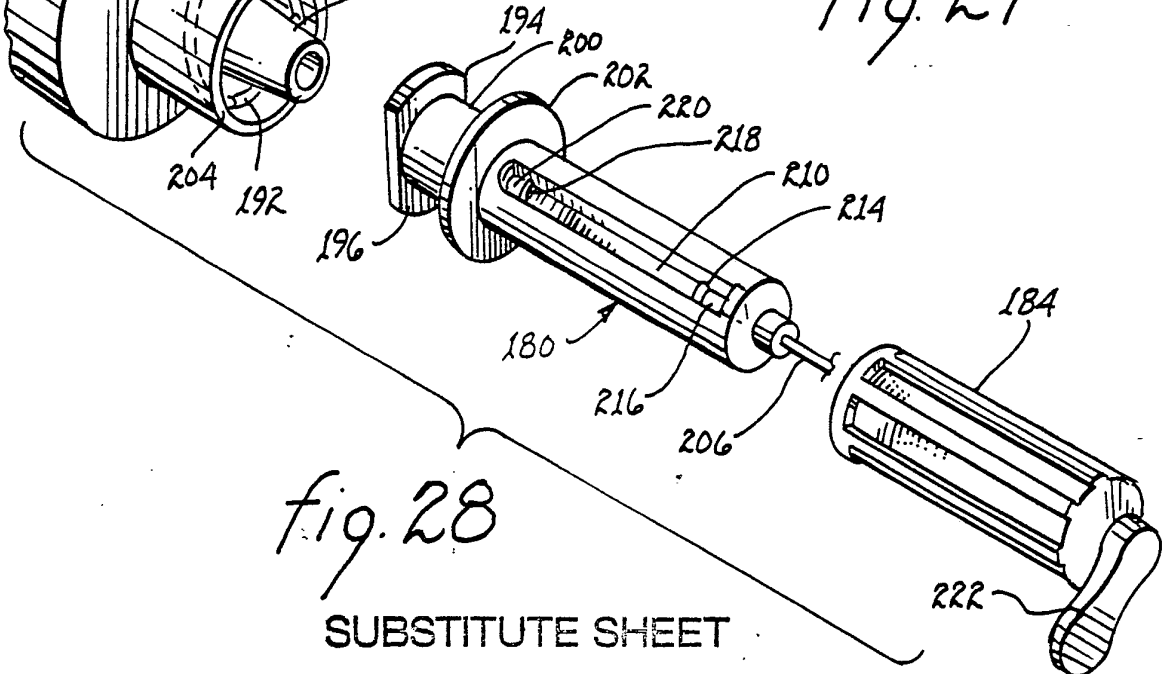
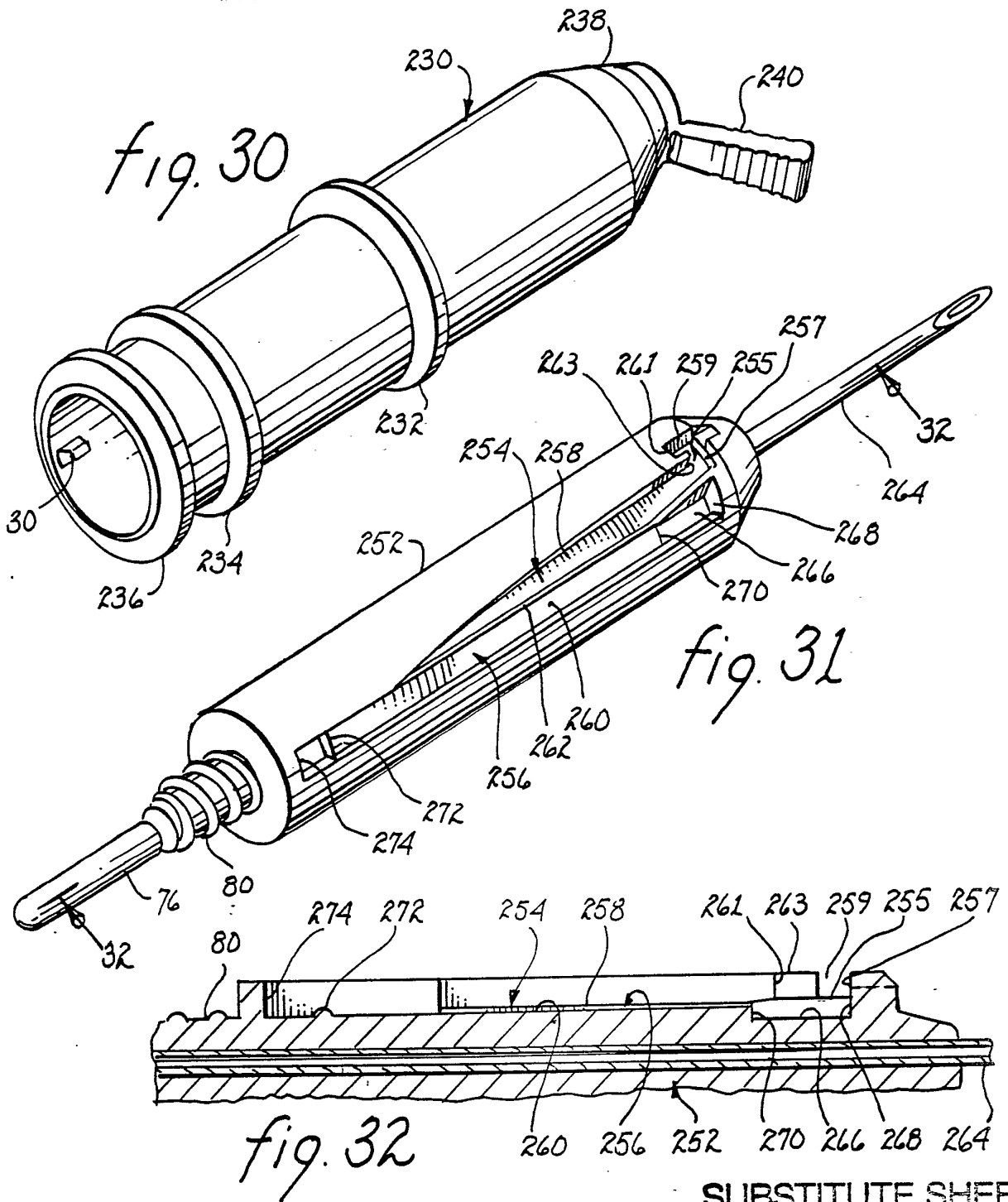
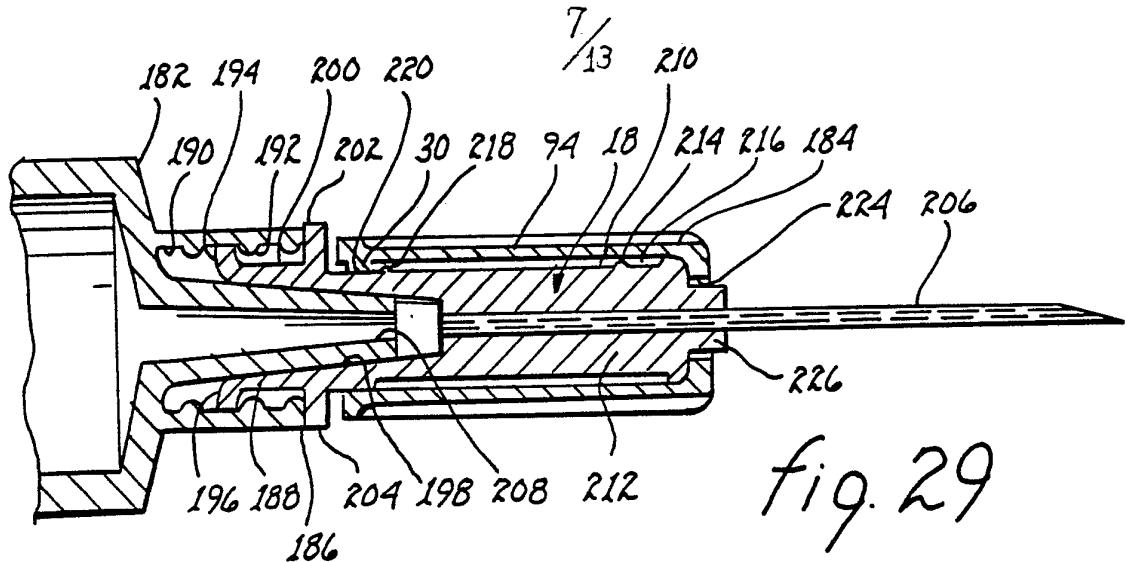

fig. 28

SUBSTITUTE SHEET



8/13

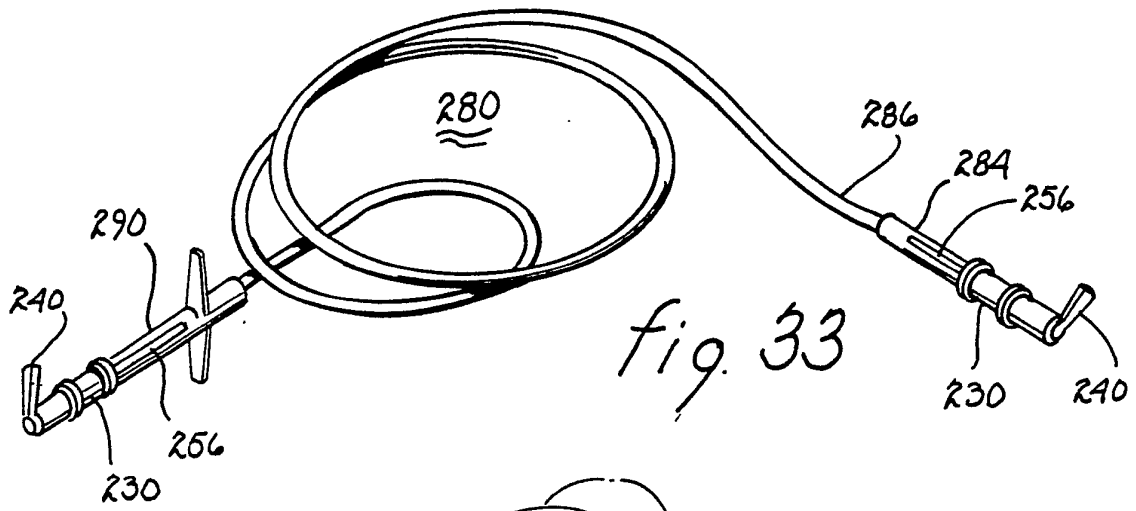

fig. 33

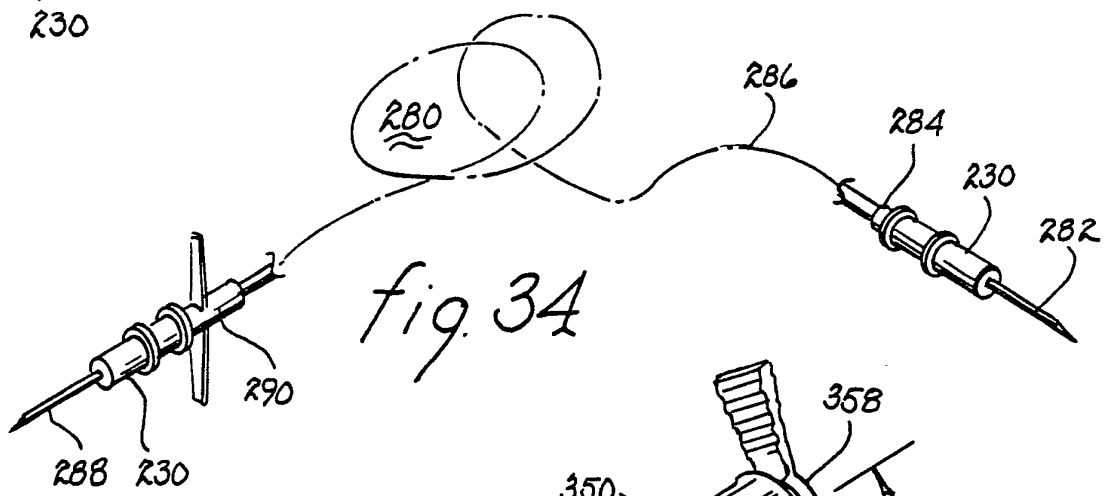

fig. 34

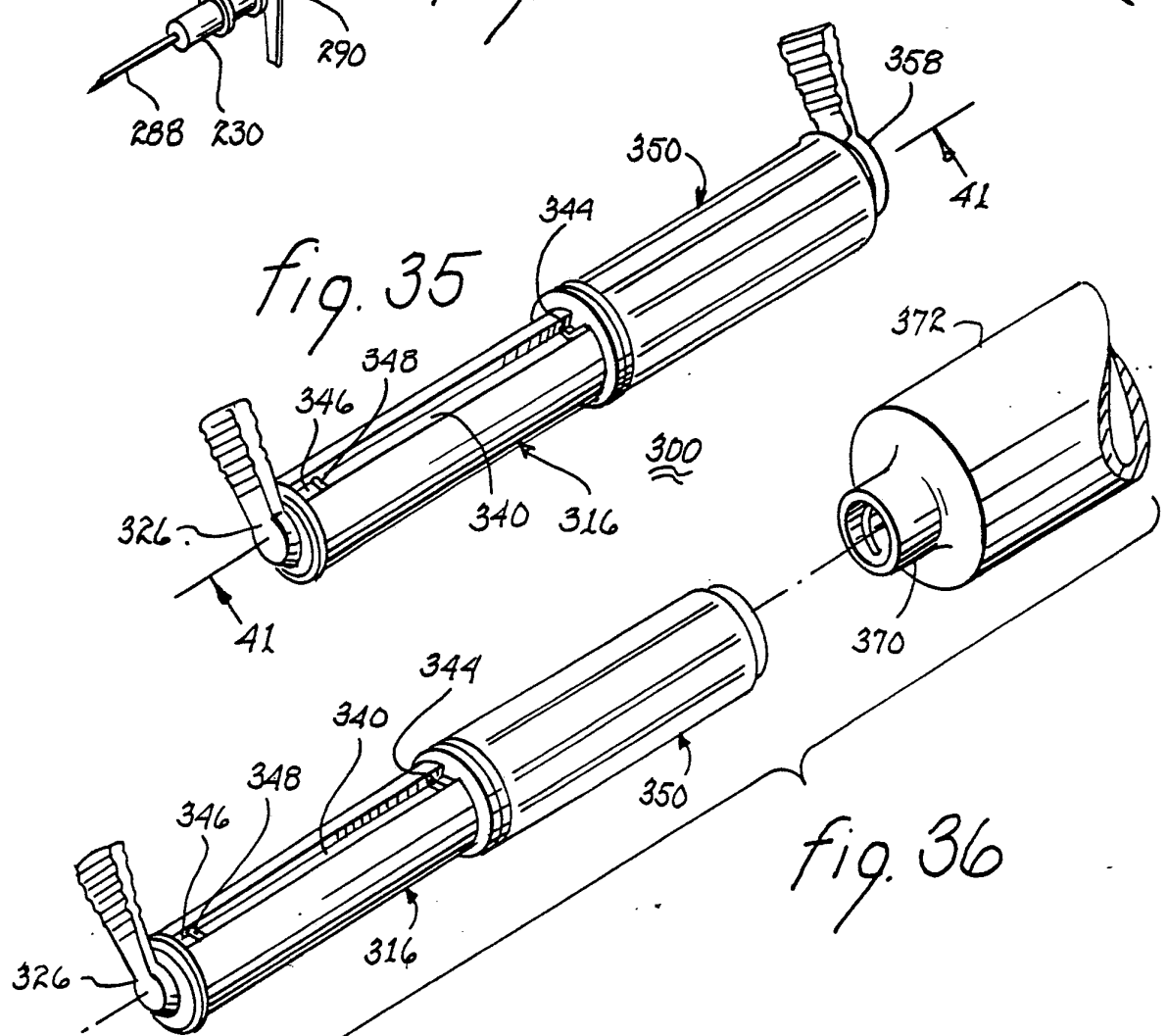
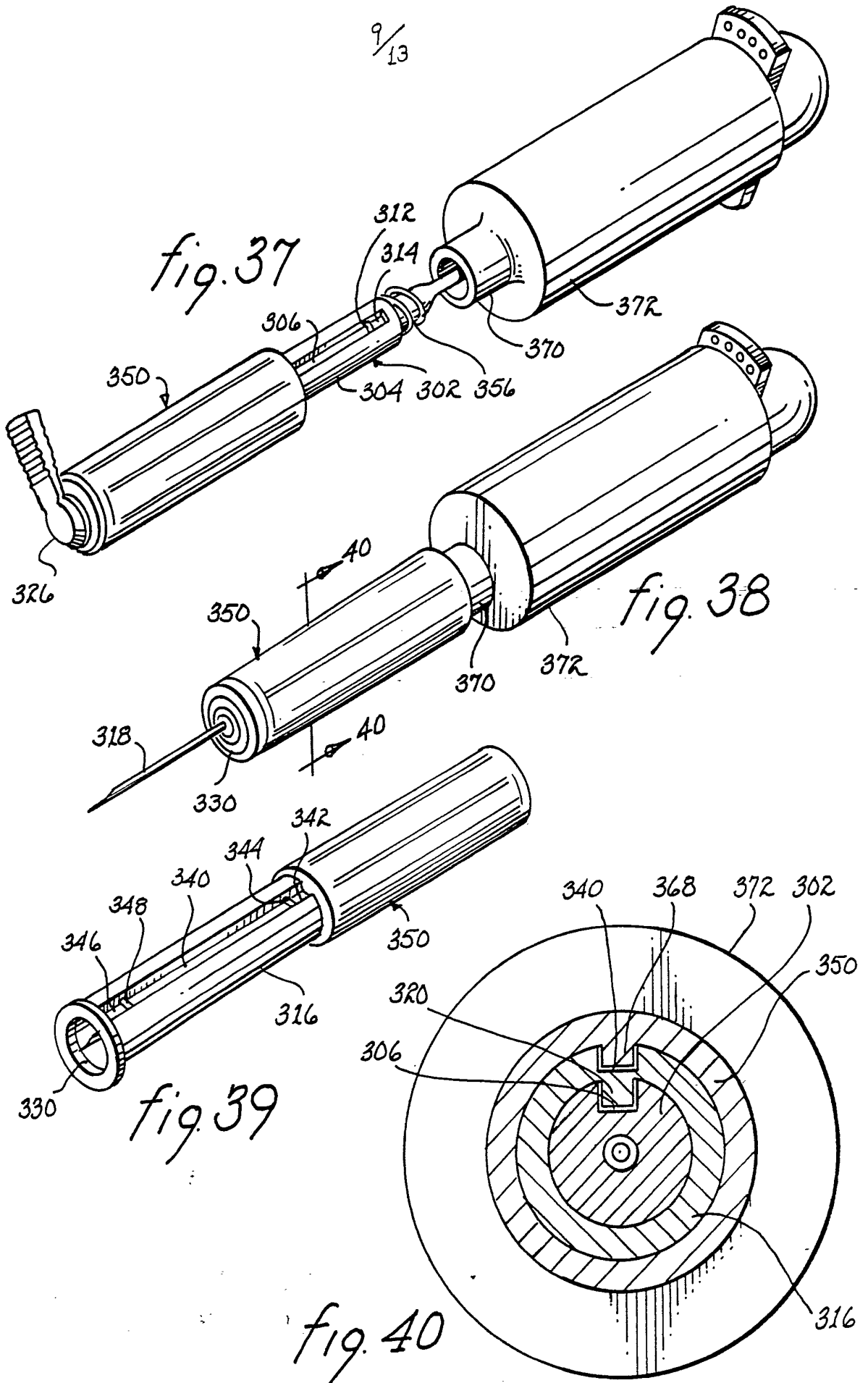

fig. 35

fig. 36

9/13



10
/13

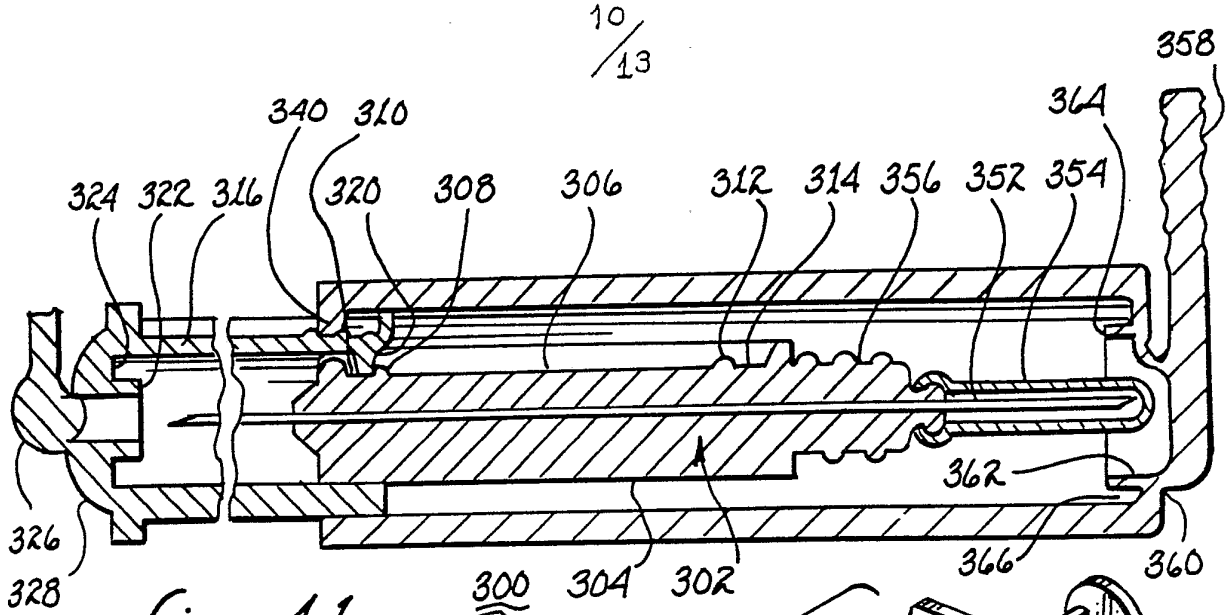

fig. 41

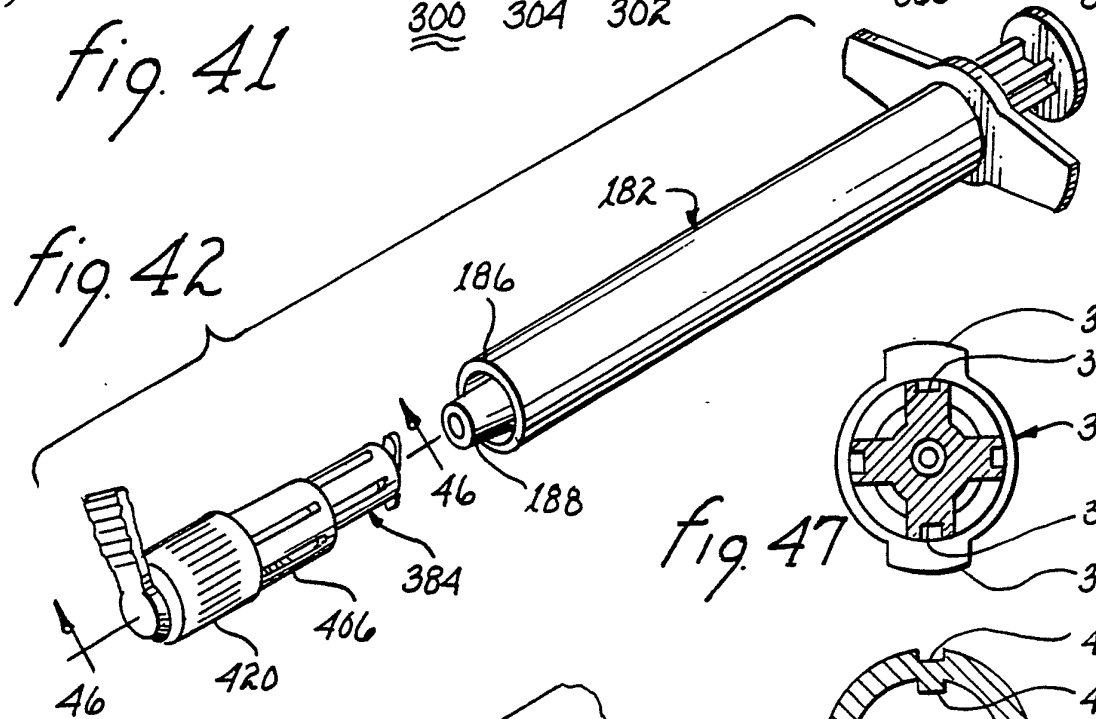

fig. 42

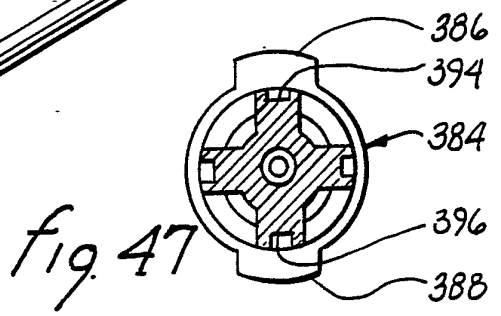

fig. 47

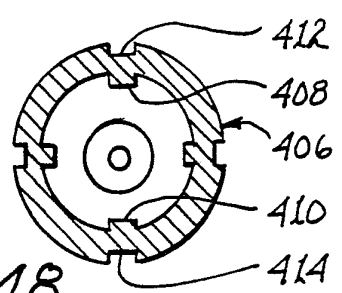

fig. 48

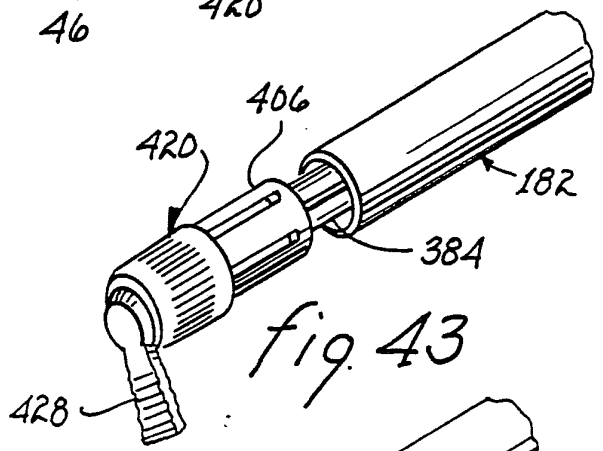

fig. 43

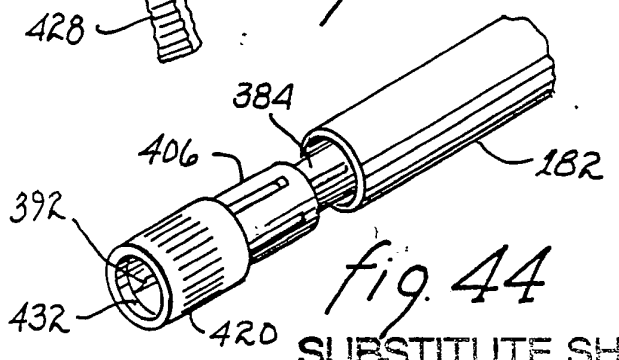

fig. 44

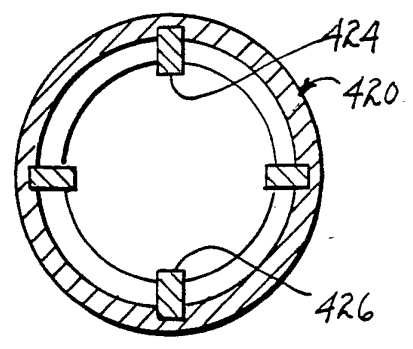
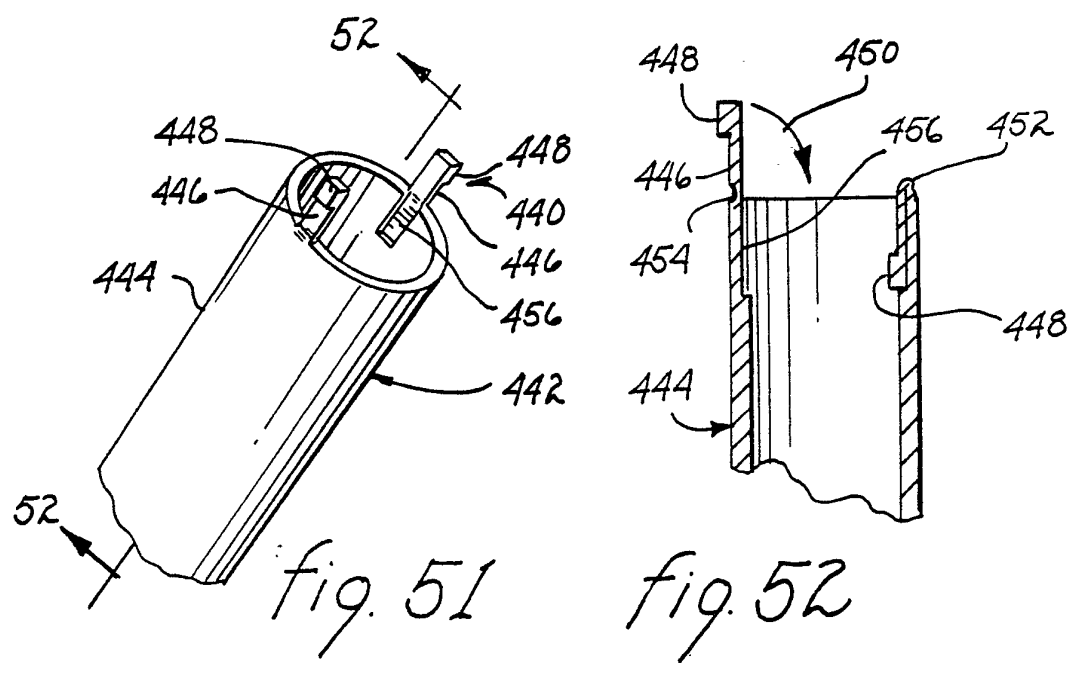
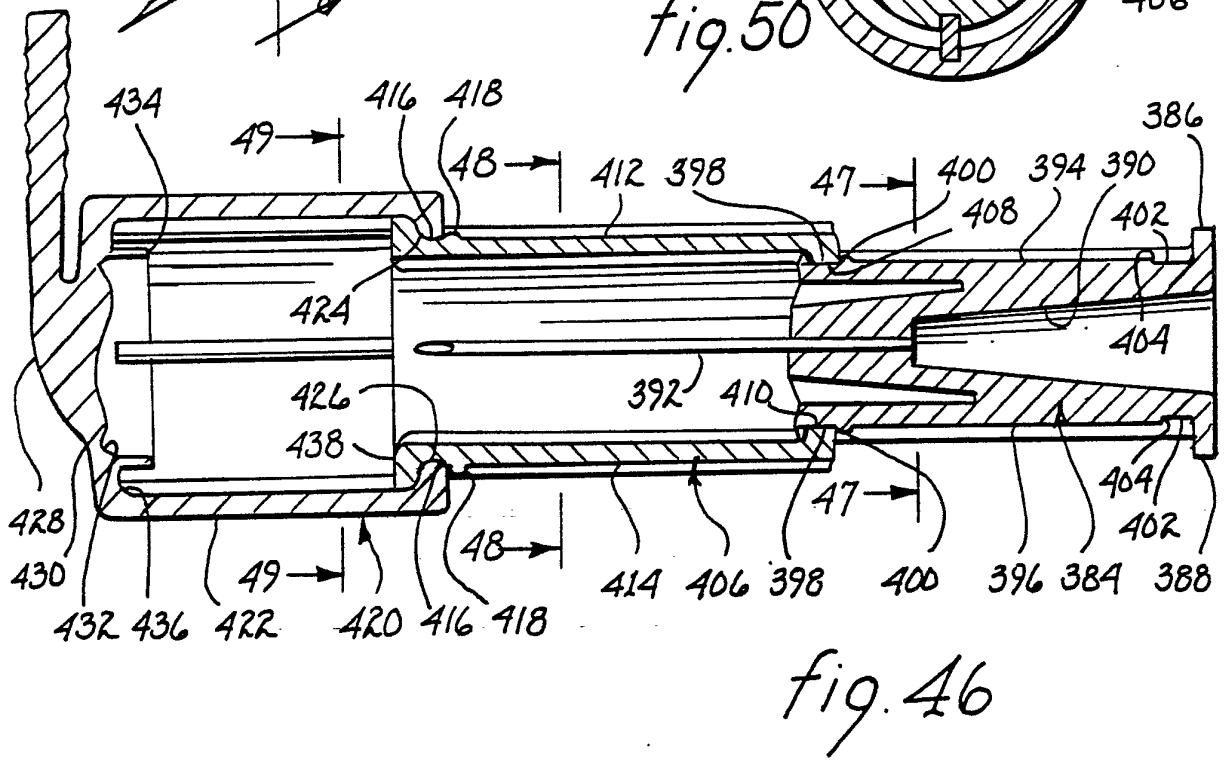
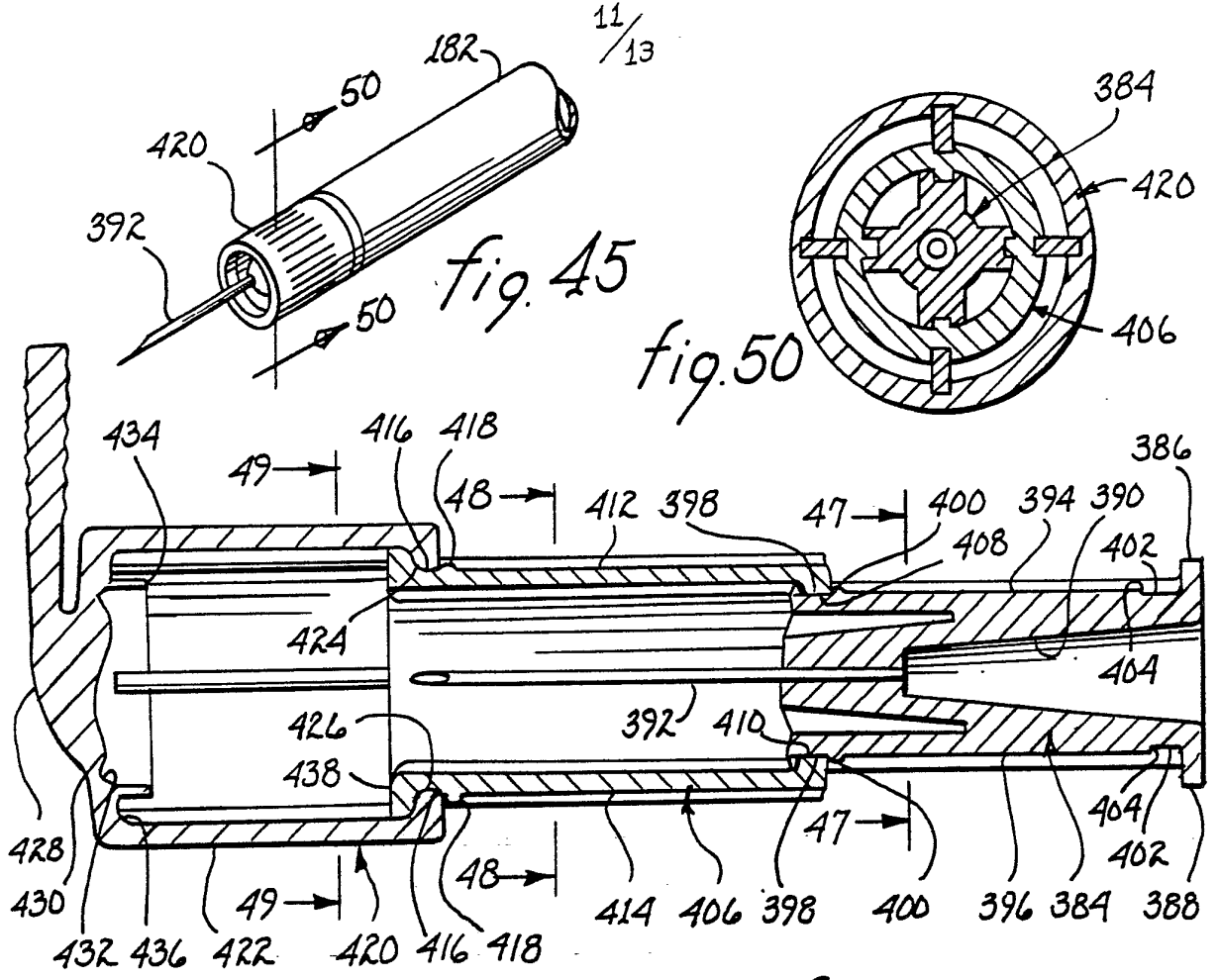

fig. 49

11/13



12
/13

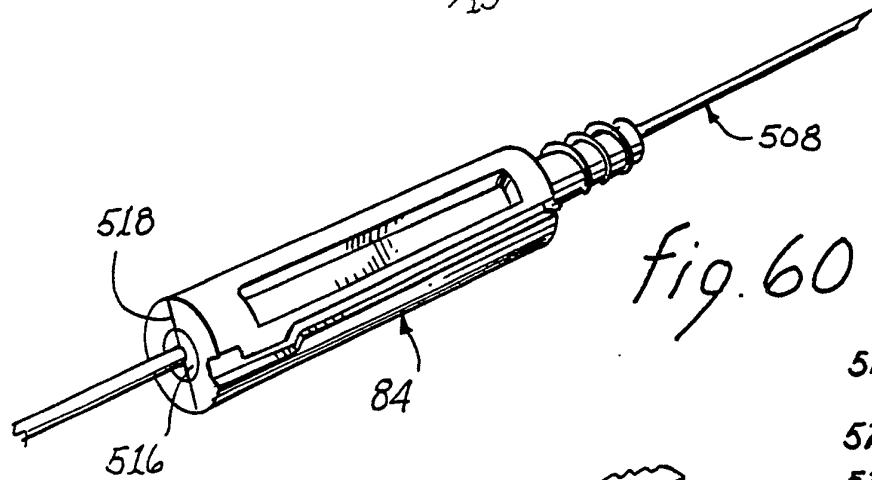

fig. 60

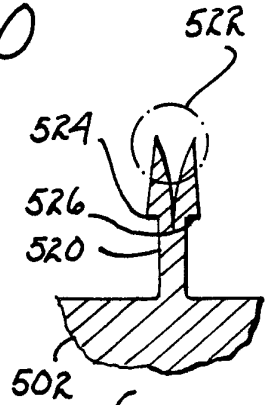

fig. 59

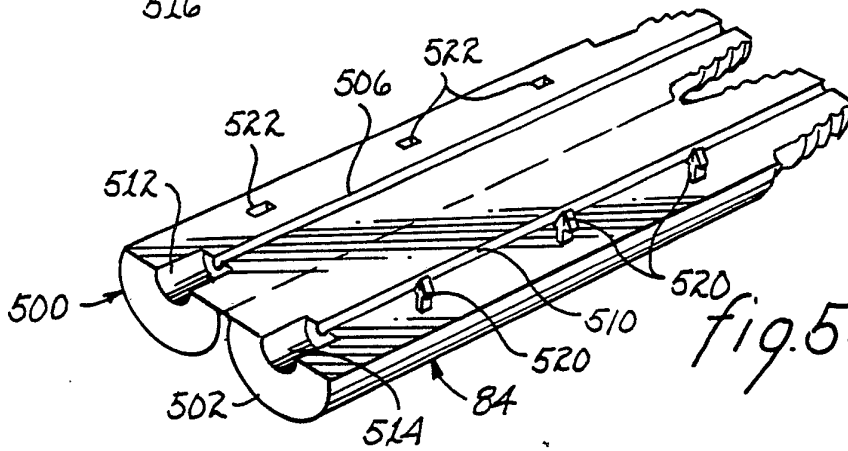

fig. 58

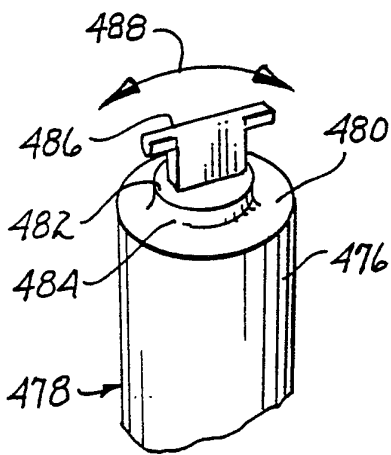

fig. 55

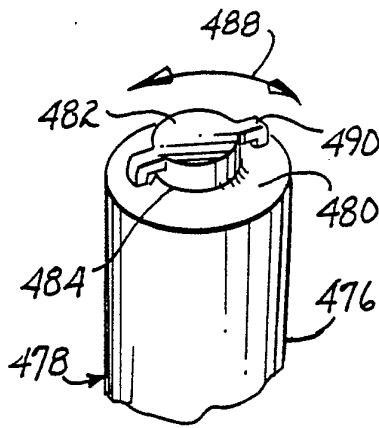

fig. 56

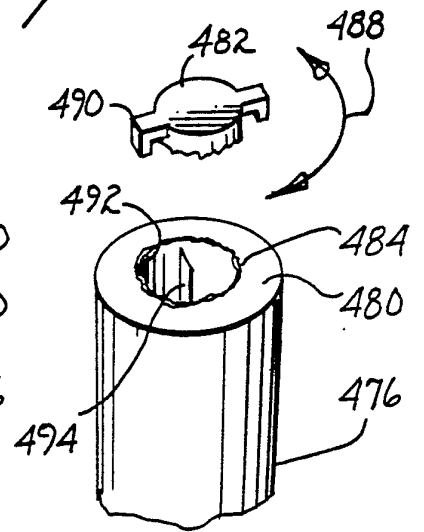

fig. 57

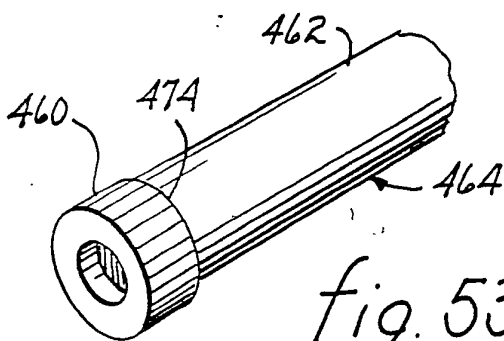

fig. 53

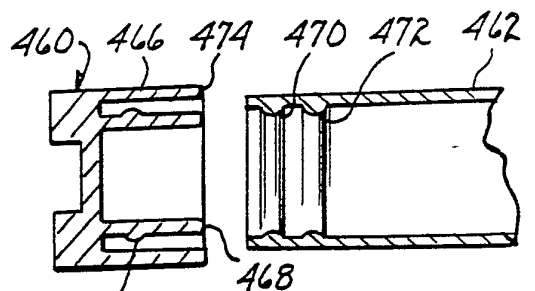
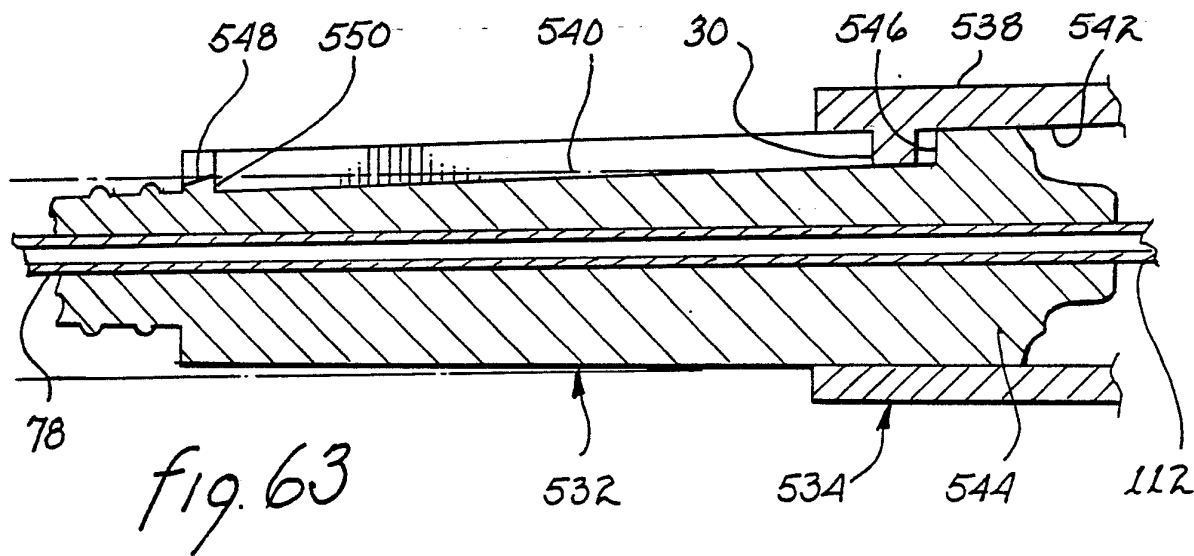
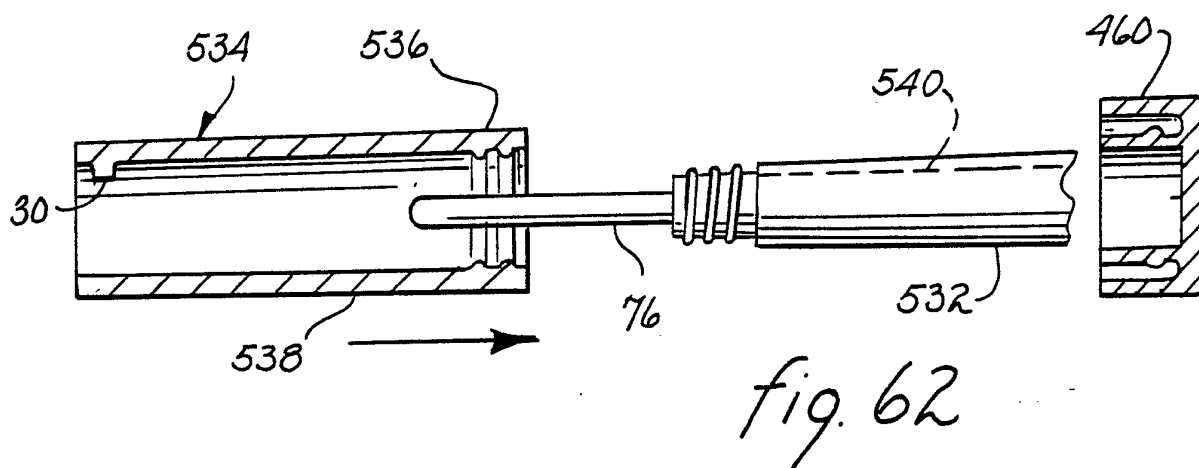
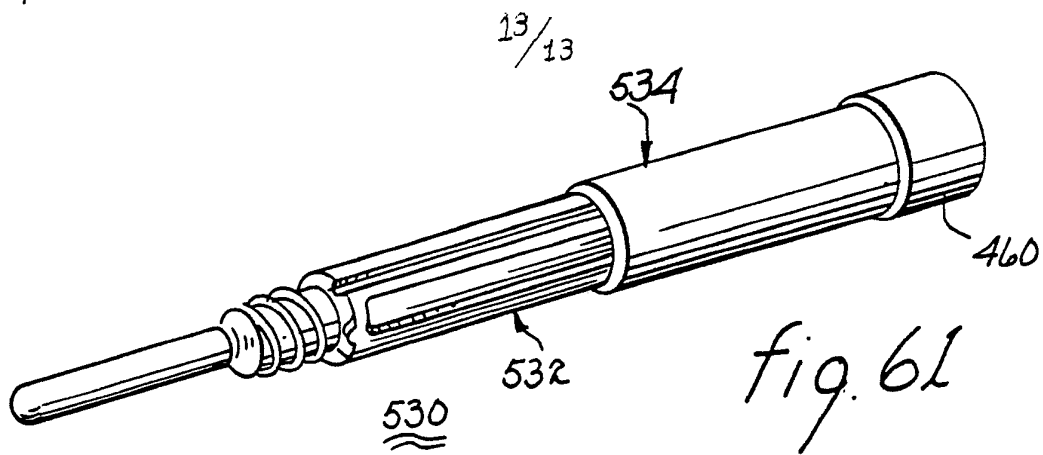

fig. 54



INTERNATIONAL SEARCH REPORT

International Application No

PCT/US87/01140

I. CLASSIFICATION OF SUBJECT MATTER (if several classification symbols apply, indicate all) ³		
According to International Patent Classification (IPC) or to both National Classification and IPC		
IPC (4): A61M 5/00		
U.S. Cl. 604/192		
II. FIELDS SEARCHED		
Minimum Documentation Searched ⁴		
Classification System	Classification Symbols	
U.S.	604/110, 162, 163, 192, 197, 198, 206, 240-243, 263, 272-274, 413, 414 128/763-765; 206/363-366, 438, 571	
Documentation Searched other than Minimum Documentation to the Extent that such Documents are Included in the Fields Searched ⁵		
III. DOCUMENTS CONSIDERED TO BE RELEVANT ¹⁴		
Category [*]	Citation of Document, ¹⁶ with indication, where appropriate, of the relevant passages ¹⁷	Relevant to Claim No. ¹⁸
A	US, A, 2,997,043 (FLYNN) 22 August 1961 See column 2, lines 11-21.	1-3, 28-30, 35, 36, 55, 56 and 70
A	US, A, 3,134,380 (ARMAO) 26 May 1964 See the entire document.	1, 55 and 81
A	US, A, 3,380,448 (SADOVE ET AL) 30 April 1968, see column 1, lines 13-27.	1, 55 and 81
Y	US, A, 3,989,044 (MEIERHOEFER) 02 November 1976, see the entire document.	1-87
Y	US, A, 4,113,090 (CARSTENS) 12 September 1978, see column 4, lines 25-27.	1-3, 28-30, 35, 36, 55, 56 and 70
Y	US, A, 4,170,993 (ALVAREZ) 16 October 1979 See the entire document.	1-87
A	US, A, 4,453,936 (CASSOU) 12 June 1984 See abstract, lines 11-12.	1-3, 28-30, 35, 36, 55, 56 and 70
<p>[*] Special categories of cited documents: ¹⁵</p> <p>"A" document defining the general state of the art which is not considered to be of particular relevance</p> <p>"E" earlier document but published on or after the international filing date</p> <p>"L" document which may throw doubts on priority claim(s) or which is cited to establish the publication date of another citation or other special reason (as specified)</p> <p>"O" document referring to an oral disclosure, use, exhibition or other means</p> <p>"P" document published prior to the international filing date but later than the priority date claimed</p> <p>"T" later document published after the international filing date or priority date and not in conflict with the application but cited to understand the principle or theory underlying the invention</p> <p>"X" document of particular relevance; the claimed invention cannot be considered novel or cannot be considered to involve an inventive step</p> <p>"Y" document of particular relevance; the claimed invention cannot be considered to involve an inventive step when the document is combined with one or more other such documents, such combination being obvious to a person skilled in the art.</p> <p>"&" document member of the same patent family</p>		
IV. CERTIFICATION		
Date of the Actual Completion of the International Search ¹	Date of Mailing of this International Search Report ²	
09 June 1987	23 JUL 1987	
International Searching Authority ¹	Signature of Authorized Officer ²⁰	
ISA/US	Frank Wilkens <i>Frank Wilkens</i>	

FURTHER INFORMATION CONTINUED FROM THE SECOND SHEET

A	US, A, 4,573,976 (SAMPSON ET AL) 04 March 1986, see the entire document.	1-87
A, P	US, A, 4,643,722 (SMITH, JR.) 17 February 1987, see abstract, lines 10-11.	1-3, 28-30, 35, 36, 55, 56 and 70
A, P	US, A, 4,654,034 (MASTERS ET AL) 31 March 1987, see the entire document.	1, 28-54 and 69-80
A, P	US, A, 4,655,751 (HARBAUGH) 17 April 1987 See the entire document.	1, 55 and 81

V. OBSERVATIONS WHERE CERTAIN CLAIMS WERE FOUND UNSEARCHABLE ¹⁰

This international search report has not been established in respect of certain claims under Article 17(2) (a) for the following reasons:

1. Claim numbers because they relate to subject matter ¹² not required to be searched by this Authority, namely:

2. Claim numbers because they relate to parts of the international application that do not comply with the prescribed requirements to such an extent that no meaningful international search can be carried out ¹³, specifically:

VI. OBSERVATIONS WHERE UNITY OF INVENTION IS LACKING ¹¹

This International Searching Authority found multiple inventions in this international application as follows:

1. As all required additional search fees were timely paid by the applicant, this international search report covers all searchable claims of the international application.

2. As only some of the required additional search fees were timely paid by the applicant, this international search report covers only those claims of the international application for which fees were paid, specifically claims:

3. No required additional search fees were timely paid by the applicant. Consequently, this international search report is restricted to the invention first mentioned in the claims; it is covered by claim numbers:

4. As all searchable claims could be searched without effort justifying an additional fee, the International Searching Authority did not invite payment of any additional fee.

Remark on Protest

The additional search fees were accompanied by applicant's protest.

No protest accompanied the payment of additional search fees.

III. DOCUMENTS CONSIDERED TO BE RELEVANT (CONTINUED FROM THE SECOND SHEET)		
Category *	Citation of Document, ¹⁶ with indication, where appropriate, of the relevant passages ¹⁷	Relevant to Claim No ¹⁸
A, P	US, A, 4,659,330 (NELSON ET AL) 21 April 1987 see the entire document.	1,55 and 81
A,	US, A, 3,889,673 (DOVEY ET AL) 17 June 1975 see the entire document	1,55 and 81