

(19) World Intellectual Property Organization
International Bureau



(43) International Publication Date
17 March 2011 (17.03.2011)

(10) International Publication Number
WO 2011/031992 A3

(51) International Patent Classification:

B62K 17/00 (2006.01) **B62K 3/00** (2006.01)
B62K 13/00 (2006.01) **B60L 15/20** (2006.01)
B62K 11/00 (2006.01) **B62K 5/04** (2006.01)

sachusetts 02143 (US). **BLECK, Olaf** [US/US]; 24 Breakwater Drive, Chelsea, Massachusetts 02150 (US). **GULAK, Benjamin J. Poss** [CA/CA]; 5175 Derry Road, Milton, Ontario L9T2X6 (CA).

(21) International Application Number:

PCT/US2010/048460

(74) Agents: **ROHLICEK, J. Robin** et al.; Occhiuti Rohlicek & Tsao LLP, 10 Fawcett Street, Cambridge, MA 02138 (US).

(22) International Filing Date:

10 September 2010 (10.09.2010)

(81) Designated States (unless otherwise indicated, for every kind of national protection available): AE, AG, AL, AM, AO, AT, AU, AZ, BA, BB, BG, BH, BR, BW, BY, BZ, CA, CH, CL, CN, CO, CR, CU, CZ, DE, DK, DM, DO, DZ, EC, EE, EG, ES, FI, GB, GD, GE, GH, GM, GT, HN, HR, HU, ID, IL, IN, IS, JP, KE, KG, KM, KN, KP, KR, KZ, LA, LC, LK, LR, LS, LT, LU, LY, MA, MD, ME, MG, MK, MN, MW, MX, MY, MZ, NA, NG, NI, NO, NZ, OM, PE, PG, PH, PL, PT, RO, RS, RU, SC, SD, SE, SG, SK, SL, SM, ST, SV, SY, TH, TJ, TM, TN, TR, TT, TZ, UA, UG, US, UZ, VC, VN, ZA, ZM, ZW.

(25) Filing Language:

English

(26) Publication Language:

English

(30) Priority Data:

61/241,282 10 September 2009 (10.09.2009) US

(71) Applicant (for all designated States except US): **BPG INC.** [US/US]; 95 Fulkerson Street, Cambridge, Massachusetts 02141 (US).

(72) Inventors; and

(75) Inventors/Applicants (for US only): **DILWORTH, Peter** [US/US]; 23 Monmouth Street, Somerville, Mas-

(84) Designated States (unless otherwise indicated, for every kind of regional protection available): ARIPO (BW, GH,

[Continued on next page]

(54) Title: PERSONAL TRANSPORT VEHICLE

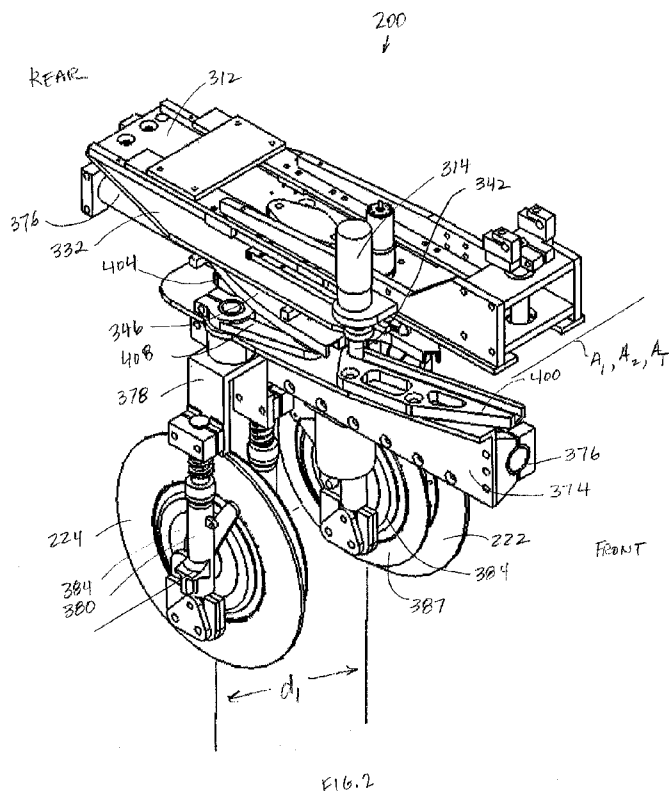

(57) Abstract: A personal transport vehicle is disclosed that can transition, while in motion, between a unicycle and motorcycle operating modes. The vehicle includes a frame, a first and second wheel connected to the frame, and a drive system mounted to the frame and configured to drive at least one of the first and second wheels. The wheels are configured to move relative to each other while the vehicle is in motion such that the spacing in the direction of travel of the vehicle between the axis of rotation of the first wheel and the axis of rotation of the second wheel changes. In unicycle mode, the wheels are side-by-side and the vehicle is operated using first set of steering, vehicle speed, and balance controls. In the motorcycle mode, the wheels are splayed in the fore-aft direction and the vehicle is operated using second set of steering, vehicle speed, and balance controls.

WO 2011/031992 A3

GM, KE, LR, LS, MW, MZ, NA, SD, SL, SZ, TZ, UG, ZM, ZW), Eurasian (AM, AZ, BY, KG, KZ, MD, RU, TJ, TM), European (AL, AT, BE, BG, CH, CY, CZ, DE, DK, EE, ES, FI, FR, GB, GR, HR, HU, IE, IS, IT, LT, LU, LV, MC, MK, MT, NL, NO, PL, PT, RO, SE, SI, SK, SM, TR), OAPI (BF, BJ, CF, CG, CI, CM, GA, GN, GQ, GW, ML, MR, NE, SN, TD, TG).

Published:

— *with international search report (Art. 21(3))*

(88) Date of publication of the international search report:

29 September 2011

A. CLASSIFICATION OF SUBJECT MATTER

B62K 17/00(2006.01)i, B62K 13/00(2006.01)i, B62K 11/00(2006.01)i, B62K 3/00(2006.01)i, B60L 15/20(2006.01)i, B62K 5/04(2006.01)i

According to International Patent Classification (IPC) or to both national classification and IPC

B. FIELDS SEARCHED

Minimum documentation searched (classification system followed by classification symbols)

B62K 17/00; B60K 11/02; B62K 15/00; B62J 6/06

Documentation searched other than minimum documentation to the extent that such documents are included in the fields searched

Korean utility models and applications for utility models
Japanese utility models and applications for utility models

Electronic data base consulted during the international search (name of data base and, where practicable, search terms used)

eKOMPASS(KIPO internal) & Keywords: vehicle, wheels, in motion, motor, engine, bicycle

C. DOCUMENTS CONSIDERED TO BE RELEVANT

Category*	Citation of document, with indication, where appropriate, of the relevant passages	Relevant to claim No.
X	KR 20-0318845 Y1 (YU, I. J.) 04 July 2003 See abstract and figures 1-4.	1, 17
X	JP 50-102045 U1 (NOMURA, TOMOKUNI) 23 August 1975 See claim 1 and figure.	18
X	EP 2221205 A1 (LAING BAN INTERNATIONAL INC.) 25 August 2010 See claim 1 and figures 1-11.	19
A	JP 62-061788 U (HONDA KIKEN CO. LTD.) 16 April 1987 See claim 1 and figures 1-2.	1-19

Further documents are listed in the continuation of Box C.

See patent family annex.

* Special categories of cited documents:

"A" document defining the general state of the art which is not considered to be of particular relevance

"E" earlier application or patent but published on or after the international filing date

"L" document which may throw doubts on priority claim(s) or which is cited to establish the publication date of citation or other special reason (as specified)

"O" document referring to an oral disclosure, use, exhibition or other means

"P" document published prior to the international filing date but later than the priority date claimed

"T" later document published after the international filing date or priority date and not in conflict with the application but cited to understand the principle or theory underlying the invention

"X" document of particular relevance; the claimed invention cannot be considered novel or cannot be considered to involve an inventive step when the document is taken alone

"Y" document of particular relevance; the claimed invention cannot be considered to involve an inventive step when the document is combined with one or more other such documents, such combination being obvious to a person skilled in the art

"&" document member of the same patent family

Date of the actual completion of the international search

01 JUNE 2011 (01.06.2011)

Date of mailing of the international search report

03 JUNE 2011 (03.06.2011)

Name and mailing address of the ISA/KR



Korean Intellectual Property Office
Government Complex-Daejeon, 189 Cheongsa-ro,
Seo-gu, Daejeon 302-701, Republic of Korea

Facsimile No. 82-42-472-7140

Authorized officer

WON, Yoo Cheol

Telephone No. 82-42-481-5969



INTERNATIONAL SEARCH REPORT

Information on patent family members

International application No.

PCT/US2010/048460

Patent document cited in search report	Publication date	Patent family member(s)	Publication date
KR 20-0318845 Y1	04.07.2003	None	
JP 50-102045 U1	23.08.1975	None	
EP 2221205 A1	25.08.2010	None	
JP 62-061788 U	16.04.1987	None	