

Loeffelholz & Prier,

Sash Fastener.

No. 113070.

Patented Mar. 28, 1871.

Fig. 1.

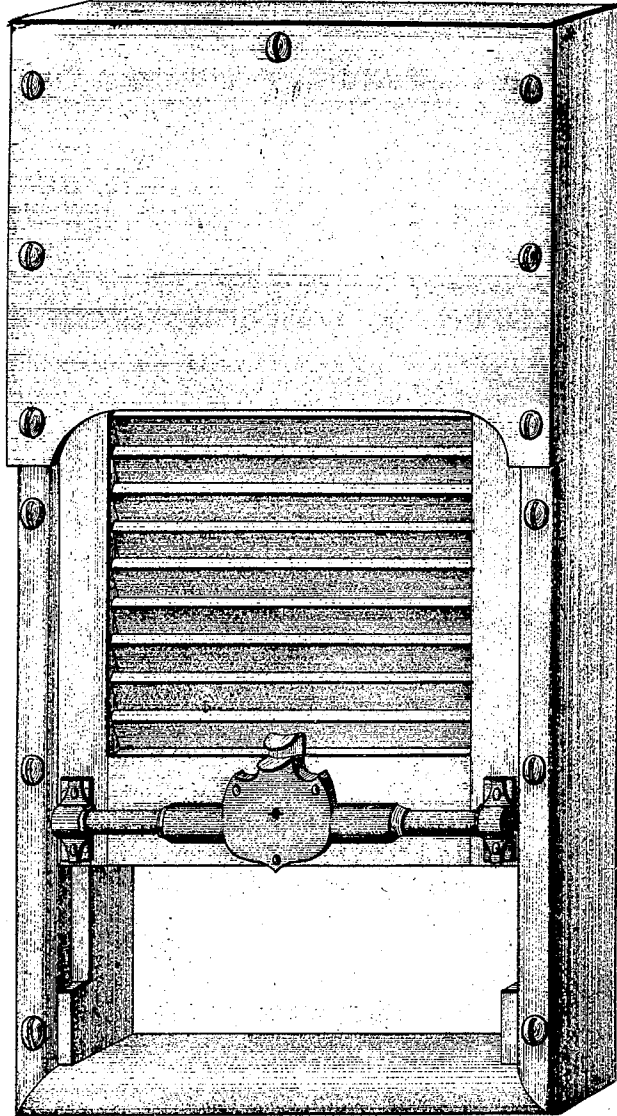
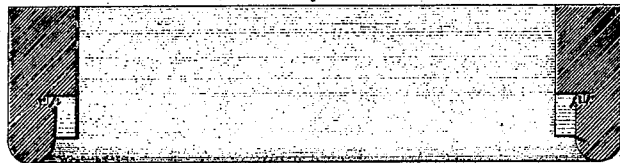

Fig. 2.



WITNESSES

G. W. Mygath  
F. S. Bonnell

INVENTORS

A. Loeffelholz  
& Prier

*Loeffelholz & Frier,*

*3. Sheets, Sheet 2.*

*Sash Fastener.*

*No. 113070.*

*Patented Mar. 28. 1871.*

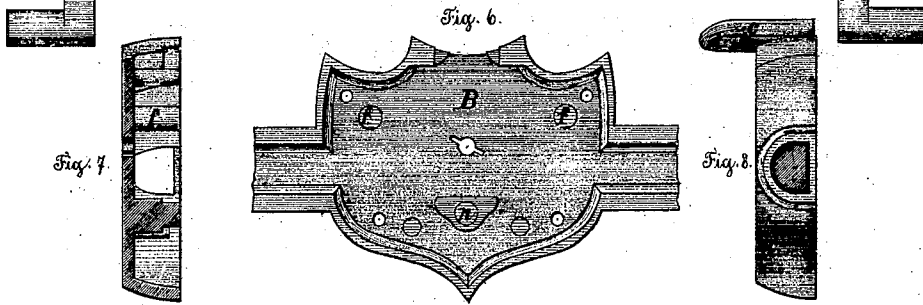
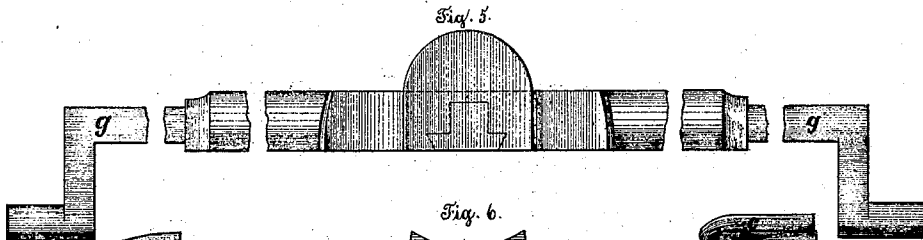
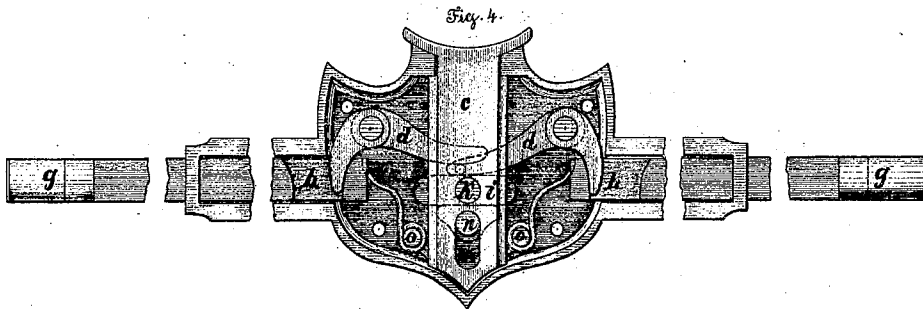
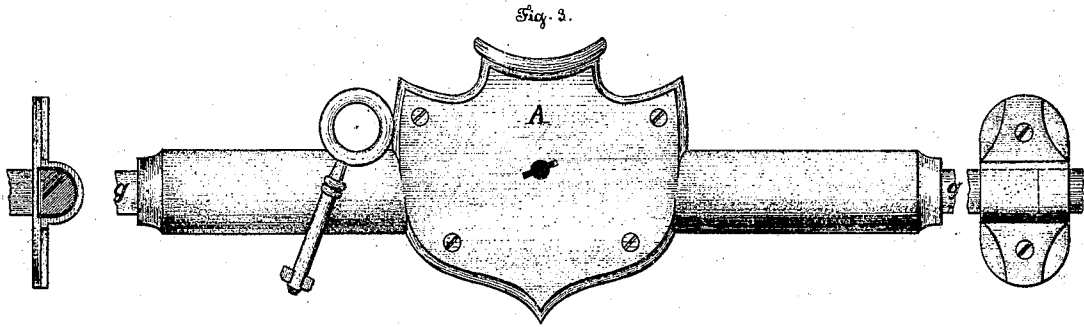
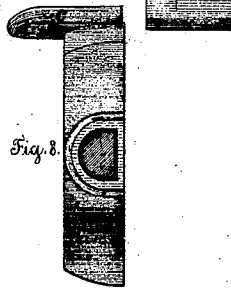

Fig. 7.



Fig. 8.



WITNESSES

*G. W. Mygatt*  
*F. S. Bunnell*

INVENTORS

*A. Loeffelholz*  
*et. Frier*

Loeffelholz & Prier,

3. Sheets, Sheet 3.

Sash Fastener.

No. 113070.

Patented Mar. 28. 1871.

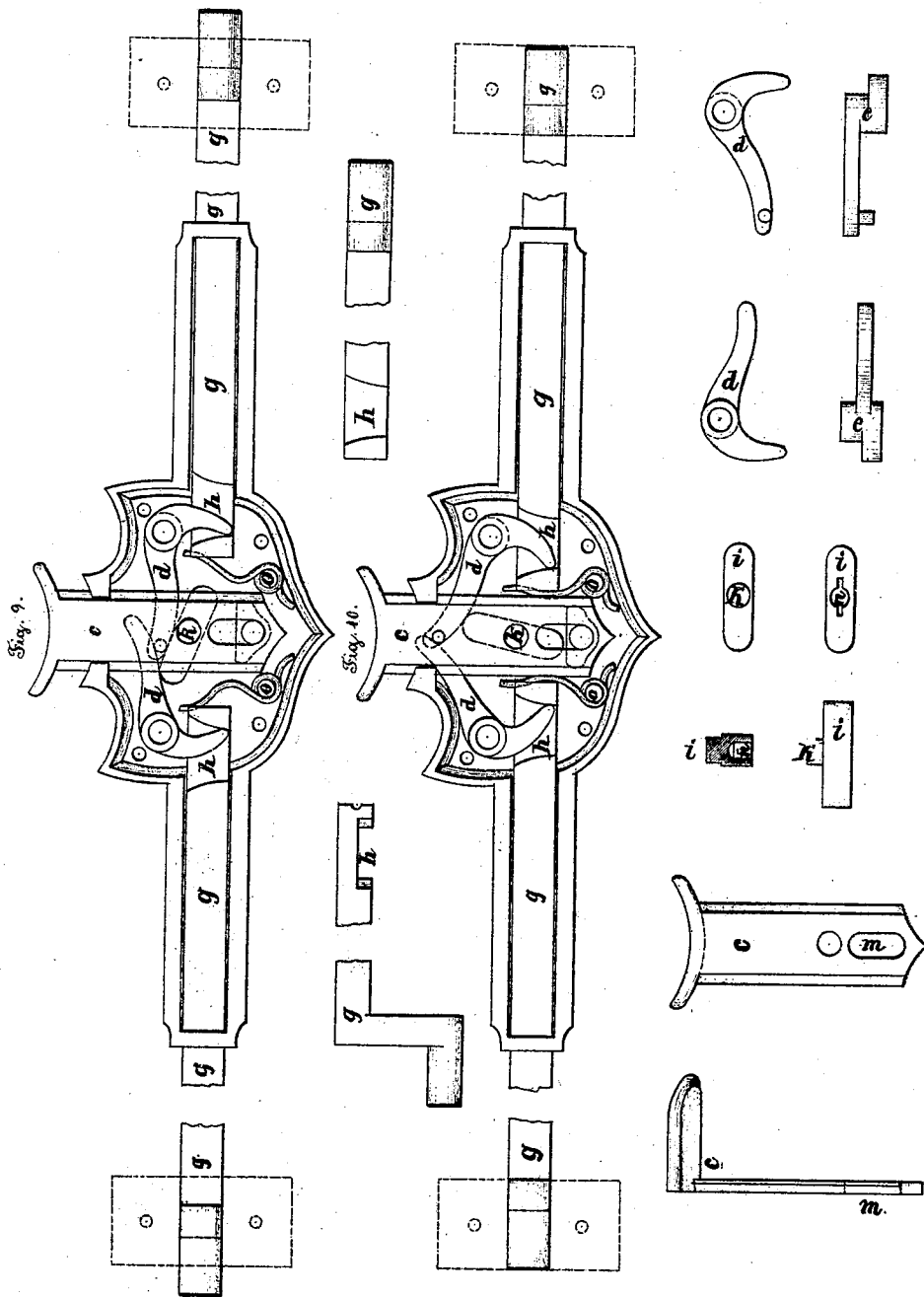

WITNESSES

E. W. Mygatt  
J. S. Pinnell

INVENTORS

A. Loeffelholz  
& C. Prier

# United States Patent Office.

ADAM LOEFFELHOLZ AND ANTON PRIER, OF MILWAUKEE, WISCONSIN.

Letters Patent No. 113,070, dated March 28, 1871.

## IMPROVEMENT IN SASH-HOLDERS FOR RAILROAD-CARS.

The Schedule referred to in these Letters Patent and making part of the same.

We, ADAM LOEFFELHOLZ and ANTON PRIER, of the city of Milwaukee, in the State of Wisconsin, have invented certain Improvements on Locks and Fasteners for Railroad-Car Window-Sash and Blinds, of which the following is a specification.

The object of this invention is to provide the sash of the car with an economical and useful lock or fastener, having as a leading feature the ready and easy affixing or attaching of the sash in the frame, and the ready detaching thereof, in addition to the usual features of such fasteners, of securing the sash, when down or when up, and of holding the sash at intermediate points of elevation between the lower and upper parts of the frame; and consists in an arrangement of a tumbler having a key-hole, in combination with the lift and levers, whereby, when the lift is elevated, the keyhole is exposed, allowing the key to be put in use, and to so further withdraw the bolts as to allow of the detaching of the sash or blind.

### Explanation of the Drawing.

Figure 1 is a perspective view showing the position of the lock on the blind or sash.

Figure 2, plan showing grooves for the bolts and notches in the frame for the ends of the bolts, securing the blinds or sash in place when closed or opened.

Figure 3, front plate of the lock, with the key, and clasp for the ends of the bolts, shown by front view and by section.

Figure 4, internal arrangement of the parts.

Figure 5, sectional view, showing kneed bolts and lift.

Figure 6, view of the back plate of the lock.

Figure 7, section through the center of the lock, with space for the bolts.

Figure 8, section showing the ends of the bolts and lift.

Figure 9, section showing the position of the parts by action of the lift for raising or lowering the blind or sash.

Figure 10, section showing the position of the parts by action of the key, which admits of the removal of the sash or blind when so desired.

The other unnumbered views of parts will readily be recognized as views of detached pieces or parts.

The letters on the drawing refer to the several parts thus.

- A, front plate of the lock.
- B, back plate of the lock.
- C, lift.
- d, angle-levers, face view.

e, angle-levers, edge view.

f, pin for angle-levers, which levers actuate the bolts

g, bolts, kneed at each end.

h, recess on the inner ends of the bolts for the ends of the angle-levers.

i, front side and section of the tumbler with the key-hole.

k, pin of the tumbler, operating in and with the lift-piece.

m, slot in the lift-piece for the guide-piece.

n, key-hole in the tumbler.

o, springs for the bolts.

p, grooves in the frame, in which the end of the bolts slide.

r, notches in the frame holding the sash or blind in place, either up or down.

Other notches may be at such intermediate points as desirable.

Now it will readily be perceived that if the lift C be raised the bolts will be drawn inward, the ends being removed from the notches in the frame, and thus the sash or blind may be in condition to be raised or lowered, and when the pressure from the lift is removed the springs will come into play and force out the bolts, so that the sash or blind will be held closed or opened, as may be desired.

In order to act still further upon the bolts, so as to relieve their ends from the recesses in the frame, and allow of the detaching and removal of the sash or blind from the frame, when the lift C is fully elevated the key is inserted, and then, by the action of the key on the tumbler i, the bolts are drawn further inward, and the ends of the bolts removed from the recesses.

We are aware that an arrangement of springs and levers, to be actuated by a thumb-piece or lifts, or by a key, has been used to operate the bolts of sash-holders, and we therefore do not claim such arrangement; but

What we do claim is—

An arrangement of lifts, levers, springs, and bolts, in combination with a tumbler, i, to be operated upon by a key, for the purpose of allowing the sash to be detached or removed from the frame, substantially as herein recited.

This specification signed this 17th day of January, 1871.

ADAM LOEFFELHOLZ.  
ANTON PRIER.

Witnesses:

F. S. BONNELL,  
H. P. ELLIS.