

(21) Application No: 0620767.4  
(22) Date of Filing: 19.10.2006

(51) INT CL: E04D 13/16 (2006.01) E04B 1/76 (2006.01)

(71) Applicant(s): John Ralph  
2 Busby Lane, KIRKBY-IN-CLEVELAND,  
TS9 7AW, United Kingdom

(56) Documents Cited: EP 0029277 A1 DE 020308997 U1  
DE 019654465 A1 DE 010038927 A1  
DE 003713574 A DE 003531910 A  
FR 002636657 A1

(72) Inventor(s): John Ralph

(58) Field of Search: INT CL E04B, E04D  
Other: EPODOC, WPI

(74) Agent and/or Address for Service: John Ralph  
2 Busby Lane, KIRKBY-IN-CLEVELAND,  
TS9 7AW, United Kingdom

(54) Abstract Title: Pitched roof energy saving insulating system

(57) The invention relates to a system of insulating a pitched roof structure. The invention comprises a "Z" shaped extruded carrier fixed to the roof rafters to hold in place insulation boards positioned between said roof rafters. The extruded carrier is preferably fixed to the rafters by means of a corrosion resistant screw and washer assembly. The "Z" shaped carrier and insulation boards may be fixed to the pitched roof externally without the need to access the roof internally, thereby maintaining security and privacy for the building occupiers.

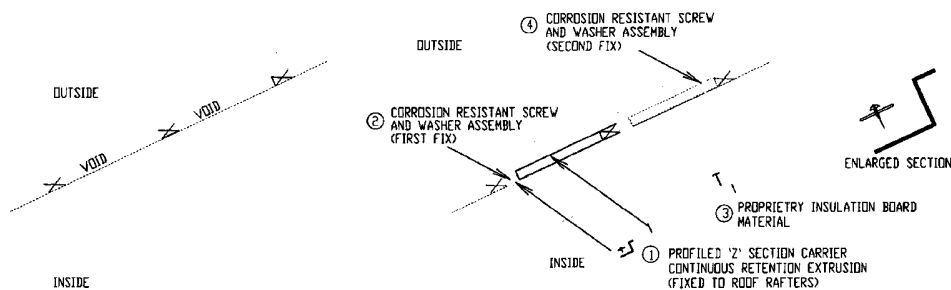

TYPICAL ROOF SECTION BEFORE APPLICATION

TYPICAL ROOF SECTION AFTER APPLICATION

PITCHED ROOF ENERGY SAVING INSULATION SYSTEM (P.R.E.S.I.S.)

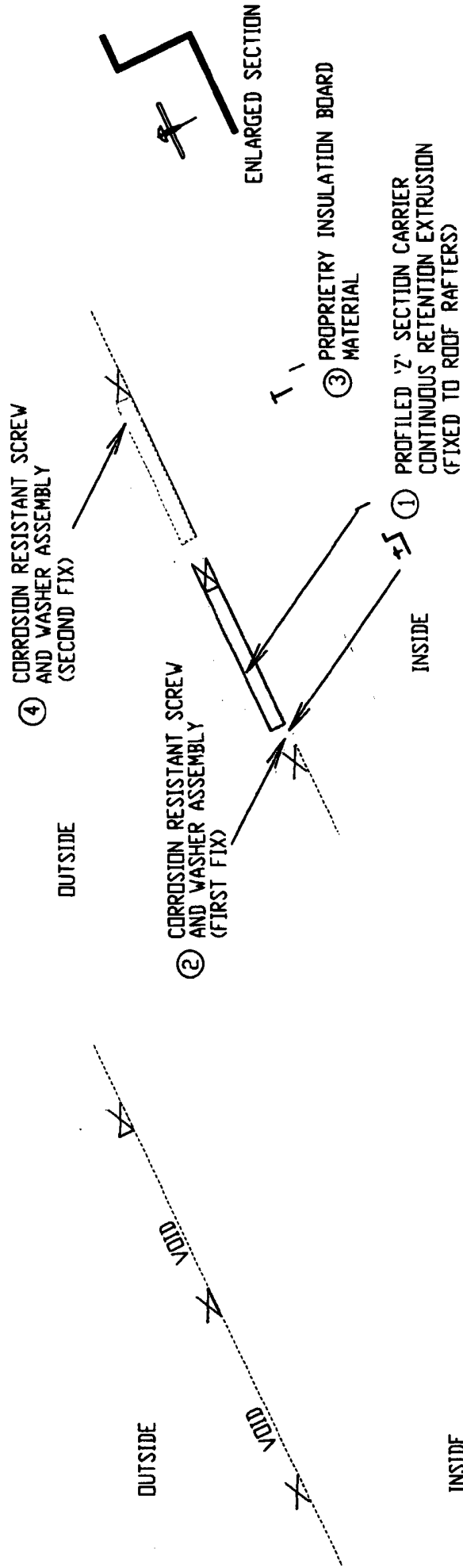

TYPICAL ROOF SECTION  
BEFORE APPLICATION

TYPICAL ROOF SECTION  
AFTER APPLICATION

2443025

**TITLE of INVENTION:**

**PITCHED ROOF ENERGY SAVING INSULATING SYSTEM - (PRESIS)**

**DESCRIPTION:**

**PRESIS COMPRISES OF TWO MAIN COMPONENTS WHICH WHEN ASSEMBLED AND MECHANICALLY FIXED INTO AN EXISTING UNUSED SPACE TO BE FOUND ON PITCHED ROOFED BUILDINGS, WILL PROVIDE A PERMANENT AND EFFECTIVE ENERGY SAVING MASS AND MINIMISE THE AIR LEAKAGE LOSS BEING EXPERIENCED FROM THE INTERNAL SPACE BELOW TO THE EXTERNAL ATMOSPHERE ABOVE.**

**CLAIMS:**

**1:  
THE INVENTION WILL PROVIDE AN ADDITIONAL ENERGY SAVING FACTOR AND IMPROVED THERMAL TRANSMITTANCE VALUE TO THE NEW OR EXISTING ROOF STRUCTURE OF THE BUILDING UNDER.**

**2:  
THE INVENTION WILL IMPROVE AIR LEAKAGE FACTORS BY SUBSTANCIALY REDUCING THE FLOW OF AIR THROUGH THE ROOF CONSTRUCTION AT THE POINT OF INSTALLATION.**

**3:  
THE INVENTION WILL UNIQUELY OCCUPY A PRESENTLY UNUSED ROOF SPACE WHICH EXISTS IN ALL NEW AND EXISTING ROOF CONSTRUCTION INSTALLATIONS.**

**Application No:** GB0620767.4

**Examiner:** Mr Haydn Gupwell

**Claims searched:** 1-3

**Date of search:** 19 December 2007

## Patents Act 1977: Search Report under Section 17

### Documents considered to be relevant:

Category	Relevant to claims	Identity of document and passage or figure of particular relevance
X	1-3	EP0029277 A1 (REDLAND BRAAS NV) see whole document especially the figures noting items 9 that support insulation panels 3 between beams 2.
X	1-3	DE20308997 U1 (WOLFSBURGER BEDACHUNGSGESELLSC) see whole document especially the abstract and figures noting stepped profile support element 4.
X	1-3	DE10038927 A1 (NU WERNER) see whole document especially the abstract and figures.
X	1-3	DE19654465 A1 (MAGASS WALTER) see whole document especially the abstract and figures.
X	1-3	DE3713574 A (IMC ACRYL GUSS GMBH) see whole document especially the figures noting item 9.
X	1-3	DE3531910 A (INGBUERO FUER BAUWESEN HANS BE et al) see whole document especially the abstract and figures noting item 15.
X	1-3	FR2636657 A1 (LEBRAUT RICHARD) see whole document especially the abstract and figures noting item 5.

### Categories:

X	Document indicating lack of novelty or inventive step	A	Document indicating technological background and/or state of the art.
Y	Document indicating lack of inventive step if combined with one or more other documents of same category.	P	Document published on or after the declared priority date but before the filing date of this invention.
&	Member of the same patent family	E	Patent document published on or after, but with priority date earlier than, the filing date of this application.

### Field of Search:

Search of GB, EP, WO & US patent documents classified in the following areas of the UKC<sup>X</sup>:

--

Worldwide search of patent documents classified in the following areas of the IPC

E04B; E04D

The following online and other databases have been used in the preparation of this search report

EPODOC, WPI

**International Classification:**

<b>Subclass</b>	<b>Subgroup</b>	<b>Valid From</b>
E04D	0013/16	01/01/2006
E04B	0001/76	01/01/2006