



US00D702338S

(12) **United States Design Patent**  
**Jones**

(10) **Patent No.:** **US D702,338 S**

(45) **Date of Patent:** **\*\* Apr. 8, 2014**

(54) **VENT**

(75) Inventor: **Rory Macpherson Jones**, Christchurch (NZ)

(73) Assignee: **Teal Corporation Limited**, Auckland (NZ)

(\*\*) Term: **14 Years**

(21) Appl. No.: **29/427,433**

(22) Filed: **Jul. 18, 2012**

(30) **Foreign Application Priority Data**

Jan. 18, 2012 (NZ) ..... 415755

(51) **LOC (10) Cl.** ..... **23-02**

(52) **U.S. Cl.**

USPC ..... **D23/393**

(58) **Field of Classification Search**

USPC ..... D23/385-395, 397, 370-373, 365, 354, D23/399-403, 421, 499; 454/309, 275-277, 454/284, 287-291, 358-363; 52/302.1, 52/32.07; 285/229, 189, 183, 123.1, 15, 285/114, 110, 424, 197; 264/310, 114; 137/511, 543.21; D7/630, 584, 587; D30/129

See application file for complete search history.

(56) **References Cited**

**U.S. PATENT DOCUMENTS**

3,350,745 A 11/1967 Schott  
3,550,206 A 12/1970 Von Der Heide

4,585,021 A 4/1986 Belknap  
4,704,510 A \* 11/1987 Matsui ..... D7/584  
5,349,984 A 9/1994 Weinheimer  
D351,263 S \* 10/1994 Evans ..... D30/129  
D381,472 S \* 7/1997 Catalano et al. .... D7/584  
5,911,938 A \* 6/1999 El et al. .... 264/261  
D478,474 S \* 8/2003 Zettle ..... D7/584  
D509,101 S \* 9/2005 Søndergaard et al. .... D7/392.1  
D575,589 S \* 8/2008 Fadda ..... D7/584  
D590,551 S \* 4/2009 Sperbeck ..... D30/129  
D623,806 S \* 9/2010 Modi et al. .... D30/129  
D628,443 S \* 12/2010 McTaggart ..... D7/587  
D634,486 S \* 3/2011 Graham-Cretcher ..... D30/129  
D651,865 S \* 1/2012 Smyers ..... D7/630  
D652,266 S \* 1/2012 Smyers ..... D7/630  
8,133,425 B2 3/2012 Jones

\* cited by examiner

*Primary Examiner* — David Muller

(74) *Attorney, Agent, or Firm* — Jacobson Holman PLLC

(57) **CLAIM**

I claim the ornamental design for the vent, as shown and described.

**DESCRIPTION**

FIG. 1 is a top perspective view of the vent embodying my design;

FIG. 2 is a bottom perspective view thereof;

FIG. 3 is a top plan view thereof;

FIG. 4 is a bottom plan view thereof;

FIG. 5 is a side elevation view thereof, the view of the other four sides being identical; and,

FIG. 6 is a cross-sectional view along line 6-6 of FIG. 3.

**1 Claim, 3 Drawing Sheets**

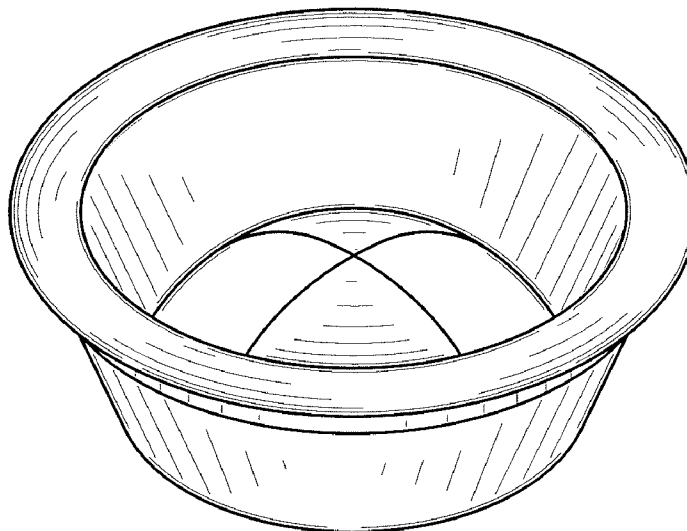

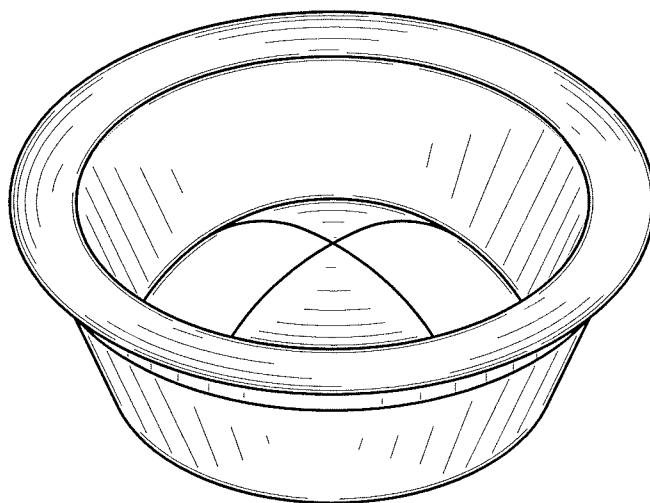

FIG. 1

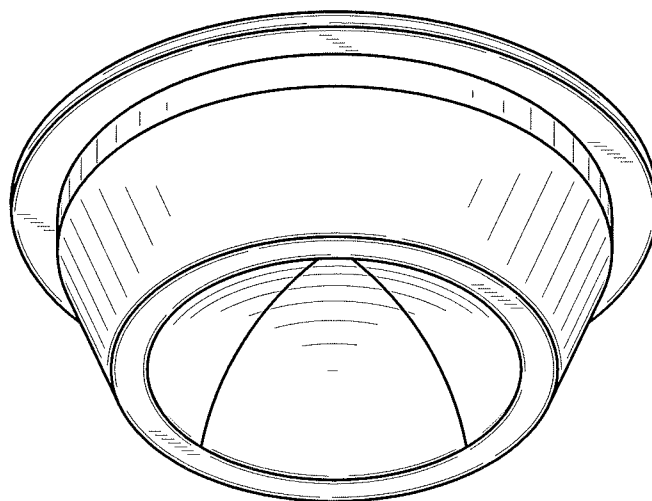

FIG. 2

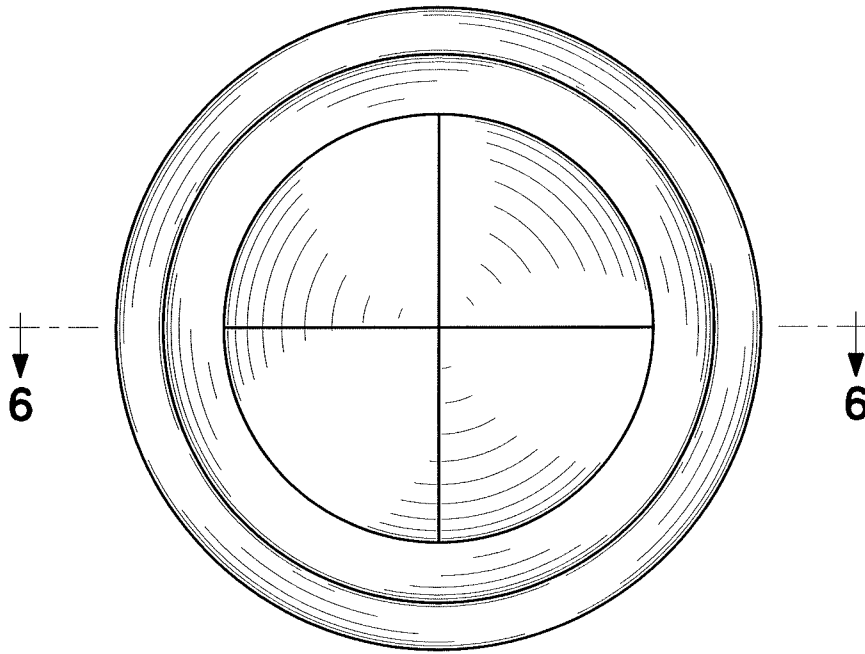

FIG. 3

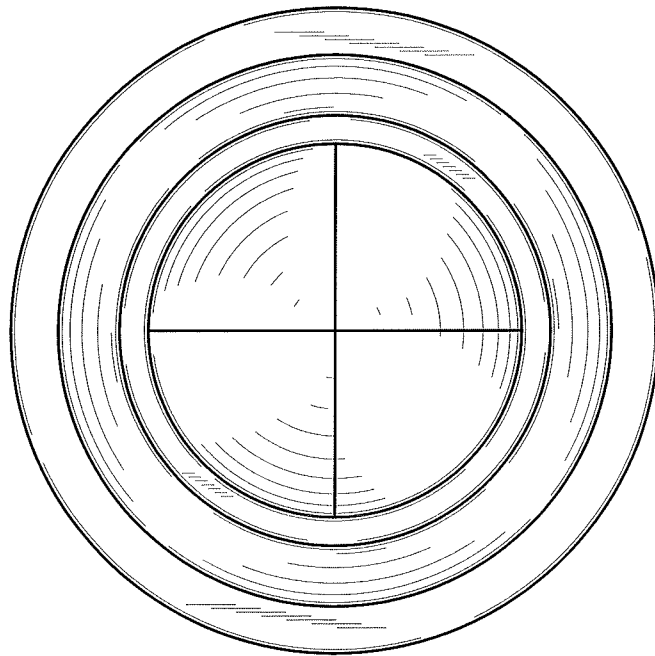

FIG. 4

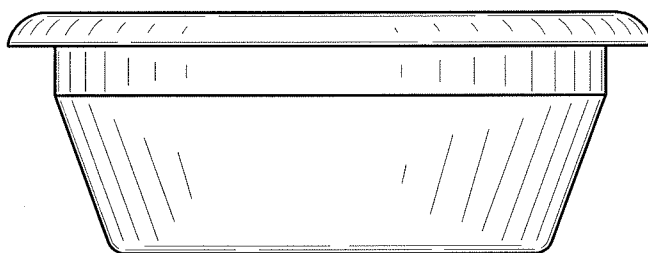

FIG. 5

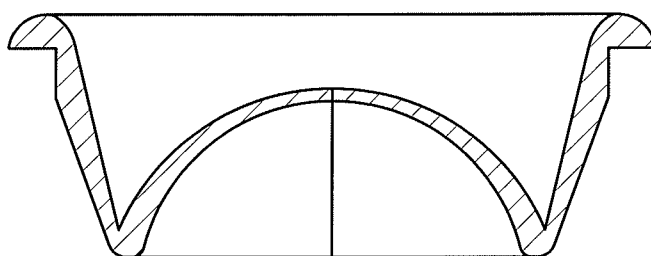

FIG. 6