



- (51) **International Patent Classification:**
H01R 13/11 (2006.01) *H01R 43/16* (2006.01)
- (21) **International Application Number:**
PCT/EP2013/075350
- (22) **International Filing Date:**
3 December 2013 (03.12.2013)
- (25) **Filing Language:** English
- (26) **Publication Language:** English
- (71) **Applicant:** FCI ASIA PTE.LTD [SG/SG]; 159 Kampong Ampat, #04-01/04 KA Place, Singapore 368328 (SG).
- (72) **Inventors:** DROESBEKE, Gert; 2 Rue de La Fayette, F-25050 Cedex Besancon (FR). SOUDY, Aymeric; 2 Rue de La Fayette, F-25050 Cedex Besancon (FR).
- (74) **Agent:** DE VRIES & METMAN; Overschiestraat 180, NL-1062 XK Amsterdam (NL).
- (81) **Designated States** (*unless otherwise indicated, for every kind of national protection available*): AE, AG, AL, AM, AO, AT, AU, AZ, BA, BB, BG, BH, BN, BR, BW, BY,

BZ, CA, CH, CL, CN, CO, CR, CU, CZ, DE, DK, DM, DO, DZ, EC, EE, EG, ES, FI, GB, GD, GE, GH, GM, GT, HN, HR, HU, ID, IL, IN, IR, IS, JP, KE, KG, KN, KP, KR, KZ, LA, LC, LK, LR, LS, LT, LU, LY, MA, MD, ME, MG, MK, MN, MW, MX, MY, MZ, NA, NG, NI, NO, NZ, OM, PA, PE, PG, PH, PL, PT, QA, RO, RS, RU, RW, SA, SC, SD, SE, SG, SK, SL, SM, ST, SV, SY, TH, TJ, TM, TN, TR, TT, TZ, UA, UG, US, UZ, VC, VN, ZA, ZM, ZW.

- (84) **Designated States** (*unless otherwise indicated, for every kind of regional protection available*): ARIPO (BW, GH, GM, KE, LR, LS, MW, MZ, NA, RW, SD, SL, SZ, TZ, UG, ZM, ZW), Eurasian (AM, AZ, BY, KG, KZ, RU, TJ, TM), European (AL, AT, BE, BG, CH, CY, CZ, DE, DK, EE, ES, FI, FR, GB, GR, HR, HU, IE, IS, IT, LT, LU, LV, MC, MK, MT, NL, NO, PL, PT, RO, RS, SE, SI, SK, SM, TR), OAPI (BF, BJ, CF, CG, CI, CM, GA, GN, GQ, GW, KM, ML, MR, NE, SN, TD, TG).

Published:

— with international search report (Art. 21(3))

(54) **Title:** CONNECTOR AND PIN RECEIVING CONTACT FOR SUCH A CONNECTOR

Fig. 1

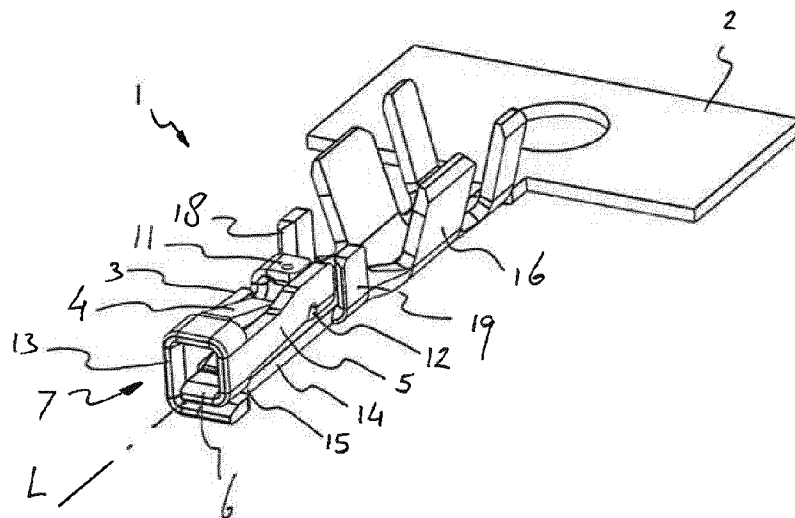

(57) **Abstract:** A pin receiving terminal contact and a connector comprising one or more of such terminal contacts. The terminal contacts (1) comprise a base (13) comprising a folded strip and at least a first contact beam (3, 5) having a root end extending from said base (13) and a contact face (11, 12) bent sideward under an angle with said root end.

CONNECTOR AND PIN RECEIVING CONTACT FOR SUCH A CONNECTOR

The invention relates to a connector configured to be coupled with a pin header connector and to pin receiving contacts for such a connector. The invention also relates to a method of manufacturing such contacts.

5

Such cable connectors are for instance used in automotive applications, e.g., for cooperation with an on-board pin header connector on a printed circuit board or a similar substrate. Such connectors are typically provided with pin receiving contacts comprising contact beams resiliently engaging an inserted contact pin of a complementary pin header connector. The contact between the contact beams and an inserted contact pin should be sufficient to conduct required amounts of current. The contact should also be reliable, particularly when it is exposed to vibrational loads, as may occur in automotive practice. Contact between the terminal contact and an inserted contact beam can be improved by using more contact points.

20 Contact pins are usually provided with a coating of gold or another precious metal on the contact face. Since gold does not oxidize, a gold coating helps to improve electro-conductive contact between the pin and the terminal contact. It also helps to reduce friction between the contact pin and the terminal contact during insertion of the pin. Increase of
25 the number of contact points would increase the required gold consumption and the manufacturing costs of the terminal contact.

It is an object of the invention to provide a cable connector which can be manufactured economically and which provides good and reliable contact with an inserted contact pin.

5 To this end, a connector is disclosed with one or more pin receiving terminal contacts with a base comprising a folded strip. The terminal contact has at least a first contact beam having a root end extending from the base and a contact face bent sideward under an angle with said root end.

10

The base can for example be rectangular, square, polygonal or circular, C-shaped or U-shaped, when viewed in a pin insertion direction, e.g. folded over at least two folding lines substantially parallel to a pin insertion direction.

15

This way, it can support a plurality of parallel contact beams at different sides of the terminal contact. It may form a pin receiving opening forming a passage of a contact pin of a mating counterconnector or it may be an opening in line with a pin insertion direction. If the contact beams extend in a direction coinciding with the pin insertion direction, the base will typically be a pin receiving opening. In case the contact beams extend in the opposite direction, the base is not necessarily a pin receiving opening.

20

25

In a specific embodiment, the terminal contact provides at least one pair of contact points at one or more sides. The contact points of a pair at one side of the terminal contact can be positioned on different contact beams. Having two contact points on different contact beams at the same side of the terminal contact enables to provide a reliable contact which is less sensitive for vibrational loads and which requires less gold consumption.

30

To balance contact forces, the terminal contact may for instance comprise at least two pairs of contact points at opposite sides of the terminal contact.

5 The contact points of a pair may for example be positioned on contact beams resiliently flexed in different bending directions. For instance, a first contact beam can be flexed towards the center of the pin receiving space, while the second contact beam comprises a contact point on a sideward
10 bent flange or flag. This results in different vibrational behaviour, so the vibration resistance of the contact as a whole is increased.

In a specific embodiment, the terminal contact of may have a
15 first contact beam extending from a first side of the base, and a second contact beam extending from an adjacent second side of the base, the contact face of the first contact beam being bent sideward to be in line with said second contact beam. In a more specific embodiment, the terminal contact may
20 comprise a third contact beam facing the first contact beam and extending from a third side of the base, and a fourth beam facing the second contact beam and extending from an adjacent fourth side of the base. The third contact beam may comprise a contact face bent sideward to be in line with said
25 fourth contact beam.

Optionally, the pin receiving space is four-sided in cross section, two opposite sides being defined by the longer contact beams while the other two sides are defined by the
30 shorter contact beams. The tips of the longer contact beams may for example comprise flanges forming rear contact faces, the flanges being folded to be in line with the shorter contact beams. In that case each pair of contact points or contact areas includes one front contact area provided by a
35 resiliently biased tip of a forwardly flexed shorter contact

beam while the rear contact area is provided by the inwardly bent flange at the tip of the longer contact beam.

The line through the contact points or areas at the same side
5 of the terminal contact can be parallel to the pin insertion
direction, or it can make an angle with the pin insertion
direction. In the last case, when a contact pin is inserted
into the pin receiving space, one contact point will wipe and
slide over the left hand side of the contact pin, while the
10 other contact point will wipe and slide over the right hand
side of the contact pin. As a result the contact points
produce separate wear tracks on the contact pin, so the
extent of wear per wear track is less. This enhances
durability and the maximum number of possible mating cycles.

15

The shorter and longer contact beams may for example extend
from a base defining a pin receiving opening. The contact
beams can extend rearwardly from the base, so the contact pin
will first pass the base before being contacted to the
20 contact points. Alternatively, the contact beams can extend
forwardly from the base, so the contact pin will first be
contacted to the contact points before it passes the base.

Optionally, the terminal contact may comprise a backbone with
25 a connection end projecting from the contact beams, e.g., for
connection to a cable end or a printed circuit board or a
similar substrate. Such a connection end of the backbone may
for example be provided with a crimp connection for
attachment to a cable. Other types of cable attachments or
30 printed circuit board connections, such as solder tail
(surface mount (SMT) or pin-through-hole (PTH)) or press-fit
connections, can also be used, if so desired.

The backbone connects the cable connection end to the base.
35 In case the terminal contact comprises two or more bases, it

connects the cable connection to a rear base closest to the cable connection end, and optionally also to the further base, e.g., between the contact beams.

5 A midsection of the backbone connecting the crimp connection section with the contact beam section, can for example be rigid or it can be made flexible. A flexible mid-section helps to reduce transfer of vibrational loads from the cable connection end to the pin receiving end of the terminal
10 contact.

Optionally, the backbone may overlap one of the contact beams. For instance, the base can be folded in such a way that side of the base carrying said contact beam overlaps the
15 side of the base connected to the backbone. These overlapping end parts of the base can for example be welded, soldered or glued.

In a further possible embodiment of the connector the
20 terminal contact may for example comprise a front base, a rear base and one or more beams having:

- a front section connected to a first side of the front base,
- a rear section connected to a side of the rear base in
25 line with a second side of the front face, and
- a folded mid-section connecting the front end to the rear end.

The beams can be contact beams or merely supporting beams.
30 More specifically, the beams may include a first and second beam being oppositely arranged. The terminal contact may further comprise oppositely arranged third and fourth beams between the first and second beams, both having a root end connected to a side of the front or rear base. For instance,
35 the third and fourth beams may have a root end connected to

the front base, a free end extending between the rear sections of the first and second beams and a mid-section bridging the root end and the free end.

5 In a further embodiment, the connector may comprise a terminal contact comprising at least one contact beam having a root end extending from the base and a contact face bent sideward along a folding line making an acute angle with a pin insertion direction.

10

A further possible embodiment may comprise a beam, such as a contact beam, extending from one side of the base pre-loading a contact beam extending from an adjacent side of the base. This makes it possible to increase the resilient contact force exerted by the pre-loaded contact beam to a mating contact pin.

15

Optionally, the connector may comprises a terminal contact with one or more support beams, each backing the contact area of an associated contact beam. The support beam contributes to the normal force exerted by the contact beam to a mating contact pin.

20

The longer contact beams can be equally dimensioned. Alternatively, they can be configured such that they have a different vibrational behaviour, e.g., with a different stiffness or length. Optionally, the contact areas or contact points of the longer contact beams can be staggered relative to each other, so that contact areas at different sides of the terminal contact are at different distances from the base. Similarly, the shorter contact beams can be configured such that they have a different vibrational behaviour, e.g., with a different stiffness or length or with staggered contact points. These measures help to improve resistance against vibrational loads.

30

35

Optionally, one or more contact areas are formed by bulging contact bumps or domes. For instance, the contact terminal may comprise one or more sides with contact areas on
5 different contact beams, at least one of the contact areas on a side being formed by a dome. If a side of the contact terminal has two contact areas of different contact beams, both may be shaped as domes or one of the contact areas may be a dome, while the other is differently shaped, e.g.,
10 having a flat contact face or a bent tip. For example, if the first contact area at one side of the terminal contact is formed by a sideward bent flange of a longer contact beam, while the second contact area is formed by a shorter contact beam, the first contact area may be dome shaped, while the
15 second contact area may also be dome shaped or not dome shaped. In such a configuration, the normal force exerted by the first contact area will typically be higher.

Notwithstanding the higher normal force, pressure differences between the two contact areas can be reduced by adjusting the
20 surface area of the one of the contact areas, e.g., by adjusting the shape, width, length or curvature of the dome shape.

The invention also relates to the terminal contact as such,
25 which may for instance be folded from a single stamped part of sheet metal.

To manufacture such a contact, a process can be used, comprising the steps of:
30 - stamping a blank from a sheet metal, the blank comprising a base strip and one or more, e.g., four, contact beams extending from the base strip;
- folding the base strip over at least two folding lines parallel to a pin insertion direction, e.g., to form a C-
35 shape or a substantially square or rectangular opening.

The blank may for example comprise two longer contact beams,
a first shorter contact beam between the two longer beams and
a second shorter contact beam at a second end of the base
5 strip.

Optionally, the two longer contact beams are provided with
sidewardly extending flanges pointing away from the backbone,
wherein the flanges are first bent upwardly before folding
10 the base strip.

To allow easier handling of a large number of blanks, a
series of blanks can be attached to a transport strip during
folding.

15 Exemplary embodiments of the connector and the terminal
contacts will be further explained with reference to the
accompanying drawings.

20 Figure 1: shows an exemplary terminal contact;
Figure 2: shows a different perspective view of the terminal
contact of Figure 1;
Figure 3: shows a blank for making the terminal contact of
Figure 1;
25 Figure 4: shows a transportation strip carrying a series of
blanks in consecutive stages of the manufacturing
process;
Figures 5A-D: show consecutive steps of the manufacturing
process;
30 Figure 6: shows a second embodiment of a terminal contact;
Figure 7: shows a third embodiment of a terminal contact in
side view;
Figure 8: shows a fourth embodiment of a terminal contact in
side view;

Figure 9: shows a fifth embodiment of a terminal contact in perspective view;

Figure 10: shows a blank for the terminal contact of Figure 9;

5 Figure 11: shows a further possible embodiment of a terminal contact in perspective view;

Figure 12: shows a further possible embodiment of a terminal contact in perspective view.

10 Figure 1 shows a terminal contact 1 still connected to a piece of a transport strip 2 used during manufacturing. This piece is cut off before connection of the terminal contact 1 to a cable end. The terminal contact 1 has four contact beams 3, 4, 5, 6 defining a pin receiving space 7. The four contact
15 beams 3, 4, 5, 6 include two oppositely arranged shorter contact beams 4, 6 and two longer contact beams 3, 5. The shorter contact beams 4, 6 are bent inwardly with their tips 8, 9 forming front contact points for an inserted contact pin (see Figure 2).

20

The tips of the longer contact beams 3, 5 have flanges 11, 12 forming the rear contact points at the inner face of the pin receiving space 7. The flanges 11, 12 have been folded to be in line with the shorter contact beams 4, 6. When a contact
25 pin (not shown) is inserted into the pin receiving space 7, it will first be contacted with the front contact points formed by the tips 8, 9 of the shorter beams and subsequently by the rear contact points formed by the inner faces of flanges 11, 12. The rear contact point formed by the flange
30 11 is paired and in line with the front contact point formed by the tip end 9 of the shorter contact beam 4 at the same side of the pin receiving space 7. Similarly, the rear contact point formed by the flange 12 is paired and in line with the front contact point formed by the tip end 8 of the

shorter contact beam 6 at the same side of the pin receiving space 7.

Due to the different bending directions the front contact points formed by the tips 8, 9 of the shorter contact beams 4, 6 have a different vibrational behaviour than the rear contact points formed by the inwardly bent flanges 11, 12. This improves the overall resistance of the terminal contact 1 against vibrational loads.

10

The parallel contact beams 3, 4, 5, 6 extend from a base 13, formed by a strip folded to form a square or rectangular ring defining the entrance of the pin receiving space 7. A first folding line L is positioned between the backbone 14 and the contact beams 3, 4, 5, 6 and runs substantially parallel to the contact beams 3, 4, 5, 6 and the backbone 14. Folding the base strip 13 along this folding line L results in a geometry with the contact beams 3, 4, 5, 6 extending in substantially the same direction as the backbone without being coplanar with the backbone 14.

20

The terminal contact 1 further comprises a backbone 14, extending from the base 13 in a direction parallel to the contact beams 3, 4, 5, 6. In the shown embodiment, the backbone 14 and the contact beams 3, 4, 5, 6 extend rearwardly. This means that a contact pin must first pass the base 13 before it contacts the contact points of the contact beams 3, 4, 5, 6. In an alternative embodiment, the contact beams 3, 4, 5, 6 may extend forwardly with or without a backbone being present, so a contact pin will first contact the longer contact beams 4, 6 and subsequently the shorter contact beams 3, 5.

25

30

The contact beams, extending forwardly or rearwardly, may be folded such that a contact beam pre-loads two adjacent,

35

oppositely arranged contact beams by resiliently forcing them apart before insertion of a contact pin. This will result in a higher contact force of the pre-loaded contact beams after insertion of a contact pin.

5

The backbone 14 has one end opposite to the base 13 provided with a crimp connection 16 allowing electrical and mechanical connection to a terminal end of a cable (not shown). The crimp connection 16 forms a cable connection end and projects
10 from the contact beams 3, 4, 5, 6.

Between the crimp connection 16 and the contact beams 3, 4, 5, 6 the terminal contact 1 is provided with two upwardly folded flanges 18, 19 forming key-coding flags for correctly
15 positioning the terminal contact 1 in a housing of a connector.

Optionally, the contact terminal can be designed for being side loaded into a connector housing or housing part. To that
20 end, the contact can be provided with appropriate flags and/or guiding surfaces. Also the crimp connection, if present, can be designed for being used to position, press fit and or retain the contact into a matching cavity in the housing or housing part.

25

Figure 3 shows a blank 20 which can be folded to form the terminal contact, which is substantially similar to the terminal contact 1 of Figure 1. The blank 20 comprises a base strip for forming the base 13. A first shorter contact beam 6
30 extends from a first end of the base strip 13, while the backbone 14 extends from the opposite end of the base strip 13. Between the backbone 14 and the short contact beam 6 the base strip 13 carries the two longer contact beams 3, 5 and a second shorter contact beam 4 between the two longer contact
35 beams 3, 5. The two longer contact beams 3, 5 are identical

in outline. The two shorter contact beams 4, 6 are mirrored, both having a straight longitudinal side edge 21 and an oblique longitudinal side edge 22 making an angle α of about 5 degrees with the straight side edge, such that the base of the shorter contact beam 4, 6 is wider than its respective tip 8, 9. The oblique side edges 22 of the two shorter contact beams 4, 6 are directed to each other. The tip ends 8, 9 are made convex to improve contact with an inserted contact pin.

10

Similarly, the two longer contact beams 3, 5 have a straight longitudinal side edge 23 and an oblique longitudinal side edge 24 making an angle of about 5 degrees with the straight side edge 23. However, the top half 25 of the straight edge 23 is slightly offset to the lower half 26 of the straight edge 23 with a oblique mid-section 27 bridging the straight upper and lower halves 25, 26. The top ends of the longer contact beams 3, 5 are provided with the sidewardly extending flanges 11, 12, both pointing away from the backbone 14. The two flanges 11, 12 are provided with imprinted convex contact faces 28, 29.

During manufacture the blanks 20 can be attached to a transportation strip 2, as shown in Figure 4. The blanks 20 in Figure 4 are in different stages A - H of the folding process. In the first step A the blank 20 is still flat. In a second step B the flanges 11, 12 of the longer contact beams 3, 5 are folded upwardly along a folding line substantially parallel to the longitudinal length of the contact beams 3, 5. In a third step C the outer shorter contact beam 6 is folded upwardly and flexed slightly inwardly. Then (step D) the next longer contact beam 5 is folded upwardly (see also Fig. 5A). The two shorter beams 4, 6 now face each other, their tips 8, 9 being flexed towards each other. Then in step E the second shorter contact beam 4 is folded upwardly (see

Fig. 5B). After a further folding step F, G the outer shorter contact beam 6 overlays the backbone 14. To make the base 13 more rigid the end part of the strip carrying the backbone 14 and the end part of the strip carrying the outer short contact beam 6 can be attached to each other, e.g., by soldering. In a final step the crimp tabs 16 are folded upwardly. The folded terminal contact 1 can now be cut off from the transportation strip 2.

10 All folding lines extend in a direction substantially parallel to the longitudinal length of the contact beams.

When the terminal contact 1 is folded, the front contact point on the tip end 8 of the outer shorter beam 6 is in line with the convex rear contact point 28 of the flag 12 of the adjacent longer contact beam 5. The paired contact points 8, 28 are at the same side of the pin receiving space 7 and contact a same side of an inserted contact pin.

20 Similarly, the front contact point on the tip end 9 of the other shorter beam 4 is in line with the convex rear contact point 29 of the flag 11 of the longer contact beam 3 next to the backbone 14. The paired contact points 9, 29 are at the same side of the pin receiving space 7 and contact a same side of an inserted contact pin.

Figure 6 shows in cross section an alternative embodiment of a terminal contact 40. The terminal contact 40 comprises a backbone 41 with a first end 42 connected to a base 43. The other end 44 of the backbone carries a crimp connection 45 for attachment to a cable. The base 43 connects the first end 42 of the backbone 41 to a root end 46 of a contact beam 47 of the terminal contact 40. The base 43 is formed by a folded strip. One of the folding lines L is between the backbone 41 and the contact beam 47, such that the contact beam 47 is

parallel but not co-planar with the backbone 41. The strip is folded to form a rectangular pin receiving opening 48. The opposite end 49 of the contact beam 47 points towards the crimp connection 45 and comprises a flange 50 folded along a folding line L1 under about a 90 degrees angle with the root end of the contact beam. The folding line L1 makes an acute angle with the backbone and the folding line L.

In the embodiment of Figure 7, the terminal contact 60 comprises a backbone 61 with a mid-section 62 connecting a crimp connection section 63 to a section 64 carrying the contact beams 65. Section 64 is substantially similar to the corresponding section of the terminal contact of Figure 1. The mid-section 62 makes an acute angle with the longitudinal direction of the contact beams 65 to offset the pin receiving cavity from the crimp connection. This prevents that an inserted contact pin would brush over the crimped cable conductors.

In Figure 8 a terminal contact 70 is shown with a backbone 71 with a mid-section 72 connecting a crimp connection section 73 to a section 74 carrying the contact beams 75. The mid-section 72 is flexible. This helps to reduce transfer of vibrational loads from the cable end of the contact 70 to the section 74 with the contact beams 75.

Figure 9 shows a further alternative embodiment of a terminal contact 80 with two longer contact beams 81, 82 and two short contact beams 83, 84. A blank 86 of the terminal contact 80 is shown in Figure 10. At a pin receiving side 87 the terminal contact 80 comprises a front base 88 connected to front sections of the longer contact beams 81, 82 and connected to respective root ends 89, 90 of the two contact beams 83, 84. The front base 88 has a four sided cross section and is folded along a folding lines L1, L2, L3 (see

Figure 10) between the longer contact beams 81, 82 and the shorter contact beams 83, 84.

At a cable connection side 92 the terminal contact 80
5 comprises a rear base 93 with a four-sided cross section. The two opposite longer contact beams 81, 82 extend between the front base 88 and the rear base 93 and have a front section 94, 95 extending from a side of the front base 88, a rear section 97, 98 extending from a side of the second base 93,
10 and a midsection 99, 100 connecting the rear and front sections. The front and rear sections of the longer contact beams 81, 82 have parallel longitudinal directions but extend in different planes defining different adjacent sides of the terminal contact 80.

15

A first short contact beam 83 extends from the front base 88 between the two longer contact beams 81, 82. The short contact beam 83 has a root end 102, a contact end 103 and a midsection 104 connecting the root end 102 to the contact end
20 103. The root end 102 is connected to the front base 88 and extends between the front sections 94, 95 of the two adjacent longer contact beams 81, 82 in the direction of the rear base 93. The contact end 103 extends between the rear sections 97, 98 of the two longer contact beams 81, 82 and is folded
25 sideward along a folding line parallel to the pin insertion direction over a 90 degrees angle with the root end 102. The contact end 103 has an inwardly bent tip 106 forming a contact face for an inserted contact pin.

30 The second contact beam 84 extends from an outer end of the first base 88 and also has a root end 107, a contact end 108 and a midsection 109 connecting the root end 107 to the contact end 108 in a similar arrangement. The contact end 108 of the second contact beam is folded over a 90 degrees angle
35 with the root end 107 and partly overlaps the front section

94 of the longer contact beam 81 extending from the opposite side of the front base 88. The contact end 108 has an inwardly bent tip 111 forming a contact face for an inserted contact pin.

5

The front sections of both longer contact beams 81, 82 are provided with an inwardly bulging surface 112, 113 at different distances from the front base 88.

10 The front base 88 and the rear base 93 are both provided with a flag 114, 115 comprising a recess 116, 117 for receiving a projection 118, 119 at the opposite side of the respective base 88, 93.

15 As is particularly shown in Figure 9, the midsection 109 of the shorter contact beam 84 overlaps the contact area 112 of the longer contact beam 82. If, in an alternative embodiment, the shorter contact beam 84 would tightly overlap the contact area 112, it would form a support beam backing the contact
20 area and increasing the contact force exerted by the contact area 112 to an inserted contact pin. In that case, the beam 84 should not be used as a contact pin and it should not have a bent tip.

25 Figure 11 shows a terminal contact 120 which is similar to the one of Figure 9, with the difference that the short beams 83a, 84a are not contact beams but support beams backing the respective contact sections 112, 113 of the longer contact beams 81, 82. The support beams 83a, 84a increase the normal
30 force exerted by the contact area 112, 113 to a mating contact pin.

Figure 12 shows a further possible embodiment 121, also similar to the embodiment of Figure 9, but with the
35 difference that the short beams 83b extend forwardly from the

rear base 93 into the direction of the front base 88. To facilitate easy insertion of a pin the contact areas can be staggered. After insertion of a contact pin through the front base 88 the pin first contacts the contact area of the lower long contact beam 81, then the contact area 112 of the upper long contact beams 82 and subsequently the respective bent tips 111, 106 of the shorter contact beams 83b, 84b.

The foregoing description is provided for the purpose of explanation and is not to be construed as limiting the invention. While various embodiments have been described with reference to preferred embodiments or preferred methods, it is understood that the words which have been used herein are words of description and illustration, rather than words of limitation. Furthermore, although the embodiments have been described herein with reference to particular structure, methods, and embodiments, the invention is not intended to be limited to the particulars disclosed herein. For instance, it should be appreciated that structure and methods described in association with one embodiment are equally applicable to all other embodiments described herein unless otherwise indicated. Those skilled in the relevant art, having the benefit of the teachings of this specification, may effect numerous modifications to the invention as described herein, and changes may be made without departing from the spirit and scope of the invention, for instance as set forth by the appended claims.

CLAIMS

1. A connector comprising one or more pin receiving terminal contacts (1) with a base (13) comprising a folded strip and with at least a first contact beam (3, 5) having a root end extending from said base (13) and a contact face (11, 12) bent sideward under an angle with said root end.
5
2. A connector according to claim 1, wherein the first contact beam (3) extends from a first side of the base (13) , the terminal contact comprising a second contact beam (4) extending from an adjacent second side of the base, wherein
10 the contact face (11) of the first contact beam is bent sideward to be in line with said second contact beam.
3. A connector according to claim 2, comprising a third contact beam (5) facing the first contact beam (3) and
15 extending from a third side of the base (13), and a fourth beam (6) facing the second contact beam (4) and extending from an adjacent fourth side of the base, wherein the third contact beam comprises a contact face (12) bent sideward to
20 be in line with said fourth contact beam.
4. A connector according to any one of the preceding claims comprising at least two contact areas at one side of the terminal contact, wherein the line through the contact areas
25 makes an angle to the pin insertion direction.
5. A connector according to any one of the preceding claims, wherein the contact beams include two oppositely arranged shorter contact beams (4, 6) with tips (8, 9)
30 forming front contact areas and two oppositely arranged longer contact beams (3, 5) with folded flanges (11, 12) forming rear contact areas at the same side of the terminal contact as the front contact areas.

6. A connector according to claim 5, comprising a pin receiving space (7), which is four-sided in cross section, two opposite sides being defined by the longer contact beams (3, 5) while the other two sides are defined by the shorter contact beams (4, 6).

7. A connector according to anyone of the preceding claims, wherein the contact beams extend from the base in a direction coinciding with a pin insertion direction.

10

8. A connector according to anyone of claims 1 -6, wherein the contact beams extend from the base in a direction opposite to a pin insertion direction.

9. A connector according to any one of the preceding claims, wherein contact points at different sides of the terminal contact are at different distances from the base.

10. A connector according to any one of the preceding claims, wherein the terminal contact (1) comprises a backbone (14) with a cable connection end (16).

11. A connector according to claim 10, wherein the cable connection end of the backbone (14) is provided with a crimp connection (16) for attachment to a cable.

12. A connector according to claim 10 or 11, comprising a mid-section (62, 72) which offsets the pin receiving base from the cable end connection (64, 74).

30

13. A connector according to claim 12, wherein the midsection (72) is flexible.

14. A connector according to claim 10, 11, 12 or 13, wherein the backbone (14) overlaps one of the contact beams (6).

15. A connector according to any one of the preceding
5 claims, wherein the terminal contact (80) comprises a front base (88), a rear base (93) and one or more beams (81, 82) having:

- a front section (94, 95) connected to a first side of the front base,
- 10 • a rear section (97, 98) connected to a side of the rear base in line with a second side of the front face, and
- a folded mid-section (99, 100) connecting the front end to the rear end.

16. A connector according to claim 15, wherein said beams
15 comprise a first and second beam being oppositely arranged, the terminal contact further comprising oppositely arranged third and fourth beams (83, 84) between the first and second beams, both having a root end (102, 107) connected to a side
20 of the front or rear base.

17. A connector according to claim 16, wherein the third and
fourth beams (83, 84) have a root end connected to the front
base (88), a free end extending between the rear sections
25 (97, 98) of the first and second beams and a mid-section bridging the root end and the free end.

18. A connector according to any one of the preceding
claims, comprising at least one contact beam (47) having a
30 root end extending from the base (43) and a contact face (50) bent sideward along a folding line making an acute angle with a pin insertion direction.

19. A connector according to any one of the preceding
35 claims, wherein one or more contact areas are formed by

bulging contact bumps or domes on the contact beams (3, 4, 5, 6; 81, 82, 83, 84).

20. A connector according to claim 19, wherein the terminal
5 comprises at least one side with contact areas on different contact beams, at least one of the contact areas on a side being formed by a dome.

21. A connector according to claim 19, wherein the shape of
10 the dome is configured to exert a pressure to an inserted pin of the same order as the other contact area at the same side of the terminal contact.

22. A connector according to any one of the preceding claims
15 comprising a contact beam extending from one side of the base pre-loading a contact beam extending from an adjacent side of the base.

23. A connector according to any one of the preceding
20 claims, wherein the terminal contact comprises one or more support beams backing the contact area of an associated contact beam.

24. A terminal contact (1) for a connector according to any
25 one of the preceding claims.

25. A terminal contact according to claim 24, folded from a single stamped blank (20) of sheet metal.

30 26. A method for manufacturing a terminal contact according to claim 24 or 25, comprising the steps of:

- stamping a blank (20) from a sheet metal, the blank comprising a base strip (13) and one or more contact beams (3, 4, 5, 6) extending from the base strip;
- 35 - folding the base strip.

27. A method according to claim 26, wherein at least two contact beams (3, 5) are provided with sideward extending flanges (11, 12) pointing in the same direction, wherein the flanges are first bent upwardly before folding the base
5 strip.

28. A method according to claim 27, wherein the blank (20) comprises two longer contact beams (3, 5) carrying the sideward extending flanges, a first shorter contact beam (4)
10 between the two longer beams and a second shorter contact beam (6) at a second end of the base strip.

Fig. 1

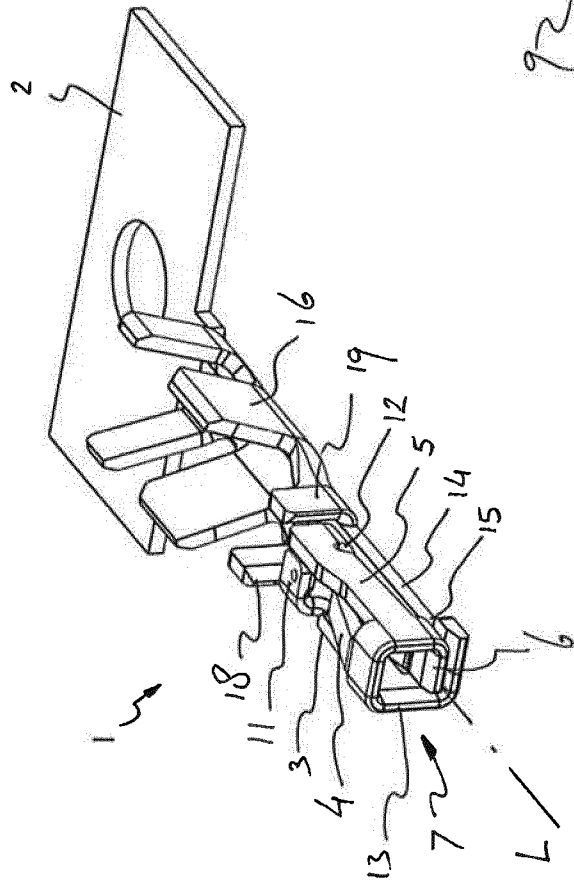

Fig. 2

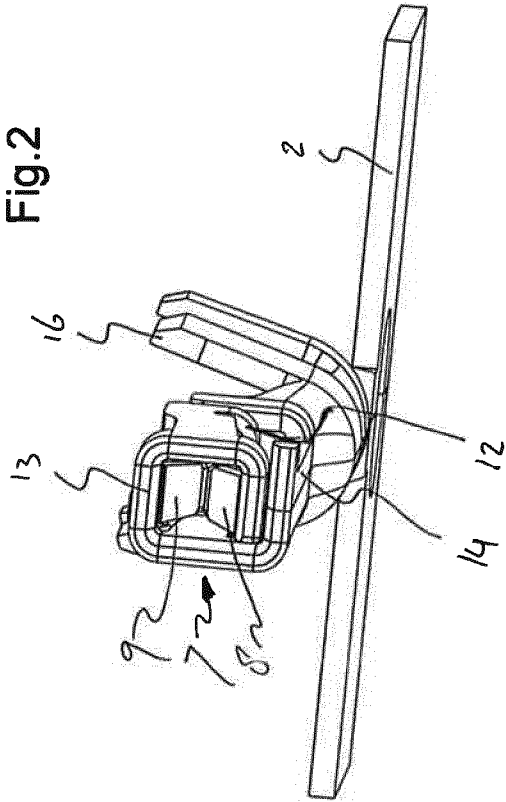
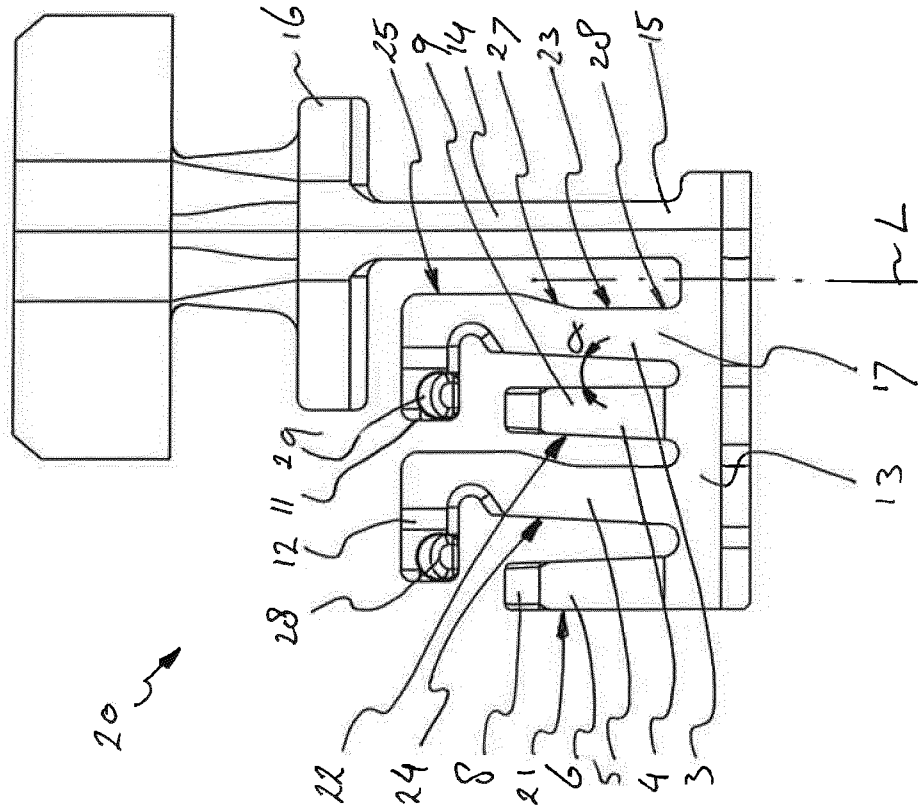

Fig. 3



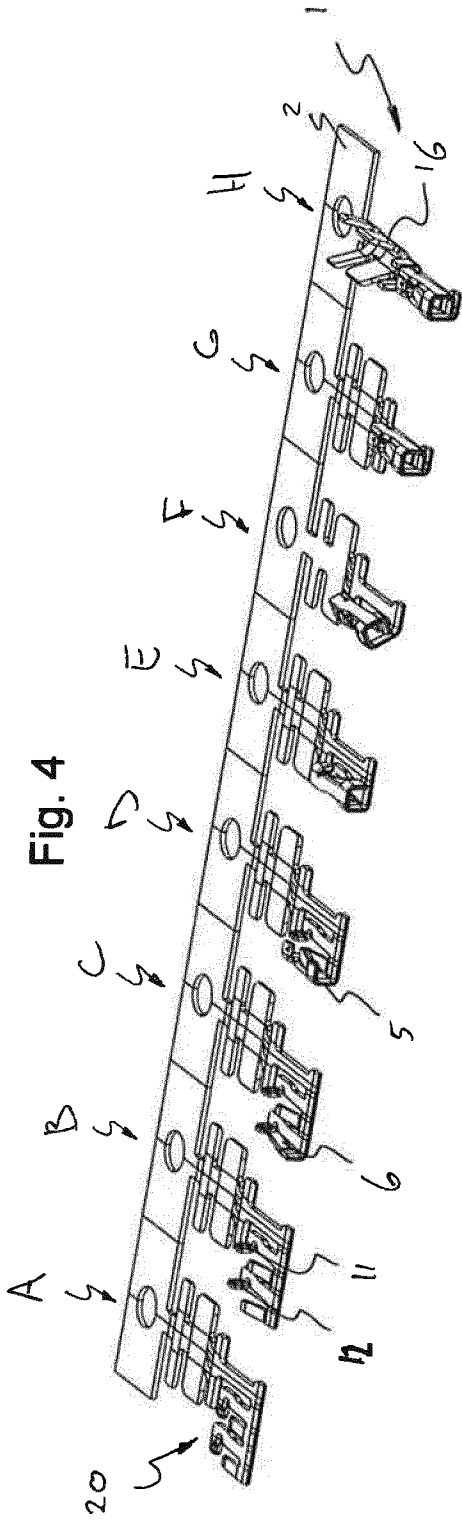

Fig. 4

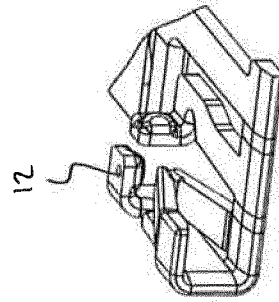

Fig. 5A

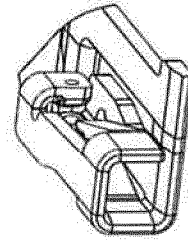

Fig. 5B

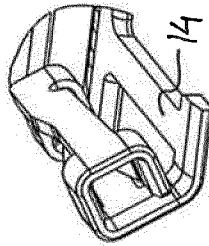

Fig. 5C

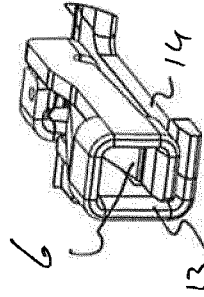
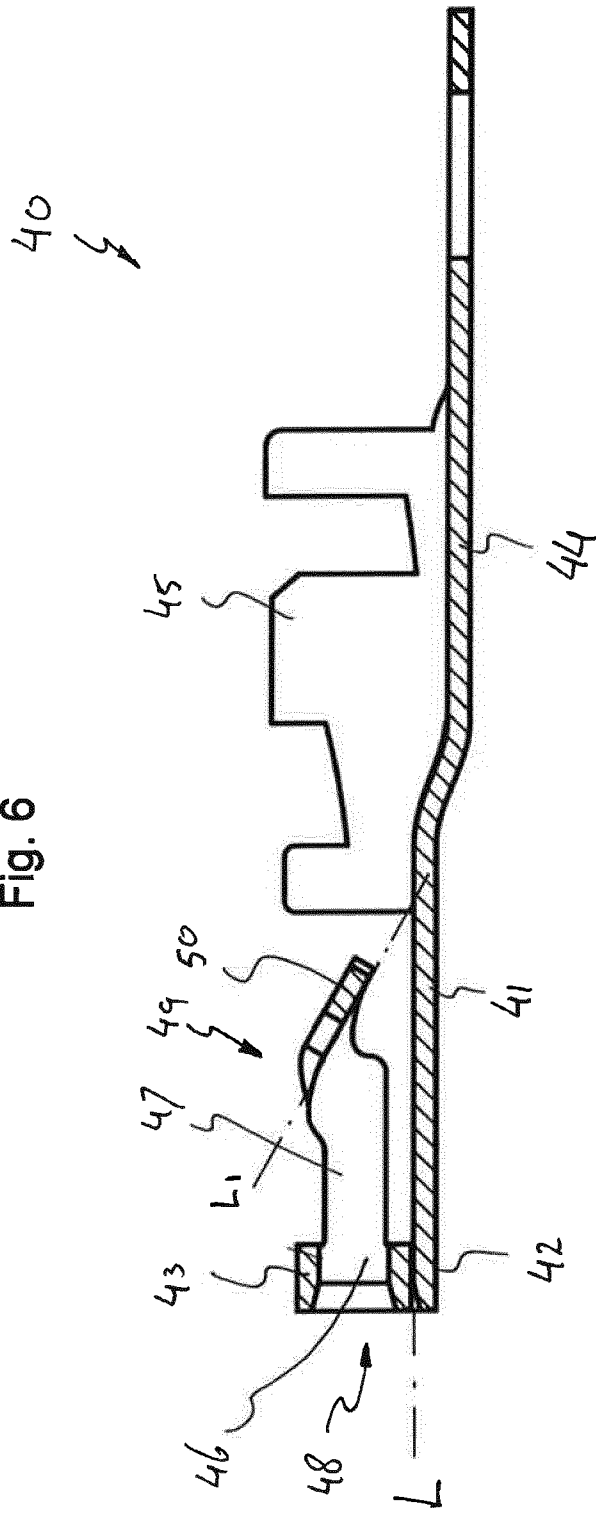

Fig. 5D

Fig. 6



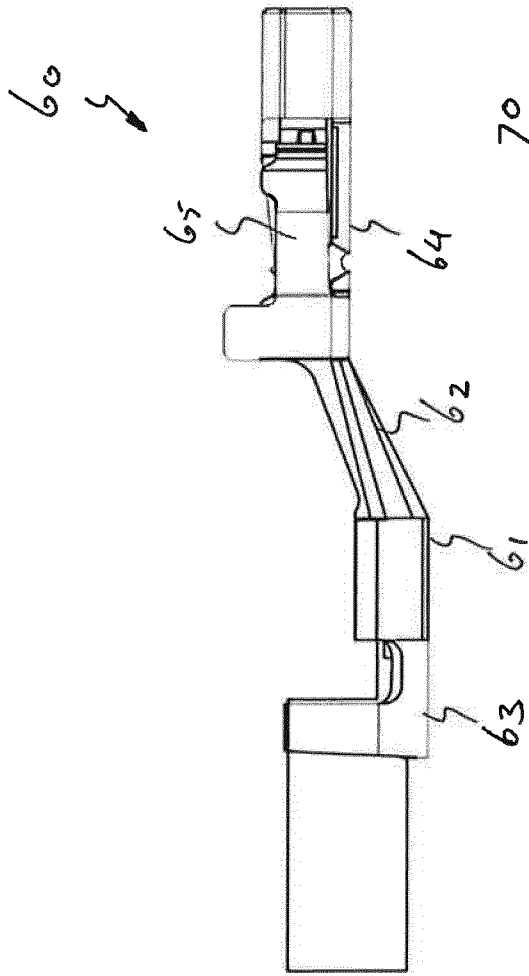

Fig. 7

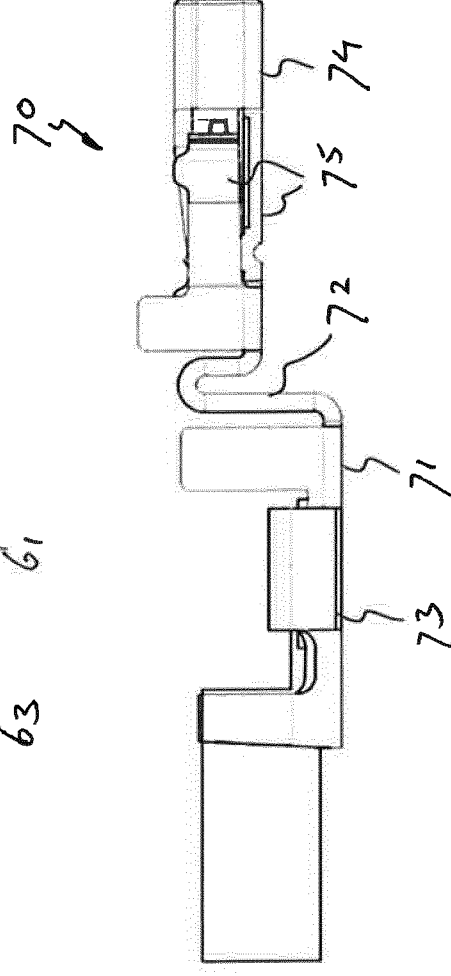

Fig. 8

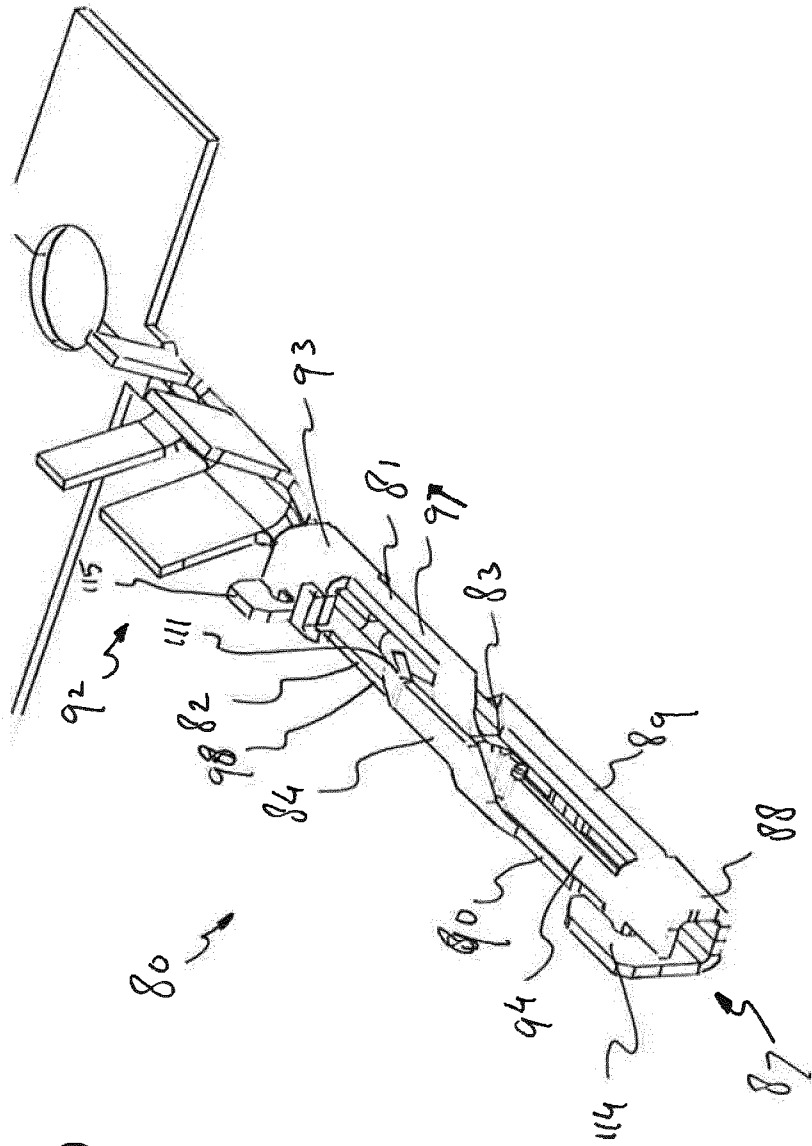

Fig. 9

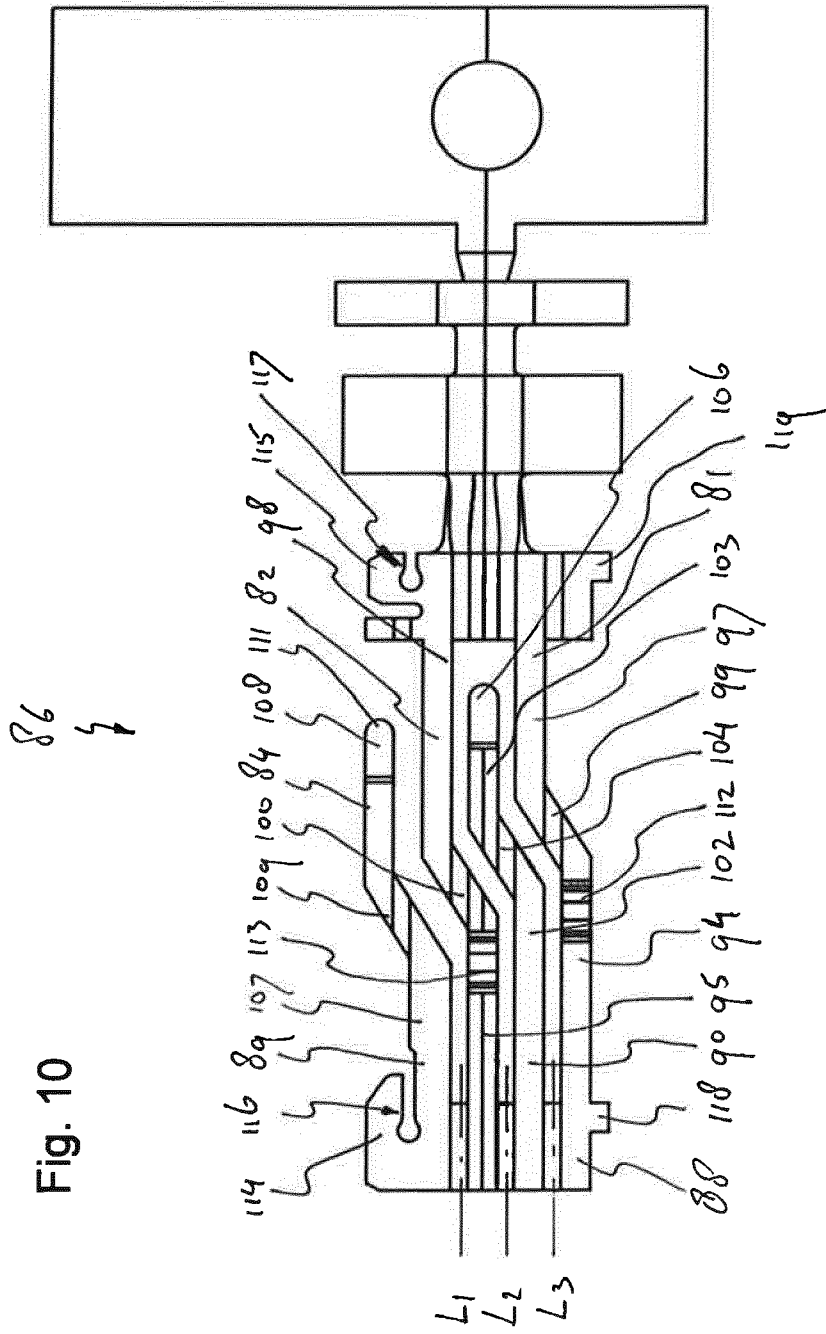

Fig. 10

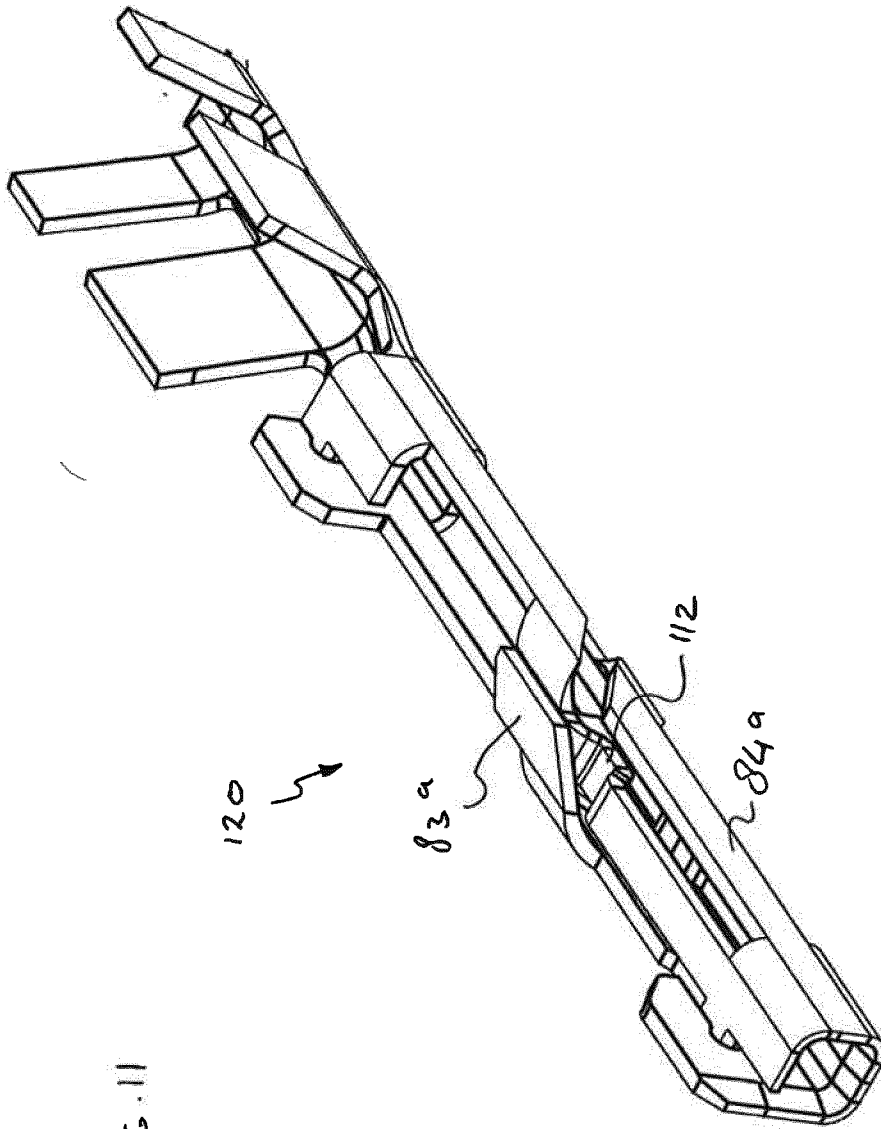

FIG. 11

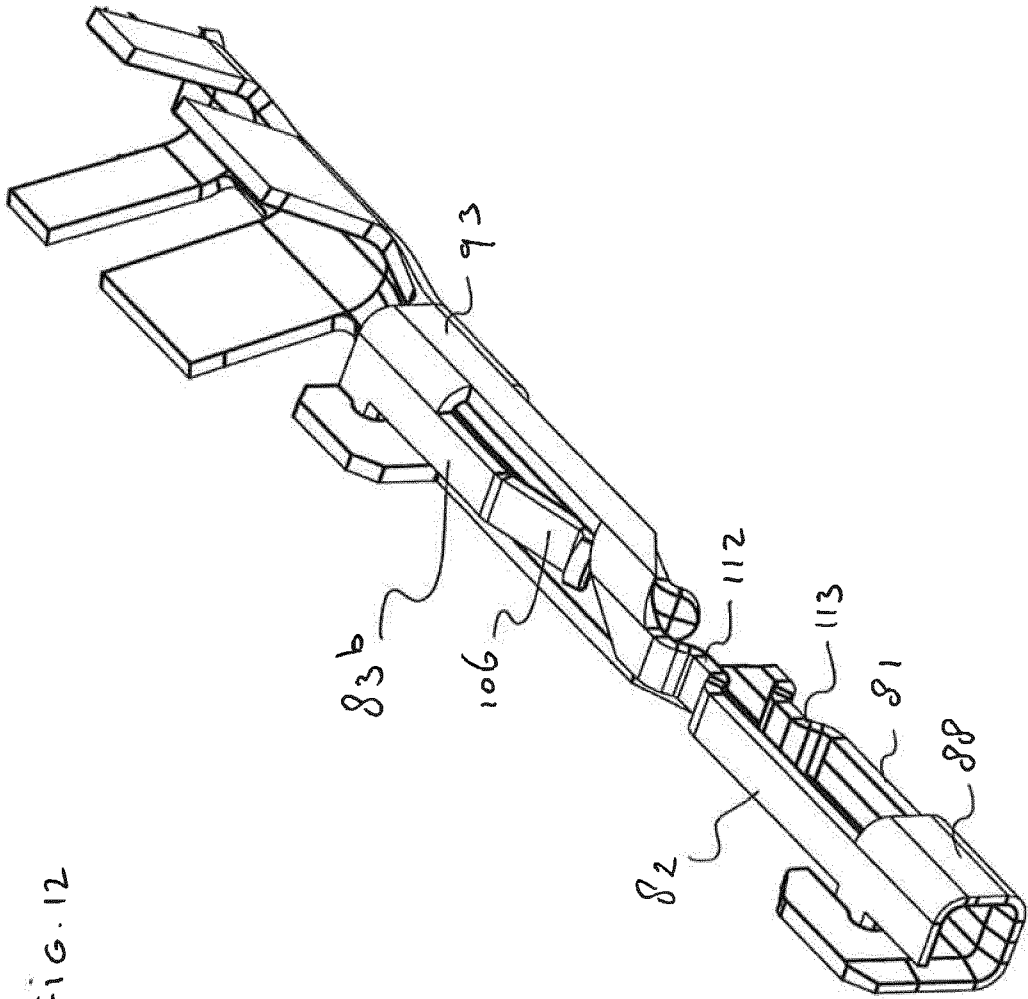

FIG. 12

INTERNATIONAL SEARCH REPORT

International application No
PCT/EP2013/075350

A. CLASSIFICATION OF SUBJECT MATTER
INV. H01R13/11 H01R43/16
ADD.
According to International Patent Classification (IPC) or to both national classification and IPC

B. FIELDS SEARCHED
Minimum documentation searched (classification system followed by classification symbols)
H01R
Documentation searched other than minimum documentation to the extent that such documents are included in the fields searched

Electronic data base consulted during the international search (name of data base and, where practicable, search terms used)
EPO-Internal, WPI Data

C. DOCUMENTS CONSIDERED TO BE RELEVANT		
Category*	Citation of document, with indication, where appropriate, of the relevant passages	Relevant to claim No.
X	US 2012/295493 A1 (HIRABAYASHI OSAMU [JP]) 22 November 2012 (2012-11-22) abstract paragraph [0041] - paragraph [0042] figures 1-12	1,7,8, 10-15, 18,19, 21-27
X	US 5 681 190 A (CHILDS JONATHAN [US]) 28 October 1997 (1997-10-28) the whole document ----- -/--	1,2,4, 7-15, 18-27

Further documents are listed in the continuation of Box C.

See patent family annex.

* Special categories of cited documents :

- "A" document defining the general state of the art which is not considered to be of particular relevance
- "E" earlier application or patent but published on or after the international filing date
- "L" document which may throw doubts on priority claim(s) or which is cited to establish the publication date of another citation or other special reason (as specified)
- "O" document referring to an oral disclosure, use, exhibition or other means
- "P" document published prior to the international filing date but later than the priority date claimed

- "T" later document published after the international filing date or priority date and not in conflict with the application but cited to understand the principle or theory underlying the invention
- "X" document of particular relevance; the claimed invention cannot be considered novel or cannot be considered to involve an inventive step when the document is taken alone
- "Y" document of particular relevance; the claimed invention cannot be considered to involve an inventive step when the document is combined with one or more other such documents, such combination being obvious to a person skilled in the art
- "&" document member of the same patent family

Date of the actual completion of the international search 11 July 2014	Date of mailing of the international search report 18/07/2014
Name and mailing address of the ISA/ European Patent Office, P.B. 5818 Patentlaan 2 NL - 2280 HV Rijswijk Tel. (+31-70) 340-2040, Fax: (+31-70) 340-3016	Authorized officer Pugliese, Sandro

INTERNATIONAL SEARCH REPORT

International application No
PCT/EP2013/075350

C(Continuation). DOCUMENTS CONSIDERED TO BE RELEVANT		
Category*	Citation of document, with indication, where appropriate, of the relevant passages	Relevant to claim No.
X	WO 2010/015894 A1 (FRAMATOME CONNECTORS INT [FR]; MULOT GERARD [FR]; ROZET DOMINIQUE [FR]) 11 February 2010 (2010-02-11) abstract page 6, line 8 - page 7, line 20 figures 3-6 -----	1,2,7,8, 10-15, 18,19, 21-27
X	JP 2001 135398 A (JAPAN AVIATION ELECTRON) 18 May 2001 (2001-05-18) abstract figures 1-7 -----	1,7,8, 10-15, 18,19, 21-27
X	US 2002/160666 A1 (SATO NAOTOSHI [JP] ET AL) 31 October 2002 (2002-10-31) abstract figures 1-6 -----	1,7,8, 10-15, 18,19, 21-27
A	WO 2013/046663 A1 (YAZAKI CORP [JP]; KATO HAJIME [JP]) 4 April 2013 (2013-04-04) figures 4,6,8,10,12-13 -----	1-28

INTERNATIONAL SEARCH REPORT

Information on patent family members

International application No PCT/EP2013/075350

Patent document cited in search report	Publication date	Patent family member(s)	Publication date
US 2012295493 A1	22-11-2012	JP 2012243542 A US 2012295493 A1	10-12-2012 22-11-2012

US 5681190 A	28-10-1997	NONE	

WO 2010015894 A1	11-02-2010	CN 102119470 A EP 2311149 A1 WO 2010015894 A1	06-07-2011 20-04-2011 11-02-2010

JP 2001135398 A	18-05-2001	JP 3489045 B2 JP 2001135398 A	19-01-2004 18-05-2001

US 2002160666 A1	31-10-2002	JP 2000173703 A US 2002160666 A1	23-06-2000 31-10-2002

WO 2013046663 A1	04-04-2013	CN 103828128 A EP 2761697 A1 JP 2013073741 A WO 2013046663 A1	28-05-2014 06-08-2014 22-04-2013 04-04-2013
