

Correct Installation Methods



1. ONLY cut at the scissor mark or black spot, NOT cut at else place.



2. Use proper aluminum channel track to fix when making linear installation, neon light's glowing surface to be upwards.

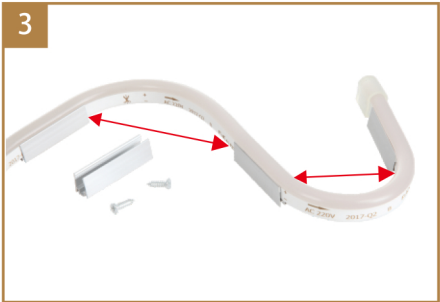

3. When installing the neon light to corner place, use mounting clips and make the bending diameter $\geq 8\text{cm}$, glowing surface upwards.

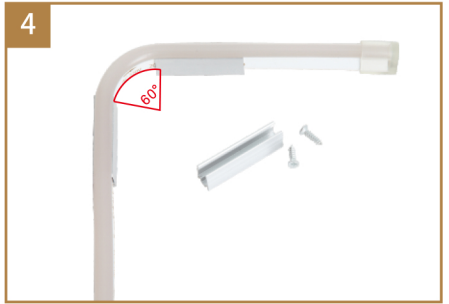

4. When making near 90 angles, leave a 60° soft angle in the corner and use mounting clips in turning places, glowing surface upwards.

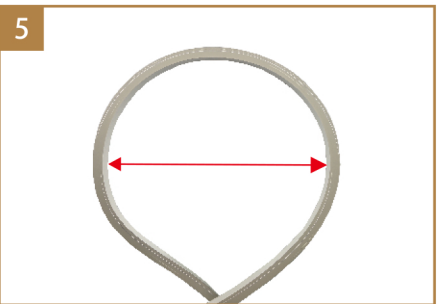

5. The neon rope light's minimum bending diameter is 8cm , when bending, make the diameter $\geq 8\text{cm}$.

Wrong Installation Methods



1. DON'T bend towards neon light's glowing surface or over-twisting the neon light strip, this will cause wrinkling and breaking of the led chip board and ruin the light strip.

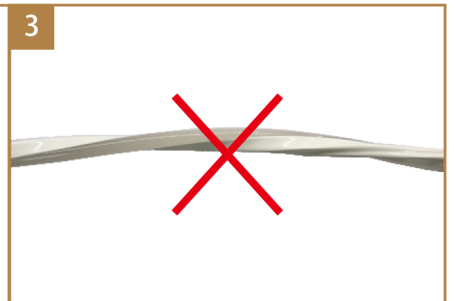

2. DON'T bend upwards or downwards the neon light's glowing surface, this will damage the led chip board.