

TEL: +91-11-24632950 Extn: 2219/2233 AFS: VIDDYXAX FAX: +91-11-24615508 Email: gmais@aai.aero	INDIA AERONAUTICAL INFORMATION SERVICE AIRPORTS AUTHORITY OF INDIA RAJIV GANDHI BHAVAN SAFDARJUNG AIRPORT NEW DELHI – 110003	211/2023
		28 DEC 2023

File No. ATM-19013(19)/1/2023-ATM

Following supplement is issued for information, guidance and necessary action.

sd/-

संजीव कुमार

SANJEEV KUMAR

अध्यक्ष/CHAIRMAN

भारतीय विमानपत्तन प्राधिकरण

AIRPORTS AUTHORITY OF INDIA

[EFFECTIVE DATE: 22 FEB 2024]

COMMISSIONING OF PART PARALLEL TAXIWAYS E2 AND E3,
ASSOCIATED TAXIWAYS AND NEW APRON
TIRUCHIRAPPALLI AIRPORT, TIRUCHIRAPPALLI (VOTR)

INTRODUCTION:

The purpose of this AIP Supplement is to inform all external and internal stakeholders of Tiruchirappalli Airport regarding the commissioning of new ground infrastructure as per the following details:

- i. Part Parallel Taxiways E2 and E3
- ii. Link Taxiway H and E1
- iii. Taxiway F and Taxiway G
- iv. New Apron with Stand Nos. 10 to 20.

- For details refer Aircraft Parking/Docking Chart.

AMENDMENT/CANCELLATIONS

1. Amend VOTR AD 2.8 of eAIP India as shown below:

VOTR AD 2.8 APRONS, TAXIWAYS AND CHECK LOCATIONS/POSITIONS DATA

1	Designation, surface and strength of aprons	Refer Aircraft Parking/Docking Chart
---	---	--------------------------------------

2	Designation, width, surface and strength of taxiways	Refer Aircraft Parking/Docking Chart
6	Remarks	<p>1. Coordinates of RWY Holding Position</p> <ul style="list-style-type: none"> i. TWY A: 104552.82N 0784231.49E/ELEV: 292 FT ii. TWY B: 104552.96N 0784234.08E/ELEV: 291 FT iii. TWY D: 104558.81N 0784230.55E/ELEV: 287 FT iv. TWY J: 104602.13N 0784314.14E/ELEV: 280 FT v. TWY H: 104556.16N 0784314.62E/ELEV: 282 FT <p>2. Coordinates of RWY & TWY Intersection:</p> <ul style="list-style-type: none"> i. TWY A TWY B, TWY D:104555.90N 0784232.31E/ELEV: 290 FT ii. TWY J: 104559.21N 0784314.38E/ELEV: 283 FT iii. TWY H: 104559.21N 0784314.38E/ELEV: 283 FT <p>3. Coordinates of Intermediate Holding Positions (IHP):</p> <ul style="list-style-type: none"> i. IHP 1 on E1: 104549.97N 0784232.63E ii. IHP 2 on E1: 104550.08N 0784234.10E iii. IHP 3 on B: 104548.39N 0784236.84E iv. IHP 4 on E2: 104550.37N 0784237.84E v. IHP 5 on E2: 104552.26N 0784301.90E vi. IHP 6 on F: 104550.85N 0784303.61E vii. IHP 7 on E3: 104552.50N 0784305.00E viii. IHP 8 on E3: 104552.72N 0784307.76E <p>3.4. Geoid Model: EGM08</p>

2. Amend VOTR AD 2.9 of eAIP India as shown below:

VOTR AD 2.9 SURFACE MOVEMENT GUIDANCE AND CONTROL SYSTEM AND MARKINGS

1	Use of aircraft stand identification signs, taxiway guidelines and visual docking/parking guidance system at aircraft stands	TWY guidance sign at all the intersection with TWY and RWY and at all holding position Guidelines at Apron. Nose in guidance at aircraft stands. PAX Boarding Bridge with Advanced Visual Docking Guidance System available on Stand NR. 7 5,6,7 and 10 – 19.
---	--	--

3. **Replace** Aerodrome Chart in VOTR AD 2.24 of eAIP India with the Aerodrome Chart of this AIP Supplement.

4. **Replace** Aircraft Parking/Docking Chart in VOTR AD 2.24 of eAIP India with the Aircraft Parking/Docking Chart of this AIP Supplement.

AERODROME CHART

10° 45' 56.116" N
078° 42' 54.161" E

AD. ELEV. : 292 ft.

MAIN 118.3/124.0

TIRUCHIRAPPALLI , INDIA
TIRUCHIRAPPALLI AIRPORT

RWY	DIRECTION	THR. CO-ORDINATES	THR. ELEV.	BEARING STRENGTH
09	087°	10° 45' 55.64" N 078° 42' 28.98" E	291	64°/A/W/T FROM BEGINNING RWY-09 TO 1847M
27	267°	10° 46' 01.51" N 078° 43' 43.66" E	268	93°/F/B/W/T FROM 1847 TO 2423M

* DATUM: HORIZONTAL-WGS 84
VERTICAL EGM-08
* ELEVATIONS IN FEET
* DIMENSIONS IN METRES
* RWY BEARINGS ARE MAGNETIC

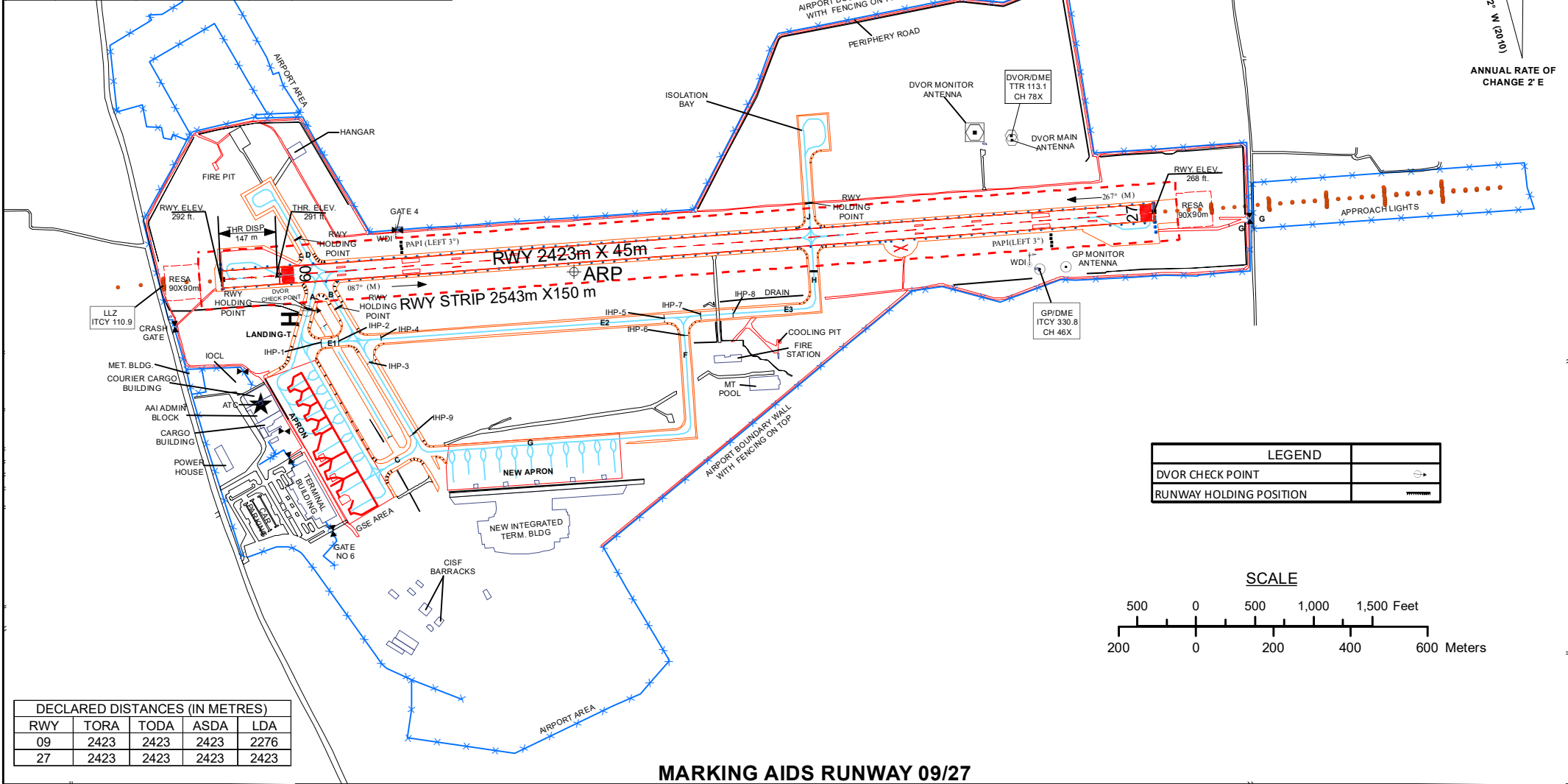
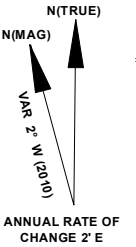

LEGEND	
DVOR CHECK POINT	
RUNWAY HOLDING POSITION	

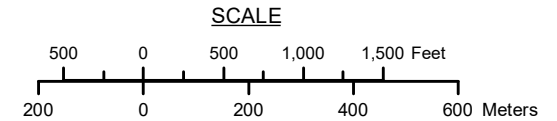

DECLARED DISTANCES (IN METRES)				
RWY	TORA	TODA	ASDA	LDA
09	2423	2423	2423	2276
27	2423	2423	2423	2423

MARKING AIDS RUNWAY 09/27

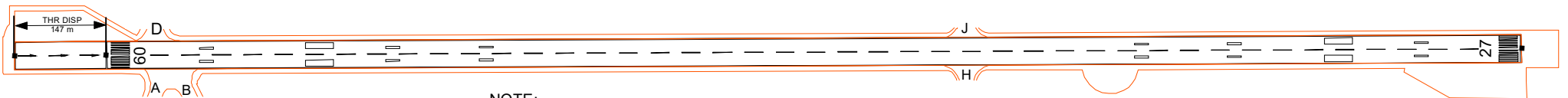

AERONAUTICAL INFO PTO SEPTEMBER 2023

NOTE:
1.AERONAUTICAL GROUND LIGHTS ARE NOT SHOWN IN THIS CHART.

MAP REF : QA/TRY/ADC/2023/N 1/2
DATE OF ISSUE : 08.06.2023
SUPERSEDES DATE : 20.05.2023

AIRCRAFT PARKING/ DOCKING CHART

APRON ELEV. 296 Ft.

TWR 118.3/124.0

TIRUCHIRAPPALLI , INDIA TIRUCHIRAPPALLI AIRPORT

* DATUM: HORIZONTAL WGS 84
VERTICAL EGM-08
* ELEVATIONS IN FEET
* DIMENSIONS IN METRES
* RWY BEARINGS ARE MAGNETIC

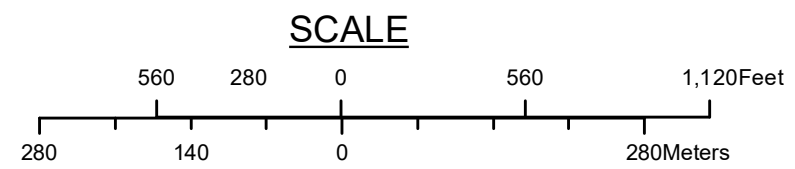
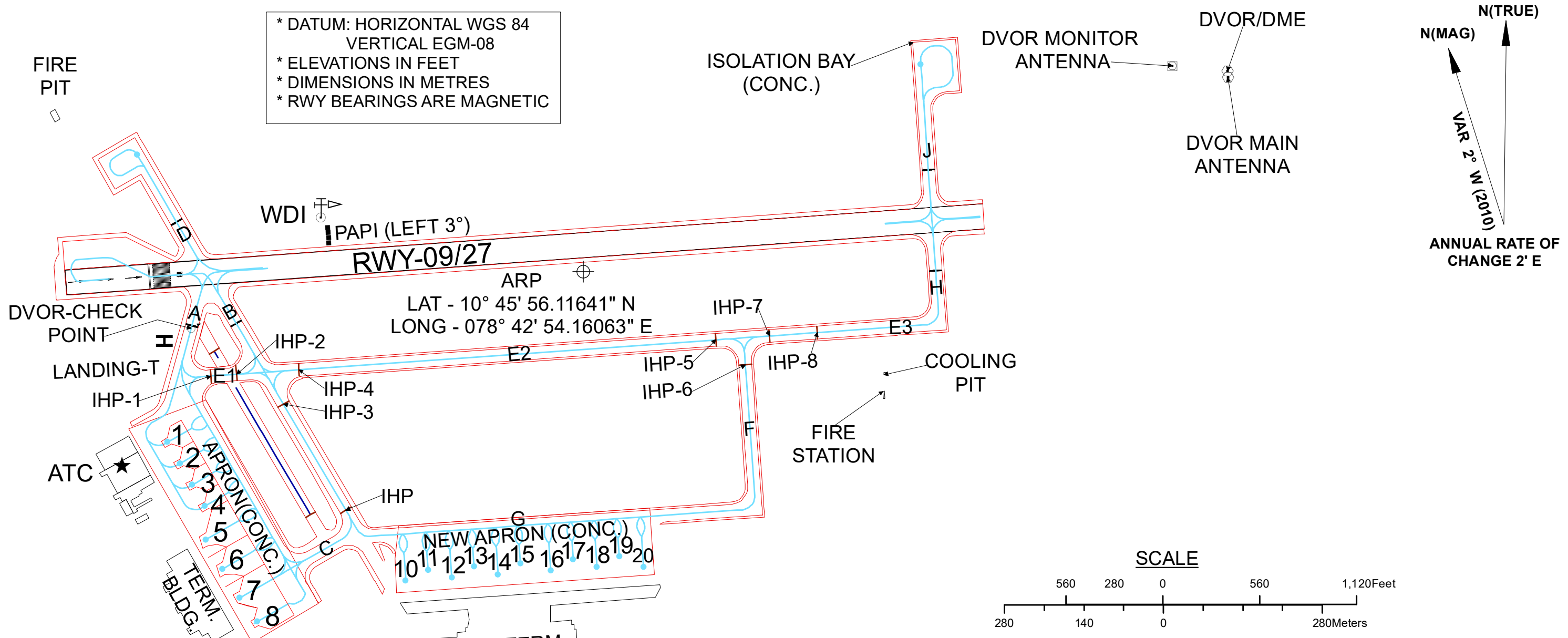

TWY	PCN	WIDTH
A	51/F/B/W/T	23 M
B	55/F/B/W/T	23 M
C	61/F/C/W/T	23 M
D	55/F/B/W/T	23 M
E1	64/F/A/W/T	23 M
E2	87/R/B/W/T	23 M
E3	87/R/B/W/T	23 M
F	87/R/B/W/T	23 M
G	87/R/B/W/T	23 M
H	87/R/B/W/T	23 M
J	64/R/B/W/T	23 M

PARKING BAY DETAILS							
STAND NO	COORDINATES FOR AIRCRAFT STAND		SUITABILITY	PCN	ELEV	REMARKS	CONTACT / REMOTE
	LATITUDE	LONGITUDE					
BAY 1	10° 45' 46.16378" N	078° 42' 30.14062" E	B739, A321	70/R/C/W/T	296	POWER-IN POWER-OUT	REMOTE
BAY 2	10° 45' 44.94357" N	078° 42' 30.86449" E	B739, A321	70/R/C/W/T	295	POWER-IN POWER-OUT	REMOTE
BAY 3	10° 45' 43.72307" N	078° 42' 31.59116" E	B739, A321	70/R/C/W/T	295	POWER-IN POWER-OUT	REMOTE
BAY 4	10° 45' 42.50187" N	078° 42' 32.31720" E	B739, A321	70/R/C/W/T	295	POWER-IN POWER-OUT	REMOTE
BAY 5	10° 45' 40.58792" N	078° 42' 32.40113" E	B767	84/R/B/W/T	294	POWER-IN PUSH-BACK	CONTACT
BAY 6	10° 45' 38.91787" N	078° 42' 33.39504" E	B767	84/R/B/W/T	293	POWER-IN PUSH-BACK	CONTACT
BAY 7	10° 45' 37.25202" N	078° 42' 34.38579" E	B767	84/R/B/W/T	293	POWER-IN PUSH-BACK	CONTACT
BAY 8	10° 45' 35.911" N	078° 42' 35.425" E	A321	68/R/B/W/T	292	POWER-IN PUSH-BACK	REMOTE
BAY 10	10° 45' 38.309" N	078° 42' 44.016" E	A321	87/R/B/W/T	289	POWER-IN PUSH-BACK	CONTACT
BAY 11	10° 45' 38.941" N	078° 42' 45.305" E	A321	87/R/B/W/T	289	POWER-IN PUSH-BACK	CONTACT
BAY 12	10° 45' 38.516" N	078° 42' 46.690" E	A321	87/R/B/W/T	289	POWER-IN PUSH-BACK	CONTACT
BAY 13	10° 45' 39.148" N	078° 42' 47.980" E	A321	87/R/B/W/T	289	POWER-IN PUSH-BACK	CONTACT
BAY 14	10° 45' 38.708" N	078° 42' 49.365" E	A321	87/R/B/W/T	289	POWER-IN PUSH-BACK	CONTACT
BAY 15	10° 45' 39.356" N	078° 42' 50.655" E	A321	87/R/B/W/T	289	POWER-IN PUSH-BACK	CONTACT
BAY 16	10° 45' 38.960" N	078° 42' 52.423" E	A321	87/R/B/W/T	289	POWER-IN PUSH-BACK	CONTACT
BAY 17	10° 45' 39.594" N	078° 42' 53.713" E	A321	87/R/B/W/T	289	POWER-IN PUSH-BACK	CONTACT
BAY 18	10° 45' 39.169" N	078° 42' 55.097" E	A321	87/R/B/W/T	289	POWER-IN PUSH-BACK	CONTACT
BAY 19	10° 45' 39.802" N	078° 42' 56.387" E	A321	87/R/B/W/T	289	POWER-IN PUSH-BACK	CONTACT
BAY 20	10° 45' 39.209" N	078° 42' 57.805" E	A321	87/R/B/W/T	289	POWER-IN PUSH-BACK	CONTACT
ISOLATION BAY	10° 46' 08.139" N	078° 43' 13.659" E	A321	64/R/B/W/T	275	POWER-IN POWER-OUT	REMOTE

LEGEND	
AIRCRAFT STAND	
VOR CHECKPOINT	
RUNWAY HOLDING POSITION	