

ADJUSTABLE DOORSTOP PART # 521

For heavy duty use, specify 599 which feature a captive adjustment screw drilled and tapped into the solid bar. One side of each piece mitered if ordered in sets.

Where adjustable door stops are applied on top of existing stops, it is recommended that locks with 3-3/4" backsets be used rather than locks with a 2-3/4" backset. This allows adequate space between the doorknob and the weatherstrip.

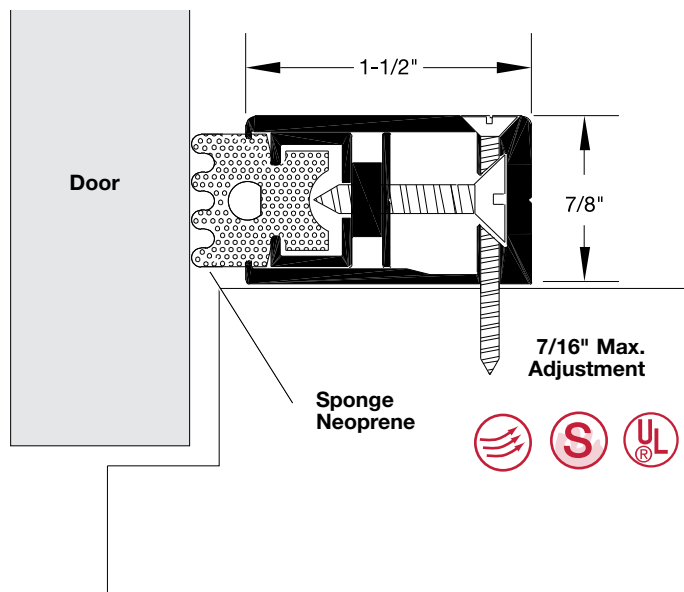

PLEASE NOTE: These products have been fire rated for use as perimeter seals only and shall not be used in lieu of an integral pressed steel stop on fire rated installations.